



Rogers

Assessment Property Record Card for Tax Year 2026

Data provided by LISA DELOZIER County Assessor

Date 04/16/2026
 Time 22:21:14
 Page 1

Assessment Data					Primary Image																																																																																																																				
Account 660023441 Parcel ID 000000-00-0-45010-002-0005 Cadastral ID 27-24-15-02150 Property Type REAL - Real Property Property Class URP VI Area 2 Tax Area 32 - TALALA OT/NW FIRE Name ID 274249 CLEEK, GENE A PO BOX 118 TALALA OK 74080-0000 Parcel Location Situs 00509 NOWATA Subdivision TALALA TOWN Lot/Block 0005 / 0002 Parcel Size 2 - Lots Sec/Twn/Rng 27 / 24 / 15 / 5 Neighborhood 1202 - R-V02-NW OOLOGAH School District S004 - OOLOGAH SCHOOLS					<p>660023441_003.JPG 1/23/2025</p>																																																																																																																				
Legal Description Lat/Long: 36.53280963 -95.69336025 LOTS 5 & 6 BLOCK 2 TALALA TOWN																																																																																																																									
Exemptions <table border="1"> <thead> <tr> <th>Code</th> <th>Type</th> <th>Active</th> <th>Maximum</th> <th>Exemption</th> </tr> </thead> <tbody> <tr> <td> </td> <td> </td> <td> </td> <td> </td> <td> </td> </tr> </tbody> </table>					Code	Type	Active	Maximum	Exemption						Building Permits <table border="1"> <thead> <tr> <th>Number</th> <th>Description</th> <th>Opened</th> <th>Closed</th> <th>Amount</th> </tr> </thead> <tbody> <tr> <td> </td> <td> </td> <td> </td> <td> </td> <td> </td> </tr> </tbody> </table>					Number	Description	Opened	Closed	Amount																																																																																																	
Code	Type	Active	Maximum	Exemption																																																																																																																					
Number	Description	Opened	Closed	Amount																																																																																																																					
Parcel Valuation <table border="1"> <thead> <tr> <th>Source</th> <th>REAL</th> <th>Fair Cash</th> <th>Capped</th> <th>Asmnt Level</th> <th>Assessed</th> <th>Levy Rate</th> <th>108.182</th> <th>Current Tax</th> </tr> </thead> <tbody> <tr> <td>Remove Cap</td> <td>2001</td> <td>Land Value 8,836</td> <td>8,836</td> <td>11%</td> <td>972</td> <td>Assessed</td> <td>3,254</td> <td>352.02</td> </tr> <tr> <td>Year Frozen</td> <td>0</td> <td>Improvements 20,746</td> <td>20,746</td> <td></td> <td>2,282</td> <td>Penalty</td> <td>0</td> <td></td> </tr> <tr> <td>Uncapped Value</td> <td>0</td> <td>Mobile Home 0</td> <td>0</td> <td></td> <td>0</td> <td>Exemption</td> <td>0</td> <td>0.00</td> </tr> <tr> <td>TIF Project ID</td> <td>0</td> <td>Total Value 29,582</td> <td>29,582</td> <td></td> <td>3,254</td> <td>Total Taxable</td> <td>3,254</td> <td>352.00</td> </tr> </tbody> </table>					Source	REAL	Fair Cash	Capped	Asmnt Level	Assessed	Levy Rate	108.182	Current Tax	Remove Cap	2001	Land Value 8,836	8,836	11%	972	Assessed	3,254	352.02	Year Frozen	0	Improvements 20,746	20,746		2,282	Penalty	0		Uncapped Value	0	Mobile Home 0	0		0	Exemption	0	0.00	TIF Project ID	0	Total Value 29,582	29,582		3,254	Total Taxable	3,254	352.00	Sale History <table border="1"> <thead> <tr> <th>Bk/Pg</th> <th>Grantor</th> <th>Date</th> <th>Price</th> <th>Code</th> </tr> </thead> <tbody> <tr> <td>1228/854</td> <td>YOCHAM, BILLY C TRUSTEE</td> <td>05/17/2000</td> <td>28,500</td> <td>Yes</td> </tr> <tr> <td>902/152</td> <td>YOCHAM, BILLY C TRUSTEE</td> <td>12/18/1992</td> <td>0</td> <td>No</td> </tr> <tr> <td>892/829</td> <td>YOCHAM, BILLY C TRUSTEE</td> <td>09/15/1992</td> <td>0</td> <td>No</td> </tr> </tbody> </table>					Bk/Pg	Grantor	Date	Price	Code	1228/854	YOCHAM, BILLY C TRUSTEE	05/17/2000	28,500	Yes	902/152	YOCHAM, BILLY C TRUSTEE	12/18/1992	0	No	892/829	YOCHAM, BILLY C TRUSTEE	09/15/1992	0	No																																															
Source	REAL	Fair Cash	Capped	Asmnt Level	Assessed	Levy Rate	108.182	Current Tax																																																																																																																	
Remove Cap	2001	Land Value 8,836	8,836	11%	972	Assessed	3,254	352.02																																																																																																																	
Year Frozen	0	Improvements 20,746	20,746		2,282	Penalty	0																																																																																																																		
Uncapped Value	0	Mobile Home 0	0		0	Exemption	0	0.00																																																																																																																	
TIF Project ID	0	Total Value 29,582	29,582		3,254	Total Taxable	3,254	352.00																																																																																																																	
Bk/Pg	Grantor	Date	Price	Code																																																																																																																					
1228/854	YOCHAM, BILLY C TRUSTEE	05/17/2000	28,500	Yes																																																																																																																					
902/152	YOCHAM, BILLY C TRUSTEE	12/18/1992	0	No																																																																																																																					
892/829	YOCHAM, BILLY C TRUSTEE	09/15/1992	0	No																																																																																																																					
Assessment History <table border="1"> <thead> <tr> <th>Tax Year</th> <th>Statement Number</th> <th>Billed Owner</th> <th>Tax Area</th> <th>Total Value</th> <th>Exemptions</th> <th>Taxable Value</th> <th>Billed Tax</th> </tr> </thead> <tbody> <tr><td>2025</td><td>2025-660023441</td><td>CLEEK, GENE A</td><td>32</td><td>30,082</td><td>0</td><td>3,309</td><td>358.00</td></tr> <tr><td>2024</td><td>2024-660023441</td><td>CLEEK, GENE A</td><td>32</td><td>31,750</td><td>0</td><td>3,176</td><td>333.00</td></tr> <tr><td>2023</td><td>2023-660023441</td><td>CLEEK, GENE A</td><td>32</td><td>30,509</td><td>0</td><td>3,025</td><td>314.00</td></tr> <tr><td>2022</td><td>2022-660023441</td><td>CLEEK, GENE A</td><td>32</td><td>31,234</td><td>0</td><td>2,880</td><td>298.00</td></tr> <tr><td>2021</td><td>2021-660023441</td><td>CLEEK, GENE A</td><td>32</td><td>27,273</td><td>0</td><td>2,744</td><td>286.00</td></tr> <tr><td>2020</td><td>2020-660023441</td><td>CLEEK, GENE A</td><td>32</td><td>23,754</td><td>0</td><td>2,613</td><td>274.00</td></tr> <tr><td>2019</td><td>2019-660023441</td><td>CLEEK, GENE A</td><td>32</td><td>23,916</td><td>0</td><td>2,631</td><td>270.00</td></tr> <tr><td>2018</td><td>2018-660023441</td><td>CLEEK, GENE A</td><td>32</td><td>26,925</td><td>0</td><td>2,962</td><td>314.00</td></tr> <tr><td>2017</td><td>2017-660023441</td><td>CLEEK, GENE A</td><td>32</td><td>26,738</td><td>0</td><td>2,941</td><td>334.00</td></tr> <tr><td>2016</td><td>2016-660023441</td><td>CLEEK, GENE A</td><td>32</td><td>26,074</td><td>0</td><td>2,868</td><td>294.00</td></tr> <tr><td>2015</td><td>2015-660023441</td><td>CLEEK, GENE A</td><td>32</td><td>25,674</td><td>0</td><td>2,824</td><td>276.00</td></tr> <tr><td>2014</td><td>2014-660023441</td><td>CLEEK, GENE A</td><td>32</td><td>25,850</td><td>0</td><td>2,843</td><td>278.00</td></tr> <tr><td>2013</td><td>2013-660023441</td><td>CLEEK, GENE A</td><td>32</td><td>27,373</td><td>0</td><td>2,969</td><td>281.00</td></tr> </tbody> </table>										Tax Year	Statement Number	Billed Owner	Tax Area	Total Value	Exemptions	Taxable Value	Billed Tax	2025	2025-660023441	CLEEK, GENE A	32	30,082	0	3,309	358.00	2024	2024-660023441	CLEEK, GENE A	32	31,750	0	3,176	333.00	2023	2023-660023441	CLEEK, GENE A	32	30,509	0	3,025	314.00	2022	2022-660023441	CLEEK, GENE A	32	31,234	0	2,880	298.00	2021	2021-660023441	CLEEK, GENE A	32	27,273	0	2,744	286.00	2020	2020-660023441	CLEEK, GENE A	32	23,754	0	2,613	274.00	2019	2019-660023441	CLEEK, GENE A	32	23,916	0	2,631	270.00	2018	2018-660023441	CLEEK, GENE A	32	26,925	0	2,962	314.00	2017	2017-660023441	CLEEK, GENE A	32	26,738	0	2,941	334.00	2016	2016-660023441	CLEEK, GENE A	32	26,074	0	2,868	294.00	2015	2015-660023441	CLEEK, GENE A	32	25,674	0	2,824	276.00	2014	2014-660023441	CLEEK, GENE A	32	25,850	0	2,843	278.00	2013	2013-660023441	CLEEK, GENE A	32	27,373	0	2,969	281.00
Tax Year	Statement Number	Billed Owner	Tax Area	Total Value	Exemptions	Taxable Value	Billed Tax																																																																																																																		
2025	2025-660023441	CLEEK, GENE A	32	30,082	0	3,309	358.00																																																																																																																		
2024	2024-660023441	CLEEK, GENE A	32	31,750	0	3,176	333.00																																																																																																																		
2023	2023-660023441	CLEEK, GENE A	32	30,509	0	3,025	314.00																																																																																																																		
2022	2022-660023441	CLEEK, GENE A	32	31,234	0	2,880	298.00																																																																																																																		
2021	2021-660023441	CLEEK, GENE A	32	27,273	0	2,744	286.00																																																																																																																		
2020	2020-660023441	CLEEK, GENE A	32	23,754	0	2,613	274.00																																																																																																																		
2019	2019-660023441	CLEEK, GENE A	32	23,916	0	2,631	270.00																																																																																																																		
2018	2018-660023441	CLEEK, GENE A	32	26,925	0	2,962	314.00																																																																																																																		
2017	2017-660023441	CLEEK, GENE A	32	26,738	0	2,941	334.00																																																																																																																		
2016	2016-660023441	CLEEK, GENE A	32	26,074	0	2,868	294.00																																																																																																																		
2015	2015-660023441	CLEEK, GENE A	32	25,674	0	2,824	276.00																																																																																																																		
2014	2014-660023441	CLEEK, GENE A	32	25,850	0	2,843	278.00																																																																																																																		
2013	2013-660023441	CLEEK, GENE A	32	27,373	0	2,969	281.00																																																																																																																		



Rogers

Assessment Property Record Card for Tax Year 2026

Data provided by LISA DELOZIER County Assessor

Date 04/16/2026
 Time 22:21:15
 Page 2

Lot Data		Square-Foot - NBHD 1202 #1
Lot Size		
Lot Count		
Units Buildable	1	
Non-Ag Acres	0.5131	
Topography		
Street Access		
Utilities		
Amenities	LAND QUALITY	0
		0
Method	Square-Foot	
Base Lot Value	22,352.00 x .40 = 8,836	
Factor Value		
Adjustments	1.0000	
Lot Value	8,836	



Residential Data	
Type	1 Single Family Residence
Condition	1.5 - Low
Quality	1 - Low
Architecture	
Style	100% One Story
Exterior Wall	100% Frame, Siding, Vinyl
Base/Total Area	680 / 680
Style	100% One Story
HVAC	100% Floor Furnace
Roof Cover	4 Metal, Preformed
Area on Slab	0
Fixture/RghIn	4 /
Bed/F/H Bath	2 / 1.0 /
Basement Area	
Garage Type	600 Attached Garage - Unfinished
Remodel	
Year/Eff Age	1967 / 71

660023441_003.JPG 1/23/2025

GRM Approach	
GRM Code	
Gross Rent	0.00
Indicated Value	

Multiple Regression			
MRA Code	1	Test	
Adusted R	0.8445		
Indicated Value	85,462	125.68	Per SqFt

Direct Comparables	
Selection Model	A Adam Test
Adjustment Model	1 2022 Residential
Comparables	
Indicated Value	

Cost Approach				Manual : 01/2025	
Base Cost	90.98	Total Misc Impr	+	1,204	
Roofing Adj	+ 5.13	Garage Cost	+	12,354	
Subfloor Adj	+ 2.77	Total RCN	=	86,440	
Heat/Cool Adj	+ 1.52	Depreciation (76%)	-	65,694	
Plumbing Adj	+ 6.78	Lump Sums	+	0	
Basement Adj	+ 0.00	RCNLD	=	20,746	
Adj Base Cost	= 107.18	Lot Value	+	8,836	
Total Area	x 680	Indicated Value	=	29,582	
Adjusted Cost	= 72,882	Value Per SqFt		43.50	

Value Reconciliation			
Selected Approach	Cost Approach		
Improvements	20,746		
Lot Value	8,836		
Indicated Value	29,582	43.50	Per SqFt
Agland Value			
Site Improvements			
Total Value	29,582	43.50	Total Value Per SqFt

Miscellaneous Improvements								
Code	Description	Sketch ID	Size	Year	Units	Unit Cost	Depr	Value
PRCH	SLAB PORCH - COVERED	57784	11x6		66	18.24		1,204



Rogers

Assessment Property Record Card for Tax Year 2026

Data provided by LISA DELOZIER County Assessor

Date 04/16/2026
 Time 22:21:15
 Page 3

Sketch Image

660023441

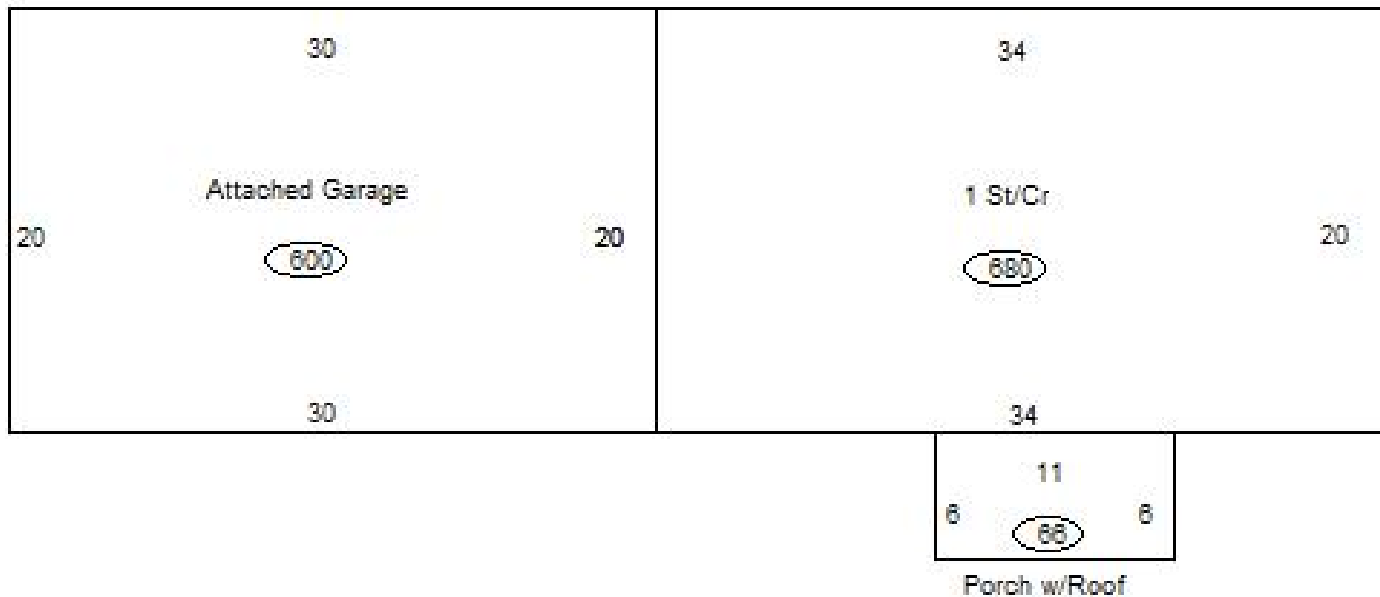

Sketch Vector Information

Sequence	Code	Type	Built Over	Scale	Section Label	Base Area	Multiplier	Total Area
1	R	1	Crawl	13	1 St/Cr	680	1.000	680
2	G	1		13	Attached Garage	600	1.000	600
3	M	PRCH		13	SLBC	66	1.000	66
Total Building Area						680		680



Rogers

Assessment Property Record Card for Tax Year 2026

Data provided by LISA DELOZIER County Assessor

Date 04/16/2026
Time 22:21:15
Page 4

660023441

Outbuildings/Site Improvements

Building Image	Code	Description	Dimensions	Floor	Roofing	Total Units
	STF	STG FAIR	0x0x0			
	Qual	2	Cond	Year	Eff Age	
Valuation Summary			Modifier Total	RCN	Depr (100% Phys/ % Func)	RCNLD
		Base Cost (4.68 x)				