



Rogers

Assessment Property Record Card for Tax Year 2026

Data provided by LISA DELOZIER County Assessor

Date 04/16/2026
 Time 22:21:30
 Page 1

Assessment Data					Primary Image																																																																																																																				
Account 660023495 Parcel ID 000000-00-0-45010-017-0004 Cadastral ID 27-24-15-02680 Property Type REAL - Real Property Property Class URP VI Area 2 Tax Area 32 - TALALA OT/NW FIRE Name ID 202474 SWEET, BILLY L 202 E WATOVA TALALA OK 74080-0000 Parcel Location Situs 00202 WATOVA Subdivision TALALA TOWN Lot/Block 0004 / 0017 Parcel Size 1.33 - Lots Sec/Twn/Rng 27 / 24 / 15 / 5 Neighborhood 1202 - R-V02-NW OOLOGAH School District S004 - OOLOGAH SCHOOLS					 <p>660023495 12/03/24</p> <p>660023495_002.JPG 1/23/2025</p>																																																																																																																				
Legal Description Lat/Long: 36.53046327 -95.69817474 W 25' LOT 3 & ALL LOT 4 & E 40' VACATED CEDAR ST BLOCK 17 TALALA TOWN																																																																																																																									
Exemptions <table border="1"> <thead> <tr> <th>Code</th> <th>Type</th> <th>Active</th> <th>Maximum</th> <th>Exemption</th> </tr> </thead> <tbody> <tr> <td>H</td> <td>Homestead</td> <td>Yes</td> <td>1,000</td> <td>1,000</td> </tr> </tbody> </table>					Code	Type	Active	Maximum	Exemption	H	Homestead	Yes	1,000	1,000	Building Permits <table border="1"> <thead> <tr> <th>Number</th> <th>Description</th> <th>Opened</th> <th>Closed</th> <th>Amount</th> </tr> </thead> <tbody> <tr> <td colspan="5"> </td> </tr> </tbody> </table>					Number	Description	Opened	Closed	Amount																																																																																																	
Code	Type	Active	Maximum	Exemption																																																																																																																					
H	Homestead	Yes	1,000	1,000																																																																																																																					
Number	Description	Opened	Closed	Amount																																																																																																																					
Parcel Valuation <table border="1"> <thead> <tr> <th>Source</th> <th>REAL</th> <th>Fair Cash</th> <th>Capped</th> <th>Asmnt Level</th> <th>Assessed</th> <th>Levy Rate</th> <th>108.182</th> <th>Current Tax</th> </tr> </thead> <tbody> <tr> <td>Remove Cap</td> <td>0</td> <td>Land Value 9,980</td> <td>7,597</td> <td>11%</td> <td>836</td> <td>Assessed</td> <td>5,758</td> <td>622.91</td> </tr> <tr> <td>Year Frozen</td> <td>2005</td> <td>Improvements 58,780</td> <td>44,746</td> <td></td> <td>4,922</td> <td>Penalty</td> <td>0</td> <td></td> </tr> <tr> <td>Uncapped Value</td> <td>0</td> <td>Mobile Home 0</td> <td>0</td> <td></td> <td>0</td> <td>Exemption</td> <td>1,000</td> <td>-94.00</td> </tr> <tr> <td>TIF Project ID</td> <td>0</td> <td>Total Value 68,760</td> <td>52,343</td> <td></td> <td>5,758</td> <td>Total Taxable</td> <td>4,758</td> <td>529.00</td> </tr> </tbody> </table>					Source	REAL	Fair Cash	Capped	Asmnt Level	Assessed	Levy Rate	108.182	Current Tax	Remove Cap	0	Land Value 9,980	7,597	11%	836	Assessed	5,758	622.91	Year Frozen	2005	Improvements 58,780	44,746		4,922	Penalty	0		Uncapped Value	0	Mobile Home 0	0		0	Exemption	1,000	-94.00	TIF Project ID	0	Total Value 68,760	52,343		5,758	Total Taxable	4,758	529.00	Sale History <table border="1"> <thead> <tr> <th>Bk/Pg</th> <th>Grantor</th> <th>Date</th> <th>Price</th> <th>Code</th> </tr> </thead> <tbody> <tr> <td colspan="5"> </td> </tr> </tbody> </table>					Bk/Pg	Grantor	Date	Price	Code																																																														
Source	REAL	Fair Cash	Capped	Asmnt Level	Assessed	Levy Rate	108.182	Current Tax																																																																																																																	
Remove Cap	0	Land Value 9,980	7,597	11%	836	Assessed	5,758	622.91																																																																																																																	
Year Frozen	2005	Improvements 58,780	44,746		4,922	Penalty	0																																																																																																																		
Uncapped Value	0	Mobile Home 0	0		0	Exemption	1,000	-94.00																																																																																																																	
TIF Project ID	0	Total Value 68,760	52,343		5,758	Total Taxable	4,758	529.00																																																																																																																	
Bk/Pg	Grantor	Date	Price	Code																																																																																																																					
Assessment History <table border="1"> <thead> <tr> <th>Tax Year</th> <th>Statement Number</th> <th>Billed Owner</th> <th>Tax Area</th> <th>Total Value</th> <th>Exemptions</th> <th>Taxable Value</th> <th>Billed Tax</th> </tr> </thead> <tbody> <tr><td>2025</td><td>2025-660023495</td><td>SWEET, BILLY L</td><td>32</td><td>67,553</td><td>1000</td><td>4,758</td><td>529.00</td></tr> <tr><td>2024</td><td>2024-660023495</td><td>SWEET, BILLY L</td><td>32</td><td>71,429</td><td>1000</td><td>4,757</td><td>513.00</td></tr> <tr><td>2023</td><td>2023-660023495</td><td>SWEET, BILLY L</td><td>32</td><td>64,040</td><td>1000</td><td>4,758</td><td>509.00</td></tr> <tr><td>2022</td><td>2022-660023495</td><td>SWEET, BILLY L</td><td>32</td><td>65,460</td><td>1000</td><td>4,757</td><td>506.00</td></tr> <tr><td>2021</td><td>2021-660023495</td><td>SWEET, BILLY L</td><td>32</td><td>70,158</td><td>1000</td><td>4,758</td><td>509.00</td></tr> <tr><td>2020</td><td>2020-660023495</td><td>SWEET, BILLY L</td><td>32</td><td>65,244</td><td>1000</td><td>4,757</td><td>510.00</td></tr> <tr><td>2019</td><td>2019-660023495</td><td>SWEET, BILLY L</td><td>32</td><td>64,146</td><td>1000</td><td>4,758</td><td>501.00</td></tr> <tr><td>2018</td><td>2018-660023495</td><td>SWEET, BILLY L</td><td>32</td><td>72,171</td><td>1000</td><td>4,758</td><td>518.00</td></tr> <tr><td>2017</td><td>2017-660023495</td><td>SWEET, BILLY L</td><td>32</td><td>71,377</td><td>1000</td><td>4,758</td><td>553.00</td></tr> <tr><td>2016</td><td>2016-660023495</td><td>SWEET, BILLY L</td><td>32</td><td>69,520</td><td>1000</td><td>4,758</td><td>500.00</td></tr> <tr><td>2015</td><td>2015-660023495</td><td>SWEET, BILLY L</td><td>32</td><td>67,270</td><td>1000</td><td>4,758</td><td>479.00</td></tr> <tr><td>2014</td><td>2014-660023495</td><td>SWEET, BILLY L</td><td>32</td><td>67,679</td><td>1000</td><td>4,758</td><td>478.00</td></tr> <tr><td>2013</td><td>2013-660023495</td><td>SWEET, BILLY L</td><td>32</td><td>65,798</td><td>1000</td><td>4,758</td><td>462.00</td></tr> </tbody> </table>										Tax Year	Statement Number	Billed Owner	Tax Area	Total Value	Exemptions	Taxable Value	Billed Tax	2025	2025-660023495	SWEET, BILLY L	32	67,553	1000	4,758	529.00	2024	2024-660023495	SWEET, BILLY L	32	71,429	1000	4,757	513.00	2023	2023-660023495	SWEET, BILLY L	32	64,040	1000	4,758	509.00	2022	2022-660023495	SWEET, BILLY L	32	65,460	1000	4,757	506.00	2021	2021-660023495	SWEET, BILLY L	32	70,158	1000	4,758	509.00	2020	2020-660023495	SWEET, BILLY L	32	65,244	1000	4,757	510.00	2019	2019-660023495	SWEET, BILLY L	32	64,146	1000	4,758	501.00	2018	2018-660023495	SWEET, BILLY L	32	72,171	1000	4,758	518.00	2017	2017-660023495	SWEET, BILLY L	32	71,377	1000	4,758	553.00	2016	2016-660023495	SWEET, BILLY L	32	69,520	1000	4,758	500.00	2015	2015-660023495	SWEET, BILLY L	32	67,270	1000	4,758	479.00	2014	2014-660023495	SWEET, BILLY L	32	67,679	1000	4,758	478.00	2013	2013-660023495	SWEET, BILLY L	32	65,798	1000	4,758	462.00
Tax Year	Statement Number	Billed Owner	Tax Area	Total Value	Exemptions	Taxable Value	Billed Tax																																																																																																																		
2025	2025-660023495	SWEET, BILLY L	32	67,553	1000	4,758	529.00																																																																																																																		
2024	2024-660023495	SWEET, BILLY L	32	71,429	1000	4,757	513.00																																																																																																																		
2023	2023-660023495	SWEET, BILLY L	32	64,040	1000	4,758	509.00																																																																																																																		
2022	2022-660023495	SWEET, BILLY L	32	65,460	1000	4,757	506.00																																																																																																																		
2021	2021-660023495	SWEET, BILLY L	32	70,158	1000	4,758	509.00																																																																																																																		
2020	2020-660023495	SWEET, BILLY L	32	65,244	1000	4,757	510.00																																																																																																																		
2019	2019-660023495	SWEET, BILLY L	32	64,146	1000	4,758	501.00																																																																																																																		
2018	2018-660023495	SWEET, BILLY L	32	72,171	1000	4,758	518.00																																																																																																																		
2017	2017-660023495	SWEET, BILLY L	32	71,377	1000	4,758	553.00																																																																																																																		
2016	2016-660023495	SWEET, BILLY L	32	69,520	1000	4,758	500.00																																																																																																																		
2015	2015-660023495	SWEET, BILLY L	32	67,270	1000	4,758	479.00																																																																																																																		
2014	2014-660023495	SWEET, BILLY L	32	67,679	1000	4,758	478.00																																																																																																																		
2013	2013-660023495	SWEET, BILLY L	32	65,798	1000	4,758	462.00																																																																																																																		



Rogers

Assessment Property Record Card for Tax Year 2026

Data provided by LISA DELOZIER County Assessor

Date 04/16/2026
Time 22:21:30
Page 2

Lot Data		Square-Foot - NBHD 1202 #1		Primary Image				
Lot Size								
Lot Count								
Units Buildable	21700							
Non-Ag Acres	0.6969							
Topography								
Street Access								
Utilities								
Amenities	LAND QUALITY	0						
		0						
Method	Square-Foot							
Base Lot Value	30,357.00 x .33 = 9,980							
Factor Value								
Adjustments	1.0000							
Lot Value	9,980							
Residential Data				660023495_002.JPG 1/23/2025				
Type	1 Single Family Residence			GRM Approach				
Condition	2 - Fair			GRM Code				
Quality	2 - Fair			Gross Rent 0.00				
Architecture				Indicated Value				
Style	100% One Story			Multiple Regression				
Exterior Wall	100% Veneer, Masonry			MRA Code 1 Test				
Base/Total Area	1,410 / 1,410			Adusted R 0.8445				
Style	100% One Story			Indicated Value 139,438 98.89 Per SqFt				
HVAC	100% Wall Furnace			Direct Comparables				
Roof Cover	1 Composition Shingle			Selection Model A Adam Test				
Area on Slab	0			Adjustment Model 1 2022 Residential				
Fixture/RghIn	4 /			Comparables 1				
Bed/F/H Bath	3 / 1.0 /			Indicated Value 19,000 Per SqFt				
Basement Area				Value Reconciliation				
Garage Type	576 Attached Garage - Unfinished			Selected Approach Cost Approach				
Remodel				Improvements 51,065				
Year/Eff Age	1962 / 64			Lot Value 9,980				
Cost Approach				Indicated Value 61,045 43.29 Per SqFt				
Manual : 01/2025				Agland Value				
Base Cost	96.24	Total Misc Impr	+ 6,592	Site Improvements 7,715				
Roofing Adj	+ 3.95	Garage Cost	+ 13,023	Total Value 68,760 48.77 Total Value Per SqFt				
Subfloor Adj	+ 2.31	Total RCN	= 170,217					
Heat/Cool Adj	+ 0.76	Depreciation (70%)	- 119,152					
Plumbing Adj	+ 3.55	Lump Sums	+ 0					
Basement Adj	+ 0.00	RCNLD	= 51,065					
Adj Base Cost	= 106.81	Lot Value	+ 9,980					
Total Area	x 1,410	Indicated Value	= 61,045					
Adjusted Cost	= 150,602	Value Per SqFt	43.29					
Miscellaneous Improvements								
Code	Description	Sketch ID	Size	Year	Units	Unit Cost	Depr	Value
FPR1	FIREPLACE - RESIDENTIAL 1 STORY	0		1	1	4,576.55		4,577
PRCH	SLAB PORCH - COVERED	115688	16x6		96	20.99		2,015



Rogers

Assessment Property Record Card for Tax Year 2026

Data provided by LISA DELOZIER County Assessor

Date 04/16/2026

Time 22:21:30

Page 3

Sketch Image

660023495

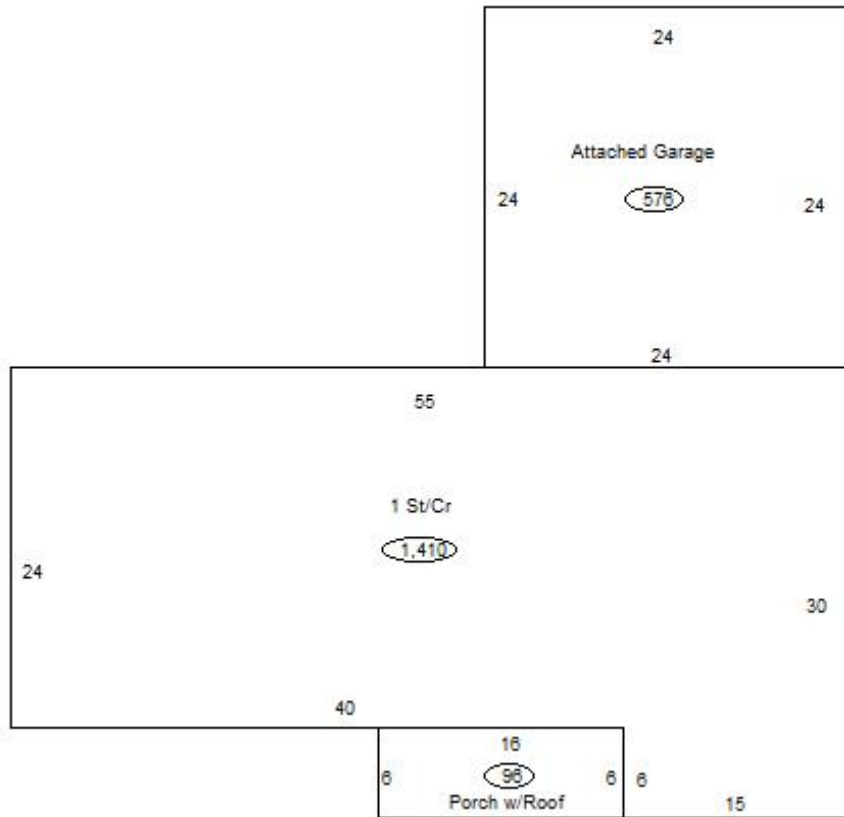

Sketch Vector Information

Sequence	Code	Type	Built Over	Scale	Section Label	Base Area	Multiplier	Total Area
1	R	1	Crawl	13	1 St/Cr	1,410	1.000	1,410
2	G	1		13	Attached Garage	576	1.000	576
3	M	PRCH		13	SLBC	96	1.000	96
Total Building Area						1,410		1,410



Rogers

Assessment Property Record Card for Tax Year 2026

Data provided by LISA DELOZIER County Assessor

Date 04/16/2026
 Time 22:21:30
 Page 4

660023495

Outbuildings/Site Improvements

Building Image	Code	Description	Dimensions	Floor	Roofing	Total Units
	DTGF	DETACHED GARAGE FAIR	0x0x0			576
	Qual 2	Cond 3	Year	Eff Age		
	Valuation Summary Base Cost (16.00 x 576) 9,216		Modifier Total	RCN 9,216	Depr (40% Phys/ % Func) 3,686	RCNLD 5,530
	CPDT	CARPORT - DETACHED	24x14x0			336
	Qual 2	Cond 3	Year	Eff Age 1520		
	Valuation Summary Base Cost (10.84 x 336) 3,642		Modifier Total	RCN 3,642	Depr (40% Phys/ % Func) 1,457	RCNLD 2,185