



Rogers

Assessment Property Record Card for Tax Year 2026

Data provided by LISA DELOZIER County Assessor

Date 04/17/2026
Time 14:21:00
Page 1

Assessment Data					Primary Image				
Account	660023547				<p>660023547 12/02/24</p> <p>660023547_005.JPG 1/23/2025</p>				
Parcel ID	000000-00-0-45010-026-0004								
Cadastral ID	27-24-15-03220								
Property Type	REAL - Real Property								
Property Class	URP VI Area 2								
Tax Area	32 - TALALA OT/NW FIRE								
Name ID	203594								
SWEET, GLENN P & NANCY J									
TRSUTEES									
PO BOX 24 TALALA OK 74080-0000									
Parcel Location									
Situs	00101 S CEDAR ST								
Subdivision	TALALA TOWN								
Lot/Block	0004 / 0026	Parcel Size	2 - Lots						
Sec/Twn/Rng	27 / 24 / 15 / 5								
Neighborhood	1202 - R-V02-NW OOLOGAH								
School District	S004 - OOLOGAH SCHOOLS								
Legal Description									
Lots 3 & 4 Block 26 Talala Town									
Lat/Long: 36.52936052 -95.69824491									
Building Permits									
Number Description Opened Closed Amount									
Exemptions									
Code	Type	Active	Maximum	Exemption					
H	Homestead	Yes	1,000	1,000					
Sale History									
Bk/Pg	Grantor	Date	Price	Code					
2588/578	SWEET, GLENN PAUL & NANCY JAYNI	10/27/2016	0	4					
Parcel Valuation									
Source	REAL	Fair Cash	Capped	Asmnt Level	Assessed	Levy Rate	108.182	Current Tax	
Remove Cap	0	Land Value	8,986	8,723	11%	960	Assessed	17,396 1,881.93	
Year Frozen	0	Improvements	183,827	149,425		16,436	Penalty	0	
Uncapped Value	0	Mobile Home	0	0		0	Exemption	1,000 -94.00	
TIF Project ID	0	Total Value	192,813	158,148		17,396	Total Taxable	16,396 1,788.00	
Assessment History									
Tax Year	Statement Number	Billed Owner	Tax Area	Total Value	Exemptions	Taxable Value	Billed Tax		
2025	2025-660023547	SWEET, GLENN P & NANCY J	32	190,159	1000	15,890	1,733.00		
2024	2024-660023547	SWEET, GLENN P & NANCY J	32	200,578	1000	15,398	1,627.00		
2023	2023-660023547	SWEET, GLENN P & NANCY J	32	176,320	1000	14,920	1,566.00		
2022	2022-660023547	SWEET, GLENN P & NANCY J	32	164,079	1000	14,457	1,511.00		
2021	2021-660023547	SWEET, GLENN P & NANCY J	32	166,100	1000	14,007	1,474.00		
2020	2020-660023547	SWEET, GLENN P & NANCY J	32	168,052	1000	13,569	1,433.00		
2019	2019-660023547	SWEET, GLENN P & NANCY J	32	159,167	1000	13,145	1,361.00		
2018	2018-660023547	SWEET, GLENN P & NANCY J	32	170,012	1000	12,734	1,364.00		
2017	2017-660023547	SWEET, GLENN P & NANCY J	32	167,947	1000	12,333	1,413.00		
2016	2016-660023547	SWEET, GLENN PAUL & NANCY JAYNE	32	163,635	1000	11,945	1,236.00		
2015	2015-660023547	SWEET, GLENN PAUL & NANCY JAYNE	32	162,419	1000	11,568	1,146.00		
2014	2014-660023547	SWEET, GLENN PAUL & NANCY JAYNE	32	167,972	1000	11,202	1,108.00		
2013	2013-660023547	SWEET, GLENN PAUL & NANCY JAYNE	32	161,126	1000	10,847	1,038.00		



Rogers

Assessment Property Record Card for Tax Year 2026

Data provided by LISA DELOZIER County Assessor

Date 04/17/2026
Time 14:21:00
Page 2

Lot Data		Square-Foot - NBHD 1202 #1		Primary Image				
Lot Size								
Lot Count								
Units Buildable	23400							
Non-Ag Acres	0.5372							
Topography								
Street Access								
Utilities								
Amenities	LAND QUALITY					0		
						0		
Method	Square-Foot							
Base Lot Value	23,402.00 x .38 = 8,986			660023547_005.JPG		1/23/2025		
Factor Value				GRM Approach				
Adjustments	1.0000			GRM Code				
Lot Value	8,986			Gross Rent 0.00				
Residential Data				Indicated Value				
Type	1 Single Family Residence			Multiple Regression				
Condition	3 - Average			MRA Code 1 Test				
Quality	2.5 - Fair			Adusted R 0.8445				
Architecture				Indicated Value 246,810 91.82 Per SqFt				
Style	100% 1 1/2 Story Finished			Direct Comparables				
Exterior Wall	75% Veneer, Stone 25% Frame, Siding, Wood			Selection Model A Adam Test				
Base/Total Area	2,116 / 2,688			Adjustment Model 1 2022 Residential				
Style	100% 1 1/2 Story Finished			Comparables				
HVAC	100% Warmed & Cooled Air			Indicated Value				
Roof Cover	1 Composition Shingle			Value Reconciliation				
Area on Slab	2,116			Selected Approach Cost Approach				
Fixture/RghIn	7 /			Improvements 161,166				
Bed/F/H Bath	4 / 1.5 /			Lot Value 8,986				
Basement Area				Indicated Value 170,152 63.30 Per SqFt				
Garage Type	484 Carport - Gable Roof			Agland Value				
Remodel				Site Improvements 22,661				
Year/Eff Age	1968 / 44			Total Value 192,813 71.73 Total Value Per SqFt				
Cost Approach		Manual : 01/2025						
Base Cost	90.08	Total Misc Impr	+ 11,963					
Roofing Adj	+ 3.31	Garage Cost	+ 3,920					
Subfloor Adj	+ -0.86	Total RCN	= 304,655					
Heat/Cool Adj	+ 11.47	Depreciation (52%)	- 158,421					
Plumbing Adj	+ 3.43	Lump Sums	+ 14,932					
Basement Adj	+ 0.00	RCNLD	= 161,166					
Adj Base Cost	= 107.43	Lot Value	+ 8,986					
Total Area	x 2,688	Indicated Value	= 170,152					
Adjusted Cost	= 288,772	Value Per SqFt	63.30					
Miscellaneous Improvements								
Code	Description	Sketch ID	Size	Year	Units	Unit Cost	Depr	Value
PRCH	SLAB PORCH - COVERED	57940	12x6		72	24.04		1,731
PRCH	SLAB PORCH - COVERED	57942	30x12		360	23.13		8,327
PATO	SLAB PORCH - OPEN	57943	21x9		189	10.08		1,905
GRDT	GARAGE - DETACHED	57944	28x24		672	22.22		14,932



Rogers
Assessment Property Record Card for Tax Year 2026

Data provided by LISA DELOZIER County Assessor

Date 04/17/2026
 Time 14:21:00
 Page 3

Sketch Image

660023547

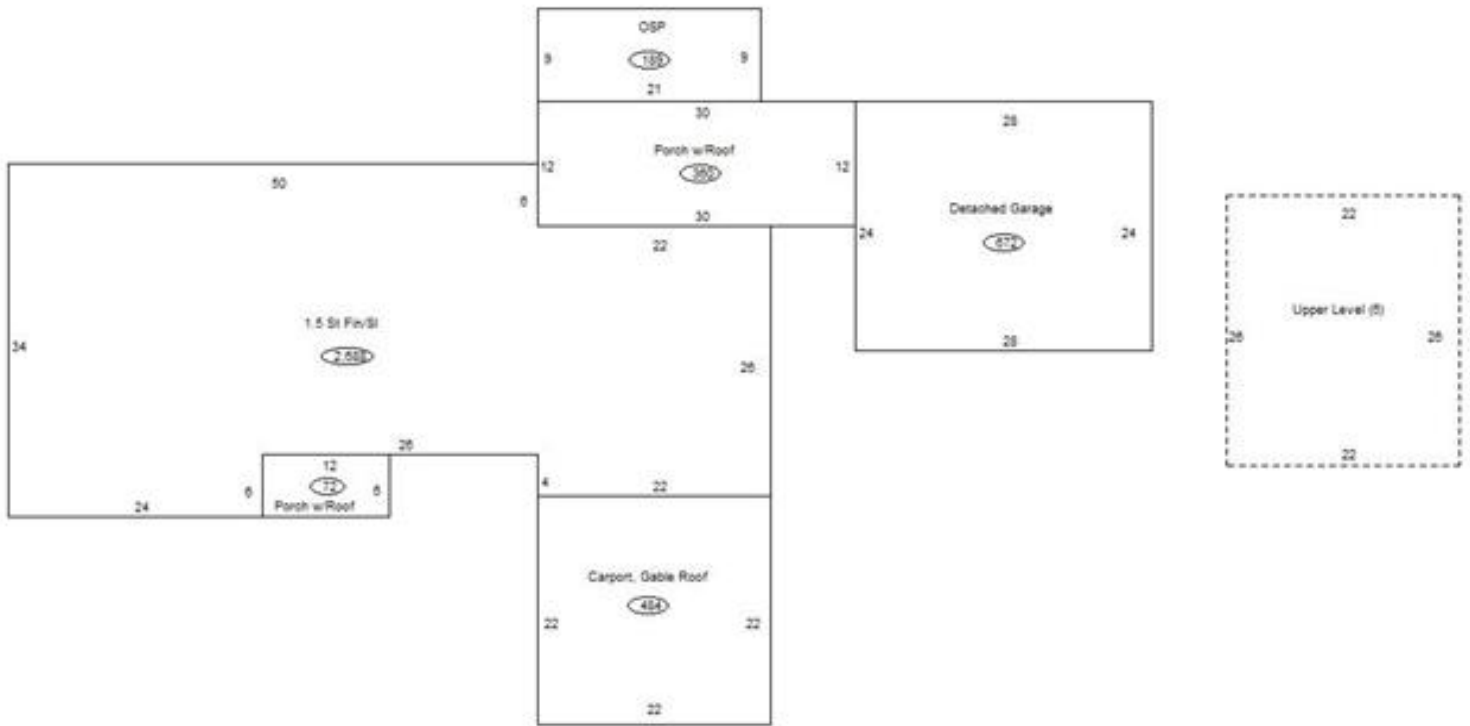

Sketch Vector Information

Sequence	Code	Type	Built Over	Scale	Section Label	Base Area	Multiplier	Total Area
1	M	PRCH		13	SLBC	72	1.000	72
2	G	3		13	Carport, Gable Roof	484	1.000	484
3	M	PRCH		13	SLBC	360	1.000	360
4	M	PATO		13	Open Slab	189	1.000	189
5	G	2		13	Detached Garage	672	1.000	672
6	R	5	Slab	13	1.5 St Fin/Sl	2,116	1.270	2,688
7	U	^UL		13	Upper Level (6)	572	1.000	572
Total Building Area						2,116		2,688



Rogers



Assessment Property Record Card for Tax Year 2026

Data provided by LISA DELOZIER County Assessor

Date 04/17/2026
Time 14:21:00
Page 4

660023547

Outbuildings/Site Improvements

Building Image	Code	Description	Dimensions	Floor	Roofing	Total Units
	DTGF	DETACHED GARAGE FAIR	0x0x0			504
	Qual 2	Cond 3	Year	Eff Age		
	Valuation Summary		Modifier Total	RCN	Depr (5% Phys/ % Func)	RCNLD
	Base Cost (16.00 x 504)	8,064		8,064	403	7,661
	SV	SWIM VINYL	0x0x0			1
	Qual 3	Cond 3	Year	Eff Age		
	Valuation Summary		Modifier Total	RCN	Depr (40% Phys/ % Func)	RCNLD
	Base Cost (25,000.00 x 1)	25,000		25,000	10,000	15,000