



Rogers

Assessment Property Record Card for Tax Year 2026

Data provided by LISA DELOZIER County Assessor

Date 04/17/2026
 Time 16:36:32
 Page 1

Assessment Data					Primary Image									
Account	660023646													
Parcel ID	19N17E-28-4-00000-000-0000													
Cadastral ID	28-19-17-01900													
Property Type	REAL - Real Property													
Property Class	RR	VI Area	3											
Tax Area	2 - INOLA RURAL													
Name ID	298504													
GETZFRIED, JEROD L &														
DANA R														
18455 E 640 RD														
INOLA OK 74036-0000														
Parcel Location														
Situs	18455 E 640 RD													
Subdivision														
Lot/Block	/	Parcel Size	11 - Acres											
Sec/Twn/Rng	28 / 19 / 17 / 4													
Neighborhood	1917 - UNPLATTED													
School District	S005 - INOLA SCHOOLS													
Legal Description Lat/Long: 36.09162244 -95.50210438														
Building Permits														
W2 W2 SW SE & E 33' W 363' SW SE														
<table border="1"> <thead> <tr> <th>Number</th> <th>Description</th> <th>Opened</th> <th>Closed</th> <th>Amount</th> </tr> </thead> <tbody> <tr> <td colspan="5" style="height: 100px;"> </td> </tr> </tbody> </table>					Number	Description	Opened	Closed	Amount					
Number	Description	Opened	Closed	Amount										
Exemptions														
Code	Type	Active	Maximum	Exemption	Sale History									
					Bk/Pg	Grantor	Date	Price	Code					
					1969/230	GETZFREID, GERALD L	07/25/2008	183,000	4					
Parcel Valuation														
Source	REAL	Fair Cash	Capped	Asmnt Level	Assessed	Levy Rate	80.060	Current Tax						
Remove Cap	0	Land Value	66,646	66,646	11%	7,331	Assessed	22,170	1,774.93					
Year Frozen	0	Improvements	260,025	134,899		14,839	Penalty	0						
Uncapped Value	0	Mobile Home	0	0		0	Exemption	0	0.00					
TIF Project ID	0	Total Value	326,671	201,545		22,170	Total Taxable	22,170	1,775.00					
Assessment History														
Tax Year	Statement Number	Billed Owner	Tax Area	Total Value	Exemptions	Taxable Value	Billed Tax							
2025	2025-660023646	GETZFRIED, JEROD L &	2	202,327	0	21,114	1,690.00							
2024	2024-660023646	GETZFRIED, JEROD L &	2	210,324	0	20,109	1,617.00							
2023	2023-660023646	GETZFRIED, JEROD L &	2	187,155	0	19,151	1,542.00							
2022	2022-660023646	GETZFRIED, JEROD L &	2	170,164	0	18,239	1,479.00							
2021	2021-660023646	GETZFRIED, JEROD L &	2	157,918	0	17,371	1,392.00							
2020	2020-660023646	GETZFRIED, JEROD L &	2	153,453	0	16,660	1,346.00							
2019	2019-660023646	GETZFRIED, JEROD L &	2	144,240	0	15,866	1,311.00							
2018	2018-660023646	GETZFRIED, JEROD L &	2	144,919	0	15,941	1,331.00							
2017	2017-660023646	GETZFRIED, JEROD L &	2	145,256	0	15,978	1,344.00							
2016	2016-660023646	GETZFRIED, JEROD L &	2	142,765	0	15,704	1,336.00							
2015	2015-660023646	GETZFRIED, JEROD L &	2	143,521	0	15,445	1,340.00							
2014	2014-660023646	GETZFRIED, JEROD L &	2	146,933	0	14,709	1,321.00							
2013	2013-660023646	GETZFRIED, JEROD L &	2	131,553	0	14,008	1,180.00							



Rogers

Assessment Property Record Card for Tax Year 2026

Data provided by LISA DELOZIER County Assessor

Date 04/17/2026
 Time 16:36:32
 Page 2

Lot Data	Square-Foot - NBHD 1917 #1	Primary Image
Lot Size Lot Count Units Buildable 11 Non-Ag Acres 10.5948 Topography Street Access Utilities Amenities LAND QUALITY FLOOD ZONE Method Square-Foot Base Lot Value 461,511.00 x .24 = 112,787 Factor Value Adjustments 0.5909 Lot Value 66,646		

Residential Data	
Type	1 Single Family Residence
Condition	3 - Average
Quality	2.5 - Fair
Architecture	TRAD TRADITIONAL
Style	100% One Story
Exterior Wall	50% Frame, Siding, Vinyl 50% Veneer, Stone
Base/Total Area	1,316 / 1,316
Style	100% One Story
HVAC	100% Warmed & Cooled Air
Roof Cover	4 Metal, Preformed
Area on Slab	0
Fixture/RghIn	10 /
Bed/F/H Bath	3 / 2.0 /
Basement Area	
Garage Type	648 Attached Garage - Finished 2 Stalls
Remodel	
Year/Eff Age	1964 / 47

GRM Approach
GRM Code Gross Rent 0.00 Indicated Value

Multiple Regression
MRA Code 1 Test Adusted R 0.8445 Indicated Value 319,960 243.13 Per SqFt

Direct Comparables
Selection Model 1 Res Adjustment Model A2 AO Test Comparables Indicated Value

Cost Approach				Manual : 01/2025			
Base Cost	101.08	Total Misc Impr	+ 8,266	Roofing Adj	+ 5.12	Garage Cost	+ 21,157
Subfloor Adj	+ 1.15	Total RCN	= 198,647	Heat/Cool Adj	+ 11.47	Depreciation (54%)	- 107,269
Plumbing Adj	+ 9.77	Lump Sums	+ 0	Basement Adj	+ 0.00	RCNLD	= 91,378
Adj Base Cost	= 128.59	Lot Value	+ 66,646	Total Area	x 1,316	Indicated Value	= 158,024
		Value Per SqFt	120.08	Adjusted Cost	= 169,224		

Value Reconciliation			
Selected Approach	Cost Approach		
Improvements	91,378		
Lot Value	66,646		
Indicated Value	158,024	120.08	Per SqFt
Agland Value			
Site Improvements	168,647		
Total Value	326,671	248.23	Total Value Per SqFt

Miscellaneous Improvements								
Code	Description	Sketch ID	Size	Year	Units	Unit Cost	Depr	Value
FPR1	FIREPLACE - RESIDENTIAL 1 STORY	0		1	1	5,095.98		5,096
EPSW	ENCLOSED PORCH - SOLID WALL	58079		50	50	63.39		3,170



Rogers
Assessment Property Record Card for Tax Year 2026

Data provided by LISA DELOZIER County Assessor

Date 04/17/2026
 Time 16:36:32
 Page 3

Sketch Image

660023646

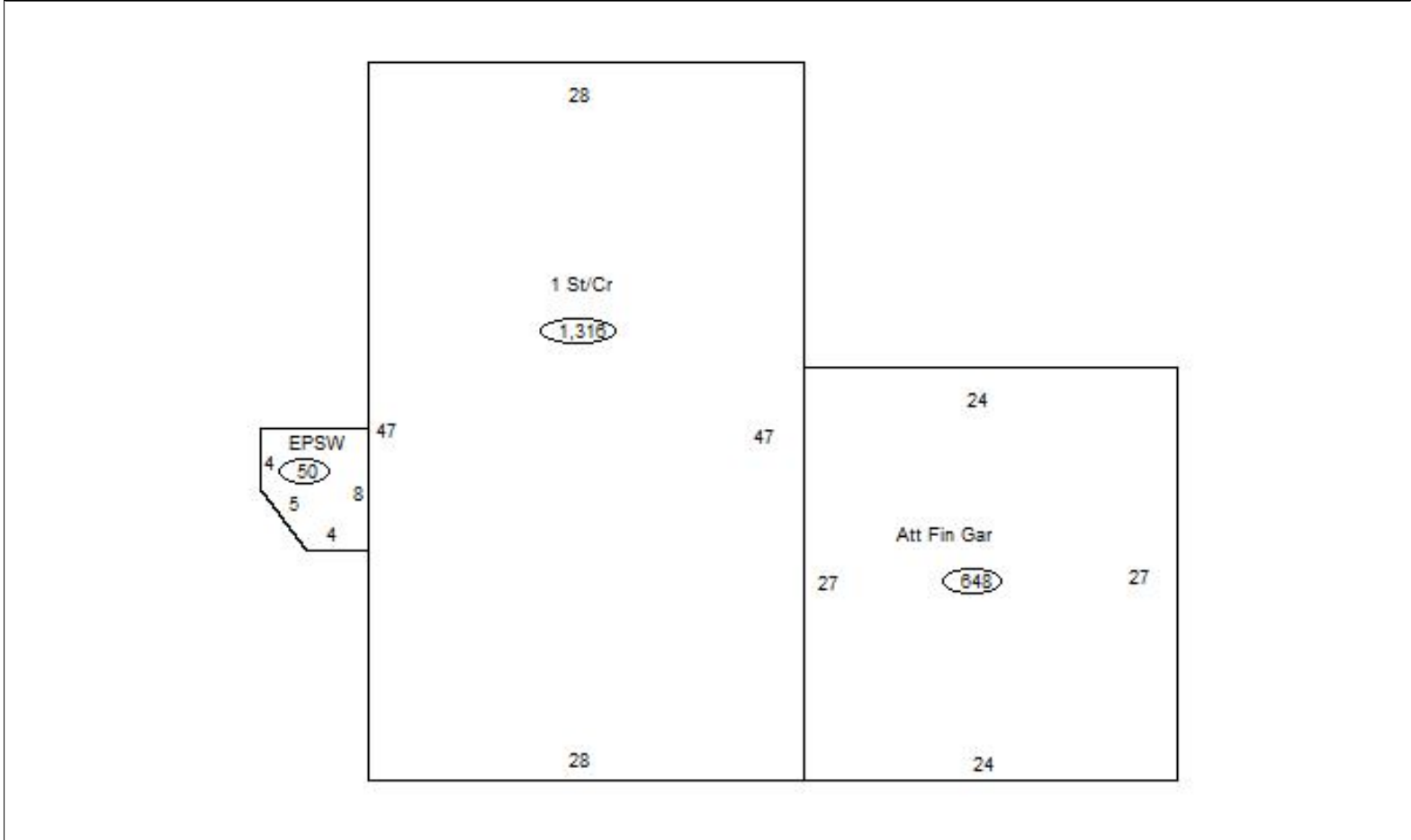

Sketch Vector Information

Sequence	Code	Type	Built Over	Scale	Section Label	Base Area	Multiplier	Total Area
1	R	1	Crawl	13	1 St/Cr	1,316	1.000	1,316
2	G	5		13	Att Fin Gar	648	1.000	648
3	M	EPSW		13	EPSW	50	1.000	50
Total Building Area						1,316		1,316



Rogers

Assessment Property Record Card for Tax Year 2026

Data provided by LISA DELOZIER County Assessor

Date 04/17/2026
Time 16:36:32
Page 4

Outbuildings/Site Improvements

660023646

Building Image	Code	Description	Dimensions	Floor	Roofing	Total Units
	SHDS	Shed - Small	8x4x6	Plank	Formed Metal	32
	Qual	2	Cond 3	Year 2020	Eff Age 5	
	Valuation Summary		Modifier Total	RCN	Depr (23% Phys/ % Func)	RCNLD
	Base Cost (32.38 x 32)		1,036		1,036	238
	UTIL	Utility Building	30x70x14	Concrete	Formed Metal	2,100
	Qual	2	Cond 3	Year 2015	Eff Age 8	
	Warm & Cooled Air		Total Area 2100			14,826
	Valuation Summary		Modifier Total	RCN	Depr (15% Phys/ % Func)	RCNLD
Base Cost (28.15 x 2,100)		59,115	14,826	73,941	11,091	62,850
	UTIL	Utility Building	20x30x10	Concrete	Formed Metal	600
	Qual	3	Cond 3	Year 2015	Eff Age 8	
	Warm & Cooled Air		Total Area 600			4,236
	Valuation Summary		Modifier Total	RCN	Depr (15% Phys/ % Func)	RCNLD
Base Cost (31.86 x 600)		19,116	4,236	23,352	3,503	19,849
	UTIL	Utility Building	25x30x14	Concrete	Formed Metal	750
	Qual	2	Cond 3	Year 2015	Eff Age 8	
	Warm & Cooled Air		Total Area 750			5,295
	Valuation Summary		Modifier Total	RCN	Depr (15% Phys/ % Func)	RCNLD
Base Cost (31.46 x 750)		23,595	5,295	28,890	4,334	24,556
	SHDS	Shed - Small	12x12x8	Plank	Formed Metal	144
	Qual	2	Cond 3	Year 2015	Eff Age 8	
	Valuation Summary		Modifier Total	RCN	Depr (37% Phys/ % Func)	RCNLD
	Base Cost (20.68 x 144)		2,978		2,978	1,102
	SHDS	Shed - Small	12x25x8	Plank	Formed Metal	300
	Qual	2	Cond 3	Year 2015	Eff Age 8	
	Valuation Summary		Modifier Total	RCN	Depr (37% Phys/ % Func)	RCNLD
	Base Cost (18.86 x 300)		5,658		5,658	2,093
	UTIL	Utility Building	46x36x16	Concrete	Formed Metal	1,656
	Qual	2	Cond 3	Year 2012	Eff Age 11	
	Warm & Cooled Air		Total Area 1656			11,691
	Valuation Summary		Modifier Total	RCN	Depr (22% Phys/ % Func)	RCNLD
Base Cost (30.75 x 1,656)		50,922	11,691	62,613	13,775	48,838



Rogers

Assessment Property Record Card for Tax Year 2026

Data provided by LISA DELOZIER County Assessor

Date 04/17/2026
Time 16:36:32
Page 5

660023646

Outbuildings/Site Improvements

Building Image	Code	Description	Dimensions	Floor	Roofing	Total Units
	EQSH	Equipment Shed	24x28x8	Dirt	Composition Shingle	672
	Qual 3	Cond 2.5	Year 1990	Eff Age 32		

Valuation Summary	Modifier Total	RCN	Depr (58% Phys/ % Func)	RCNLD
Base Cost (18.83 x 672) 12,654			12,654 7,339	5,315



SHIP	Shipping/Storage Container	8x20x8			160
Qual 3	Cond 3	Year 0	Eff Age 0		

Valuation Summary	Modifier Total	RCN	Depr (0% Phys/ 0% Func)	RCNLD
Base Cost (6.25 x 160) 1,000			1,000	1,000