



# Rogers

## Assessment Property Record Card for Tax Year 2026

Data provided by LISA DELOZIER County Assessor

Date 04/16/2026  
Time 22:44:22  
Page 1

Assessment Data					Primary Image																																																																																																																				
<b>Account</b> 660023681 <b>Parcel ID</b> 20N15E-28-1-00000-000-0000 <b>Cadastral ID</b> 28-20-15-02300 <b>Property Type</b> REAL - Real Property <b>Property Class</b> RR VI Area 3 <b>Tax Area</b> 20 - CATOOSA RURAL <b>Name ID</b> 259287 CHASE, SUE E &/OR  MARK T GRAVES JR - TRUSTEES 2523 N 232 E AVE CATOOSA OK 74015-0000  <b>Parcel Location</b> <b>Situs</b> 02523 232 E AVE <b>Subdivision</b> <b>Lot/Block</b> / <b>Parcel Size</b> 5 - Acres <b>Sec/Twn/Rng</b> 28 / 20 / 15 / 1 <b>Neighborhood</b> 2015 - UNPLATTED <b>School District</b> S002 - CATOOSA SCHOOLS					<p>660023681_001.JPG 10/7/2025</p>																																																																																																																				
<b>Legal Description</b> Lat/Long: 36.19104687 -95.71638713 N2 NW NW NE																																																																																																																									
<b>Exemptions</b> <table border="1"> <thead> <tr> <th>Code</th> <th>Type</th> <th>Active</th> <th>Maximum</th> <th>Exemption</th> </tr> </thead> <tbody> <tr> <td></td> <td></td> <td></td> <td></td> <td></td> </tr> </tbody> </table>					Code	Type	Active	Maximum	Exemption						<b>Building Permits</b> <table border="1"> <thead> <tr> <th>Number</th> <th>Description</th> <th>Opened</th> <th>Closed</th> <th>Amount</th> </tr> </thead> <tbody> <tr> <td></td> <td></td> <td></td> <td></td> <td></td> </tr> </tbody> </table>					Number	Description	Opened	Closed	Amount																																																																																																	
Code	Type	Active	Maximum	Exemption																																																																																																																					
Number	Description	Opened	Closed	Amount																																																																																																																					
<b>Parcel Valuation</b> <table border="1"> <thead> <tr> <th>Source</th> <th>REAL</th> <th>Fair Cash</th> <th>Capped</th> <th>Asmnt Level</th> <th>Assessed</th> <th>Levy Rate</th> <th>92.860</th> <th>Current Tax</th> </tr> </thead> <tbody> <tr> <td>Remove Cap</td> <td>0</td> <td>Land Value 78,183</td> <td>78,183</td> <td>11%</td> <td>8,600</td> <td>Assessed</td> <td>29,597</td> <td>2,748.38</td> </tr> <tr> <td>Year Frozen</td> <td>0</td> <td>Improvements 252,240</td> <td>190,881</td> <td></td> <td>20,997</td> <td>Penalty</td> <td>0</td> <td></td> </tr> <tr> <td>Uncapped Value</td> <td>0</td> <td>Mobile Home 0</td> <td>0</td> <td></td> <td>0</td> <td>Exemption</td> <td>0</td> <td>0.00</td> </tr> <tr> <td>TIF Project ID</td> <td>0</td> <td>Total Value 330,423</td> <td>269,064</td> <td></td> <td>29,597</td> <td>Total Taxable</td> <td>29,597</td> <td>2,748.00</td> </tr> </tbody> </table>					Source	REAL	Fair Cash	Capped	Asmnt Level	Assessed	Levy Rate	92.860	Current Tax	Remove Cap	0	Land Value 78,183	78,183	11%	8,600	Assessed	29,597	2,748.38	Year Frozen	0	Improvements 252,240	190,881		20,997	Penalty	0		Uncapped Value	0	Mobile Home 0	0		0	Exemption	0	0.00	TIF Project ID	0	Total Value 330,423	269,064		29,597	Total Taxable	29,597	2,748.00	<b>Sale History</b> <table border="1"> <thead> <tr> <th>Bk/Pg</th> <th>Grantor</th> <th>Date</th> <th>Price</th> <th>Code</th> </tr> </thead> <tbody> <tr> <td>965/831</td> <td>SLANKER, DANIEL R DDS</td> <td>08/17/1994</td> <td>168,000</td> <td>Yes</td> </tr> </tbody> </table>					Bk/Pg	Grantor	Date	Price	Code	965/831	SLANKER, DANIEL R DDS	08/17/1994	168,000	Yes																																																									
Source	REAL	Fair Cash	Capped	Asmnt Level	Assessed	Levy Rate	92.860	Current Tax																																																																																																																	
Remove Cap	0	Land Value 78,183	78,183	11%	8,600	Assessed	29,597	2,748.38																																																																																																																	
Year Frozen	0	Improvements 252,240	190,881		20,997	Penalty	0																																																																																																																		
Uncapped Value	0	Mobile Home 0	0		0	Exemption	0	0.00																																																																																																																	
TIF Project ID	0	Total Value 330,423	269,064		29,597	Total Taxable	29,597	2,748.00																																																																																																																	
Bk/Pg	Grantor	Date	Price	Code																																																																																																																					
965/831	SLANKER, DANIEL R DDS	08/17/1994	168,000	Yes																																																																																																																					
<b>Assessment History</b> <table border="1"> <thead> <tr> <th>Tax Year</th> <th>Statement Number</th> <th>Billed Owner</th> <th>Tax Area</th> <th>Total Value</th> <th>Exemptions</th> <th>Taxable Value</th> <th>Billed Tax</th> </tr> </thead> <tbody> <tr><td>2025</td><td>2025-660023681</td><td>CHASE, SUE E &amp;/OR</td><td>20</td><td>261,023</td><td>0</td><td>28,188</td><td>2,618.00</td></tr> <tr><td>2024</td><td>2024-660023681</td><td>CHASE, SUE E &amp;/OR</td><td>20</td><td>277,838</td><td>0</td><td>26,845</td><td>2,428.00</td></tr> <tr><td>2023</td><td>2023-660023681</td><td>CHASE, SUE E &amp;/OR</td><td>20</td><td>232,429</td><td>0</td><td>25,567</td><td>2,219.00</td></tr> <tr><td>2022</td><td>2022-660023681</td><td>CHASE, SUE E &amp;/OR</td><td>20</td><td>233,742</td><td>0</td><td>25,712</td><td>2,238.00</td></tr> <tr><td>2021</td><td>2021-660023681</td><td>CHASE, SUE E &amp;/OR</td><td>20</td><td>242,784</td><td>0</td><td>26,706</td><td>2,350.00</td></tr> <tr><td>2020</td><td>2020-660023681</td><td>CHASE, SUE E &amp;/OR</td><td>20</td><td>239,414</td><td>0</td><td>26,139</td><td>2,313.00</td></tr> <tr><td>2019</td><td>2019-660023681</td><td>CHASE, SUE E &amp;/OR</td><td>20</td><td>226,314</td><td>0</td><td>24,895</td><td>2,230.00</td></tr> <tr><td>2018</td><td>2018-660023681</td><td>CHASE, SUE E &amp;/OR</td><td>20</td><td>235,942</td><td>0</td><td>25,954</td><td>2,310.00</td></tr> <tr><td>2017</td><td>2017-660023681</td><td>CHASE, SUE E &amp;/OR</td><td>20</td><td>256,289</td><td>0</td><td>28,192</td><td>2,546.00</td></tr> <tr><td>2016</td><td>2016-660023681</td><td>CHASE, SUE E &amp;/OR</td><td>20</td><td>250,281</td><td>0</td><td>27,531</td><td>2,449.00</td></tr> <tr><td>2015</td><td>2015-660023681</td><td>CHASE, SUE E &amp;/OR</td><td>20</td><td>243,210</td><td>0</td><td>26,753</td><td>2,391.00</td></tr> <tr><td>2014</td><td>2014-660023681</td><td>CHASE, SUE E &amp;/OR</td><td>20</td><td>245,081</td><td>0</td><td>26,959</td><td>2,439.00</td></tr> <tr><td>2013</td><td>2013-660023681</td><td>CHASE, SUE E &amp;/OR</td><td>20</td><td>236,680</td><td>0</td><td>26,035</td><td>2,330.00</td></tr> </tbody> </table>										Tax Year	Statement Number	Billed Owner	Tax Area	Total Value	Exemptions	Taxable Value	Billed Tax	2025	2025-660023681	CHASE, SUE E &/OR	20	261,023	0	28,188	2,618.00	2024	2024-660023681	CHASE, SUE E &/OR	20	277,838	0	26,845	2,428.00	2023	2023-660023681	CHASE, SUE E &/OR	20	232,429	0	25,567	2,219.00	2022	2022-660023681	CHASE, SUE E &/OR	20	233,742	0	25,712	2,238.00	2021	2021-660023681	CHASE, SUE E &/OR	20	242,784	0	26,706	2,350.00	2020	2020-660023681	CHASE, SUE E &/OR	20	239,414	0	26,139	2,313.00	2019	2019-660023681	CHASE, SUE E &/OR	20	226,314	0	24,895	2,230.00	2018	2018-660023681	CHASE, SUE E &/OR	20	235,942	0	25,954	2,310.00	2017	2017-660023681	CHASE, SUE E &/OR	20	256,289	0	28,192	2,546.00	2016	2016-660023681	CHASE, SUE E &/OR	20	250,281	0	27,531	2,449.00	2015	2015-660023681	CHASE, SUE E &/OR	20	243,210	0	26,753	2,391.00	2014	2014-660023681	CHASE, SUE E &/OR	20	245,081	0	26,959	2,439.00	2013	2013-660023681	CHASE, SUE E &/OR	20	236,680	0	26,035	2,330.00
Tax Year	Statement Number	Billed Owner	Tax Area	Total Value	Exemptions	Taxable Value	Billed Tax																																																																																																																		
2025	2025-660023681	CHASE, SUE E &/OR	20	261,023	0	28,188	2,618.00																																																																																																																		
2024	2024-660023681	CHASE, SUE E &/OR	20	277,838	0	26,845	2,428.00																																																																																																																		
2023	2023-660023681	CHASE, SUE E &/OR	20	232,429	0	25,567	2,219.00																																																																																																																		
2022	2022-660023681	CHASE, SUE E &/OR	20	233,742	0	25,712	2,238.00																																																																																																																		
2021	2021-660023681	CHASE, SUE E &/OR	20	242,784	0	26,706	2,350.00																																																																																																																		
2020	2020-660023681	CHASE, SUE E &/OR	20	239,414	0	26,139	2,313.00																																																																																																																		
2019	2019-660023681	CHASE, SUE E &/OR	20	226,314	0	24,895	2,230.00																																																																																																																		
2018	2018-660023681	CHASE, SUE E &/OR	20	235,942	0	25,954	2,310.00																																																																																																																		
2017	2017-660023681	CHASE, SUE E &/OR	20	256,289	0	28,192	2,546.00																																																																																																																		
2016	2016-660023681	CHASE, SUE E &/OR	20	250,281	0	27,531	2,449.00																																																																																																																		
2015	2015-660023681	CHASE, SUE E &/OR	20	243,210	0	26,753	2,391.00																																																																																																																		
2014	2014-660023681	CHASE, SUE E &/OR	20	245,081	0	26,959	2,439.00																																																																																																																		
2013	2013-660023681	CHASE, SUE E &/OR	20	236,680	0	26,035	2,330.00																																																																																																																		



# Rogers

## Assessment Property Record Card for Tax Year 2026

Data provided by LISA DELOZIER County Assessor

Date 04/16/2026  
Time 22:44:23  
Page 2

Lot Data	Square-Foot - NBHD 2015 #1	Primary Image
<b>Lot Size</b> <b>Lot Count</b> <b>Units Buildable</b> 1 <b>Non-Ag Acres</b> 5.2793 <b>Topography</b> <b>Street Access</b> <b>Utilities</b> <b>Amenities</b> LAND QUALITY 0 FLOOD ZONE 0 <b>Method</b> Square-Foot <b>Base Lot Value</b> 229,966.00 x .34 = 78,183 <b>Factor Value</b> <b>Adjustments</b> 1.0000 <b>Lot Value</b> 78,183		<p>660023681 09/30/25</p> <p>660023681_001.JPG 10/7/2025</p>

Residential Data	
<b>Type</b>	1 Single Family Residence
<b>Condition</b>	3 - Average
<b>Quality</b>	3.5 - Average
<b>Architecture</b>	TRAD TRADITIONAL
<b>Style</b>	100% 1 1/2 Story Finished
<b>Exterior Wall</b>	100% Veneer, Masonry
<b>Base/Total Area</b>	2,119 / 3,244
<b>Style</b>	100% 1 1/2 Story Finished
<b>HVAC</b>	100% Warmed & Cooled Air
<b>Roof Cover</b>	1 Composition Shingle
<b>Area on Slab</b>	2,119
<b>Fixture/RghIn</b>	14 /
<b>Bed/F/H Bath</b>	4 / 3.0 /
<b>Basement Area</b>	
<b>Garage Type</b>	728 Attached Garage - Finished 2 Stalls
<b>Remodel</b>	
<b>Year/Eff Age</b>	1973 / 40

GRM Approach
<b>GRM Code</b> <b>Gross Rent</b> 0.00 <b>Indicated Value</b>

Multiple Regression
<b>MRA Code</b> 1 Test <b>Adusted R</b> 0.8445 <b>Indicated Value</b> 375,301 115.69 Per SqFt

Direct Comparables
<b>Selection Model</b> 1 Res <b>Adjustment Model</b> A2 AO Test <b>Comparables</b> <b>Indicated Value</b>

Cost Approach				Manual : 01/2025			
<b>Base Cost</b>	96.21	<b>Total Misc Impr</b>	+ 26,757	<b>Roofing Adj</b>	+ 3.47	<b>Garage Cost</b>	+ 33,954
<b>Subfloor Adj</b>	+ -2.22	<b>Total RCN</b>	= 446,163	<b>Heat/Cool Adj</b>	+ 14.47	<b>Depreciation ( 46%)</b>	- 205,235
<b>Plumbing Adj</b>	+ 6.89	<b>Lump Sums</b>	+ 0	<b>Basement Adj</b>	+ 0.00	<b>RCNLD</b>	= 240,928
<b>Adj Base Cost</b>	= 118.82	<b>Lot Value</b>	+ 78,183	<b>Total Area</b>	x 3,244	<b>Indicated Value</b>	= 319,111
		<b>Value Per SqFt</b>	98.37	<b>Adjusted Cost</b>	= 385,452		

Value Reconciliation
<b>Selected Approach</b> Cost Approach <b>Improvements</b> 240,928 <b>Lot Value</b> 78,183 <b>Indicated Value</b> 319,111 98.37 Per SqFt <b>Agland Value</b> <b>Site Improvements</b> 11,312 <b>Total Value</b> 330,423 101.86 Total Value Per SqFt

Miscellaneous Improvements								
Code	Description	Sketch ID	Size	Year	Units	Unit Cost	Depr	Value
FPR1	FIREPLACE - RESIDENTIAL 1 STORY	0		1	1	6,429.63		6,430
PRCH	SLAB PORCH - COVERED	58157		329	329	28.38		9,337
EPSW	ENCLOSED PORCH - SOLID WALL	58158		12x12	144	76.32		10,990



# Rogers

## Assessment Property Record Card for Tax Year 2026

Data provided by LISA DELOZIER County Assessor

Date 04/16/2026  
 Time 22:44:23  
 Page 3

### Sketch Image

660023681

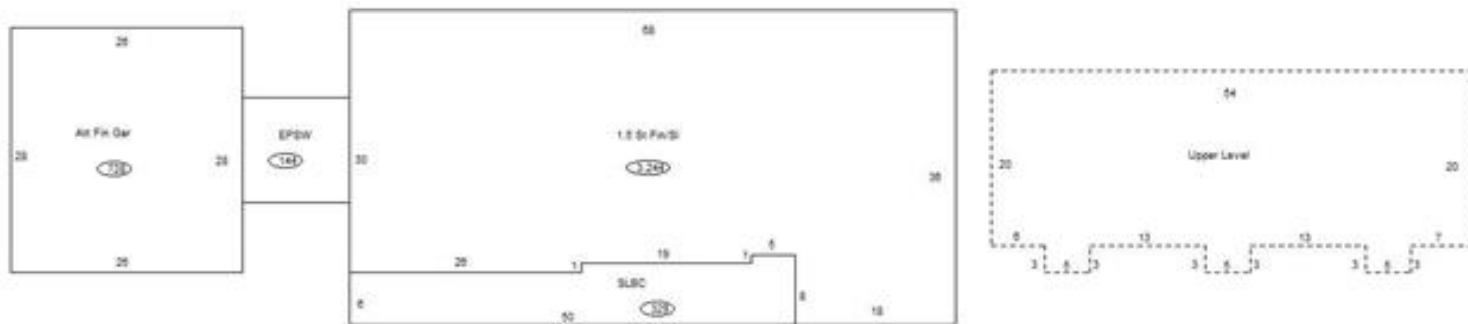

### Sketch Vector Information

Sequence	Code	Type	Built Over	Scale	Section Label	Base Area	Multiplier	Total Area
1	R	5	Slab	13	1.5 St Fin/Sl	2,119	1.531	3,244
2	G	5		13	Att Fin Gar	728	1.000	728
3	M	PRCH		13	SLBC	329	1.000	329
4	M	EPSW		13	EPSW	144	1.000	144
5	U	^UL	Overhang	13	Upper Level	1,125	1.000	1,125
<b>Total Building Area</b>						<b>2,119</b>		<b>3,244</b>



# Rogers



## Assessment Property Record Card for Tax Year 2026

Data provided by LISA DELOZIER County Assessor

Date 04/16/2026  
Time 22:44:23  
Page 4

660023681

### Outbuildings/Site Improvements

Building Image	Code	Description	Dimensions	Floor	Roofing	Total Units	
	SPLG	Swimming Pool - In Ground GUNITE	32x14x0	Concrete		448	
	Qual	3	Cond 3	Year 1995	Eff Age 23		
	<b>Valuation Summary</b>		<b>Modifier Total</b>	<b>RCN</b>	<b>Depr (68% Phys/ % Func)</b>		<b>RCNLD</b>
	Base Cost (52.61 x 448)		23,569		23,569	16,027	7,542
	BNGP	Barn - General Purpose	28x32x10	Dirt	Galvanized Metal	896	
	Qual	3	Cond 1	Year 1980	Eff Age 64		
	<b>Valuation Summary</b>		<b>Modifier Total</b>	<b>RCN</b>	<b>Depr (80% Phys/ % Func)</b>		<b>RCNLD</b>
	Base Cost (21.04 x 896)		18,852		18,852	15,082	3,770