



Rogers

Assessment Property Record Card for Tax Year 2026

Data provided by LISA DELOZIER County Assessor

Date 04/16/2026
Time 21:49:18
Page 1

Assessment Data					Primary Image																																																																																																																				
Account 660024025 Parcel ID 000000-00-0-40010-016-0005 Cadastral ID 28-23-15-04080 Property Type REAL - Real Property Property Class URP VI Area 2 Tax Area 31 - OOLOGAH OT/NW FIRE Name ID 320655 LEWIS, GEORGE PO BOX 153 COLLINSVILLE OK 74021-0000 Parcel Location Situs 00225 COOWEESCOOWEE AVE Subdivision OOLOGAH O T Lot/Block 0005 / 0016 Parcel Size 2.5 - Lots Sec/Twn/Rng 28 / 23 / 15 / 5 Neighborhood 1200 - R-V02-SE OOLOGAH School District S004 - OOLOGAH SCHOOLS					<p>\\tsclient\C\Users\CB\Pictures\2020-06-16\IMG_0081.JPG 6/16/2020</p>																																																																																																																				
Legal Description Lat/Long: 36.44674889 -95.70670540 W 50' OF LOT 3 & ALL OF LOTS 4 & 5 BLOCK 16 OOLOGAH O T																																																																																																																									
Exemptions <table border="1"> <thead> <tr> <th>Code</th> <th>Type</th> <th>Active</th> <th>Maximum</th> <th>Exemption</th> </tr> </thead> <tbody> <tr> <td>H</td> <td>Homestead</td> <td>No</td> <td>1,000</td> <td></td> </tr> </tbody> </table>					Code	Type	Active	Maximum	Exemption	H	Homestead	No	1,000		Building Permits <table border="1"> <thead> <tr> <th>Number</th> <th>Description</th> <th>Opened</th> <th>Closed</th> <th>Amount</th> </tr> </thead> <tbody> <tr> <td></td> <td></td> <td></td> <td></td> <td></td> </tr> </tbody> </table>					Number	Description	Opened	Closed	Amount																																																																																																	
Code	Type	Active	Maximum	Exemption																																																																																																																					
H	Homestead	No	1,000																																																																																																																						
Number	Description	Opened	Closed	Amount																																																																																																																					
Parcel Valuation <table border="1"> <thead> <tr> <th>Source</th> <th>REAL</th> <th>Fair Cash</th> <th>Capped</th> <th>Asmnt Level</th> <th>Assessed</th> <th>Levy Rate</th> <th>108.182</th> <th>Current Tax</th> </tr> </thead> <tbody> <tr> <td>Remove Cap</td> <td>2020</td> <td>Land Value 46,704</td> <td>21,129</td> <td>11%</td> <td>2,324</td> <td>Assessed</td> <td>10,329</td> <td>1,117.41</td> </tr> <tr> <td>Year Frozen</td> <td>0</td> <td>Improvements 73,649</td> <td>72,777</td> <td></td> <td>8,005</td> <td>Penalty</td> <td>0</td> <td></td> </tr> <tr> <td>Uncapped Value</td> <td>0</td> <td>Mobile Home 0</td> <td>0</td> <td></td> <td>0</td> <td>Exemption</td> <td>0</td> <td>0.00</td> </tr> <tr> <td>TIF Project ID</td> <td>0</td> <td>Total Value 120,353</td> <td>93,906</td> <td></td> <td>10,329</td> <td>Total Taxable</td> <td>10,329</td> <td>1,117.00</td> </tr> </tbody> </table>					Source	REAL	Fair Cash	Capped	Asmnt Level	Assessed	Levy Rate	108.182	Current Tax	Remove Cap	2020	Land Value 46,704	21,129	11%	2,324	Assessed	10,329	1,117.41	Year Frozen	0	Improvements 73,649	72,777		8,005	Penalty	0		Uncapped Value	0	Mobile Home 0	0		0	Exemption	0	0.00	TIF Project ID	0	Total Value 120,353	93,906		10,329	Total Taxable	10,329	1,117.00	Sale History <table border="1"> <thead> <tr> <th>Bk/Pg</th> <th>Grantor</th> <th>Date</th> <th>Price</th> <th>Code</th> </tr> </thead> <tbody> <tr> <td>/</td> <td>NORRIS, RICKEY J</td> <td>11/28/2018</td> <td>54,000</td> <td>10</td> </tr> <tr> <td>1175/31</td> <td>HFTA FIRST FINANCIAL CORP</td> <td>06/02/1999</td> <td>72,500</td> <td>Yes</td> </tr> <tr> <td>1137/413</td> <td>THOMASON, JACKIE D</td> <td>10/19/1998</td> <td>0</td> <td>No</td> </tr> </tbody> </table>					Bk/Pg	Grantor	Date	Price	Code	/	NORRIS, RICKEY J	11/28/2018	54,000	10	1175/31	HFTA FIRST FINANCIAL CORP	06/02/1999	72,500	Yes	1137/413	THOMASON, JACKIE D	10/19/1998	0	No																																															
Source	REAL	Fair Cash	Capped	Asmnt Level	Assessed	Levy Rate	108.182	Current Tax																																																																																																																	
Remove Cap	2020	Land Value 46,704	21,129	11%	2,324	Assessed	10,329	1,117.41																																																																																																																	
Year Frozen	0	Improvements 73,649	72,777		8,005	Penalty	0																																																																																																																		
Uncapped Value	0	Mobile Home 0	0		0	Exemption	0	0.00																																																																																																																	
TIF Project ID	0	Total Value 120,353	93,906		10,329	Total Taxable	10,329	1,117.00																																																																																																																	
Bk/Pg	Grantor	Date	Price	Code																																																																																																																					
/	NORRIS, RICKEY J	11/28/2018	54,000	10																																																																																																																					
1175/31	HFTA FIRST FINANCIAL CORP	06/02/1999	72,500	Yes																																																																																																																					
1137/413	THOMASON, JACKIE D	10/19/1998	0	No																																																																																																																					
Assessment History <table border="1"> <thead> <tr> <th>Tax Year</th> <th>Statement Number</th> <th>Billed Owner</th> <th>Tax Area</th> <th>Total Value</th> <th>Exemptions</th> <th>Taxable Value</th> <th>Billed Tax</th> </tr> </thead> <tbody> <tr><td>2025</td><td>2025-660024025</td><td>LEWIS, GEORGE</td><td>31</td><td>118,271</td><td>0</td><td>9,838</td><td>1,064.00</td></tr> <tr><td>2024</td><td>2024-660024025</td><td>LEWIS, GEORGE</td><td>31</td><td>99,664</td><td>0</td><td>9,369</td><td>981.00</td></tr> <tr><td>2023</td><td>2023-660024025</td><td>LEWIS, GEORGE</td><td>31</td><td>81,121</td><td>0</td><td>8,923</td><td>928.00</td></tr> <tr><td>2022</td><td>2022-660024025</td><td>LEWIS, GEORGE</td><td>31</td><td>82,815</td><td>0</td><td>9,109</td><td>943.00</td></tr> <tr><td>2021</td><td>2021-660024025</td><td>LEWIS, GEORGE</td><td>31</td><td>84,299</td><td>0</td><td>9,273</td><td>967.00</td></tr> <tr><td>2020</td><td>2020-660024025</td><td>LEWIS, GEORGE</td><td>31</td><td>83,055</td><td>0</td><td>9,136</td><td>966.00</td></tr> <tr><td>2019</td><td>2019-660024025</td><td>LEWIS, GEORGE</td><td>31</td><td>82,287</td><td>0</td><td>9,051</td><td>940.00</td></tr> <tr><td>2018</td><td>2018-660024025</td><td>NORRIS, RICKEY J</td><td>31</td><td>86,793</td><td>1000</td><td>8,547</td><td>932.00</td></tr> <tr><td>2017</td><td>2017-660024025</td><td>NORRIS, RICKEY J</td><td>31</td><td>86,138</td><td>1000</td><td>8,475</td><td>977.00</td></tr> <tr><td>2016</td><td>2016-660024025</td><td>NORRIS, RICKEY J</td><td>31</td><td>84,038</td><td>1000</td><td>8,244</td><td>868.00</td></tr> <tr><td>2015</td><td>2015-660024025</td><td>NORRIS, RICKEY J</td><td>31</td><td>82,298</td><td>1000</td><td>8,052</td><td>802.00</td></tr> <tr><td>2014</td><td>2014-660024025</td><td>NORRIS, RICKEY J</td><td>31</td><td>82,895</td><td>1000</td><td>7,807</td><td>776.00</td></tr> <tr><td>2013</td><td>2013-660024025</td><td>NORRIS, RICKEY J</td><td>31</td><td>83,556</td><td>1000</td><td>7,551</td><td>726.00</td></tr> </tbody> </table>										Tax Year	Statement Number	Billed Owner	Tax Area	Total Value	Exemptions	Taxable Value	Billed Tax	2025	2025-660024025	LEWIS, GEORGE	31	118,271	0	9,838	1,064.00	2024	2024-660024025	LEWIS, GEORGE	31	99,664	0	9,369	981.00	2023	2023-660024025	LEWIS, GEORGE	31	81,121	0	8,923	928.00	2022	2022-660024025	LEWIS, GEORGE	31	82,815	0	9,109	943.00	2021	2021-660024025	LEWIS, GEORGE	31	84,299	0	9,273	967.00	2020	2020-660024025	LEWIS, GEORGE	31	83,055	0	9,136	966.00	2019	2019-660024025	LEWIS, GEORGE	31	82,287	0	9,051	940.00	2018	2018-660024025	NORRIS, RICKEY J	31	86,793	1000	8,547	932.00	2017	2017-660024025	NORRIS, RICKEY J	31	86,138	1000	8,475	977.00	2016	2016-660024025	NORRIS, RICKEY J	31	84,038	1000	8,244	868.00	2015	2015-660024025	NORRIS, RICKEY J	31	82,298	1000	8,052	802.00	2014	2014-660024025	NORRIS, RICKEY J	31	82,895	1000	7,807	776.00	2013	2013-660024025	NORRIS, RICKEY J	31	83,556	1000	7,551	726.00
Tax Year	Statement Number	Billed Owner	Tax Area	Total Value	Exemptions	Taxable Value	Billed Tax																																																																																																																		
2025	2025-660024025	LEWIS, GEORGE	31	118,271	0	9,838	1,064.00																																																																																																																		
2024	2024-660024025	LEWIS, GEORGE	31	99,664	0	9,369	981.00																																																																																																																		
2023	2023-660024025	LEWIS, GEORGE	31	81,121	0	8,923	928.00																																																																																																																		
2022	2022-660024025	LEWIS, GEORGE	31	82,815	0	9,109	943.00																																																																																																																		
2021	2021-660024025	LEWIS, GEORGE	31	84,299	0	9,273	967.00																																																																																																																		
2020	2020-660024025	LEWIS, GEORGE	31	83,055	0	9,136	966.00																																																																																																																		
2019	2019-660024025	LEWIS, GEORGE	31	82,287	0	9,051	940.00																																																																																																																		
2018	2018-660024025	NORRIS, RICKEY J	31	86,793	1000	8,547	932.00																																																																																																																		
2017	2017-660024025	NORRIS, RICKEY J	31	86,138	1000	8,475	977.00																																																																																																																		
2016	2016-660024025	NORRIS, RICKEY J	31	84,038	1000	8,244	868.00																																																																																																																		
2015	2015-660024025	NORRIS, RICKEY J	31	82,298	1000	8,052	802.00																																																																																																																		
2014	2014-660024025	NORRIS, RICKEY J	31	82,895	1000	7,807	776.00																																																																																																																		
2013	2013-660024025	NORRIS, RICKEY J	31	83,556	1000	7,551	726.00																																																																																																																		



Rogers

Assessment Property Record Card for Tax Year 2026

Data provided by LISA DELOZIER County Assessor

Date 04/16/2026
Time 21:49:19
Page 2

Lot Data	Square-Foot - NBHD 1200 #1	Primary Image
Lot Size		
Lot Count		
Units Buildable	1	
Non-Ag Acres	0.5008	
Topography		
Street Access		
Utilities		
Amenities	LAND QUAL.	
	0	
	0	
Method	Square-Foot	
Base Lot Value	21,817.00 x 2.14 = 46,704	
Factor Value		
Adjustments	1.0000	
Lot Value	46,704	

Residential Data	
Type	1 Single Family Residence
Condition	3 - Average
Quality	2 - Fair
Architecture	TRAD TRADITIONAL
Style	100% One Story
Exterior Wall	100% Frame, Siding, Vinyl
Base/Total Area	1,698 / 1,698
Style	100% One Story
HVAC	100% Warmed & Cooled Air
Roof Cover	1 Composition Shingle
Area on Slab	0
Fixture/RghIn	7 /
Bed/F/H Bath	3 / 1.0 / 1.0
Basement Area	
Garage Type	
Remodel	
Year/Eff Age	1955 / 53

Cost Approach		Manual : 01/2025	
Base Cost	82.56	Total Misc Impr	+ 12,558
Roofing Adj	+ 3.78	Garage Cost	+ 0
Subfloor Adj	+ 2.31	Total RCN	= 188,844
Heat/Cool Adj	+ 10.30	Depreciation (61%)	- 115,195
Plumbing Adj	+ 4.87	Lump Sums	+ 0
Basement Adj	+ 0.00	RCNLD	= 73,649
Adj Base Cost	= 103.82	Lot Value	+ 46,704
Total Area	x 1,698	Indicated Value	= 120,353
Adjusted Cost	= 176,286	Value Per SqFt	70.88



\\tsclient\C\Users\CB\Pictures\2020-06-16\IMG_0081.JPG 6/16/2020

GRM Approach	
GRM Code	
Gross Rent	0.00
Indicated Value	

Multiple Regression			
MRA Code	1	Test	
Adusted R	0.8445		
Indicated Value	88,892	52.35	Per SqFt

Direct Comparables			
Selection Model	A	Adam Test	
Adjustment Model	1	2022 Residential	
Comparables	2		
Indicated Value	68,170		Per SqFt

Value Reconciliation			
Selected Approach	Cost Approach		
Improvements	73,649		
Lot Value	46,704		
Indicated Value	120,353	70.88	Per SqFt
Agland Value			
Site Improvements			
Total Value	120,353	70.88	Total Value Per SqFt

Miscellaneous Improvements								
Code	Description	Sketch ID	Size	Year	Units	Unit Cost	Depr	Value
PRCH	SLAB PORCH - COVERED	59031	10x4		40	21.17		847
PATO	SLAB PORCH - OPEN	59032	6x4		24	10.24		246
PATO	SLAB PORCH - OPEN	59033	34x6		204	9.35		1,907
PRCH	SLAB PORCH - COVERED	59034	34x14		476	20.08		9,558



Rogers

Assessment Property Record Card for Tax Year 2026

Data provided by LISA DELOZIER County Assessor

Date 04/16/2026
 Time 21:49:19
 Page 3

Sketch Image

660024025

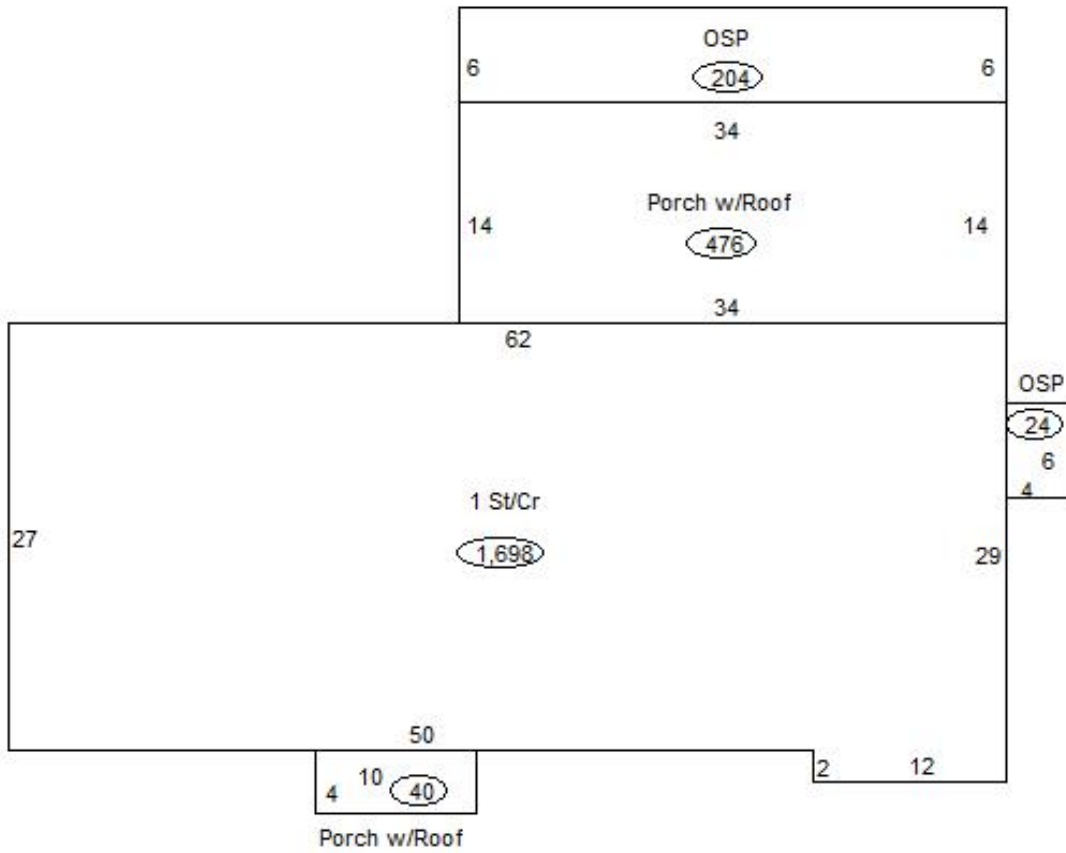

Sketch Vector Information

Sequence	Code	Type	Built Over	Scale	Section Label	Base Area	Multiplier	Total Area
1	R	1	Crawl	13	1 St/Cr	1,698	1.000	1,698
2	M	PRCH		13	SLBC	40	1.000	40
3	M	PATO		13	Open Slab	24	1.000	24
4	M	PATO		13	Open Slab	204	1.000	204
5	M	PRCH		13	SLBC	476	1.000	476
Total Building Area						1,698		1,698



Rogers



Assessment Property Record Card for Tax Year 2026

Data provided by LISA DELOZIER County Assessor

Date 04/16/2026
 Time 21:49:19
 Page 4

660024025

Outbuildings/Site Improvements

Building Image	Code	Description	Dimensions	Floor	Roofing	Total Units
	SHDS	Shed - Small	14x8x8	Plank	Formed Metal	112
	Qual	3	Cond 3	Year 2015	Eff Age 8	
	Valuation Summary		Modifier Total	RCN	Depr (100% Phys/ % Func)	RCNLD
	Base Cost (26.51 x 112)		2,969		2,969	2,969
	SHDS	Shed - Small	10x14x8	Plank	Formed Metal	140
	Qual	3	Cond 3	Year 2010	Eff Age 12	
	Valuation Summary		Modifier Total	RCN	Depr (100% Phys/ % Func)	RCNLD
	Base Cost (25.15 x 140)		3,521		3,521	3,521