



Rogers

Assessment Property Record Card for Tax Year 2026

Data provided by LISA DELOZIER County Assessor

Date 04/16/2026
Time 22:25:52
Page 1

Assessment Data					Primary Image																																																																																																																				
Account 660024598 Parcel ID 000000-00-0-20130-002-0013 Cadastral ID 29-20-15-01780 Property Type REAL - Real Property Property Class URP VI Area 3 Tax Area 1 - CATOOSA OT Name ID 326260 TAYLOR, HENRY LLOYD & LORRAINE NEAL JACKSON 620 FORT SPUNKY RD CATOOSA OK 74015-0000 Parcel Location Situs 00620 FORT SPUNKY RD Subdivision SPUNKY CREEK I Lot/Block 0013 / 0002 Parcel Size 1 - Lots Sec/Twn/Rng 29 / 20 / 15 / 5 Neighborhood 1190 - R-V03-SW CATOOSA School District S002 - CATOOSA SCHOOLS					 <p>\\tsclient\C\Users\Randy Necessary\Pictures\101_0119\IMG_0037. 1/20/2022</p>																																																																																																																				
Legal Description Lot/Long: 36.18799234 -95.73789968 LOT 13 BLOCK 2 SPUNKY CREEK I																																																																																																																									
Exemptions <table border="1"> <thead> <tr> <th>Code</th> <th>Type</th> <th>Active</th> <th>Maximum</th> <th>Exemption</th> </tr> </thead> <tbody> <tr> <td>HV</td> <td>Veteran</td> <td>Yes</td> <td>999,999</td> <td>28,444</td> </tr> </tbody> </table>					Code	Type	Active	Maximum	Exemption	HV	Veteran	Yes	999,999	28,444	Building Permits <table border="1"> <thead> <tr> <th>Number</th> <th>Description</th> <th>Opened</th> <th>Closed</th> <th>Amount</th> </tr> </thead> <tbody> <tr> <td></td> <td></td> <td></td> <td></td> <td></td> </tr> </tbody> </table>					Number	Description	Opened	Closed	Amount																																																																																																	
Code	Type	Active	Maximum	Exemption																																																																																																																					
HV	Veteran	Yes	999,999	28,444																																																																																																																					
Number	Description	Opened	Closed	Amount																																																																																																																					
Parcel Valuation <table border="1"> <thead> <tr> <th>Source</th> <th>REAL</th> <th>Fair Cash</th> <th>Capped</th> <th>Asmnt Level</th> <th>Assessed</th> <th>Levy Rate</th> <th>106.660</th> <th>Current Tax</th> </tr> </thead> <tbody> <tr> <td>Remove Cap</td> <td>2019</td> <td>Land Value</td> <td>83,387</td> <td>83,387</td> <td>11%</td> <td>9,173</td> <td>Assessed</td> <td>28,444 3,033.84</td> </tr> <tr> <td>Year Frozen</td> <td>0</td> <td>Improvements</td> <td>186,470</td> <td>175,198</td> <td></td> <td>19,271</td> <td>Penalty</td> <td>0</td> </tr> <tr> <td>Uncapped Value</td> <td>0</td> <td>Mobile Home</td> <td>0</td> <td>0</td> <td></td> <td>0</td> <td>Exemption</td> <td>28,444 -3,034.00</td> </tr> <tr> <td>TIF Project ID</td> <td>0</td> <td>Total Value</td> <td>269,857</td> <td>258,585</td> <td></td> <td>28,444</td> <td>Total Taxable</td> <td>0 0.00</td> </tr> </tbody> </table>					Source	REAL	Fair Cash	Capped	Asmnt Level	Assessed	Levy Rate	106.660	Current Tax	Remove Cap	2019	Land Value	83,387	83,387	11%	9,173	Assessed	28,444 3,033.84	Year Frozen	0	Improvements	186,470	175,198		19,271	Penalty	0	Uncapped Value	0	Mobile Home	0	0		0	Exemption	28,444 -3,034.00	TIF Project ID	0	Total Value	269,857	258,585		28,444	Total Taxable	0 0.00	Sale History <table border="1"> <thead> <tr> <th>Bk/Pg</th> <th>Grantor</th> <th>Date</th> <th>Price</th> <th>Code</th> </tr> </thead> <tbody> <tr> <td>/</td> <td>CHALLACOMB, DAVID G &</td> <td>10/27/2018</td> <td>225,000</td> <td>YES</td> </tr> <tr> <td>2368/203</td> <td>WEILACHER, DAN R</td> <td>10/24/2013</td> <td>200,000</td> <td>YES</td> </tr> <tr> <td>930/569</td> <td>FEGALY, RONALD J</td> <td>09/24/1993</td> <td>109,500</td> <td>Yes</td> </tr> </tbody> </table>					Bk/Pg	Grantor	Date	Price	Code	/	CHALLACOMB, DAVID G &	10/27/2018	225,000	YES	2368/203	WEILACHER, DAN R	10/24/2013	200,000	YES	930/569	FEGALY, RONALD J	09/24/1993	109,500	Yes																																															
Source	REAL	Fair Cash	Capped	Asmnt Level	Assessed	Levy Rate	106.660	Current Tax																																																																																																																	
Remove Cap	2019	Land Value	83,387	83,387	11%	9,173	Assessed	28,444 3,033.84																																																																																																																	
Year Frozen	0	Improvements	186,470	175,198		19,271	Penalty	0																																																																																																																	
Uncapped Value	0	Mobile Home	0	0		0	Exemption	28,444 -3,034.00																																																																																																																	
TIF Project ID	0	Total Value	269,857	258,585		28,444	Total Taxable	0 0.00																																																																																																																	
Bk/Pg	Grantor	Date	Price	Code																																																																																																																					
/	CHALLACOMB, DAVID G &	10/27/2018	225,000	YES																																																																																																																					
2368/203	WEILACHER, DAN R	10/24/2013	200,000	YES																																																																																																																					
930/569	FEGALY, RONALD J	09/24/1993	109,500	Yes																																																																																																																					
Assessment History <table border="1"> <thead> <tr> <th>Tax Year</th> <th>Statement Number</th> <th>Billed Owner</th> <th>Tax Area</th> <th>Total Value</th> <th>Exemptions</th> <th>Taxable Value</th> <th>Billed Tax</th> </tr> </thead> <tbody> <tr><td>2025</td><td>2025-660024598</td><td>TAYLOR, HENRY LLOYD &</td><td>1</td><td>252,499</td><td>27616</td><td></td><td>.00</td></tr> <tr><td>2024</td><td>2024-660024598</td><td>TAYLOR, HENRY LLOYD &</td><td>1</td><td>245,693</td><td>26812</td><td></td><td>.00</td></tr> <tr><td>2023</td><td>2023-660024598</td><td>TAYLOR, HENRY LLOYD &</td><td>1</td><td>239,351</td><td>26031</td><td></td><td>.00</td></tr> <tr><td>2022</td><td>2022-660024598</td><td>TAYLOR, HENRY LLOYD &</td><td>1</td><td>229,751</td><td>25273</td><td></td><td>.00</td></tr> <tr><td>2021</td><td>2021-660024598</td><td>TAYLOR, HENRY LLOYD</td><td>1</td><td>242,271</td><td>26650</td><td></td><td>.00</td></tr> <tr><td>2020</td><td>2020-660024598</td><td>TAYLOR, HENRY LLOYD</td><td>1</td><td>240,560</td><td>25928</td><td></td><td>.00</td></tr> <tr><td>2019</td><td>2019-660024598</td><td>TAYLOR, HENRY LLOYD</td><td>1</td><td>228,844</td><td>25173</td><td></td><td>.00</td></tr> <tr><td>2018</td><td>2018-660024598</td><td>CHALLACOMB, DAVID G &</td><td>1</td><td>213,304</td><td>0</td><td>23,463</td><td>2,094.00</td></tr> <tr><td>2017</td><td>2017-660024598</td><td>CHALLACOMB, DAVID G &</td><td>1</td><td>210,973</td><td>0</td><td>23,207</td><td>2,096.00</td></tr> <tr><td>2016</td><td>2016-660024598</td><td>CHALLACOMB, DAVID G &</td><td>1</td><td>206,340</td><td>0</td><td>22,697</td><td>2,019.00</td></tr> <tr><td>2015</td><td>2015-660024598</td><td>CHALLACOMB, DAVID G &</td><td>1</td><td>201,613</td><td>0</td><td>22,177</td><td>1,982.00</td></tr> <tr><td>2014</td><td>2014-660024598</td><td>CHALLACOMB, DAVID G &</td><td>1</td><td>203,385</td><td>0</td><td>22,372</td><td>2,024.00</td></tr> <tr><td>2013</td><td>2013-660024598</td><td>WEILACHER, DAN R</td><td>1</td><td>174,929</td><td>1000</td><td>14,854</td><td>1,330.00</td></tr> </tbody> </table>										Tax Year	Statement Number	Billed Owner	Tax Area	Total Value	Exemptions	Taxable Value	Billed Tax	2025	2025-660024598	TAYLOR, HENRY LLOYD &	1	252,499	27616		.00	2024	2024-660024598	TAYLOR, HENRY LLOYD &	1	245,693	26812		.00	2023	2023-660024598	TAYLOR, HENRY LLOYD &	1	239,351	26031		.00	2022	2022-660024598	TAYLOR, HENRY LLOYD &	1	229,751	25273		.00	2021	2021-660024598	TAYLOR, HENRY LLOYD	1	242,271	26650		.00	2020	2020-660024598	TAYLOR, HENRY LLOYD	1	240,560	25928		.00	2019	2019-660024598	TAYLOR, HENRY LLOYD	1	228,844	25173		.00	2018	2018-660024598	CHALLACOMB, DAVID G &	1	213,304	0	23,463	2,094.00	2017	2017-660024598	CHALLACOMB, DAVID G &	1	210,973	0	23,207	2,096.00	2016	2016-660024598	CHALLACOMB, DAVID G &	1	206,340	0	22,697	2,019.00	2015	2015-660024598	CHALLACOMB, DAVID G &	1	201,613	0	22,177	1,982.00	2014	2014-660024598	CHALLACOMB, DAVID G &	1	203,385	0	22,372	2,024.00	2013	2013-660024598	WEILACHER, DAN R	1	174,929	1000	14,854	1,330.00
Tax Year	Statement Number	Billed Owner	Tax Area	Total Value	Exemptions	Taxable Value	Billed Tax																																																																																																																		
2025	2025-660024598	TAYLOR, HENRY LLOYD &	1	252,499	27616		.00																																																																																																																		
2024	2024-660024598	TAYLOR, HENRY LLOYD &	1	245,693	26812		.00																																																																																																																		
2023	2023-660024598	TAYLOR, HENRY LLOYD &	1	239,351	26031		.00																																																																																																																		
2022	2022-660024598	TAYLOR, HENRY LLOYD &	1	229,751	25273		.00																																																																																																																		
2021	2021-660024598	TAYLOR, HENRY LLOYD	1	242,271	26650		.00																																																																																																																		
2020	2020-660024598	TAYLOR, HENRY LLOYD	1	240,560	25928		.00																																																																																																																		
2019	2019-660024598	TAYLOR, HENRY LLOYD	1	228,844	25173		.00																																																																																																																		
2018	2018-660024598	CHALLACOMB, DAVID G &	1	213,304	0	23,463	2,094.00																																																																																																																		
2017	2017-660024598	CHALLACOMB, DAVID G &	1	210,973	0	23,207	2,096.00																																																																																																																		
2016	2016-660024598	CHALLACOMB, DAVID G &	1	206,340	0	22,697	2,019.00																																																																																																																		
2015	2015-660024598	CHALLACOMB, DAVID G &	1	201,613	0	22,177	1,982.00																																																																																																																		
2014	2014-660024598	CHALLACOMB, DAVID G &	1	203,385	0	22,372	2,024.00																																																																																																																		
2013	2013-660024598	WEILACHER, DAN R	1	174,929	1000	14,854	1,330.00																																																																																																																		



Rogers

Assessment Property Record Card for Tax Year 2026

Data provided by LISA DELOZIER County Assessor

Date 04/16/2026

Time 22:25:53

Page 3

Sketch Image

660024598

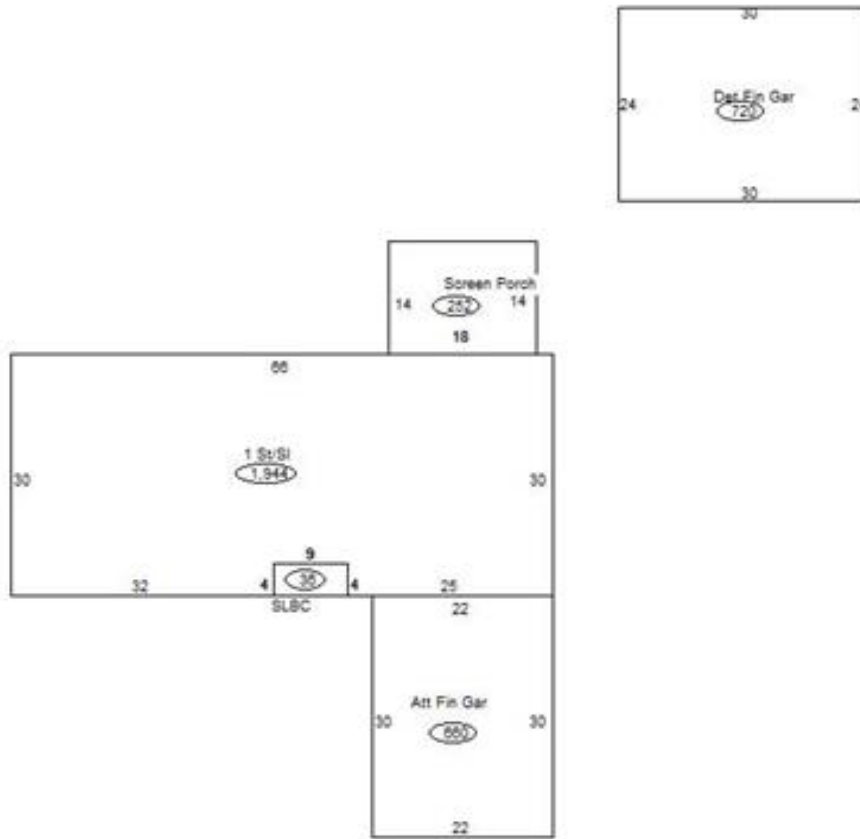

Sketch Vector Information

Sequence	Code	Type	Built Over	Scale	Section Label	Base Area	Multiplier	Total Area
1	R	1	Slab	20	1 St/SI	1,944	1.000	1,944
2	G	5		20	Att Fin Gar	660	1.000	660
3	M	PRCH		20	SLBC	36	1.000	36
4	M	EPKS		20	Screen Porch	252	1.000	252
5	G	6		20	Det Fin Gar	720	1.000	720
Total Building Area						1,944		1,944



Rogers

Assessment Property Record Card for Tax Year 2026

Data provided by LISA DELOZIER County Assessor

Date 04/16/2026
Time 22:25:53
Page 4

660024598

Outbuildings/Site Improvements

Building Image	Code	Description	Dimensions	Floor	Roofing	Total Units
	SPLG	Swimming Pool - In Ground	0x0x0	Concrete		327
	Qual 3	Cond 3	Year 2000	Eff Age 20		
Valuation Summary		Modifier Total	RCN	Depr (65% Phys/ % Func)	RCNLD	
Base Cost (54.44 x 327)		17,802	17,802	11,571	6,231	