



# Rogers

## Assessment Property Record Card for Tax Year 2026

Data provided by LISA DELOZIER County Assessor

Date 04/16/2026  
Time 22:12:18  
Page 1

Assessment Data					Primary Image																																																																																																																				
<b>Account</b> 660024752 <b>Parcel ID</b> 21N15E-29-1-00000-000-0000 <b>Cadastral ID</b> 29-21-15-01500 <b>Property Type</b> REAL - Real Property <b>Property Class</b> RR VI Area 4 <b>Tax Area</b> 23 - CATOOSA RURAL/LIME FIRE <b>Name ID</b> 119184 OLMSTEAD, MARK A &  RHONDA C 23277 SO A KEETONVILLE RD CLAREMORE OK 74019-0000  <b>Parcel Location</b> <b>Situs</b> 23277 S KEETONVILLE RD <b>Subdivision</b> <b>Lot/Block</b> / <b>Parcel Size</b> 6.07 - Acres <b>Sec/Twn/Rng</b> 29 / 21 / 15 / 1 <b>Neighborhood</b> 6070 - UNPLATTED <b>School District</b> S002 - CATOOSA SCHOOLS																																																																																																																									
<b>Legal Description</b> Lat/Long: 36.27292057 -95.72357972																																																																																																																									
<b>Legal Description</b> TR IN SE NE BEG 204.60' W SE/C N 1261.67' TO C/L RD, S 81-41- 04 W 179.82', W ALG C/L RD 32. 06', S 1235.61', E 210' TO POB					<b>Building Permits</b> <table border="1"> <thead> <tr> <th>Number</th> <th>Description</th> <th>Opened</th> <th>Closed</th> <th>Amount</th> </tr> </thead> <tbody> <tr> <td> </td> <td> </td> <td> </td> <td> </td> <td> </td> </tr> </tbody> </table>					Number	Description	Opened	Closed	Amount																																																																																																											
Number	Description	Opened	Closed	Amount																																																																																																																					
<b>Exemptions</b> <table border="1"> <thead> <tr> <th>Code</th> <th>Type</th> <th>Active</th> <th>Maximum</th> <th>Exemption</th> </tr> </thead> <tbody> <tr> <td>H</td> <td>Homestead</td> <td>Yes</td> <td>1,000</td> <td>1,000</td> </tr> </tbody> </table>					Code	Type	Active	Maximum	Exemption	H	Homestead	Yes	1,000	1,000	<b>Sale History</b> <table border="1"> <thead> <tr> <th>Bk/Pg</th> <th>Grantor</th> <th>Date</th> <th>Price</th> <th>Code</th> </tr> </thead> <tbody> <tr> <td> </td> <td> </td> <td> </td> <td> </td> <td> </td> </tr> </tbody> </table>					Bk/Pg	Grantor	Date	Price	Code																																																																																																	
Code	Type	Active	Maximum	Exemption																																																																																																																					
H	Homestead	Yes	1,000	1,000																																																																																																																					
Bk/Pg	Grantor	Date	Price	Code																																																																																																																					
<b>Parcel Valuation</b> <table border="1"> <thead> <tr> <th>Source</th> <th>REAL</th> <th>Fair Cash</th> <th>Capped</th> <th>Asmnt Level</th> <th>Assessed</th> <th>Levy Rate</th> <th>103.438</th> <th>Current Tax</th> </tr> </thead> <tbody> <tr> <td>Remove Cap</td> <td>0</td> <td>Land Value 91,308</td> <td>40,349</td> <td>11%</td> <td>4,438</td> <td>Assessed</td> <td>23,607</td> <td>2,441.86</td> </tr> <tr> <td>Year Frozen</td> <td>0</td> <td>Improvements 251,524</td> <td>174,264</td> <td></td> <td>19,169</td> <td>Penalty</td> <td>0</td> <td></td> </tr> <tr> <td>Uncapped Value</td> <td>0</td> <td>Mobile Home 0</td> <td>0</td> <td></td> <td>0</td> <td>Exemption</td> <td>1,000</td> <td>-93.00</td> </tr> <tr> <td>TIF Project ID</td> <td>0</td> <td>Total Value 342,832</td> <td>214,613</td> <td></td> <td>23,607</td> <td>Total Taxable</td> <td>22,607</td> <td>2,349.00</td> </tr> </tbody> </table>										Source	REAL	Fair Cash	Capped	Asmnt Level	Assessed	Levy Rate	103.438	Current Tax	Remove Cap	0	Land Value 91,308	40,349	11%	4,438	Assessed	23,607	2,441.86	Year Frozen	0	Improvements 251,524	174,264		19,169	Penalty	0		Uncapped Value	0	Mobile Home 0	0		0	Exemption	1,000	-93.00	TIF Project ID	0	Total Value 342,832	214,613		23,607	Total Taxable	22,607	2,349.00																																																																			
Source	REAL	Fair Cash	Capped	Asmnt Level	Assessed	Levy Rate	103.438	Current Tax																																																																																																																	
Remove Cap	0	Land Value 91,308	40,349	11%	4,438	Assessed	23,607	2,441.86																																																																																																																	
Year Frozen	0	Improvements 251,524	174,264		19,169	Penalty	0																																																																																																																		
Uncapped Value	0	Mobile Home 0	0		0	Exemption	1,000	-93.00																																																																																																																	
TIF Project ID	0	Total Value 342,832	214,613		23,607	Total Taxable	22,607	2,349.00																																																																																																																	
<b>Assessment History</b> <table border="1"> <thead> <tr> <th>Tax Year</th> <th>Statement Number</th> <th>Billed Owner</th> <th>Tax Area</th> <th>Total Value</th> <th>Exemptions</th> <th>Taxable Value</th> <th>Billed Tax</th> </tr> </thead> <tbody> <tr><td>2025</td><td>2025-660024752</td><td>OLMSTEAD, MARK A &amp;</td><td>23</td><td>316,069</td><td>1000</td><td>21,920</td><td>2,277.00</td></tr> <tr><td>2024</td><td>2024-660024752</td><td>OLMSTEAD, MARK A &amp;</td><td>23</td><td>331,191</td><td>1000</td><td>21,253</td><td>2,241.00</td></tr> <tr><td>2023</td><td>2023-660024752</td><td>OLMSTEAD, MARK A &amp;</td><td>23</td><td>284,836</td><td>1000</td><td>20,605</td><td>2,098.00</td></tr> <tr><td>2022</td><td>2022-660024752</td><td>OLMSTEAD, MARK A &amp;</td><td>23</td><td>282,858</td><td>1000</td><td>19,975</td><td>2,039.00</td></tr> <tr><td>2021</td><td>2021-660024752</td><td>OLMSTEAD, MARK A &amp;</td><td>23</td><td>269,243</td><td>1000</td><td>19,365</td><td>1,995.00</td></tr> <tr><td>2020</td><td>2020-660024752</td><td>OLMSTEAD, MARK A &amp;</td><td>23</td><td>270,005</td><td>1000</td><td>18,771</td><td>1,943.00</td></tr> <tr><td>2019</td><td>2019-660024752</td><td>OLMSTEAD, MARK A &amp;</td><td>23</td><td>254,303</td><td>1000</td><td>18,195</td><td>1,904.00</td></tr> <tr><td>2018</td><td>2018-660024752</td><td>OLMSTEAD, MARK A &amp;</td><td>23</td><td>262,562</td><td>1000</td><td>17,637</td><td>1,836.00</td></tr> <tr><td>2017</td><td>2017-660024752</td><td>OLMSTEAD, MARK A &amp;</td><td>23</td><td>260,535</td><td>1000</td><td>17,094</td><td>1,802.00</td></tr> <tr><td>2016</td><td>2016-660024752</td><td>OLMSTEAD, MARK A &amp;</td><td>23</td><td>254,473</td><td>1000</td><td>16,566</td><td>1,724.00</td></tr> <tr><td>2015</td><td>2015-660024752</td><td>OLMSTEAD, MARK A &amp;</td><td>23</td><td>251,411</td><td>1000</td><td>16,055</td><td>1,679.00</td></tr> <tr><td>2014</td><td>2014-660024752</td><td>OLMSTEAD, MARK A &amp;</td><td>23</td><td>256,050</td><td>1000</td><td>15,559</td><td>1,643.00</td></tr> <tr><td>2013</td><td>2013-660024752</td><td>OLMSTEAD, MARK A &amp;</td><td>23</td><td>242,198</td><td>1000</td><td>15,077</td><td>1,580.00</td></tr> </tbody> </table>										Tax Year	Statement Number	Billed Owner	Tax Area	Total Value	Exemptions	Taxable Value	Billed Tax	2025	2025-660024752	OLMSTEAD, MARK A &	23	316,069	1000	21,920	2,277.00	2024	2024-660024752	OLMSTEAD, MARK A &	23	331,191	1000	21,253	2,241.00	2023	2023-660024752	OLMSTEAD, MARK A &	23	284,836	1000	20,605	2,098.00	2022	2022-660024752	OLMSTEAD, MARK A &	23	282,858	1000	19,975	2,039.00	2021	2021-660024752	OLMSTEAD, MARK A &	23	269,243	1000	19,365	1,995.00	2020	2020-660024752	OLMSTEAD, MARK A &	23	270,005	1000	18,771	1,943.00	2019	2019-660024752	OLMSTEAD, MARK A &	23	254,303	1000	18,195	1,904.00	2018	2018-660024752	OLMSTEAD, MARK A &	23	262,562	1000	17,637	1,836.00	2017	2017-660024752	OLMSTEAD, MARK A &	23	260,535	1000	17,094	1,802.00	2016	2016-660024752	OLMSTEAD, MARK A &	23	254,473	1000	16,566	1,724.00	2015	2015-660024752	OLMSTEAD, MARK A &	23	251,411	1000	16,055	1,679.00	2014	2014-660024752	OLMSTEAD, MARK A &	23	256,050	1000	15,559	1,643.00	2013	2013-660024752	OLMSTEAD, MARK A &	23	242,198	1000	15,077	1,580.00
Tax Year	Statement Number	Billed Owner	Tax Area	Total Value	Exemptions	Taxable Value	Billed Tax																																																																																																																		
2025	2025-660024752	OLMSTEAD, MARK A &	23	316,069	1000	21,920	2,277.00																																																																																																																		
2024	2024-660024752	OLMSTEAD, MARK A &	23	331,191	1000	21,253	2,241.00																																																																																																																		
2023	2023-660024752	OLMSTEAD, MARK A &	23	284,836	1000	20,605	2,098.00																																																																																																																		
2022	2022-660024752	OLMSTEAD, MARK A &	23	282,858	1000	19,975	2,039.00																																																																																																																		
2021	2021-660024752	OLMSTEAD, MARK A &	23	269,243	1000	19,365	1,995.00																																																																																																																		
2020	2020-660024752	OLMSTEAD, MARK A &	23	270,005	1000	18,771	1,943.00																																																																																																																		
2019	2019-660024752	OLMSTEAD, MARK A &	23	254,303	1000	18,195	1,904.00																																																																																																																		
2018	2018-660024752	OLMSTEAD, MARK A &	23	262,562	1000	17,637	1,836.00																																																																																																																		
2017	2017-660024752	OLMSTEAD, MARK A &	23	260,535	1000	17,094	1,802.00																																																																																																																		
2016	2016-660024752	OLMSTEAD, MARK A &	23	254,473	1000	16,566	1,724.00																																																																																																																		
2015	2015-660024752	OLMSTEAD, MARK A &	23	251,411	1000	16,055	1,679.00																																																																																																																		
2014	2014-660024752	OLMSTEAD, MARK A &	23	256,050	1000	15,559	1,643.00																																																																																																																		
2013	2013-660024752	OLMSTEAD, MARK A &	23	242,198	1000	15,077	1,580.00																																																																																																																		



# Rogers

## Assessment Property Record Card for Tax Year 2026

Data provided by LISA DELOZIER County Assessor

Date 04/16/2026  
Time 22:12:18  
Page 2

Lot Data	Square-Foot - UNPLATTED (ACRES)	Primary Image
Lot Size		
Lot Count		
Units Buildable	6.07	
Non-Ag Acres	5.4205	
Topography		
Street Access		
Utilities		
Amenities	LAND QUALITY 0	
	0	
Method	Square-Foot	
Base Lot Value	236,116.00 x .39 = 91,308	
Factor Value		
Adjustments	1.0000	
Lot Value	91,308	

Residential Data	
Type	1 Single Family Residence
Condition	3 - Average
Quality	3 - Average
Architecture	
Style	100% Two Story
Exterior Wall	100% Frame, Siding, Vinyl
Base/Total Area	2,020 / 2,916
Style	100% Two Story
HVAC	100% Warmed & Cooled Air
Roof Cover	1 Composition Shingle
Area on Slab	0
Fixture/RghIn	16 /
Bed/F/H Bath	4 / 3.5 /
Basement Area	
Garage Type	588 Attached Garage - Unfinished
Remodel	
Year/Eff Age	1996 / 23

GRM Approach	
GRM Code	
Gross Rent	0.00
Indicated Value	

Multiple Regression	
MRA Code	1 Test
Adusted R	0.8445
Indicated Value	310,749 106.57 Per SqFt

Direct Comparables	
Selection Model	1 Res
Adjustment Model	A2 AO Test
Comparables	
Indicated Value	

Cost Approach				Manual : 01/2025			
Base Cost	82.15	Total Misc Impr	+ 10,413				
Roofing Adj	+ 3.25	Garage Cost	+ 18,057				
Subfloor Adj	+ 0.00	Total RCN	= 336,545				
Heat/Cool Adj	+ 12.64	Depreciation ( 28%)	- 94,233				
Plumbing Adj	+ 7.61	Lump Sums	+ 9,212				
Basement Adj	+ 0.00	RCNLD	= 251,524				
Adj Base Cost	= 105.65	Lot Value	+ 91,308				
Total Area	x 2,916	Indicated Value	= 342,832				
Adjusted Cost	= 308,075	Value Per SqFt	117.57				

Value Reconciliation	
Selected Approach	Cost Approach
Improvements	251,524
Lot Value	91,308
Indicated Value	342,832 117.57 Per SqFt
Agland Value	
Site Improvements	
Total Value	342,832 117.57 Total Value Per SqFt

Miscellaneous Improvements								
Code	Description	Sketch ID	Size	Year	Units	Unit Cost	Depr	Value
FPR1	FIREPLACE - RESIDENTIAL 1 STORY	0		1	1	5,615.40		5,615
WODC	WOOD DECK - COVERED	60670	27x8		216	37.14	40%	4,813
PRCH	SLAB PORCH - COVERED	60671	26x7		182	26.36		4,798
WODO	WOOD DECK - OPEN	60672	27x16		432	16.97	40%	4,399



# Rogers

## Assessment Property Record Card for Tax Year 2026

Data provided by LISA DELOZIER County Assessor

Date 04/16/2026  
 Time 22:12:18  
 Page 3

Sketch Image

660024752

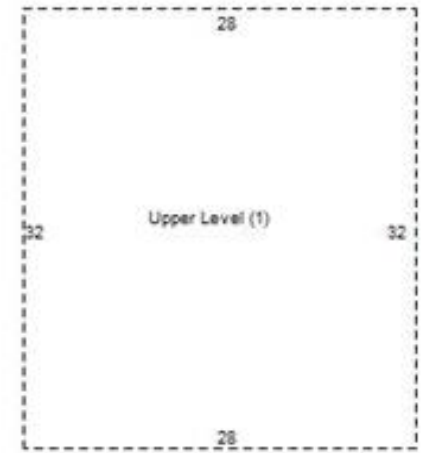
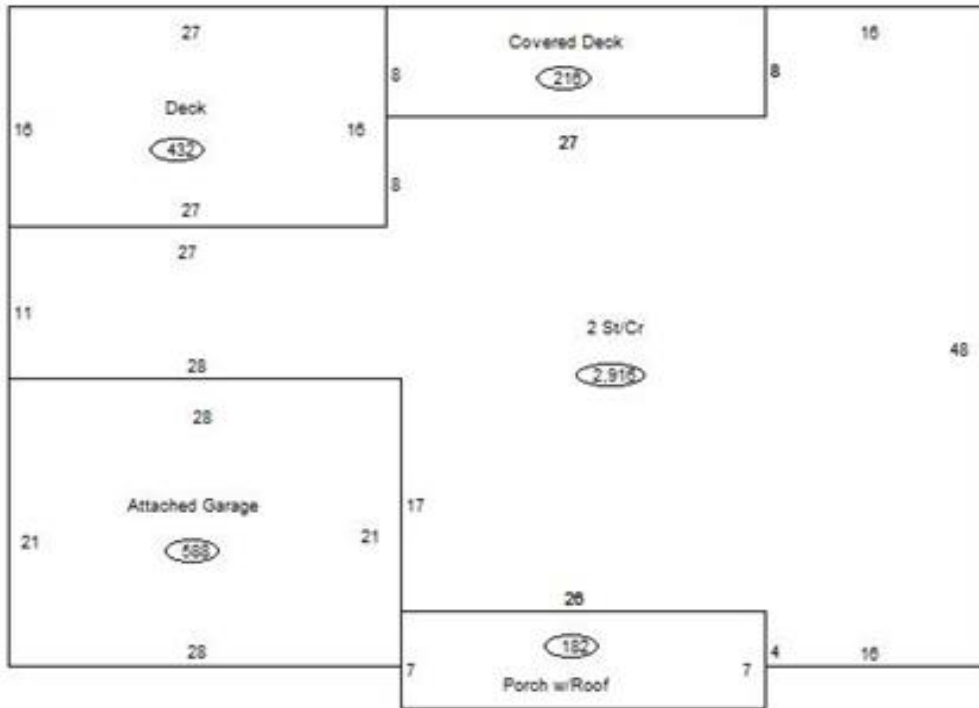

### Sketch Vector Information

Sequence	Code	Type	Built Over	Scale	Section Label	Base Area	Multiplier	Total Area
1	R	2	Crawl	13	2 St/Cr	2,020	1.444	2,916
2	G	1		13	Attached Garage	588	1.000	588
3	M	WODC		13	WODC	216	1.000	216
4	M	PRCH		13	SLBC	182	1.000	182
5	M	WODO		13	WODO	432	1.000	432
6	U	^UL		13	Upper Level (1)	896	1.000	896
<b>Total Building Area</b>						<b>2,020</b>		<b>2,916</b>