



Rogers

Assessment Property Record Card for Tax Year 2026

Data provided by LISA DELOZIER County Assessor

Date 04/16/2026
Time 22:01:28
Page 1

Assessment Data					Primary Image																																																																																																																				
Account 660024823 Parcel ID 000000-00-0-00756-003-0011 Cadastral ID 29-21-16-05070 Property Type REAL - Real Property Property Class RRP VI Area 1 Tax Area 21 - CLAREMORE RURAL/VERD FIR Name ID 254849 LEWIS, CECIL RAY JR & LISA FERN & CAMERON RYAN LEWIS 23635 S SOUTH RIDGE DR CLAREMORE OK 74019-0000 Parcel Location Situs 23635 S SOUTH RIDGE DR Subdivision SOUTH RIDGE ESTATES Lot/Block 0011 / 0003 Parcel Size 1 - Lots Sec/Twn/Rng 29 / 21 / 16 / 5 Neighborhood 1121 - R-V01-SW CLAREMORE School District S001 - CLAREMORE SCHOOLS																																																																																																																									
Legal Description Lot/Long: 36.26882747 -95.62511883																																																																																																																									
LOT 11 BLOCK 3 SOUTH RIDGE ESTATES					Building Permits <table border="1"> <thead> <tr> <th>Number</th> <th>Description</th> <th>Opened</th> <th>Closed</th> <th>Amount</th> </tr> </thead> <tbody> <tr> <td> </td> <td> </td> <td> </td> <td> </td> <td> </td> </tr> </tbody> </table>					Number	Description	Opened	Closed	Amount																																																																																																											
Number	Description	Opened	Closed	Amount																																																																																																																					
Exemptions <table border="1"> <thead> <tr> <th>Code</th> <th>Type</th> <th>Active</th> <th>Maximum</th> <th>Exemption</th> </tr> </thead> <tbody> <tr> <td>H</td> <td>Homestead</td> <td>Yes</td> <td>1,000</td> <td>1,000</td> </tr> </tbody> </table>					Code	Type	Active	Maximum	Exemption	H	Homestead	Yes	1,000	1,000	Sale History <table border="1"> <thead> <tr> <th>Bk/Pg</th> <th>Grantor</th> <th>Date</th> <th>Price</th> <th>Code</th> </tr> </thead> <tbody> <tr> <td>900/551</td> <td>GAITHER-KNAPP DEVELOPMENT</td> <td>11/30/1992</td> <td>71,400</td> <td>Yes</td> </tr> </tbody> </table>					Bk/Pg	Grantor	Date	Price	Code	900/551	GAITHER-KNAPP DEVELOPMENT	11/30/1992	71,400	Yes																																																																																												
Code	Type	Active	Maximum	Exemption																																																																																																																					
H	Homestead	Yes	1,000	1,000																																																																																																																					
Bk/Pg	Grantor	Date	Price	Code																																																																																																																					
900/551	GAITHER-KNAPP DEVELOPMENT	11/30/1992	71,400	Yes																																																																																																																					
Parcel Valuation <table border="1"> <thead> <tr> <th>Source</th> <th>REAL</th> <th>Fair Cash</th> <th>Capped</th> <th>Asmnt Level</th> <th>Assessed</th> <th>Levy Rate</th> <th>109.172</th> <th>Current Tax</th> </tr> </thead> <tbody> <tr> <td>Remove Cap</td> <td>0</td> <td>Land Value 92,996</td> <td>46,661</td> <td>11%</td> <td>5,133</td> <td>Assessed</td> <td>22,412</td> <td>2,446.76</td> </tr> <tr> <td>Year Frozen</td> <td>0</td> <td>Improvements 157,083</td> <td>157,083</td> <td></td> <td>17,279</td> <td>Penalty</td> <td>0</td> <td></td> </tr> <tr> <td>Uncapped Value</td> <td>0</td> <td>Mobile Home 0</td> <td>0</td> <td></td> <td>0</td> <td>Exemption</td> <td>1,000</td> <td>-92.00</td> </tr> <tr> <td>TIF Project ID</td> <td>0</td> <td>Total Value 250,079</td> <td>203,744</td> <td></td> <td>22,412</td> <td>Total Taxable</td> <td>21,412</td> <td>2,355.00</td> </tr> </tbody> </table>										Source	REAL	Fair Cash	Capped	Asmnt Level	Assessed	Levy Rate	109.172	Current Tax	Remove Cap	0	Land Value 92,996	46,661	11%	5,133	Assessed	22,412	2,446.76	Year Frozen	0	Improvements 157,083	157,083		17,279	Penalty	0		Uncapped Value	0	Mobile Home 0	0		0	Exemption	1,000	-92.00	TIF Project ID	0	Total Value 250,079	203,744		22,412	Total Taxable	21,412	2,355.00																																																																			
Source	REAL	Fair Cash	Capped	Asmnt Level	Assessed	Levy Rate	109.172	Current Tax																																																																																																																	
Remove Cap	0	Land Value 92,996	46,661	11%	5,133	Assessed	22,412	2,446.76																																																																																																																	
Year Frozen	0	Improvements 157,083	157,083		17,279	Penalty	0																																																																																																																		
Uncapped Value	0	Mobile Home 0	0		0	Exemption	1,000	-92.00																																																																																																																	
TIF Project ID	0	Total Value 250,079	203,744		22,412	Total Taxable	21,412	2,355.00																																																																																																																	
Assessment History <table border="1"> <thead> <tr> <th>Tax Year</th> <th>Statement Number</th> <th>Billed Owner</th> <th>Tax Area</th> <th>Total Value</th> <th>Exemptions</th> <th>Taxable Value</th> <th>Billed Tax</th> </tr> </thead> <tbody> <tr><td>2025</td><td>2025-660024823</td><td>LEWIS, CECIL RAY JR & LISA FERN</td><td>21</td><td>248,974</td><td>1000</td><td>20,760</td><td>2,283.00</td></tr> <tr><td>2024</td><td>2024-660024823</td><td>LEWIS, CECIL RAY JR & LISA FERN</td><td>21</td><td>265,815</td><td>1000</td><td>20,125</td><td>2,078.00</td></tr> <tr><td>2023</td><td>2023-660024823</td><td>LEWIS, CECIL RAY JR & LISA FERN</td><td>21</td><td>190,705</td><td>1000</td><td>19,510</td><td>1,998.00</td></tr> <tr><td>2022</td><td>2022-660024823</td><td>LEWIS, CECIL RAY JR & LISA FERN</td><td>21</td><td>190,699</td><td>1000</td><td>18,913</td><td>1,956.00</td></tr> <tr><td>2021</td><td>2021-660024823</td><td>LEWIS, CECIL RAY JR &</td><td>21</td><td>175,754</td><td>1000</td><td>18,333</td><td>1,818.00</td></tr> <tr><td>2020</td><td>2020-660024823</td><td>LEWIS, CECIL RAY JR &</td><td>21</td><td>176,152</td><td>1000</td><td>17,987</td><td>1,843.00</td></tr> <tr><td>2019</td><td>2019-660024823</td><td>LEWIS, CECIL RAY JR &</td><td>21</td><td>167,585</td><td>1000</td><td>17,434</td><td>1,805.00</td></tr> <tr><td>2018</td><td>2018-660024823</td><td>LEWIS, CECIL RAY JR &</td><td>21</td><td>171,807</td><td>1000</td><td>17,085</td><td>1,765.00</td></tr> <tr><td>2017</td><td>2017-660024823</td><td>LEWIS, CECIL RAY JR &</td><td>21</td><td>170,446</td><td>1000</td><td>16,558</td><td>1,700.00</td></tr> <tr><td>2016</td><td>2016-660024823</td><td>LEWIS, CECIL RAY JR &</td><td>21</td><td>166,127</td><td>1000</td><td>16,047</td><td>1,680.00</td></tr> <tr><td>2015</td><td>2015-660024823</td><td>LEWIS, CECIL RAY JR &</td><td>21</td><td>151,197</td><td>1000</td><td>15,551</td><td>1,571.00</td></tr> <tr><td>2014</td><td>2014-660024823</td><td>LEWIS, CECIL RAY JR &</td><td>21</td><td>153,717</td><td>1000</td><td>15,069</td><td>1,563.00</td></tr> <tr><td>2013</td><td>2013-660024823</td><td>LEWIS, CECIL RAY JR &</td><td>21</td><td>145,015</td><td>1000</td><td>14,601</td><td>1,497.00</td></tr> </tbody> </table>										Tax Year	Statement Number	Billed Owner	Tax Area	Total Value	Exemptions	Taxable Value	Billed Tax	2025	2025-660024823	LEWIS, CECIL RAY JR & LISA FERN	21	248,974	1000	20,760	2,283.00	2024	2024-660024823	LEWIS, CECIL RAY JR & LISA FERN	21	265,815	1000	20,125	2,078.00	2023	2023-660024823	LEWIS, CECIL RAY JR & LISA FERN	21	190,705	1000	19,510	1,998.00	2022	2022-660024823	LEWIS, CECIL RAY JR & LISA FERN	21	190,699	1000	18,913	1,956.00	2021	2021-660024823	LEWIS, CECIL RAY JR &	21	175,754	1000	18,333	1,818.00	2020	2020-660024823	LEWIS, CECIL RAY JR &	21	176,152	1000	17,987	1,843.00	2019	2019-660024823	LEWIS, CECIL RAY JR &	21	167,585	1000	17,434	1,805.00	2018	2018-660024823	LEWIS, CECIL RAY JR &	21	171,807	1000	17,085	1,765.00	2017	2017-660024823	LEWIS, CECIL RAY JR &	21	170,446	1000	16,558	1,700.00	2016	2016-660024823	LEWIS, CECIL RAY JR &	21	166,127	1000	16,047	1,680.00	2015	2015-660024823	LEWIS, CECIL RAY JR &	21	151,197	1000	15,551	1,571.00	2014	2014-660024823	LEWIS, CECIL RAY JR &	21	153,717	1000	15,069	1,563.00	2013	2013-660024823	LEWIS, CECIL RAY JR &	21	145,015	1000	14,601	1,497.00
Tax Year	Statement Number	Billed Owner	Tax Area	Total Value	Exemptions	Taxable Value	Billed Tax																																																																																																																		
2025	2025-660024823	LEWIS, CECIL RAY JR & LISA FERN	21	248,974	1000	20,760	2,283.00																																																																																																																		
2024	2024-660024823	LEWIS, CECIL RAY JR & LISA FERN	21	265,815	1000	20,125	2,078.00																																																																																																																		
2023	2023-660024823	LEWIS, CECIL RAY JR & LISA FERN	21	190,705	1000	19,510	1,998.00																																																																																																																		
2022	2022-660024823	LEWIS, CECIL RAY JR & LISA FERN	21	190,699	1000	18,913	1,956.00																																																																																																																		
2021	2021-660024823	LEWIS, CECIL RAY JR &	21	175,754	1000	18,333	1,818.00																																																																																																																		
2020	2020-660024823	LEWIS, CECIL RAY JR &	21	176,152	1000	17,987	1,843.00																																																																																																																		
2019	2019-660024823	LEWIS, CECIL RAY JR &	21	167,585	1000	17,434	1,805.00																																																																																																																		
2018	2018-660024823	LEWIS, CECIL RAY JR &	21	171,807	1000	17,085	1,765.00																																																																																																																		
2017	2017-660024823	LEWIS, CECIL RAY JR &	21	170,446	1000	16,558	1,700.00																																																																																																																		
2016	2016-660024823	LEWIS, CECIL RAY JR &	21	166,127	1000	16,047	1,680.00																																																																																																																		
2015	2015-660024823	LEWIS, CECIL RAY JR &	21	151,197	1000	15,551	1,571.00																																																																																																																		
2014	2014-660024823	LEWIS, CECIL RAY JR &	21	153,717	1000	15,069	1,563.00																																																																																																																		
2013	2013-660024823	LEWIS, CECIL RAY JR &	21	145,015	1000	14,601	1,497.00																																																																																																																		



Rogers

Assessment Property Record Card for Tax Year 2026

Data provided by LISA DELOZIER County Assessor

Date 04/16/2026
Time 22:01:28
Page 2

Lot Data		Square-Foot - NBHD 1121 #1
Lot Size		
Lot Count		
Units Buildable	1	
Non-Ag Acres	1.1349	
Topography		
Street Access		
Utilities		
Amenities	LAND QUALITY	0
	1/2 LOT	0
Method	Square-Foot	
Base Lot Value	49,436.00 x 1.88 = 92,996	
Factor Value		
Adjustments	1.0000	
Lot Value	92,996	



\\tsclient\A\TOMMY DUNLAP\New folder (236)\IMG_0001.JPG 7/26/2023

Residential Data	
Type	1 Single Family Residence
Condition	3 - Average
Quality	2.5 - Fair
Architecture	
Style	100% One Story
Exterior Wall	80% Veneer, Masonry 20% Frame, Siding, Wood
Base/Total Area	1,562 / 1,562
Style	100% One Story
HVAC	100% Warmed & Cooled Air
Roof Cover	1 Composition Shingle
Area on Slab	1,562
Fixture/RghIn	11 /
Bed/F/H Bath	3 / 2.0 /
Basement Area	
Garage Type	462 Attached Garage - Unfinished
Remodel	
Year/Eff Age	1992 / 26

GRM Approach	
GRM Code	
Gross Rent	0.00
Indicated Value	

Multiple Regression			
MRA Code	1 Test		
Adusted R	0.8445		
Indicated Value	176,094	112.74	Per SqFt

Direct Comparables			
Selection Model	A Adam Test		
Adjustment Model	1 2022 Residential		
Comparables	5		
Indicated Value	223,270		Per SqFt

Cost Approach		Manual : 01/2025	
Base Cost	104.28	Total Misc Impr	+ 28,674
Roofing Adj	+ 4.47	Garage Cost	+ 12,931
Subfloor Adj	+ -1.15	Total RCN	= 241,666
Heat/Cool Adj	+ 11.47	Depreciation (35%)	- 84,583
Plumbing Adj	+ 9.01	Lump Sums	+ 0
Basement Adj	+ 0.00	RCNLD	= 157,083
Adj Base Cost	= 128.08	Lot Value	+ 92,996
Total Area	x 1,562	Indicated Value	= 250,079
Adjusted Cost	= 200,061	Value Per SqFt	160.10

Value Reconciliation			
Selected Approach	Cost Approach		
Improvements	157,083		
Lot Value	92,996		
Indicated Value	250,079	160.10	Per SqFt
Agland Value			
Site Improvements			
Total Value	250,079	160.10	Total Value Per SqFt

Miscellaneous Improvements								
Code	Description	Sketch ID	Size	Year	Units	Unit Cost	Depr	Value
FPR1	FIREPLACE - RESIDENTIAL 1 STORY	0		1	1	5,095.98		5,096
PRCH	SLAB PORCH - COVERED	60875	11x6		66	24.06		1,588
PRCH	SLAB PORCH - COVERED	114894	164		164	23.70		3,887
EPSW	ENCLOSED PORCH - SOLID WALL	124962	296		296	61.16		18,103



Sketch Image

660024823

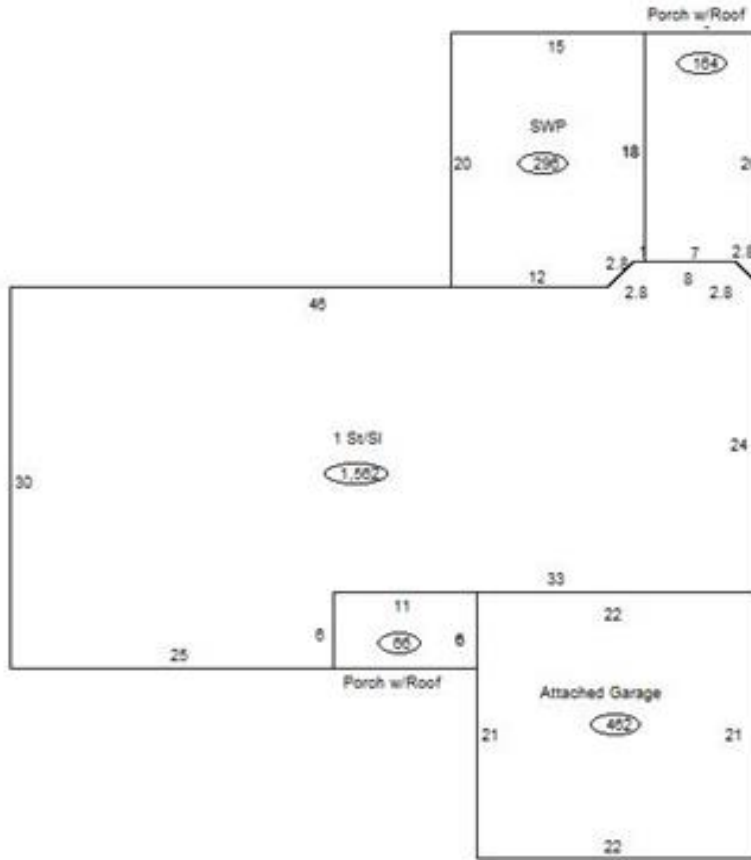

Sketch Vector Information

Sequence	Code	Type	Built Over	Scale	Section Label	Base Area	Multiplier	Total Area
1	G	1		13	Attached Garage	462	1.000	462
2	M	PRCH		13	SLBC	66	1.000	66
3	R	1	Slab	13	1 St/SI	1,562	1.000	1,562
4	M	PRCH		13	SLBC	164	1.000	164
5	M	EPSW		13	EPSW	296	1.000	296
Total Building Area						1,562		1,562