



# Rogers

## Assessment Property Record Card for Tax Year 2026

Data provided by LISA DELOZIER County Assessor

Date 04/16/2026  
 Time 23:10:08  
 Page 1

Assessment Data					Primary Image																																																																																																																				
<b>Account</b> 660024844 <b>Parcel ID</b> 000000-00-0-00756-004-0016 <b>Cadastral ID</b> 29-21-16-05280 <b>Property Type</b> REAL - Real Property <b>Property Class</b> RRP VI Area 1 <b>Tax Area</b> 21 - CLAREMORE RURAL/VERD FIR <b>Name ID</b> 349526 SEYMOUR, BENJAMIN  11313 SOUTH PARK RD CLAREMORE OK 74019-5664  <b>Parcel Location</b> <b>Situs</b> 11313 E SOUTH PARK RD <b>Subdivision</b> SOUTH RIDGE ESTATES <b>Lot/Block</b> 0016 / 0004 <b>Parcel Size</b> 1 - Lots <b>Sec/Twn/Rng</b> 29 / 21 / 16 / 5 <b>Neighborhood</b> 1121 - R-V01-SW CLAREMORE <b>School District</b> S001 - CLAREMORE SCHOOLS					<p>\\tsclient\A\TOMMY DUNLAP\New folder (237)\IMG_0035.JPG 7/27/2023</p>																																																																																																																				
<b>Legal Description</b> Lot/Long: 36.26616183 -95.62695270 LOT 16 BLOCK 4 SOUTH RIDGE ESTATES																																																																																																																									
<b>Exemptions</b> <table border="1"> <thead> <tr> <th>Code</th> <th>Type</th> <th>Active</th> <th>Maximum</th> <th>Exemption</th> </tr> </thead> <tbody> <tr> <td>H</td> <td>Homestead</td> <td>Yes</td> <td>1,000</td> <td>1,000</td> </tr> </tbody> </table>					Code	Type	Active	Maximum	Exemption	H	Homestead	Yes	1,000	1,000	<b>Building Permits</b> <table border="1"> <thead> <tr> <th>Number</th> <th>Description</th> <th>Opened</th> <th>Closed</th> <th>Amount</th> </tr> </thead> <tbody> <tr> <td colspan="5"> </td> </tr> </tbody> </table>					Number	Description	Opened	Closed	Amount																																																																																																	
Code	Type	Active	Maximum	Exemption																																																																																																																					
H	Homestead	Yes	1,000	1,000																																																																																																																					
Number	Description	Opened	Closed	Amount																																																																																																																					
<b>Parcel Valuation</b> <table border="1"> <thead> <tr> <th>Source</th> <th>REAL</th> <th>Fair Cash</th> <th>Capped</th> <th>Asmnt Level</th> <th>Assessed</th> <th>Levy Rate</th> <th>109.172</th> <th>Current Tax</th> </tr> </thead> <tbody> <tr> <td>Remove Cap</td> <td>2027</td> <td>Land Value 89,797</td> <td>49,628</td> <td>11%</td> <td>5,459</td> <td>Assessed</td> <td>16,099</td> <td>1,757.56</td> </tr> <tr> <td>Year Frozen</td> <td>2013</td> <td>Improvements 175,024</td> <td>96,729</td> <td></td> <td>10,640</td> <td>Penalty</td> <td>0</td> <td></td> </tr> <tr> <td>Uncapped Value</td> <td>0</td> <td>Mobile Home 0</td> <td>0</td> <td></td> <td>0</td> <td>Exemption</td> <td>1,000</td> <td>-93.00</td> </tr> <tr> <td>TIF Project ID</td> <td>0</td> <td>Total Value 264,821</td> <td>146,357</td> <td></td> <td>16,099</td> <td>Total Taxable</td> <td>15,099</td> <td>1,665.00</td> </tr> </tbody> </table>					Source	REAL	Fair Cash	Capped	Asmnt Level	Assessed	Levy Rate	109.172	Current Tax	Remove Cap	2027	Land Value 89,797	49,628	11%	5,459	Assessed	16,099	1,757.56	Year Frozen	2013	Improvements 175,024	96,729		10,640	Penalty	0		Uncapped Value	0	Mobile Home 0	0		0	Exemption	1,000	-93.00	TIF Project ID	0	Total Value 264,821	146,357		16,099	Total Taxable	15,099	1,665.00	<b>Sale History</b> <table border="1"> <thead> <tr> <th>Bk/Pg</th> <th>Grantor</th> <th>Date</th> <th>Price</th> <th>Code</th> </tr> </thead> <tbody> <tr> <td>/</td> <td>TAYLOR, ROBERT L</td> <td>02/27/2026</td> <td>249,000</td> <td>YES</td> </tr> <tr> <td>2555/407</td> <td>TAYLOR, ROBERT L &amp; DOROTHY M</td> <td>06/13/2016</td> <td>0</td> <td>4</td> </tr> <tr> <td>1203/831</td> <td>SHULAR, LOY RICHARD, JR &amp;</td> <td>10/20/1999</td> <td>125,000</td> <td>Yes</td> </tr> <tr> <td>986/229</td> <td>DORSEY, DAVID L</td> <td>03/30/1995</td> <td>95,000</td> <td>Yes</td> </tr> <tr> <td>943/270</td> <td>WATSON, JERRY D &amp; BEVERLY~J</td> <td>12/30/1993</td> <td>10,000</td> <td>Yes</td> </tr> <tr> <td>904/417</td> <td>DORSEY LAND DEVELOPMENT CO-IN</td> <td>01/11/1993</td> <td>12,000</td> <td>No</td> </tr> </tbody> </table>					Bk/Pg	Grantor	Date	Price	Code	/	TAYLOR, ROBERT L	02/27/2026	249,000	YES	2555/407	TAYLOR, ROBERT L & DOROTHY M	06/13/2016	0	4	1203/831	SHULAR, LOY RICHARD, JR &	10/20/1999	125,000	Yes	986/229	DORSEY, DAVID L	03/30/1995	95,000	Yes	943/270	WATSON, JERRY D & BEVERLY~J	12/30/1993	10,000	Yes	904/417	DORSEY LAND DEVELOPMENT CO-IN	01/11/1993	12,000	No																																
Source	REAL	Fair Cash	Capped	Asmnt Level	Assessed	Levy Rate	109.172	Current Tax																																																																																																																	
Remove Cap	2027	Land Value 89,797	49,628	11%	5,459	Assessed	16,099	1,757.56																																																																																																																	
Year Frozen	2013	Improvements 175,024	96,729		10,640	Penalty	0																																																																																																																		
Uncapped Value	0	Mobile Home 0	0		0	Exemption	1,000	-93.00																																																																																																																	
TIF Project ID	0	Total Value 264,821	146,357		16,099	Total Taxable	15,099	1,665.00																																																																																																																	
Bk/Pg	Grantor	Date	Price	Code																																																																																																																					
/	TAYLOR, ROBERT L	02/27/2026	249,000	YES																																																																																																																					
2555/407	TAYLOR, ROBERT L & DOROTHY M	06/13/2016	0	4																																																																																																																					
1203/831	SHULAR, LOY RICHARD, JR &	10/20/1999	125,000	Yes																																																																																																																					
986/229	DORSEY, DAVID L	03/30/1995	95,000	Yes																																																																																																																					
943/270	WATSON, JERRY D & BEVERLY~J	12/30/1993	10,000	Yes																																																																																																																					
904/417	DORSEY LAND DEVELOPMENT CO-IN	01/11/1993	12,000	No																																																																																																																					
<b>Assessment History</b> <table border="1"> <thead> <tr> <th>Tax Year</th> <th>Statement Number</th> <th>Billed Owner</th> <th>Tax Area</th> <th>Total Value</th> <th>Exemptions</th> <th>Taxable Value</th> <th>Billed Tax</th> </tr> </thead> <tbody> <tr><td>2025</td><td>2025-660024844</td><td>TAYLOR, ROBERT L</td><td>21</td><td>258,509</td><td>1000</td><td>15,099</td><td>1,666.00</td></tr> <tr><td>2024</td><td>2024-660024844</td><td>TAYLOR, ROBERT L</td><td>21</td><td>270,697</td><td>1000</td><td>15,100</td><td>1,562.00</td></tr> <tr><td>2023</td><td>2023-660024844</td><td>TAYLOR, ROBERT L</td><td>21</td><td>188,154</td><td>1000</td><td>15,099</td><td>1,549.00</td></tr> <tr><td>2022</td><td>2022-660024844</td><td>TAYLOR, ROBERT L</td><td>21</td><td>190,226</td><td>1000</td><td>15,100</td><td>1,564.00</td></tr> <tr><td>2021</td><td>2021-660024844</td><td>TAYLOR, ROBERT L</td><td>21</td><td>175,254</td><td>1000</td><td>15,099</td><td>1,499.00</td></tr> <tr><td>2020</td><td>2020-660024844</td><td>TAYLOR, ROBERT L</td><td>21</td><td>174,142</td><td>1000</td><td>15,100</td><td>1,549.00</td></tr> <tr><td>2019</td><td>2019-660024844</td><td>TAYLOR, ROBERT L</td><td>21</td><td>165,713</td><td>1000</td><td>15,099</td><td>1,564.00</td></tr> <tr><td>2018</td><td>2018-660024844</td><td>TAYLOR, ROBERT L</td><td>21</td><td>170,091</td><td>1000</td><td>15,099</td><td>1,561.00</td></tr> <tr><td>2017</td><td>2017-660024844</td><td>TAYLOR, ROBERT L</td><td>21</td><td>168,677</td><td>1000</td><td>15,099</td><td>1,551.00</td></tr> <tr><td>2016</td><td>2016-660024844</td><td>TAYLOR, ROBERT L</td><td>21</td><td>164,453</td><td>1000</td><td>15,099</td><td>1,581.00</td></tr> <tr><td>2015</td><td>2015-660024844</td><td>TAYLOR, ROBERT L &amp; DOROTHY M</td><td>21</td><td>160,440</td><td>1000</td><td>15,100</td><td>1,525.00</td></tr> <tr><td>2014</td><td>2014-660024844</td><td>TAYLOR, ROBERT L &amp; DOROTHY M</td><td>21</td><td>163,189</td><td>1000</td><td>15,099</td><td>1,566.00</td></tr> <tr><td>2013</td><td>2013-660024844</td><td>TAYLOR, ROBERT L &amp; DOROTHY M</td><td>21</td><td>153,749</td><td>1000</td><td>15,099</td><td>1,548.00</td></tr> </tbody> </table>										Tax Year	Statement Number	Billed Owner	Tax Area	Total Value	Exemptions	Taxable Value	Billed Tax	2025	2025-660024844	TAYLOR, ROBERT L	21	258,509	1000	15,099	1,666.00	2024	2024-660024844	TAYLOR, ROBERT L	21	270,697	1000	15,100	1,562.00	2023	2023-660024844	TAYLOR, ROBERT L	21	188,154	1000	15,099	1,549.00	2022	2022-660024844	TAYLOR, ROBERT L	21	190,226	1000	15,100	1,564.00	2021	2021-660024844	TAYLOR, ROBERT L	21	175,254	1000	15,099	1,499.00	2020	2020-660024844	TAYLOR, ROBERT L	21	174,142	1000	15,100	1,549.00	2019	2019-660024844	TAYLOR, ROBERT L	21	165,713	1000	15,099	1,564.00	2018	2018-660024844	TAYLOR, ROBERT L	21	170,091	1000	15,099	1,561.00	2017	2017-660024844	TAYLOR, ROBERT L	21	168,677	1000	15,099	1,551.00	2016	2016-660024844	TAYLOR, ROBERT L	21	164,453	1000	15,099	1,581.00	2015	2015-660024844	TAYLOR, ROBERT L & DOROTHY M	21	160,440	1000	15,100	1,525.00	2014	2014-660024844	TAYLOR, ROBERT L & DOROTHY M	21	163,189	1000	15,099	1,566.00	2013	2013-660024844	TAYLOR, ROBERT L & DOROTHY M	21	153,749	1000	15,099	1,548.00
Tax Year	Statement Number	Billed Owner	Tax Area	Total Value	Exemptions	Taxable Value	Billed Tax																																																																																																																		
2025	2025-660024844	TAYLOR, ROBERT L	21	258,509	1000	15,099	1,666.00																																																																																																																		
2024	2024-660024844	TAYLOR, ROBERT L	21	270,697	1000	15,100	1,562.00																																																																																																																		
2023	2023-660024844	TAYLOR, ROBERT L	21	188,154	1000	15,099	1,549.00																																																																																																																		
2022	2022-660024844	TAYLOR, ROBERT L	21	190,226	1000	15,100	1,564.00																																																																																																																		
2021	2021-660024844	TAYLOR, ROBERT L	21	175,254	1000	15,099	1,499.00																																																																																																																		
2020	2020-660024844	TAYLOR, ROBERT L	21	174,142	1000	15,100	1,549.00																																																																																																																		
2019	2019-660024844	TAYLOR, ROBERT L	21	165,713	1000	15,099	1,564.00																																																																																																																		
2018	2018-660024844	TAYLOR, ROBERT L	21	170,091	1000	15,099	1,561.00																																																																																																																		
2017	2017-660024844	TAYLOR, ROBERT L	21	168,677	1000	15,099	1,551.00																																																																																																																		
2016	2016-660024844	TAYLOR, ROBERT L	21	164,453	1000	15,099	1,581.00																																																																																																																		
2015	2015-660024844	TAYLOR, ROBERT L & DOROTHY M	21	160,440	1000	15,100	1,525.00																																																																																																																		
2014	2014-660024844	TAYLOR, ROBERT L & DOROTHY M	21	163,189	1000	15,099	1,566.00																																																																																																																		
2013	2013-660024844	TAYLOR, ROBERT L & DOROTHY M	21	153,749	1000	15,099	1,548.00																																																																																																																		



# Rogers

## Assessment Property Record Card for Tax Year 2026

Data provided by LISA DELOZIER County Assessor

Date 04/16/2026  
 Time 23:10:09  
 Page 2

Lot Data		Square-Foot - NBHD 1121 #1	
Lot Size			
Lot Count			
Units Buildable	1		
Non-Ag Acres	1.0615		
Topography			
Street Access			
Utilities			
Amenities	LAND QUALITY		0
	1/2 LOT		0
Method	Square-Foot		
Base Lot Value	46,237.00 x 1.94 = 89,797		
Factor Value			
Adjustments	1.0000		
Lot Value	89,797		

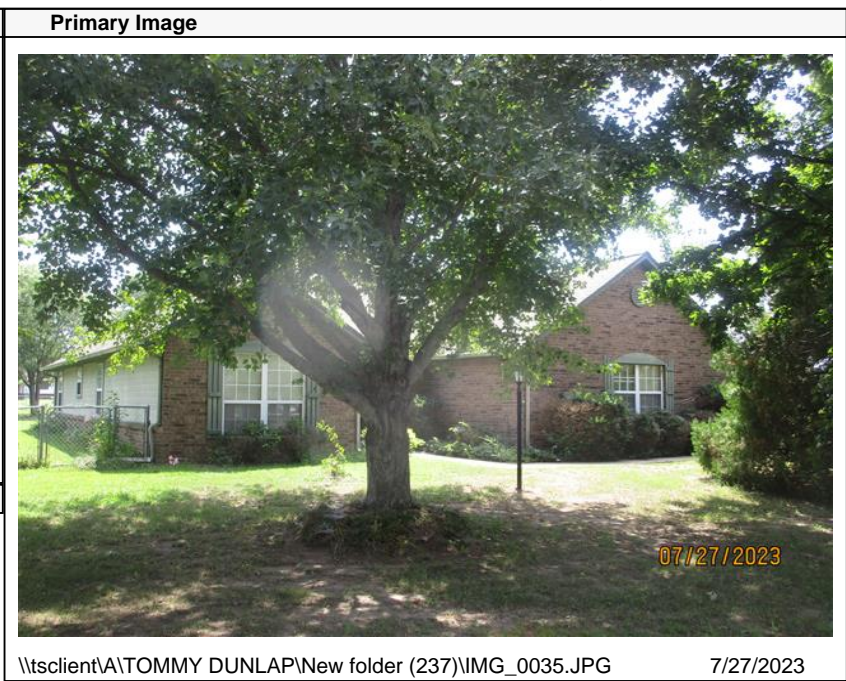

\\tsclient\A\TOMMY DUNLAP\New folder (237)\IMG\_0035.JPG 7/27/2023

Residential Data	
Type	1 Single Family Residence
Condition	3 - Average
Quality	3 - Average
Architecture	
Style	100% One Story
Exterior Wall	40% Veneer, Masonry 60% Frame, Siding, Wood
Base/Total Area	1,656 / 1,656
Style	100% One Story
HVAC	100% Warmed & Cooled Air
Roof Cover	1 Composition Shingle
Area on Slab	1,656
Fixture/RghIn	11 /
Bed/F/H Bath	3 / 2.0 /
Basement Area	
Garage Type	528 Attached Garage - Unfinished 2 Stalls
Remodel	
Year/Eff Age	1994 / 24

### GRM Approach

GRM Code	
Gross Rent	0.00
Indicated Value	

### Multiple Regression

MRA Code	1 Test
Adjusted R	0.8445
Indicated Value	210,319 127.00 Per SqFt

### Direct Comparables

Selection Model	A Adam Test
Adjustment Model	1 2022 Residential
Comparables	4
Indicated Value	242,990 Per SqFt

### Value Reconciliation

Selected Approach	Cost Approach
Improvements	175,024
Lot Value	89,797
Indicated Value	264,821 159.92 Per SqFt
Agland Value	
Site Improvements	
Total Value	264,821 159.92 Total Value Per SqFt

### Cost Approach Manual : 01/2025

Base Cost	106.60	Total Misc Impr	+	12,652
Roofing Adj	+ 4.88	Garage Cost	+	16,627
Subfloor Adj	+ -2.31	Total RCN	=	246,513
Heat/Cool Adj	+ 12.64	Depreciation ( 29%)	-	71,489
Plumbing Adj	+ 9.37	Lump Sums	+	0
Basement Adj	+ 0.00	RCNLD	=	175,024
Adj Base Cost	= 131.18	Lot Value	+	89,797
Total Area	x 1,656	Indicated Value	=	264,821
Adjusted Cost	= 217,234	Value Per SqFt		159.92

### Miscellaneous Improvements

Code	Description	Sketch ID	Size	Year	Units	Unit Cost	Depr	Value
FPR1	FIREPLACE - RESIDENTIAL 1 STORY	0		1	1	5,615.40		5,615
SHLT	STORM SHELTER	0		1	2015	0.00		
PRCH	SLAB PORCH - COVERED	60969	6x6		36	26.82		966
EPKS	ENCLOSED PORCH - KNEEWALL SCREEN	60970	209		209	29.05		6,071



# Rogers

## Assessment Property Record Card for Tax Year 2026

Data provided by LISA DELOZIER County Assessor

Date 04/16/2026  
 Time 23:10:09  
 Page 3

Sketch Image

660024844

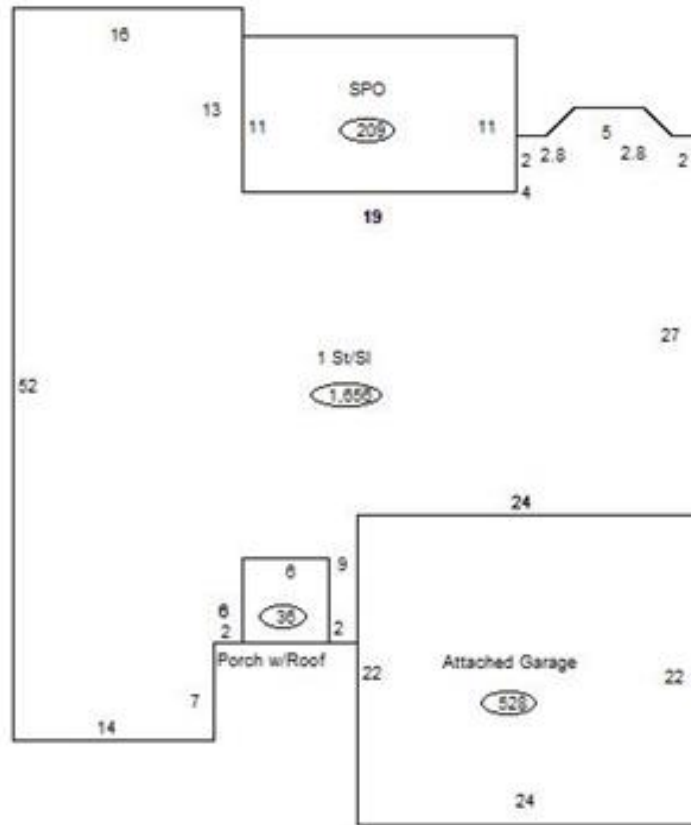

### Sketch Vector Information

Sequence	Code	Type	Built Over	Scale	Section Label	Base Area	Multiplier	Total Area
1	R	1	Slab	13	1 St/Sl	1,656	1.000	1,656
2	G	1		13	Attached Garage	528	1.000	528
3	M	PRCH		13	SLBC	36	1.000	36
4	M	EPKS		13	Screen Porch	209	1.000	209
<b>Total Building Area</b>						1,656		1,656



# Rogers

## Assessment Property Record Card for Tax Year 2026

Data provided by LISA DELOZIER County Assessor

Date 04/16/2026  
Time 23:10:09  
Page 4

660024844

### Outbuildings/Site Improvements

Building Image	Code	Description	Dimensions	Floor	Roofing	Total Units
	STF STG FAIR		0x0x0			
	Qual 2	Cond	Year	Eff Age		
<b>Valuation Summary</b>		<b>Modifier Total</b>	<b>RCN</b>	<b>Depr (100% Phys/ % Func)</b>	<b>RCNLD</b>	
Base Cost (4.68 x )						