



# Rogers

## Assessment Property Record Card for Tax Year 2026

Data provided by LISA DELOZIER County Assessor

Date 04/17/2026  
Time 00:47:57  
Page 1

Assessment Data					Primary Image																																																																																																																				
<b>Account</b> 660024914 <b>Parcel ID</b> 000000-00-0-00765-002-0011 <b>Cadastral ID</b> 29-21-16-05980 <b>Property Type</b> REAL - Real Property <b>Property Class</b> RRP VI Area 1 <b>Tax Area</b> 21 - CLAREMORE RURAL/VERD FIR <b>Name ID</b> 266246 BUECHLER, RUSSELL E & BEVERLY  JEAN MARTIN BUECHLER 23797 S CEDAR ST CLAREMORE OK 74019-0000  <b>Parcel Location</b> <b>Situs</b> 23797 S CEDAR ST <b>Subdivision</b> SOUTHLAND ACRES <b>Lot/Block</b> 0011 / 0002 <b>Parcel Size</b> 1 - Lots <b>Sec/Twn/Rng</b> 29 / 21 / 16 / 5 <b>Neighborhood</b> 1121 - R-V01-SW CLAREMORE <b>School District</b> S001 - CLAREMORE SCHOOLS																																																																																																																									
<b>Legal Description</b> Lot/Long: 36.26579357 -95.62356238																																																																																																																									
<b>Building Permits</b>					\\tsclient\A\TOMMY DUNLAP\New folder (235)\IMG_0050.JPG 7/25/2023																																																																																																																				
<b>Exemptions</b>					<b>Sale History</b>																																																																																																																				
<table border="1"> <thead> <tr> <th>Code</th> <th>Type</th> <th>Active</th> <th>Maximum</th> <th>Exemption</th> </tr> </thead> <tbody> <tr> <td>H</td> <td>Homestead</td> <td>Yes</td> <td>1,000</td> <td>1,000</td> </tr> </tbody> </table>					Code	Type	Active	Maximum	Exemption	H	Homestead	Yes	1,000	1,000	<table border="1"> <thead> <tr> <th>Number</th> <th>Description</th> <th>Opened</th> <th>Closed</th> <th>Amount</th> </tr> </thead> <tbody> <tr> <td>1075/72</td> <td>MARTIN, RUBY</td> <td>07/28/1997</td> <td></td> <td>0 No</td> </tr> </tbody> </table>					Number	Description	Opened	Closed	Amount	1075/72	MARTIN, RUBY	07/28/1997		0 No																																																																																												
Code	Type	Active	Maximum	Exemption																																																																																																																					
H	Homestead	Yes	1,000	1,000																																																																																																																					
Number	Description	Opened	Closed	Amount																																																																																																																					
1075/72	MARTIN, RUBY	07/28/1997		0 No																																																																																																																					
<b>Parcel Valuation</b>					<table border="1"> <thead> <tr> <th>Source</th> <th>REAL</th> <th>Fair Cash</th> <th>Capped</th> <th>Asmnt Level</th> <th>Assessed</th> <th>Levy Rate</th> <th>109.172</th> <th>Current Tax</th> </tr> </thead> <tbody> <tr> <td>Remove Cap</td> <td>1998</td> <td>Land Value 44,384</td> <td>25,314</td> <td>11%</td> <td>2,785</td> <td>Assessed</td> <td>8,170</td> <td>891.93</td> </tr> <tr> <td>Year Frozen</td> <td>2025</td> <td>Improvements 85,824</td> <td>48,949</td> <td></td> <td>5,385</td> <td>Penalty</td> <td>0</td> <td></td> </tr> <tr> <td>Uncapped Value</td> <td>0</td> <td>Mobile Home 0</td> <td>0</td> <td></td> <td>0</td> <td>Exemption</td> <td>1,000</td> <td>-92.00</td> </tr> <tr> <td>TIF Project ID</td> <td>0</td> <td>Total Value 130,208</td> <td>74,263</td> <td></td> <td>8,170</td> <td>Total Taxable</td> <td>7,170</td> <td>800.00</td> </tr> </tbody> </table>					Source	REAL	Fair Cash	Capped	Asmnt Level	Assessed	Levy Rate	109.172	Current Tax	Remove Cap	1998	Land Value 44,384	25,314	11%	2,785	Assessed	8,170	891.93	Year Frozen	2025	Improvements 85,824	48,949		5,385	Penalty	0		Uncapped Value	0	Mobile Home 0	0		0	Exemption	1,000	-92.00	TIF Project ID	0	Total Value 130,208	74,263		8,170	Total Taxable	7,170	800.00																																																																			
Source	REAL	Fair Cash	Capped	Asmnt Level	Assessed	Levy Rate	109.172	Current Tax																																																																																																																	
Remove Cap	1998	Land Value 44,384	25,314	11%	2,785	Assessed	8,170	891.93																																																																																																																	
Year Frozen	2025	Improvements 85,824	48,949		5,385	Penalty	0																																																																																																																		
Uncapped Value	0	Mobile Home 0	0		0	Exemption	1,000	-92.00																																																																																																																	
TIF Project ID	0	Total Value 130,208	74,263		8,170	Total Taxable	7,170	800.00																																																																																																																	
<b>Assessment History</b>					<table border="1"> <thead> <tr> <th>Tax Year</th> <th>Statement Number</th> <th>Billed Owner</th> <th>Tax Area</th> <th>Total Value</th> <th>Exemptions</th> <th>Taxable Value</th> <th>Billed Tax</th> </tr> </thead> <tbody> <tr><td>2025</td><td>2025-660024914</td><td>BUECHLER, RUSSELL E &amp; BEVERLY</td><td>21</td><td>121,348</td><td>1000</td><td>7,169</td><td>800.00</td></tr> <tr><td>2024</td><td>2024-660024914</td><td>BUECHLER, RUSSELL E &amp; BEVERLY</td><td>21</td><td>124,998</td><td>1000</td><td>6,931</td><td>723.00</td></tr> <tr><td>2023</td><td>2023-660024914</td><td>BUECHLER, RUSSELL E &amp; BEVERLY</td><td>21</td><td>87,446</td><td>1000</td><td>6,700</td><td>693.00</td></tr> <tr><td>2022</td><td>2022-660024914</td><td>BUECHLER, RUSSELL E &amp; BEVERLY</td><td>21</td><td>88,554</td><td>1000</td><td>6,475</td><td>676.00</td></tr> <tr><td>2021</td><td>2021-660024914</td><td>BUECHLER, RUSSELL E &amp; BEVERLY</td><td>21</td><td>92,057</td><td>1000</td><td>6,258</td><td>628.00</td></tr> <tr><td>2020</td><td>2020-660024914</td><td>BUECHLER, RUSSELL E &amp; BEVERLY</td><td>21</td><td>92,568</td><td>1000</td><td>6,047</td><td>627.00</td></tr> <tr><td>2019</td><td>2019-660024914</td><td>BUECHLER, RUSSELL E &amp; BEVERLY</td><td>21</td><td>89,634</td><td>1000</td><td>5,842</td><td>611.00</td></tr> <tr><td>2018</td><td>2018-660024914</td><td>BUECHLER, RUSSELL E &amp; BEVERLY</td><td>21</td><td>94,504</td><td>1000</td><td>5,642</td><td>589.00</td></tr> <tr><td>2017</td><td>2017-660024914</td><td>BUECHLER, RUSSELL E &amp; BEVERLY</td><td>21</td><td>93,416</td><td>1000</td><td>5,450</td><td>566.00</td></tr> <tr><td>2016</td><td>2016-660024914</td><td>BUECHLER, RUSSELL E &amp; BEVERLY</td><td>21</td><td>91,554</td><td>1000</td><td>5,262</td><td>558.00</td></tr> <tr><td>2015</td><td>2015-660024914</td><td>BUECHLER, RUSSELL E &amp; BEVERLY</td><td>21</td><td>87,821</td><td>1000</td><td>5,079</td><td>520.00</td></tr> <tr><td>2014</td><td>2014-660024914</td><td>BUECHLER, RUSSELL E &amp; BEVERLY</td><td>21</td><td>90,408</td><td>1000</td><td>4,902</td><td>516.00</td></tr> <tr><td>2013</td><td>2013-660024914</td><td>BUECHLER, RUSSELL E &amp; BEVERLY</td><td>21</td><td>87,307</td><td>1000</td><td>4,730</td><td>492.00</td></tr> </tbody> </table>					Tax Year	Statement Number	Billed Owner	Tax Area	Total Value	Exemptions	Taxable Value	Billed Tax	2025	2025-660024914	BUECHLER, RUSSELL E & BEVERLY	21	121,348	1000	7,169	800.00	2024	2024-660024914	BUECHLER, RUSSELL E & BEVERLY	21	124,998	1000	6,931	723.00	2023	2023-660024914	BUECHLER, RUSSELL E & BEVERLY	21	87,446	1000	6,700	693.00	2022	2022-660024914	BUECHLER, RUSSELL E & BEVERLY	21	88,554	1000	6,475	676.00	2021	2021-660024914	BUECHLER, RUSSELL E & BEVERLY	21	92,057	1000	6,258	628.00	2020	2020-660024914	BUECHLER, RUSSELL E & BEVERLY	21	92,568	1000	6,047	627.00	2019	2019-660024914	BUECHLER, RUSSELL E & BEVERLY	21	89,634	1000	5,842	611.00	2018	2018-660024914	BUECHLER, RUSSELL E & BEVERLY	21	94,504	1000	5,642	589.00	2017	2017-660024914	BUECHLER, RUSSELL E & BEVERLY	21	93,416	1000	5,450	566.00	2016	2016-660024914	BUECHLER, RUSSELL E & BEVERLY	21	91,554	1000	5,262	558.00	2015	2015-660024914	BUECHLER, RUSSELL E & BEVERLY	21	87,821	1000	5,079	520.00	2014	2014-660024914	BUECHLER, RUSSELL E & BEVERLY	21	90,408	1000	4,902	516.00	2013	2013-660024914	BUECHLER, RUSSELL E & BEVERLY	21	87,307	1000	4,730	492.00
Tax Year	Statement Number	Billed Owner	Tax Area	Total Value	Exemptions	Taxable Value	Billed Tax																																																																																																																		
2025	2025-660024914	BUECHLER, RUSSELL E & BEVERLY	21	121,348	1000	7,169	800.00																																																																																																																		
2024	2024-660024914	BUECHLER, RUSSELL E & BEVERLY	21	124,998	1000	6,931	723.00																																																																																																																		
2023	2023-660024914	BUECHLER, RUSSELL E & BEVERLY	21	87,446	1000	6,700	693.00																																																																																																																		
2022	2022-660024914	BUECHLER, RUSSELL E & BEVERLY	21	88,554	1000	6,475	676.00																																																																																																																		
2021	2021-660024914	BUECHLER, RUSSELL E & BEVERLY	21	92,057	1000	6,258	628.00																																																																																																																		
2020	2020-660024914	BUECHLER, RUSSELL E & BEVERLY	21	92,568	1000	6,047	627.00																																																																																																																		
2019	2019-660024914	BUECHLER, RUSSELL E & BEVERLY	21	89,634	1000	5,842	611.00																																																																																																																		
2018	2018-660024914	BUECHLER, RUSSELL E & BEVERLY	21	94,504	1000	5,642	589.00																																																																																																																		
2017	2017-660024914	BUECHLER, RUSSELL E & BEVERLY	21	93,416	1000	5,450	566.00																																																																																																																		
2016	2016-660024914	BUECHLER, RUSSELL E & BEVERLY	21	91,554	1000	5,262	558.00																																																																																																																		
2015	2015-660024914	BUECHLER, RUSSELL E & BEVERLY	21	87,821	1000	5,079	520.00																																																																																																																		
2014	2014-660024914	BUECHLER, RUSSELL E & BEVERLY	21	90,408	1000	4,902	516.00																																																																																																																		
2013	2013-660024914	BUECHLER, RUSSELL E & BEVERLY	21	87,307	1000	4,730	492.00																																																																																																																		



# Rogers

## Assessment Property Record Card for Tax Year 2026

Data provided by LISA DELOZIER County Assessor

Date 04/17/2026  
 Time 00:47:57  
 Page 2

Lot Data		Square-Foot - NBHD 1121 #1
Lot Size		
Lot Count		
Units Buildable	1	
Non-Ag Acres	0.5095	
Topography		
Street Access		
Utilities		
Amenities	LAND QUALITY	0
	1/2 LOT	0
Method	Square-Foot	
Base Lot Value	22,192.00 x 2.00 = 44,384	
Factor Value		
Adjustments	1.0000	
Lot Value	44,384	



\\tsclient\A\TOMMY DUNLAP\New folder (235)\IMG\_0050.JPG 7/25/2023

Residential Data	
Type	1 Single Family Residence
Condition	3 - Average
Quality	2 - Fair
Architecture	
Style	100% One Story
Exterior Wall	100% Frame, Siding, Wood
Base/Total Area	1,320 / 1,320
Style	100% One Story
HVAC	100% Wall Furnace
Roof Cover	4 Metal, Preformed
Area on Slab	1,320
Fixture/RghIn	8 /
Bed/F/H Bath	3 / 2.0 /
Basement Area	
Garage Type	
Remodel	
Year/Eff Age	1966 / 45

GRM Approach	
GRM Code	
Gross Rent	0.00
Indicated Value	

Multiple Regression			
MRA Code	1	Test	
Adusted R	0.8445		
Indicated Value	102,972	78.01	Per SqFt

Direct Comparables			
Selection Model	A	Adam Test	
Adjustment Model	1	2022 Residential	
Comparables	2		
Indicated Value	133,980		Per SqFt

Cost Approach				Manual : 01/2025	
Base Cost	86.62	Total Misc Impr	+	1,556	
Roofing Adj	+ 4.60	Garage Cost	+		
Subfloor Adj	+ 0.00	Total RCN	=	132,342	
Heat/Cool Adj	+ 0.76	Depreciation ( 55%)	-	72,788	
Plumbing Adj	+ 7.10	Lump Sums	+	2,399	
Basement Adj	+ 0.00	RCNLD	=	61,953	
Adj Base Cost	= 99.08	Lot Value	+	44,384	
Total Area	x 1,320	Indicated Value	=	106,337	
Adjusted Cost	= 130,786	Value Per SqFt		80.56	

Value Reconciliation			
Selected Approach	Cost Approach		
Improvements	61,953		
Lot Value	44,384		
Indicated Value	106,337	80.56	Per SqFt
Agland Value			
Site Improvements	23,871		
Total Value	130,208	98.64	Total Value Per SqFt

Miscellaneous Improvements								
Code	Description	Sketch ID	Size	Year	Units	Unit Cost	Depr	Value
CPDT	CARPORT - DETACHED	61209	120		120	10.13		1,216
PRCH	SLAB PORCH - COVERED	61210	4x4		16	21.24		340
WODO	WOOD DECK - OPEN	61211	12x11		132	22.72	20%	2,399



# Rogers

## Assessment Property Record Card for Tax Year 2026

Data provided by LISA DELOZIER County Assessor

Date 04/17/2026  
 Time 00:47:57  
 Page 3

### Sketch Image

660024914

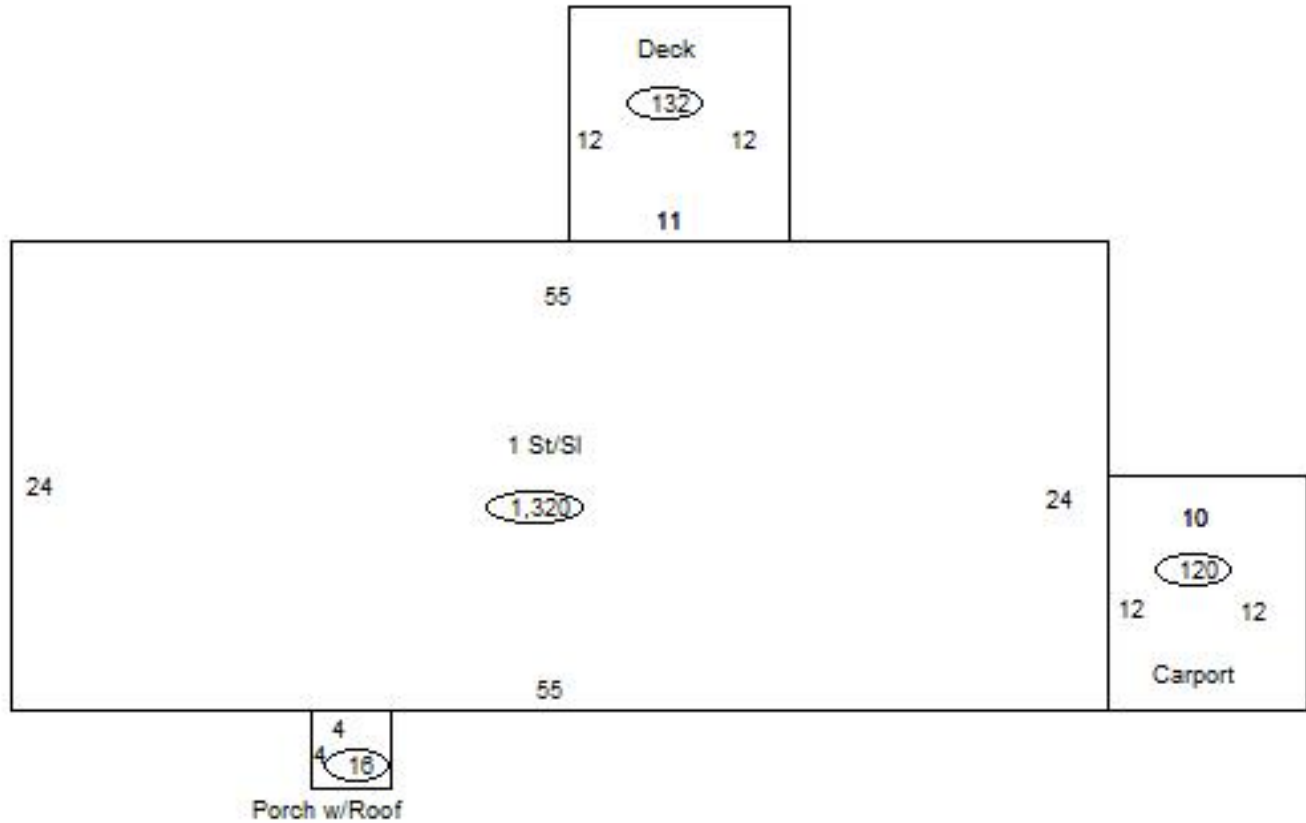

### Sketch Vector Information

Sequence	Code	Type	Built Over	Scale	Section Label	Base Area	Multiplier	Total Area
1	R	1	Slab	13	1 St/SI	1,320	1.000	1,320
2	M	CPDT		13	Carport	120	1.000	120
3	M	PRCH		13	SLBC	16	1.000	16
4	M	WODO		13	WODO	132	1.000	132
<b>Total Building Area</b>						1,320		1,320



# Rogers

## Assessment Property Record Card for Tax Year 2026

Data provided by LISA DELOZIER County Assessor

Date 04/17/2026  
 Time 00:47:57  
 Page 4

660024914

### Outbuildings/Site Improvements

Building Image	Code	Description	Dimensions	Floor	Roofing	Total Units
	UTIL	SHOP BUILDING	0x0x0			960
	Qual 3	Cond 3	Year	Eff Age		
	<b>Valuation Summary</b> Base Cost (32.53 x 960) 31,229		<b>Modifier Total</b>	<b>RCN</b> 31,229	<b>Depr (25% Phys/ % Func)</b> 7,807	<b>RCNLD</b> 23,422
	STF	STG FAIR	0x0x0			160
	Qual 2	Cond 3	Year	Eff Age		
	<b>Valuation Summary</b> Base Cost (4.68 x 160) 749		<b>Modifier Total</b>	<b>RCN</b> 749	<b>Depr (40% Phys/ % Func)</b> 300	<b>RCNLD</b> 449