



# Rogers

## Assessment Property Record Card for Tax Year 2026

Data provided by LISA DELOZIER County Assessor

Date 04/18/2026  
Time 07:58:03  
Page 1

Assessment Data					Primary Image																																																																																																																				
<b>Account</b> 660024972 <b>Parcel ID</b> 000000-00-0-00780-001-0005 <b>Cadastral ID</b> 29-22-16-01450 <b>Property Type</b> REAL - Real Property <b>Property Class</b> RRP VI Area 1 <b>Tax Area</b> 10 - OOLOGAH RURAL/NW FIRE <b>Name ID</b> 313978 ATZBACH, TONY E & CHARLAINE M  17222 STONEHEDGE CT CLAREMORE OK 74017-0000  <b>Parcel Location</b> <b>Situs</b> 17222 STONEHEDGE CT <b>Subdivision</b> STONE HEDGE <b>Lot/Block</b> 0005 / 0001 <b>Parcel Size</b> 1 - Lots <b>Sec/Twn/Rng</b> 29 / 22 / 16 / 5 <b>Neighborhood</b> 1148 - R-V01-NW OOLOGAH <b>School District</b> S004 - OOLOGAH SCHOOLS																																																																																																																									
<b>Legal Description</b> Lot/Long: 36.36144395 -95.61646992																																																																																																																									
<b>Legal Description</b> LOT 5 BLOCK 1 STONE HEDGE					<b>Building Permits</b> <table border="1"> <thead> <tr> <th>Number</th> <th>Description</th> <th>Opened</th> <th>Closed</th> <th>Amount</th> </tr> </thead> <tbody> <tr> <td></td> <td></td> <td></td> <td></td> <td></td> </tr> </tbody> </table>					Number	Description	Opened	Closed	Amount																																																																																																											
Number	Description	Opened	Closed	Amount																																																																																																																					
<b>Exemptions</b> <table border="1"> <thead> <tr> <th>Code</th> <th>Type</th> <th>Active</th> <th>Maximum</th> <th>Exemption</th> </tr> </thead> <tbody> <tr> <td>H</td> <td>Homestead</td> <td>Yes</td> <td>1,000</td> <td>1,000</td> </tr> </tbody> </table>					Code	Type	Active	Maximum	Exemption	H	Homestead	Yes	1,000	1,000	<b>Sale History</b> <table border="1"> <thead> <tr> <th>Bk/Pg</th> <th>Grantor</th> <th>Date</th> <th>Price</th> <th>Code</th> </tr> </thead> <tbody> <tr> <td>2441/146</td> <td>ADAMS, FRANK E &amp;</td> <td>11/26/2014</td> <td>200,000</td> <td>YES</td> </tr> <tr> <td>2209/273</td> <td>ADAMS, JOHN T &amp;</td> <td>11/21/2011</td> <td>214,500</td> <td>YES</td> </tr> <tr> <td>1831/604</td> <td>DEUTSCHE BANK NATL TRST CO</td> <td>12/12/2006</td> <td>193,500</td> <td>YES</td> </tr> <tr> <td>1700/940</td> <td>BREEN, JON D &amp; TAMA J</td> <td>07/25/2005</td> <td>0</td> <td>10</td> </tr> <tr> <td>1088/603</td> <td>WARREN, GARY L &amp;</td> <td>11/14/1997</td> <td>165,000</td> <td>Yes</td> </tr> <tr> <td>858/229</td> <td></td> <td></td> <td>0</td> <td>No</td> </tr> </tbody> </table>					Bk/Pg	Grantor	Date	Price	Code	2441/146	ADAMS, FRANK E &	11/26/2014	200,000	YES	2209/273	ADAMS, JOHN T &	11/21/2011	214,500	YES	1831/604	DEUTSCHE BANK NATL TRST CO	12/12/2006	193,500	YES	1700/940	BREEN, JON D & TAMA J	07/25/2005	0	10	1088/603	WARREN, GARY L &	11/14/1997	165,000	Yes	858/229			0	No																																																																			
Code	Type	Active	Maximum	Exemption																																																																																																																					
H	Homestead	Yes	1,000	1,000																																																																																																																					
Bk/Pg	Grantor	Date	Price	Code																																																																																																																					
2441/146	ADAMS, FRANK E &	11/26/2014	200,000	YES																																																																																																																					
2209/273	ADAMS, JOHN T &	11/21/2011	214,500	YES																																																																																																																					
1831/604	DEUTSCHE BANK NATL TRST CO	12/12/2006	193,500	YES																																																																																																																					
1700/940	BREEN, JON D & TAMA J	07/25/2005	0	10																																																																																																																					
1088/603	WARREN, GARY L &	11/14/1997	165,000	Yes																																																																																																																					
858/229			0	No																																																																																																																					
<b>Parcel Valuation</b> <table border="1"> <thead> <tr> <th>Source</th> <th>REAL</th> <th>Fair Cash</th> <th>Capped</th> <th>Asmnt Level</th> <th>Assessed</th> <th>Levy Rate</th> <th>108.182</th> <th>Current Tax</th> </tr> </thead> <tbody> <tr> <td>Remove Cap</td> <td>2015</td> <td>Land Value 70,094</td> <td>40,570</td> <td>11%</td> <td>4,463</td> <td>Assessed</td> <td>27,378</td> <td>2,961.79</td> </tr> <tr> <td>Year Frozen</td> <td>0</td> <td>Improvements 227,993</td> <td>208,322</td> <td></td> <td>22,915</td> <td>Penalty</td> <td>0</td> <td></td> </tr> <tr> <td>Uncapped Value</td> <td>0</td> <td>Mobile Home 0</td> <td>0</td> <td></td> <td>0</td> <td>Exemption</td> <td>1,000</td> <td>-94.00</td> </tr> <tr> <td>TIF Project ID</td> <td>0</td> <td>Total Value 298,087</td> <td>248,892</td> <td></td> <td>27,378</td> <td>Total Taxable</td> <td>26,378</td> <td>2,868.00</td> </tr> </tbody> </table>										Source	REAL	Fair Cash	Capped	Asmnt Level	Assessed	Levy Rate	108.182	Current Tax	Remove Cap	2015	Land Value 70,094	40,570	11%	4,463	Assessed	27,378	2,961.79	Year Frozen	0	Improvements 227,993	208,322		22,915	Penalty	0		Uncapped Value	0	Mobile Home 0	0		0	Exemption	1,000	-94.00	TIF Project ID	0	Total Value 298,087	248,892		27,378	Total Taxable	26,378	2,868.00																																																																			
Source	REAL	Fair Cash	Capped	Asmnt Level	Assessed	Levy Rate	108.182	Current Tax																																																																																																																	
Remove Cap	2015	Land Value 70,094	40,570	11%	4,463	Assessed	27,378	2,961.79																																																																																																																	
Year Frozen	0	Improvements 227,993	208,322		22,915	Penalty	0																																																																																																																		
Uncapped Value	0	Mobile Home 0	0		0	Exemption	1,000	-94.00																																																																																																																	
TIF Project ID	0	Total Value 298,087	248,892		27,378	Total Taxable	26,378	2,868.00																																																																																																																	
<b>Assessment History</b> <table border="1"> <thead> <tr> <th>Tax Year</th> <th>Statement Number</th> <th>Billed Owner</th> <th>Tax Area</th> <th>Total Value</th> <th>Exemptions</th> <th>Taxable Value</th> <th>Billed Tax</th> </tr> </thead> <tbody> <tr><td>2025</td><td>2025-660024972</td><td>ATZBACH, TONY E &amp; CHARLAINE M</td><td>10</td><td>290,436</td><td>1000</td><td>25,581</td><td>2,781.00</td></tr> <tr><td>2024</td><td>2024-660024972</td><td>ATZBACH, TONY E &amp; CHARLAINE M</td><td>10</td><td>304,189</td><td>1000</td><td>24,807</td><td>2,612.00</td></tr> <tr><td>2023</td><td>2023-660024972</td><td>ATZBACH, TONY E &amp; CHARLAINE M</td><td>10</td><td>255,176</td><td>1000</td><td>24,055</td><td>2,515.00</td></tr> <tr><td>2022</td><td>2022-660024972</td><td>ATZBACH, TONY E &amp; CHARLAINE M</td><td>10</td><td>259,101</td><td>1000</td><td>23,325</td><td>2,428.00</td></tr> <tr><td>2021</td><td>2021-660024972</td><td>ATZBACH, TONY E &amp; CHARLAINE M</td><td>10</td><td>245,930</td><td>1000</td><td>22,617</td><td>2,371.00</td></tr> <tr><td>2020</td><td>2020-660024972</td><td>ATZBACH, TONY E &amp; CHARLAINE M</td><td>10</td><td>244,916</td><td>1000</td><td>21,929</td><td>2,334.00</td></tr> <tr><td>2019</td><td>2019-660024972</td><td>ATZBACH, TONY E &amp; CHARLAINE M</td><td>10</td><td>202,374</td><td>1000</td><td>21,261</td><td>2,220.00</td></tr> <tr><td>2018</td><td>2018-660024972</td><td>ATZBACH, TONY E &amp; CHARLAINE M</td><td>10</td><td>206,880</td><td>1000</td><td>21,757</td><td>2,351.00</td></tr> <tr><td>2017</td><td>2017-660024972</td><td>ATZBACH, TONY E &amp; CHARLAINE M</td><td>10</td><td>205,172</td><td>1000</td><td>21,569</td><td>2,465.00</td></tr> <tr><td>2016</td><td>2016-660024972</td><td>ATZBACH, TONY E &amp; CHARLAINE M</td><td>10</td><td>200,153</td><td>0</td><td>22,017</td><td>2,280.00</td></tr> <tr><td>2015</td><td>2015-660024972</td><td>ATZBACH, TONY E &amp; CHARLAINE M</td><td>10</td><td>201,518</td><td>0</td><td>22,167</td><td>2,172.00</td></tr> <tr><td>2014</td><td>2014-660024972</td><td>ADAMS, FRANK E &amp;</td><td>10</td><td>253,193</td><td>0</td><td>26,357</td><td>2,578.00</td></tr> <tr><td>2013</td><td>2013-660024972</td><td>ADAMS, FRANK E &amp;</td><td>10</td><td>242,224</td><td>0</td><td>25,102</td><td>2,375.00</td></tr> </tbody> </table>										Tax Year	Statement Number	Billed Owner	Tax Area	Total Value	Exemptions	Taxable Value	Billed Tax	2025	2025-660024972	ATZBACH, TONY E & CHARLAINE M	10	290,436	1000	25,581	2,781.00	2024	2024-660024972	ATZBACH, TONY E & CHARLAINE M	10	304,189	1000	24,807	2,612.00	2023	2023-660024972	ATZBACH, TONY E & CHARLAINE M	10	255,176	1000	24,055	2,515.00	2022	2022-660024972	ATZBACH, TONY E & CHARLAINE M	10	259,101	1000	23,325	2,428.00	2021	2021-660024972	ATZBACH, TONY E & CHARLAINE M	10	245,930	1000	22,617	2,371.00	2020	2020-660024972	ATZBACH, TONY E & CHARLAINE M	10	244,916	1000	21,929	2,334.00	2019	2019-660024972	ATZBACH, TONY E & CHARLAINE M	10	202,374	1000	21,261	2,220.00	2018	2018-660024972	ATZBACH, TONY E & CHARLAINE M	10	206,880	1000	21,757	2,351.00	2017	2017-660024972	ATZBACH, TONY E & CHARLAINE M	10	205,172	1000	21,569	2,465.00	2016	2016-660024972	ATZBACH, TONY E & CHARLAINE M	10	200,153	0	22,017	2,280.00	2015	2015-660024972	ATZBACH, TONY E & CHARLAINE M	10	201,518	0	22,167	2,172.00	2014	2014-660024972	ADAMS, FRANK E &	10	253,193	0	26,357	2,578.00	2013	2013-660024972	ADAMS, FRANK E &	10	242,224	0	25,102	2,375.00
Tax Year	Statement Number	Billed Owner	Tax Area	Total Value	Exemptions	Taxable Value	Billed Tax																																																																																																																		
2025	2025-660024972	ATZBACH, TONY E & CHARLAINE M	10	290,436	1000	25,581	2,781.00																																																																																																																		
2024	2024-660024972	ATZBACH, TONY E & CHARLAINE M	10	304,189	1000	24,807	2,612.00																																																																																																																		
2023	2023-660024972	ATZBACH, TONY E & CHARLAINE M	10	255,176	1000	24,055	2,515.00																																																																																																																		
2022	2022-660024972	ATZBACH, TONY E & CHARLAINE M	10	259,101	1000	23,325	2,428.00																																																																																																																		
2021	2021-660024972	ATZBACH, TONY E & CHARLAINE M	10	245,930	1000	22,617	2,371.00																																																																																																																		
2020	2020-660024972	ATZBACH, TONY E & CHARLAINE M	10	244,916	1000	21,929	2,334.00																																																																																																																		
2019	2019-660024972	ATZBACH, TONY E & CHARLAINE M	10	202,374	1000	21,261	2,220.00																																																																																																																		
2018	2018-660024972	ATZBACH, TONY E & CHARLAINE M	10	206,880	1000	21,757	2,351.00																																																																																																																		
2017	2017-660024972	ATZBACH, TONY E & CHARLAINE M	10	205,172	1000	21,569	2,465.00																																																																																																																		
2016	2016-660024972	ATZBACH, TONY E & CHARLAINE M	10	200,153	0	22,017	2,280.00																																																																																																																		
2015	2015-660024972	ATZBACH, TONY E & CHARLAINE M	10	201,518	0	22,167	2,172.00																																																																																																																		
2014	2014-660024972	ADAMS, FRANK E &	10	253,193	0	26,357	2,578.00																																																																																																																		
2013	2013-660024972	ADAMS, FRANK E &	10	242,224	0	25,102	2,375.00																																																																																																																		



# Rogers

## Assessment Property Record Card for Tax Year 2026

Data provided by LISA DELOZIER County Assessor

Date 04/18/2026  
 Time 07:58:03  
 Page 2

Lot Data	Square-Foot - NBHD 1148 #1	Primary Image
<b>Lot Size</b> <b>Lot Count</b> <b>Units Buildable</b> 1 <b>Non-Ag Acres</b> 1.1319 <b>Topography</b> <b>Street Access</b> <b>Utilities</b> <b>Amenities</b> LAND QUALITY 0 0 <b>Method</b> Square-Foot <b>Base Lot Value</b> 49,306.00 x 1.42 = 70,094 <b>Factor Value</b> <b>Adjustments</b> 1.0000 <b>Lot Value</b> 70,094		
<b>Residential Data</b> <b>Type</b> 1 Single Family Residence <b>Condition</b> 3 - Average <b>Quality</b> 3 - Average <b>Architecture</b> <b>Style</b> 100% 1 1/2 Story Finished <b>Exterior Wall</b> 30% Veneer, Stone 70% Frame, Siding, Vinyl <b>Base/Total Area</b> 2,149 / 3,382 <b>Style</b> 100% 1 1/2 Story Finished <b>HVAC</b> 100% Warmed & Cooled Air <b>Roof Cover</b> 1 Composition Shingle <b>Area on Slab</b> 2,149 <b>Fixture/RghIn</b> 14 / <b>Bed/F/H Bath</b> 4 / 3.0 / <b>Basement Area</b> <b>Garage Type</b> 1,275 Attached Garage - Unfinished <b>Remodel</b> <b>Year/Eff Age</b> 1986 / 30		

\\tsclient\T\LOGAN\LOGAN RESIDENTIAL VI\2023-2-6\IMG\_0005. 2/6/2023

GRM Approach	
<b>GRM Code</b>	
<b>Gross Rent</b>	0.00
<b>Indicated Value</b>	

Multiple Regression			
<b>MRA Code</b>	1	Test	
<b>Adusted R</b>	0.8445		
<b>Indicated Value</b>	395,538	116.95	Per SqFt

Direct Comparables			
<b>Selection Model</b>	A	Adam Test	
<b>Adjustment Model</b>	1	2022 Residential	
<b>Comparables</b>	3		
<b>Indicated Value</b>	408,630		Per SqFt

Value Reconciliation			
<b>Selected Approach</b>	Cost Approach		
<b>Improvements</b>	227,993		
<b>Lot Value</b>	70,094		
<b>Indicated Value</b>	298,087	88.14	Per SqFt
<b>Agland Value</b>			
<b>Site Improvements</b>			
<b>Total Value</b>	298,087	88.14	Total Value Per SqFt

Cost Approach				Manual : 01/2025			
<b>Base Cost</b>	86.86	<b>Total Misc Impr</b>	+ 22,962				
<b>Roofing Adj</b>	+ 2.93	<b>Garage Cost</b>	+ 37,982				
<b>Subfloor Adj</b>	+ -1.39	<b>Total RCN</b>	= 422,209				
<b>Heat/Cool Adj</b>	+ 12.64	<b>Depreciation ( 46%)</b>	- 194,216				
<b>Plumbing Adj</b>	+ 5.78	<b>Lump Sums</b>	+ 0				
<b>Basement Adj</b>	+ 0.00	<b>RCNLD</b>	= 227,993				
<b>Adj Base Cost</b>	= 106.82	<b>Lot Value</b>	+ 70,094				
<b>Total Area</b>	x 3,382	<b>Indicated Value</b>	= 298,087				
<b>Adjusted Cost</b>	= 361,265	<b>Value Per SqFt</b>	88.14				

Miscellaneous Improvements								
Code	Description	Sketch ID	Size	Year	Units	Unit Cost	Depr	Value
FPR1	FIREPLACE - RESIDENTIAL 1 STORY	0		1	1	5,615.40		5,615
PRCH	SLAB PORCH - COVERED	61364		252	252	26.14		6,587
PRCH	SLAB PORCH - COVERED	61366	35x12		420	25.62		10,760



# Rogers

## Assessment Property Record Card for Tax Year 2026

Data provided by LISA DELOZIER County Assessor

Date 04/18/2026

Time 07:58:03

Page 3

### Sketch Image

660024972

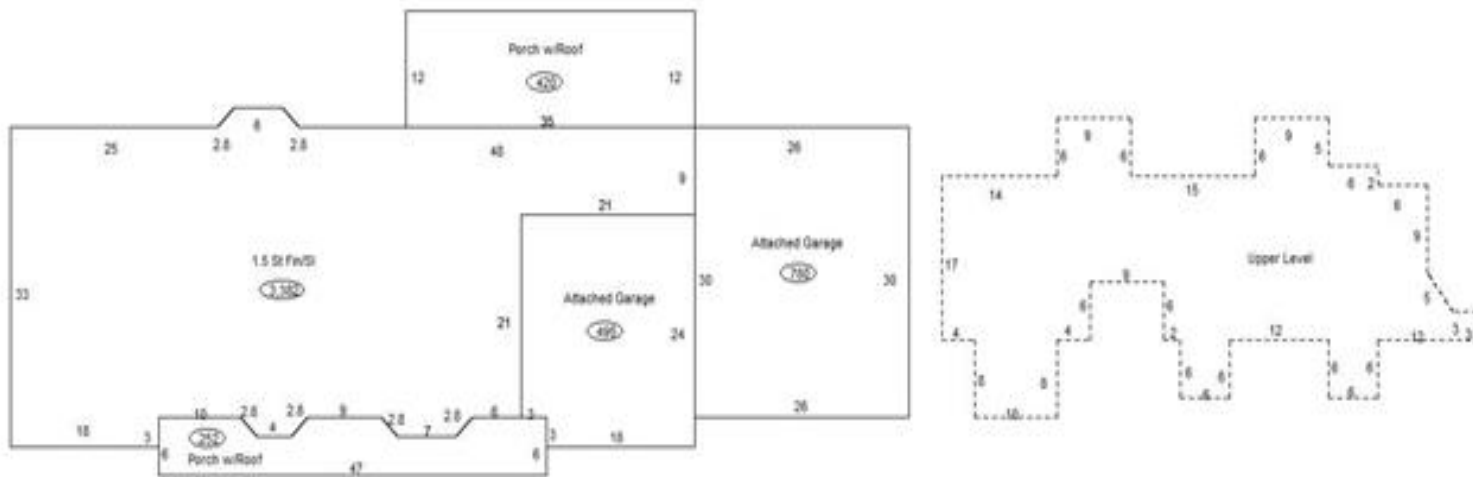

### Sketch Vector Information

Sequence	Code	Type	Built Over	Scale	Section Label	Base Area	Multiplier	Total Area
1	R	5	Slab	13	1.5 St Fin/SI	2,149	1.574	3,382
2	G	1		13	Attached Garage	495	1.000	495
3	M	PRCH		13	SLBC	252	1.000	252
4	G	1		13	Attached Garage	780	1.000	780
5	M	PRCH		13	SLBC	420	1.000	420
6	U	^UL	Overhang	13	Upper Level	1,233	1.000	1,233
<b>Total Building Area</b>						<b>2,149</b>		<b>3,382</b>