



Rogers

Assessment Property Record Card for Tax Year 2026

Data provided by LISA DELOZIER County Assessor

Date 04/16/2026
Time 21:50:46
Page 1

Assessment Data					Primary Image																																																																																																																				
Account 660024997 Parcel ID 000000-00-0-00780-003-0002 Cadastral ID 29-22-16-01700 Property Type REAL - Real Property Property Class RRP VI Area 1 Tax Area 10 - OOLOGAH RURAL/NW FIRE Name ID 315653 CLIFTON, DANA R 11840 LAUREL LN CLAREMORE OK 74017-0000 Parcel Location Situs 11840 LAUREL LN Subdivision STONE HEDGE Lot/Block 0002 / 0003 Parcel Size 1 - Lots Sec/Twn/Rng 29 / 22 / 16 / 5 Neighborhood 1148 - R-V01-NW OOLOGAH School District S004 - OOLOGAH SCHOOLS					 <p>660024997_001.JPG 7/10/2025</p>																																																																																																																				
Legal Description Lot/Long: 36.35847313 -95.61801018 LOT 2 BLOCK 3 STONE HEDGE																																																																																																																									
Exemptions <table border="1"> <thead> <tr> <th>Code</th> <th>Type</th> <th>Active</th> <th>Maximum</th> <th>Exemption</th> </tr> </thead> <tbody> <tr> <td>H</td> <td>Homestead</td> <td>Yes</td> <td>1,000</td> <td>1,000</td> </tr> </tbody> </table>					Code	Type	Active	Maximum	Exemption	H	Homestead	Yes	1,000	1,000	Building Permits <table border="1"> <thead> <tr> <th>Number</th> <th>Description</th> <th>Opened</th> <th>Closed</th> <th>Amount</th> </tr> </thead> <tbody> <tr> <td>R26 113</td> <td>NEW RMA 19X20</td> <td>03/2026</td> <td></td> <td>20,000</td> </tr> <tr> <td>R24 238</td> <td>NEW RMA 1080 SQ FT</td> <td>08/2024</td> <td>08/2025</td> <td>40,000</td> </tr> </tbody> </table>					Number	Description	Opened	Closed	Amount	R26 113	NEW RMA 19X20	03/2026		20,000	R24 238	NEW RMA 1080 SQ FT	08/2024	08/2025	40,000																																																																																							
Code	Type	Active	Maximum	Exemption																																																																																																																					
H	Homestead	Yes	1,000	1,000																																																																																																																					
Number	Description	Opened	Closed	Amount																																																																																																																					
R26 113	NEW RMA 19X20	03/2026		20,000																																																																																																																					
R24 238	NEW RMA 1080 SQ FT	08/2024	08/2025	40,000																																																																																																																					
Parcel Valuation <table border="1"> <thead> <tr> <th>Source</th> <th>REAL</th> <th>Fair Cash</th> <th>Capped</th> <th>Asmnt Level</th> <th>Assessed</th> <th>Levy Rate</th> <th>108.182</th> <th>Current Tax</th> </tr> </thead> <tbody> <tr> <td>Remove Cap</td> <td>2016</td> <td>Land Value 70,355</td> <td>39,207</td> <td>11%</td> <td>4,313</td> <td>Assessed</td> <td>18,653</td> <td>2,017.91</td> </tr> <tr> <td>Year Frozen</td> <td>0</td> <td>Improvements 152,334</td> <td>130,360</td> <td></td> <td>14,340</td> <td>Penalty</td> <td>0</td> <td></td> </tr> <tr> <td>Uncapped Value</td> <td>30,279</td> <td>Mobile Home 0</td> <td>0</td> <td></td> <td>0</td> <td>Exemption</td> <td>1,000</td> <td>-94.00</td> </tr> <tr> <td>TIF Project ID</td> <td>0</td> <td>Total Value 222,689</td> <td>169,567</td> <td></td> <td>18,653</td> <td>Total Taxable</td> <td>17,653</td> <td>1,924.00</td> </tr> </tbody> </table>					Source	REAL	Fair Cash	Capped	Asmnt Level	Assessed	Levy Rate	108.182	Current Tax	Remove Cap	2016	Land Value 70,355	39,207	11%	4,313	Assessed	18,653	2,017.91	Year Frozen	0	Improvements 152,334	130,360		14,340	Penalty	0		Uncapped Value	30,279	Mobile Home 0	0		0	Exemption	1,000	-94.00	TIF Project ID	0	Total Value 222,689	169,567		18,653	Total Taxable	17,653	1,924.00	Sale History <table border="1"> <thead> <tr> <th>Bk/Pg</th> <th>Grantor</th> <th>Date</th> <th>Price</th> <th>Code</th> </tr> </thead> <tbody> <tr> <td>2485/283</td> <td>COLONIAL SAVINGS FA</td> <td>07/06/2015</td> <td>110,000</td> <td>3</td> </tr> <tr> <td>2431/343</td> <td>CHASTEEN, SHIRLEY M</td> <td>10/01/2014</td> <td>0</td> <td>10</td> </tr> <tr> <td>2165/574</td> <td>BARBEE, DAVID LOREN</td> <td>03/28/2011</td> <td>125,000</td> <td>YES</td> </tr> </tbody> </table>					Bk/Pg	Grantor	Date	Price	Code	2485/283	COLONIAL SAVINGS FA	07/06/2015	110,000	3	2431/343	CHASTEEN, SHIRLEY M	10/01/2014	0	10	2165/574	BARBEE, DAVID LOREN	03/28/2011	125,000	YES																																															
Source	REAL	Fair Cash	Capped	Asmnt Level	Assessed	Levy Rate	108.182	Current Tax																																																																																																																	
Remove Cap	2016	Land Value 70,355	39,207	11%	4,313	Assessed	18,653	2,017.91																																																																																																																	
Year Frozen	0	Improvements 152,334	130,360		14,340	Penalty	0																																																																																																																		
Uncapped Value	30,279	Mobile Home 0	0		0	Exemption	1,000	-94.00																																																																																																																	
TIF Project ID	0	Total Value 222,689	169,567		18,653	Total Taxable	17,653	1,924.00																																																																																																																	
Bk/Pg	Grantor	Date	Price	Code																																																																																																																					
2485/283	COLONIAL SAVINGS FA	07/06/2015	110,000	3																																																																																																																					
2431/343	CHASTEEN, SHIRLEY M	10/01/2014	0	10																																																																																																																					
2165/574	BARBEE, DAVID LOREN	03/28/2011	125,000	YES																																																																																																																					
Assessment History <table border="1"> <thead> <tr> <th>Tax Year</th> <th>Statement Number</th> <th>Billed Owner</th> <th>Tax Area</th> <th>Total Value</th> <th>Exemptions</th> <th>Taxable Value</th> <th>Billed Tax</th> </tr> </thead> <tbody> <tr><td>2025</td><td>2025-660024997</td><td>CLIFTON, DANA R</td><td>10</td><td>190,409</td><td>1000</td><td>13,875</td><td>1,515.00</td></tr> <tr><td>2024</td><td>2024-660024997</td><td>CLIFTON, PERRY M & DANA R</td><td>10</td><td>199,017</td><td>1000</td><td>13,442</td><td>1,421.00</td></tr> <tr><td>2023</td><td>2023-660024997</td><td>CLIFTON, PERRY M & DANA R</td><td>10</td><td>127,470</td><td>1000</td><td>13,022</td><td>1,368.00</td></tr> <tr><td>2022</td><td>2022-660024997</td><td>CLIFTON, PERRY M & DANA R</td><td>10</td><td>125,827</td><td>1000</td><td>12,841</td><td>1,343.00</td></tr> <tr><td>2021</td><td>2021-660024997</td><td>CLIFTON, PERRY M & DANA R</td><td>10</td><td>137,031</td><td>1000</td><td>14,073</td><td>1,481.00</td></tr> <tr><td>2020</td><td>2020-660024997</td><td>CLIFTON, PERRY M & DANA R</td><td>10</td><td>138,058</td><td>1000</td><td>14,047</td><td>1,500.00</td></tr> <tr><td>2019</td><td>2019-660024997</td><td>CLIFTON, PERRY M & DANA R</td><td>10</td><td>132,803</td><td>1000</td><td>13,608</td><td>1,426.00</td></tr> <tr><td>2018</td><td>2018-660024997</td><td>CLIFTON, PERRY M & DANA R</td><td>10</td><td>139,182</td><td>0</td><td>15,310</td><td>1,644.00</td></tr> <tr><td>2017</td><td>2017-660024997</td><td>CLIFTON, PERRY M & DANA R</td><td>10</td><td>138,202</td><td>0</td><td>15,202</td><td>1,729.00</td></tr> <tr><td>2016</td><td>2016-660024997</td><td>CLIFTON, PERRY M & DANA R</td><td>10</td><td>135,222</td><td>0</td><td>14,874</td><td>1,540.00</td></tr> <tr><td>2015</td><td>2015-660024997</td><td>CLIFTON, PERRY M & DANA R</td><td>10</td><td>134,392</td><td>0</td><td>14,783</td><td>1,449.00</td></tr> <tr><td>2014</td><td>2014-660024997</td><td>CHASTEEN, SHIRLEY M</td><td>10</td><td>135,346</td><td>0</td><td>14,888</td><td>1,456.00</td></tr> <tr><td>2013</td><td>2013-660024997</td><td>CHASTEEN, SHIRLEY M</td><td>10</td><td>130,793</td><td>0</td><td>14,387</td><td>1,361.00</td></tr> </tbody> </table>										Tax Year	Statement Number	Billed Owner	Tax Area	Total Value	Exemptions	Taxable Value	Billed Tax	2025	2025-660024997	CLIFTON, DANA R	10	190,409	1000	13,875	1,515.00	2024	2024-660024997	CLIFTON, PERRY M & DANA R	10	199,017	1000	13,442	1,421.00	2023	2023-660024997	CLIFTON, PERRY M & DANA R	10	127,470	1000	13,022	1,368.00	2022	2022-660024997	CLIFTON, PERRY M & DANA R	10	125,827	1000	12,841	1,343.00	2021	2021-660024997	CLIFTON, PERRY M & DANA R	10	137,031	1000	14,073	1,481.00	2020	2020-660024997	CLIFTON, PERRY M & DANA R	10	138,058	1000	14,047	1,500.00	2019	2019-660024997	CLIFTON, PERRY M & DANA R	10	132,803	1000	13,608	1,426.00	2018	2018-660024997	CLIFTON, PERRY M & DANA R	10	139,182	0	15,310	1,644.00	2017	2017-660024997	CLIFTON, PERRY M & DANA R	10	138,202	0	15,202	1,729.00	2016	2016-660024997	CLIFTON, PERRY M & DANA R	10	135,222	0	14,874	1,540.00	2015	2015-660024997	CLIFTON, PERRY M & DANA R	10	134,392	0	14,783	1,449.00	2014	2014-660024997	CHASTEEN, SHIRLEY M	10	135,346	0	14,888	1,456.00	2013	2013-660024997	CHASTEEN, SHIRLEY M	10	130,793	0	14,387	1,361.00
Tax Year	Statement Number	Billed Owner	Tax Area	Total Value	Exemptions	Taxable Value	Billed Tax																																																																																																																		
2025	2025-660024997	CLIFTON, DANA R	10	190,409	1000	13,875	1,515.00																																																																																																																		
2024	2024-660024997	CLIFTON, PERRY M & DANA R	10	199,017	1000	13,442	1,421.00																																																																																																																		
2023	2023-660024997	CLIFTON, PERRY M & DANA R	10	127,470	1000	13,022	1,368.00																																																																																																																		
2022	2022-660024997	CLIFTON, PERRY M & DANA R	10	125,827	1000	12,841	1,343.00																																																																																																																		
2021	2021-660024997	CLIFTON, PERRY M & DANA R	10	137,031	1000	14,073	1,481.00																																																																																																																		
2020	2020-660024997	CLIFTON, PERRY M & DANA R	10	138,058	1000	14,047	1,500.00																																																																																																																		
2019	2019-660024997	CLIFTON, PERRY M & DANA R	10	132,803	1000	13,608	1,426.00																																																																																																																		
2018	2018-660024997	CLIFTON, PERRY M & DANA R	10	139,182	0	15,310	1,644.00																																																																																																																		
2017	2017-660024997	CLIFTON, PERRY M & DANA R	10	138,202	0	15,202	1,729.00																																																																																																																		
2016	2016-660024997	CLIFTON, PERRY M & DANA R	10	135,222	0	14,874	1,540.00																																																																																																																		
2015	2015-660024997	CLIFTON, PERRY M & DANA R	10	134,392	0	14,783	1,449.00																																																																																																																		
2014	2014-660024997	CHASTEEN, SHIRLEY M	10	135,346	0	14,888	1,456.00																																																																																																																		
2013	2013-660024997	CHASTEEN, SHIRLEY M	10	130,793	0	14,387	1,361.00																																																																																																																		



Rogers

Assessment Property Record Card for Tax Year 2026

Data provided by LISA DELOZIER County Assessor

Date 04/16/2026
 Time 21:50:47
 Page 2

Lot Data	Square-Foot - NBHD 1148 #1	Primary Image
Lot Size Lot Count Units Buildable 1 Non-Ag Acres 1.1419 Topography Street Access Utilities Amenities LAND QUALITY 0 0 Method Square-Foot Base Lot Value 49,740.00 x 1.41 = 70,355 Factor Value Adjustments 1.0000 Lot Value 70,355		 <p>660024997_001.JPG 7/10/2025</p>

Residential Data	
Type	1 Single Family Residence
Condition	3 - Average
Quality	2.5 - Fair
Architecture	
Style	100% 1 1/2 Story Finished
Exterior Wall	75% Veneer, Masonry 25% Frame, Siding, Wood
Base/Total Area	1,326 / 1,578
Style	100% 1 1/2 Story Finished
HVAC	100% Warmed & Cooled Air
Roof Cover	1 Composition Shingle
Area on Slab	1,326
Fixture/RghIn	11 /
Bed/F/H Bath	3 / 2.0 /
Basement Area	
Garage Type	546 Attached Garage - Unfinished 2 Stalls
Remodel	
Year/Eff Age	1984 / 32

GRM Approach
GRM Code Gross Rent 0.00 Indicated Value

Multiple Regression
MRA Code 1 Test Adusted R 0.8445 Indicated Value 176,214 111.67 Per SqFt

Direct Comparables
Selection Model A Adam Test Adjustment Model 1 2022 Residential Comparables 3 Indicated Value 223,740 Per SqFt

Cost Approach				Manual : 01/2025			
Base Cost	89.54	Total Misc Impr	+ 70,226				
Roofing Adj	+ 3.66	Garage Cost	+ 14,704				
Subfloor Adj	+ -0.97	Total RCN	= 262,644				
Heat/Cool Adj	+ 11.47	Depreciation (42%)	- 110,310				
Plumbing Adj	+ 8.92	Lump Sums	+ 0				
Basement Adj	+ 0.00	RCNLD	= 152,334				
Adj Base Cost	= 112.62	Lot Value	+ 70,355				
Total Area	x 1,578	Indicated Value	= 222,689				
Adjusted Cost	= 177,714	Value Per SqFt	141.12				

Value Reconciliation
Selected Approach Cost Approach Improvements 152,334 Lot Value 70,355 Indicated Value 222,689 141.12 Per SqFt Agland Value Site Improvements Total Value 222,689 141.12 Total Value Per SqFt

Miscellaneous Improvements								
Code	Description	Sketch ID	Size	Year	Units	Unit Cost	Depr	Value
FPR1	FIREPLACE - RESIDENTIAL 1 STORY	0		1	1	5,095.98		5,096
PRCH	SLAB PORCH - COVERED	61478	25x7		175	23.66		4,141
PRCH	SLAB PORCH - COVERED	61479	55x20		1,100	21.76		23,936
GRAT	Garage - Attached	61481	1444		1,444	25.66		37,053



Rogers

Assessment Property Record Card for Tax Year 2026

Data provided by LISA DELOZIER County Assessor

Date 04/16/2026
 Time 21:50:47
 Page 3

Sketch Image

660024997

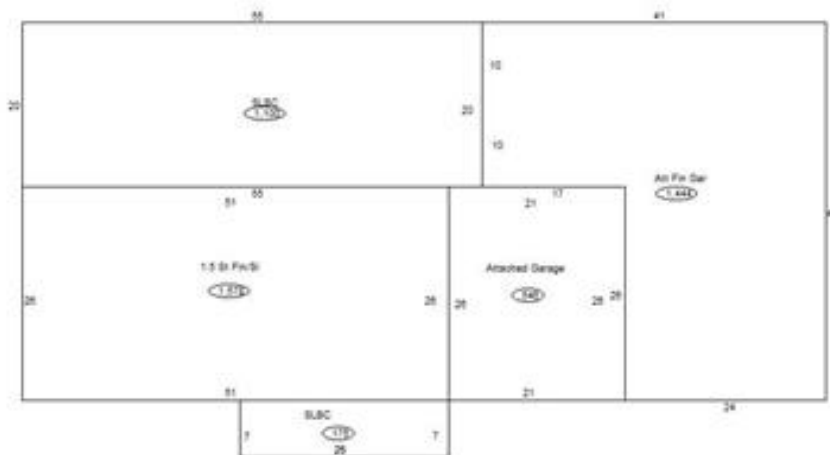

Sketch Vector Information

Sequence	Code	Type	Built Over	Scale	Section Label	Base Area	Multiplier	Total Area
1	R	5	Slab	13	1.5 St Fin/SI	1,326	1.190	1,578
2	G	1		13	Attached Garage	546	1.000	546
3	M	PRCH		13	SLBC	175	1.000	175
4	M	PRCH		13	SLBC	1,100	1.000	1,100
5	U	^UL	Overhang	13	Upper Level	252	1.000	252
6	G	5		13	Att Fin Gar	1,444	1.000	1,444
Total Building Area						1,326		1,578



Rogers

Assessment Property Record Card for Tax Year 2026

Data provided by LISA DELOZIER County Assessor

Date 04/16/2026
Time 21:50:47
Page 4

660024997

Outbuildings/Site Improvements

Building Image	Code	Description	Dimensions	Floor	Roofing	Total Units
	STF	STG FAIR	0x0x0			
	Qual	2	Cond	Year	Eff Age	
Valuation Summary		Modifier Total	RCN	Depr (100% Phys/ % Func)	RCNLD	
Base Cost (4.68 x)						