



Rogers

Assessment Property Record Card for Tax Year 2026

Data provided by LISA DELOZIER County Assessor

Date 04/16/2026
Time 22:46:44
Page 1

Assessment Data					Primary Image									
Account	660025380				<p>660025380_001.JPG 12/8/2025</p>									
Parcel ID	000000-00-0-20010-031-0009													
Cadastral ID	30-20-15-03620													
Property Type	REAL - Real Property													
Property Class	URP	VI Area	3											
Tax Area	1 - CATOOSA OT													
Name ID	180004													
STARKS, JOHN B														
REVOCABLE TRUST														
ET AL														
302 S DELAWARE														
CATOOSA OK 74015-0000														
Parcel Location														
Situs	00302 DELAWARE													
Subdivision	CATOOSA O T													
Lot/Block	0009 / 0031	Parcel Size	1 - Lots											
Sec/Twn/Rng	30 / 20 / 15 / 5													
Neighborhood	1184 - R-V03-SW CATOOSA													
School District	S002 - CATOOSA SCHOOLS													
Legal Description														
Lat/Long: 36.18526879 -95.74840775														
S 60' LOT 8 & S 60' LOT 9 BLOCK 31 CATOOSA O T														
Building Permits														
<table border="1"> <thead> <tr> <th>Number</th> <th>Description</th> <th>Opened</th> <th>Closed</th> <th>Amount</th> </tr> </thead> <tbody> <tr> <td colspan="5" style="height: 100px;"> </td> </tr> </tbody> </table>					Number	Description	Opened	Closed	Amount					
Number	Description	Opened	Closed	Amount										
Exemptions														
Code	Type	Active	Maximum	Exemption										
H	Homestead	Yes	1,000	1,000										
PD	Add-Homestead	Yes	1,000	1,000										
Sale History														
Bk/Pg	Grantor	Date	Price	Code										
Parcel Valuation														
Source	REAL	Fair Cash	Capped	Asmnt Level	Assessed	Levy Rate	106.660	Current Tax						
Remove Cap	0	Land Value	19,797	9,389	11%	1,033	Assessed	4,065	433.57					
Year Frozen	2017	Improvements	58,106	27,558		3,032	Penalty	0						
Uncapped Value	0	Mobile Home	0	0		0	Exemption	2,000	-214.00					
TIF Project ID	0	Total Value	77,903	36,947		4,065	Total Taxable	2,065	220.00					
Assessment History														
Tax Year	Statement Number	Billed Owner	Tax Area	Total Value	Exemptions	Taxable Value	Billed Tax							
2025	2025-660025380	STARKS, JOHN B	1	73,581	2000	2,065	220.00							
2024	2024-660025380	STARKS, JOHN B	1	74,510	2000	2,064	218.00							
2023	2023-660025380	STARKS, JOHN B	1	56,144	2000	2,064	212.00							
2022	2022-660025380	STARKS, JOHN B	1	56,144	2000	2,064	207.00							
2021	2021-660025380	STARKS, JOHN B	1	56,249	2000	2,064	182.00							
2020	2020-660025380	STARKS, JOHN B	1	56,948	2000	2,064	183.00							
2019	2019-660025380	STARKS, JOHN B	1	54,092	2000	2,065	185.00							
2018	2018-660025380	STARKS, JOHN B	1	57,665	2000	2,065	184.00							
2017	2017-660025380	STARKS, JOHN B	1	57,179	2000	2,065	186.00							
2016	2016-660025380	STARKS, JOHN B	1	55,672	1000	2,946	262.00							
2015	2015-660025380	STARKS, JOHN B	1	53,892	1000	2,831	253.00							
2014	2014-660025380	STARKS, JOHN B	1	55,765	1000	2,720	246.00							
2013	2013-660025380	STARKS, JOHN B	1	54,801	1000	2,611	234.00							



Rogers

Assessment Property Record Card for Tax Year 2026

Data provided by LISA DELOZIER County Assessor

Date 04/16/2026
 Time 22:46:44
 Page 2

Lot Data	Square-Foot - NBHD 1184 #1	Primary Image
Lot Size Lot Count Units Buildable 1 Non-Ag Acres 0.1515 Topography Street Access Utilities Amenities LAND QUALITY 0 0 Method Square-Foot Base Lot Value 6,599.00 x 3.00 = 19,797 Factor Value Adjustments 1.0000 Lot Value 19,797		

Residential Data	
Type	1 Single Family Residence
Condition	3 - Average
Quality	2 - Fair
Architecture	TRAD TRADITIONAL
Style	100% One Story
Exterior Wall	100% Veneer, Masonry
Base/Total Area	1,012 / 1,012
Style	100% One Story
HVAC	100% Forced Air Furnace
Roof Cover	1 Composition Shingle
Area on Slab	0
Fixture/RghIn	7 /
Bed/F/H Bath	2 / 1.0 /
Basement Area	
Garage Type	
Remodel	
Year/Eff Age	1964 / 47



660025380_001.JPG 12/8/2025

GRM Approach	
GRM Code	
Gross Rent	0.00
Indicated Value	

Multiple Regression			
MRA Code	1	Test	
Adusted R	0.8445		
Indicated Value	63,328	62.58	Per SqFt

Direct Comparables	
Selection Model	A Adam Test
Adjustment Model	1 2022 Residential
Comparables	
Indicated Value	

Cost Approach				Manual : 01/2025	
Base Cost	107.31	Total Misc Impr	+	847	
Roofing Adj	+ 4.39	Garage Cost	+		
Subfloor Adj	+ 2.55	Total RCN	=	129,806	
Heat/Cool Adj	+ 5.00	Depreciation (56%)	-	72,691	
Plumbing Adj	+ 8.18	Lump Sums	+	0	
Basement Adj	+ 0.00	RCNLD	=	57,115	
Adj Base Cost	= 127.43	Lot Value	+	19,797	
Total Area	x 1,012	Indicated Value	=	76,912	
Adjusted Cost	= 128,959	Value Per SqFt		76.00	

Value Reconciliation			
Selected Approach	Cost Approach		
Improvements	57,115		
Lot Value	19,797		
Indicated Value	76,912	76.00	Per SqFt
Agland Value			
Site Improvements	991		
Total Value	77,903	76.98	Total Value Per SqFt

Miscellaneous Improvements								
Code	Description	Sketch ID	Size	Year	Units	Unit Cost	Depr	Value
PRCH	SLAB PORCH - COVERED	62049	10x4		40	21.17		847



Rogers

Assessment Property Record Card for Tax Year 2026

Data provided by LISA DELOZIER County Assessor

Date 04/16/2026

Time 22:46:44

Page 3

Sketch Image

660025380

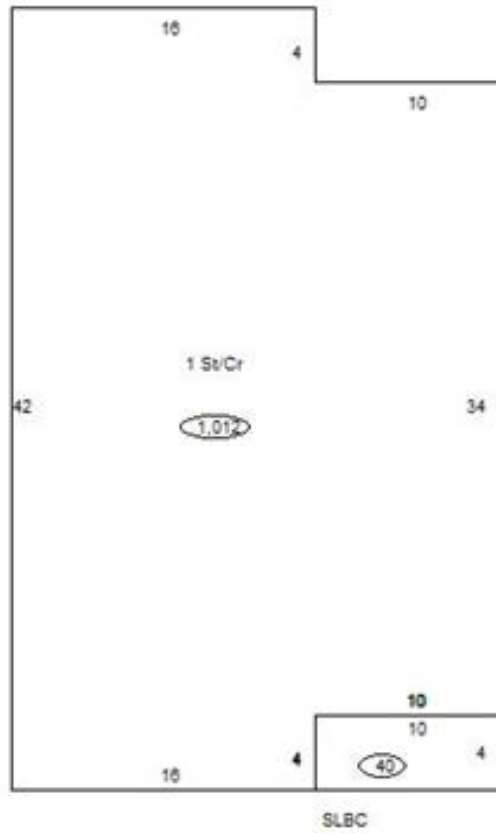

Sketch Vector Information

Sequence	Code	Type	Built Over	Scale	Section Label	Base Area	Multiplier	Total Area
1	R	1	Crawl	10	1 St/Cr	1,012	1.000	1,012
2	M	PRCH		10	SLBC	40	1.000	40
Total Building Area						1,012		1,012



Rogers



Assessment Property Record Card for Tax Year 2026

Data provided by LISA DELOZIER County Assessor

Date 04/16/2026
 Time 22:46:45
 Page 4

660025380

Outbuildings/Site Improvements

Building Image	Code	Description	Dimensions	Floor	Roofing	Total Units	
	SHDS	Shed - Small	8x10x8	Plank	Formed Metal	80	
	Qual	2	Cond 3	Year 2005	Eff Age 16		
	Valuation Summary		Modifier Total	RCN	Depr (52% Phys/ % Func)	RCNLD	
	Base Cost (25.80 x 80)		2,064		2,064	1,073	991
	SHDS	Shed - Small - NCV	10x12x6	Dirt	Formed Metal	120	
	Qual	2	Cond 2	Year 2000	Eff Age 26		
	Valuation Summary		Modifier Total	RCN	Depr (100% Phys/ % Func)	RCNLD	
	Base Cost (15.80 x 120)		1,896		1,896	1,896	