



# Rogers

## Assessment Property Record Card for Tax Year 2026

Data provided by LISA DELOZIER County Assessor

Date 04/18/2026  
 Time 07:48:24  
 Page 1

Assessment Data					Primary Image																																																																																																																				
<b>Account</b> 660025392 <b>Parcel ID</b> 000000-00-0-20010-035-0002 <b>Cadastral ID</b> 30-20-15-03735 <b>Property Type</b> REAL - Real Property <b>Property Class</b> UCP VI Area 3 <b>Tax Area</b> 1 - CATOOSA OT <b>Name ID</b> 348085 WAYLAND, TERENCE KEVIN & WILLIAM ROBERT WAYLAND  6340 PIMA PL NW ALBUQUERQUE NM 87120-0000  <b>Parcel Location</b> <b>Situs</b> 01920 N HWY 66 <b>Subdivision</b> CATOOSA O T <b>Lot/Block</b> 0002 / 0035 <b>Parcel Size</b> 1 - Lots <b>Sec/Twn/Rng</b> 30 / 20 / 15 / 5 <b>Neighborhood</b> 5001 - TASC 2016 <b>School District</b> S002 - CATOOSA SCHOOLS					<p>660025392_001.JPG 12/8/2025</p>																																																																																																																				
<b>Legal Description</b> Lat/Long: 36.18417382 -95.74586199 PT LOTS 1 & 2 BLOCK 35 & PT NE NE NE SE BEG: 7.5' E NW/C LOT 2, E 265.2' TO HWY 66, S 41-38 W 220.40' TO S/L LOT 1, NWLY TO POB CATOOSA O T																																																																																																																									
<b>Exemptions</b>					<b>Building Permits</b>																																																																																																																				
<table border="1"> <thead> <tr> <th>Code</th> <th>Type</th> <th>Active</th> <th>Maximum</th> <th>Exemption</th> </tr> </thead> <tbody> <tr> <td> </td> <td> </td> <td> </td> <td> </td> <td> </td> </tr> </tbody> </table>					Code	Type	Active	Maximum	Exemption						<table border="1"> <thead> <tr> <th>Number</th> <th>Description</th> <th>Opened</th> <th>Closed</th> <th>Amount</th> </tr> </thead> <tbody> <tr> <td> </td> <td> </td> <td> </td> <td> </td> <td> </td> </tr> </tbody> </table>					Number	Description	Opened	Closed	Amount																																																																																																	
Code	Type	Active	Maximum	Exemption																																																																																																																					
Number	Description	Opened	Closed	Amount																																																																																																																					
<table border="1"> <thead> <tr> <th>Code</th> <th>Type</th> <th>Active</th> <th>Maximum</th> <th>Exemption</th> </tr> </thead> <tbody> <tr> <td> </td> <td> </td> <td> </td> <td> </td> <td> </td> </tr> </tbody> </table>					Code	Type	Active	Maximum	Exemption						<b>Sale History</b> <table border="1"> <thead> <tr> <th>Bk/Pg</th> <th>Grantor</th> <th>Date</th> <th>Price</th> <th>Code</th> </tr> </thead> <tbody> <tr> <td>/</td> <td>WAYLAND, SANDRA JAN</td> <td>08/20/2025</td> <td>0</td> <td>4</td> </tr> <tr> <td>1463/751</td> <td>ROGERS, C T SR</td> <td>03/31/2003</td> <td>0</td> <td>16</td> </tr> <tr> <td>/</td> <td>ROGERS, CHARLES T SR</td> <td>03/31/2003</td> <td>0</td> <td>4</td> </tr> <tr> <td>917/658</td> <td>ROGERS, C T SR &amp;</td> <td>06/07/1993</td> <td>0</td> <td>No</td> </tr> </tbody> </table>					Bk/Pg	Grantor	Date	Price	Code	/	WAYLAND, SANDRA JAN	08/20/2025	0	4	1463/751	ROGERS, C T SR	03/31/2003	0	16	/	ROGERS, CHARLES T SR	03/31/2003	0	4	917/658	ROGERS, C T SR &	06/07/1993	0	No																																																																													
Code	Type	Active	Maximum	Exemption																																																																																																																					
Bk/Pg	Grantor	Date	Price	Code																																																																																																																					
/	WAYLAND, SANDRA JAN	08/20/2025	0	4																																																																																																																					
1463/751	ROGERS, C T SR	03/31/2003	0	16																																																																																																																					
/	ROGERS, CHARLES T SR	03/31/2003	0	4																																																																																																																					
917/658	ROGERS, C T SR &	06/07/1993	0	No																																																																																																																					
<b>Parcel Valuation</b> <table border="1"> <thead> <tr> <th>Source</th> <th>REAL</th> <th>Fair Cash</th> <th>Capped</th> <th>Asmnt Level</th> <th>Assessed</th> <th>Levy Rate</th> <th>106.660</th> <th>Current Tax</th> </tr> </thead> <tbody> <tr> <td>Remove Cap</td> <td>0</td> <td>Land Value 21,635</td> <td>21,635</td> <td>11%</td> <td>2,380</td> <td>Assessed</td> <td>13,423</td> <td>1,431.70</td> </tr> <tr> <td>Year Frozen</td> <td>0</td> <td>Improvements 170,178</td> <td>100,394</td> <td></td> <td>11,043</td> <td>Penalty</td> <td>0</td> <td></td> </tr> <tr> <td>Uncapped Value</td> <td>0</td> <td>Mobile Home 0</td> <td>0</td> <td></td> <td>0</td> <td>Exemption</td> <td>0</td> <td>0.00</td> </tr> <tr> <td>TIF Project ID</td> <td>0</td> <td>Total Value 191,813</td> <td>122,029</td> <td></td> <td>13,423</td> <td>Total Taxable</td> <td>13,423</td> <td>1,432.00</td> </tr> </tbody> </table>										Source	REAL	Fair Cash	Capped	Asmnt Level	Assessed	Levy Rate	106.660	Current Tax	Remove Cap	0	Land Value 21,635	21,635	11%	2,380	Assessed	13,423	1,431.70	Year Frozen	0	Improvements 170,178	100,394		11,043	Penalty	0		Uncapped Value	0	Mobile Home 0	0		0	Exemption	0	0.00	TIF Project ID	0	Total Value 191,813	122,029		13,423	Total Taxable	13,423	1,432.00																																																																			
Source	REAL	Fair Cash	Capped	Asmnt Level	Assessed	Levy Rate	106.660	Current Tax																																																																																																																	
Remove Cap	0	Land Value 21,635	21,635	11%	2,380	Assessed	13,423	1,431.70																																																																																																																	
Year Frozen	0	Improvements 170,178	100,394		11,043	Penalty	0																																																																																																																		
Uncapped Value	0	Mobile Home 0	0		0	Exemption	0	0.00																																																																																																																	
TIF Project ID	0	Total Value 191,813	122,029		13,423	Total Taxable	13,423	1,432.00																																																																																																																	
<b>Assessment History</b> <table border="1"> <thead> <tr> <th>Tax Year</th> <th>Statement Number</th> <th>Billed Owner</th> <th>Tax Area</th> <th>Total Value</th> <th>Exemptions</th> <th>Taxable Value</th> <th>Billed Tax</th> </tr> </thead> <tbody> <tr> <td>2025</td> <td>2025-660025392</td> <td>WAYLAND, TERENCE KEVIN &amp;</td> <td>1</td> <td>207,268</td> <td>0</td> <td>12,784</td> <td>1,364.00</td> </tr> <tr> <td>2024</td> <td>2024-660025392</td> <td>WAYLAND, SANDRA JAN</td> <td>1</td> <td>110,685</td> <td>0</td> <td>12,176</td> <td>1,284.00</td> </tr> <tr> <td>2023</td> <td>2023-660025392</td> <td>WAYLAND, SANDRA JAN</td> <td>1</td> <td>158,482</td> <td>0</td> <td>17,433</td> <td>1,789.00</td> </tr> <tr> <td>2022</td> <td>2022-660025392</td> <td>WAYLAND, SANDRA JAN</td> <td>1</td> <td>167,635</td> <td>0</td> <td>17,708</td> <td>1,778.00</td> </tr> <tr> <td>2021</td> <td>2021-660025392</td> <td>ROGERS, CHARLES T SR</td> <td>1</td> <td>153,319</td> <td>0</td> <td>16,865</td> <td>1,484.00</td> </tr> <tr> <td>2020</td> <td>2020-660025392</td> <td>ROGERS, CHARLES T SR</td> <td>1</td> <td>153,319</td> <td>0</td> <td>16,865</td> <td>1,494.00</td> </tr> <tr> <td>2019</td> <td>2019-660025392</td> <td>ROGERS, CHARLES T SR</td> <td>1</td> <td>153,319</td> <td>0</td> <td>16,865</td> <td>1,514.00</td> </tr> <tr> <td>2018</td> <td>2018-660025392</td> <td>ROGERS, CHARLES T SR</td> <td>1</td> <td>158,697</td> <td>0</td> <td>3,566</td> <td>318.00</td> </tr> <tr> <td>2017</td> <td>2017-660025392</td> <td>ROGERS, CHARLES T SR</td> <td>1</td> <td>158,697</td> <td>0</td> <td>3,396</td> <td>307.00</td> </tr> <tr> <td>2016</td> <td>2016-660025392</td> <td>ROGERS, CHARLES T SR</td> <td>1</td> <td>158,697</td> <td>0</td> <td>3,234</td> <td>288.00</td> </tr> <tr> <td>2015</td> <td>2015-660025392</td> <td>ROGERS, CHARLES T SR</td> <td>1</td> <td>28,000</td> <td>0</td> <td>3,080</td> <td>275.00</td> </tr> <tr> <td>2014</td> <td>2014-660025392</td> <td>ROGERS, CHARLES T SR</td> <td>1</td> <td>28,000</td> <td>0</td> <td>3,080</td> <td>279.00</td> </tr> <tr> <td>2013</td> <td>2013-660025392</td> <td>ROGERS, CHARLES T SR</td> <td>1</td> <td>28,000</td> <td>0</td> <td>3,080</td> <td>276.00</td> </tr> </tbody> </table>										Tax Year	Statement Number	Billed Owner	Tax Area	Total Value	Exemptions	Taxable Value	Billed Tax	2025	2025-660025392	WAYLAND, TERENCE KEVIN &	1	207,268	0	12,784	1,364.00	2024	2024-660025392	WAYLAND, SANDRA JAN	1	110,685	0	12,176	1,284.00	2023	2023-660025392	WAYLAND, SANDRA JAN	1	158,482	0	17,433	1,789.00	2022	2022-660025392	WAYLAND, SANDRA JAN	1	167,635	0	17,708	1,778.00	2021	2021-660025392	ROGERS, CHARLES T SR	1	153,319	0	16,865	1,484.00	2020	2020-660025392	ROGERS, CHARLES T SR	1	153,319	0	16,865	1,494.00	2019	2019-660025392	ROGERS, CHARLES T SR	1	153,319	0	16,865	1,514.00	2018	2018-660025392	ROGERS, CHARLES T SR	1	158,697	0	3,566	318.00	2017	2017-660025392	ROGERS, CHARLES T SR	1	158,697	0	3,396	307.00	2016	2016-660025392	ROGERS, CHARLES T SR	1	158,697	0	3,234	288.00	2015	2015-660025392	ROGERS, CHARLES T SR	1	28,000	0	3,080	275.00	2014	2014-660025392	ROGERS, CHARLES T SR	1	28,000	0	3,080	279.00	2013	2013-660025392	ROGERS, CHARLES T SR	1	28,000	0	3,080	276.00
Tax Year	Statement Number	Billed Owner	Tax Area	Total Value	Exemptions	Taxable Value	Billed Tax																																																																																																																		
2025	2025-660025392	WAYLAND, TERENCE KEVIN &	1	207,268	0	12,784	1,364.00																																																																																																																		
2024	2024-660025392	WAYLAND, SANDRA JAN	1	110,685	0	12,176	1,284.00																																																																																																																		
2023	2023-660025392	WAYLAND, SANDRA JAN	1	158,482	0	17,433	1,789.00																																																																																																																		
2022	2022-660025392	WAYLAND, SANDRA JAN	1	167,635	0	17,708	1,778.00																																																																																																																		
2021	2021-660025392	ROGERS, CHARLES T SR	1	153,319	0	16,865	1,484.00																																																																																																																		
2020	2020-660025392	ROGERS, CHARLES T SR	1	153,319	0	16,865	1,494.00																																																																																																																		
2019	2019-660025392	ROGERS, CHARLES T SR	1	153,319	0	16,865	1,514.00																																																																																																																		
2018	2018-660025392	ROGERS, CHARLES T SR	1	158,697	0	3,566	318.00																																																																																																																		
2017	2017-660025392	ROGERS, CHARLES T SR	1	158,697	0	3,396	307.00																																																																																																																		
2016	2016-660025392	ROGERS, CHARLES T SR	1	158,697	0	3,234	288.00																																																																																																																		
2015	2015-660025392	ROGERS, CHARLES T SR	1	28,000	0	3,080	275.00																																																																																																																		
2014	2014-660025392	ROGERS, CHARLES T SR	1	28,000	0	3,080	279.00																																																																																																																		
2013	2013-660025392	ROGERS, CHARLES T SR	1	28,000	0	3,080	276.00																																																																																																																		



# Rogers

## Assessment Property Record Card for Tax Year 2026

Data provided by LISA DELOZIER County Assessor

Date 04/18/2026  
 Time 07:48:25  
 Page 2

Lot Data		Primary Image	
Lot Size	0 x 0		
Lot Count	0		
Units Buildable	29199		
Non-Ag Acres	0.397		
Topography			
Street Access			
Utilities			
Amenities	0		
	0		
Value Model	1835 COMM		
Value Method	Square-Foot		
Base Lot Value	17,308.00 x 1.25 = 21,635		
Factor Value	0		
Adjustments			
Lot Value	21,635		
Cost Approach		Image Information	
Manual Date	01/2025	Image ID	1121909
Total Building Area	3,016	Image Date	12/8/2025
Total Base Value	449,862	Name	001.JPG
Modifier Value		Description	660025392_001.JPG
Misc Improvements			
Replacement Cost New	449,862		
Phys/Func Depreciation Loss	()		
RCN Less Phys/Func	159,113		
Economic Depreciation			
RCNLD (All Sources)	159,113		
Depreciated Improvements			
Outbuilding Value	11,065		
Total Improvement Value	170,178		
Land Value	21,635		
Cost Approach Value	191,813		
			63.60/SqFt
Income Approach		Value Reconciliation	
Potential Gross Income (PGI)		Selected Valuation Method	Cost Approach
Vacancy & Collection Loss		Total Improvement Value	11,065
Miscellaneous Income		Land Value	21,635
Effective Gross Income (EGI)		Total Appraised Value	191,813
Total Expenses			63.60/SqFt
Net Operating Income (NOI)			
Income Capitalization Rate			
Indicated Value	0.00		



**Rogers**  
**Assessment Property Record Card for Tax Year 2026**

Data provided by LISA DELOZIER County Assessor

Date 04/18/2026  
 Time 07:48:25  
 Page 3

Sketch Image

660025392

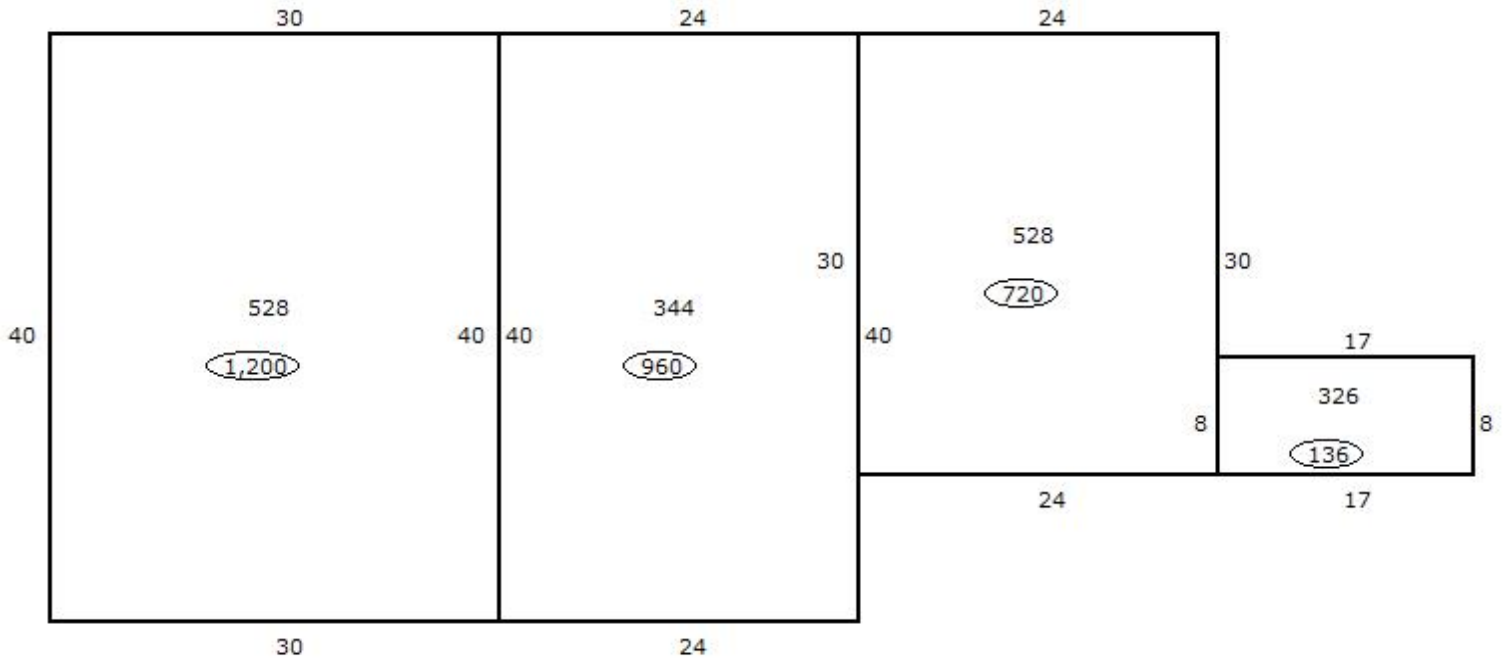

**Sketch Vector Information**

Sequence	Code	Type	Built Over	Scale	Section Label	Base Area	Multiplier	Total Area
1	C	528		13	528	1,200	1.000	1,200
2	C	344		13	344	960	1.000	960
3	C	528		13	528	720	1.000	720
4	C	326		13	326	136	1.000	136
<b>Total Building Area</b>						3,016		3,016



# Rogers

## Assessment Property Record Card for Tax Year 2026

Data provided by LISA DELOZIER County Assessor

Date 04/18/2026  
Time 07:48:25  
Page 4

Account 660025392  
Parcel ID 000000-00-0-20010-035-0002  
Cadastral ID 30-20-15-03735

Tax Area Code 1  
Property Class UCP  
Owners Name WAYLAND, TERENCE KEVIN &

### Building Data

Building ID 3775  
Building Sequence 1  
Occupancy 1 326 Storage Garage 100%  
Occupancy 2  
Occupancy 3  
Total Floor Area 136  
Average Perimeter 50  
Number Of Storys 1.00  
Average Wall Ht 14.00  
Year Built 1980  
Effective Age 23  
Construction Class 2 - Heavier Wood or Steel Stud Frame  
Quality 3 - Average  
Condition 3 - Average  
Exterior Wall 86 - Stud Hardboard Sheet  
Heating/Cooling 15 - No HVAC  
Roof Type Gable  
Roof Cover

Basement Area  
Basement Levels  
Basement Finish  
Finish Code - 1  
Finish Area - 1  
Finish Code - 2  
Finish Area - 2

### Building Image



### Image Information

Image Name IMG\_0010.JPG  
Image Date 5/17/2021  
Image Name IMG\_0010.JPG  
Description REVAL 2022

### Cost Calculations

Appraisal Zone 3  
Zone Description  
Base Cost 61.03  
Wall Cost 158.92  
HVAC Cost 0.00  
Basement Cost 0.00  
Total Base Cost 219.95  
Total Area 136  
Base RCN 29,913  
Misc Impr Value

Manual Date 01/2025  
Base Year 2026  
Modifier Value  
Total Replacement Cost 29,913  
Physical Depreciation 48%  
Functional Depreciation  
Total Depreciation 48% (14,358)  
Total RCNLD 15,555  
Lump Sums  
Total Building Value 15,555 \$ 114.38 Per SqFt



# Rogers

## Assessment Property Record Card for Tax Year 2026

Data provided by LISA DELOZIER County Assessor

Date 04/18/2026  
Time 07:48:25  
Page 5

Account 660025392  
Parcel ID 000000-00-0-20010-035-0002  
Cadastral ID 30-20-15-03735

Tax Area Code 1  
Property Class UCP  
Owners Name WAYLAND, TERENCE KEVIN &

### Building Data

Building ID 3774  
Building Sequence 2  
Occupancy 1 528 Service Repair Garage 100%  
Occupancy 2  
Occupancy 3  
Total Floor Area 720  
Average Perimeter 108  
Number Of Storys 1.00  
Average Wall Ht 14.00  
Year Built 1980  
Effective Age 23  
Construction Class 2 - Heavier Wood or Steel Stud Frame  
Quality 3 - Average  
Condition 3 - Average  
Exterior Wall 86 - Stud Hardboard Sheet  
Heating/Cooling 8 - Warmed and Cooled Air  
Roof Type Gable  
Roof Cover

Basement Area  
Basement Levels  
Basement Finish  
Finish Code - 1  
Finish Area - 1  
Finish Code - 2  
Finish Area - 2

### Building Image

### Image Information

Image Name  
Image Date  
Image Name  
Description

### Cost Calculations

Appraisal Zone 3  
Zone Description  
Base Cost 62.02  
Wall Cost 64.84  
HVAC Cost 13.70  
Basement Cost 0.00  
Total Base Cost 140.56  
Total Area 720  
Base RCN 101,203  
Misc Impr Value

Manual Date 01/2025  
Base Year 2026  
Modifier Value  
Total Replacement Cost 101,203  
Physical Depreciation 63%  
Functional Depreciation  
Total Depreciation 63% (63,758)  
Total RCNLD 37,445  
Lump Sums  
Total Building Value 37,445 \$ 52.01 Per SqFt



# Rogers

## Assessment Property Record Card for Tax Year 2026

Data provided by LISA DELOZIER County Assessor

Date 04/18/2026  
Time 07:48:25  
Page 6

Account 660025392  
Parcel ID 000000-00-0-20010-035-0002  
Cadastral ID 30-20-15-03735

Tax Area Code 1  
Property Class UCP  
Owners Name WAYLAND, TERENCE KEVIN &

### Building Data

Building ID 3773  
Building Sequence 3  
Occupancy 1 344 Office Building 100%  
Occupancy 2  
Occupancy 3  
Total Floor Area 960  
Average Perimeter 128  
Number Of Storys 1.00  
Average Wall Ht 14.00  
Year Built 1980  
Effective Age 39  
Construction Class 2 - Heavier Wood or Steel Stud Frame  
Quality 3 - Average  
Condition 1 - Low  
Exterior Wall 86 - Stud Hardboard Sheet  
Heating/Cooling 8 - Warmed and Cooled Air  
Roof Type Gable  
Roof Cover

Basement Area  
Basement Levels  
Basement Finish  
Finish Code - 1  
Finish Area - 1  
Finish Code - 2  
Finish Area - 2

### Building Image



### Image Information

Image Name IMG\_0008.JPG  
Image Date 5/17/2021  
Image Name IMG\_0008.JPG  
Description REVAL 2022

### Cost Calculations

Appraisal Zone 3  
Zone Description  
Base Cost 101.58  
Wall Cost 57.64  
HVAC Cost 16.72  
Basement Cost 0.00  
Total Base Cost 175.94  
Total Area 960  
Base RCN 168,902  
Misc Impr Value

Manual Date 01/2025  
Base Year 2026  
Modifier Value  
Total Replacement Cost 168,902  
Physical Depreciation 70%  
Functional Depreciation  
Total Depreciation 70% (118,231)  
Total RCNLD 50,671  
Lump Sums  
Total Building Value 50,671 \$ 52.78 Per SqFt



# Rogers

## Assessment Property Record Card for Tax Year 2026

Data provided by LISA DELOZIER County Assessor

Date 04/18/2026  
Time 07:48:25  
Page 7

Account 660025392  
Parcel ID 000000-00-0-20010-035-0002  
Cadastral ID 30-20-15-03735

Tax Area Code 1  
Property Class UCP  
Owners Name WAYLAND, TERENCE KEVIN &

### Building Data

Building ID 3772  
Building Sequence 4  
Occupancy 1 528 Service Repair Garage 100%  
Occupancy 2  
Occupancy 3  
Total Floor Area 1,200  
Average Perimeter 140  
Number Of Storys 1.00  
Average Wall Ht 14.00  
Year Built 1980  
Effective Age 23  
Construction Class 2 - Heavier Wood or Steel Stud Frame  
Quality 3 - Average  
Condition 3 - Average  
Exterior Wall 86 - Stud Hardboard Sheet  
Heating/Cooling 8 - Warmed and Cooled Air  
Roof Type Gable  
Roof Cover

Basement Area  
Basement Levels  
Basement Finish  
Finish Code - 1  
Finish Area - 1  
Finish Code - 2  
Finish Area - 2

### Building Image



### Image Information

Image Name IMG\_0008.JPG  
Image Date 5/17/2021  
Image Name IMG\_0008.JPG  
Description REVAL 2022

### Cost Calculations

Appraisal Zone 3  
Zone Description  
Base Cost 60.74  
Wall Cost 50.43  
HVAC Cost 13.70  
Basement Cost 0.00  
Total Base Cost 124.87  
Total Area 1,200  
Base RCN 149,844  
Misc Impr Value

Manual Date 01/2025  
Base Year 2026  
Modifier Value  
Total Replacement Cost 149,844  
Physical Depreciation 63%  
Functional Depreciation  
Total Depreciation 63% (94,402)  
Total RCNLD 55,442  
Lump Sums  
Total Building Value 55,442 \$ 46.20 Per SqFt



# Rogers

## Assessment Property Record Card for Tax Year 2026

Data provided by LISA DELOZIER County Assessor

Date 04/18/2026

Time 07:48:25

Page 8

660025392

### Outbuildings/Site Improvements

Building Image	Code	Description	Dimensions	Floor	Roofing	Total Units
	PACN	PAVING - CONCRETE	36x68x0			2,448
	Qual	Cond	Year	Eff Age		
Valuation Summary		Modifier Total	RCN	Depr (% Phys/ % Func)	RCNLD	
Base Cost (4.52 x 2,448)				11,065		11,065
Total Site Improvement Value						11,065