



Rogers

Assessment Property Record Card for Tax Year 2026

Data provided by LISA DELOZIER County Assessor

Date 04/17/2026
 Time 06:06:09
 Page 1

Assessment Data					Primary Image																																																																																																																				
Account 660025845 Parcel ID 000000-00-0-00849-001-0005 Cadastral ID 30-21-16-07030 Property Type REAL - Real Property Property Class URP VI Area 1 Tax Area 85 - CLRM SD-VERD TOWN/FIRE Name ID 14124 GRISHAM, WILLIAM R & DELOIS TRUSTEES GRISHAM FAMILY TRUST 21541 E 107TH ST S BROKEN ARROW OK 74014-3690																																																																																																																									
Parcel Location Situs 23436 S TWIN OAKS DR Subdivision TWIN OAKS ESTATES II Lot/Block 0005 / 0001 Parcel Size 1 - Lots Sec/Twn/Rng 30 / 21 / 16 / 5 Neighborhood 1113 - R-V01-SW CLAREMORE School District S001 - CLAREMORE SCHOOLS																																																																																																																									
Legal Description Lat/Long: 36.27320230 -95.64141733 LOT 5 BLOCK 1 TWIN OAKS EST. 2					Building Permits <table border="1"> <thead> <tr> <th>Number</th> <th>Description</th> <th>Opened</th> <th>Closed</th> <th>Amount</th> </tr> </thead> <tbody> <tr> <td> </td> <td> </td> <td> </td> <td> </td> <td> </td> </tr> </tbody> </table>					Number	Description	Opened	Closed	Amount																																																																																																											
Number	Description	Opened	Closed	Amount																																																																																																																					
Exemptions <table border="1"> <thead> <tr> <th>Code</th> <th>Type</th> <th>Active</th> <th>Maximum</th> <th>Exemption</th> </tr> </thead> <tbody> <tr> <td>H</td> <td>Homestead</td> <td>Yes</td> <td>1,000</td> <td>1,000</td> </tr> </tbody> </table>					Code	Type	Active	Maximum	Exemption	H	Homestead	Yes	1,000	1,000	Sale History <table border="1"> <thead> <tr> <th>Bk/Pg</th> <th>Grantor</th> <th>Date</th> <th>Price</th> <th>Code</th> </tr> </thead> <tbody> <tr> <td> </td> <td> </td> <td> </td> <td> </td> <td> </td> </tr> </tbody> </table>					Bk/Pg	Grantor	Date	Price	Code																																																																																																	
Code	Type	Active	Maximum	Exemption																																																																																																																					
H	Homestead	Yes	1,000	1,000																																																																																																																					
Bk/Pg	Grantor	Date	Price	Code																																																																																																																					
Parcel Valuation <table border="1"> <thead> <tr> <th>Source</th> <th>REAL</th> <th>Fair Cash</th> <th>Capped</th> <th>Asmnt Level</th> <th>Assessed</th> <th>Levy Rate</th> <th>109.172</th> <th>Current Tax</th> </tr> </thead> <tbody> <tr> <td>Remove Cap</td> <td>0</td> <td>Land Value 59,832</td> <td>24,431</td> <td>11%</td> <td>2,687</td> <td>Assessed</td> <td>9,394</td> <td>1,025.56</td> </tr> <tr> <td>Year Frozen</td> <td>2005</td> <td>Improvements 149,316</td> <td>60,969</td> <td></td> <td>6,707</td> <td>Penalty</td> <td>0</td> <td></td> </tr> <tr> <td>Uncapped Value</td> <td>0</td> <td>Mobile Home 0</td> <td>0</td> <td></td> <td>0</td> <td>Exemption</td> <td>1,000</td> <td>-93.00</td> </tr> <tr> <td>TIF Project ID</td> <td>0</td> <td>Total Value 209,148</td> <td>85,400</td> <td></td> <td>9,394</td> <td>Total Taxable</td> <td>8,394</td> <td>933.00</td> </tr> </tbody> </table>										Source	REAL	Fair Cash	Capped	Asmnt Level	Assessed	Levy Rate	109.172	Current Tax	Remove Cap	0	Land Value 59,832	24,431	11%	2,687	Assessed	9,394	1,025.56	Year Frozen	2005	Improvements 149,316	60,969		6,707	Penalty	0		Uncapped Value	0	Mobile Home 0	0		0	Exemption	1,000	-93.00	TIF Project ID	0	Total Value 209,148	85,400		9,394	Total Taxable	8,394	933.00																																																																			
Source	REAL	Fair Cash	Capped	Asmnt Level	Assessed	Levy Rate	109.172	Current Tax																																																																																																																	
Remove Cap	0	Land Value 59,832	24,431	11%	2,687	Assessed	9,394	1,025.56																																																																																																																	
Year Frozen	2005	Improvements 149,316	60,969		6,707	Penalty	0																																																																																																																		
Uncapped Value	0	Mobile Home 0	0		0	Exemption	1,000	-93.00																																																																																																																	
TIF Project ID	0	Total Value 209,148	85,400		9,394	Total Taxable	8,394	933.00																																																																																																																	
Assessment History <table border="1"> <thead> <tr> <th>Tax Year</th> <th>Statement Number</th> <th>Billed Owner</th> <th>Tax Area</th> <th>Total Value</th> <th>Exemptions</th> <th>Taxable Value</th> <th>Billed Tax</th> </tr> </thead> <tbody> <tr><td>2025</td><td>2025-660025845</td><td>GRISHAM, WILLIAM R & DELOIS</td><td>85</td><td>206,828</td><td>1000</td><td>8,394</td><td>933.00</td></tr> <tr><td>2024</td><td>2024-660025845</td><td>GRISHAM, WILLIAM R & DELOIS</td><td>85</td><td>217,109</td><td>1000</td><td>8,394</td><td>873.00</td></tr> <tr><td>2023</td><td>2023-660025845</td><td>GRISHAM, WILLIAM R & DELOIS</td><td>85</td><td>150,686</td><td>1000</td><td>8,394</td><td>866.00</td></tr> <tr><td>2022</td><td>2022-660025845</td><td>GRISHAM, WILLIAM R &</td><td>85</td><td>148,437</td><td>1000</td><td>8,394</td><td>874.00</td></tr> <tr><td>2021</td><td>2021-660025845</td><td>GRISHAM, WILLIAM R &</td><td>85</td><td>153,161</td><td>1000</td><td>8,394</td><td>838.00</td></tr> <tr><td>2020</td><td>2020-660025845</td><td>GRISHAM, WILLIAM R &</td><td>85</td><td>150,636</td><td>1000</td><td>8,394</td><td>866.00</td></tr> <tr><td>2019</td><td>2019-660025845</td><td>GRISHAM, WILLIAM R &</td><td>85</td><td>146,823</td><td>1000</td><td>8,394</td><td>874.00</td></tr> <tr><td>2018</td><td>2018-660025845</td><td>GRISHAM, WILLIAM R &</td><td>85</td><td>151,354</td><td>1000</td><td>8,394</td><td>873.00</td></tr> <tr><td>2017</td><td>2017-660025845</td><td>GRISHAM, WILLIAM R &</td><td>85</td><td>150,116</td><td>1000</td><td>8,394</td><td>867.00</td></tr> <tr><td>2016</td><td>2016-660025845</td><td>GRISHAM, WILLIAM R &</td><td>85</td><td>146,228</td><td>1000</td><td>8,394</td><td>884.00</td></tr> <tr><td>2015</td><td>2015-660025845</td><td>GRISHAM, WILLIAM R &</td><td>85</td><td>132,886</td><td>1000</td><td>8,394</td><td>853.00</td></tr> <tr><td>2014</td><td>2014-660025845</td><td>GRISHAM, WILLIAM R &</td><td>85</td><td>135,555</td><td>1000</td><td>8,394</td><td>875.00</td></tr> <tr><td>2013</td><td>2013-660025845</td><td>GRISHAM, WILLIAM R &</td><td>85</td><td>129,943</td><td>1000</td><td>8,394</td><td>865.00</td></tr> </tbody> </table>										Tax Year	Statement Number	Billed Owner	Tax Area	Total Value	Exemptions	Taxable Value	Billed Tax	2025	2025-660025845	GRISHAM, WILLIAM R & DELOIS	85	206,828	1000	8,394	933.00	2024	2024-660025845	GRISHAM, WILLIAM R & DELOIS	85	217,109	1000	8,394	873.00	2023	2023-660025845	GRISHAM, WILLIAM R & DELOIS	85	150,686	1000	8,394	866.00	2022	2022-660025845	GRISHAM, WILLIAM R &	85	148,437	1000	8,394	874.00	2021	2021-660025845	GRISHAM, WILLIAM R &	85	153,161	1000	8,394	838.00	2020	2020-660025845	GRISHAM, WILLIAM R &	85	150,636	1000	8,394	866.00	2019	2019-660025845	GRISHAM, WILLIAM R &	85	146,823	1000	8,394	874.00	2018	2018-660025845	GRISHAM, WILLIAM R &	85	151,354	1000	8,394	873.00	2017	2017-660025845	GRISHAM, WILLIAM R &	85	150,116	1000	8,394	867.00	2016	2016-660025845	GRISHAM, WILLIAM R &	85	146,228	1000	8,394	884.00	2015	2015-660025845	GRISHAM, WILLIAM R &	85	132,886	1000	8,394	853.00	2014	2014-660025845	GRISHAM, WILLIAM R &	85	135,555	1000	8,394	875.00	2013	2013-660025845	GRISHAM, WILLIAM R &	85	129,943	1000	8,394	865.00
Tax Year	Statement Number	Billed Owner	Tax Area	Total Value	Exemptions	Taxable Value	Billed Tax																																																																																																																		
2025	2025-660025845	GRISHAM, WILLIAM R & DELOIS	85	206,828	1000	8,394	933.00																																																																																																																		
2024	2024-660025845	GRISHAM, WILLIAM R & DELOIS	85	217,109	1000	8,394	873.00																																																																																																																		
2023	2023-660025845	GRISHAM, WILLIAM R & DELOIS	85	150,686	1000	8,394	866.00																																																																																																																		
2022	2022-660025845	GRISHAM, WILLIAM R &	85	148,437	1000	8,394	874.00																																																																																																																		
2021	2021-660025845	GRISHAM, WILLIAM R &	85	153,161	1000	8,394	838.00																																																																																																																		
2020	2020-660025845	GRISHAM, WILLIAM R &	85	150,636	1000	8,394	866.00																																																																																																																		
2019	2019-660025845	GRISHAM, WILLIAM R &	85	146,823	1000	8,394	874.00																																																																																																																		
2018	2018-660025845	GRISHAM, WILLIAM R &	85	151,354	1000	8,394	873.00																																																																																																																		
2017	2017-660025845	GRISHAM, WILLIAM R &	85	150,116	1000	8,394	867.00																																																																																																																		
2016	2016-660025845	GRISHAM, WILLIAM R &	85	146,228	1000	8,394	884.00																																																																																																																		
2015	2015-660025845	GRISHAM, WILLIAM R &	85	132,886	1000	8,394	853.00																																																																																																																		
2014	2014-660025845	GRISHAM, WILLIAM R &	85	135,555	1000	8,394	875.00																																																																																																																		
2013	2013-660025845	GRISHAM, WILLIAM R &	85	129,943	1000	8,394	865.00																																																																																																																		



Rogers

Assessment Property Record Card for Tax Year 2026

Data provided by LISA DELOZIER County Assessor

Date 04/17/2026
 Time 06:06:09
 Page 2

Lot Data	Square-Foot - NBHD 1113 #1	Primary Image
Lot Size		
Lot Count		
Units Buildable	1	
Non-Ag Acres	0.6868	
Topography		
Street Access		
Utilities		
Amenities	LAND QUALITY	
	0	
	0	
Method	Square-Foot	
Base Lot Value	29,916.00 x 2.00 = 59,832	
Factor Value		
Adjustments	1.0000	
Lot Value	59,832	

Residential Data	
Type	1 Single Family Residence
Condition	3 - Average
Quality	2.5 - Fair
Architecture	
Style	100% One Story
Exterior Wall	50% Veneer, Stone 50% Frame, Siding, Wood
Base/Total Area	2,114 / 2,114
Style	100% One Story
HVAC	100% Warmed & Cooled Air
Roof Cover	1 Composition Shingle
Area on Slab	2,114
Fixture/RghIn	11 /
Bed/F/H Bath	3 / 2.0 /
Basement Area	
Garage Type	484 Attached Garage - Unfinished
Remodel	
Year/Eff Age	1977 / 37

GRM Approach	
GRM Code	
Gross Rent	0.00
Indicated Value	

Multiple Regression	
MRA Code	1 Test
Adusted R	0.8445
Indicated Value	196,867 93.13 Per SqFt

Direct Comparables	
Selection Model	A Adam Test
Adjustment Model	1 2022 Residential
Comparables	6
Indicated Value	194,460 Per SqFt

Cost Approach				Manual : 01/2025			
Base Cost	98.19	Total Misc Impr	+ 10,642				
Roofing Adj	+ 4.21	Garage Cost	+ 13,373				
Subfloor Adj	+ -1.09	Total RCN	= 276,511				
Heat/Cool Adj	+ 11.47	Depreciation (46%)	- 127,195				
Plumbing Adj	+ 6.66	Lump Sums	+ 0				
Basement Adj	+ 0.00	RCNLD	= 149,316				
Adj Base Cost	= 119.44	Lot Value	+ 59,832				
Total Area	x 2,114	Indicated Value	= 209,148				
Adjusted Cost	= 252,496	Value Per SqFt	98.93				

Value Reconciliation	
Selected Approach	Cost Approach
Improvements	149,316
Lot Value	59,832
Indicated Value	209,148 98.93 Per SqFt
Agland Value	
Site Improvements	
Total Value	209,148 98.93 Total Value Per SqFt

Miscellaneous Improvements								
Code	Description	Sketch ID	Size	Year	Units	Unit Cost	Depr	Value
FPR1	FIREPLACE - RESIDENTIAL 1 STORY	0		1	1	5,095.98		5,096
PRCH	SLAB PORCH - COVERED	63129	165		165	23.70		3,911
PATO	SLAB PORCH - OPEN	63130	158		158	10.35		1,635



Rogers
Assessment Property Record Card for Tax Year 2026

Data provided by LISA DELOZIER County Assessor

Date 04/17/2026
 Time 06:06:09
 Page 3

Sketch Image

660025845

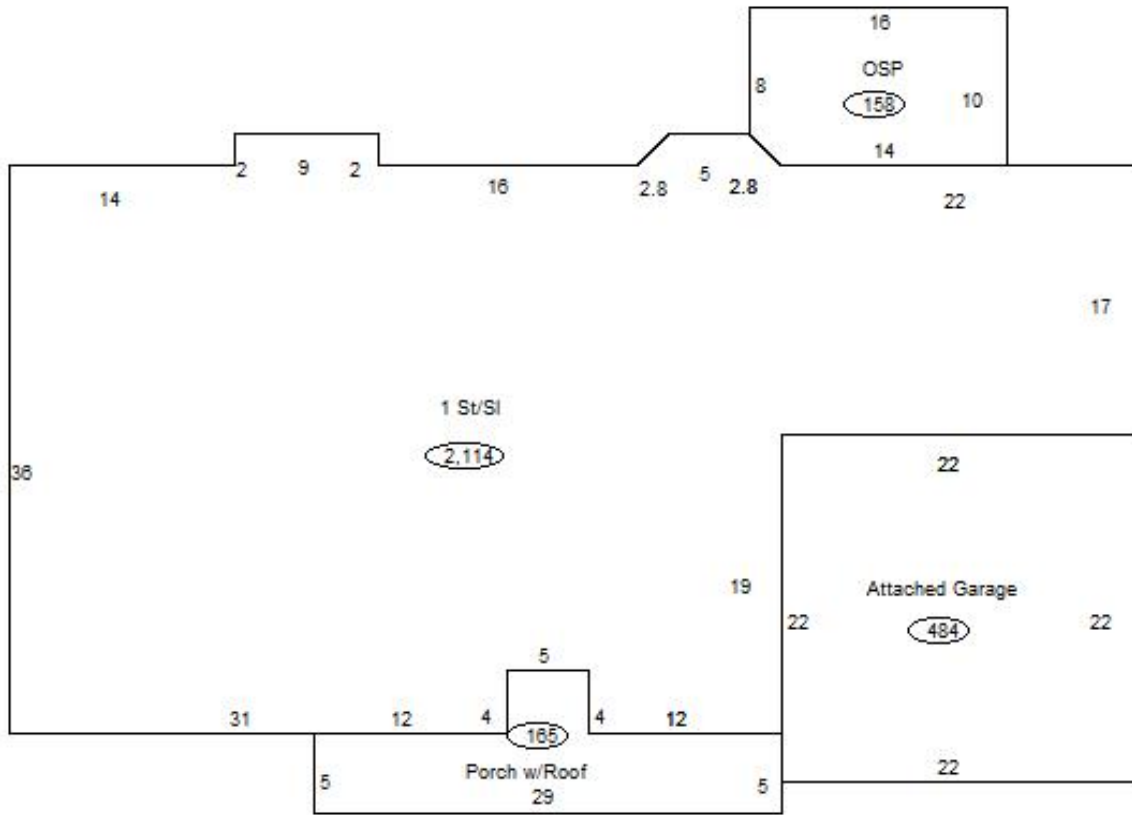

Sketch Vector Information

Sequence	Code	Type	Built Over	Scale	Section Label	Base Area	Multiplier	Total Area
1	R	1	Slab	13	1 St/Sl	2,114	1.000	2,114
2	G	1		13	Attached Garage	484	1.000	484
3	M	PRCH		13	SLBC	165	1.000	165
4	M	PATO		13	Open Slab	158	1.000	158
Total Building Area						2,114		2,114



Rogers

Assessment Property Record Card for Tax Year 2026

Data provided by LISA DELOZIER County Assessor

Date 04/17/2026
Time 06:06:09
Page 4

660025845

Outbuildings/Site Improvements

Building Image	Code	Description	Dimensions	Floor	Roofing	Total Units
	STF	STG FAIR	0x0x0			
	Qual	2	Cond	Year	Eff Age	
Valuation Summary		Modifier Total		RCN	Depr (100% Phys/ % Func)	RCNLD
Base Cost (4.68 x)						