



Rogers

Assessment Property Record Card for Tax Year 2026

Data provided by LISA DELOZIER County Assessor

Date 04/17/2026
 Time 04:37:36
 Page 1

Assessment Data					Primary Image																																																																																																																				
Account 660026090 Parcel ID 23N17E-30-1-00000-000-0000 Cadastral ID 30-23-17-02500 Property Type REAL - Real Property Property Class RR VI Area 2 Tax Area 70 - FOYIL RURAL/FOYIL FIRE Name ID 338556 WILSON, CALEB & SAMANTHA 16634 E 390 RD CLAREMORE OK 74017-0000 Parcel Location Situs 16634 E 390 RD Subdivision Lot/Block / Parcel Size 6 - Acres Sec/Twn/Rng 30 / 23 / 17 / 1 Neighborhood 4070 - FOYIL SEQUOYAH AREA School District S007 - FOYIL SCHOOLS					 <p>\\tsclient\H\My Pictures\06-29-12 008.jpg 6/29/2012</p>																																																																																																																				
Legal Description Lat/Long: 36.44912791 -95.53317127																																																																																																																									
TR W2 NE, BEG 1179.44' N SW/C; E 537.51' N 448.59'; N 49-48- 15 W ON S B/L CO RD 390.66'; TH S 18-26-53 W 754.19' TO POB					Building Permits <table border="1"> <thead> <tr> <th>Number</th> <th>Description</th> <th>Opened</th> <th>Closed</th> <th>Amount</th> </tr> </thead> <tbody> <tr><td> </td><td> </td><td> </td><td> </td><td> </td></tr> <tr><td> </td><td> </td><td> </td><td> </td><td> </td></tr> <tr><td> </td><td> </td><td> </td><td> </td><td> </td></tr> <tr><td> </td><td> </td><td> </td><td> </td><td> </td></tr> <tr><td> </td><td> </td><td> </td><td> </td><td> </td></tr> </tbody> </table>					Number	Description	Opened	Closed	Amount																																																																																																											
Number	Description	Opened	Closed	Amount																																																																																																																					
Exemptions <table border="1"> <thead> <tr> <th>Code</th> <th>Type</th> <th>Active</th> <th>Maximum</th> <th>Exemption</th> </tr> </thead> <tbody> <tr> <td>H</td> <td>Homestead</td> <td>No</td> <td>1,000</td> <td> </td> </tr> </tbody> </table>					Code	Type	Active	Maximum	Exemption	H	Homestead	No	1,000		Sale History <table border="1"> <thead> <tr> <th>Bk/Pg</th> <th>Grantor</th> <th>Date</th> <th>Price</th> <th>Code</th> </tr> </thead> <tbody> <tr> <td>/</td> <td>KELLEY, KYLE</td> <td>05/27/2022</td> <td>98,500</td> <td>YES</td> </tr> <tr> <td>2412/220</td> <td>US BANK NA</td> <td>07/02/2014</td> <td>0</td> <td>3</td> </tr> <tr> <td>2412/225</td> <td>ESTES, EDWARD</td> <td>06/12/2014</td> <td>37,500</td> <td>YES</td> </tr> <tr> <td>2360/95</td> <td>CHAISSON, MICHAEL</td> <td>09/25/2013</td> <td>0</td> <td>10</td> </tr> <tr> <td>1148/801</td> <td>RADLEY, STEPHEN F II &</td> <td>12/22/1998</td> <td>83,000</td> <td>No</td> </tr> </tbody> </table>					Bk/Pg	Grantor	Date	Price	Code	/	KELLEY, KYLE	05/27/2022	98,500	YES	2412/220	US BANK NA	07/02/2014	0	3	2412/225	ESTES, EDWARD	06/12/2014	37,500	YES	2360/95	CHAISSON, MICHAEL	09/25/2013	0	10	1148/801	RADLEY, STEPHEN F II &	12/22/1998	83,000	No																																																																								
Code	Type	Active	Maximum	Exemption																																																																																																																					
H	Homestead	No	1,000																																																																																																																						
Bk/Pg	Grantor	Date	Price	Code																																																																																																																					
/	KELLEY, KYLE	05/27/2022	98,500	YES																																																																																																																					
2412/220	US BANK NA	07/02/2014	0	3																																																																																																																					
2412/225	ESTES, EDWARD	06/12/2014	37,500	YES																																																																																																																					
2360/95	CHAISSON, MICHAEL	09/25/2013	0	10																																																																																																																					
1148/801	RADLEY, STEPHEN F II &	12/22/1998	83,000	No																																																																																																																					
Parcel Valuation <table border="1"> <thead> <tr> <th>Source</th> <th>REAL</th> <th>Fair Cash</th> <th>Capped</th> <th>Asmnt Level</th> <th>Assessed</th> <th>Levy Rate</th> <th>101.660</th> <th>Current Tax</th> </tr> </thead> <tbody> <tr> <td>Remove Cap</td> <td>2023</td> <td>Land Value 86,266</td> <td>86,266</td> <td>11%</td> <td>9,489</td> <td>Assessed</td> <td>12,543</td> <td>1,275.12</td> </tr> <tr> <td>Year Frozen</td> <td>0</td> <td>Improvements 37,949</td> <td>27,759</td> <td> </td> <td>3,054</td> <td>Penalty</td> <td>0</td> <td> </td> </tr> <tr> <td>Uncapped Value</td> <td>0</td> <td>Mobile Home 0</td> <td>0</td> <td> </td> <td>0</td> <td>Exemption</td> <td>0</td> <td>0.00</td> </tr> <tr> <td>TIF Project ID</td> <td>0</td> <td>Total Value 124,215</td> <td>114,025</td> <td> </td> <td>12,543</td> <td>Total Taxable</td> <td>12,543</td> <td>1,275.00</td> </tr> </tbody> </table>										Source	REAL	Fair Cash	Capped	Asmnt Level	Assessed	Levy Rate	101.660	Current Tax	Remove Cap	2023	Land Value 86,266	86,266	11%	9,489	Assessed	12,543	1,275.12	Year Frozen	0	Improvements 37,949	27,759		3,054	Penalty	0		Uncapped Value	0	Mobile Home 0	0		0	Exemption	0	0.00	TIF Project ID	0	Total Value 124,215	114,025		12,543	Total Taxable	12,543	1,275.00																																																																			
Source	REAL	Fair Cash	Capped	Asmnt Level	Assessed	Levy Rate	101.660	Current Tax																																																																																																																	
Remove Cap	2023	Land Value 86,266	86,266	11%	9,489	Assessed	12,543	1,275.12																																																																																																																	
Year Frozen	0	Improvements 37,949	27,759		3,054	Penalty	0																																																																																																																		
Uncapped Value	0	Mobile Home 0	0		0	Exemption	0	0.00																																																																																																																	
TIF Project ID	0	Total Value 124,215	114,025		12,543	Total Taxable	12,543	1,275.00																																																																																																																	
Assessment History <table border="1"> <thead> <tr> <th>Tax Year</th> <th>Statement Number</th> <th>Billed Owner</th> <th>Tax Area</th> <th>Total Value</th> <th>Exemptions</th> <th>Taxable Value</th> <th>Billed Tax</th> </tr> </thead> <tbody> <tr><td>2025</td><td>2025-660026090</td><td>WILSON, CALEB & SAMANTHA</td><td>70</td><td>124,647</td><td>0</td><td>11,945</td><td>1,214.00</td></tr> <tr><td>2024</td><td>2024-660026090</td><td>WILSON, CALEB & SAMANTHA</td><td>70</td><td>108,929</td><td>0</td><td>11,376</td><td>1,186.00</td></tr> <tr><td>2023</td><td>2023-660026090</td><td>WILSON, CALEB & SAMANTHA</td><td>70</td><td>98,500</td><td>0</td><td>10,835</td><td>1,130.00</td></tr> <tr><td>2022</td><td>2022-660026090</td><td>WILSON, CALEB & SAMANTHA</td><td>70</td><td>63,895</td><td>0</td><td>6,534</td><td>684.00</td></tr> <tr><td>2021</td><td>2021-660026090</td><td>KELLEY, KYLE</td><td>70</td><td>64,628</td><td>0</td><td>6,223</td><td>634.00</td></tr> <tr><td>2020</td><td>2020-660026090</td><td>KELLEY, KYLE</td><td>70</td><td>56,706</td><td>0</td><td>5,927</td><td>628.00</td></tr> <tr><td>2019</td><td>2019-660026090</td><td>KELLEY, KYLE</td><td>70</td><td>51,316</td><td>0</td><td>5,645</td><td>600.00</td></tr> <tr><td>2018</td><td>2018-660026090</td><td>KELLEY, KYLE</td><td>70</td><td>53,111</td><td>0</td><td>5,842</td><td>609.00</td></tr> <tr><td>2017</td><td>2017-660026090</td><td>KELLEY, KYLE</td><td>70</td><td>51,614</td><td>0</td><td>5,678</td><td>594.00</td></tr> <tr><td>2016</td><td>2016-660026090</td><td>KELLEY, KYLE</td><td>70</td><td>51,975</td><td>0</td><td>5,717</td><td>619.00</td></tr> <tr><td>2015</td><td>2015-660026090</td><td>KELLEY, KYLE</td><td>70</td><td>51,588</td><td>0</td><td>5,675</td><td>609.00</td></tr> <tr><td>2014</td><td>2014-660026090</td><td>KELLEY, KYLE</td><td>70</td><td>49,888</td><td>0</td><td>5,488</td><td>580.00</td></tr> <tr><td>2013</td><td>2013-660026090</td><td>CHAISSON, MICHAEL</td><td>70</td><td>49,108</td><td>1000</td><td>4,402</td><td>471.00</td></tr> </tbody> </table>										Tax Year	Statement Number	Billed Owner	Tax Area	Total Value	Exemptions	Taxable Value	Billed Tax	2025	2025-660026090	WILSON, CALEB & SAMANTHA	70	124,647	0	11,945	1,214.00	2024	2024-660026090	WILSON, CALEB & SAMANTHA	70	108,929	0	11,376	1,186.00	2023	2023-660026090	WILSON, CALEB & SAMANTHA	70	98,500	0	10,835	1,130.00	2022	2022-660026090	WILSON, CALEB & SAMANTHA	70	63,895	0	6,534	684.00	2021	2021-660026090	KELLEY, KYLE	70	64,628	0	6,223	634.00	2020	2020-660026090	KELLEY, KYLE	70	56,706	0	5,927	628.00	2019	2019-660026090	KELLEY, KYLE	70	51,316	0	5,645	600.00	2018	2018-660026090	KELLEY, KYLE	70	53,111	0	5,842	609.00	2017	2017-660026090	KELLEY, KYLE	70	51,614	0	5,678	594.00	2016	2016-660026090	KELLEY, KYLE	70	51,975	0	5,717	619.00	2015	2015-660026090	KELLEY, KYLE	70	51,588	0	5,675	609.00	2014	2014-660026090	KELLEY, KYLE	70	49,888	0	5,488	580.00	2013	2013-660026090	CHAISSON, MICHAEL	70	49,108	1000	4,402	471.00
Tax Year	Statement Number	Billed Owner	Tax Area	Total Value	Exemptions	Taxable Value	Billed Tax																																																																																																																		
2025	2025-660026090	WILSON, CALEB & SAMANTHA	70	124,647	0	11,945	1,214.00																																																																																																																		
2024	2024-660026090	WILSON, CALEB & SAMANTHA	70	108,929	0	11,376	1,186.00																																																																																																																		
2023	2023-660026090	WILSON, CALEB & SAMANTHA	70	98,500	0	10,835	1,130.00																																																																																																																		
2022	2022-660026090	WILSON, CALEB & SAMANTHA	70	63,895	0	6,534	684.00																																																																																																																		
2021	2021-660026090	KELLEY, KYLE	70	64,628	0	6,223	634.00																																																																																																																		
2020	2020-660026090	KELLEY, KYLE	70	56,706	0	5,927	628.00																																																																																																																		
2019	2019-660026090	KELLEY, KYLE	70	51,316	0	5,645	600.00																																																																																																																		
2018	2018-660026090	KELLEY, KYLE	70	53,111	0	5,842	609.00																																																																																																																		
2017	2017-660026090	KELLEY, KYLE	70	51,614	0	5,678	594.00																																																																																																																		
2016	2016-660026090	KELLEY, KYLE	70	51,975	0	5,717	619.00																																																																																																																		
2015	2015-660026090	KELLEY, KYLE	70	51,588	0	5,675	609.00																																																																																																																		
2014	2014-660026090	KELLEY, KYLE	70	49,888	0	5,488	580.00																																																																																																																		
2013	2013-660026090	CHAISSON, MICHAEL	70	49,108	1000	4,402	471.00																																																																																																																		



Rogers

Assessment Property Record Card for Tax Year 2026

Data provided by LISA DELOZIER County Assessor

Date 04/17/2026
 Time 04:37:36
 Page 2

Lot Data		Square-Foot - NBHD 4070 #1		Primary Image				
Lot Size								
Lot Count								
Units Buildable	6							
Non-Ag Acres	0							
Topography								
Street Access								
Utilities								
Amenities	LAND QUALITY		0					
			0					
Method	Square-Foot							
Base Lot Value	257,944.00 x .33 = 86,266							
Factor Value								
Adjustments	1.0000							
Lot Value	86,266							
Residential Data								
Type								
Condition	-							
Quality	-							
Architecture								
Style								
Exterior Wall								
Base/Total Area	/			GRM Approach				
Style				GRM Code				
HVAC				Gross Rent 0.00				
Roof Cover				Indicated Value				
Area on Slab				Multiple Regression				
Fixture/RghIn	/			MRA Code				
Bed/F/H Bath	/ /			Adusted R				
Basement Area				Indicated Value				
Garage Type				Direct Comparables				
Remodel				Selection Model 1 Res				
Year/Eff Age	/			Adjustment Model A2 AO Test				
Cost Approach		Manual : 01/2025						
Base Cost	0.00	Total Misc Impr	+ 0					
Roofing Adj	+ 0.00	Garage Cost	+ 0					
Subfloor Adj	+ 0.00	Total RCN	= 0					
Heat/Cool Adj	+ 0.00	Depreciation (0%)	- 0					
Plumbing Adj	+ 0.00	Lump Sums	+ 0					
Basement Adj	+ 0.00	RCNLD	= 0					
Adj Base Cost	= 0.00	Lot Value	+ 86,266					
Total Area	x	Indicated Value	= 86,266					
Adjusted Cost	= 0	Value Per SqFt	0.00					
				Value Reconciliation				
				Selected Approach Cost Approach				
				Improvements				
				Lot Value 86,266				
				Indicated Value 86,266 0.00 Per SqFt				
				Agland Value				
				Site Improvements 7,121				
				Total Value 93,387 0.00 Total Value Per SqFt				
Miscellaneous Improvements								
Code	Description	Sketch ID	Size	Year	Units	Unit Cost	Depr	Value



Rogers

Assessment Property Record Card for Tax Year 2026

Data provided by LISA DELOZIER County Assessor

Date 04/17/2026
Time 04:37:37
Page 3

660026090

Outbuildings/Site Improvements

Building Image	Code	Description	Dimensions	Floor	Roofing	Total Units		
	BNGP	Barn - General Purpose	40x20x8	Dirt	Formed Metal	800		
	Qual	3	Cond	3	Year	2000	Eff Age	20
	Valuation Summary		Modifier Total		RCN	Depr (65% Phys/ 0% Func)	RCNLD	
Base Cost (21.86 x 800)		17,488			17,488	11,367	6,121	
	SHDS	Shed - Small	10x16x6	Plank	Galvanized Metal	160		
	Qual	2	Cond	2	Year	2000	Eff Age	26
	Valuation Summary		Modifier Total		RCN	Depr (70% Phys/ 100% Func)	RCNLD	
Base Cost (18.89 x 160)		3,022			3,022	3,022		
	SHIP	Shipping/Storage Container	8x20x8	Plank		160		
	Qual	3	Cond	3	Year	0	Eff Age	0
	Valuation Summary		Modifier Total		RCN	Depr (0% Phys/ % Func)	RCNLD	
Base Cost (6.25 x 160)		1,000			1,000		1,000	



Rogers

Assessment Property Record Card for Tax Year 2026

Data provided by LISA DELOZIER County Assessor

Date 04/17/2026
 Time 04:37:37
 Page 4

Lot Data	
Lot Size	-
Lot Count	
Units Buildable	
Non-Ag Acres	
Topography	
Street Access	
Utilities	
Amenities	LAND QUALITY
Method	
Base Lot Value	
Factor Value	
Adjustments	
Lot Value	

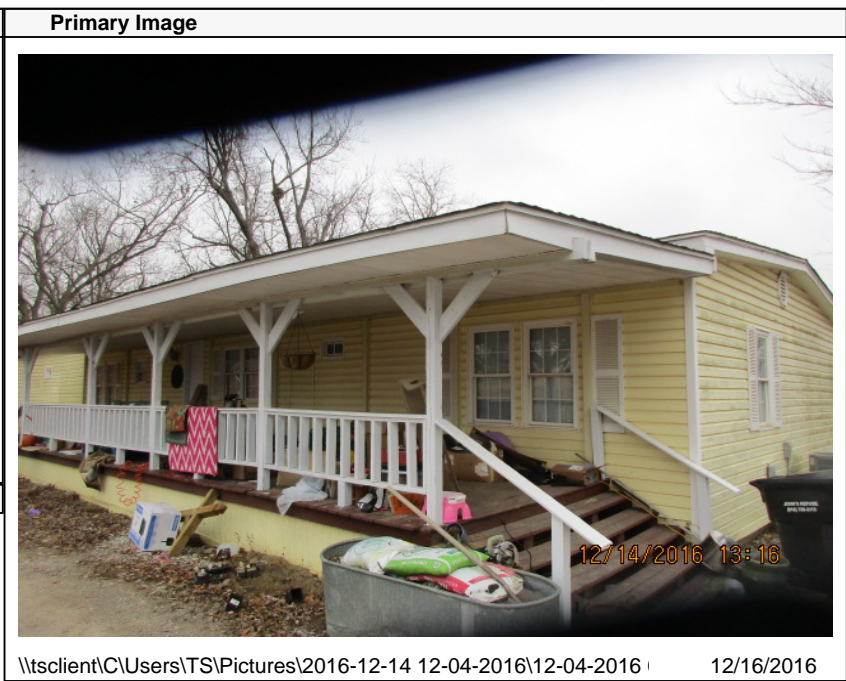

\\tsclient\C\Users\TS\Pictures\2016-12-14 12-04-2016\12-04-2016 12/16/2016

Residential Data	
Type	6 Mobile Home 68 x 28
Condition	4 - Good
Quality	3 - Average
Architecture	6 MS ADJ
Style	100% Double Wide
Exterior Wall	100% Frame, Siding, Vinyl
Base/Total Area	1,904 / 1,904
Style	100% Double Wide
HVAC	100% Warmed & Cooled Air 2 Wall Air Conditioner
Roof Cover	1 Composition Shingle
Area on Slab	0
Fixture/RghIn	/
Bed/F/H Bath	3 / 2.0 /
Basement Area	
Garage Type	
Remodel	
Year/Eff Age	1978 / 29

GRM Approach

GRM Code	
Gross Rent	0.00
Indicated Value	

Multiple Regression

MRA Code	
Adjusted R	
Indicated Value	

Direct Comparables

Selection Model	1 Res
Adjustment Model	A2 AO Test
Comparables	
Indicated Value	

Value Reconciliation

Selected Approach	Cost Approach
Improvements	30,828
Lot Value	
Indicated Value	30,828
Agland Value	16.19 Per SqFt
Site Improvements	
Total Value	30,828
	16.19 Total Value Per SqFt

Cost Approach		Manual : 01/2025	
Base Cost	32.16	Total Misc Impr	+ 6,024
Roofing Adj	+ 2.51	Garage Cost	+
Subfloor Adj	+ 0.00	Total RCN	= 87,020
Heat/Cool Adj	+ 2.28	Depreciation (73%)	- 63,525
Plumbing Adj	+ 5.59	Lump Sums	+ 7,333
Basement Adj	+ 0.00	RCNLD	= 30,828
Adj Base Cost	= 42.54	Lot Value	+
Total Area	x 1,904	Indicated Value	= 30,828
Adjusted Cost	= 80,996	Value Per SqFt	16.19

Miscellaneous Improvements

Code	Description	Sketch ID	Size	Year	Units	Unit Cost	Depr	Value
EPSW	ENCLOSED PORCH - SOLID WALL	132525	12x12		144	41.83		6,024
WODO	WOOD DECK - OPEN	132526	55x10		550	16.95	60%	3,729
WODO	WOOD DECK - OPEN	132527	24x10		240	20.02	25%	3,604



Rogers

Assessment Property Record Card for Tax Year 2026

Data provided by LISA DELOZIER County Assessor

Date 04/17/2026
 Time 04:37:37
 Page 5

Sketch Image

660026090



Sketch Vector Information

Sequence	Code	Type	Built Over	Scale	Section Label	Base Area	Multiplier	Total Area
1	R	14		13	Doublewide	1,904	1.000	1,904
2	M	EPSW		13	EPSW	144	1.000	144
3	M	WODO		13	WODO	550	1.000	550
4	M	WODO		13	WODO	240	1.000	240
Total Building Area						1,904		1,904