



# Rogers

## Assessment Property Record Card for Tax Year 2026

Data provided by LISA DELOZIER County Assessor

Date 04/16/2026  
 Time 23:45:53  
 Page 1

Assessment Data					Primary Image																																																																																																																				
<b>Account</b> 660026195 <b>Parcel ID</b> 000000-00-0-30010-006-0004 <b>Cadastral ID</b> 30-24-18-00240 <b>Property Type</b> REAL - Real Property <b>Property Class</b> URP VI Area 2 <b>Tax Area</b> 29 - CHELSEA OT <b>Name ID</b> 340273 PROUT, JAMES & JULIA  18123 E 410 RD CLAREMORE OK 74017-0000  <b>Parcel Location</b> <b>Situs</b> 00306 OAK ST <b>Subdivision</b> CHELSEA O T <b>Lot/Block</b> 0004 / 0006 <b>Parcel Size</b> 1.5 - Lots <b>Sec/Twn/Rng</b> 30 / 24 / 18 / 5 <b>Neighborhood</b> 1195 - R-V02-NE CHELSEA <b>School District</b> S003 - CHELSEA SCHOOLS																																																																																																																									
<b>Legal Description</b> Lat/Long: 36.53336594 -95.42060015 ALL OF LOT 4 LESS SWLY 55' BLOCK 6 CHELSEA O T																																																																																																																									
<b>Exemptions</b> <table border="1"> <thead> <tr> <th>Code</th> <th>Type</th> <th>Active</th> <th>Maximum</th> <th>Exemption</th> </tr> </thead> <tbody> <tr> <td>H</td> <td>Homestead</td> <td>No</td> <td>1,000</td> <td></td> </tr> </tbody> </table>					Code	Type	Active	Maximum	Exemption	H	Homestead	No	1,000		<b>Building Permits</b> <table border="1"> <thead> <tr> <th>Number</th> <th>Description</th> <th>Opened</th> <th>Closed</th> <th>Amount</th> </tr> </thead> <tbody> <tr> <td></td> <td></td> <td></td> <td></td> <td></td> </tr> </tbody> </table>					Number	Description	Opened	Closed	Amount																																																																																																	
Code	Type	Active	Maximum	Exemption																																																																																																																					
H	Homestead	No	1,000																																																																																																																						
Number	Description	Opened	Closed	Amount																																																																																																																					
<b>Parcel Valuation</b> <table border="1"> <thead> <tr> <th>Source</th> <th>REAL</th> <th>Fair Cash</th> <th>Capped</th> <th>Asmnt Level</th> <th>Assessed</th> <th>Levy Rate</th> <th>82.750</th> <th>Current Tax</th> </tr> </thead> <tbody> <tr> <td>Remove Cap</td> <td>2023</td> <td>Land Value</td> <td>9,097</td> <td>5,072</td> <td>11%</td> <td>558</td> <td>Assessed</td> <td>2,547</td> <td>210.76</td> </tr> <tr> <td>Year Frozen</td> <td>0</td> <td>Improvements</td> <td>18,210</td> <td>18,080</td> <td></td> <td>1,989</td> <td>Penalty</td> <td>0</td> <td></td> </tr> <tr> <td>Uncapped Value</td> <td>0</td> <td>Mobile Home</td> <td>0</td> <td>0</td> <td></td> <td>0</td> <td>Exemption</td> <td>0</td> <td>0.00</td> </tr> <tr> <td>TIF Project ID</td> <td>0</td> <td>Total Value</td> <td>27,307</td> <td>23,152</td> <td></td> <td>2,547</td> <td>Total Taxable</td> <td>2,547</td> <td>211.00</td> </tr> </tbody> </table>					Source	REAL	Fair Cash	Capped	Asmnt Level	Assessed	Levy Rate	82.750	Current Tax	Remove Cap	2023	Land Value	9,097	5,072	11%	558	Assessed	2,547	210.76	Year Frozen	0	Improvements	18,210	18,080		1,989	Penalty	0		Uncapped Value	0	Mobile Home	0	0		0	Exemption	0	0.00	TIF Project ID	0	Total Value	27,307	23,152		2,547	Total Taxable	2,547	211.00	<b>Sale History</b> <table border="1"> <thead> <tr> <th>Bk/Pg</th> <th>Grantor</th> <th>Date</th> <th>Price</th> <th>Code</th> </tr> </thead> <tbody> <tr> <td>/</td> <td>OWENS, LAURA SHORT &amp;</td> <td>11/25/2022</td> <td>20,000</td> <td>4</td> </tr> <tr> <td>/</td> <td>SHORT, WILMER H</td> <td>05/10/2007</td> <td>0</td> <td>4</td> </tr> </tbody> </table>					Bk/Pg	Grantor	Date	Price	Code	/	OWENS, LAURA SHORT &	11/25/2022	20,000	4	/	SHORT, WILMER H	05/10/2007	0	4																																																
Source	REAL	Fair Cash	Capped	Asmnt Level	Assessed	Levy Rate	82.750	Current Tax																																																																																																																	
Remove Cap	2023	Land Value	9,097	5,072	11%	558	Assessed	2,547	210.76																																																																																																																
Year Frozen	0	Improvements	18,210	18,080		1,989	Penalty	0																																																																																																																	
Uncapped Value	0	Mobile Home	0	0		0	Exemption	0	0.00																																																																																																																
TIF Project ID	0	Total Value	27,307	23,152		2,547	Total Taxable	2,547	211.00																																																																																																																
Bk/Pg	Grantor	Date	Price	Code																																																																																																																					
/	OWENS, LAURA SHORT &	11/25/2022	20,000	4																																																																																																																					
/	SHORT, WILMER H	05/10/2007	0	4																																																																																																																					
<b>Assessment History</b> <table border="1"> <thead> <tr> <th>Tax Year</th> <th>Statement Number</th> <th>Billed Owner</th> <th>Tax Area</th> <th>Total Value</th> <th>Exemptions</th> <th>Taxable Value</th> <th>Billed Tax</th> </tr> </thead> <tbody> <tr><td>2025</td><td>2025-660026195</td><td>PROUT, JAMES &amp; JULIA</td><td>29</td><td>26,334</td><td>0</td><td>2,425</td><td>201.00</td></tr> <tr><td>2024</td><td>2024-660026195</td><td>PROUT, JAMES &amp; JULIA</td><td>29</td><td>27,601</td><td>0</td><td>2,310</td><td>195.00</td></tr> <tr><td>2023</td><td>2023-660026195</td><td>PROUT, JAMES &amp; JULIA</td><td>29</td><td>20,000</td><td>0</td><td>2,200</td><td>188.00</td></tr> <tr><td>2022</td><td>2022-660026195</td><td>OWENS, LAURA SHORT &amp;</td><td>29</td><td>15,645</td><td>1000</td><td>721</td><td>61.00</td></tr> <tr><td>2021</td><td>2021-660026195</td><td>SHORT, WILMER H</td><td>29</td><td>16,237</td><td>1000</td><td>694</td><td>59.00</td></tr> <tr><td>2020</td><td>2020-660026195</td><td>SHORT, WILMER H</td><td>29</td><td>15,166</td><td>1000</td><td>645</td><td>55.00</td></tr> <tr><td>2019</td><td>2019-660026195</td><td>SHORT, WILMER H</td><td>29</td><td>14,517</td><td>1000</td><td>597</td><td>51.00</td></tr> <tr><td>2018</td><td>2018-660026195</td><td>SHORT, WILMER H</td><td>29</td><td>14,650</td><td>1000</td><td>611</td><td>52.00</td></tr> <tr><td>2017</td><td>2017-660026195</td><td>SHORT, WILMER H</td><td>29</td><td>14,548</td><td>1000</td><td>600</td><td>51.00</td></tr> <tr><td>2016</td><td>2016-660026195</td><td>SHORT, WILMER H</td><td>29</td><td>19,834</td><td>1000</td><td>1,182</td><td>103.00</td></tr> <tr><td>2015</td><td>2015-660026195</td><td>SHORT, WILMER H</td><td>29</td><td>19,634</td><td>1000</td><td>1,160</td><td>100.00</td></tr> <tr><td>2014</td><td>2014-660026195</td><td>SHORT, WILMER H</td><td>29</td><td>20,365</td><td>1000</td><td>1,197</td><td>107.00</td></tr> <tr><td>2013</td><td>2013-660026195</td><td>SHORT, WILMER H</td><td>29</td><td>21,090</td><td>1000</td><td>1,133</td><td>101.00</td></tr> </tbody> </table>										Tax Year	Statement Number	Billed Owner	Tax Area	Total Value	Exemptions	Taxable Value	Billed Tax	2025	2025-660026195	PROUT, JAMES & JULIA	29	26,334	0	2,425	201.00	2024	2024-660026195	PROUT, JAMES & JULIA	29	27,601	0	2,310	195.00	2023	2023-660026195	PROUT, JAMES & JULIA	29	20,000	0	2,200	188.00	2022	2022-660026195	OWENS, LAURA SHORT &	29	15,645	1000	721	61.00	2021	2021-660026195	SHORT, WILMER H	29	16,237	1000	694	59.00	2020	2020-660026195	SHORT, WILMER H	29	15,166	1000	645	55.00	2019	2019-660026195	SHORT, WILMER H	29	14,517	1000	597	51.00	2018	2018-660026195	SHORT, WILMER H	29	14,650	1000	611	52.00	2017	2017-660026195	SHORT, WILMER H	29	14,548	1000	600	51.00	2016	2016-660026195	SHORT, WILMER H	29	19,834	1000	1,182	103.00	2015	2015-660026195	SHORT, WILMER H	29	19,634	1000	1,160	100.00	2014	2014-660026195	SHORT, WILMER H	29	20,365	1000	1,197	107.00	2013	2013-660026195	SHORT, WILMER H	29	21,090	1000	1,133	101.00
Tax Year	Statement Number	Billed Owner	Tax Area	Total Value	Exemptions	Taxable Value	Billed Tax																																																																																																																		
2025	2025-660026195	PROUT, JAMES & JULIA	29	26,334	0	2,425	201.00																																																																																																																		
2024	2024-660026195	PROUT, JAMES & JULIA	29	27,601	0	2,310	195.00																																																																																																																		
2023	2023-660026195	PROUT, JAMES & JULIA	29	20,000	0	2,200	188.00																																																																																																																		
2022	2022-660026195	OWENS, LAURA SHORT &	29	15,645	1000	721	61.00																																																																																																																		
2021	2021-660026195	SHORT, WILMER H	29	16,237	1000	694	59.00																																																																																																																		
2020	2020-660026195	SHORT, WILMER H	29	15,166	1000	645	55.00																																																																																																																		
2019	2019-660026195	SHORT, WILMER H	29	14,517	1000	597	51.00																																																																																																																		
2018	2018-660026195	SHORT, WILMER H	29	14,650	1000	611	52.00																																																																																																																		
2017	2017-660026195	SHORT, WILMER H	29	14,548	1000	600	51.00																																																																																																																		
2016	2016-660026195	SHORT, WILMER H	29	19,834	1000	1,182	103.00																																																																																																																		
2015	2015-660026195	SHORT, WILMER H	29	19,634	1000	1,160	100.00																																																																																																																		
2014	2014-660026195	SHORT, WILMER H	29	20,365	1000	1,197	107.00																																																																																																																		
2013	2013-660026195	SHORT, WILMER H	29	21,090	1000	1,133	101.00																																																																																																																		



# Rogers

## Assessment Property Record Card for Tax Year 2026

Data provided by LISA DELOZIER County Assessor

Date 04/16/2026  
 Time 23:45:53  
 Page 2

Lot Data	Square-Foot - NBHD 1195 #1	Primary Image
<b>Lot Size</b> <b>Lot Count</b> <b>Units Buildable</b> 1 <b>Non-Ag Acres</b> 0.1899 <b>Topography</b> <b>Street Access</b> <b>Utilities</b> <b>Amenities</b> LAND QUALITY 0 0 <b>Method</b> Square-Foot <b>Base Lot Value</b> 8,270.00 x 1.10 = 9,097 <b>Factor Value</b> <b>Adjustments</b> 1.0000 <b>Lot Value</b> 9,097		

Residential Data	
<b>Type</b>	1 Single Family Residence
<b>Condition</b>	2 - Fair
<b>Quality</b>	1 - Low
<b>Architecture</b>	
<b>Style</b>	100% One Story
<b>Exterior Wall</b>	100% Frame, Siding, Wood
<b>Base/Total Area</b>	816 / 816
<b>Style</b>	100% One Story
<b>HVAC</b>	
<b>Roof Cover</b>	1 Composition Shingle
<b>Area on Slab</b>	0
<b>Fixture/RghIn</b>	4 /
<b>Bed/F/H Bath</b>	2 / 1.0 /
<b>Basement Area</b>	
<b>Garage Type</b>	
<b>Remodel</b>	
<b>Year/Eff Age</b>	1940 / 86



GRM Approach	
<b>GRM Code</b>	
<b>Gross Rent</b>	0.00
<b>Indicated Value</b>	

Multiple Regression	
<b>MRA Code</b>	1 Test
<b>Adusted R</b>	0.8445
<b>Indicated Value</b>	15,475 18.96 Per SqFt

Direct Comparables	
<b>Selection Model</b>	A Adam Test
<b>Adjustment Model</b>	1 2022 Residential
<b>Comparables</b>	8
<b>Indicated Value</b>	28,320 Per SqFt

Cost Approach				Manual : 01/2025	
<b>Base Cost</b>	91.08	<b>Total Misc Impr</b>	+	2,384	
<b>Roofing Adj</b>	+ 4.31	<b>Garage Cost</b>	+		
<b>Subfloor Adj</b>	+ 2.67	<b>Total RCN</b>	=	87,020	
<b>Heat/Cool Adj</b>	+ 0.00	<b>Depreciation ( 80%)</b>	-	69,616	
<b>Plumbing Adj</b>	+ 5.66	<b>Lump Sums</b>	+	0	
<b>Basement Adj</b>	+ 0.00	<b>RCNLD</b>	=	17,404	
<b>Adj Base Cost</b>	= 103.72	<b>Lot Value</b>	+	9,097	
<b>Total Area</b>	x 816	<b>Indicated Value</b>	=	26,501	
<b>Adjusted Cost</b>	= 84,636	<b>Value Per SqFt</b>		32.48	

Value Reconciliation	
<b>Selected Approach</b>	Cost Approach
<b>Improvements</b>	17,404
<b>Lot Value</b>	9,097
<b>Indicated Value</b>	26,501 32.48 Per SqFt
<b>Agland Value</b>	
<b>Site Improvements</b>	806
<b>Total Value</b>	27,307 33.46 Total Value Per SqFt

Miscellaneous Improvements								
Code	Description	Sketch ID	Size	Year	Units	Unit Cost	Depr	Value
PRCH	SLAB PORCH - COVERED	63880	22x6		132	18.06		2,384



# Rogers

## Assessment Property Record Card for Tax Year 2026

Data provided by LISA DELOZIER County Assessor

Date 04/16/2026

Time 23:45:53

Page 3

### Sketch Image

660026195

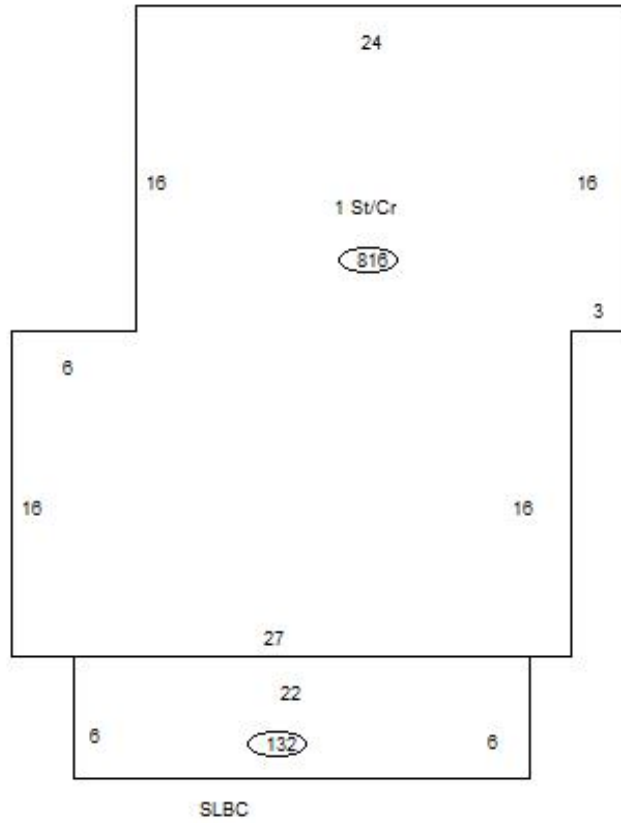

### Sketch Vector Information

Sequence	Code	Type	Built Over	Scale	Section Label	Base Area	Multiplier	Total Area
1	R	1	Crawl	10	1 St/Cr	816	1.000	816
2	M	PRCH		10	SLBC	132	1.000	132
<b>Total Building Area</b>						816		816



# Rogers





## Assessment Property Record Card for Tax Year 2026

Data provided by LISA DELOZIER County Assessor

Date 04/16/2026  
Time 23:45:53  
Page 4

660026195

### Outbuildings/Site Improvements

Building Image	Code	Description	Dimensions	Floor	Roofing	Total Units
	CP	Carport Dirt	24x32x0			768
	Qual 2	Cond 2	Year	Eff Age		
		<b>Valuation Summary</b>	<b>Modifier Total</b>	<b>RCN</b>	<b>Depr (70% Phys/ % Func)</b>	<b>RCNLD</b>
		Base Cost (3.50 x 768)	2,688		2,688	1,882
	STF	STG FAIR	0x0x0			
	Qual 2	Cond	Year	Eff Age		
		<b>Valuation Summary</b>	<b>Modifier Total</b>	<b>RCN</b>	<b>Depr (100% Phys/ % Func)</b>	<b>RCNLD</b>
		Base Cost (4.68 x )				806
	STF	STG FAIR	0x0x0			
	Qual 2	Cond	Year	Eff Age		
		<b>Valuation Summary</b>	<b>Modifier Total</b>	<b>RCN</b>	<b>Depr (100% Phys/ % Func)</b>	<b>RCNLD</b>
		Base Cost (4.68 x )				
	STF	STG FAIR	0x0x0			
	Qual 2	Cond	Year	Eff Age		
		<b>Valuation Summary</b>	<b>Modifier Total</b>	<b>RCN</b>	<b>Depr (100% Phys/ % Func)</b>	<b>RCNLD</b>
		Base Cost (4.68 x )				