



# Rogers

## Assessment Property Record Card for Tax Year 2026

Data provided by LISA DELOZIER County Assessor

Date 04/18/2026  
 Time 06:36:37  
 Page 1

Assessment Data					Primary Image																																																	
<b>Account</b> 660026212 <b>Parcel ID</b> 000000-00-0-30010-008-0006 <b>Cadastral ID</b> 30-24-18-00410 <b>Property Type</b> REAL - Real Property <b>Property Class</b> URP VI Area 2 <b>Tax Area</b> 29 - CHELSEA OT <b>Name ID</b> 337405 DONELSON, MICHELLE & CASEY L WOOTEN  211 ELM ST CHELSEA OK 74016-0000  <b>Parcel Location</b> <b>Situs</b> 00211 ELM ST <b>Subdivision</b> CHELSEA O T <b>Lot/Block</b> 0006 / 0008 <b>Parcel Size</b> 1 - Lots <b>Sec/Twn/Rng</b> 30 / 24 / 18 / 5 <b>Neighborhood</b> 1195 - R-V02-NE CHELSEA <b>School District</b> S003 - CHELSEA SCHOOLS																																																						
<b>Legal Description</b> Lot/Long: 36.53393272 -95.42250491										<b>Building Permits</b>																																												
LOT 6 BLOCK 8 CHELSEA O T					<table border="1"> <thead> <tr> <th>Number</th> <th>Description</th> <th>Opened</th> <th>Closed</th> <th>Amount</th> </tr> </thead> <tbody> <tr> <td></td> <td></td> <td></td> <td></td> <td></td> </tr> </tbody> </table>					Number	Description	Opened	Closed	Amount																																								
Number	Description	Opened	Closed	Amount																																																		
<b>Exemptions</b>					<b>Sale History</b>																																																	
<b>Code</b>	<b>Type</b>	<b>Active</b>	<b>Maximum</b>	<b>Exemption</b>	<b>Bk/Pg</b>	<b>Grantor</b>	<b>Date</b>	<b>Price</b>	<b>Code</b>																																													
					/	HUCKABY, JIM BOB JR &	02/18/2022	0	4																																													
					2168/697	FEDERAL NATIONAL MORTGAGE-AS:	04/15/2011	16,000	3																																													
					2150/288	PATTON, TIMOTHY G	12/27/2010	0	10																																													
					1741/855	SMITH, ALICE	12/19/2005	45,500	YES																																													
					875/799	SELLER	03/06/1992	0	No																																													
<b>Parcel Valuation</b>					<table border="1"> <thead> <tr> <th>Source</th> <th>REAL</th> <th>Fair Cash</th> <th>Capped</th> <th>Asmnt Level</th> <th>Assessed</th> <th>Levy Rate</th> <th>82.750</th> <th>Current Tax</th> </tr> </thead> <tbody> <tr> <td>Remove Cap</td> <td>0</td> <td>Land Value 15,908</td> <td>8,782</td> <td>11%</td> <td>966</td> <td>Assessed</td> <td>3,923</td> <td>324.63</td> </tr> <tr> <td>Year Frozen</td> <td>0</td> <td>Improvements 31,039</td> <td>26,886</td> <td></td> <td>2,957</td> <td>Penalty</td> <td>0</td> <td></td> </tr> <tr> <td>Uncapped Value</td> <td>0</td> <td>Mobile Home 0</td> <td>0</td> <td></td> <td>0</td> <td>Exemption</td> <td>0</td> <td>0.00</td> </tr> <tr> <td>TIF Project ID</td> <td>0</td> <td>Total Value 46,947</td> <td>35,668</td> <td></td> <td>3,923</td> <td>Total Taxable</td> <td>3,923</td> <td>325.00</td> </tr> </tbody> </table>					Source	REAL	Fair Cash	Capped	Asmnt Level	Assessed	Levy Rate	82.750	Current Tax	Remove Cap	0	Land Value 15,908	8,782	11%	966	Assessed	3,923	324.63	Year Frozen	0	Improvements 31,039	26,886		2,957	Penalty	0		Uncapped Value	0	Mobile Home 0	0		0	Exemption	0	0.00	TIF Project ID	0	Total Value 46,947	35,668		3,923	Total Taxable	3,923	325.00
Source	REAL	Fair Cash	Capped	Asmnt Level	Assessed	Levy Rate	82.750	Current Tax																																														
Remove Cap	0	Land Value 15,908	8,782	11%	966	Assessed	3,923	324.63																																														
Year Frozen	0	Improvements 31,039	26,886		2,957	Penalty	0																																															
Uncapped Value	0	Mobile Home 0	0		0	Exemption	0	0.00																																														
TIF Project ID	0	Total Value 46,947	35,668		3,923	Total Taxable	3,923	325.00																																														
<b>Assessment History</b>																																																						
Tax Year	Statement Number	Billed Owner	Tax Area	Total Value	Exemptions	Taxable Value	Billed Tax																																															
2025	2025-660026212	DONELSON, MICHELLE &	29	47,818	0	3,737	309.00																																															
2024	2024-660026212	DONELSON, MICHELLE &	29	48,321	0	3,558	300.00																																															
2023	2023-660026212	DONELSON, MICHELLE &	29	34,935	0	3,389	289.00																																															
2022	2022-660026212	DONELSON, MICHELLE &	29	35,985	0	3,228	273.00																																															
2021	2021-660026212	HUCKABY, JIM BOB JR &	29	27,949	0	3,074	261.00																																															
2020	2020-660026212	HUCKABY, JIM BOB JR &	29	28,827	0	3,171	269.00																																															
2019	2019-660026212	HUCKABY, JIM BOB JR &	29	27,586	0	3,034	261.00																																															
2018	2018-660026212	HUCKABY, JIM BOB JR &	29	31,115	0	3,423	292.00																																															
2017	2017-660026212	HUCKABY, JIM BOB JR &	29	30,827	0	3,391	291.00																																															
2016	2016-660026212	HUCKABY, JIM BOB JR &	29	30,156	0	3,317	289.00																																															
2015	2015-660026212	HUCKABY, JIM BOB JR &	29	32,763	0	3,604	310.00																																															
2014	2014-660026212	HUCKABY, JIM BOB JR &	29	33,793	0	3,631	323.00																																															
2013	2013-660026212	HUCKABY, JIM BOB JR &	29	33,704	0	3,458	307.00																																															



# Rogers

## Assessment Property Record Card for Tax Year 2026

Data provided by LISA DELOZIER County Assessor

Date 04/18/2026  
Time 06:36:37  
Page 2

Lot Data		Square-Foot - NBHD 1195 #1	
Lot Size			
Lot Count			
Units Buildable	1		
Non-Ag Acres	0.332		
Topography			
Street Access			
Utilities			
Amenities	LAND QUALITY	0	0
Method	Square-Foot		
Base Lot Value	14,462.00 x 1.10 = 15,908		
Factor Value			
Adjustments	1.0000		
Lot Value	15,908		



Residential Data	
Type	1 Single Family Residence
Condition	2 - Fair
Quality	2 - Fair
Architecture	
Style	100% One Story
Exterior Wall	100% Frame, Siding, Wood
Base/Total Area	1,012 / 1,012
Style	100% One Story
HVAC	100% Warmed & Cooled Air
Roof Cover	1 Composition Shingle
Area on Slab	0
Fixture/RghIn	4 /
Bed/F/H Bath	3 / 1.0 /
Basement Area	
Garage Type	576 Attached Garage - Unfinished 1 Stalls
Remodel	
Year/Eff Age	1952 / 74

### GRM Approach

GRM Code	
Gross Rent	0.00
Indicated Value	

### Multiple Regression

MRA Code	1 Test
Adusted R	0.8445
Indicated Value	107,581 106.31 Per SqFt

### Direct Comparables

Selection Model	A Adam Test
Adjustment Model	1 2022 Residential
Comparables	8
Indicated Value	75,580 Per SqFt

### Value Reconciliation

Selected Approach	Cost Approach
Improvements	27,891
Lot Value	15,908
Indicated Value	43,799 43.28 Per SqFt
Agland Value	
Site Improvements	3,148
Total Value	46,947 46.39 Total Value Per SqFt

Cost Approach		Manual : 01/2025	
Base Cost	95.27	Total Misc Impr	+ 1,015
Roofing Adj	+ 4.30	Garage Cost	+ 13,023
Subfloor Adj	+ 2.54	Total RCN	= 132,816
Heat/Cool Adj	+ 10.30	Depreciation ( 79%)	- 104,925
Plumbing Adj	+ 4.96	Lump Sums	+ 0
Basement Adj	+ 0.00	RCNLD	= 27,891
Adj Base Cost	= 117.37	Lot Value	+ 15,908
Total Area	x 1,012	Indicated Value	= 43,799
Adjusted Cost	= 118,778	Value Per SqFt	43.28

### Miscellaneous Improvements

Code	Description	Sketch ID	Size	Year	Units	Unit Cost	Depr	Value
PRCH	SLAB PORCH - COVERED	63915	8x6		48	21.14		1,015



# Rogers

## Assessment Property Record Card for Tax Year 2026

Data provided by LISA DELOZIER County Assessor

Date 04/18/2026  
 Time 06:36:37  
 Page 3

### Sketch Image

660026212

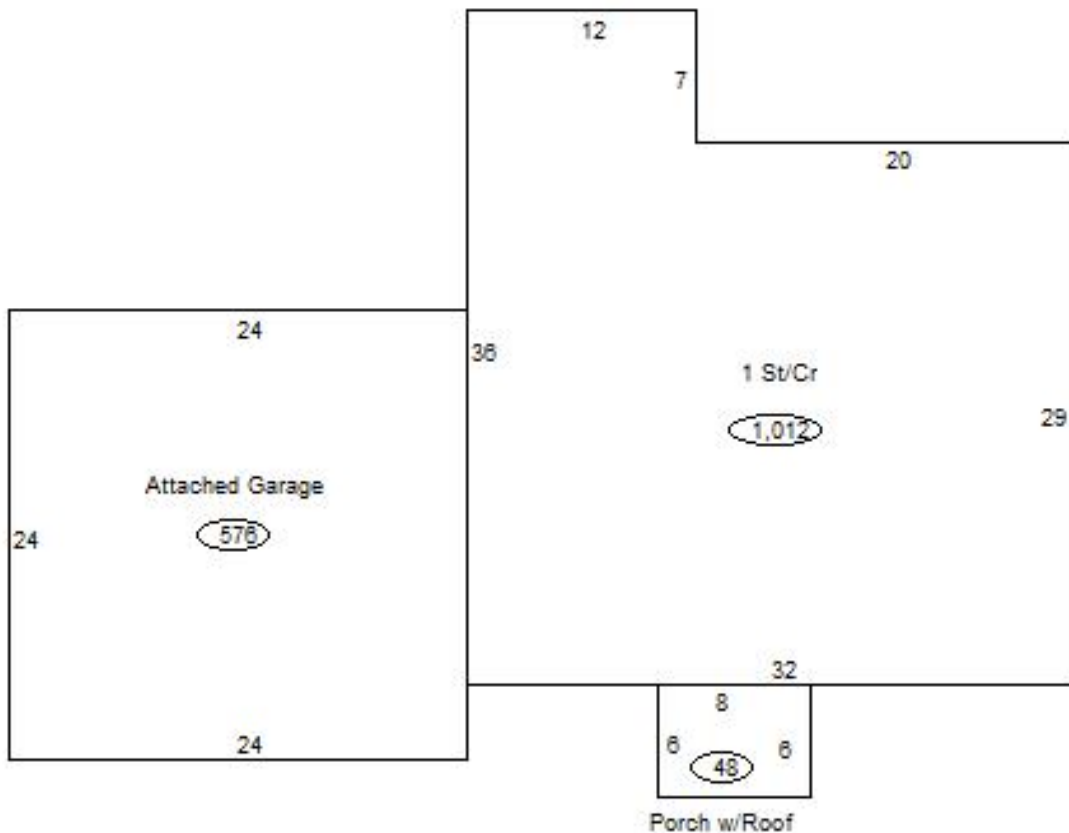

### Sketch Vector Information

Sequence	Code	Type	Built Over	Scale	Section Label	Base Area	Multiplier	Total Area
1	R	1	Crawl	13	1 St/Cr	1,012	1.000	1,012
2	G	1		13	Attached Garage	576	1.000	576
3	M	PRCH		13	SLBC	48	1.000	48
<b>Total Building Area</b>						1,012		1,012



# Rogers

## Assessment Property Record Card for Tax Year 2026

Data provided by LISA DELOZIER County Assessor

Date 04/18/2026  
Time 06:36:37  
Page 4

660026212

### Outbuildings/Site Improvements

Building Image	Code	Description	Dimensions	Floor	Roofing	Total Units
	BARN	BARN	0x0x0			864
	Qual 2	Cond 3	Year	Eff Age		
<b>Valuation Summary</b>		<b>Modifier Total</b>	<b>RCN</b>	<b>Depr (60% Phys/ % Func)</b>	<b>RCNLD</b>	
Base Cost (9.11 x 864)		7,871	7,871	4,723	3,148	