



Rogers

Assessment Property Record Card for Tax Year 2026

Data provided by LISA DELOZIER County Assessor

Date 04/16/2026
Time 21:10:30
Page 1

Assessment Data					Primary Image									
Account	660026235													
Parcel ID	000000-00-0-30010-010-0008													
Cadastral ID	30-24-18-00690													
Property Type	REAL - Real Property													
Property Class	URP	VI Area	2											
Tax Area	29 - CHELSEA OT													
Name ID	276516													
ROSALES, SHARON KAY & JOHN														
313 S WILLOW CHELSEA OK 74016-0000														
Parcel Location														
Situs	00313 S WILLOW ST													
Subdivision	CHELSEA O T													
Lot/Block	0008 / 0010	Parcel Size	2 - Lots											
Sec/Twn/Rng	30 / 24 / 18 / 5													
Neighborhood	1195 - R-V02-NE CHELSEA													
School District	S003 - CHELSEA SCHOOLS													
Legal Description Lat/Long: 36.53433412 -95.42396915														
Building Permits														
LOTS 7 & 8 BLOCK 10 CHELSEA O T														
<table border="1"> <thead> <tr> <th>Number</th> <th>Description</th> <th>Opened</th> <th>Closed</th> <th>Amount</th> </tr> </thead> <tbody> <tr> <td> </td> <td> </td> <td> </td> <td> </td> <td> </td> </tr> </tbody> </table>					Number	Description	Opened	Closed	Amount					
Number	Description	Opened	Closed	Amount										
Exemptions														
Sale History														
Code	Type	Active	Maximum	Exemption	Bk/Pg	Grantor	Date	Price	Code					
H	Homestead	Yes	1,000	1,000	1281/193	PATTON, EVADEN	04/09/2001	0	No					
Parcel Valuation														
Source	REAL	Fair Cash	Capped	Asmnt Level	Assessed	Levy Rate	82.750	Current Tax						
Remove Cap	2002	Land Value	32,835	25,611	11%	2,817	Assessed	2,883	238.57					
Year Frozen	0	Improvements	644	604		66	Penalty	0						
Uncapped Value	0	Mobile Home	0	0		0	Exemption	1,000	-83.00					
TIF Project ID	0	Total Value	33,479	26,215		2,883	Total Taxable	1,883	156.00					
Assessment History														
Tax Year	Statement Number	Billed Owner	Tax Area	Total Value	Exemptions	Taxable Value	Billed Tax							
2025	2025-660026235	ROSALES, SHARON KAY & JOHN	29	33,422	1000	1,800	149.00							
2024	2024-660026235	ROSALES, SHARON KAY & JOHN	29	64,325	1000	1,718	145.00							
2023	2023-660026235	ROSALES, SHARON KAY & JOHN	29	32,655	1000	1,639	140.00							
2022	2022-660026235	ROSALES, SHARON KAY & JOHN	29	30,051	1000	1,562	132.00							
2021	2021-660026235	ROSALES, SHARON KAY & JOHN	29	22,616	1000	1,488	126.00							
2020	2020-660026235	ROSALES, SHARON KAY & JOHN	29	22,921	1000	1,481	126.00							
2019	2019-660026235	ROSALES, SHARON KAY & JOHN	29	21,899	1000	1,409	121.00							
2018	2018-660026235	ROSALES, SHARON KAY & JOHN	29	23,906	1000	1,630	139.00							
2017	2017-660026235	ROSALES, SHARON KAY & JOHN	29	23,730	1000	1,610	138.00							
2016	2016-660026235	ROSALES, SHARON KAY & JOHN	29	23,128	1000	1,544	135.00							
2015	2015-660026235	ROSALES, SHARON KAY & JOHN	29	22,861	1000	1,515	130.00							
2014	2014-660026235	ROSALES, SHARON KAY & JOHN	29	23,643	1000	1,601	143.00							
2013	2013-660026235	ROSALES, SHARON KAY & JOHN	29	23,447	1000	1,548	137.00							



Rogers

Assessment Property Record Card for Tax Year 2026

Data provided by LISA DELOZIER County Assessor

Date 04/16/2026
 Time 21:10:30
 Page 2

Lot Data		Square-Foot - NBHD 1195 #1		Primary Image	
Lot Size					
Lot Count					
Units Buildable	1				
Non-Ag Acres	0.6853				
Topography					
Street Access					
Utilities					
Amenities	LAND QUALITY	0	0		
Method	Square-Foot				
Base Lot Value	29,850.00 x 1.10 = 32,835				
Factor Value					
Adjustments	1.0000				
Lot Value	32,835				
Residential Data				5/10/2024	
Type				GRM Approach	
Condition	-			GRM Code	
Quality	-			Gross Rent 0.00	
Architecture				Indicated Value	
Style				Multiple Regression	
Exterior Wall				MRA Code 1 Test	
Base/Total Area	0 / 0			Adusted R 0.8445	
Style				Indicated Value 114,078 Per SqFt	
HVAC				Direct Comparables	
Roof Cover				Selection Model A Adam Test	
Area on Slab	0			Adjustment Model 1 2022 Residential	
Fixture/RghIn	/			Comparables 3	
Bed/F/H Bath	/ /			Indicated Value 44,380 Per SqFt	
Basement Area				Value Reconciliation	
Garage Type				Selected Approach Cost Approach	
Remodel				Improvements 644	
Year/Eff Age	/			Lot Value 32,835	
Cost Approach		Manual : 01/2025		Indicated Value 33,479	
Base Cost	0.00	Total Misc Impr	+ 644	Agland Value	
Roofing Adj	+ 0.00	Garage Cost	+ 644	Site Improvements	
Subfloor Adj	+ 0.00	Total RCN	= 644	Total Value 33,479 0.00 Total Value Per SqFt	
Heat/Cool Adj	+ 0.00	Depreciation (0%)	- 0		
Plumbing Adj	+ 0.00	Lump Sums	+ 0		
Basement Adj	+ 0.00	RCNLD	= 644		
Adj Base Cost	= 0.00	Lot Value	+ 32,835		
Total Area	x 0	Indicated Value	= 33,479		
Adjusted Cost	= 0	Value Per SqFt	0.00		

Miscellaneous Improvements							
Code	Description	Sketch ID	Size	Year	Units	Unit Cost	Depr Value
PRCH	SLAB PORCH - COVERED	63942	6x4		24	26.85	644



Rogers

Assessment Property Record Card for Tax Year 2026

Data provided by LISA DELOZIER County Assessor

Date 04/16/2026

Time 21:10:30

Page 3

Sketch Image

660026235

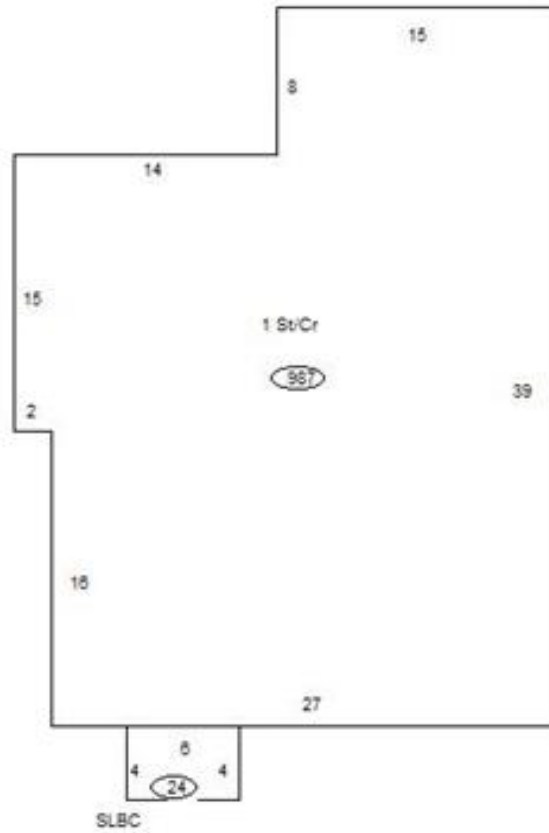

Sketch Vector Information

Sequence	Code	Type	Built Over	Scale	Section Label	Base Area	Multiplier	Total Area
1	R	1	Crawl	10	1 St/Cr	987	1.000	987
2	M	PRCH		10	SLBC	24	1.000	24
Total Building Area						987		987



Rogers

Assessment Property Record Card for Tax Year 2026

Data provided by LISA DELOZIER County Assessor

Date 04/16/2026
Time 21:10:30
Page 4

660026235

Outbuildings/Site Improvements

Building Image	Code	Description	Dimensions	Floor	Roofing	Total Units
	STF	STG FAIR	0x0x0			
	Qual	2	Cond	Year	Eff Age	
Valuation Summary			Modifier Total	RCN	Depr (100% Phys/ % Func)	RCNLD
		Base Cost (4.68 x)				