



Rogers

Assessment Property Record Card for Tax Year 2026

Data provided by LISA DELOZIER County Assessor

Date 04/16/2026
Time 23:39:53
Page 1

Assessment Data					Primary Image									
Account	660026345													
Parcel ID	000000-00-0-30010-022-0002													
Cadastral ID	30-24-18-01770													
Property Type	REAL - Real Property													
Property Class	URP	VI Area	2											
Tax Area	29 - CHELSEA OT													
Name ID	346929													
BROWN, JIM														
300 E 4TH ST CHELSEA OK 74016-0000														
Parcel Location														
Situs	00300 E 4TH ST													
Subdivision	CHELSEA O T													
Lot/Block	0002 / 0022	Parcel Size	2 - Lots											
Sec/Twn/Rng	30 / 24 / 18 / 5													
Neighborhood	1195 - R-V02-NE CHELSEA													
School District	S003 - CHELSEA SCHOOLS													
Legal Description Lat/Long: 36.53435378 -95.42547871														
Building Permits														
LOTS 1 & 2 BLOCK 22 CHELSEA O T														
<table border="1"> <thead> <tr> <th>Number</th> <th>Description</th> <th>Opened</th> <th>Closed</th> <th>Amount</th> </tr> </thead> <tbody> <tr> <td></td> <td></td> <td></td> <td></td> <td></td> </tr> </tbody> </table>					Number	Description	Opened	Closed	Amount					
Number	Description	Opened	Closed	Amount										
Exemptions														
Sale History														
Code	Type	Active	Maximum	Exemption	Bk/Pg	Grantor	Date	Price	Code					
H	Homestead	Yes	1,000	1,000	/	BROWN, BETTY L ESTATE	05/05/2025	0	4					
					1118/21	DARKS, MINNIE B	06/15/1998	62,000	No					
Parcel Valuation														
Source	REAL		Fair Cash	Capped	Asmnt Level	Assessed	Levy Rate	82.750	Current Tax					
Remove Cap	1999	Land Value	33,156	9,866	11%	1,085	Assessed	8,432	697.75					
Year Frozen	2005	Improvements	103,480	66,791		7,347	Penalty	0						
Uncapped Value	0	Mobile Home	0	0		0	Exemption	1,000	-83.00					
TIF Project ID	0	Total Value	136,636	76,657		8,432	Total Taxable	7,432	615.00					
Assessment History														
Tax Year	Statement Number	Billed Owner			Tax Area	Total Value	Exemptions	Taxable Value	Billed Tax					
2025	2025-660026345	BROWN, JIM			29	133,464	0	8,187	677.00					
2024	2024-660026345	BROWN, BOBBY J & BETTY L			29	139,890	0	7,797	658.00					
2023	2023-660026345	BROWN, BOBBY J & BETTY L			29	90,921	0	7,425	633.00					
2022	2022-660026345	BROWN, BOBBY J & BETTY L			29	90,919	0	7,072	598.00					
2021	2021-660026345	BROWN, BOBBY J & BETTY L			29	89,915	2000	4,736	401.00					
2020	2020-660026345	BROWN, BOBBY J & BETTY L			29	91,471	2000	4,735	402.00					
2019	2019-660026345	BROWN, BOBBY J & BETTY L			29	86,811	2000	4,735	407.00					
2018	2018-660026345	BROWN, BOBBY J & BETTY L			29	91,790	2000	4,735	404.00					
2017	2017-660026345	BROWN, BOBBY J & BETTY L			29	91,004	2000	4,735	406.00					
2016	2016-660026345	BROWN, BOBBY J & BETTY L			29	88,575	2000	4,736	413.00					
2015	2015-660026345	BROWN, BOBBY J & BETTY L			29	85,745	2000	4,735	408.00					
2014	2014-660026345	BROWN, BOBBY J & BETTY L			29	90,516	2000	4,735	422.00					
2013	2013-660026345	BROWN, BOBBY J & BETTY L			29	88,903	2000	4,736	420.00					



Rogers

Assessment Property Record Card for Tax Year 2026

Data provided by LISA DELOZIER County Assessor

Date 04/16/2026
 Time 23:39:53
 Page 2

Lot Data		Square-Foot - NBHD 1195 #1	
Lot Size			
Lot Count			
Units Buildable	1		
Non-Ag Acres	0.692		
Topography			
Street Access			
Utilities			
Amenities	LAND QUALITY	0	
		0	
Method	Square-Foot		
Base Lot Value	30,142.00 x 1.10 = 33,156		
Factor Value			
Adjustments	1.0000		
Lot Value	33,156		



Residential Data	
Type	1 Single Family Residence
Condition	3 - Average
Quality	2.5 - Fair
Architecture	
Style	100% One Story
Exterior Wall	100% Veneer, Stone
Base/Total Area	1,764 / 1,764
Style	100% One Story
HVAC	100% Warmed & Cooled Air
Roof Cover	1 Composition Shingle
Area on Slab	0
Fixture/RghIn	4 /
Bed/F/H Bath	2 / 1.0 /
Basement Area	
Garage Type	506 Attached Garage - Unfinished
Remodel	
Year/Eff Age	1956 / 53

GRM Approach	
GRM Code	
Gross Rent	0.00
Indicated Value	

Multiple Regression			
MRA Code	1	Test	
Adusted R	0.8445		
Indicated Value	159,762	90.57	Per SqFt

Direct Comparables			
Selection Model	A	Adam Test	
Adjustment Model	1	2022 Residential	
Comparables	1		
Indicated Value	12,000		Per SqFt

Cost Approach				Manual : 01/2025			
Base Cost	109.10	Total Misc Impr	+ 10,539				
Roofing Adj	+ 4.37	Garage Cost	+ 13,854				
Subfloor Adj	+ 1.15	Total RCN	= 252,390				
Heat/Cool Adj	+ 11.47	Depreciation (59%)	- 148,910				
Plumbing Adj	+ 3.16	Lump Sums	+ 0				
Basement Adj	+ 0.00	RCNLD	= 103,480				
Adj Base Cost	= 129.25	Lot Value	+ 33,156				
Total Area	x 1,764	Indicated Value	= 136,636				
Adjusted Cost	= 227,997	Value Per SqFt	77.46				

Value Reconciliation			
Selected Approach	Cost Approach		
Improvements	103,480		
Lot Value	33,156		
Indicated Value	136,636	77.46	Per SqFt
Agland Value			
Site Improvements			
Total Value	136,636	77.46	Total Value Per SqFt

Miscellaneous Improvements								
Code	Description	Sketch ID	Size	Year	Units	Unit Cost	Depr	Value
PRCH	SLAB PORCH - COVERED	64134	25x6		150	23.76		3,564
PRCH	SLAB PORCH - COVERED	64135	300		300	23.25		6,975



Rogers

Assessment Property Record Card for Tax Year 2026

Data provided by LISA DELOZIER County Assessor

Date 04/16/2026
 Time 23:39:53
 Page 3

Sketch Image

660026345

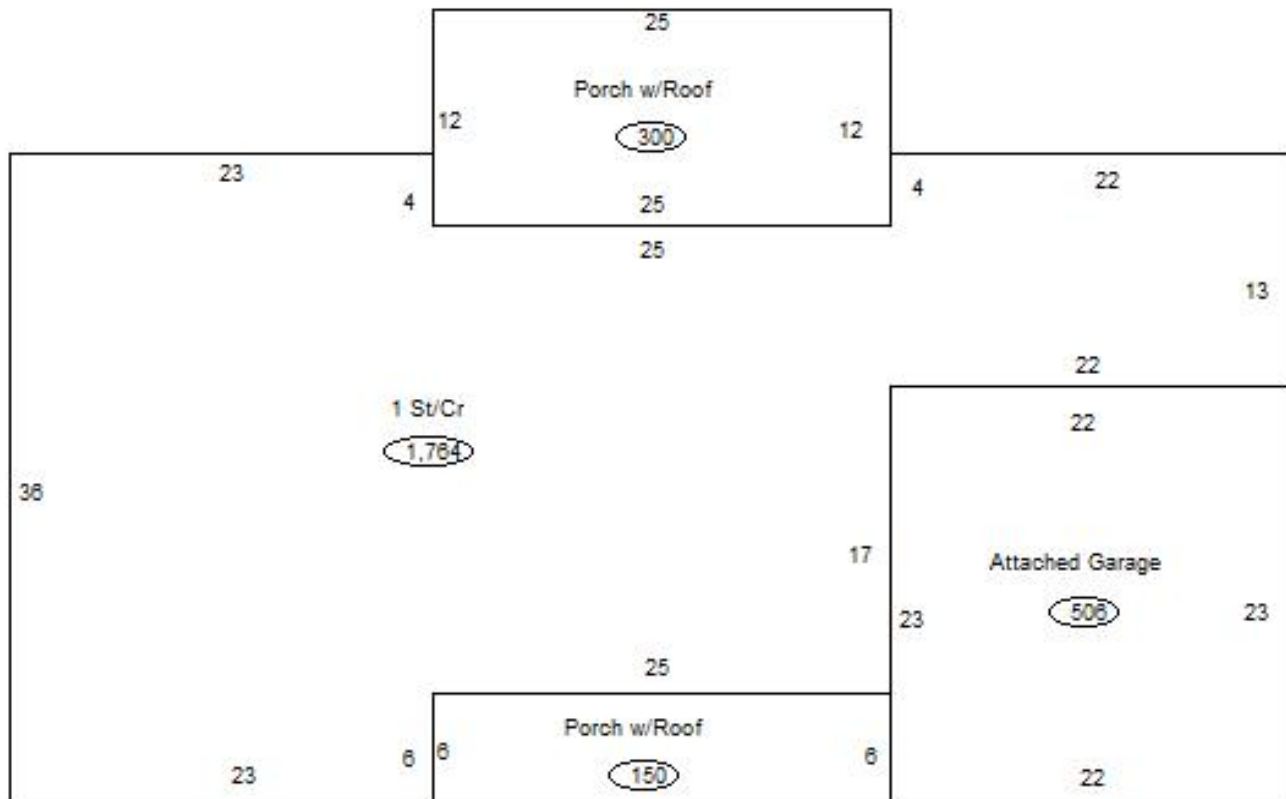

Sketch Vector Information

Sequence	Code	Type	Built Over	Scale	Section Label	Base Area	Multiplier	Total Area
1	R	1	Crawl	13	1 St/Cr	1,764	1.000	1,764
2	G	1		13	Attached Garage	506	1.000	506
3	M	PRCH		13	SLBC	150	1.000	150
4	M	PRCH		13	SLBC	300	1.000	300
Total Building Area						1,764		1,764



Rogers



Assessment Property Record Card for Tax Year 2026

Data provided by LISA DELOZIER County Assessor

Date 04/16/2026
Time 23:39:54
Page 4

660026345

Outbuildings/Site Improvements

Building Image	Code	Description	Dimensions	Floor	Roofing	Total Units
	STF	STG FAIR	0x0x0			
	Qual	2	Cond	Year	Eff Age	
	Valuation Summary		Modifier Total	RCN	Depr (100% Phys/ % Func)	RCNLD
	Base Cost (4.68 x)					
	STF	STG FAIR	0x0x0			
	Qual	2	Cond	Year	Eff Age	
	Valuation Summary		Modifier Total	RCN	Depr (100% Phys/ % Func)	RCNLD
	Base Cost (4.68 x)					