



Rogers

Assessment Property Record Card for Tax Year 2026

Data provided by LISA DELOZIER County Assessor

Date 04/18/2026
Time 07:35:54
Page 1

Assessment Data					Primary Image									
Account	660026428													
Parcel ID	000000-00-0-30010-031-0013													
Cadastral ID	30-24-18-02690													
Property Type	REAL - Real Property													
Property Class	UCP	VI Area	2											
Tax Area	29 - CHELSEA OT													
Name ID	6074													
MILAM, KATHERINE B TRUST														
JOHN B MILAM-SUCC TRUSTEE														
PO BOX 26 CHELSEA OK 74016-0000														
Parcel Location														
Situs	00341 W 6TH ST													
Subdivision	CHELSEA O T													
Lot/Block	0013 / 0031	Parcel Size	.1 - Lots											
Sec/Twn/Rng	30 / 24 / 18 / 5													
Neighborhood	5001 - TASC 2016													
School District	S003 - CHELSEA SCHOOLS													
Legal Description														
Lat/Long: 36.53636789 -95.43289592														
W 10.75' OF LOT 13 & E 9.75' OF LOT 14 BLOCK 31 CHELSEA O T														
Building Permits														
<table border="1"> <thead> <tr> <th>Number</th> <th>Description</th> <th>Opened</th> <th>Closed</th> <th>Amount</th> </tr> </thead> <tbody> <tr> <td></td> <td></td> <td></td> <td></td> <td></td> </tr> </tbody> </table>					Number	Description	Opened	Closed	Amount					
Number	Description	Opened	Closed	Amount										
Exemptions														
Code	Type	Active	Maximum	Exemption										
Sale History														
Bk/Pg	Grantor	Date	Price	Code										
/	MILAM SONS' MINERALS LLC	07/24/2023	0	4										
/	MILAM, KATHERINE B TRUST	11/15/2022	0	4										
903/344	MILAM, KATHERINE B TRUST	07/02/1984	0	No										
Parcel Valuation														
Source	REAL	Fair Cash	Capped	Asmnt Level	Assessed	Levy Rate	82.750	Current Tax						
Remove Cap	0	Land Value	3,946	3,946	11%	434	Assessed	3,137	259.59					
Year Frozen	0	Improvements	110,183	24,572		2,703	Penalty	0						
Uncapped Value	0	Mobile Home	0	0		0	Exemption	0	0.00					
TIF Project ID	0	Total Value	114,129	28,518		3,137	Total Taxable	3,137	260.00					
Assessment History														
Tax Year	Statement Number	Billed Owner	Tax Area	Total Value	Exemptions	Taxable Value	Billed Tax							
2025	2025-660026428	MILAM, KATHERINE B TRUST	29	109,122	0	2,988	247.00							
2024	2024-660026428	MILAM, KATHERINE B TRUST	29	96,611	0	2,845	240.00							
2023	2023-660026428	MILAM, KATHERINE B TRUST	29	80,751	0	2,710	231.00							
2022	2022-660026428	MILAM, KATHERINE B TRUST	29	80,751	0	2,581	218.00							
2021	2021-660026428	MILAM, KATHERINE B TRUST	29	60,135	0	2,458	208.00							
2020	2020-660026428	MILAM, KATHERINE B TRUST	29	61,323	0	2,341	199.00							
2019	2019-660026428	MILAM, KATHERINE B TRUST	29	61,323	0	2,230	192.00							
2018	2018-660026428	MILAM, KATHERINE B TRUST	29	55,067	0	2,123	181.00							
2017	2017-660026428	MILAM, KATHERINE B TRUST	29	55,067	0	2,022	173.00							
2016	2016-660026428	MILAM, KATHERINE B TRUST	29	17,510	0	1,926	168.00							
2015	2015-660026428	MILAM, KATHERINE B TRUST	29	17,510	0	1,926	166.00							
2014	2014-660026428	MILAM, KATHERINE B TRUST	29	17,510	0	1,926	172.00							
2013	2013-660026428	MILAM, KATHERINE B TRUST	29	17,510	0	1,926	171.00							



Rogers

Assessment Property Record Card for Tax Year 2026

Data provided by LISA DELOZIER County Assessor

Date 04/18/2026
 Time 07:35:54
 Page 2

Lot Data		Primary Image	
Lot Size	0 x 0		
Lot Count	0		
Units Buildable	3075		
Non-Ag Acres	0.072		
Topography			
Street Access			
Utilities			
Amenities	0		
	0		
Value Model	1835 COMM		
Value Method	Square-Foot		
Base Lot Value	3,157.00 x 1.25 = 3,946		
Factor Value	0		
Adjustments			
Lot Value	3,946		
Cost Approach		Image Information	
Manual Date	01/2025	Image ID	930764
Total Building Area	2,088	Image Date	6/22/2020
Total Base Value	544,467	Name	IMG_0091.JPG
Modifier Value		Description	REVAL 2021
Misc Improvements			
Replacement Cost New	544,467		
Phys/Func Depreciation Loss	()		
RCN Less Phys/Func	108,893		
Economic Depreciation			
RCNLD (All Sources)	108,893		
Depreciated Improvements			
Outbuilding Value	1,290		
Total Improvement Value	110,183		
Land Value	3,946		
Cost Approach Value	114,129 54.66/SqFt		
Income Approach		Value Reconciliation	
Potential Gross Income (PGI)		Selected Valuation Method	Cost Approach
Vacancy & Collection Loss		Total Improvement Value	1,290
Miscellaneous Income		Land Value	3,946
Effective Gross Income (EGI)		Total Appraised Value	114,129 54.66/SqFt
Total Expenses			
Net Operating Income (NOI)			
Income Capitalization Rate			
Indicated Value	0.00		



Rogers

Assessment Property Record Card for Tax Year 2026

Data provided by LISA DELOZIER County Assessor

Date 04/18/2026

Time 07:35:54

Page 3

Sketch Image

660026428

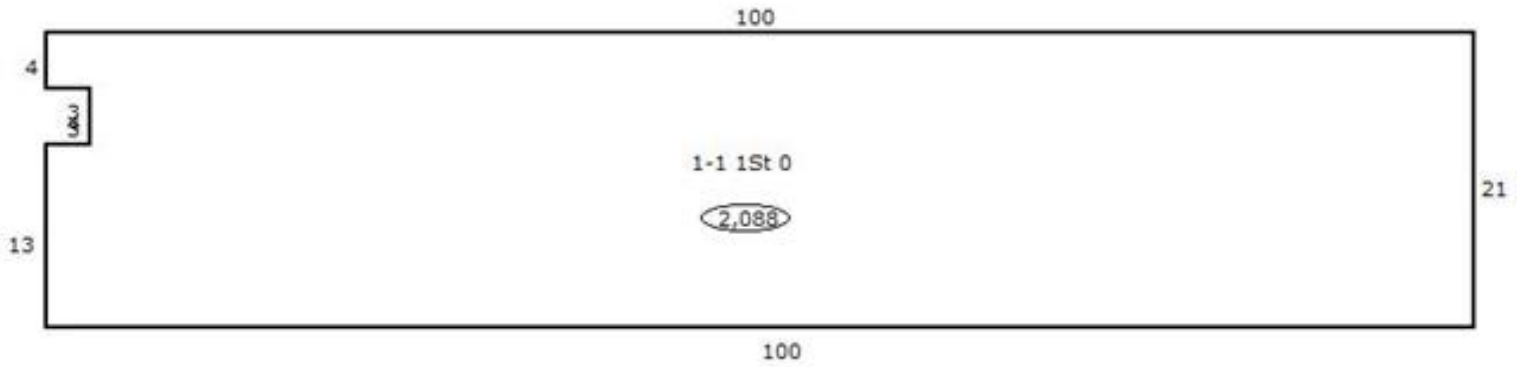

Sketch Vector Information

Sequence	Code	Type	Built Over	Scale	Section Label	Base Area	Multiplier	Total Area
1	C	344		13	1-1 1St 0	2,088	1.000	2,088
Total Building Area						2,088		2,088



Rogers

Assessment Property Record Card for Tax Year 2026

Data provided by LISA DELOZIER County Assessor

Date 04/18/2026
Time 07:35:54
Page 4

Account 660026428
Parcel ID 000000-00-0-30010-031-0013
Cadastral ID 30-24-18-02690

Tax Area Code 29
Property Class UCP
Owners Name MILAM, KATHERINE B TRUST

Building Data

Building ID 875
Building Sequence 1
Occupancy 1 344 Office Building 100%
Occupancy 2
Occupancy 3
Total Floor Area 2,088
Average Perimeter 248
Number Of Storys 1.00
Average Wall Ht 12.00
Year Built 1920
Effective Age 90
Construction Class 3 - Unreinforced Masonry Walls, Wood Joists
Quality 2 - Fair
Condition 1 - Low
Exterior Wall 10 - Cavity Brick
Heating/Cooling 8 - Warmed and Cooled Air
Roof Type Gable
Roof Cover

Basement Area
Basement Levels
Basement Finish
Finish Code - 1
Finish Area - 1
Finish Code - 2
Finish Area - 2

Building Image

Image Information

Image Name
Image Date
Image Name
Description

Cost Calculations

Appraisal Zone 2
Zone Description
Base Cost 86.60
Wall Cost 159.62
HVAC Cost 14.54
Basement Cost 0.00
Total Base Cost 260.76
Total Area 2,088
Base RCN 544,467
Misc Impr Value

Manual Date 01/2025
Base Year 2026
Modifier Value
Total Replacement Cost 544,467
Physical Depreciation 80%
Functional Depreciation
Total Depreciation 80% (435,574)
Total RCNLD 108,893
Lump Sums
Total Building Value 108,893 \$ 52.15 Per SqFt



Rogers

Assessment Property Record Card for Tax Year 2026

Data provided by LISA DELOZIER County Assessor

Date 04/18/2026

Time 07:35:54

Page 5

660026428

Outbuildings/Site Improvements

Building Image	Code	Description	Dimensions	Floor	Roofing	Total Units
	FLV1	CANOPY	21x24x0			504
	Qual	Cond	Year	Eff Age		
Valuation Summary		Modifier Total	RCN	Depr (% Phys/ % Func)		RCNLD
Base Cost (5.00 x 504)				2,520	1,260	1,260
	FLV1	CANOPY	3x4x0			12
	Qual	Cond	Year	Eff Age		
Valuation Summary		Modifier Total	RCN	Depr (% Phys/ % Func)		RCNLD
Base Cost (5.00 x 12)				60	30	30
Total Site Improvement Value						1,290