



Rogers

Assessment Property Record Card for Tax Year 2026

Data provided by LISA DELOZIER County Assessor

Date 04/18/2026

Time 06:43:32

Page 1

Assessment Data					Primary Image				
Account	660026554				<p>660026554_001.JPG 5/10/2024</p>				
Parcel ID	000000-00-0-30010-048-0003								
Cadastral ID	30-24-18-03930								
Property Type	REAL - Real Property								
Property Class	URP VI Area 2								
Tax Area	29 - CHELSEA OT								
Name ID	323858								
BAXTER, MICHAEL & DENICE CAMERON									
223 E 8TH ST CHELSEA OK 74016-0000									
Parcel Location									
Situs	00223 E 8TH ST								
Subdivision	CHELSEA O T								
Lot/Block	0003 / 0048		Parcel Size 1 - Lots						
Sec/Twn/Rng	30 / 24 / 18 / 5								
Neighborhood	1195 - R-V02-NE CHELSEA								
School District	S003 - CHELSEA SCHOOLS								
Legal Description Lat/Long: 36.53139004 -95.42901476									
Building Permits									
LOT 3 BLOCK 48 CHELSEA O T									
Number	Description	Opened	Closed	Amount					
0502	R6 FOR SFR ADDN (COMPLETION ES	02/2005	12/2005	45,000					
Exemptions									
Code	Type	Active	Maximum	Exemption					
HV	Veteran	Yes	999,999	15,050					
Sale History									
Bk/Pg	Grantor	Date	Price	Code					
2693/659	CRANE, OTIS W JR	02/23/2018	110,000	YES					
2634/520	CRANE, OTIS W JR & JESSICA L	01/26/2017	0	4					
2377/539	FIRST UNITED BANK & TRUST CO	11/01/2013	80,000	3					
2269/512	FEDERAL NATIONAL MORTGAGE ASS	08/30/2012	0	5					
2157/710	SHIREL, TIMOTHY	01/19/2011	0	10					
1604/137	RATHFON, BERTHA MAE	12/01/1998	0	4					
Parcel Valuation									
Source	REAL	Fair Cash	Capped	Asmnt Level	Assessed	Levy Rate	82.750	Current Tax	
Remove Cap	2019	Land Value	18,567	8,849	11%	973	Assessed	15,050 1,245.39	
Year Frozen	0	Improvements	220,431	127,972		14,077	Penalty	0	
Uncapped Value	0	Mobile Home	0	0		0	Exemption	15,050 -1,245.00	
TIF Project ID	0	Total Value	238,998	136,821		15,050	Total Taxable	0 0.00	
Assessment History									
Tax Year	Statement Number	Billed Owner	Tax Area	Total Value	Exemptions	Taxable Value	Billed Tax		
2025	2025-660026554	BAXTER, MICHAEL &	29	235,314	14612		.00		
2024	2024-660026554	BAXTER, MICHAEL &	29	227,264	14187		.00		
2023	2023-660026554	BAXTER, MICHAEL &	29	126,254	13774		.00		
2022	2022-660026554	BAXTER, MICHAEL &	29	126,249	13373		.00		
2021	2021-660026554	BAXTER, MICHAEL &	29	118,119	12983		.00		
2020	2020-660026554	BAXTER, MICHAEL &	29	116,001	1000	11,605	984.00		
2019	2019-660026554	BAXTER, MICHAEL &	29	111,251	1000	11,238	965.00		
2018	2018-660026554	BAXTER, MICHAEL &	29	117,133	0	12,885	1,101.00		
2017	2017-660026554	CRANE, OTIS W JR	29	143,189	0	15,751	1,351.00		
2016	2016-660026554	CRANE, OTIS W JR & JESSICA L	29	139,071	0	15,298	1,333.00		
2015	2015-660026554	CRANE, OTIS W JR & JESSICA L	29	135,603	0	14,917	1,285.00		
2014	2014-660026554	CRANE, OTIS W JR & JESSICA L	29	136,820	0	15,051	1,341.00		
2013	2013-660026554	FIRST UNITED BANK & TRUST CO	29	127,709	0	13,593	1,206.00		



Rogers

Assessment Property Record Card for Tax Year 2026

Data provided by LISA DELOZIER County Assessor

Date 04/18/2026
Time 06:43:32
Page 2

Lot Data	Square-Foot - NBHD 1195 #1	Primary Image
Lot Size Lot Count 0 Units Buildable 2 Non-Ag Acres 0.3875 Topography Street Access Utilities Amenities LAND QUALITY 0 0 Method Square-Foot Base Lot Value 16,879.00 x 1.10 = 18,567 Factor Value Adjustments 1.0000 Lot Value 18,567		

Residential Data	
Type	1 Single Family Residence
Condition	3 - Average
Quality	3 - Average
Architecture	
Style	100% One Story
Exterior Wall	80% Frame, Siding, Wood 20% Veneer, Masonry
Base/Total Area	1,923 / 1,923
Style	100% One Story
HVAC	100% Warmed & Cooled Air
Roof Cover	1 Composition Shingle
Area on Slab	1,923
Fixture/RghIn	11 /
Bed/F/H Bath	3 / 2.0 /
Basement Area	
Garage Type	780 Attached Garage - Unfinished
Remodel	
Year/Eff Age	2005 / 16

GRM Approach
GRM Code Gross Rent 0.00 Indicated Value

Multiple Regression			
MRA Code	1	Test	
Adusted R	0.8445		
Indicated Value	266,330	138.50	Per SqFt

Direct Comparables	
Selection Model	A Adam Test
Adjustment Model	1 2022 Residential
Comparables	
Indicated Value	

Cost Approach				Manual : 01/2025			
Base Cost	99.43	Total Misc Impr	+ 7,102				
Roofing Adj	+ 4.63	Garage Cost	+ 23,236				
Subfloor Adj	+ -2.43	Total RCN	= 265,579				
Heat/Cool Adj	+ 12.64	Depreciation (17%)	- 45,148				
Plumbing Adj	+ 8.06	Lump Sums	+ 0				
Basement Adj	+ 0.00	RCNLD	= 220,431				
Adj Base Cost	= 122.33	Lot Value	+ 18,567				
Total Area	x 1,923	Indicated Value	= 238,998				
Adjusted Cost	= 235,241	Value Per SqFt	124.28				

Value Reconciliation			
Selected Approach	Cost Approach		
Improvements	220,431		
Lot Value	18,567		
Indicated Value	238,998	124.28	Per SqFt
Agland Value			
Site Improvements			
Total Value	238,998	124.28	Total Value Per SqFt

Miscellaneous Improvements							
Code	Description	Sketch ID	Size	Year	Units	Unit Cost	Depr Value
SHLT	STORM SHELTER	0		1 2012	1	0.00	
PRCH	SLAB PORCH - COVERED	64347	19x6		114	26.57	3,029
PRCH	SLAB PORCH - COVERED	115982	14x11		154	26.45	4,073



Rogers

Assessment Property Record Card for Tax Year 2026

Data provided by LISA DELOZIER County Assessor

Date 04/18/2026

Time 06:43:32

Page 3

Sketch Image

660026554

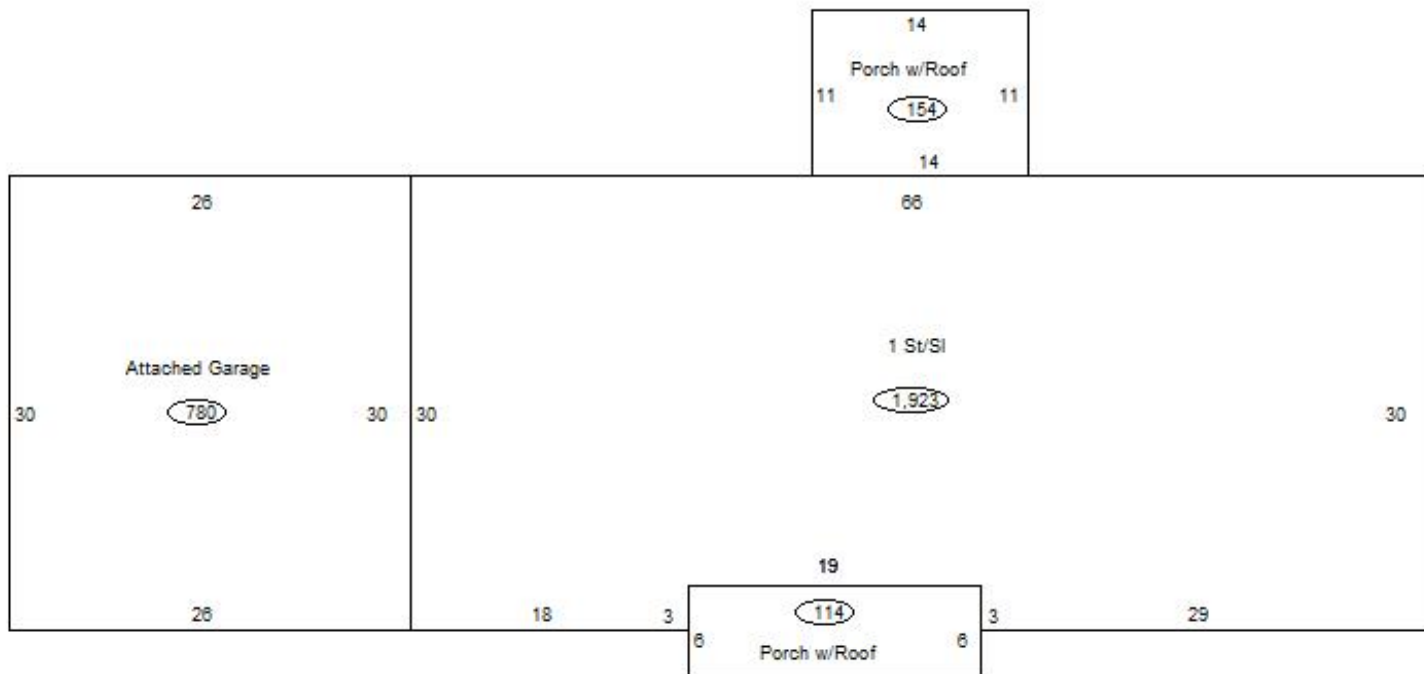

Sketch Vector Information

Sequence	Code	Type	Built Over	Scale	Section Label	Base Area	Multiplier	Total Area
1	R	1	Slab	13	1 St/SI	1,923	1.000	1,923
2	G	1		13	Attached Garage	780	1.000	780
3	M	PRCH		13	SLBC	114	1.000	114
4	M	PRCH		13	SLBC	154	1.000	154
Total Building Area						1,923		1,923



Rogers

Assessment Property Record Card for Tax Year 2026

Data provided by LISA DELOZIER County Assessor

Date 04/18/2026
Time 06:43:32
Page 4

660026554

Outbuildings/Site Improvements

Building Image	Code	Description	Dimensions	Floor	Roofing	Total Units
	STF	STG FAIR	0x0x0			
	Qual	2	Cond	Year	Eff Age	
Valuation Summary			Modifier Total	RCN	Depr (100% Phys/ % Func)	RCNLD
		Base Cost (4.68 x)				