



Rogers

Assessment Property Record Card for Tax Year 2026

Data provided by LISA DELOZIER County Assessor

Date 04/16/2026
Time 23:34:50
Page 1

Assessment Data					Primary Image																																																																																																																				
Account 660026575 Parcel ID 000000-00-0-30010-051-0001 Cadastral ID 30-24-18-04140 Property Type REAL - Real Property Property Class URP VI Area 2 Tax Area 29 - CHELSEA OT Name ID 277902 FOSTER, DAVID LYNN & TINA MARIE 300 VINE ST CHELSEA OK 74016-0000 Parcel Location Situs 00300 W 7TH ST Subdivision CHELSEA O T Lot/Block 0001 / 0051 Parcel Size 1 - Lots Sec/Twn/Rng 30 / 24 / 18 / 5 Neighborhood 1195 - R-V02-NE CHELSEA School District S003 - CHELSEA SCHOOLS																																																																																																																									
Legal Description Lat/Long: 36.53448657 -95.43361028																																																																																																																									
E2 LOTS 1 & 2 BLOCK 51 CHELSEA O T					Building Permits <table border="1"> <thead> <tr> <th>Number</th> <th>Description</th> <th>Opened</th> <th>Closed</th> <th>Amount</th> </tr> </thead> <tbody> <tr> <td> </td> <td> </td> <td> </td> <td> </td> <td> </td> </tr> </tbody> </table>					Number	Description	Opened	Closed	Amount																																																																																																											
Number	Description	Opened	Closed	Amount																																																																																																																					
Exemptions <table border="1"> <thead> <tr> <th>Code</th> <th>Type</th> <th>Active</th> <th>Maximum</th> <th>Exemption</th> </tr> </thead> <tbody> <tr> <td> </td> <td> </td> <td> </td> <td> </td> <td> </td> </tr> </tbody> </table>					Code	Type	Active	Maximum	Exemption						Sale History <table border="1"> <thead> <tr> <th>Bk/Pg</th> <th>Grantor</th> <th>Date</th> <th>Price</th> <th>Code</th> </tr> </thead> <tbody> <tr> <td>1705/665</td> <td>FOSTER, TED & CHARLOTTE &</td> <td>08/03/2005</td> <td>140,000</td> <td>11</td> </tr> <tr> <td>1112/288</td> <td>MAIDEN, MARILYN SUE</td> <td>05/05/1998</td> <td>28,500</td> <td>Yes</td> </tr> <tr> <td>975/824</td> <td>EDMONDSON, JANICE</td> <td>12/07/1994</td> <td>26,000</td> <td>Yes</td> </tr> <tr> <td>922/565</td> <td>EDMONDSON, MARJORIE</td> <td>07/20/1993</td> <td>0</td> <td>No</td> </tr> </tbody> </table>					Bk/Pg	Grantor	Date	Price	Code	1705/665	FOSTER, TED & CHARLOTTE &	08/03/2005	140,000	11	1112/288	MAIDEN, MARILYN SUE	05/05/1998	28,500	Yes	975/824	EDMONDSON, JANICE	12/07/1994	26,000	Yes	922/565	EDMONDSON, MARJORIE	07/20/1993	0	No																																																																													
Code	Type	Active	Maximum	Exemption																																																																																																																					
Bk/Pg	Grantor	Date	Price	Code																																																																																																																					
1705/665	FOSTER, TED & CHARLOTTE &	08/03/2005	140,000	11																																																																																																																					
1112/288	MAIDEN, MARILYN SUE	05/05/1998	28,500	Yes																																																																																																																					
975/824	EDMONDSON, JANICE	12/07/1994	26,000	Yes																																																																																																																					
922/565	EDMONDSON, MARJORIE	07/20/1993	0	No																																																																																																																					
Parcel Valuation <table border="1"> <thead> <tr> <th>Source</th> <th>REAL</th> <th>Fair Cash</th> <th>Capped</th> <th>Asmnt Level</th> <th>Assessed</th> <th>Levy Rate</th> <th>82.750</th> <th>Current Tax</th> </tr> </thead> <tbody> <tr> <td>Remove Cap</td> <td>2006</td> <td>Land Value 13,316</td> <td>11,881</td> <td>11%</td> <td>1,307</td> <td>Assessed</td> <td>3,792</td> <td>313.79</td> </tr> <tr> <td>Year Frozen</td> <td>0</td> <td>Improvements 22,754</td> <td>22,596</td> <td></td> <td>2,485</td> <td>Penalty</td> <td>0</td> <td></td> </tr> <tr> <td>Uncapped Value</td> <td>0</td> <td>Mobile Home 0</td> <td>0</td> <td></td> <td>0</td> <td>Exemption</td> <td>0</td> <td>0.00</td> </tr> <tr> <td>TIF Project ID</td> <td>0</td> <td>Total Value 36,070</td> <td>34,477</td> <td></td> <td>3,792</td> <td>Total Taxable</td> <td>3,792</td> <td>314.00</td> </tr> </tbody> </table>										Source	REAL	Fair Cash	Capped	Asmnt Level	Assessed	Levy Rate	82.750	Current Tax	Remove Cap	2006	Land Value 13,316	11,881	11%	1,307	Assessed	3,792	313.79	Year Frozen	0	Improvements 22,754	22,596		2,485	Penalty	0		Uncapped Value	0	Mobile Home 0	0		0	Exemption	0	0.00	TIF Project ID	0	Total Value 36,070	34,477		3,792	Total Taxable	3,792	314.00																																																																			
Source	REAL	Fair Cash	Capped	Asmnt Level	Assessed	Levy Rate	82.750	Current Tax																																																																																																																	
Remove Cap	2006	Land Value 13,316	11,881	11%	1,307	Assessed	3,792	313.79																																																																																																																	
Year Frozen	0	Improvements 22,754	22,596		2,485	Penalty	0																																																																																																																		
Uncapped Value	0	Mobile Home 0	0		0	Exemption	0	0.00																																																																																																																	
TIF Project ID	0	Total Value 36,070	34,477		3,792	Total Taxable	3,792	314.00																																																																																																																	
Assessment History <table border="1"> <thead> <tr> <th>Tax Year</th> <th>Statement Number</th> <th>Billed Owner</th> <th>Tax Area</th> <th>Total Value</th> <th>Exemptions</th> <th>Taxable Value</th> <th>Billed Tax</th> </tr> </thead> <tbody> <tr><td>2025</td><td>2025-660026575</td><td>FOSTER, DAVID LYNN &</td><td>29</td><td>34,837</td><td>0</td><td>3,612</td><td>299.00</td></tr> <tr><td>2024</td><td>2024-660026575</td><td>FOSTER, DAVID LYNN &</td><td>29</td><td>35,112</td><td>0</td><td>3,440</td><td>290.00</td></tr> <tr><td>2023</td><td>2023-660026575</td><td>FOSTER, DAVID LYNN</td><td>29</td><td>34,276</td><td>0</td><td>3,276</td><td>279.00</td></tr> <tr><td>2022</td><td>2022-660026575</td><td>FOSTER, DAVID LYNN</td><td>29</td><td>34,276</td><td>0</td><td>3,120</td><td>264.00</td></tr> <tr><td>2021</td><td>2021-660026575</td><td>FOSTER, DAVID LYNN</td><td>29</td><td>27,016</td><td>0</td><td>2,972</td><td>252.00</td></tr> <tr><td>2020</td><td>2020-660026575</td><td>FOSTER, DAVID LYNN</td><td>29</td><td>28,708</td><td>0</td><td>3,158</td><td>268.00</td></tr> <tr><td>2019</td><td>2019-660026575</td><td>FOSTER, DAVID LYNN</td><td>29</td><td>27,438</td><td>0</td><td>3,018</td><td>259.00</td></tr> <tr><td>2018</td><td>2018-660026575</td><td>FOSTER, DAVID LYNN</td><td>29</td><td>29,799</td><td>0</td><td>3,278</td><td>280.00</td></tr> <tr><td>2017</td><td>2017-660026575</td><td>FOSTER, DAVID LYNN</td><td>29</td><td>29,522</td><td>0</td><td>3,248</td><td>279.00</td></tr> <tr><td>2016</td><td>2016-660026575</td><td>FOSTER, DAVID LYNN</td><td>29</td><td>29,444</td><td>0</td><td>3,239</td><td>282.00</td></tr> <tr><td>2015</td><td>2015-660026575</td><td>FOSTER, DAVID LYNN</td><td>29</td><td>32,288</td><td>0</td><td>3,552</td><td>306.00</td></tr> <tr><td>2014</td><td>2014-660026575</td><td>FOSTER, DAVID LYNN</td><td>29</td><td>33,860</td><td>0</td><td>3,407</td><td>303.00</td></tr> <tr><td>2013</td><td>2013-660026575</td><td>FOSTER, DAVID LYNN</td><td>29</td><td>33,932</td><td>0</td><td>3,245</td><td>288.00</td></tr> </tbody> </table>										Tax Year	Statement Number	Billed Owner	Tax Area	Total Value	Exemptions	Taxable Value	Billed Tax	2025	2025-660026575	FOSTER, DAVID LYNN &	29	34,837	0	3,612	299.00	2024	2024-660026575	FOSTER, DAVID LYNN &	29	35,112	0	3,440	290.00	2023	2023-660026575	FOSTER, DAVID LYNN	29	34,276	0	3,276	279.00	2022	2022-660026575	FOSTER, DAVID LYNN	29	34,276	0	3,120	264.00	2021	2021-660026575	FOSTER, DAVID LYNN	29	27,016	0	2,972	252.00	2020	2020-660026575	FOSTER, DAVID LYNN	29	28,708	0	3,158	268.00	2019	2019-660026575	FOSTER, DAVID LYNN	29	27,438	0	3,018	259.00	2018	2018-660026575	FOSTER, DAVID LYNN	29	29,799	0	3,278	280.00	2017	2017-660026575	FOSTER, DAVID LYNN	29	29,522	0	3,248	279.00	2016	2016-660026575	FOSTER, DAVID LYNN	29	29,444	0	3,239	282.00	2015	2015-660026575	FOSTER, DAVID LYNN	29	32,288	0	3,552	306.00	2014	2014-660026575	FOSTER, DAVID LYNN	29	33,860	0	3,407	303.00	2013	2013-660026575	FOSTER, DAVID LYNN	29	33,932	0	3,245	288.00
Tax Year	Statement Number	Billed Owner	Tax Area	Total Value	Exemptions	Taxable Value	Billed Tax																																																																																																																		
2025	2025-660026575	FOSTER, DAVID LYNN &	29	34,837	0	3,612	299.00																																																																																																																		
2024	2024-660026575	FOSTER, DAVID LYNN &	29	35,112	0	3,440	290.00																																																																																																																		
2023	2023-660026575	FOSTER, DAVID LYNN	29	34,276	0	3,276	279.00																																																																																																																		
2022	2022-660026575	FOSTER, DAVID LYNN	29	34,276	0	3,120	264.00																																																																																																																		
2021	2021-660026575	FOSTER, DAVID LYNN	29	27,016	0	2,972	252.00																																																																																																																		
2020	2020-660026575	FOSTER, DAVID LYNN	29	28,708	0	3,158	268.00																																																																																																																		
2019	2019-660026575	FOSTER, DAVID LYNN	29	27,438	0	3,018	259.00																																																																																																																		
2018	2018-660026575	FOSTER, DAVID LYNN	29	29,799	0	3,278	280.00																																																																																																																		
2017	2017-660026575	FOSTER, DAVID LYNN	29	29,522	0	3,248	279.00																																																																																																																		
2016	2016-660026575	FOSTER, DAVID LYNN	29	29,444	0	3,239	282.00																																																																																																																		
2015	2015-660026575	FOSTER, DAVID LYNN	29	32,288	0	3,552	306.00																																																																																																																		
2014	2014-660026575	FOSTER, DAVID LYNN	29	33,860	0	3,407	303.00																																																																																																																		
2013	2013-660026575	FOSTER, DAVID LYNN	29	33,932	0	3,245	288.00																																																																																																																		



Rogers

Assessment Property Record Card for Tax Year 2026

Data provided by LISA DELOZIER County Assessor

Date 04/16/2026
 Time 23:34:50
 Page 2

Lot Data	Square-Foot - NBHD 1195 #1	Primary Image
Lot Size Lot Count Units Buildable 1 Non-Ag Acres 0.2779 Topography Street Access Utilities Amenities LAND QUALITY 0 0 Method Square-Foot Base Lot Value 12,105.00 x 1.10 = 13,316 Factor Value Adjustments 1.0000 Lot Value 13,316		

Residential Data	
Type	1 Single Family Residence
Condition	1.5 - Low
Quality	2 - Fair
Architecture	
Style	100% One Story
Exterior Wall	100% Frame, Siding, Wood
Base/Total Area	1,032 / 1,032
Style	100% One Story
HVAC	100% Wall Furnace
Roof Cover	1 Composition Shingle
Area on Slab	0
Fixture/RghIn	4 /
Bed/F/H Bath	2 / 1.0 /
Basement Area	
Garage Type	
Remodel	RMA -
Year/Eff Age	1940 / 103

GRM Approach
GRM Code Gross Rent 0.00 Indicated Value

Multiple Regression
MRA Code 1 Test Adusted R 0.8445 Indicated Value 45,832 44.41 Per SqFt

Direct Comparables
Selection Model A Adam Test Adjustment Model 1 2022 Residential Comparables 7 Indicated Value 25,380 Per SqFt

Cost Approach				Manual : 01/2025			
Base Cost	93.43	Total Misc Impr	+ 2,026				
Roofing Adj	+ 4.20	Garage Cost	+ 0				
Subfloor Adj	+ 2.43	Total RCN	= 111,077				
Heat/Cool Adj	+ 0.76	Depreciation (80%)	- 88,862				
Plumbing Adj	+ 4.85	Lump Sums	+ 0				
Basement Adj	+ 0.00	RCNLD	= 22,215				
Adj Base Cost	= 105.67	Lot Value	+ 13,316				
Total Area	x 1,032	Indicated Value	= 35,531				
Adjusted Cost	= 109,051	Value Per SqFt	34.43				

Value Reconciliation
Selected Approach Cost Approach Improvements 22,215 Lot Value 13,316 Indicated Value 35,531 34.43 Per SqFt Agland Value Site Improvements 539 Total Value 36,070 34.95 Total Value Per SqFt

Miscellaneous Improvements								
Code	Description	Sketch ID	Size	Year	Units	Unit Cost	Depr	Value
PRCH	SLAB PORCH - COVERED	64379	6x4		24	21.22		509
PRCH	SLAB PORCH - COVERED	64380	12x6		72	21.07		1,517



Rogers

Assessment Property Record Card for Tax Year 2026

Data provided by LISA DELOZIER County Assessor

Date 04/16/2026

Time 23:34:50

Page 3

Sketch Image

660026575

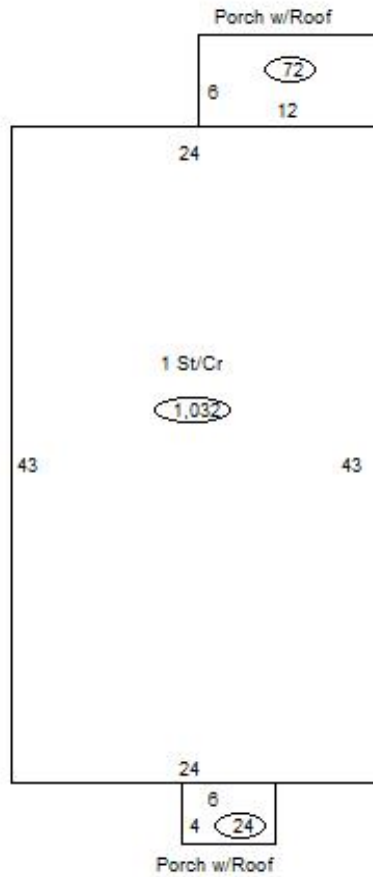

Sketch Vector Information

Sequence	Code	Type	Built Over	Scale	Section Label	Base Area	Multiplier	Total Area
1	R	1	Crawl	13	1 St/Cr	1,032	1.000	1,032
2	M	PRCH		13	SLBC	24	1.000	24
3	M	PRCH		13	SLBC	72	1.000	72
Total Building Area						1,032		1,032



Rogers



Assessment Property Record Card for Tax Year 2026

Data provided by LISA DELOZIER County Assessor

Date 04/16/2026
Time 23:34:50
Page 4

660026575

Outbuildings/Site Improvements

Building Image	Code	Description	Dimensions	Floor	Roofing	Total Units	
	STF	STG FAIR	0x0x0			384	
	Qual	2	Cond 3	Year	Eff Age		
	Valuation Summary		Modifier Total	RCN	Depr (70% Phys/ % Func)	RCNLD	
	Base Cost (4.68 x 384)		1,797		1,797	1,258	539
	STF	STG FAIR	0x0x0				
	Qual	2	Cond	Year	Eff Age		
	Valuation Summary		Modifier Total	RCN	Depr (100% Phys/ % Func)	RCNLD	
	Base Cost (4.68 x)						