



Rogers

Assessment Property Record Card for Tax Year 2026

Data provided by LISA DELOZIER County Assessor

Date 04/16/2026
 Time 22:05:10
 Page 1

Assessment Data					Primary Image																																																																																																																				
Account 660026600 Parcel ID 000000-00-0-30010-060-0006 Cadastral ID 30-24-18-04410 Property Type REAL - Real Property Property Class URP VI Area 2 Tax Area 29 - CHELSEA OT Name ID 325383 INMAN, DRAKE & TAYLOR TRUST 903 PINE ST CHELSEA OK 74016-0000 Parcel Location Situs 00903 PINE ST Subdivision CHELSEA O T Lot/Block 0006 / 0060 Parcel Size 2 - Lots Sec/Twn/Rng 30 / 24 / 18 / 5 Neighborhood 1195 - R-V02-NE CHELSEA School District S003 - CHELSEA SCHOOLS																																																																																																																									
Legal Description Lot/Long: 36.53283304 -95.43514128																																																																																																																									
Building Permits					<table border="1"> <thead> <tr> <th>Number</th> <th>Description</th> <th>Opened</th> <th>Closed</th> <th>Amount</th> </tr> </thead> <tbody> <tr> <td colspan="5"> </td> </tr> </tbody> </table>					Number	Description	Opened	Closed	Amount																																																																																																											
Number	Description	Opened	Closed	Amount																																																																																																																					
Exemptions					Sale History																																																																																																																				
<table border="1"> <thead> <tr> <th>Code</th> <th>Type</th> <th>Active</th> <th>Maximum</th> <th>Exemption</th> </tr> </thead> <tbody> <tr> <td>H</td> <td>Homestead</td> <td>No</td> <td>1,000</td> <td></td> </tr> </tbody> </table>					Code	Type	Active	Maximum	Exemption	H	Homestead	No	1,000		<table border="1"> <thead> <tr> <th>Bk/Pg</th> <th>Grantor</th> <th>Date</th> <th>Price</th> <th>Code</th> </tr> </thead> <tbody> <tr> <td>/</td> <td>FRALEY, GEORGE</td> <td>08/14/2018</td> <td>90,500</td> <td>WG</td> </tr> <tr> <td>2708/166</td> <td>HENSLEY, JULIE A</td> <td>05/02/2018</td> <td>68,000</td> <td>WB</td> </tr> <tr> <td>2323/250</td> <td>KRUIS, ADAM &</td> <td>04/29/2013</td> <td>54,000</td> <td>YES</td> </tr> <tr> <td>2019/287</td> <td>KAY, NICK L &</td> <td>04/14/2009</td> <td>63,000</td> <td>YES</td> </tr> <tr> <td>1818/430</td> <td>WILSON, PEGGY D</td> <td>10/26/2006</td> <td>58,500</td> <td>YES</td> </tr> <tr> <td>1076/863</td> <td>HENDRICKSON, RUTH MARIE-TRUST</td> <td>08/07/1997</td> <td>55,000</td> <td>Yes</td> </tr> </tbody> </table>					Bk/Pg	Grantor	Date	Price	Code	/	FRALEY, GEORGE	08/14/2018	90,500	WG	2708/166	HENSLEY, JULIE A	05/02/2018	68,000	WB	2323/250	KRUIS, ADAM &	04/29/2013	54,000	YES	2019/287	KAY, NICK L &	04/14/2009	63,000	YES	1818/430	WILSON, PEGGY D	10/26/2006	58,500	YES	1076/863	HENDRICKSON, RUTH MARIE-TRUST	08/07/1997	55,000	Yes																																																																			
Code	Type	Active	Maximum	Exemption																																																																																																																					
H	Homestead	No	1,000																																																																																																																						
Bk/Pg	Grantor	Date	Price	Code																																																																																																																					
/	FRALEY, GEORGE	08/14/2018	90,500	WG																																																																																																																					
2708/166	HENSLEY, JULIE A	05/02/2018	68,000	WB																																																																																																																					
2323/250	KRUIS, ADAM &	04/29/2013	54,000	YES																																																																																																																					
2019/287	KAY, NICK L &	04/14/2009	63,000	YES																																																																																																																					
1818/430	WILSON, PEGGY D	10/26/2006	58,500	YES																																																																																																																					
1076/863	HENDRICKSON, RUTH MARIE-TRUST	08/07/1997	55,000	Yes																																																																																																																					
Parcel Valuation																																																																																																																									
<table border="1"> <thead> <tr> <th>Source</th> <th>REAL</th> <th>Fair Cash</th> <th>Capped</th> <th>Asmnt Level</th> <th>Assessed</th> <th>Levy Rate</th> <th>82.750</th> <th>Current Tax</th> </tr> </thead> <tbody> <tr> <td>Remove Cap</td> <td>2019</td> <td>Land Value</td> <td>20,590</td> <td>10,551</td> <td>11%</td> <td>1,161</td> <td>Assessed</td> <td>9,815</td> <td>812.19</td> </tr> <tr> <td>Year Frozen</td> <td>0</td> <td>Improvements</td> <td>98,739</td> <td>78,674</td> <td></td> <td>8,654</td> <td>Penalty</td> <td>0</td> <td></td> </tr> <tr> <td>Uncapped Value</td> <td>0</td> <td>Mobile Home</td> <td>0</td> <td>0</td> <td></td> <td>0</td> <td>Exemption</td> <td>0</td> <td>0.00</td> </tr> <tr> <td>TIF Project ID</td> <td>0</td> <td>Total Value</td> <td>119,329</td> <td>89,225</td> <td></td> <td>9,815</td> <td>Total Taxable</td> <td>9,815</td> <td>812.00</td> </tr> </tbody> </table>		Source	REAL	Fair Cash	Capped	Asmnt Level	Assessed	Levy Rate	82.750	Current Tax	Remove Cap	2019	Land Value	20,590	10,551	11%	1,161	Assessed	9,815	812.19	Year Frozen	0	Improvements	98,739	78,674		8,654	Penalty	0		Uncapped Value	0	Mobile Home	0	0		0	Exemption	0	0.00	TIF Project ID	0	Total Value	119,329	89,225		9,815	Total Taxable	9,815	812.00																																																																							
Source	REAL	Fair Cash	Capped	Asmnt Level	Assessed	Levy Rate	82.750	Current Tax																																																																																																																	
Remove Cap	2019	Land Value	20,590	10,551	11%	1,161	Assessed	9,815	812.19																																																																																																																
Year Frozen	0	Improvements	98,739	78,674		8,654	Penalty	0																																																																																																																	
Uncapped Value	0	Mobile Home	0	0		0	Exemption	0	0.00																																																																																																																
TIF Project ID	0	Total Value	119,329	89,225		9,815	Total Taxable	9,815	812.00																																																																																																																
Assessment History																																																																																																																									
<table border="1"> <thead> <tr> <th>Tax Year</th> <th>Statement Number</th> <th>Billed Owner</th> <th>Tax Area</th> <th>Total Value</th> <th>Exemptions</th> <th>Taxable Value</th> <th>Billed Tax</th> </tr> </thead> <tbody> <tr><td>2025</td><td>2025-660026600</td><td>INMAN, DRAKE & TAYLOR</td><td>29</td><td>116,069</td><td>0</td><td>9,347</td><td>773.00</td></tr> <tr><td>2024</td><td>2024-660026600</td><td>INMAN, DRAKE & TAYLOR</td><td>29</td><td>134,335</td><td>0</td><td>8,903</td><td>751.00</td></tr> <tr><td>2023</td><td>2023-660026600</td><td>INMAN, DRAKE & TAYLOR</td><td>29</td><td>77,078</td><td>0</td><td>8,478</td><td>723.00</td></tr> <tr><td>2022</td><td>2022-660026600</td><td>INMAN, DRAKE & TAYLOR</td><td>29</td><td>78,504</td><td>0</td><td>8,635</td><td>731.00</td></tr> <tr><td>2021</td><td>2021-660026600</td><td>INMAN, DRAKE & TAYLOR</td><td>29</td><td>82,833</td><td>0</td><td>9,111</td><td>772.00</td></tr> <tr><td>2020</td><td>2020-660026600</td><td>INMAN, DRAKE W &</td><td>29</td><td>79,799</td><td>0</td><td>8,778</td><td>744.00</td></tr> <tr><td>2019</td><td>2019-660026600</td><td>INMAN, DRAKE W &</td><td>29</td><td>77,878</td><td>0</td><td>8,566</td><td>736.00</td></tr> <tr><td>2018</td><td>2018-660026600</td><td>INMAN, DRAKE W &</td><td>29</td><td>78,687</td><td>0</td><td>8,655</td><td>739.00</td></tr> <tr><td>2017</td><td>2017-660026600</td><td>HENSLEY, JULIE A</td><td>29</td><td>77,982</td><td>0</td><td>8,578</td><td>736.00</td></tr> <tr><td>2016</td><td>2016-660026600</td><td>HENSLEY, JULIE A</td><td>29</td><td>75,970</td><td>0</td><td>8,356</td><td>728.00</td></tr> <tr><td>2015</td><td>2015-660026600</td><td>HENSLEY, JULIE A</td><td>29</td><td>73,549</td><td>0</td><td>8,090</td><td>697.00</td></tr> <tr><td>2014</td><td>2014-660026600</td><td>HENSLEY, JULIE A</td><td>29</td><td>74,178</td><td>0</td><td>8,159</td><td>727.00</td></tr> <tr><td>2013</td><td>2013-660026600</td><td>HENSLEY, JULIE A</td><td>29</td><td>80,562</td><td>1000</td><td>7,862</td><td>698.00</td></tr> </tbody> </table>										Tax Year	Statement Number	Billed Owner	Tax Area	Total Value	Exemptions	Taxable Value	Billed Tax	2025	2025-660026600	INMAN, DRAKE & TAYLOR	29	116,069	0	9,347	773.00	2024	2024-660026600	INMAN, DRAKE & TAYLOR	29	134,335	0	8,903	751.00	2023	2023-660026600	INMAN, DRAKE & TAYLOR	29	77,078	0	8,478	723.00	2022	2022-660026600	INMAN, DRAKE & TAYLOR	29	78,504	0	8,635	731.00	2021	2021-660026600	INMAN, DRAKE & TAYLOR	29	82,833	0	9,111	772.00	2020	2020-660026600	INMAN, DRAKE W &	29	79,799	0	8,778	744.00	2019	2019-660026600	INMAN, DRAKE W &	29	77,878	0	8,566	736.00	2018	2018-660026600	INMAN, DRAKE W &	29	78,687	0	8,655	739.00	2017	2017-660026600	HENSLEY, JULIE A	29	77,982	0	8,578	736.00	2016	2016-660026600	HENSLEY, JULIE A	29	75,970	0	8,356	728.00	2015	2015-660026600	HENSLEY, JULIE A	29	73,549	0	8,090	697.00	2014	2014-660026600	HENSLEY, JULIE A	29	74,178	0	8,159	727.00	2013	2013-660026600	HENSLEY, JULIE A	29	80,562	1000	7,862	698.00
Tax Year	Statement Number	Billed Owner	Tax Area	Total Value	Exemptions	Taxable Value	Billed Tax																																																																																																																		
2025	2025-660026600	INMAN, DRAKE & TAYLOR	29	116,069	0	9,347	773.00																																																																																																																		
2024	2024-660026600	INMAN, DRAKE & TAYLOR	29	134,335	0	8,903	751.00																																																																																																																		
2023	2023-660026600	INMAN, DRAKE & TAYLOR	29	77,078	0	8,478	723.00																																																																																																																		
2022	2022-660026600	INMAN, DRAKE & TAYLOR	29	78,504	0	8,635	731.00																																																																																																																		
2021	2021-660026600	INMAN, DRAKE & TAYLOR	29	82,833	0	9,111	772.00																																																																																																																		
2020	2020-660026600	INMAN, DRAKE W &	29	79,799	0	8,778	744.00																																																																																																																		
2019	2019-660026600	INMAN, DRAKE W &	29	77,878	0	8,566	736.00																																																																																																																		
2018	2018-660026600	INMAN, DRAKE W &	29	78,687	0	8,655	739.00																																																																																																																		
2017	2017-660026600	HENSLEY, JULIE A	29	77,982	0	8,578	736.00																																																																																																																		
2016	2016-660026600	HENSLEY, JULIE A	29	75,970	0	8,356	728.00																																																																																																																		
2015	2015-660026600	HENSLEY, JULIE A	29	73,549	0	8,090	697.00																																																																																																																		
2014	2014-660026600	HENSLEY, JULIE A	29	74,178	0	8,159	727.00																																																																																																																		
2013	2013-660026600	HENSLEY, JULIE A	29	80,562	1000	7,862	698.00																																																																																																																		



Rogers

Assessment Property Record Card for Tax Year 2026

Data provided by LISA DELOZIER County Assessor

Date 04/16/2026
Time 22:05:11
Page 2

Lot Data	Square-Foot - NBHD 1195 #1	Primary Image
Lot Size Lot Count Units Buildable 1 Non-Ag Acres 0.4297 Topography Street Access Utilities Amenities LAND QUALITY 0 0 Method Square-Foot Base Lot Value 18,718.00 x 1.10 = 20,590 Factor Value Adjustments 1.0000 Lot Value 20,590		

Residential Data	
Type	1 Single Family Residence
Condition	3 - Average
Quality	2.5 - Fair
Architecture	
Style	100% One Story
Exterior Wall	100% Veneer, Masonry
Base/Total Area	1,306 / 1,306
Style	100% One Story
HVAC	100% Warmed & Cooled Air
Roof Cover	1 Composition Shingle
Area on Slab	1,306
Fixture/RghIn	8 /
Bed/F/H Bath	3 / 2.0 /
Basement Area	
Garage Type	540 Attached Garage - Unfinished
Remodel	
Year/Eff Age	1973 / 40

GRM Approach
GRM Code Gross Rent 0.00 Indicated Value

Multiple Regression
MRA Code 1 Test Adusted R 0.8445 Indicated Value 149,609 114.56 Per SqFt

Direct Comparables
Selection Model A Adam Test Adjustment Model 1 2022 Residential Comparables 2 Indicated Value 106,100 Per SqFt

Cost Approach				Manual : 01/2025			
Base Cost	105.59	Total Misc Impr	+ 1,564	Roofing Adj	+ 4.46	Garage Cost	+ 14,575
Subfloor Adj	+ -1.15	Total RCN	= 183,777	Heat/Cool Adj	+ 11.47	Depreciation (48%)	- 88,213
Plumbing Adj	+ 7.99	Lump Sums	+ 2,263	Basement Adj	+ 0.00	RCNLD	= 97,827
Adj Base Cost	= 128.36	Lot Value	+ 20,590	Total Area	x 1,306	Indicated Value	= 118,417
		Value Per SqFt	90.67	Adjusted Cost	= 167,638		

Value Reconciliation
Selected Approach Cost Approach Improvements 97,827 Lot Value 20,590 Indicated Value 118,417 90.67 Per SqFt Agland Value Site Improvements 912 Total Value 119,329 91.37 Total Value Per SqFt

Miscellaneous Improvements								
Code	Description	Sketch ID	Size	Year	Units	Unit Cost	Depr	Value
PRCH	SLAB PORCH - COVERED	64452	13x5		65	24.06		1,564
WODO	WOOD DECK - OPEN	146365	22x16		352	16.07	60%	2,263



Rogers

Assessment Property Record Card for Tax Year 2026

Data provided by LISA DELOZIER County Assessor

Date 04/16/2026

Time 22:05:11

Page 3

Sketch Image

660026600

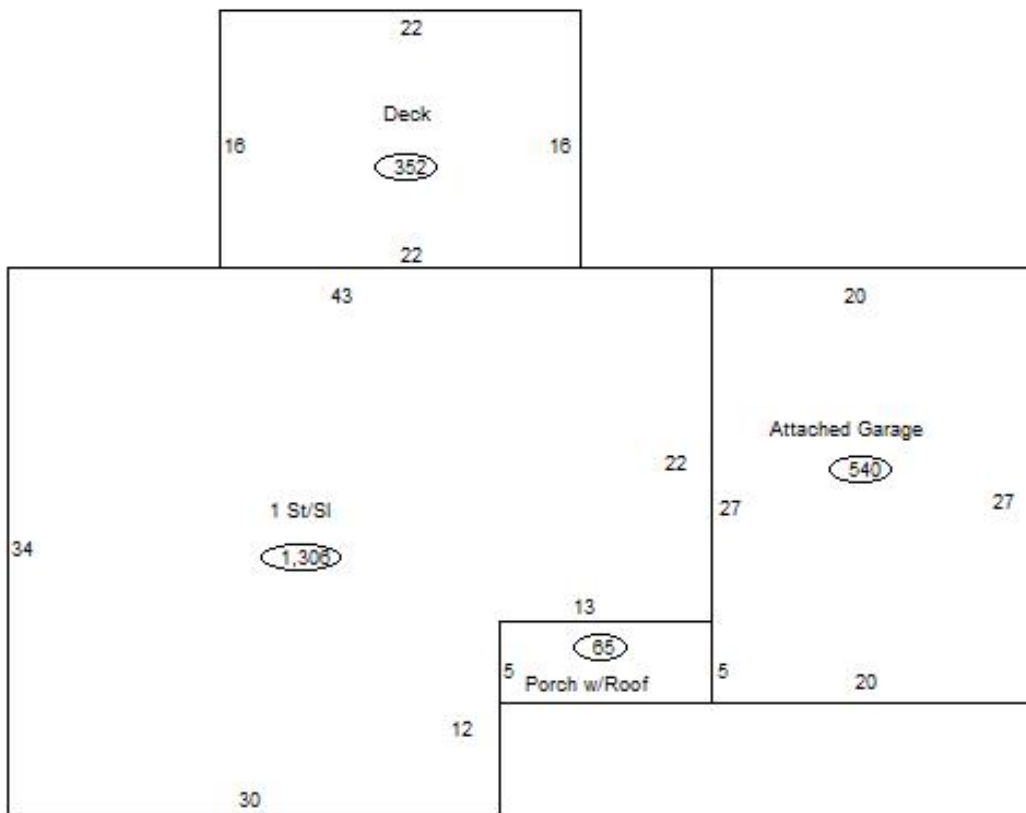

Sketch Vector Information

Sequence	Code	Type	Built Over	Scale	Section Label	Base Area	Multiplier	Total Area
1	R	1	Slab	13	1 St/Sl	1,306	1.000	1,306
2	G	1		13	Attached Garage	540	1.000	540
3	M	PRCH		13	SLBC	65	1.000	65
4	M	WODO		13	WODO	352	1.000	352
Total Building Area						1,306		1,306



Rogers



Assessment Property Record Card for Tax Year 2026

Data provided by LISA DELOZIER County Assessor

Date 04/16/2026
 Time 22:05:11
 Page 4

660026600

Outbuildings/Site Improvements

Building Image	Code	Description	Dimensions	Floor	Roofing	Total Units	
	STF	STG FAIR	0x0x0			320	
	Qual	2	Cond 3	Year	Eff Age		
	Valuation Summary		Modifier Total		RCN	Depr (50% Phys/ % Func)	RCNLD
Base Cost (4.68 x 320)		1,498			1,498	749	749
	LT	LEAN-TO	8x14x0			112	
	Qual	2	Cond 2	Year	Eff Age		
	Valuation Summary		Modifier Total		RCN	Depr (50% Phys/ % Func)	RCNLD
Base Cost (2.92 x 112)		327			327	164	163