



Rogers

Assessment Property Record Card for Tax Year 2026

Data provided by LISA DELOZIER County Assessor

Date 04/16/2026
Time 23:40:14
Page 1

Assessment Data					Primary Image																																																																																																																				
Account 660026637 Parcel ID 000000-00-0-30010-062-0007 Cadastral ID 30-24-18-04790 Property Type REAL - Real Property Property Class URP VI Area 2 Tax Area 29 - CHELSEA OT Name ID 343355 LAIR, HARLEY HUNTER & VICTORIA 900 OLIVE ST CHELSEA OK 74016-0000 Parcel Location Situs 00900 OLIVE ST Subdivision CHELSEA O T Lot/Block 0007 / 0062 Parcel Size 2 - Lots Sec/Twn/Rng 30 / 24 / 18 / 5 Neighborhood 1195 - R-V02-NE CHELSEA School District S003 - CHELSEA SCHOOLS																																																																																																																									
Legal Description Lot/Long: 36.53176940 -95.43327535																																																																																																																									
Legal Description LOTS 6 & 7 BLOCK 62 CHELSEA O T					Building Permits <table border="1"> <thead> <tr> <th>Number</th> <th>Description</th> <th>Opened</th> <th>Closed</th> <th>Amount</th> </tr> </thead> <tbody> <tr> <td> </td> <td> </td> <td> </td> <td> </td> <td> </td> </tr> </tbody> </table>					Number	Description	Opened	Closed	Amount																																																																																																											
Number	Description	Opened	Closed	Amount																																																																																																																					
Exemptions <table border="1"> <thead> <tr> <th>Code</th> <th>Type</th> <th>Active</th> <th>Maximum</th> <th>Exemption</th> </tr> </thead> <tbody> <tr> <td>H</td> <td>Homestead</td> <td>No</td> <td>1,000</td> <td> </td> </tr> <tr> <td>PD</td> <td>Add-Homestead</td> <td>No</td> <td>1,000</td> <td> </td> </tr> </tbody> </table>					Code	Type	Active	Maximum	Exemption	H	Homestead	No	1,000		PD	Add-Homestead	No	1,000		Sale History <table border="1"> <thead> <tr> <th>Bk/Pg</th> <th>Grantor</th> <th>Date</th> <th>Price</th> <th>Code</th> </tr> </thead> <tbody> <tr> <td>/</td> <td>ON THE ROCKS RENTALS &</td> <td>12/21/2023</td> <td>217,000</td> <td>YES</td> </tr> <tr> <td>/</td> <td>DRAEGER, WYNONA ESTATE</td> <td>04/10/2023</td> <td>25,000</td> <td>19</td> </tr> </tbody> </table>					Bk/Pg	Grantor	Date	Price	Code	/	ON THE ROCKS RENTALS &	12/21/2023	217,000	YES	/	DRAEGER, WYNONA ESTATE	04/10/2023	25,000	19																																																																																		
Code	Type	Active	Maximum	Exemption																																																																																																																					
H	Homestead	No	1,000																																																																																																																						
PD	Add-Homestead	No	1,000																																																																																																																						
Bk/Pg	Grantor	Date	Price	Code																																																																																																																					
/	ON THE ROCKS RENTALS &	12/21/2023	217,000	YES																																																																																																																					
/	DRAEGER, WYNONA ESTATE	04/10/2023	25,000	19																																																																																																																					
Parcel Valuation <table border="1"> <thead> <tr> <th>Source</th> <th>REAL</th> <th>Fair Cash</th> <th>Capped</th> <th>Asmnt Level</th> <th>Assessed</th> <th>Levy Rate</th> <th>82.750</th> <th>Current Tax</th> </tr> </thead> <tbody> <tr> <td>Remove Cap</td> <td>2024</td> <td>Land Value 51,942</td> <td>51,942</td> <td>11%</td> <td>5,714</td> <td>Assessed</td> <td>24,251</td> <td>2,006.77</td> </tr> <tr> <td>Year Frozen</td> <td>2005</td> <td>Improvements 168,525</td> <td>168,525</td> <td> </td> <td>18,537</td> <td>Penalty</td> <td>0</td> <td> </td> </tr> <tr> <td>Uncapped Value</td> <td>0</td> <td>Mobile Home 0</td> <td>0</td> <td> </td> <td>0</td> <td>Exemption</td> <td>0</td> <td>0.00</td> </tr> <tr> <td>TIF Project ID</td> <td>0</td> <td>Total Value 220,467</td> <td>220,467</td> <td> </td> <td>24,251</td> <td>Total Taxable</td> <td>24,251</td> <td>2,007.00</td> </tr> </tbody> </table>										Source	REAL	Fair Cash	Capped	Asmnt Level	Assessed	Levy Rate	82.750	Current Tax	Remove Cap	2024	Land Value 51,942	51,942	11%	5,714	Assessed	24,251	2,006.77	Year Frozen	2005	Improvements 168,525	168,525		18,537	Penalty	0		Uncapped Value	0	Mobile Home 0	0		0	Exemption	0	0.00	TIF Project ID	0	Total Value 220,467	220,467		24,251	Total Taxable	24,251	2,007.00																																																																			
Source	REAL	Fair Cash	Capped	Asmnt Level	Assessed	Levy Rate	82.750	Current Tax																																																																																																																	
Remove Cap	2024	Land Value 51,942	51,942	11%	5,714	Assessed	24,251	2,006.77																																																																																																																	
Year Frozen	2005	Improvements 168,525	168,525		18,537	Penalty	0																																																																																																																		
Uncapped Value	0	Mobile Home 0	0		0	Exemption	0	0.00																																																																																																																	
TIF Project ID	0	Total Value 220,467	220,467		24,251	Total Taxable	24,251	2,007.00																																																																																																																	
Assessment History <table border="1"> <thead> <tr> <th>Tax Year</th> <th>Statement Number</th> <th>Billed Owner</th> <th>Tax Area</th> <th>Total Value</th> <th>Exemptions</th> <th>Taxable Value</th> <th>Billed Tax</th> </tr> </thead> <tbody> <tr><td>2025</td><td>2025-660026637</td><td>LAIR, HARLEY HUNTER &</td><td>29</td><td>217,000</td><td>0</td><td>23,870</td><td>1,975.00</td></tr> <tr><td>2024</td><td>2024-660026637</td><td>LAIR, HARLEY HUNTER &</td><td>29</td><td>217,274</td><td>0</td><td>23,900</td><td>2,017.00</td></tr> <tr><td>2023</td><td>2023-660026637</td><td>ON THE ROCKS RENTALS &</td><td>29</td><td>71,475</td><td>0</td><td>3,652</td><td>311.00</td></tr> <tr><td>2022</td><td>2022-660026637</td><td>DRAEGER, ROY W-ESTATE</td><td>29</td><td>63,994</td><td>2000</td><td>1,478</td><td>125.00</td></tr> <tr><td>2021</td><td>2021-660026637</td><td>DRAEGER, ROY W</td><td>29</td><td>64,042</td><td>2000</td><td>1,478</td><td>125.00</td></tr> <tr><td>2020</td><td>2020-660026637</td><td>DRAEGER, ROY W</td><td>29</td><td>64,302</td><td>2000</td><td>1,478</td><td>125.00</td></tr> <tr><td>2019</td><td>2019-660026637</td><td>DRAEGER, ROY W</td><td>29</td><td>60,861</td><td>2000</td><td>1,478</td><td>127.00</td></tr> <tr><td>2018</td><td>2018-660026637</td><td>DRAEGER, ROY W</td><td>29</td><td>67,693</td><td>2000</td><td>1,478</td><td>126.00</td></tr> <tr><td>2017</td><td>2017-660026637</td><td>DRAEGER, ROY W</td><td>29</td><td>67,083</td><td>2000</td><td>1,478</td><td>127.00</td></tr> <tr><td>2016</td><td>2016-660026637</td><td>DRAEGER, ROY W</td><td>29</td><td>64,940</td><td>2000</td><td>1,478</td><td>129.00</td></tr> <tr><td>2015</td><td>2015-660026637</td><td>DRAEGER, ROY W</td><td>29</td><td>68,184</td><td>2000</td><td>1,478</td><td>127.00</td></tr> <tr><td>2014</td><td>2014-660026637</td><td>DRAEGER, ROY W</td><td>29</td><td>70,689</td><td>2000</td><td>1,478</td><td>132.00</td></tr> <tr><td>2013</td><td>2013-660026637</td><td>DRAEGER, ROY W</td><td>29</td><td>70,024</td><td>2000</td><td>1,478</td><td>131.00</td></tr> </tbody> </table>										Tax Year	Statement Number	Billed Owner	Tax Area	Total Value	Exemptions	Taxable Value	Billed Tax	2025	2025-660026637	LAIR, HARLEY HUNTER &	29	217,000	0	23,870	1,975.00	2024	2024-660026637	LAIR, HARLEY HUNTER &	29	217,274	0	23,900	2,017.00	2023	2023-660026637	ON THE ROCKS RENTALS &	29	71,475	0	3,652	311.00	2022	2022-660026637	DRAEGER, ROY W-ESTATE	29	63,994	2000	1,478	125.00	2021	2021-660026637	DRAEGER, ROY W	29	64,042	2000	1,478	125.00	2020	2020-660026637	DRAEGER, ROY W	29	64,302	2000	1,478	125.00	2019	2019-660026637	DRAEGER, ROY W	29	60,861	2000	1,478	127.00	2018	2018-660026637	DRAEGER, ROY W	29	67,693	2000	1,478	126.00	2017	2017-660026637	DRAEGER, ROY W	29	67,083	2000	1,478	127.00	2016	2016-660026637	DRAEGER, ROY W	29	64,940	2000	1,478	129.00	2015	2015-660026637	DRAEGER, ROY W	29	68,184	2000	1,478	127.00	2014	2014-660026637	DRAEGER, ROY W	29	70,689	2000	1,478	132.00	2013	2013-660026637	DRAEGER, ROY W	29	70,024	2000	1,478	131.00
Tax Year	Statement Number	Billed Owner	Tax Area	Total Value	Exemptions	Taxable Value	Billed Tax																																																																																																																		
2025	2025-660026637	LAIR, HARLEY HUNTER &	29	217,000	0	23,870	1,975.00																																																																																																																		
2024	2024-660026637	LAIR, HARLEY HUNTER &	29	217,274	0	23,900	2,017.00																																																																																																																		
2023	2023-660026637	ON THE ROCKS RENTALS &	29	71,475	0	3,652	311.00																																																																																																																		
2022	2022-660026637	DRAEGER, ROY W-ESTATE	29	63,994	2000	1,478	125.00																																																																																																																		
2021	2021-660026637	DRAEGER, ROY W	29	64,042	2000	1,478	125.00																																																																																																																		
2020	2020-660026637	DRAEGER, ROY W	29	64,302	2000	1,478	125.00																																																																																																																		
2019	2019-660026637	DRAEGER, ROY W	29	60,861	2000	1,478	127.00																																																																																																																		
2018	2018-660026637	DRAEGER, ROY W	29	67,693	2000	1,478	126.00																																																																																																																		
2017	2017-660026637	DRAEGER, ROY W	29	67,083	2000	1,478	127.00																																																																																																																		
2016	2016-660026637	DRAEGER, ROY W	29	64,940	2000	1,478	129.00																																																																																																																		
2015	2015-660026637	DRAEGER, ROY W	29	68,184	2000	1,478	127.00																																																																																																																		
2014	2014-660026637	DRAEGER, ROY W	29	70,689	2000	1,478	132.00																																																																																																																		
2013	2013-660026637	DRAEGER, ROY W	29	70,024	2000	1,478	131.00																																																																																																																		



Rogers

Assessment Property Record Card for Tax Year 2026

Data provided by LISA DELOZIER County Assessor

Date 04/16/2026
 Time 23:40:14
 Page 2

Lot Data		Square-Foot - NBHD 1195 #1	
Lot Size			
Lot Count			
Units Buildable	1		
Non-Ag Acres	0.5343		
Topography			
Street Access			
Utilities			
Amenities	LAND QUALITY	0	
		0	
Method	Square-Foot		
Base Lot Value	23,274.00 x 1.10 = 25,601		
Factor Value			
Adjustments	2.0289		
Lot Value	51,942		



Residential Data	
Type	1 Single Family Residence
Condition	3 - Average
Quality	3 - Average
Architecture	
Style	100% One Story
Exterior Wall	100% Frame, Siding, Wood
Base/Total Area	1,906 / 1,906
Style	100% One Story
HVAC	100% Wall Furnace
Roof Cover	1 Composition Shingle
Area on Slab	0
Fixture/RghIn	4 /
Bed/F/H Bath	3 / 1.0 /
Basement Area	
Garage Type	
Remodel	UPDATE -
Year/Eff Age	1940 / 22

GRM Approach

GRM Code	
Gross Rent	0.00
Indicated Value	

Multiple Regression

MRA Code	1 Test
Adjusted R	0.8445
Indicated Value	143,269 75.17 Per SqFt

Direct Comparables

Selection Model	A Adam Test
Adjustment Model	1 2022 Residential
Comparables	7
Indicated Value	92,190 Per SqFt

Value Reconciliation

Selected Approach	Cost Approach
Improvements	160,212
Lot Value	51,942
Indicated Value	212,154 111.31 Per SqFt
Agland Value	
Site Improvements	8,313
Total Value	220,467 115.67 Total Value Per SqFt

Cost Approach Manual : 01/2025

Base Cost	100.29	Total Misc Impr	+	8,368
Roofing Adj	+ 4.75	Garage Cost	+	
Subfloor Adj	+ 0.00	Total RCN	=	216,503
Heat/Cool Adj	+ 0.93	Depreciation (26%)	-	56,291
Plumbing Adj	+ 3.23	Lump Sums	+	0
Basement Adj	+ 0.00	RCNLD	=	160,212
Adj Base Cost	= 109.20	Lot Value	+	51,942
Total Area	x 1,906	Indicated Value	=	212,154
Adjusted Cost	= 208,135	Value Per SqFt		111.31

Miscellaneous Improvements

Code	Description	Sketch ID	Size	Year	Units	Unit Cost	Depr	Value
PRCH	SLAB PORCH - COVERED	64534	33x6		198	26.31		5,209
PRCH	SLAB PORCH - COVERED	64535	17x7		119	26.55		3,159



Rogers

Assessment Property Record Card for Tax Year 2026

Data provided by LISA DELOZIER County Assessor

Date 04/16/2026

Time 23:40:14

Page 3

Sketch Image

660026637

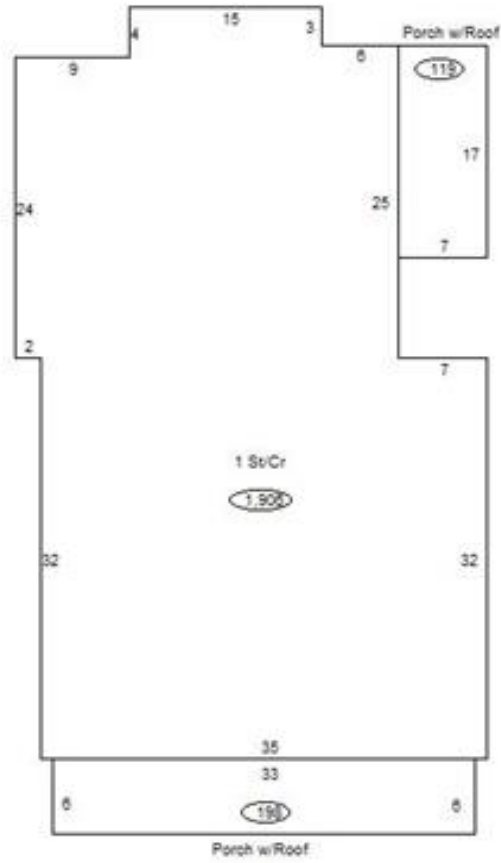

Sketch Vector Information

Sequence	Code	Type	Built Over	Scale	Section Label	Base Area	Multiplier	Total Area
1	R	1	Crawl	13	1 St/Cr	1,906	1.000	1,906
2	M	PRCH		13	SLBC	198	1.000	198
3	M	PRCH		13	SLBC	119	1.000	119
Total Building Area						1,906		1,906



Rogers

Assessment Property Record Card for Tax Year 2026

Data provided by LISA DELOZIER County Assessor

Date 04/16/2026
Time 23:40:14
Page 4

660026637

Outbuildings/Site Improvements

Building Image	Code	Description	Dimensions	Floor	Roofing	Total Units
	GRDT	GARAGE - DETACHED	0x0x0			594
	Qual 3	Cond 3	Year	Eff Age		
Valuation Summary		Modifier Total	RCN	Depr (50% Phys/ % Func)	RCNLD	
Base Cost (27.99 x 594)		16,626	16,626	8,313	8,313	