



Rogers

Assessment Property Record Card for Tax Year 2026

Data provided by LISA DELOZIER County Assessor

Date 04/16/2026
Time 23:40:27
Page 1

Assessment Data					Primary Image																																																																																																																				
Account 660026673 Parcel ID 000000-00-0-30010-065-0003 Cadastral ID 30-24-18-05160 Property Type REAL - Real Property Property Class URP VI Area 2 Tax Area 29 - CHELSEA OT Name ID 322448 SCHULZE, KEITH & FRANCIS SCHULZE 320 E 8TH ST CHELSEA OK 74016-0000 Parcel Location Situs 00320 E 8TH ST Subdivision CHELSEA O T Lot/Block 0003 / 0065 Parcel Size 1 - Lots Sec/Twn/Rng 30 / 24 / 18 / 5 Neighborhood 1195 - R-V02-NE CHELSEA School District S003 - CHELSEA SCHOOLS					<p>\\tsclient\C\Users\rln\Pictures\2020-05-06\IMG_0099.JPG 5/11/2020</p>																																																																																																																				
Legal Description Lot/Long: 36.53031218 -95.42849301																																																																																																																									
Building Permits					<table border="1"> <thead> <tr> <th>Number</th> <th>Description</th> <th>Opened</th> <th>Closed</th> <th>Amount</th> </tr> </thead> <tbody> <tr> <td colspan="5"> </td> </tr> </tbody> </table>					Number	Description	Opened	Closed	Amount																																																																																																											
Number	Description	Opened	Closed	Amount																																																																																																																					
Exemptions					Sale History																																																																																																																				
<table border="1"> <thead> <tr> <th>Code</th> <th>Type</th> <th>Active</th> <th>Maximum</th> <th>Exemption</th> </tr> </thead> <tbody> <tr> <td colspan="5"> </td> </tr> </tbody> </table>					Code	Type	Active	Maximum	Exemption						<table border="1"> <thead> <tr> <th>Bk/Pg</th> <th>Grantor</th> <th>Date</th> <th>Price</th> <th>Code</th> </tr> </thead> <tbody> <tr> <td>2659/509</td> <td>HERBRICH, WOLF THOMAS</td> <td>09/05/2017</td> <td>0</td> <td>12</td> </tr> <tr> <td>2478/381</td> <td>DADLER, WOLFGANG</td> <td>06/08/2015</td> <td>0</td> <td>1</td> </tr> </tbody> </table>					Bk/Pg	Grantor	Date	Price	Code	2659/509	HERBRICH, WOLF THOMAS	09/05/2017	0	12	2478/381	DADLER, WOLFGANG	06/08/2015	0	1																																																																																							
Code	Type	Active	Maximum	Exemption																																																																																																																					
Bk/Pg	Grantor	Date	Price	Code																																																																																																																					
2659/509	HERBRICH, WOLF THOMAS	09/05/2017	0	12																																																																																																																					
2478/381	DADLER, WOLFGANG	06/08/2015	0	1																																																																																																																					
Parcel Valuation																																																																																																																									
<table border="1"> <thead> <tr> <th>Source</th> <th>REAL</th> </tr> </thead> <tbody> <tr> <td>Remove Cap</td> <td></td> </tr> <tr> <td>Year Frozen</td> <td>0</td> </tr> <tr> <td>Uncapped Value</td> <td>0</td> </tr> <tr> <td>TIF Project ID</td> <td>0</td> </tr> </tbody> </table>		Source	REAL	Remove Cap		Year Frozen	0	Uncapped Value	0	TIF Project ID	0	<table border="1"> <thead> <tr> <th>Fair Cash</th> <th>Capped</th> <th>Asmnt Level</th> <th>Assessed</th> </tr> </thead> <tbody> <tr> <td>Land Value 16,694</td> <td>8,496</td> <td>11%</td> <td>935</td> </tr> <tr> <td>Improvements 27,847</td> <td>7,680</td> <td></td> <td>845</td> </tr> <tr> <td>Mobile Home 0</td> <td>0</td> <td></td> <td>0</td> </tr> <tr> <td>Total Value 44,541</td> <td>16,176</td> <td></td> <td>1,780</td> </tr> </tbody> </table>			Fair Cash	Capped	Asmnt Level	Assessed	Land Value 16,694	8,496	11%	935	Improvements 27,847	7,680		845	Mobile Home 0	0		0	Total Value 44,541	16,176		1,780	<table border="1"> <thead> <tr> <th>Levy Rate</th> <th>82.750</th> <th>Current Tax</th> </tr> </thead> <tbody> <tr> <td>Assessed</td> <td>1,780</td> <td>147.30</td> </tr> <tr> <td>Penalty</td> <td>0</td> <td></td> </tr> <tr> <td>Exemption</td> <td>0</td> <td>0.00</td> </tr> <tr> <td>Total Taxable</td> <td>1,780</td> <td>147.00</td> </tr> </tbody> </table>		Levy Rate	82.750	Current Tax	Assessed	1,780	147.30	Penalty	0		Exemption	0	0.00	Total Taxable	1,780	147.00																																																																						
Source	REAL																																																																																																																								
Remove Cap																																																																																																																									
Year Frozen	0																																																																																																																								
Uncapped Value	0																																																																																																																								
TIF Project ID	0																																																																																																																								
Fair Cash	Capped	Asmnt Level	Assessed																																																																																																																						
Land Value 16,694	8,496	11%	935																																																																																																																						
Improvements 27,847	7,680		845																																																																																																																						
Mobile Home 0	0		0																																																																																																																						
Total Value 44,541	16,176		1,780																																																																																																																						
Levy Rate	82.750	Current Tax																																																																																																																							
Assessed	1,780	147.30																																																																																																																							
Penalty	0																																																																																																																								
Exemption	0	0.00																																																																																																																							
Total Taxable	1,780	147.00																																																																																																																							
Assessment History																																																																																																																									
<table border="1"> <thead> <tr> <th>Tax Year</th> <th>Statement Number</th> <th>Billed Owner</th> <th>Tax Area</th> <th>Total Value</th> <th>Exemptions</th> <th>Taxable Value</th> <th>Billed Tax</th> </tr> </thead> <tbody> <tr><td>2025</td><td>2025-660026673</td><td>SCHULZE, KEITH &</td><td>29</td><td>42,991</td><td>0</td><td>1,695</td><td>140.00</td></tr> <tr><td>2024</td><td>2024-660026673</td><td>SCHULZE, KEITH &</td><td>29</td><td>45,102</td><td>0</td><td>1,614</td><td>136.00</td></tr> <tr><td>2023</td><td>2023-660026673</td><td>SCHULZE, KEITH &</td><td>29</td><td>19,119</td><td>0</td><td>1,537</td><td>131.00</td></tr> <tr><td>2022</td><td>2022-660026673</td><td>SCHULZE, KEITH &</td><td>29</td><td>13,310</td><td>0</td><td>1,464</td><td>124.00</td></tr> <tr><td>2021</td><td>2021-660026673</td><td>SCHULZE, KEITH &</td><td>29</td><td>17,954</td><td>0</td><td>1,975</td><td>167.00</td></tr> <tr><td>2020</td><td>2020-660026673</td><td>SCHULZE, KEITH &</td><td>29</td><td>28,006</td><td>0</td><td>3,081</td><td>261.00</td></tr> <tr><td>2019</td><td>2019-660026673</td><td>SCHULZE, KEITH &</td><td>29</td><td>26,826</td><td>0</td><td>2,951</td><td>253.00</td></tr> <tr><td>2018</td><td>2018-660026673</td><td>SCHULZE, KEITH &</td><td>29</td><td>27,032</td><td>0</td><td>2,974</td><td>254.00</td></tr> <tr><td>2017</td><td>2017-660026673</td><td>SCHULZE, KEITH &</td><td>29</td><td>26,851</td><td>0</td><td>2,954</td><td>253.00</td></tr> <tr><td>2016</td><td>2016-660026673</td><td>HERBRICH, WOLF THOMAS</td><td>29</td><td>26,226</td><td>0</td><td>2,885</td><td>251.00</td></tr> <tr><td>2015</td><td>2015-660026673</td><td>HERBRICH, WOLF THOMAS</td><td>29</td><td>25,870</td><td>0</td><td>2,833</td><td>244.00</td></tr> <tr><td>2014</td><td>2014-660026673</td><td>DADLER, WOLFGANG</td><td>29</td><td>26,039</td><td>0</td><td>2,698</td><td>240.00</td></tr> <tr><td>2013</td><td>2013-660026673</td><td>DADLER, WOLFGANG</td><td>29</td><td>25,920</td><td>0</td><td>2,570</td><td>228.00</td></tr> </tbody> </table>										Tax Year	Statement Number	Billed Owner	Tax Area	Total Value	Exemptions	Taxable Value	Billed Tax	2025	2025-660026673	SCHULZE, KEITH &	29	42,991	0	1,695	140.00	2024	2024-660026673	SCHULZE, KEITH &	29	45,102	0	1,614	136.00	2023	2023-660026673	SCHULZE, KEITH &	29	19,119	0	1,537	131.00	2022	2022-660026673	SCHULZE, KEITH &	29	13,310	0	1,464	124.00	2021	2021-660026673	SCHULZE, KEITH &	29	17,954	0	1,975	167.00	2020	2020-660026673	SCHULZE, KEITH &	29	28,006	0	3,081	261.00	2019	2019-660026673	SCHULZE, KEITH &	29	26,826	0	2,951	253.00	2018	2018-660026673	SCHULZE, KEITH &	29	27,032	0	2,974	254.00	2017	2017-660026673	SCHULZE, KEITH &	29	26,851	0	2,954	253.00	2016	2016-660026673	HERBRICH, WOLF THOMAS	29	26,226	0	2,885	251.00	2015	2015-660026673	HERBRICH, WOLF THOMAS	29	25,870	0	2,833	244.00	2014	2014-660026673	DADLER, WOLFGANG	29	26,039	0	2,698	240.00	2013	2013-660026673	DADLER, WOLFGANG	29	25,920	0	2,570	228.00
Tax Year	Statement Number	Billed Owner	Tax Area	Total Value	Exemptions	Taxable Value	Billed Tax																																																																																																																		
2025	2025-660026673	SCHULZE, KEITH &	29	42,991	0	1,695	140.00																																																																																																																		
2024	2024-660026673	SCHULZE, KEITH &	29	45,102	0	1,614	136.00																																																																																																																		
2023	2023-660026673	SCHULZE, KEITH &	29	19,119	0	1,537	131.00																																																																																																																		
2022	2022-660026673	SCHULZE, KEITH &	29	13,310	0	1,464	124.00																																																																																																																		
2021	2021-660026673	SCHULZE, KEITH &	29	17,954	0	1,975	167.00																																																																																																																		
2020	2020-660026673	SCHULZE, KEITH &	29	28,006	0	3,081	261.00																																																																																																																		
2019	2019-660026673	SCHULZE, KEITH &	29	26,826	0	2,951	253.00																																																																																																																		
2018	2018-660026673	SCHULZE, KEITH &	29	27,032	0	2,974	254.00																																																																																																																		
2017	2017-660026673	SCHULZE, KEITH &	29	26,851	0	2,954	253.00																																																																																																																		
2016	2016-660026673	HERBRICH, WOLF THOMAS	29	26,226	0	2,885	251.00																																																																																																																		
2015	2015-660026673	HERBRICH, WOLF THOMAS	29	25,870	0	2,833	244.00																																																																																																																		
2014	2014-660026673	DADLER, WOLFGANG	29	26,039	0	2,698	240.00																																																																																																																		
2013	2013-660026673	DADLER, WOLFGANG	29	25,920	0	2,570	228.00																																																																																																																		



Rogers

Assessment Property Record Card for Tax Year 2026

Data provided by LISA DELOZIER County Assessor

Date 04/16/2026
 Time 23:40:27
 Page 2

Lot Data		Square-Foot - NBHD 1195 #1	
Lot Size			
Lot Count			
Units Buildable	1		
Non-Ag Acres	0.3484		
Topography			
Street Access			
Utilities			
Amenities	LAND QUALITY	0	
		0	
Method	Square-Foot		
Base Lot Value	15,176.00 x 1.10 = 16,694		
Factor Value			
Adjustments	1.0000		
Lot Value	16,694		

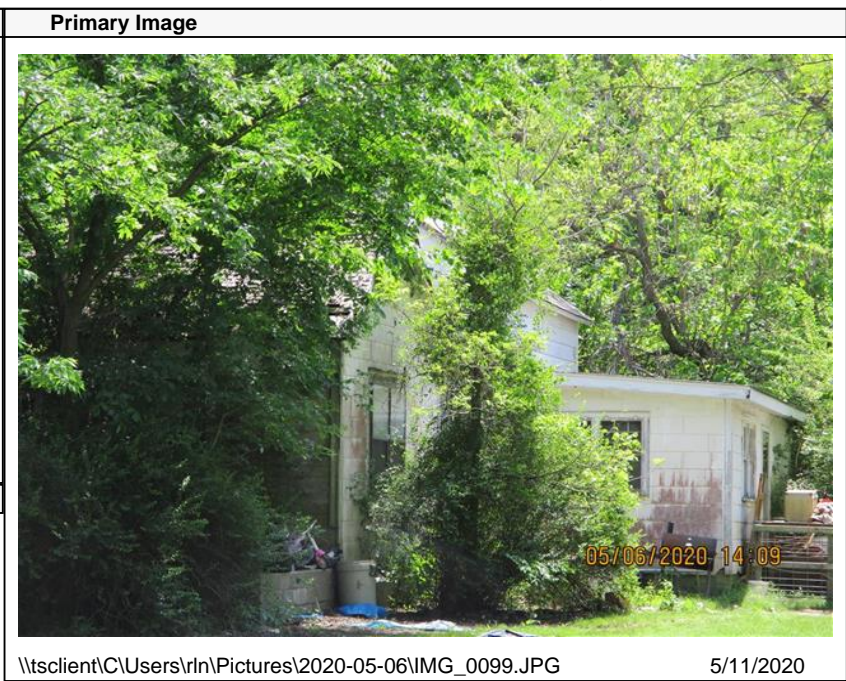

\\tsclient\C\Users\rln\Pictures\2020-05-06\IMG_0099.JPG 5/11/2020

Residential Data	
Type	1 Single Family Residence
Condition	1 - Low
Quality	1 - Low
Architecture	
Style	100% 1 1/2 Story Finished
Exterior Wall	100% Frame, Siding, Wood
Base/Total Area	1,632 / 1,812
Style	100% 1 1/2 Story Finished
HVAC	100% Wall Furnace
Roof Cover	1 Composition Shingle
Area on Slab	0
Fixture/RghIn	4 /
Bed/F/H Bath	3 / 1.0 /
Basement Area	
Garage Type	
Remodel	
Year/Eff Age	1940 / 120

GRM Approach

GRM Code	
Gross Rent	0.00
Indicated Value	

Multiple Regression

MRA Code	1 Test
Adjusted R	0.8445
Indicated Value	39,109 21.58 Per SqFt

Direct Comparables

Selection Model	A Adam Test
Adjustment Model	1 2022 Residential
Comparables	4
Indicated Value	28,690 Per SqFt

Value Reconciliation

Selected Approach	Cost Approach
Improvements	27,847
Lot Value	16,694
Indicated Value	44,541 24.58 Per SqFt
Agland Value	
Site Improvements	
Total Value	44,541 24.58 Total Value Per SqFt

Cost Approach Manual : 01/2025

Base Cost	67.28	Total Misc Impr	+	1,958
Roofing Adj	+ 3.16	Garage Cost	+	
Subfloor Adj	+ 2.08	Total RCN	=	139,235
Heat/Cool Adj	+ 0.70	Depreciation (80%)	-	111,388
Plumbing Adj	+ 2.54	Lump Sums	+	0
Basement Adj	+ 0.00	RCNLD	=	27,847
Adj Base Cost	= 75.76	Lot Value	+	16,694
Total Area	x 1,812	Indicated Value	=	44,541
Adjusted Cost	= 137,277	Value Per SqFt		24.58

Miscellaneous Improvements

Code	Description	Sketch ID	Size	Year	Units	Unit Cost	Depr	Value
PRCH	SLAB PORCH - COVERED	64586	18x6		108	18.13		1,958



Rogers

Assessment Property Record Card for Tax Year 2026

Data provided by LISA DELOZIER County Assessor

Date 04/16/2026
 Time 23:40:27
 Page 3

Sketch Image

660026673

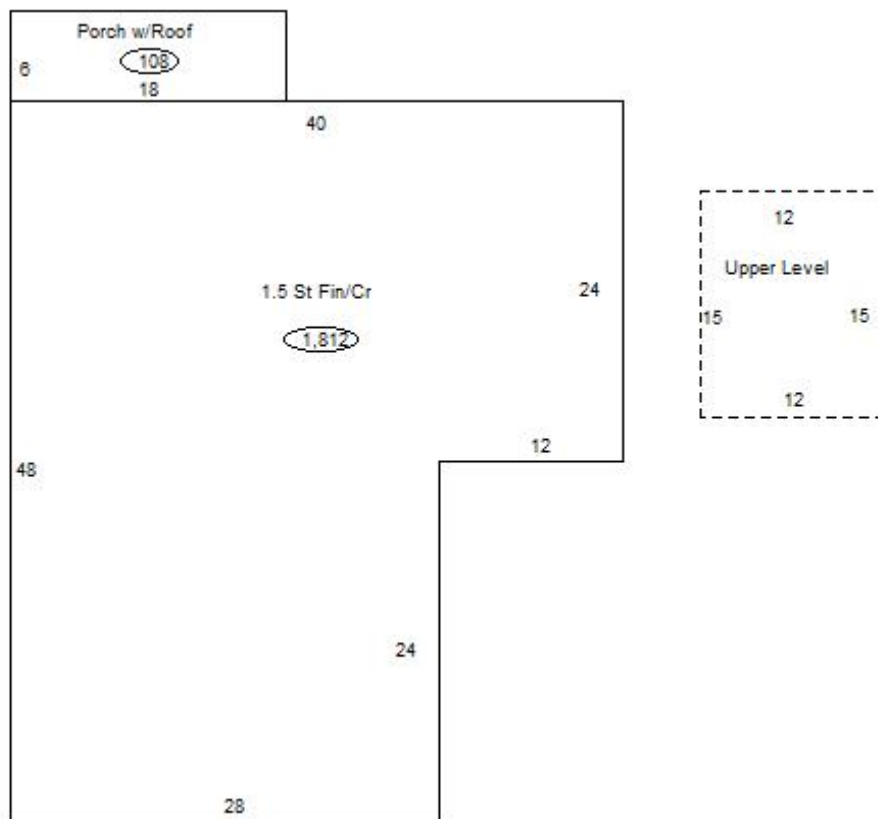

Sketch Vector Information

Sequence	Code	Type	Built Over	Scale	Section Label	Base Area	Multiplier	Total Area
1	R	5	Crawl	13	1.5 St Fin/Cr	1,632	1.110	1,812
2	M	PRCH		13	SLBC	108	1.000	108
3	U	^UL	Overhang	13	Upper Level	180	1.000	180
Total Building Area						1,632		1,812