



Rogers

Assessment Property Record Card for Tax Year 2026

Data provided by LISA DELOZIER County Assessor

Date 04/16/2026
Time 23:40:35
Page 1

Assessment Data					Primary Image																																																																																																																				
Account 660026683 Parcel ID 000000-00-0-30010-065-0011 Cadastral ID 30-24-18-05250 Property Type REAL - Real Property Property Class URP VI Area 2 Tax Area 29 - CHELSEA OT Name ID 285986 WILEY, CAROLYN E 311 E 9TH ST CHELSEA OK 74016-0000 Parcel Location Situs 00311 E 9TH ST Subdivision CHELSEA O T Lot/Block 0011 / 0065 Parcel Size .5 - Lots Sec/Twn/Rng 30 / 24 / 18 / 5 Neighborhood 1195 - R-V02-NE CHELSEA School District S003 - CHELSEA SCHOOLS																																																																																																																									
Legal Description Lat/Long: 36.53007544 -95.42905649																																																																																																																									
Legal Description W 80' OF LOT 11 BLOCK 65 CHELSEA O T					Building Permits <table border="1"> <thead> <tr> <th>Number</th> <th>Description</th> <th>Opened</th> <th>Closed</th> <th>Amount</th> </tr> </thead> <tbody> <tr> <td></td> <td></td> <td></td> <td></td> <td></td> </tr> </tbody> </table>					Number	Description	Opened	Closed	Amount																																																																																																											
Number	Description	Opened	Closed	Amount																																																																																																																					
Exemptions <table border="1"> <thead> <tr> <th>Code</th> <th>Type</th> <th>Active</th> <th>Maximum</th> <th>Exemption</th> </tr> </thead> <tbody> <tr> <td>H</td> <td>Homestead</td> <td>Yes</td> <td>1,000</td> <td>1,000</td> </tr> </tbody> </table>					Code	Type	Active	Maximum	Exemption	H	Homestead	Yes	1,000	1,000	Sale History <table border="1"> <thead> <tr> <th>Bk/Pg</th> <th>Grantor</th> <th>Date</th> <th>Price</th> <th>Code</th> </tr> </thead> <tbody> <tr> <td>1604/456</td> <td>MELSON, ROGER W &</td> <td>06/25/2004</td> <td>34,000</td> <td>9</td> </tr> <tr> <td>1259/167</td> <td>KING, GARY DALE</td> <td>11/28/2000</td> <td>20,000</td> <td>Yes</td> </tr> <tr> <td>1038/203</td> <td>WILES, JIM D &</td> <td>08/03/1996</td> <td>27,500</td> <td>No</td> </tr> <tr> <td>857/106</td> <td></td> <td></td> <td>0</td> <td>No</td> </tr> </tbody> </table>					Bk/Pg	Grantor	Date	Price	Code	1604/456	MELSON, ROGER W &	06/25/2004	34,000	9	1259/167	KING, GARY DALE	11/28/2000	20,000	Yes	1038/203	WILES, JIM D &	08/03/1996	27,500	No	857/106			0	No																																																																													
Code	Type	Active	Maximum	Exemption																																																																																																																					
H	Homestead	Yes	1,000	1,000																																																																																																																					
Bk/Pg	Grantor	Date	Price	Code																																																																																																																					
1604/456	MELSON, ROGER W &	06/25/2004	34,000	9																																																																																																																					
1259/167	KING, GARY DALE	11/28/2000	20,000	Yes																																																																																																																					
1038/203	WILES, JIM D &	08/03/1996	27,500	No																																																																																																																					
857/106			0	No																																																																																																																					
Parcel Valuation <table border="1"> <thead> <tr> <th>Source</th> <th>REAL</th> <th>Fair Cash</th> <th>Capped</th> <th>Asmnt Level</th> <th>Assessed</th> <th>Levy Rate</th> <th>82.750</th> <th>Current Tax</th> </tr> </thead> <tbody> <tr> <td>Remove Cap</td> <td>2005</td> <td>Land Value 12,664</td> <td>7,320</td> <td>11%</td> <td>805</td> <td>Assessed</td> <td>2,960</td> <td>244.94</td> </tr> <tr> <td>Year Frozen</td> <td>0</td> <td>Improvements 27,490</td> <td>19,587</td> <td></td> <td>2,155</td> <td>Penalty</td> <td>0</td> <td></td> </tr> <tr> <td>Uncapped Value</td> <td>0</td> <td>Mobile Home 0</td> <td>0</td> <td></td> <td>0</td> <td>Exemption</td> <td>1,000</td> <td>-83.00</td> </tr> <tr> <td>TIF Project ID</td> <td>0</td> <td>Total Value 40,154</td> <td>26,907</td> <td></td> <td>2,960</td> <td>Total Taxable</td> <td>1,960</td> <td>162.00</td> </tr> </tbody> </table>										Source	REAL	Fair Cash	Capped	Asmnt Level	Assessed	Levy Rate	82.750	Current Tax	Remove Cap	2005	Land Value 12,664	7,320	11%	805	Assessed	2,960	244.94	Year Frozen	0	Improvements 27,490	19,587		2,155	Penalty	0		Uncapped Value	0	Mobile Home 0	0		0	Exemption	1,000	-83.00	TIF Project ID	0	Total Value 40,154	26,907		2,960	Total Taxable	1,960	162.00																																																																			
Source	REAL	Fair Cash	Capped	Asmnt Level	Assessed	Levy Rate	82.750	Current Tax																																																																																																																	
Remove Cap	2005	Land Value 12,664	7,320	11%	805	Assessed	2,960	244.94																																																																																																																	
Year Frozen	0	Improvements 27,490	19,587		2,155	Penalty	0																																																																																																																		
Uncapped Value	0	Mobile Home 0	0		0	Exemption	1,000	-83.00																																																																																																																	
TIF Project ID	0	Total Value 40,154	26,907		2,960	Total Taxable	1,960	162.00																																																																																																																	
Assessment History <table border="1"> <thead> <tr> <th>Tax Year</th> <th>Statement Number</th> <th>Billed Owner</th> <th>Tax Area</th> <th>Total Value</th> <th>Exemptions</th> <th>Taxable Value</th> <th>Billed Tax</th> </tr> </thead> <tbody> <tr><td>2025</td><td>2025-660026683</td><td>WILEY, CAROLYN E</td><td>29</td><td>38,735</td><td>1000</td><td>1,874</td><td>155.00</td></tr> <tr><td>2024</td><td>2024-660026683</td><td>WILEY, CAROLYN E</td><td>29</td><td>40,762</td><td>1000</td><td>1,790</td><td>151.00</td></tr> <tr><td>2023</td><td>2023-660026683</td><td>WILEY, CAROLYN E</td><td>29</td><td>29,671</td><td>1000</td><td>1,709</td><td>146.00</td></tr> <tr><td>2022</td><td>2022-660026683</td><td>WILEY, CAROLYN E</td><td>29</td><td>23,909</td><td>1000</td><td>1,630</td><td>138.00</td></tr> <tr><td>2021</td><td>2021-660026683</td><td>WILEY, CAROLYN E</td><td>29</td><td>25,644</td><td>1000</td><td>1,821</td><td>154.00</td></tr> <tr><td>2020</td><td>2020-660026683</td><td>WILEY, CAROLYN E</td><td>29</td><td>26,174</td><td>1000</td><td>1,838</td><td>156.00</td></tr> <tr><td>2019</td><td>2019-660026683</td><td>WILEY, CAROLYN E</td><td>29</td><td>25,045</td><td>1000</td><td>1,755</td><td>151.00</td></tr> <tr><td>2018</td><td>2018-660026683</td><td>WILEY, CAROLYN E</td><td>29</td><td>26,951</td><td>1000</td><td>1,965</td><td>168.00</td></tr> <tr><td>2017</td><td>2017-660026683</td><td>WILEY, CAROLYN E</td><td>29</td><td>26,758</td><td>1000</td><td>1,944</td><td>167.00</td></tr> <tr><td>2016</td><td>2016-660026683</td><td>WILEY, CAROLYN E</td><td>29</td><td>26,131</td><td>1000</td><td>1,875</td><td>163.00</td></tr> <tr><td>2015</td><td>2015-660026683</td><td>WILEY, CAROLYN E</td><td>29</td><td>25,667</td><td>1000</td><td>1,824</td><td>157.00</td></tr> <tr><td>2014</td><td>2014-660026683</td><td>WILEY, CAROLYN E</td><td>29</td><td>26,646</td><td>1000</td><td>1,906</td><td>170.00</td></tr> <tr><td>2013</td><td>2013-660026683</td><td>WILEY, CAROLYN E</td><td>29</td><td>26,505</td><td>1000</td><td>1,821</td><td>162.00</td></tr> </tbody> </table>										Tax Year	Statement Number	Billed Owner	Tax Area	Total Value	Exemptions	Taxable Value	Billed Tax	2025	2025-660026683	WILEY, CAROLYN E	29	38,735	1000	1,874	155.00	2024	2024-660026683	WILEY, CAROLYN E	29	40,762	1000	1,790	151.00	2023	2023-660026683	WILEY, CAROLYN E	29	29,671	1000	1,709	146.00	2022	2022-660026683	WILEY, CAROLYN E	29	23,909	1000	1,630	138.00	2021	2021-660026683	WILEY, CAROLYN E	29	25,644	1000	1,821	154.00	2020	2020-660026683	WILEY, CAROLYN E	29	26,174	1000	1,838	156.00	2019	2019-660026683	WILEY, CAROLYN E	29	25,045	1000	1,755	151.00	2018	2018-660026683	WILEY, CAROLYN E	29	26,951	1000	1,965	168.00	2017	2017-660026683	WILEY, CAROLYN E	29	26,758	1000	1,944	167.00	2016	2016-660026683	WILEY, CAROLYN E	29	26,131	1000	1,875	163.00	2015	2015-660026683	WILEY, CAROLYN E	29	25,667	1000	1,824	157.00	2014	2014-660026683	WILEY, CAROLYN E	29	26,646	1000	1,906	170.00	2013	2013-660026683	WILEY, CAROLYN E	29	26,505	1000	1,821	162.00
Tax Year	Statement Number	Billed Owner	Tax Area	Total Value	Exemptions	Taxable Value	Billed Tax																																																																																																																		
2025	2025-660026683	WILEY, CAROLYN E	29	38,735	1000	1,874	155.00																																																																																																																		
2024	2024-660026683	WILEY, CAROLYN E	29	40,762	1000	1,790	151.00																																																																																																																		
2023	2023-660026683	WILEY, CAROLYN E	29	29,671	1000	1,709	146.00																																																																																																																		
2022	2022-660026683	WILEY, CAROLYN E	29	23,909	1000	1,630	138.00																																																																																																																		
2021	2021-660026683	WILEY, CAROLYN E	29	25,644	1000	1,821	154.00																																																																																																																		
2020	2020-660026683	WILEY, CAROLYN E	29	26,174	1000	1,838	156.00																																																																																																																		
2019	2019-660026683	WILEY, CAROLYN E	29	25,045	1000	1,755	151.00																																																																																																																		
2018	2018-660026683	WILEY, CAROLYN E	29	26,951	1000	1,965	168.00																																																																																																																		
2017	2017-660026683	WILEY, CAROLYN E	29	26,758	1000	1,944	167.00																																																																																																																		
2016	2016-660026683	WILEY, CAROLYN E	29	26,131	1000	1,875	163.00																																																																																																																		
2015	2015-660026683	WILEY, CAROLYN E	29	25,667	1000	1,824	157.00																																																																																																																		
2014	2014-660026683	WILEY, CAROLYN E	29	26,646	1000	1,906	170.00																																																																																																																		
2013	2013-660026683	WILEY, CAROLYN E	29	26,505	1000	1,821	162.00																																																																																																																		



Rogers

Assessment Property Record Card for Tax Year 2026

Data provided by LISA DELOZIER County Assessor

Date 04/16/2026
 Time 23:40:35
 Page 2

Lot Data		Square-Foot - NBHD 1195 #1	
Lot Size			
Lot Count			
Units Buildable	1		
Non-Ag Acres	0.2643		
Topography			
Street Access			
Utilities			
Amenities	LAND QUALITY	0	
		0	
Method	Square-Foot		
Base Lot Value	11,513.00 x 1.10 = 12,664		
Factor Value			
Adjustments	1.0000		
Lot Value	12,664		



Residential Data	
Type	1 Single Family Residence
Condition	2 - Fair
Quality	2 - Fair
Architecture	
Style	100% One Story
Exterior Wall	100% Frame, Siding, Vinyl
Base/Total Area	1,108 / 1,108
Style	100% One Story
HVAC	100% Warmed & Cooled Air
Roof Cover	1 Composition Shingle
Area on Slab	0
Fixture/RghIn	4 /
Bed/F/H Bath	2 / 1.0 /
Basement Area	
Garage Type	330 Attached Garage - Unfinished
Remodel	
Year/Eff Age	1940 / 86

5/10/2024

Cost Approach				Manual : 01/2025			
Base Cost	94.58	Total Misc Impr	+ 0				
Roofing Adj	+ 4.30	Garage Cost	+ 8,656				
Subfloor Adj	+ 2.54	Total RCN	= 137,450				
Heat/Cool Adj	+ 10.30	Depreciation (80%)	- 109,960				
Plumbing Adj	+ 4.52	Lump Sums	+ 0				
Basement Adj	+ 0.00	RCNLD	= 27,490				
Adj Base Cost	= 116.24	Lot Value	+ 12,664				
Total Area	x 1,108	Indicated Value	= 40,154				
Adjusted Cost	= 128,794	Value Per SqFt	36.24				

GRM Approach	
GRM Code	
Gross Rent	0.00
Indicated Value	

Multiple Regression			
MRA Code	1 Test		
Adusted R	0.8445		
Indicated Value	78,515	70.86	Per SqFt

Direct Comparables			
Selection Model	A Adam Test		
Adjustment Model	1 2022 Residential		
Comparables	8		
Indicated Value	63,750		Per SqFt

Value Reconciliation			
Selected Approach	Cost Approach		
Improvements	27,490		
Lot Value	12,664		
Indicated Value	40,154	36.24	Per SqFt
Agland Value			
Site Improvements			
Total Value	40,154	36.24	Total Value Per SqFt

Miscellaneous Improvements							
Code	Description	Sketch ID	Size	Year	Units	Unit Cost	Depr Value



Rogers

Assessment Property Record Card for Tax Year 2026

Data provided by LISA DELOZIER County Assessor

Date 04/16/2026
Time 23:40:35
Page 3

Sketch Image

660026683

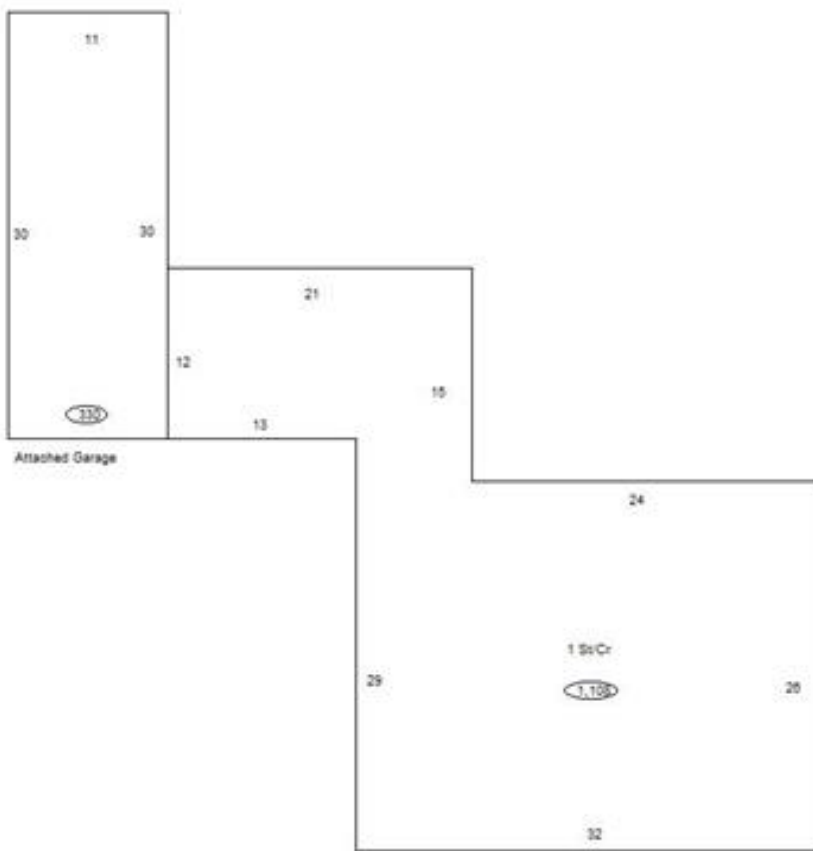

Sketch Vector Information

Sequence	Code	Type	Built Over	Scale	Section Label	Base Area	Multiplier	Total Area
1	R	1	Crawl	10	1 St/Cr	1,108	1.000	1,108
2	G	1		10	Attached Garage	330	1.000	330
Total Building Area						1,108		1,108



Rogers

Assessment Property Record Card for Tax Year 2026

Data provided by LISA DELOZIER County Assessor

Date 04/16/2026
Time 23:40:35
Page 4

660026683

Outbuildings/Site Improvements

Building Image	Code	Description	Dimensions	Floor	Roofing	Total Units
	STF	STG FAIR	0x0x0			
	Qual	2	Cond	Year	Eff Age	
Valuation Summary		Modifier Total	RCN	Depr (100% Phys/ % Func)	RCNLD	
Base Cost (4.68 x)						