



Rogers

Assessment Property Record Card for Tax Year 2026

Data provided by LISA DELOZIER County Assessor

Date 04/17/2026
 Time 17:59:16
 Page 1

Assessment Data					Primary Image																																																																																																																				
Account 660027193 Parcel ID 000000-00-0-00831-001-0005 Cadastral ID 31-22-15-02750 Property Type REAL - Real Property Property Class RRP VI Area 4 Tax Area 28 - COLLINSVILLE/LIME FIRE Name ID 300938 GRANGER, JONATHAN & ALTAGRACIA REVOCABLE LIVING TRUST 18427 S ASH RD CLAREMORE OK 74019-0000																																																																																																																									
Parcel Location Situs 18427 S ASH RD Subdivision TRAILS END ESTATES Lot/Block 0005 / 0001 Parcel Size 1 - Lots Sec/Twn/Rng 31 / 22 / 15 / 5 Neighborhood 1132 - R-V04-NW COLLINSVILLE School District S026 - COLLINSVILLE SCHOOLS																																																																																																																									
Legal Description Lot/Long: 36.34092589 -95.74187125 LOT 5 BLOCK 1 TRAILS END ESTATES					Building Permits <table border="1"> <thead> <tr> <th>Number</th> <th>Description</th> <th>Opened</th> <th>Closed</th> <th>Amount</th> </tr> </thead> <tbody> <tr> <td> </td> <td> </td> <td> </td> <td> </td> <td> </td> </tr> </tbody> </table>					Number	Description	Opened	Closed	Amount																																																																																																											
Number	Description	Opened	Closed	Amount																																																																																																																					
Exemptions <table border="1"> <thead> <tr> <th>Code</th> <th>Type</th> <th>Active</th> <th>Maximum</th> <th>Exemption</th> </tr> </thead> <tbody> <tr> <td>H</td> <td>Homestead</td> <td>Yes</td> <td> </td> <td>1,000</td> </tr> </tbody> </table>					Code	Type	Active	Maximum	Exemption	H	Homestead	Yes		1,000	Sale History <table border="1"> <thead> <tr> <th>Bk/Pg</th> <th>Grantor</th> <th>Date</th> <th>Price</th> <th>Code</th> </tr> </thead> <tbody> <tr> <td>2046/436</td> <td>FOX, MICHAEL DAREN &</td> <td>07/30/2009</td> <td>140,000</td> <td>YES</td> </tr> <tr> <td>1303/499</td> <td>DRAKE, JOHN E</td> <td>07/09/2001</td> <td>110,000</td> <td>YES</td> </tr> <tr> <td>946/337</td> <td>HOMES BY BETTY</td> <td>02/08/1994</td> <td>68,500</td> <td>Yes</td> </tr> <tr> <td>939/338</td> <td>SOKOLOSKY, D M &</td> <td>12/07/1993</td> <td>10,000</td> <td>No</td> </tr> </tbody> </table>					Bk/Pg	Grantor	Date	Price	Code	2046/436	FOX, MICHAEL DAREN &	07/30/2009	140,000	YES	1303/499	DRAKE, JOHN E	07/09/2001	110,000	YES	946/337	HOMES BY BETTY	02/08/1994	68,500	Yes	939/338	SOKOLOSKY, D M &	12/07/1993	10,000	No																																																																													
Code	Type	Active	Maximum	Exemption																																																																																																																					
H	Homestead	Yes		1,000																																																																																																																					
Bk/Pg	Grantor	Date	Price	Code																																																																																																																					
2046/436	FOX, MICHAEL DAREN &	07/30/2009	140,000	YES																																																																																																																					
1303/499	DRAKE, JOHN E	07/09/2001	110,000	YES																																																																																																																					
946/337	HOMES BY BETTY	02/08/1994	68,500	Yes																																																																																																																					
939/338	SOKOLOSKY, D M &	12/07/1993	10,000	No																																																																																																																					
Parcel Valuation <table border="1"> <thead> <tr> <th>Source</th> <th>REAL</th> <th>Fair Cash</th> <th>Capped</th> <th>Asmnt Level</th> <th>Assessed</th> <th>Levy Rate</th> <th>112.698</th> <th>Current Tax</th> </tr> </thead> <tbody> <tr> <td>Remove Cap</td> <td>2010</td> <td>Land Value 55,262</td> <td>40,508</td> <td>11%</td> <td>4,456</td> <td>Assessed</td> <td>19,735</td> <td>2,224.10</td> </tr> <tr> <td>Year Frozen</td> <td>0</td> <td>Improvements 150,298</td> <td>138,897</td> <td> </td> <td>15,279</td> <td>Penalty</td> <td>0</td> <td> </td> </tr> <tr> <td>Uncapped Value</td> <td>0</td> <td>Mobile Home 0</td> <td>0</td> <td> </td> <td>0</td> <td>Exemption</td> <td>1,000</td> <td>-102.00</td> </tr> <tr> <td>TIF Project ID</td> <td>0</td> <td>Total Value 205,560</td> <td>179,405</td> <td> </td> <td>19,735</td> <td>Total Taxable</td> <td>18,735</td> <td>2,122.00</td> </tr> </tbody> </table>										Source	REAL	Fair Cash	Capped	Asmnt Level	Assessed	Levy Rate	112.698	Current Tax	Remove Cap	2010	Land Value 55,262	40,508	11%	4,456	Assessed	19,735	2,224.10	Year Frozen	0	Improvements 150,298	138,897		15,279	Penalty	0		Uncapped Value	0	Mobile Home 0	0		0	Exemption	1,000	-102.00	TIF Project ID	0	Total Value 205,560	179,405		19,735	Total Taxable	18,735	2,122.00																																																																			
Source	REAL	Fair Cash	Capped	Asmnt Level	Assessed	Levy Rate	112.698	Current Tax																																																																																																																	
Remove Cap	2010	Land Value 55,262	40,508	11%	4,456	Assessed	19,735	2,224.10																																																																																																																	
Year Frozen	0	Improvements 150,298	138,897		15,279	Penalty	0																																																																																																																		
Uncapped Value	0	Mobile Home 0	0		0	Exemption	1,000	-102.00																																																																																																																	
TIF Project ID	0	Total Value 205,560	179,405		19,735	Total Taxable	18,735	2,122.00																																																																																																																	
Assessment History <table border="1"> <thead> <tr> <th>Tax Year</th> <th>Statement Number</th> <th>Billed Owner</th> <th>Tax Area</th> <th>Total Value</th> <th>Exemptions</th> <th>Taxable Value</th> <th>Billed Tax</th> </tr> </thead> <tbody> <tr><td>2025</td><td>2025-660027193</td><td>GRANGER, JONATHAN &</td><td>28</td><td>201,500</td><td>1000</td><td>18,159</td><td>2,057.00</td></tr> <tr><td>2024</td><td>2024-660027193</td><td>GRANGER, JONATHAN D &</td><td>28</td><td>221,443</td><td>1000</td><td>17,602</td><td>2,030.00</td></tr> <tr><td>2023</td><td>2023-660027193</td><td>GRANGER, JONATHAN D &</td><td>28</td><td>168,457</td><td>1000</td><td>17,060</td><td>1,936.00</td></tr> <tr><td>2022</td><td>2022-660027193</td><td>GRANGER, JONATHAN D &</td><td>28</td><td>165,217</td><td>0</td><td>17,534</td><td>1,963.00</td></tr> <tr><td>2021</td><td>2021-660027193</td><td>GRANGER, JONATHAN D &</td><td>28</td><td>154,691</td><td>0</td><td>16,699</td><td>1,895.00</td></tr> <tr><td>2020</td><td>2020-660027193</td><td>GRANGER, JONATHAN D &</td><td>28</td><td>144,581</td><td>0</td><td>15,904</td><td>1,809.00</td></tr> <tr><td>2019</td><td>2019-660027193</td><td>GRANGER, JONATHAN D &</td><td>28</td><td>139,561</td><td>0</td><td>15,352</td><td>1,729.00</td></tr> <tr><td>2018</td><td>2018-660027193</td><td>GRANGER, JONATHAN D &</td><td>28</td><td>155,120</td><td>0</td><td>17,063</td><td>1,941.00</td></tr> <tr><td>2017</td><td>2017-660027193</td><td>GRANGER, JONATHAN D &</td><td>28</td><td>153,960</td><td>0</td><td>16,936</td><td>1,899.00</td></tr> <tr><td>2016</td><td>2016-660027193</td><td>GRANGER, JONATHAN D &</td><td>28</td><td>150,420</td><td>0</td><td>16,315</td><td>1,789.00</td></tr> <tr><td>2015</td><td>2015-660027193</td><td>GRANGER, JONATHAN D &</td><td>28</td><td>141,250</td><td>0</td><td>15,538</td><td>1,722.00</td></tr> <tr><td>2014</td><td>2014-660027193</td><td>GRANGER, JONATHAN D &</td><td>28</td><td>142,088</td><td>0</td><td>15,522</td><td>1,675.00</td></tr> <tr><td>2013</td><td>2013-660027193</td><td>GRANGER, JONATHAN D &</td><td>28</td><td>134,389</td><td>0</td><td>14,783</td><td>1,591.00</td></tr> </tbody> </table>										Tax Year	Statement Number	Billed Owner	Tax Area	Total Value	Exemptions	Taxable Value	Billed Tax	2025	2025-660027193	GRANGER, JONATHAN &	28	201,500	1000	18,159	2,057.00	2024	2024-660027193	GRANGER, JONATHAN D &	28	221,443	1000	17,602	2,030.00	2023	2023-660027193	GRANGER, JONATHAN D &	28	168,457	1000	17,060	1,936.00	2022	2022-660027193	GRANGER, JONATHAN D &	28	165,217	0	17,534	1,963.00	2021	2021-660027193	GRANGER, JONATHAN D &	28	154,691	0	16,699	1,895.00	2020	2020-660027193	GRANGER, JONATHAN D &	28	144,581	0	15,904	1,809.00	2019	2019-660027193	GRANGER, JONATHAN D &	28	139,561	0	15,352	1,729.00	2018	2018-660027193	GRANGER, JONATHAN D &	28	155,120	0	17,063	1,941.00	2017	2017-660027193	GRANGER, JONATHAN D &	28	153,960	0	16,936	1,899.00	2016	2016-660027193	GRANGER, JONATHAN D &	28	150,420	0	16,315	1,789.00	2015	2015-660027193	GRANGER, JONATHAN D &	28	141,250	0	15,538	1,722.00	2014	2014-660027193	GRANGER, JONATHAN D &	28	142,088	0	15,522	1,675.00	2013	2013-660027193	GRANGER, JONATHAN D &	28	134,389	0	14,783	1,591.00
Tax Year	Statement Number	Billed Owner	Tax Area	Total Value	Exemptions	Taxable Value	Billed Tax																																																																																																																		
2025	2025-660027193	GRANGER, JONATHAN &	28	201,500	1000	18,159	2,057.00																																																																																																																		
2024	2024-660027193	GRANGER, JONATHAN D &	28	221,443	1000	17,602	2,030.00																																																																																																																		
2023	2023-660027193	GRANGER, JONATHAN D &	28	168,457	1000	17,060	1,936.00																																																																																																																		
2022	2022-660027193	GRANGER, JONATHAN D &	28	165,217	0	17,534	1,963.00																																																																																																																		
2021	2021-660027193	GRANGER, JONATHAN D &	28	154,691	0	16,699	1,895.00																																																																																																																		
2020	2020-660027193	GRANGER, JONATHAN D &	28	144,581	0	15,904	1,809.00																																																																																																																		
2019	2019-660027193	GRANGER, JONATHAN D &	28	139,561	0	15,352	1,729.00																																																																																																																		
2018	2018-660027193	GRANGER, JONATHAN D &	28	155,120	0	17,063	1,941.00																																																																																																																		
2017	2017-660027193	GRANGER, JONATHAN D &	28	153,960	0	16,936	1,899.00																																																																																																																		
2016	2016-660027193	GRANGER, JONATHAN D &	28	150,420	0	16,315	1,789.00																																																																																																																		
2015	2015-660027193	GRANGER, JONATHAN D &	28	141,250	0	15,538	1,722.00																																																																																																																		
2014	2014-660027193	GRANGER, JONATHAN D &	28	142,088	0	15,522	1,675.00																																																																																																																		
2013	2013-660027193	GRANGER, JONATHAN D &	28	134,389	0	14,783	1,591.00																																																																																																																		



Rogers

Assessment Property Record Card for Tax Year 2026

Data provided by LISA DELOZIER County Assessor

Date 04/17/2026
Time 17:59:16
Page 2

Lot Data	Square-Foot - NBHD 1132 #1	Primary Image
Lot Size		
Lot Count		
Units Buildable	18344	
Non-Ag Acres	1.0287	
Topography		
Street Access		
Utilities		
Amenities	0	
	0	
Method	Square-Foot	
Base Lot Value	44,809.00 x 1.23 = 55,262	
Factor Value		
Adjustments	1.0000	
Lot Value	55,262	

Residential Data	
Type	1 Single Family Residence
Condition	3 - Average
Quality	2.5 - Fair
Architecture	
Style	100% One Story
Exterior Wall	90% Veneer, Masonry 10% Frame, Siding, Wood
Base/Total Area	1,308 / 1,308
Style	100% One Story
HVAC	100% Warmed & Cooled Air
Roof Cover	1 Composition Shingle
Area on Slab	1,308
Fixture/RghIn	11 /
Bed/F/H Bath	3 / 2.0 /
Basement Area	
Garage Type	440 Attached Garage - Unfinished
Remodel	
Year/Eff Age	1993 / 25

\\tsclient\T\TOMMY DUNLAP\New folder (76)\IMG_0033.JPG 6/28/2022

GRM Approach	
GRM Code	
Gross Rent	0.00
Indicated Value	

Multiple Regression			
MRA Code	1	Test	
Adusted R	0.8445		
Indicated Value	179,819	137.48	Per SqFt

Direct Comparables			
Selection Model	A	Adam Test	
Adjustment Model	1	2022 Residential	
Comparables	2		
Indicated Value	188,060		Per SqFt

Cost Approach				Manual : 01/2025			
Base Cost	109.20	Total Misc Impr	+	8,281			
Roofing Adj	+ 4.65	Garage Cost	+	12,487			
Subfloor Adj	+ -1.21	Total RCN	=	197,178			
Heat/Cool Adj	+ 11.47	Depreciation (34%)	-	67,041			
Plumbing Adj	+ 10.76	Lump Sums	+	0			
Basement Adj	+ 0.00	RCNLD	=	130,137			
Adj Base Cost	= 134.87	Lot Value	+	55,262			
Total Area	x 1,308	Indicated Value	=	185,399			
Adjusted Cost	= 176,410	Value Per SqFt		141.74			

Value Reconciliation			
Selected Approach	Cost Approach		
Improvements	130,137		
Lot Value	55,262		
Indicated Value	185,399	141.74	Per SqFt
Agland Value			
Site Improvements	20,161		
Total Value	205,560	157.16	Total Value Per SqFt

Miscellaneous Improvements								
Code	Description	Sketch ID	Size	Year	Units	Unit Cost	Depr	Value
FPR1	FIREPLACE - RESIDENTIAL 1 STORY	0		1	1	5,095.98		5,096
PRCH	SLAB PORCH - COVERED	65456		80	80	24.02		1,922
PATO	SLAB PORCH - OPEN	65457		118	118	10.70		1,263



Rogers

Assessment Property Record Card for Tax Year 2026

Data provided by LISA DELOZIER County Assessor

Date 04/17/2026
 Time 17:59:16
 Page 3

Sketch Image

660027193

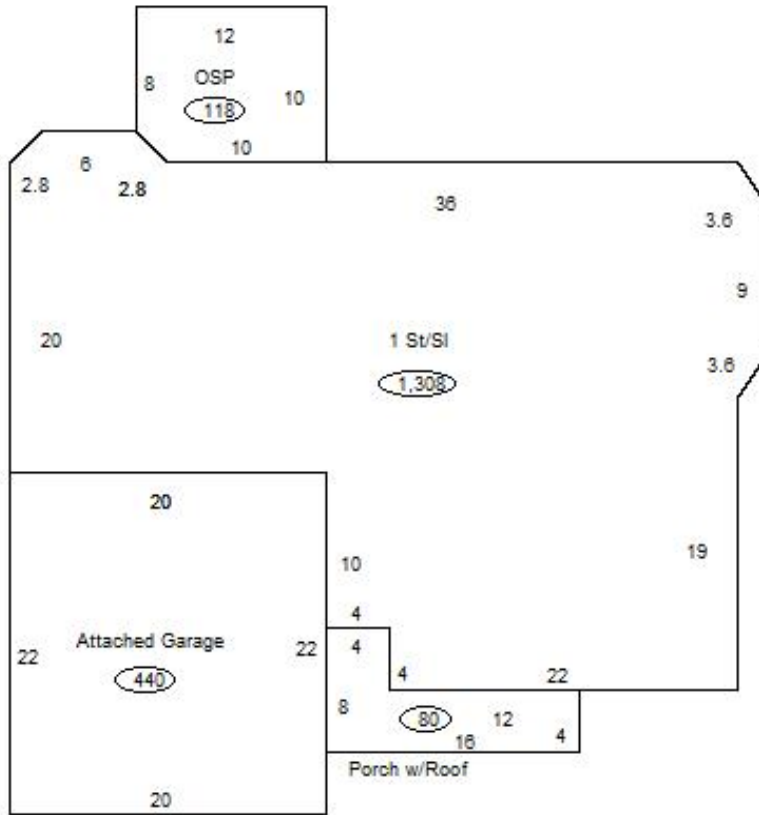

Sketch Vector Information

Sequence	Code	Type	Built Over	Scale	Section Label	Base Area	Multiplier	Total Area
1	R	1	Slab	13	1 St/Sl	1,308	1.000	1,308
2	G	1		13	Attached Garage	440	1.000	440
3	M	PRCH		13	SLBC	80	1.000	80
4	M	PATO		13	Open Slab	118	1.000	118
Total Building Area						1,308		1,308



Rogers



Assessment Property Record Card for Tax Year 2026

Data provided by LISA DELOZIER County Assessor

Date 04/17/2026
Time 17:59:17
Page 4

660027193

Outbuildings/Site Improvements

Building Image	Code	Description	Dimensions	Floor	Roofing	Total Units
	UTIL	SHOP BUILDING	0x0x0			900
	Qual 2	Cond 3	Year 2007	Eff Age	14	
	Valuation Summary		Modifier Total	RCN	Depr (31% Phys/ % Func)	RCNLD
	Base Cost (31.28 x 900)	28,152		28,152	8,727	19,425
	LT	LEAN-TO	12x30x0			360
	Qual 3	Cond 3	Year	Eff Age		
	Valuation Summary		Modifier Total	RCN	Depr (30% Phys/ % Func)	RCNLD
	Base Cost (2.92 x 360)	1,051		1,051	315	736