



# Rogers

## Assessment Property Record Card for Tax Year 2026

Data provided by LISA DELOZIER County Assessor

Date 04/16/2026  
Time 21:13:46  
Page 1

Assessment Data					Primary Image																																																																																																																				
<b>Account</b> 660027217 <b>Parcel ID</b> 000000-00-0-00831-003-0001 <b>Cadastral ID</b> 31-22-15-03000 <b>Property Type</b> REAL - Real Property <b>Property Class</b> RRP VI Area 4 <b>Tax Area</b> 28 - COLLINSVILLE/LIME FIRE <b>Name ID</b> 271296 GRAHAM, KIMBERLY MARANN  5000 E CHESTNUT DR CLAREMORE OK 74019-0000  <b>Parcel Location</b> <b>Situs</b> 05000 E CHESTNUT DR <b>Subdivision</b> TRAILS END ESTATES <b>Lot/Block</b> 0001 / 0003 Parcel Size 1 - Lots <b>Sec/Twn/Rng</b> 31 / 22 / 15 / 5 <b>Neighborhood</b> 1132 - R-V04-NW COLLINSVILLE <b>School District</b> S026 - COLLINSVILLE SCHOOLS																																																																																																																									
<b>Legal Description</b> Lot/Long: 36.34370780 -95.74057492																																																																																																																									
<b>Legal Description</b> LOT 1 BLOCK 3 TRAILS END ESTATES					<b>Building Permits</b> <table border="1"> <thead> <tr> <th>Number</th> <th>Description</th> <th>Opened</th> <th>Closed</th> <th>Amount</th> </tr> </thead> <tbody> <tr> <td> </td> <td> </td> <td> </td> <td> </td> <td> </td> </tr> </tbody> </table>					Number	Description	Opened	Closed	Amount																																																																																																											
Number	Description	Opened	Closed	Amount																																																																																																																					
<b>Exemptions</b> <table border="1"> <thead> <tr> <th>Code</th> <th>Type</th> <th>Active</th> <th>Maximum</th> <th>Exemption</th> </tr> </thead> <tbody> <tr> <td>H</td> <td>Homestead</td> <td>Yes</td> <td>1,000</td> <td>1,000</td> </tr> </tbody> </table>					Code	Type	Active	Maximum	Exemption	H	Homestead	Yes	1,000	1,000	<b>Sale History</b> <table border="1"> <thead> <tr> <th>Bk/Pg</th> <th>Grantor</th> <th>Date</th> <th>Price</th> <th>Code</th> </tr> </thead> <tbody> <tr> <td>1173/245</td> <td>BOYS OF OKLAHOMA~CONSTRUCTIC</td> <td>05/21/1999</td> <td>90,500</td> <td>Yes</td> </tr> <tr> <td>1144/619</td> <td>SOKOLOSKY, D M &amp;</td> <td>09/25/1998</td> <td>19,500</td> <td>Yes</td> </tr> </tbody> </table>					Bk/Pg	Grantor	Date	Price	Code	1173/245	BOYS OF OKLAHOMA~CONSTRUCTIC	05/21/1999	90,500	Yes	1144/619	SOKOLOSKY, D M &	09/25/1998	19,500	Yes																																																																																							
Code	Type	Active	Maximum	Exemption																																																																																																																					
H	Homestead	Yes	1,000	1,000																																																																																																																					
Bk/Pg	Grantor	Date	Price	Code																																																																																																																					
1173/245	BOYS OF OKLAHOMA~CONSTRUCTIC	05/21/1999	90,500	Yes																																																																																																																					
1144/619	SOKOLOSKY, D M &	09/25/1998	19,500	Yes																																																																																																																					
<b>Parcel Valuation</b> <table border="1"> <thead> <tr> <th>Source</th> <th>REAL</th> <th>Fair Cash</th> <th>Capped</th> <th>Asmnt Level</th> <th>Assessed</th> <th>Levy Rate</th> <th>112.698</th> <th>Current Tax</th> </tr> </thead> <tbody> <tr> <td>Remove Cap</td> <td>2000</td> <td>Land Value 64,741</td> <td>34,859</td> <td>11%</td> <td>3,834</td> <td>Assessed</td> <td>17,774</td> <td>2,003.09</td> </tr> <tr> <td>Year Frozen</td> <td>0</td> <td>Improvements 139,575</td> <td>126,729</td> <td></td> <td>13,940</td> <td>Penalty</td> <td>0</td> <td></td> </tr> <tr> <td>Uncapped Value</td> <td>0</td> <td>Mobile Home 0</td> <td>0</td> <td></td> <td>0</td> <td>Exemption</td> <td>1,000</td> <td>-102.00</td> </tr> <tr> <td>TIF Project ID</td> <td>0</td> <td>Total Value 204,316</td> <td>161,588</td> <td></td> <td>17,774</td> <td>Total Taxable</td> <td>16,774</td> <td>1,901.00</td> </tr> </tbody> </table>										Source	REAL	Fair Cash	Capped	Asmnt Level	Assessed	Levy Rate	112.698	Current Tax	Remove Cap	2000	Land Value 64,741	34,859	11%	3,834	Assessed	17,774	2,003.09	Year Frozen	0	Improvements 139,575	126,729		13,940	Penalty	0		Uncapped Value	0	Mobile Home 0	0		0	Exemption	1,000	-102.00	TIF Project ID	0	Total Value 204,316	161,588		17,774	Total Taxable	16,774	1,901.00																																																																			
Source	REAL	Fair Cash	Capped	Asmnt Level	Assessed	Levy Rate	112.698	Current Tax																																																																																																																	
Remove Cap	2000	Land Value 64,741	34,859	11%	3,834	Assessed	17,774	2,003.09																																																																																																																	
Year Frozen	0	Improvements 139,575	126,729		13,940	Penalty	0																																																																																																																		
Uncapped Value	0	Mobile Home 0	0		0	Exemption	1,000	-102.00																																																																																																																	
TIF Project ID	0	Total Value 204,316	161,588		17,774	Total Taxable	16,774	1,901.00																																																																																																																	
<b>Assessment History</b> <table border="1"> <thead> <tr> <th>Tax Year</th> <th>Statement Number</th> <th>Billed Owner</th> <th>Tax Area</th> <th>Total Value</th> <th>Exemptions</th> <th>Taxable Value</th> <th>Billed Tax</th> </tr> </thead> <tbody> <tr><td>2025</td><td>2025-660027217</td><td>GRAHAM, KIMBERLY MARANN</td><td>28</td><td>199,060</td><td>1000</td><td>16,257</td><td>1,843.00</td></tr> <tr><td>2024</td><td>2024-660027217</td><td>GRAHAM, KIMBERLY MARANN</td><td>28</td><td>222,385</td><td>1000</td><td>15,754</td><td>1,818.00</td></tr> <tr><td>2023</td><td>2023-660027217</td><td>GRAHAM, KIMBERLY MARANN</td><td>28</td><td>152,168</td><td>1000</td><td>15,266</td><td>1,733.00</td></tr> <tr><td>2022</td><td>2022-660027217</td><td>GRAHAM, KIMBERLY MARANN</td><td>28</td><td>150,680</td><td>1000</td><td>14,793</td><td>1,671.00</td></tr> <tr><td>2021</td><td>2021-660027217</td><td>GRAHAM, KIMBERLY MARANN</td><td>28</td><td>139,389</td><td>1000</td><td>14,333</td><td>1,641.00</td></tr> <tr><td>2020</td><td>2020-660027217</td><td>GRAHAM, ROBERT MICHAEL &amp;</td><td>28</td><td>137,322</td><td>1000</td><td>13,987</td><td>1,605.00</td></tr> <tr><td>2019</td><td>2019-660027217</td><td>GRAHAM, ROBERT MICHAEL &amp;</td><td>28</td><td>132,353</td><td>1000</td><td>13,550</td><td>1,541.00</td></tr> <tr><td>2018</td><td>2018-660027217</td><td>GRAHAM, ROBERT MICHAEL &amp;</td><td>28</td><td>146,020</td><td>1000</td><td>13,126</td><td>1,507.00</td></tr> <tr><td>2017</td><td>2017-660027217</td><td>GRAHAM, ROBERT MICHAEL &amp;</td><td>28</td><td>144,896</td><td>1000</td><td>12,715</td><td>1,440.00</td></tr> <tr><td>2016</td><td>2016-660027217</td><td>GRAHAM, ROBERT MICHAEL &amp;</td><td>28</td><td>141,448</td><td>1000</td><td>12,316</td><td>1,365.00</td></tr> <tr><td>2015</td><td>2015-660027217</td><td>GRAHAM, ROBERT MICHAEL &amp;</td><td>28</td><td>137,831</td><td>1000</td><td>11,928</td><td>1,337.00</td></tr> <tr><td>2014</td><td>2014-660027217</td><td>GRAHAM, ROBERT MICHAEL &amp;</td><td>28</td><td>138,826</td><td>1000</td><td>11,551</td><td>1,261.00</td></tr> <tr><td>2013</td><td>2013-660027217</td><td>GRAHAM, ROBERT MICHAEL &amp;</td><td>28</td><td>131,185</td><td>1000</td><td>11,186</td><td>1,219.00</td></tr> </tbody> </table>										Tax Year	Statement Number	Billed Owner	Tax Area	Total Value	Exemptions	Taxable Value	Billed Tax	2025	2025-660027217	GRAHAM, KIMBERLY MARANN	28	199,060	1000	16,257	1,843.00	2024	2024-660027217	GRAHAM, KIMBERLY MARANN	28	222,385	1000	15,754	1,818.00	2023	2023-660027217	GRAHAM, KIMBERLY MARANN	28	152,168	1000	15,266	1,733.00	2022	2022-660027217	GRAHAM, KIMBERLY MARANN	28	150,680	1000	14,793	1,671.00	2021	2021-660027217	GRAHAM, KIMBERLY MARANN	28	139,389	1000	14,333	1,641.00	2020	2020-660027217	GRAHAM, ROBERT MICHAEL &	28	137,322	1000	13,987	1,605.00	2019	2019-660027217	GRAHAM, ROBERT MICHAEL &	28	132,353	1000	13,550	1,541.00	2018	2018-660027217	GRAHAM, ROBERT MICHAEL &	28	146,020	1000	13,126	1,507.00	2017	2017-660027217	GRAHAM, ROBERT MICHAEL &	28	144,896	1000	12,715	1,440.00	2016	2016-660027217	GRAHAM, ROBERT MICHAEL &	28	141,448	1000	12,316	1,365.00	2015	2015-660027217	GRAHAM, ROBERT MICHAEL &	28	137,831	1000	11,928	1,337.00	2014	2014-660027217	GRAHAM, ROBERT MICHAEL &	28	138,826	1000	11,551	1,261.00	2013	2013-660027217	GRAHAM, ROBERT MICHAEL &	28	131,185	1000	11,186	1,219.00
Tax Year	Statement Number	Billed Owner	Tax Area	Total Value	Exemptions	Taxable Value	Billed Tax																																																																																																																		
2025	2025-660027217	GRAHAM, KIMBERLY MARANN	28	199,060	1000	16,257	1,843.00																																																																																																																		
2024	2024-660027217	GRAHAM, KIMBERLY MARANN	28	222,385	1000	15,754	1,818.00																																																																																																																		
2023	2023-660027217	GRAHAM, KIMBERLY MARANN	28	152,168	1000	15,266	1,733.00																																																																																																																		
2022	2022-660027217	GRAHAM, KIMBERLY MARANN	28	150,680	1000	14,793	1,671.00																																																																																																																		
2021	2021-660027217	GRAHAM, KIMBERLY MARANN	28	139,389	1000	14,333	1,641.00																																																																																																																		
2020	2020-660027217	GRAHAM, ROBERT MICHAEL &	28	137,322	1000	13,987	1,605.00																																																																																																																		
2019	2019-660027217	GRAHAM, ROBERT MICHAEL &	28	132,353	1000	13,550	1,541.00																																																																																																																		
2018	2018-660027217	GRAHAM, ROBERT MICHAEL &	28	146,020	1000	13,126	1,507.00																																																																																																																		
2017	2017-660027217	GRAHAM, ROBERT MICHAEL &	28	144,896	1000	12,715	1,440.00																																																																																																																		
2016	2016-660027217	GRAHAM, ROBERT MICHAEL &	28	141,448	1000	12,316	1,365.00																																																																																																																		
2015	2015-660027217	GRAHAM, ROBERT MICHAEL &	28	137,831	1000	11,928	1,337.00																																																																																																																		
2014	2014-660027217	GRAHAM, ROBERT MICHAEL &	28	138,826	1000	11,551	1,261.00																																																																																																																		
2013	2013-660027217	GRAHAM, ROBERT MICHAEL &	28	131,185	1000	11,186	1,219.00																																																																																																																		



# Rogers

## Assessment Property Record Card for Tax Year 2026

Data provided by LISA DELOZIER County Assessor

Date 04/16/2026  
Time 21:13:46  
Page 2

Lot Data	Square-Foot - NBHD 1132 #1	Primary Image
Lot Size		
Lot Count		
Units Buildable	1	
Non-Ag Acres	1.3635	
Topography		
Street Access		
Utilities		
Amenities	0	
	0	
Method	Square-Foot	
Base Lot Value	59,392.00 x 1.09 = 64,741	
Factor Value		
Adjustments	1.0000	
Lot Value	64,741	

Residential Data	
Type	1 Single Family Residence
Condition	3 - Average
Quality	2.5 - Fair
Architecture	
Style	100% One Story
Exterior Wall	70% Veneer, Masonry 30% Frame, Siding, Wood
Base/Total Area	1,290 / 1,290
Style	100% One Story
HVAC	100% Warmed & Cooled Air
Roof Cover	1 Composition Shingle
Area on Slab	1,290
Fixture/RghIn	11 /
Bed/F/H Bath	3 / 2.0 /
Basement Area	
Garage Type	420 Attached Garage - Unfinished
Remodel	
Year/Eff Age	1999 / 20

\\tsclient\T\TOMMY DUNLAP\062922 (77)\IMG\_0025.JPG 6/29/2022

GRM Approach	
GRM Code	
Gross Rent	0.00
Indicated Value	

Multiple Regression			
MRA Code	1	Test	
Adusted R	0.8445		
Indicated Value	163,829	127.00	Per SqFt

Direct Comparables			
Selection Model	A	Adam Test	
Adjustment Model	1	2022 Residential	
Comparables	1		
Indicated Value	45,560		Per SqFt

Cost Approach				Manual : 01/2025	
Base Cost	107.71	Total Misc Impr	+	1,720	
Roofing Adj	+ 4.66	Garage Cost	+	12,100	
Subfloor Adj	+ -1.21	Total RCN	=	186,100	
Heat/Cool Adj	+ 11.47	Depreciation ( 25%)	-	46,525	
Plumbing Adj	+ 10.92	Lump Sums	+	0	
Basement Adj	+ 0.00	RCNLD	=	139,575	
Adj Base Cost	= 133.55	Lot Value	+	64,741	
Total Area	x 1,290	Indicated Value	=	204,316	
Adjusted Cost	= 172,280	Value Per SqFt		158.38	

Value Reconciliation			
Selected Approach	Cost Approach		
Improvements	139,575		
Lot Value	64,741		
Indicated Value	204,316	158.38	Per SqFt
Agland Value			
Site Improvements			
Total Value	204,316	158.38	Total Value Per SqFt

Miscellaneous Improvements								
Code	Description	Sketch ID	Size	Year	Units	Unit Cost	Depr	Value
PRCH	SLAB PORCH - COVERED	65565		23	23	24.19		556
PATO	SLAB PORCH - OPEN	65566		108	108	10.78		1,164
SHLT	STORM SHELTER			4x6	24	0.00		



# Rogers

## Assessment Property Record Card for Tax Year 2026

Data provided by LISA DELOZIER County Assessor

Date 04/16/2026  
 Time 21:13:46  
 Page 3

Sketch Image

660027217

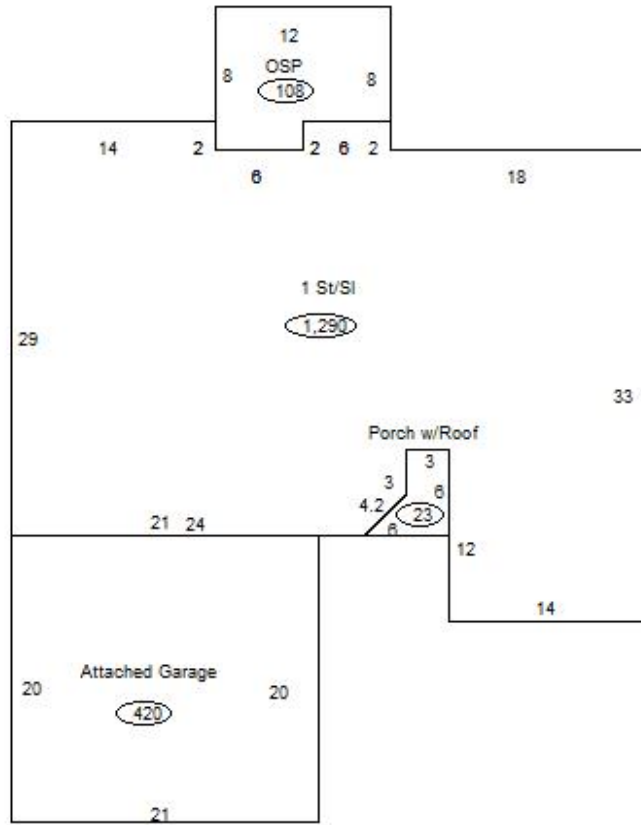

### Sketch Vector Information

Sequence	Code	Type	Built Over	Scale	Section Label	Base Area	Multiplier	Total Area
1	R	1	Slab	13	1 St/Sl	1,290	1.000	1,290
2	G	1		13	Attached Garage	420	1.000	420
3	M	PRCH		13	SLBC	23	1.000	23
4	M	PATO		13	Open Slab	108	1.000	108
<b>Total Building Area</b>						1,290		1,290