



Rogers

Assessment Property Record Card for Tax Year 2026

Data provided by LISA DELOZIER County Assessor

Date 04/16/2026
Time 21:51:09
Page 1

Assessment Data					Primary Image																																																																																																																				
Account 660027284 Parcel ID 000000-00-0-00831-009-0001 Cadastral ID 31-22-15-03660 Property Type REAL - Real Property Property Class RRP VI Area 4 Tax Area 28 - COLLINSVILLE/LIME FIRE Name ID 193374 BETTEGA, GARY W & CONNIE TRUSTEES BETTEGA FAMILY TRUST 4855 E ELM RD CLAREMORE OK 74019-0000																																																																																																																									
Parcel Location Situs 04855 E ELM RD Subdivision TRAILS END ESTATES Lot/Block 0001 / 0009 Parcel Size 1 - Lots Sec/Twn/Rng 31 / 22 / 15 / 5 Neighborhood 1132 - R-V04-NW COLLINSVILLE School District S026 - COLLINSVILLE SCHOOLS																																																																																																																									
Legal Description Lat/Long: 36.34072825 -95.74494143					Building Permits <table border="1"> <thead> <tr> <th>Number</th> <th>Description</th> <th>Opened</th> <th>Closed</th> <th>Amount</th> </tr> </thead> <tbody> <tr> <td>R23 154</td> <td>R24 NEW RMA 453 SQ FT</td> <td>06/2023</td> <td>10/2023</td> <td>26,170</td> </tr> </tbody> </table>					Number	Description	Opened	Closed	Amount	R23 154	R24 NEW RMA 453 SQ FT	06/2023	10/2023	26,170																																																																																																						
Number	Description	Opened	Closed	Amount																																																																																																																					
R23 154	R24 NEW RMA 453 SQ FT	06/2023	10/2023	26,170																																																																																																																					
Exemptions <table border="1"> <thead> <tr> <th>Code</th> <th>Type</th> <th>Active</th> <th>Maximum</th> <th>Exemption</th> </tr> </thead> <tbody> <tr> <td>H</td> <td>Homestead</td> <td>Yes</td> <td>1,000</td> <td>1,000</td> </tr> </tbody> </table>					Code	Type	Active	Maximum	Exemption	H	Homestead	Yes	1,000	1,000	Sale History <table border="1"> <thead> <tr> <th>Bk/Pg</th> <th>Grantor</th> <th>Date</th> <th>Price</th> <th>Code</th> </tr> </thead> <tbody> </tbody> </table>					Bk/Pg	Grantor	Date	Price	Code																																																																																																	
Code	Type	Active	Maximum	Exemption																																																																																																																					
H	Homestead	Yes	1,000	1,000																																																																																																																					
Bk/Pg	Grantor	Date	Price	Code																																																																																																																					
Parcel Valuation <table border="1"> <thead> <tr> <th>Source</th> <th>REAL</th> <th>Fair Cash</th> <th>Capped</th> <th>Asmnt Level</th> <th>Assessed</th> <th>Levy Rate</th> <th>112.698</th> <th>Current Tax</th> </tr> </thead> <tbody> <tr> <td>Remove Cap</td> <td>0</td> <td>Land Value 62,291</td> <td>30,285</td> <td>11%</td> <td>3,331</td> <td>Assessed</td> <td>15,256</td> <td>1,719.32</td> </tr> <tr> <td>Year Frozen</td> <td>0</td> <td>Improvements 149,991</td> <td>108,415</td> <td></td> <td>11,925</td> <td>Penalty</td> <td>0</td> <td></td> </tr> <tr> <td>Uncapped Value</td> <td>0</td> <td>Mobile Home 0</td> <td>0</td> <td></td> <td>0</td> <td>Exemption</td> <td>1,000</td> <td>-101.00</td> </tr> <tr> <td>TIF Project ID</td> <td>0</td> <td>Total Value 212,282</td> <td>138,700</td> <td></td> <td>15,256</td> <td>Total Taxable</td> <td>14,256</td> <td>1,618.00</td> </tr> </tbody> </table>										Source	REAL	Fair Cash	Capped	Asmnt Level	Assessed	Levy Rate	112.698	Current Tax	Remove Cap	0	Land Value 62,291	30,285	11%	3,331	Assessed	15,256	1,719.32	Year Frozen	0	Improvements 149,991	108,415		11,925	Penalty	0		Uncapped Value	0	Mobile Home 0	0		0	Exemption	1,000	-101.00	TIF Project ID	0	Total Value 212,282	138,700		15,256	Total Taxable	14,256	1,618.00																																																																			
Source	REAL	Fair Cash	Capped	Asmnt Level	Assessed	Levy Rate	112.698	Current Tax																																																																																																																	
Remove Cap	0	Land Value 62,291	30,285	11%	3,331	Assessed	15,256	1,719.32																																																																																																																	
Year Frozen	0	Improvements 149,991	108,415		11,925	Penalty	0																																																																																																																		
Uncapped Value	0	Mobile Home 0	0		0	Exemption	1,000	-101.00																																																																																																																	
TIF Project ID	0	Total Value 212,282	138,700		15,256	Total Taxable	14,256	1,618.00																																																																																																																	
Assessment History <table border="1"> <thead> <tr> <th>Tax Year</th> <th>Statement Number</th> <th>Billed Owner</th> <th>Tax Area</th> <th>Total Value</th> <th>Exemptions</th> <th>Taxable Value</th> <th>Billed Tax</th> </tr> </thead> <tbody> <tr><td>2025</td><td>2025-660027284</td><td>BETTEGA, GARY W & CONNIE</td><td>28</td><td>206,495</td><td>1000</td><td>13,812</td><td>1,567.00</td></tr> <tr><td>2024</td><td>2024-660027284</td><td>BETTEGA, GARY W & CONNIE</td><td>28</td><td>228,191</td><td>1000</td><td>13,381</td><td>1,546.00</td></tr> <tr><td>2023</td><td>2023-660027284</td><td>BETTEGA, GARY W & CONNIE</td><td>28</td><td>164,811</td><td>1000</td><td>12,963</td><td>1,474.00</td></tr> <tr><td>2022</td><td>2022-660027284</td><td>BETTEGA, GARY W & CONNIE</td><td>28</td><td>160,272</td><td>1000</td><td>12,556</td><td>1,421.00</td></tr> <tr><td>2021</td><td>2021-660027284</td><td>BETTEGA, GARY W & CONNIE</td><td>28</td><td>159,292</td><td>1000</td><td>12,161</td><td>1,394.00</td></tr> <tr><td>2020</td><td>2020-660027284</td><td>BETTEGA, GARY W & CONNIE</td><td>28</td><td>151,986</td><td>1000</td><td>11,778</td><td>1,353.00</td></tr> <tr><td>2019</td><td>2019-660027284</td><td>BETTEGA, GARY W</td><td>28</td><td>145,015</td><td>1000</td><td>11,406</td><td>1,299.00</td></tr> <tr><td>2018</td><td>2018-660027284</td><td>BETTEGA, GARY W</td><td>28</td><td>150,407</td><td>1000</td><td>11,045</td><td>1,270.00</td></tr> <tr><td>2017</td><td>2017-660027284</td><td>BETTEGA, GARY W</td><td>28</td><td>149,239</td><td>1000</td><td>10,694</td><td>1,213.00</td></tr> <tr><td>2016</td><td>2016-660027284</td><td>BETTEGA, GARY W</td><td>28</td><td>145,649</td><td>1000</td><td>10,353</td><td>1,150.00</td></tr> <tr><td>2015</td><td>2015-660027284</td><td>BETTEGA, GARY W</td><td>28</td><td>138,853</td><td>1000</td><td>10,022</td><td>1,125.00</td></tr> <tr><td>2014</td><td>2014-660027284</td><td>BETTEGA, GARY W</td><td>28</td><td>142,664</td><td>1000</td><td>9,702</td><td>1,061.00</td></tr> <tr><td>2013</td><td>2013-660027284</td><td>BETTEGA, GARY W</td><td>28</td><td>134,863</td><td>1000</td><td>9,390</td><td>1,025.00</td></tr> </tbody> </table>										Tax Year	Statement Number	Billed Owner	Tax Area	Total Value	Exemptions	Taxable Value	Billed Tax	2025	2025-660027284	BETTEGA, GARY W & CONNIE	28	206,495	1000	13,812	1,567.00	2024	2024-660027284	BETTEGA, GARY W & CONNIE	28	228,191	1000	13,381	1,546.00	2023	2023-660027284	BETTEGA, GARY W & CONNIE	28	164,811	1000	12,963	1,474.00	2022	2022-660027284	BETTEGA, GARY W & CONNIE	28	160,272	1000	12,556	1,421.00	2021	2021-660027284	BETTEGA, GARY W & CONNIE	28	159,292	1000	12,161	1,394.00	2020	2020-660027284	BETTEGA, GARY W & CONNIE	28	151,986	1000	11,778	1,353.00	2019	2019-660027284	BETTEGA, GARY W	28	145,015	1000	11,406	1,299.00	2018	2018-660027284	BETTEGA, GARY W	28	150,407	1000	11,045	1,270.00	2017	2017-660027284	BETTEGA, GARY W	28	149,239	1000	10,694	1,213.00	2016	2016-660027284	BETTEGA, GARY W	28	145,649	1000	10,353	1,150.00	2015	2015-660027284	BETTEGA, GARY W	28	138,853	1000	10,022	1,125.00	2014	2014-660027284	BETTEGA, GARY W	28	142,664	1000	9,702	1,061.00	2013	2013-660027284	BETTEGA, GARY W	28	134,863	1000	9,390	1,025.00
Tax Year	Statement Number	Billed Owner	Tax Area	Total Value	Exemptions	Taxable Value	Billed Tax																																																																																																																		
2025	2025-660027284	BETTEGA, GARY W & CONNIE	28	206,495	1000	13,812	1,567.00																																																																																																																		
2024	2024-660027284	BETTEGA, GARY W & CONNIE	28	228,191	1000	13,381	1,546.00																																																																																																																		
2023	2023-660027284	BETTEGA, GARY W & CONNIE	28	164,811	1000	12,963	1,474.00																																																																																																																		
2022	2022-660027284	BETTEGA, GARY W & CONNIE	28	160,272	1000	12,556	1,421.00																																																																																																																		
2021	2021-660027284	BETTEGA, GARY W & CONNIE	28	159,292	1000	12,161	1,394.00																																																																																																																		
2020	2020-660027284	BETTEGA, GARY W & CONNIE	28	151,986	1000	11,778	1,353.00																																																																																																																		
2019	2019-660027284	BETTEGA, GARY W	28	145,015	1000	11,406	1,299.00																																																																																																																		
2018	2018-660027284	BETTEGA, GARY W	28	150,407	1000	11,045	1,270.00																																																																																																																		
2017	2017-660027284	BETTEGA, GARY W	28	149,239	1000	10,694	1,213.00																																																																																																																		
2016	2016-660027284	BETTEGA, GARY W	28	145,649	1000	10,353	1,150.00																																																																																																																		
2015	2015-660027284	BETTEGA, GARY W	28	138,853	1000	10,022	1,125.00																																																																																																																		
2014	2014-660027284	BETTEGA, GARY W	28	142,664	1000	9,702	1,061.00																																																																																																																		
2013	2013-660027284	BETTEGA, GARY W	28	134,863	1000	9,390	1,025.00																																																																																																																		



Rogers

Assessment Property Record Card for Tax Year 2026

Data provided by LISA DELOZIER County Assessor

Date 04/16/2026
 Time 21:51:09
 Page 2

Lot Data		Square-Foot - NBHD 1132 #1	
Lot Size			
Lot Count			
Units Buildable	54534		
Non-Ag Acres	1.2769		
Topography			
Street Access			
Utilities			
Amenities		0	
		0	
Method	Square-Foot		
Base Lot Value	55,623.00 x 1.12 = 62,291		
Factor Value			
Adjustments	1.0000		
Lot Value	62,291		



\\tsclient\T\TOMMY DUNLAP\New folder (77)\IMG_0017.JPG 7/7/2022

Residential Data	
Type	1 Single Family Residence
Condition	3 - Average
Quality	2.5 - Fair
Architecture	
Style	100% One Story
Exterior Wall	80% Frame, Siding, Wood 20% Veneer, Masonry
Base/Total Area	1,730 / 1,730
Style	100% One Story
HVAC	100% Warmed & Cooled Air
Roof Cover	1 Composition Shingle
Area on Slab	1,730
Fixture/RghIn	11 /
Bed/F/H Bath	3 / 2.0 /
Basement Area	
Garage Type	420 Attached Garage - Unfinished
Remodel	
Year/Eff Age	1984 / 32

GRM Approach

GRM Code	
Gross Rent	0.00
Indicated Value	

Multiple Regression

MRA Code	1 Test
Adusted R	0.8445
Indicated Value	185,538 107.25 Per SqFt

Direct Comparables

Selection Model	A Adam Test
Adjustment Model	1 2022 Residential
Comparables	
Indicated Value	

Value Reconciliation

Selected Approach	Cost Approach
Improvements	138,731
Lot Value	62,291
Indicated Value	201,022 116.20 Per SqFt
Agland Value	
Site Improvements	11,260
Total Value	212,282 122.71 Total Value Per SqFt

Cost Approach		Manual : 01/2025	
Base Cost	97.01	Total Misc Impr	+ 8,288
Roofing Adj	+ 4.39	Garage Cost	+ 12,100
Subfloor Adj	+ -1.15	Total RCN	= 227,746
Heat/Cool Adj	+ 11.47	Depreciation (42%)	- 95,653
Plumbing Adj	+ 8.14	Lump Sums	+ 6,638
Basement Adj	+ 0.00	RCNLD	= 138,731
Adj Base Cost	= 119.86	Lot Value	+ 62,291
Total Area	x 1,730	Indicated Value	= 201,022
Adjusted Cost	= 207,358	Value Per SqFt	116.20

Miscellaneous Improvements

Code	Description	Sketch ID	Size	Year	Units	Unit Cost	Depr	Value
FPR1	FIREPLACE - RESIDENTIAL 1 STORY	0		1	1	5,095.98		5,096
PRCH	SLAB PORCH - COVERED	65847		134	134	23.82		3,192
WODO	WOOD DECK - OPEN	65848		440	440	16.05	6%	6,638



Rogers
Assessment Property Record Card for Tax Year 2026

Data provided by LISA DELOZIER County Assessor

Date 04/16/2026
 Time 21:51:09
 Page 3

Sketch Image

660027284

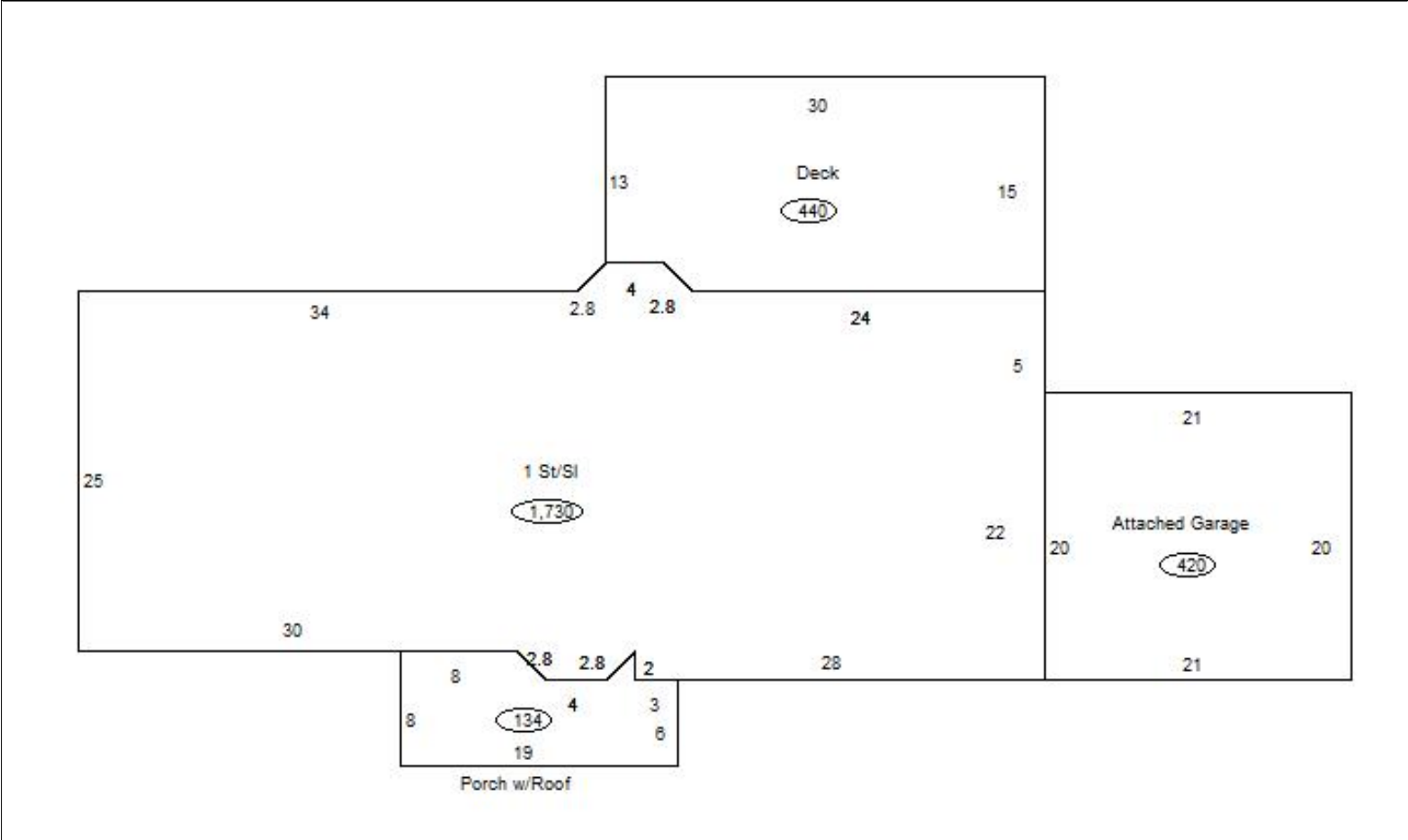

Sketch Vector Information

Sequence	Code	Type	Built Over	Scale	Section Label	Base Area	Multiplier	Total Area
1	R	1	Slab	13	1 St/Sl	1,730	1.000	1,730
2	G	1		13	Attached Garage	420	1.000	420
3	M	PRCH		13	SLBC	134	1.000	134
4	M	WODO		13	WODO	440	1.000	440
Total Building Area						1,730		1,730



Rogers

Assessment Property Record Card for Tax Year 2026

Data provided by LISA DELOZIER County Assessor

Date 04/16/2026
Time 21:51:09
Page 4

660027284

Outbuildings/Site Improvements

Building Image	Code	Description	Dimensions	Floor	Roofing	Total Units
	UTIL	SHOP BUILDING	0x0x0			480
	Qual 2	Cond 3	Year	Eff Age		
Valuation Summary		Modifier Total	RCN	Depr (25% Phys/ % Func)		RCNLD
Base Cost (31.28 x 480)		15,014	15,014	3,754		11,260