



Rogers

Assessment Property Record Card for Tax Year 2026

Data provided by LISA DELOZIER County Assessor

Date 04/16/2026
Time 21:14:48
Page 1

Assessment Data					Primary Image																																																																																																																				
Account 660027345 Parcel ID 000000-00-0-00831-012-0008 Cadastral ID 31-22-15-04270 Property Type REAL - Real Property Property Class RRP VI Area 4 Tax Area 28 - COLLINSVILLE/LIME FIRE Name ID 309138 ALLEN, ROY & SHERI 18125 S ELM RD CLAREMORE OK 74019-0000 Parcel Location Situs 18125 E ELM RD Subdivision TRAILS END ESTATES Lot/Block 0008 / 0012 Parcel Size 1 - Lots Sec/Twn/Rng 31 / 22 / 15 / 5 Neighborhood 1132 - R-V04-NW COLLINSVILLE School District S026 - COLLINSVILLE SCHOOLS					<p>C:\Users\RLN\Pictures\2018-04-09 04-09-18\04-09-18 081.JPG 4/10/2018</p>																																																																																																																				
Legal Description Lot/Long: 36.34785512 -95.74665578 LOT 8 BLOCK 12 TRAILS END ESTATES																																																																																																																									
Exemptions <table border="1"> <thead> <tr> <th>Code</th> <th>Type</th> <th>Active</th> <th>Maximum</th> <th>Exemption</th> </tr> </thead> <tbody> <tr> <td>H</td> <td>Homestead</td> <td>Yes</td> <td>1,000</td> <td>1,000</td> </tr> <tr> <td>H</td> <td>Homestead</td> <td>No</td> <td>1,000</td> <td></td> </tr> </tbody> </table>					Code	Type	Active	Maximum	Exemption	H	Homestead	Yes	1,000	1,000	H	Homestead	No	1,000		Building Permits <table border="1"> <thead> <tr> <th>Number</th> <th>Description</th> <th>Opened</th> <th>Closed</th> <th>Amount</th> </tr> </thead> <tbody> <tr> <td></td> <td></td> <td></td> <td></td> <td></td> </tr> </tbody> </table>					Number	Description	Opened	Closed	Amount																																																																																												
Code	Type	Active	Maximum	Exemption																																																																																																																					
H	Homestead	Yes	1,000	1,000																																																																																																																					
H	Homestead	No	1,000																																																																																																																						
Number	Description	Opened	Closed	Amount																																																																																																																					
Parcel Valuation <table border="1"> <thead> <tr> <th>Source</th> <th>REAL</th> <th>Fair Cash</th> <th>Capped</th> <th>Asmnt Level</th> <th>Assessed</th> <th>Levy Rate</th> <th>112.698</th> <th>Current Tax</th> </tr> </thead> <tbody> <tr> <td>Remove Cap</td> <td>2014</td> <td>Land Value</td> <td>55,465</td> <td>37,135</td> <td>11%</td> <td>4,085</td> <td>Assessed</td> <td>20,126 2,268.16</td> </tr> <tr> <td>Year Frozen</td> <td>0</td> <td>Improvements</td> <td>184,183</td> <td>145,823</td> <td></td> <td>16,041</td> <td>Penalty</td> <td>0</td> </tr> <tr> <td>Uncapped Value</td> <td>0</td> <td>Mobile Home</td> <td>0</td> <td>0</td> <td></td> <td>0</td> <td>Exemption</td> <td>1,000 -102.00</td> </tr> <tr> <td>TIF Project ID</td> <td>0</td> <td>Total Value</td> <td>239,648</td> <td>182,958</td> <td></td> <td>20,126</td> <td>Total Taxable</td> <td>19,126 2,166.00</td> </tr> </tbody> </table>					Source	REAL	Fair Cash	Capped	Asmnt Level	Assessed	Levy Rate	112.698	Current Tax	Remove Cap	2014	Land Value	55,465	37,135	11%	4,085	Assessed	20,126 2,268.16	Year Frozen	0	Improvements	184,183	145,823		16,041	Penalty	0	Uncapped Value	0	Mobile Home	0	0		0	Exemption	1,000 -102.00	TIF Project ID	0	Total Value	239,648	182,958		20,126	Total Taxable	19,126 2,166.00	Sale History <table border="1"> <thead> <tr> <th>Bk/Pg</th> <th>Grantor</th> <th>Date</th> <th>Price</th> <th>Code</th> </tr> </thead> <tbody> <tr> <td>2305/819</td> <td>DINELLI, DAVID</td> <td>02/13/2013</td> <td>140,000</td> <td>YES</td> </tr> <tr> <td>1870/59</td> <td>WARING, HERB L</td> <td>05/18/2007</td> <td>131,000</td> <td>YES</td> </tr> <tr> <td>1166/143</td> <td>BOYS OF OKLAHOMA CONSTR CO</td> <td>04/09/1999</td> <td>95,000</td> <td>Yes</td> </tr> <tr> <td>1139/923</td> <td>SOKOLOSKY, D M &</td> <td>10/30/1998</td> <td>13,500</td> <td>Yes</td> </tr> </tbody> </table>					Bk/Pg	Grantor	Date	Price	Code	2305/819	DINELLI, DAVID	02/13/2013	140,000	YES	1870/59	WARING, HERB L	05/18/2007	131,000	YES	1166/143	BOYS OF OKLAHOMA CONSTR CO	04/09/1999	95,000	Yes	1139/923	SOKOLOSKY, D M &	10/30/1998	13,500	Yes																																										
Source	REAL	Fair Cash	Capped	Asmnt Level	Assessed	Levy Rate	112.698	Current Tax																																																																																																																	
Remove Cap	2014	Land Value	55,465	37,135	11%	4,085	Assessed	20,126 2,268.16																																																																																																																	
Year Frozen	0	Improvements	184,183	145,823		16,041	Penalty	0																																																																																																																	
Uncapped Value	0	Mobile Home	0	0		0	Exemption	1,000 -102.00																																																																																																																	
TIF Project ID	0	Total Value	239,648	182,958		20,126	Total Taxable	19,126 2,166.00																																																																																																																	
Bk/Pg	Grantor	Date	Price	Code																																																																																																																					
2305/819	DINELLI, DAVID	02/13/2013	140,000	YES																																																																																																																					
1870/59	WARING, HERB L	05/18/2007	131,000	YES																																																																																																																					
1166/143	BOYS OF OKLAHOMA CONSTR CO	04/09/1999	95,000	Yes																																																																																																																					
1139/923	SOKOLOSKY, D M &	10/30/1998	13,500	Yes																																																																																																																					
Assessment History <table border="1"> <thead> <tr> <th>Tax Year</th> <th>Statement Number</th> <th>Billed Owner</th> <th>Tax Area</th> <th>Total Value</th> <th>Exemptions</th> <th>Taxable Value</th> <th>Billed Tax</th> </tr> </thead> <tbody> <tr><td>2025</td><td>2025-660027345</td><td>ALLEN, ROY & SHERI</td><td>28</td><td>225,942</td><td>1000</td><td>18,540</td><td>2,100.00</td></tr> <tr><td>2024</td><td>2024-660027345</td><td>ALLEN, ROY & SHERI</td><td>28</td><td>246,097</td><td>1000</td><td>17,970</td><td>2,072.00</td></tr> <tr><td>2023</td><td>2023-660027345</td><td>ALLEN, ROY & SHERI</td><td>28</td><td>187,356</td><td>1000</td><td>17,417</td><td>1,976.00</td></tr> <tr><td>2022</td><td>2022-660027345</td><td>ALLEN, ROY & SHERI</td><td>28</td><td>185,211</td><td>1000</td><td>16,881</td><td>1,904.00</td></tr> <tr><td>2021</td><td>2021-660027345</td><td>ALLEN, ROY & SHERI</td><td>28</td><td>164,521</td><td>1000</td><td>16,360</td><td>1,871.00</td></tr> <tr><td>2020</td><td>2020-660027345</td><td>ALLEN, ROY & SHERI</td><td>28</td><td>155,620</td><td>1000</td><td>15,855</td><td>1,818.00</td></tr> <tr><td>2019</td><td>2019-660027345</td><td>ALLEN, ROY & SHERI</td><td>28</td><td>148,766</td><td>1000</td><td>15,364</td><td>1,745.00</td></tr> <tr><td>2018</td><td>2018-660027345</td><td>ALLEN, ROY & SHERI</td><td>28</td><td>152,306</td><td>1000</td><td>15,754</td><td>1,805.00</td></tr> <tr><td>2017</td><td>2017-660027345</td><td>ALLEN, ROY & SHERI</td><td>28</td><td>151,158</td><td>1000</td><td>15,422</td><td>1,744.00</td></tr> <tr><td>2016</td><td>2016-660027345</td><td>ALLEN, ROY & SHERI</td><td>28</td><td>147,772</td><td>1000</td><td>14,943</td><td>1,654.00</td></tr> <tr><td>2015</td><td>2015-660027345</td><td>ALLEN, ROY & SHERI</td><td>28</td><td>140,720</td><td>1000</td><td>14,479</td><td>1,619.00</td></tr> <tr><td>2014</td><td>2014-660027345</td><td>ALLEN, ROY & SHERI</td><td>28</td><td>143,169</td><td>1000</td><td>14,749</td><td>1,606.00</td></tr> <tr><td>2013</td><td>2013-660027345</td><td>ALLEN, ROY & SHERI</td><td>28</td><td>135,657</td><td>1000</td><td>13,540</td><td>1,472.00</td></tr> </tbody> </table>										Tax Year	Statement Number	Billed Owner	Tax Area	Total Value	Exemptions	Taxable Value	Billed Tax	2025	2025-660027345	ALLEN, ROY & SHERI	28	225,942	1000	18,540	2,100.00	2024	2024-660027345	ALLEN, ROY & SHERI	28	246,097	1000	17,970	2,072.00	2023	2023-660027345	ALLEN, ROY & SHERI	28	187,356	1000	17,417	1,976.00	2022	2022-660027345	ALLEN, ROY & SHERI	28	185,211	1000	16,881	1,904.00	2021	2021-660027345	ALLEN, ROY & SHERI	28	164,521	1000	16,360	1,871.00	2020	2020-660027345	ALLEN, ROY & SHERI	28	155,620	1000	15,855	1,818.00	2019	2019-660027345	ALLEN, ROY & SHERI	28	148,766	1000	15,364	1,745.00	2018	2018-660027345	ALLEN, ROY & SHERI	28	152,306	1000	15,754	1,805.00	2017	2017-660027345	ALLEN, ROY & SHERI	28	151,158	1000	15,422	1,744.00	2016	2016-660027345	ALLEN, ROY & SHERI	28	147,772	1000	14,943	1,654.00	2015	2015-660027345	ALLEN, ROY & SHERI	28	140,720	1000	14,479	1,619.00	2014	2014-660027345	ALLEN, ROY & SHERI	28	143,169	1000	14,749	1,606.00	2013	2013-660027345	ALLEN, ROY & SHERI	28	135,657	1000	13,540	1,472.00
Tax Year	Statement Number	Billed Owner	Tax Area	Total Value	Exemptions	Taxable Value	Billed Tax																																																																																																																		
2025	2025-660027345	ALLEN, ROY & SHERI	28	225,942	1000	18,540	2,100.00																																																																																																																		
2024	2024-660027345	ALLEN, ROY & SHERI	28	246,097	1000	17,970	2,072.00																																																																																																																		
2023	2023-660027345	ALLEN, ROY & SHERI	28	187,356	1000	17,417	1,976.00																																																																																																																		
2022	2022-660027345	ALLEN, ROY & SHERI	28	185,211	1000	16,881	1,904.00																																																																																																																		
2021	2021-660027345	ALLEN, ROY & SHERI	28	164,521	1000	16,360	1,871.00																																																																																																																		
2020	2020-660027345	ALLEN, ROY & SHERI	28	155,620	1000	15,855	1,818.00																																																																																																																		
2019	2019-660027345	ALLEN, ROY & SHERI	28	148,766	1000	15,364	1,745.00																																																																																																																		
2018	2018-660027345	ALLEN, ROY & SHERI	28	152,306	1000	15,754	1,805.00																																																																																																																		
2017	2017-660027345	ALLEN, ROY & SHERI	28	151,158	1000	15,422	1,744.00																																																																																																																		
2016	2016-660027345	ALLEN, ROY & SHERI	28	147,772	1000	14,943	1,654.00																																																																																																																		
2015	2015-660027345	ALLEN, ROY & SHERI	28	140,720	1000	14,479	1,619.00																																																																																																																		
2014	2014-660027345	ALLEN, ROY & SHERI	28	143,169	1000	14,749	1,606.00																																																																																																																		
2013	2013-660027345	ALLEN, ROY & SHERI	28	135,657	1000	13,540	1,472.00																																																																																																																		



Rogers

Assessment Property Record Card for Tax Year 2026

Data provided by LISA DELOZIER County Assessor

Date 04/16/2026
Time 21:14:48
Page 2

Lot Data	Square-Foot - NBHD 1132 #1	Primary Image
Lot Size Lot Count Units Buildable 47931 Non-Ag Acres 1.0358 Topography Street Access Utilities Amenities 0 Method Square-Foot Base Lot Value 45,121.00 x 1.23 = 55,465 Factor Value Adjustments 1.0000 Lot Value 55,465		

C:\Users\RLN\Pictures\2018-04-09 04-09-18\04-09-18 081.JPG 4/10/2018

Residential Data	
Type	1 Single Family Residence
Condition	3 - Average
Quality	2.5 - Fair
Architecture	
Style	100% One Story
Exterior Wall	70% Frame, Siding, Wood 30% Veneer, Masonry
Base/Total Area	1,462 / 1,462
Style	100% One Story
HVAC	100% Warmed & Cooled Air
Roof Cover	1 Composition Shingle
Area on Slab	1,462
Fixture/RghIn	11 /
Bed/F/H Bath	3 / 2.0 /
Basement Area	
Garage Type	336 Attached Garage - Unfinished
Remodel	
Year/Eff Age	1998 / 21

GRM Approach	
GRM Code	
Gross Rent	0.00
Indicated Value	

Multiple Regression			
MRA Code	1	Test	
Adusted R	0.8445		
Indicated Value	200,131	136.89	Per SqFt

Direct Comparables			
Selection Model	A	Adam Test	
Adjustment Model	1	2022 Residential	
Comparables	1		
Indicated Value	45,440		Per SqFt

Cost Approach				Manual : 01/2025			
Base Cost	101.38	Total Misc Impr	+ 10,738				
Roofing Adj	+ 4.55	Garage Cost	+ 10,335				
Subfloor Adj	+ -1.18	Total RCN	= 205,066				
Heat/Cool Adj	+ 11.47	Depreciation (27%)	- 55,368				
Plumbing Adj	+ 9.63	Lump Sums	+ 0				
Basement Adj	+ 0.00	RCNLD	= 149,698				
Adj Base Cost	= 125.85	Lot Value	+ 55,465				
Total Area	x 1,462	Indicated Value	= 205,163				
Adjusted Cost	= 183,993	Value Per SqFt	140.33				

Value Reconciliation			
Selected Approach	Cost Approach		
Improvements	149,698		
Lot Value	55,465		
Indicated Value	205,163	140.33	Per SqFt
Agland Value			
Site Improvements	34,485		
Total Value	239,648	163.92	Total Value Per SqFt

Miscellaneous Improvements							
Code	Description	Sketch ID	Size	Year	Units	Unit Cost	Depr Value
FPR1	FIREPLACE - RESIDENTIAL 1 STORY	0		1	1	5,095.98	5,096
PRCH	SLAB PORCH - COVERED	66097		73	73	24.04	1,755
PRCH	SLAB PORCH - COVERED	66098		164	164	23.70	3,887



Rogers

Assessment Property Record Card for Tax Year 2026

Data provided by LISA DELOZIER County Assessor

Date 04/16/2026
 Time 21:14:48
 Page 3

Sketch Image

660027345

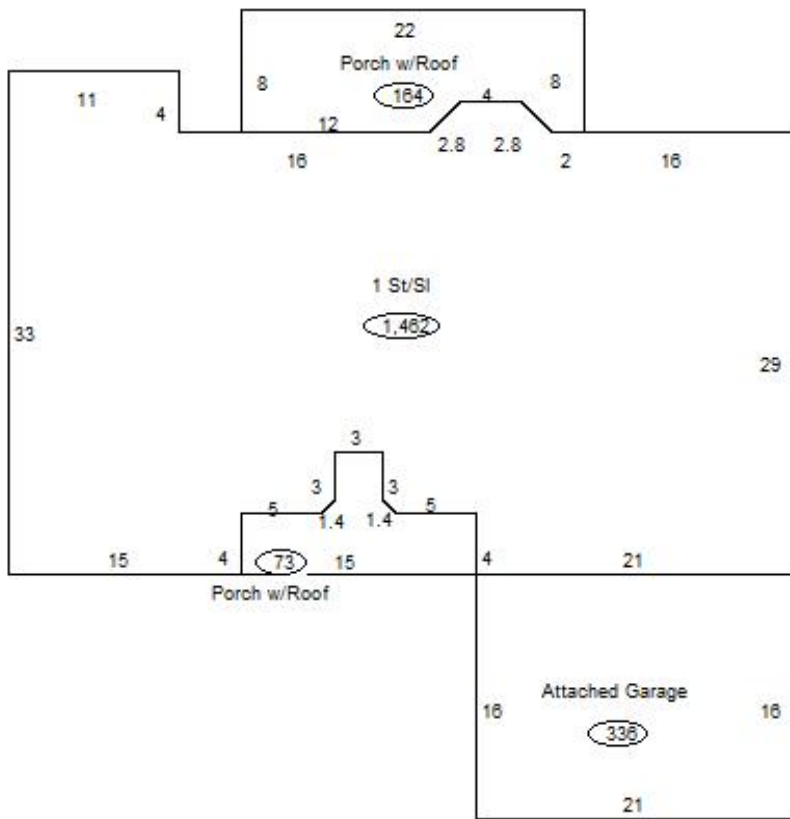

Sketch Vector Information

Sequence	Code	Type	Built Over	Scale	Section Label	Base Area	Multiplier	Total Area
1	R	1	Slab	13	1 St/Sl	1,462	1.000	1,462
2	G	1		13	Attached Garage	336	1.000	336
3	M	PRCH		13	SLBC	73	1.000	73
4	M	PRCH		13	SLBC	164	1.000	164
Total Building Area						1,462		1,462



Rogers



Assessment Property Record Card for Tax Year 2026

Data provided by LISA DELOZIER County Assessor

Date 04/16/2026
Time 21:14:48
Page 4

660027345

Outbuildings/Site Improvements

Building Image	Code	Description	Dimensions	Floor	Roofing	Total Units	
	UTIL	SHOP BUILDING	0x0x0			1,200	
	Qual	2	Cond 3	Year	Eff Age		
	Valuation Summary		Modifier Total	RCN	Depr (5% Phys/ % Func)	RCNLD	
	Base Cost (30.25 x 1,200)		36,300		36,300	1,815	34,485
	STF	STG FAIR	0x0x0				
	Qual		Cond	Year	Eff Age		
	Valuation Summary		Modifier Total	RCN	Depr (100% Phys/ % Func)	RCNLD	
	Base Cost (4.68 x)						