



Rogers

Assessment Property Record Card for Tax Year 2026

Data provided by LISA DELOZIER County Assessor

Date 04/16/2026
Time 21:52:08
Page 1

Assessment Data					Primary Image																																																																																																																				
Account 660027409 Parcel ID 000000-00-0-00540-002-0005 Cadastral ID 31-22-16-02000 Property Type REAL - Real Property Property Class RRP VI Area 1 Tax Area 10 - OOLOGAH RURAL/NW FIRE Name ID 332782 MOUA, SHUR & MAI K YANG 10155 E NORTH PARK ST CLAREMORE OK 74017-0000 Parcel Location Situs 10155 E NORTH PARK Subdivision NORTHAVEN Lot/Block 0005 / 0002 Parcel Size 1.158 - Lots Sec/Twn/Rng 31 / 22 / 16 / 5 Neighborhood 1114 - R-V01,4-NW OOLOGAH School District S004 - OOLOGAH SCHOOLS																																																																																																																									
Legal Description Lot/Long: 36.33949912 -95.64823328																																																																																																																									
Legal Description LOT 5 BLOCK 2 NORTHAVEN					Building Permits <table border="1"> <thead> <tr> <th>Number</th> <th>Description</th> <th>Opened</th> <th>Closed</th> <th>Amount</th> </tr> </thead> <tbody> <tr> <td> </td> <td> </td> <td> </td> <td> </td> <td> </td> </tr> </tbody> </table>					Number	Description	Opened	Closed	Amount																																																																																																											
Number	Description	Opened	Closed	Amount																																																																																																																					
Exemptions <table border="1"> <thead> <tr> <th>Code</th> <th>Type</th> <th>Active</th> <th>Maximum</th> <th>Exemption</th> </tr> </thead> <tbody> <tr> <td>H</td> <td>Homestead</td> <td>No</td> <td>1,000</td> <td> </td> </tr> <tr> <td>H</td> <td>Homestead</td> <td>No</td> <td>1,000</td> <td> </td> </tr> </tbody> </table>					Code	Type	Active	Maximum	Exemption	H	Homestead	No	1,000		H	Homestead	No	1,000		Sale History <table border="1"> <thead> <tr> <th>Bk/Pg</th> <th>Grantor</th> <th>Date</th> <th>Price</th> <th>Code</th> </tr> </thead> <tbody> <tr> <td>/</td> <td>ATES, BENJAMIN D</td> <td>11/18/2020</td> <td>270,000</td> <td>YES</td> </tr> <tr> <td>2668/69</td> <td>GOUDIE, DYLAN R &</td> <td>10/09/2017</td> <td>240,000</td> <td>YES</td> </tr> <tr> <td>2556/282</td> <td>DARNELL, STEVEN L &</td> <td>06/07/2016</td> <td>235,000</td> <td>YES</td> </tr> <tr> <td>2465/828</td> <td>DARNELL, STEVEN L &</td> <td>04/08/2015</td> <td>0</td> <td>4</td> </tr> <tr> <td>2443/749</td> <td>THORNE, DAVID A & SUSAN M</td> <td>12/12/2014</td> <td>195,000</td> <td>YES</td> </tr> <tr> <td>1035/638</td> <td>THOMPSON, GARY E &</td> <td>08/13/1996</td> <td>92,000</td> <td>Yes</td> </tr> </tbody> </table>					Bk/Pg	Grantor	Date	Price	Code	/	ATES, BENJAMIN D	11/18/2020	270,000	YES	2668/69	GOUDIE, DYLAN R &	10/09/2017	240,000	YES	2556/282	DARNELL, STEVEN L &	06/07/2016	235,000	YES	2465/828	DARNELL, STEVEN L &	04/08/2015	0	4	2443/749	THORNE, DAVID A & SUSAN M	12/12/2014	195,000	YES	1035/638	THOMPSON, GARY E &	08/13/1996	92,000	Yes																																																														
Code	Type	Active	Maximum	Exemption																																																																																																																					
H	Homestead	No	1,000																																																																																																																						
H	Homestead	No	1,000																																																																																																																						
Bk/Pg	Grantor	Date	Price	Code																																																																																																																					
/	ATES, BENJAMIN D	11/18/2020	270,000	YES																																																																																																																					
2668/69	GOUDIE, DYLAN R &	10/09/2017	240,000	YES																																																																																																																					
2556/282	DARNELL, STEVEN L &	06/07/2016	235,000	YES																																																																																																																					
2465/828	DARNELL, STEVEN L &	04/08/2015	0	4																																																																																																																					
2443/749	THORNE, DAVID A & SUSAN M	12/12/2014	195,000	YES																																																																																																																					
1035/638	THOMPSON, GARY E &	08/13/1996	92,000	Yes																																																																																																																					
Parcel Valuation <table border="1"> <thead> <tr> <th>Source</th> <th>REAL</th> <th>Fair Cash</th> <th>Capped</th> <th>Asmnt Level</th> <th>Assessed</th> <th>Levy Rate</th> <th>108.182</th> <th>Current Tax</th> </tr> </thead> <tbody> <tr> <td>Remove Cap</td> <td>2021</td> <td>Land Value 74,462</td> <td>61,728</td> <td>11%</td> <td>6,790</td> <td>Assessed</td> <td>38,537</td> <td>4,168.99</td> </tr> <tr> <td>Year Frozen</td> <td>0</td> <td>Improvements 292,730</td> <td>288,612</td> <td></td> <td>31,747</td> <td>Penalty</td> <td>0</td> <td></td> </tr> <tr> <td>Uncapped Value</td> <td>0</td> <td>Mobile Home 0</td> <td>0</td> <td></td> <td>0</td> <td>Exemption</td> <td>0</td> <td>0.00</td> </tr> <tr> <td>TIF Project ID</td> <td>0</td> <td>Total Value 367,192</td> <td>350,340</td> <td></td> <td>38,537</td> <td>Total Taxable</td> <td>38,537</td> <td>4,169.00</td> </tr> </tbody> </table>										Source	REAL	Fair Cash	Capped	Asmnt Level	Assessed	Levy Rate	108.182	Current Tax	Remove Cap	2021	Land Value 74,462	61,728	11%	6,790	Assessed	38,537	4,168.99	Year Frozen	0	Improvements 292,730	288,612		31,747	Penalty	0		Uncapped Value	0	Mobile Home 0	0		0	Exemption	0	0.00	TIF Project ID	0	Total Value 367,192	350,340		38,537	Total Taxable	38,537	4,169.00																																																																			
Source	REAL	Fair Cash	Capped	Asmnt Level	Assessed	Levy Rate	108.182	Current Tax																																																																																																																	
Remove Cap	2021	Land Value 74,462	61,728	11%	6,790	Assessed	38,537	4,168.99																																																																																																																	
Year Frozen	0	Improvements 292,730	288,612		31,747	Penalty	0																																																																																																																		
Uncapped Value	0	Mobile Home 0	0		0	Exemption	0	0.00																																																																																																																	
TIF Project ID	0	Total Value 367,192	350,340		38,537	Total Taxable	38,537	4,169.00																																																																																																																	
Assessment History <table border="1"> <thead> <tr> <th>Tax Year</th> <th>Statement Number</th> <th>Billed Owner</th> <th>Tax Area</th> <th>Total Value</th> <th>Exemptions</th> <th>Taxable Value</th> <th>Billed Tax</th> </tr> </thead> <tbody> <tr><td>2025</td><td>2025-660027409</td><td>MOUA, SHUR & MAI K YANG</td><td>10</td><td>349,331</td><td>0</td><td>36,702</td><td>3,970.00</td></tr> <tr><td>2024</td><td>2024-660027409</td><td>MOUA, SHUR & MAI K YANG</td><td>10</td><td>370,920</td><td>0</td><td>34,955</td><td>3,661.00</td></tr> <tr><td>2023</td><td>2023-660027409</td><td>MOUA, SHUR & MAI K YANG</td><td>10</td><td>302,639</td><td>0</td><td>33,290</td><td>3,461.00</td></tr> <tr><td>2022</td><td>2022-660027409</td><td>MOUA, SHUR & MAI K YANG</td><td>10</td><td>302,296</td><td>0</td><td>32,718</td><td>3,387.00</td></tr> <tr><td>2021</td><td>2021-660027409</td><td>MOUA, SHUR & MAI K YANG</td><td>10</td><td>283,270</td><td>0</td><td>31,160</td><td>3,249.00</td></tr> <tr><td>2020</td><td>2020-660027409</td><td>ATES, BENJAMIN D</td><td>10</td><td>252,836</td><td>0</td><td>27,161</td><td>2,873.00</td></tr> <tr><td>2019</td><td>2019-660027409</td><td>ATES, BENJAMIN D</td><td>10</td><td>235,157</td><td>0</td><td>25,867</td><td>2,684.00</td></tr> <tr><td>2018</td><td>2018-660027409</td><td>ATES, BENJAMIN D</td><td>10</td><td>241,276</td><td>0</td><td>26,540</td><td>2,850.00</td></tr> <tr><td>2017</td><td>2017-660027409</td><td>GOUDIE, DYLAN R &</td><td>10</td><td>236,364</td><td>0</td><td>26,000</td><td>2,956.00</td></tr> <tr><td>2016</td><td>2016-660027409</td><td>GOUDIE, DYLAN R &</td><td>10</td><td>207,127</td><td>1000</td><td>21,694</td><td>2,261.00</td></tr> <tr><td>2015</td><td>2015-660027409</td><td>DARNELL, STEVEN L &</td><td>10</td><td>200,297</td><td>1000</td><td>21,033</td><td>2,073.00</td></tr> <tr><td>2014</td><td>2014-660027409</td><td>THORNE, DAVID A & SUSAN M</td><td>10</td><td>165,000</td><td>1000</td><td>17,150</td><td>1,690.00</td></tr> <tr><td>2013</td><td>2013-660027409</td><td>THORNE, DAVID A & SUSAN M</td><td>10</td><td>165,000</td><td>1000</td><td>17,150</td><td>1,635.00</td></tr> </tbody> </table>										Tax Year	Statement Number	Billed Owner	Tax Area	Total Value	Exemptions	Taxable Value	Billed Tax	2025	2025-660027409	MOUA, SHUR & MAI K YANG	10	349,331	0	36,702	3,970.00	2024	2024-660027409	MOUA, SHUR & MAI K YANG	10	370,920	0	34,955	3,661.00	2023	2023-660027409	MOUA, SHUR & MAI K YANG	10	302,639	0	33,290	3,461.00	2022	2022-660027409	MOUA, SHUR & MAI K YANG	10	302,296	0	32,718	3,387.00	2021	2021-660027409	MOUA, SHUR & MAI K YANG	10	283,270	0	31,160	3,249.00	2020	2020-660027409	ATES, BENJAMIN D	10	252,836	0	27,161	2,873.00	2019	2019-660027409	ATES, BENJAMIN D	10	235,157	0	25,867	2,684.00	2018	2018-660027409	ATES, BENJAMIN D	10	241,276	0	26,540	2,850.00	2017	2017-660027409	GOUDIE, DYLAN R &	10	236,364	0	26,000	2,956.00	2016	2016-660027409	GOUDIE, DYLAN R &	10	207,127	1000	21,694	2,261.00	2015	2015-660027409	DARNELL, STEVEN L &	10	200,297	1000	21,033	2,073.00	2014	2014-660027409	THORNE, DAVID A & SUSAN M	10	165,000	1000	17,150	1,690.00	2013	2013-660027409	THORNE, DAVID A & SUSAN M	10	165,000	1000	17,150	1,635.00
Tax Year	Statement Number	Billed Owner	Tax Area	Total Value	Exemptions	Taxable Value	Billed Tax																																																																																																																		
2025	2025-660027409	MOUA, SHUR & MAI K YANG	10	349,331	0	36,702	3,970.00																																																																																																																		
2024	2024-660027409	MOUA, SHUR & MAI K YANG	10	370,920	0	34,955	3,661.00																																																																																																																		
2023	2023-660027409	MOUA, SHUR & MAI K YANG	10	302,639	0	33,290	3,461.00																																																																																																																		
2022	2022-660027409	MOUA, SHUR & MAI K YANG	10	302,296	0	32,718	3,387.00																																																																																																																		
2021	2021-660027409	MOUA, SHUR & MAI K YANG	10	283,270	0	31,160	3,249.00																																																																																																																		
2020	2020-660027409	ATES, BENJAMIN D	10	252,836	0	27,161	2,873.00																																																																																																																		
2019	2019-660027409	ATES, BENJAMIN D	10	235,157	0	25,867	2,684.00																																																																																																																		
2018	2018-660027409	ATES, BENJAMIN D	10	241,276	0	26,540	2,850.00																																																																																																																		
2017	2017-660027409	GOUDIE, DYLAN R &	10	236,364	0	26,000	2,956.00																																																																																																																		
2016	2016-660027409	GOUDIE, DYLAN R &	10	207,127	1000	21,694	2,261.00																																																																																																																		
2015	2015-660027409	DARNELL, STEVEN L &	10	200,297	1000	21,033	2,073.00																																																																																																																		
2014	2014-660027409	THORNE, DAVID A & SUSAN M	10	165,000	1000	17,150	1,690.00																																																																																																																		
2013	2013-660027409	THORNE, DAVID A & SUSAN M	10	165,000	1000	17,150	1,635.00																																																																																																																		



Rogers

Assessment Property Record Card for Tax Year 2026

Data provided by LISA DELOZIER County Assessor

Date 04/16/2026
Time 21:52:08
Page 2

Lot Data	Square-Foot - NBHD 1114 #1	Primary Image
Lot Size Lot Count Units Buildable 1 Non-Ag Acres 1.2735 Topography Street Access Utilities Amenities LAND VALUE 0 0 Method Square-Foot Base Lot Value 55,475.00 x 1.34 = 74,462 Factor Value Adjustments 1.0000 Lot Value 74,462		 <p>\\tsclient\T\TOMMY DUNLAP\New folder (113)\IMG_0084.JPG 11/21/2022</p>

Residential Data	
Type	1 Single Family Residence
Condition	3 - Average
Quality	3 - Average
Architecture	
Style	100% One Story
Exterior Wall	30% Veneer, Masonry 70% Frame, Siding, Wood
Base/Total Area	2,365 / 2,365
Style	100% One Story
HVAC	100% Warmed & Cooled Air
Roof Cover	1 Composition Shingle
Area on Slab	2,365
Fixture/RghIn	16 /
Bed/F/H Bath	4 / 3.0 /
Basement Area	
Garage Type	
Remodel	RMA -
Year/Eff Age	1992 / 16

Cost Approach				Manual : 01/2025			
Base Cost	91.58	Total Misc Impr	+ 18,030				
Roofing Adj	+ 4.23	Garage Cost	+ 0				
Subfloor Adj	+ -2.04	Total RCN	= 291,897				
Heat/Cool Adj	+ 12.64	Depreciation (17%)	- 49,622				
Plumbing Adj	+ 9.39	Lump Sums	+ 0				
Basement Adj	+ 0.00	RCNLD	= 242,275				
Adj Base Cost	= 115.80	Lot Value	+ 74,462				
Total Area	x 2,365	Indicated Value	= 316,737				
Adjusted Cost	= 273,867	Value Per SqFt	133.93				

GRM Approach	
GRM Code	
Gross Rent	0.00
Indicated Value	

Multiple Regression			
MRA Code	1	Test	
Adusted R	0.8445		
Indicated Value	263,538	111.43	Per SqFt

Direct Comparables	
Selection Model	A Adam Test
Adjustment Model	1 2022 Residential
Comparables	1
Indicated Value	

Value Reconciliation			
Selected Approach	Cost Approach		
Improvements	242,275		
Lot Value	74,462		
Indicated Value	316,737	133.93	Per SqFt
Agland Value			
Site Improvements	50,455		
Total Value	367,192	155.26	Total Value Per SqFt

Miscellaneous Improvements								
Code	Description	Sketch ID	Size	Year	Units	Unit Cost	Depr	Value
FPR1	FIREPLACE - RESIDENTIAL 1 STORY	0		1	1	5,615.40		5,615
PRCH	SLAB PORCH - COVERED	66333	24x5		120	26.55		3,186
PRCH	SLAB PORCH - COVERED	66334	16x10		160	26.43		4,229
SUN	Sunroom		20x10		200	25.00		5,000



Rogers

Assessment Property Record Card for Tax Year 2026

Data provided by LISA DELOZIER County Assessor

Date 04/16/2026

Time 21:52:08

Page 3

Sketch Image

660027409

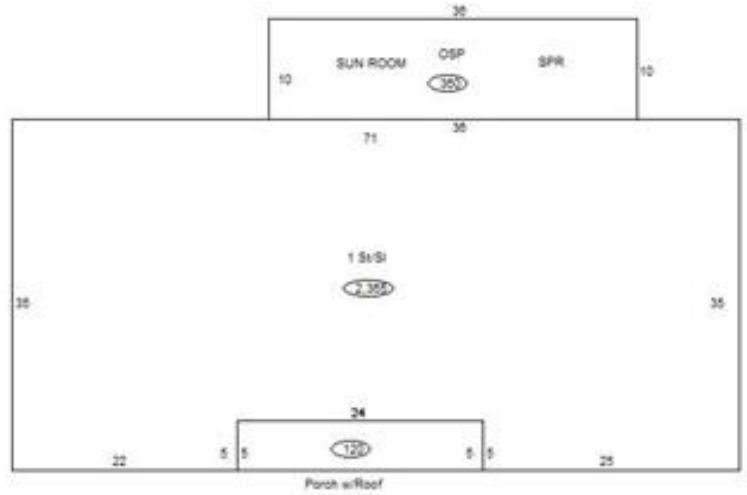

Sketch Vector Information

Sequence	Code	Type	Built Over	Scale	Section Label	Base Area	Multiplier	Total Area
1	R	1	Slab	13	1 St/Sl	2,365	1.000	2,365
2	M	PRCH		13	SLBC	120	1.000	120
3	M	PRCH		13	Open Slab	360	1.000	360
4	N	0		13	SUN ROOM		0.000	
5	N	0		13	SPR		0.000	
Total Building Area						2,365		2,365



Rogers

Assessment Property Record Card for Tax Year 2026

Data provided by LISA DELOZIER County Assessor

Date 04/16/2026
 Time 21:52:08
 Page 4

660027409

Outbuildings/Site Improvements

Building Image	Code	Description	Dimensions	Floor	Roofing	Total Units	
	UTIL	SHOP BUILDING	0x0x0			1,500	
	Qual	2	Cond 3	Year	Eff Age		
	Valuation Summary		Modifier Total	RCN	Depr (1% Phys/ % Func)	RCNLD	
	Base Cost (28.71 x 1,500)		43,065		43,065	431	42,634
	LT	LEAN-TO	0x0x0			192	
	Qual	3	Cond 3	Year	Eff Age		
	Valuation Summary		Modifier Total	RCN	Depr (5% Phys/ % Func)	RCNLD	
	Base Cost (2.92 x 192)		561		561	28	533
	UTIL	SHOP BUILDING	16x16x0			256	
	Qual	2	Cond 3	Year	Eff Age 1520		
	Valuation Summary		Modifier Total	RCN	Depr (5% Phys/ % Func)	RCNLD	
	Base Cost (29.97 x 256)		7,672		7,672	384	7,288
	CP	Carport Dirt	0x0x0				
	Qual		Cond	Year	Eff Age		
	Valuation Summary		Modifier Total	RCN	Depr (100% Phys/ % Func)	RCNLD	
	Base Cost (3.50 x)						