



Rogers

Assessment Property Record Card for Tax Year 2026

Data provided by LISA DELOZIER County Assessor

Date 04/17/2026
 Time 00:56:13
 Page 1

Assessment Data					Primary Image																																																																																																																				
Account 660027967 Parcel ID 23N17E-32-2-00000-000-0000 Cadastral ID 32-23-17-02800 Property Type REAL - Real Property Property Class RR VI Area 2 Tax Area 70 - FOYIL RURAL/FOYIL FIRE Name ID 291298 PARIS, ANNETTE I 12235 S MAPLE AVE CLAREMORE OK 74017-0000 Parcel Location Situs 12235 S MAPLE AVE Subdivision Lot/Block / Parcel Size .18 - Acres Sec/Twn/Rng 32 / 23 / 17 / 2 Neighborhood 4070 - FOYIL SEQUOYAH AREA School District S007 - FOYIL SCHOOLS					 <p>\\tsclient\C\TOMS PC PICS\2016-12-28 12-28-2016\12-28-2016 01 12/30/2016</p>																																																																																																																				
Legal Description Lat/Long: 36.43392777 -95.51636264 N 200' E 40' NE SE NW																																																																																																																									
Exemptions <table border="1"> <thead> <tr> <th>Code</th> <th>Type</th> <th>Active</th> <th>Maximum</th> <th>Exemption</th> </tr> </thead> <tbody> <tr> <td>H</td> <td>Homestead</td> <td>Yes</td> <td>1,000</td> <td>1,000</td> </tr> </tbody> </table>					Code	Type	Active	Maximum	Exemption	H	Homestead	Yes	1,000	1,000	Building Permits <table border="1"> <thead> <tr> <th>Number</th> <th>Description</th> <th>Opened</th> <th>Closed</th> <th>Amount</th> </tr> </thead> <tbody> <tr> <td>R14</td> <td>R14-NEW CONSTRUCTION AFTER FIR</td> <td>01/2013</td> <td>12/2013</td> <td></td> </tr> </tbody> </table>					Number	Description	Opened	Closed	Amount	R14	R14-NEW CONSTRUCTION AFTER FIR	01/2013	12/2013																																																																																													
Code	Type	Active	Maximum	Exemption																																																																																																																					
H	Homestead	Yes	1,000	1,000																																																																																																																					
Number	Description	Opened	Closed	Amount																																																																																																																					
R14	R14-NEW CONSTRUCTION AFTER FIR	01/2013	12/2013																																																																																																																						
Parcel Valuation <table border="1"> <thead> <tr> <th>Source</th> <th>REAL</th> <th>Fair Cash</th> <th>Capped</th> <th>Asmnt Level</th> <th>Assessed</th> <th>Levy Rate</th> <th>101.660</th> <th>Current Tax</th> </tr> </thead> <tbody> <tr> <td>Remove Cap</td> <td>2007</td> <td>Land Value 5,167</td> <td>4,790</td> <td>11%</td> <td>527</td> <td>Assessed</td> <td>16,321</td> <td>1,659.19</td> </tr> <tr> <td>Year Frozen</td> <td>0</td> <td>Improvements 194,201</td> <td>143,583</td> <td></td> <td>15,794</td> <td>Penalty</td> <td>0</td> <td></td> </tr> <tr> <td>Uncapped Value</td> <td>0</td> <td>Mobile Home 0</td> <td>0</td> <td></td> <td>0</td> <td>Exemption</td> <td>1,000</td> <td>-88.00</td> </tr> <tr> <td>TIF Project ID</td> <td>0</td> <td>Total Value 199,368</td> <td>148,373</td> <td></td> <td>16,321</td> <td>Total Taxable</td> <td>15,321</td> <td>1,571.00</td> </tr> </tbody> </table>					Source	REAL	Fair Cash	Capped	Asmnt Level	Assessed	Levy Rate	101.660	Current Tax	Remove Cap	2007	Land Value 5,167	4,790	11%	527	Assessed	16,321	1,659.19	Year Frozen	0	Improvements 194,201	143,583		15,794	Penalty	0		Uncapped Value	0	Mobile Home 0	0		0	Exemption	1,000	-88.00	TIF Project ID	0	Total Value 199,368	148,373		16,321	Total Taxable	15,321	1,571.00	Sale History <table border="1"> <thead> <tr> <th>Bk/Pg</th> <th>Grantor</th> <th>Date</th> <th>Price</th> <th>Code</th> </tr> </thead> <tbody> <tr> <td>/</td> <td>PLATT, DANNY L &</td> <td>07/14/2017</td> <td>0</td> <td>4</td> </tr> <tr> <td>1755/41</td> <td>MORGAN, BEULAH FAYE</td> <td>03/01/2006</td> <td>52,500</td> <td>YES</td> </tr> </tbody> </table>					Bk/Pg	Grantor	Date	Price	Code	/	PLATT, DANNY L &	07/14/2017	0	4	1755/41	MORGAN, BEULAH FAYE	03/01/2006	52,500	YES																																																				
Source	REAL	Fair Cash	Capped	Asmnt Level	Assessed	Levy Rate	101.660	Current Tax																																																																																																																	
Remove Cap	2007	Land Value 5,167	4,790	11%	527	Assessed	16,321	1,659.19																																																																																																																	
Year Frozen	0	Improvements 194,201	143,583		15,794	Penalty	0																																																																																																																		
Uncapped Value	0	Mobile Home 0	0		0	Exemption	1,000	-88.00																																																																																																																	
TIF Project ID	0	Total Value 199,368	148,373		16,321	Total Taxable	15,321	1,571.00																																																																																																																	
Bk/Pg	Grantor	Date	Price	Code																																																																																																																					
/	PLATT, DANNY L &	07/14/2017	0	4																																																																																																																					
1755/41	MORGAN, BEULAH FAYE	03/01/2006	52,500	YES																																																																																																																					
Assessment History <table border="1"> <thead> <tr> <th>Tax Year</th> <th>Statement Number</th> <th>Billed Owner</th> <th>Tax Area</th> <th>Total Value</th> <th>Exemptions</th> <th>Taxable Value</th> <th>Billed Tax</th> </tr> </thead> <tbody> <tr><td>2025</td><td>2025-660027967</td><td>PARIS, ANNETTE I</td><td>70</td><td>191,024</td><td>1000</td><td>14,846</td><td>1,522.00</td></tr> <tr><td>2024</td><td>2024-660027967</td><td>PARIS, ANNETTE I</td><td>70</td><td>191,909</td><td>1000</td><td>14,385</td><td>1,513.00</td></tr> <tr><td>2023</td><td>2023-660027967</td><td>PARIS, ANNETTE I</td><td>70</td><td>161,744</td><td>1000</td><td>13,936</td><td>1,467.00</td></tr> <tr><td>2022</td><td>2022-660027967</td><td>PARIS, ANNETTE I</td><td>70</td><td>159,239</td><td>1000</td><td>13,501</td><td>1,427.00</td></tr> <tr><td>2021</td><td>2021-660027967</td><td>PARIS, ANNETTE I</td><td>70</td><td>128,615</td><td>1000</td><td>13,079</td><td>1,347.00</td></tr> <tr><td>2020</td><td>2020-660027967</td><td>PARIS, ANNETTE I</td><td>70</td><td>125,020</td><td>1000</td><td>12,669</td><td>1,358.00</td></tr> <tr><td>2019</td><td>2019-660027967</td><td>PARIS, ANNETTE I</td><td>70</td><td>120,645</td><td>1000</td><td>12,271</td><td>1,320.00</td></tr> <tr><td>2018</td><td>2018-660027967</td><td>PARIS, ANNETTE I</td><td>70</td><td>122,816</td><td>1000</td><td>12,509</td><td>1,321.00</td></tr> <tr><td>2017</td><td>2017-660027967</td><td>PLATT, DANNY L &</td><td>70</td><td>121,677</td><td>1000</td><td>12,371</td><td>1,310.00</td></tr> <tr><td>2016</td><td>2016-660027967</td><td>PLATT, DANNY L &</td><td>70</td><td>118,016</td><td>1000</td><td>11,981</td><td>1,314.00</td></tr> <tr><td>2015</td><td>2015-660027967</td><td>PLATT, DANNY L &</td><td>70</td><td>115,133</td><td>1000</td><td>11,664</td><td>1,267.00</td></tr> <tr><td>2014</td><td>2014-660027967</td><td>PLATT, DANNY L &</td><td>70</td><td>115,850</td><td>1000</td><td>11,744</td><td>1,258.00</td></tr> <tr><td>2013</td><td>2013-660027967</td><td>PLATT, DANNY L &</td><td>70</td><td>2,627</td><td>0</td><td>289</td><td>30.00</td></tr> </tbody> </table>										Tax Year	Statement Number	Billed Owner	Tax Area	Total Value	Exemptions	Taxable Value	Billed Tax	2025	2025-660027967	PARIS, ANNETTE I	70	191,024	1000	14,846	1,522.00	2024	2024-660027967	PARIS, ANNETTE I	70	191,909	1000	14,385	1,513.00	2023	2023-660027967	PARIS, ANNETTE I	70	161,744	1000	13,936	1,467.00	2022	2022-660027967	PARIS, ANNETTE I	70	159,239	1000	13,501	1,427.00	2021	2021-660027967	PARIS, ANNETTE I	70	128,615	1000	13,079	1,347.00	2020	2020-660027967	PARIS, ANNETTE I	70	125,020	1000	12,669	1,358.00	2019	2019-660027967	PARIS, ANNETTE I	70	120,645	1000	12,271	1,320.00	2018	2018-660027967	PARIS, ANNETTE I	70	122,816	1000	12,509	1,321.00	2017	2017-660027967	PLATT, DANNY L &	70	121,677	1000	12,371	1,310.00	2016	2016-660027967	PLATT, DANNY L &	70	118,016	1000	11,981	1,314.00	2015	2015-660027967	PLATT, DANNY L &	70	115,133	1000	11,664	1,267.00	2014	2014-660027967	PLATT, DANNY L &	70	115,850	1000	11,744	1,258.00	2013	2013-660027967	PLATT, DANNY L &	70	2,627	0	289	30.00
Tax Year	Statement Number	Billed Owner	Tax Area	Total Value	Exemptions	Taxable Value	Billed Tax																																																																																																																		
2025	2025-660027967	PARIS, ANNETTE I	70	191,024	1000	14,846	1,522.00																																																																																																																		
2024	2024-660027967	PARIS, ANNETTE I	70	191,909	1000	14,385	1,513.00																																																																																																																		
2023	2023-660027967	PARIS, ANNETTE I	70	161,744	1000	13,936	1,467.00																																																																																																																		
2022	2022-660027967	PARIS, ANNETTE I	70	159,239	1000	13,501	1,427.00																																																																																																																		
2021	2021-660027967	PARIS, ANNETTE I	70	128,615	1000	13,079	1,347.00																																																																																																																		
2020	2020-660027967	PARIS, ANNETTE I	70	125,020	1000	12,669	1,358.00																																																																																																																		
2019	2019-660027967	PARIS, ANNETTE I	70	120,645	1000	12,271	1,320.00																																																																																																																		
2018	2018-660027967	PARIS, ANNETTE I	70	122,816	1000	12,509	1,321.00																																																																																																																		
2017	2017-660027967	PLATT, DANNY L &	70	121,677	1000	12,371	1,310.00																																																																																																																		
2016	2016-660027967	PLATT, DANNY L &	70	118,016	1000	11,981	1,314.00																																																																																																																		
2015	2015-660027967	PLATT, DANNY L &	70	115,133	1000	11,664	1,267.00																																																																																																																		
2014	2014-660027967	PLATT, DANNY L &	70	115,850	1000	11,744	1,258.00																																																																																																																		
2013	2013-660027967	PLATT, DANNY L &	70	2,627	0	289	30.00																																																																																																																		



Rogers

Assessment Property Record Card for Tax Year 2026

Data provided by LISA DELOZIER County Assessor

Date 04/17/2026
 Time 00:56:13
 Page 2

Lot Data	Square-Foot - NBHD 4070 #1	Primary Image
Lot Size Lot Count Units Buildable 0.18 Non-Ag Acres 0.2157 Topography Street Access Utilities Amenities LAND QUALITY 0 0 Method Square-Foot Base Lot Value 9,394.00 x .55 = 5,167 Factor Value Adjustments 1.0000 Lot Value 5,167		

Residential Data	
Type	1 Single Family Residence
Condition	3 - Average
Quality	3 - Average
Architecture	TRAD TRADITIONAL
Style	100% 1 1/2 Story Finished
Exterior Wall	100% Frame, Siding, Wood
Base/Total Area	1,133 / 1,721
Style	100% 1 1/2 Story Finished
HVAC	100% Warmed & Cooled Air
Roof Cover	1 Composition Shingle
Area on Slab	1,133
Fixture/RghIn	5 /
Bed/F/H Bath	4 / 2.0 / 1.0
Basement Area	
Garage Type	
Remodel	
Year/Eff Age	2013 / 10

\\tsclient\C\TOMS PC PICS\2016-12-28 12-28-2016\12-28-2016 01 12/30/2016

GRM Approach	
GRM Code	
Gross Rent	0.00
Indicated Value	

Multiple Regression			
MRA Code	1	Test	
Adusted R	0.8445		
Indicated Value	204,363	118.75	Per SqFt

Direct Comparables	
Selection Model	1 Res
Adjustment Model	A2 AO Test
Comparables	
Indicated Value	

Cost Approach				Manual : 01/2025			
Base Cost	93.80	Total Misc Impr	+ 10,749				
Roofing Adj	+ 3.52	Garage Cost	+ 204,637				
Subfloor Adj	+ -1.65	Total RCN	= 20,464				
Heat/Cool Adj	+ 12.64	Depreciation (10%)	- 0				
Plumbing Adj	+ 4.35	Lump Sums	+ 184,173				
Basement Adj	+ 0.00	RCNLD	= 5,167				
Adj Base Cost	= 112.66	Lot Value	+ 189,340				
		Indicated Value	= 193,888				
Total Area	x 1,721	Value Per SqFt					
Adjusted Cost	= 193,888						

Value Reconciliation			
Selected Approach	Cost Approach		
Improvements	184,173		
Lot Value	5,167		
Indicated Value	189,340	110.02	Per SqFt
Agland Value			
Site Improvements	10,028		
Total Value	199,368	115.84	Total Value Per SqFt

Miscellaneous Improvements								
Code	Description	Sketch ID	Size	Year	Units	Unit Cost	Depr	Value
PRCH	SLAB PORCH - COVERED	118779	365		365	25.78		9,410
PRCH	SLAB PORCH - COVERED	118780	10x5		50	26.77		1,339



Rogers

Assessment Property Record Card for Tax Year 2026

Data provided by LISA DELOZIER County Assessor

Date 04/17/2026
 Time 00:56:13
 Page 3

Sketch Image

660027967

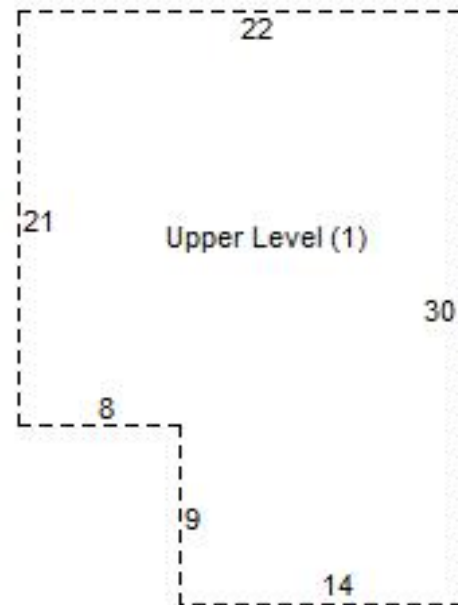
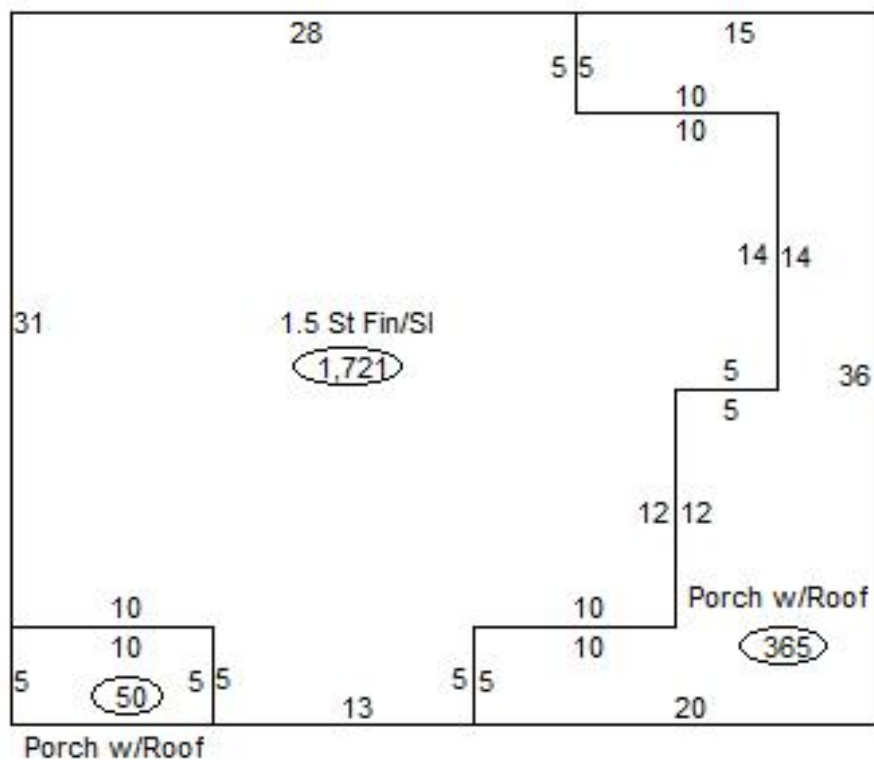

Sketch Vector Information

Sequence	Code	Type	Built Over	Scale	Section Label	Base Area	Multiplier	Total Area
1	R	5	Slab	13	1.5 St Fin/Sl	1,133	1.519	1,721
2	U	^UL		13	Upper Level (1)	588	1.000	588
3	M	PRCH		13	SLBC	365	1.000	365
4	M	PRCH		13	SLBC	50	1.000	50
Total Building Area						1,133		1,721



Rogers

Assessment Property Record Card for Tax Year 2026

Data provided by LISA DELOZIER County Assessor

Date 04/17/2026
Time 00:56:13
Page 4

660027967

Outbuildings/Site Improvements

Building Image	Code	Description	Dimensions	Floor	Roofing	Total Units
	UTIL	SHOP BUILDING	30x30x10	Concrete	Galvanized Metal	900
	Qual 2	Cond 3	Year 1980	Eff Age 35		
Valuation Summary		Modifier Total	RCN	Depr (61% Phys/ % Func)		RCNLD
Base Cost (28.57 x 900)		25,713	25,713	15,685		10,028