



Rogers

Assessment Property Record Card for Tax Year 2026

Data provided by LISA DELOZIER County Assessor

Date 04/16/2026
Time 22:52:07
Page 1

Assessment Data					Primary Image									
Account	660028339													
Parcel ID	21N15E-33-2-00000-000-0000													
Cadastral ID	33-21-15-03500													
Property Type	REAL - Real Property													
Property Class	RR	VI Area 4												
Tax Area	4 - VERDIGRIS/VERD FIRE													
Name ID	120764													
PARRISH, JUDY MAE														
24896 S MALCOM RD CLAREMORE OK 74019-0000														
Parcel Location														
Situs	24896 MALCOM RD													
Subdivision														
Lot/Block	/	Parcel Size	1.14 - Acres											
Sec/Twn/Rng	33 / 21 / 15 / 2													
Neighborhood	6090 - UNPLATTED													
School District	S008 - VERDIGRIS SCHOOLS													
Legal Description Lat/Long: 36.25201880 -95.71659516														
TR IN E2 NW SE SW, BEG NW/C E2 NW SE SW, S ALG W BNDRY/L A DIST 493.01' TO POB; S 89-58 E 215.77', N 230', N 89-58 W 215.90,S 230' TO POB														
Building Permits														
<table border="1"> <thead> <tr> <th>Number</th> <th>Description</th> <th>Opened</th> <th>Closed</th> <th>Amount</th> </tr> </thead> <tbody> <tr> <td> </td> <td> </td> <td> </td> <td> </td> <td> </td> </tr> </tbody> </table>					Number	Description	Opened	Closed	Amount					
Number	Description	Opened	Closed	Amount										
Exemptions														
Code	Type	Active	Maximum	Exemption										
H	Homestead	Yes	1,000	1,000										
Sale History														
Bk/Pg	Grantor	Date	Price	Code										
Parcel Valuation														
Source	REAL	Fair Cash	Capped	Asmnt Level	Assessed	Levy Rate	104.132	Current Tax						
Remove Cap	0	Land Value	38,511	37,789	11%	4,157	Assessed	25,095 2,613.19						
Year Frozen	0	Improvements	217,104	190,346		20,938	Penalty	0						
Uncapped Value	0	Mobile Home	0	0		0	Exemption	1,000 -87.00						
TIF Project ID	0	Total Value	255,615	228,135		25,095	Total Taxable	24,095 2,526.00						
Assessment History														
Tax Year	Statement Number	Billed Owner	Tax Area	Total Value	Exemptions	Taxable Value	Billed Tax							
2025	2025-660028339	PARRISH, JUDY MAE	4	229,692	1000	23,364	2,450.00							
2024	2024-660028339	PARRISH, JUDY MAE	4	241,733	1000	22,655	2,182.00							
2023	2023-660028339	PARRISH, CLOYD	4	208,777	1000	21,965	2,084.00							
2022	2022-660028339	PARRISH, CLOYD	4	205,132	1000	21,565	2,082.00							
2021	2021-660028339	PARRISH, CLOYD	4	213,824	1000	21,915	2,061.00							
2020	2020-660028339	PARRISH, CLOYD	4	210,415	1000	21,248	2,003.00							
2019	2019-660028339	PARRISH, CLOYD	4	196,366	1000	20,600	1,973.00							
2018	2018-660028339	PARRISH, CLOYD	4	204,720	1000	21,519	2,061.00							
2017	2017-660028339	PARRISH, CLOYD	4	202,470	1000	20,922	2,009.00							
2016	2016-660028339	PARRISH, CLOYD	4	197,803	1000	20,284	1,954.00							
2015	2015-660028339	PARRISH, CLOYD	4	193,934	1000	19,664	1,909.00							
2014	2014-660028339	PARRISH, CLOYD	4	196,133	1000	19,062	1,753.00							
2013	2013-660028339	PARRISH, CLOYD	4	188,180	1000	18,478	1,760.00							



Rogers

Assessment Property Record Card for Tax Year 2026

Data provided by LISA DELOZIER County Assessor

Date 04/16/2026
Time 22:52:07
Page 2

Lot Data	Square-Foot - NBHD 6090 #1	Primary Image
Lot Size Lot Count Units Buildable 1 Non-Ag Acres 1.2102 Topography Street Access Utilities Amenities LAND QUALITY 0 0 Method Square-Foot Base Lot Value 52,717.00 x .73 = 38,511 Factor Value Adjustments 1.0000 Lot Value 38,511		<p>\\tsclient\C\Users\Randy Necessary\Pictures\101_0706\IMG_0065. 7/7/2022</p>

Residential Data	
Type	1 Single Family Residence
Condition	3 - Average
Quality	3 - Average
Architecture	
Style	100% One Story
Exterior Wall	90% Veneer, Stone 10% Frame, Siding, Wood
Base/Total Area	2,412 / 2,412
Style	100% One Story
HVAC	100% Warmed & Cooled Air
Roof Cover	1 Composition Shingle
Area on Slab	2,412
Fixture/RghIn	14 /
Bed/F/H Bath	3 / 2.5 /
Basement Area	
Garage Type	746 Attached Garage - Unfinished 2 Stalls
Remodel	
Year/Eff Age	1979 / 35

Cost Approach				Manual : 01/2025			
Base Cost	107.87	Total Misc Impr	+	13,632			
Roofing Adj	+ 4.53	Garage Cost	+	22,223			
Subfloor Adj	+ -2.18	Total RCN	=	351,706			
Heat/Cool Adj	+ 12.64	Depreciation (43%)	-	151,234			
Plumbing Adj	+ 8.09	Lump Sums	+	0			
Basement Adj	+ 0.00	RCNLD	=	200,472			
Adj Base Cost	= 130.95	Lot Value	+	38,511			
Total Area	x 2,412	Indicated Value	=	238,983			
Adjusted Cost	= 315,851	Value Per SqFt		99.08			

GRM Approach	
GRM Code	
Gross Rent	0.00
Indicated Value	

Multiple Regression			
MRA Code	1	Test	
Adusted R	0.8445		
Indicated Value	286,647	118.84	Per SqFt

Direct Comparables			
Selection Model	1	Res	
Adjustment Model	A2	AO Test	
Comparables			
Indicated Value			

Value Reconciliation			
Selected Approach	Cost Approach		
Improvements	200,472		
Lot Value	38,511		
Indicated Value	238,983	99.08	Per SqFt
Agland Value			
Site Improvements	16,632		
Total Value	255,615	105.98	Total Value Per SqFt

Miscellaneous Improvements								
Code	Description	Sketch ID	Size	Year	Units	Unit Cost	Depr	Value
FPR1	FIREPLACE - RESIDENTIAL 1 STORY	0		1	1	5,615.40		5,615
PRCH	SLAB PORCH - COVERED	68234	38x6		228	26.21		5,976
PATO	SLAB PORCH - OPEN	68235	16x12		192	10.63		2,041



Rogers

Assessment Property Record Card for Tax Year 2026

Data provided by LISA DELOZIER County Assessor

Date 04/16/2026
 Time 22:52:07
 Page 3

Sketch Image

660028339

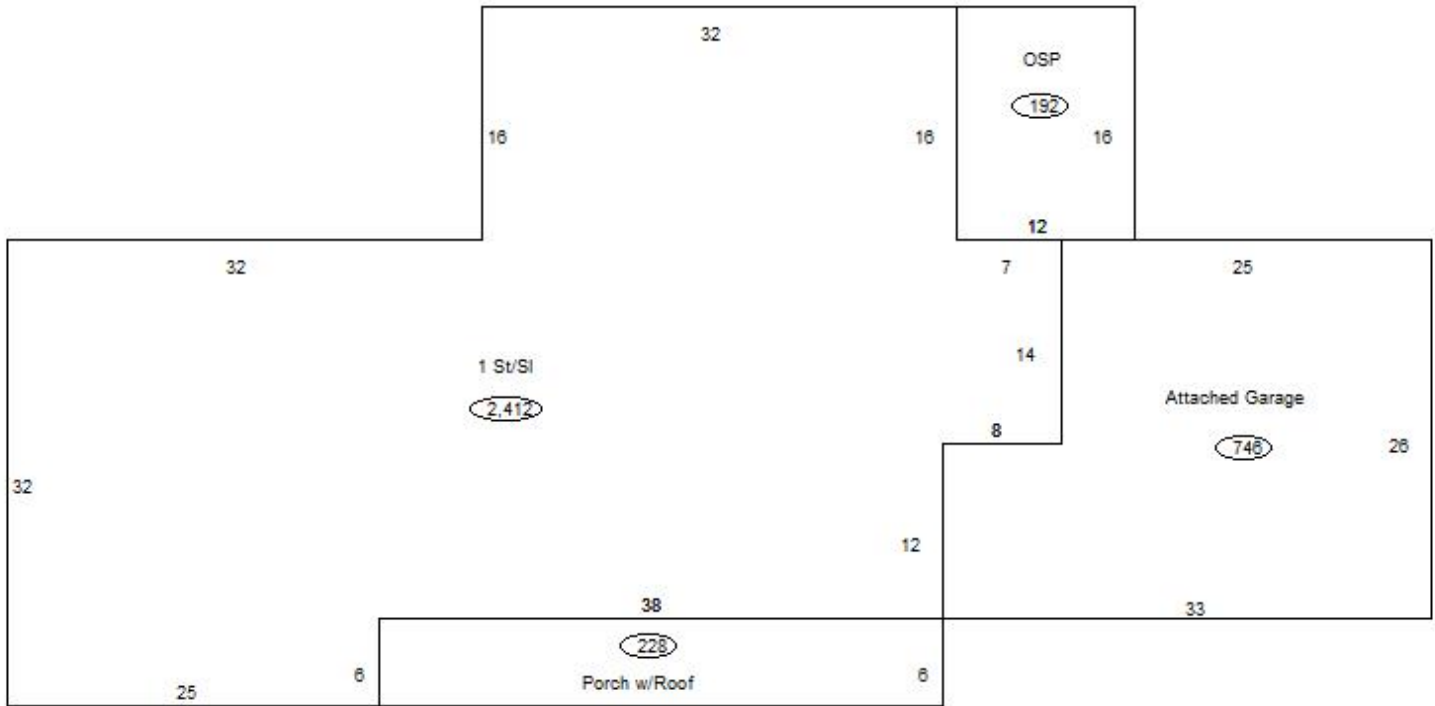

Sketch Vector Information

Sequence	Code	Type	Built Over	Scale	Section Label	Base Area	Multiplier	Total Area
1	R	1	Slab	13	1 St/SI	2,412	1.000	2,412
2	G	1		13	Attached Garage	746	1.000	746
3	M	PRCH		13	SLBC	228	1.000	228
4	M	PATO		13	Open Slab	192	1.000	192
Total Building Area						2,412		2,412



Rogers

Assessment Property Record Card for Tax Year 2026

Data provided by LISA DELOZIER County Assessor

Date 04/16/2026
Time 22:52:07
Page 4

660028339

Outbuildings/Site Improvements

Building Image	Code	Description	Dimensions	Floor	Roofing	Total Units
	DTGF	DETACHED GARAGE FAIR	0x0x0			1,386
	Qual 2	Cond 3	Year	Eff Age		
		Valuation Summary	Modifier Total	RCN	Depr (25% Phys/ % Func)	RCNLD
		Base Cost (16.00 x 1,386)	22,176	22,176	5,544	16,632