



Rogers

Assessment Property Record Card for Tax Year 2026

Data provided by LISA DELOZIER County Assessor

Date 04/18/2026
Time 07:16:45
Page 1

Assessment Data					Primary Image																																																																																																																				
Account 660028422 Parcel ID 000000-00-0-00555-002-0002 Cadastral ID 33-22-16-01200 Property Type REAL - Real Property Property Class RRP VI Area 1 Tax Area 10 - OOLOGAH RURAL/NW FIRE Name ID 321670 WEBB, ROBERT H & SHEENA 18051 OAKLAWN DR CLAREMORE OK 74017-0000 Parcel Location Situs 18051 S OAKLAWN DR Subdivision OAKLAWN PARK Lot/Block 0002 / 0002 Parcel Size 1 - Lots Sec/Twn/Rng 33 / 22 / 16 / 5 Neighborhood 1148 - R-V01-NW OOLOGAH School District S004 - OOLOGAH SCHOOLS																																																																																																																									
Legal Description Lot/Long: 36.34990834 -95.61133668																																																																																																																									
Building Permits					<table border="1"> <thead> <tr> <th>Number</th> <th>Description</th> <th>Opened</th> <th>Closed</th> <th>Amount</th> </tr> </thead> <tbody> <tr> <td> </td> <td> </td> <td> </td> <td> </td> <td> </td> </tr> </tbody> </table>					Number	Description	Opened	Closed	Amount																																																																																																											
Number	Description	Opened	Closed	Amount																																																																																																																					
Exemptions					Sale History																																																																																																																				
<table border="1"> <thead> <tr> <th>Code</th> <th>Type</th> <th>Active</th> <th>Maximum</th> <th>Exemption</th> </tr> </thead> <tbody> <tr> <td>H</td> <td>Homestead</td> <td>Yes</td> <td>1,000</td> <td>1,000</td> </tr> <tr> <td>H</td> <td>Homestead</td> <td>No</td> <td>1,000</td> <td> </td> </tr> </tbody> </table>					Code	Type	Active	Maximum	Exemption	H	Homestead	Yes	1,000	1,000	H	Homestead	No	1,000		<table border="1"> <thead> <tr> <th>Bk/Pg</th> <th>Grantor</th> <th>Date</th> <th>Price</th> <th>Code</th> </tr> </thead> <tbody> <tr> <td>2640/113</td> <td>LOCKE, ROBERT LEE &</td> <td>06/09/2017</td> <td>174,000</td> <td>YES</td> </tr> <tr> <td>2180/280</td> <td>NICOLLS, LYNDA J</td> <td>07/05/2011</td> <td>154,000</td> <td>YES</td> </tr> <tr> <td>2013/119</td> <td>NICOLLS, EMMA J ET AL</td> <td>02/24/2009</td> <td>0</td> <td>4</td> </tr> </tbody> </table>					Bk/Pg	Grantor	Date	Price	Code	2640/113	LOCKE, ROBERT LEE &	06/09/2017	174,000	YES	2180/280	NICOLLS, LYNDA J	07/05/2011	154,000	YES	2013/119	NICOLLS, EMMA J ET AL	02/24/2009	0	4																																																																													
Code	Type	Active	Maximum	Exemption																																																																																																																					
H	Homestead	Yes	1,000	1,000																																																																																																																					
H	Homestead	No	1,000																																																																																																																						
Bk/Pg	Grantor	Date	Price	Code																																																																																																																					
2640/113	LOCKE, ROBERT LEE &	06/09/2017	174,000	YES																																																																																																																					
2180/280	NICOLLS, LYNDA J	07/05/2011	154,000	YES																																																																																																																					
2013/119	NICOLLS, EMMA J ET AL	02/24/2009	0	4																																																																																																																					
Parcel Valuation																																																																																																																									
<table border="1"> <thead> <tr> <th>Source</th> <th>REAL</th> <th>Fair Cash</th> <th>Capped</th> <th>Asmnt Level</th> <th>Assessed</th> <th>Levy Rate</th> <th>108.182</th> <th>Current Tax</th> </tr> </thead> <tbody> <tr> <td>Remove Cap</td> <td>2018</td> <td>Land Value</td> <td>105,200</td> <td>40,690</td> <td>11%</td> <td>4,476</td> <td>Assessed</td> <td>21,076</td> </tr> <tr> <td>Year Frozen</td> <td>0</td> <td>Improvements</td> <td>151,490</td> <td>150,912</td> <td> </td> <td>16,600</td> <td>Penalty</td> <td>0</td> </tr> <tr> <td>Uncapped Value</td> <td>0</td> <td>Mobile Home</td> <td>0</td> <td>0</td> <td> </td> <td>0</td> <td>Exemption</td> <td>1,000</td> </tr> <tr> <td>TIF Project ID</td> <td>0</td> <td>Total Value</td> <td>256,690</td> <td>191,602</td> <td> </td> <td>21,076</td> <td>Total Taxable</td> <td>20,076</td> </tr> </tbody> </table>		Source	REAL	Fair Cash	Capped	Asmnt Level	Assessed	Levy Rate	108.182	Current Tax	Remove Cap	2018	Land Value	105,200	40,690	11%	4,476	Assessed	21,076	Year Frozen	0	Improvements	151,490	150,912		16,600	Penalty	0	Uncapped Value	0	Mobile Home	0	0		0	Exemption	1,000	TIF Project ID	0	Total Value	256,690	191,602		21,076	Total Taxable	20,076	<table border="1"> <thead> <tr> <th>Levy Rate</th> <th>108.182</th> <th>Current Tax</th> </tr> </thead> <tbody> <tr> <td>Assessed</td> <td>21,076</td> <td>2,280.03</td> </tr> <tr> <td>Penalty</td> <td>0</td> <td> </td> </tr> <tr> <td>Exemption</td> <td>1,000</td> <td>-94.00</td> </tr> <tr> <td>Total Taxable</td> <td>20,076</td> <td>2,186.00</td> </tr> </tbody> </table>		Levy Rate	108.182	Current Tax	Assessed	21,076	2,280.03	Penalty	0		Exemption	1,000	-94.00	Total Taxable	20,076	2,186.00																																																										
Source	REAL	Fair Cash	Capped	Asmnt Level	Assessed	Levy Rate	108.182	Current Tax																																																																																																																	
Remove Cap	2018	Land Value	105,200	40,690	11%	4,476	Assessed	21,076																																																																																																																	
Year Frozen	0	Improvements	151,490	150,912		16,600	Penalty	0																																																																																																																	
Uncapped Value	0	Mobile Home	0	0		0	Exemption	1,000																																																																																																																	
TIF Project ID	0	Total Value	256,690	191,602		21,076	Total Taxable	20,076																																																																																																																	
Levy Rate	108.182	Current Tax																																																																																																																							
Assessed	21,076	2,280.03																																																																																																																							
Penalty	0																																																																																																																								
Exemption	1,000	-94.00																																																																																																																							
Total Taxable	20,076	2,186.00																																																																																																																							
Assessment History																																																																																																																									
<table border="1"> <thead> <tr> <th>Tax Year</th> <th>Statement Number</th> <th>Billed Owner</th> <th>Tax Area</th> <th>Total Value</th> <th>Exemptions</th> <th>Taxable Value</th> <th>Billed Tax</th> </tr> </thead> <tbody> <tr><td>2025</td><td>2025-660028422</td><td>WEBB, ROBERT H & SHEENA</td><td>10</td><td>251,717</td><td>1000</td><td>19,463</td><td>2,120.00</td></tr> <tr><td>2024</td><td>2024-660028422</td><td>WEBB, ROBERT H & SHEENA</td><td>10</td><td>197,530</td><td>1000</td><td>18,867</td><td>1,990.00</td></tr> <tr><td>2023</td><td>2023-660028422</td><td>WEBB, ROBERT H & SHEENA</td><td>10</td><td>175,344</td><td>1000</td><td>18,288</td><td>1,916.00</td></tr> <tr><td>2022</td><td>2022-660028422</td><td>WEBB, ROBERT H & SHEENA</td><td>10</td><td>177,844</td><td>1000</td><td>18,563</td><td>1,936.00</td></tr> <tr><td>2021</td><td>2021-660028422</td><td>WEBB, ROBERT H & SHEENA</td><td>10</td><td>182,498</td><td>1000</td><td>19,075</td><td>2,002.00</td></tr> <tr><td>2020</td><td>2020-660028422</td><td>WEBB, ROBERT H & SHEENA</td><td>10</td><td>179,638</td><td>1000</td><td>18,577</td><td>1,979.00</td></tr> <tr><td>2019</td><td>2019-660028422</td><td>WEBB, ROBERT H & SHEENA</td><td>10</td><td>172,786</td><td>1000</td><td>18,006</td><td>1,883.00</td></tr> <tr><td>2018</td><td>2018-660028422</td><td>WEBB, ROBERT H & SHEENA</td><td>10</td><td>179,724</td><td>1000</td><td>18,770</td><td>2,030.00</td></tr> <tr><td>2017</td><td>2017-660028422</td><td>WEBB, ROBERT H & SHEENA</td><td>10</td><td>178,208</td><td>1000</td><td>18,552</td><td>2,123.00</td></tr> <tr><td>2016</td><td>2016-660028422</td><td>LOCKE, ROBERT LEE &</td><td>10</td><td>173,740</td><td>1000</td><td>17,983</td><td>1,876.00</td></tr> <tr><td>2015</td><td>2015-660028422</td><td>LOCKE, ROBERT LEE &</td><td>10</td><td>167,543</td><td>1000</td><td>17,430</td><td>1,721.00</td></tr> <tr><td>2014</td><td>2014-660028422</td><td>LOCKE, ROBERT LEE &</td><td>10</td><td>168,856</td><td>1000</td><td>17,095</td><td>1,684.00</td></tr> <tr><td>2013</td><td>2013-660028422</td><td>LOCKE, ROBERT LEE &</td><td>10</td><td>159,710</td><td>1000</td><td>16,568</td><td>1,579.00</td></tr> </tbody> </table>										Tax Year	Statement Number	Billed Owner	Tax Area	Total Value	Exemptions	Taxable Value	Billed Tax	2025	2025-660028422	WEBB, ROBERT H & SHEENA	10	251,717	1000	19,463	2,120.00	2024	2024-660028422	WEBB, ROBERT H & SHEENA	10	197,530	1000	18,867	1,990.00	2023	2023-660028422	WEBB, ROBERT H & SHEENA	10	175,344	1000	18,288	1,916.00	2022	2022-660028422	WEBB, ROBERT H & SHEENA	10	177,844	1000	18,563	1,936.00	2021	2021-660028422	WEBB, ROBERT H & SHEENA	10	182,498	1000	19,075	2,002.00	2020	2020-660028422	WEBB, ROBERT H & SHEENA	10	179,638	1000	18,577	1,979.00	2019	2019-660028422	WEBB, ROBERT H & SHEENA	10	172,786	1000	18,006	1,883.00	2018	2018-660028422	WEBB, ROBERT H & SHEENA	10	179,724	1000	18,770	2,030.00	2017	2017-660028422	WEBB, ROBERT H & SHEENA	10	178,208	1000	18,552	2,123.00	2016	2016-660028422	LOCKE, ROBERT LEE &	10	173,740	1000	17,983	1,876.00	2015	2015-660028422	LOCKE, ROBERT LEE &	10	167,543	1000	17,430	1,721.00	2014	2014-660028422	LOCKE, ROBERT LEE &	10	168,856	1000	17,095	1,684.00	2013	2013-660028422	LOCKE, ROBERT LEE &	10	159,710	1000	16,568	1,579.00
Tax Year	Statement Number	Billed Owner	Tax Area	Total Value	Exemptions	Taxable Value	Billed Tax																																																																																																																		
2025	2025-660028422	WEBB, ROBERT H & SHEENA	10	251,717	1000	19,463	2,120.00																																																																																																																		
2024	2024-660028422	WEBB, ROBERT H & SHEENA	10	197,530	1000	18,867	1,990.00																																																																																																																		
2023	2023-660028422	WEBB, ROBERT H & SHEENA	10	175,344	1000	18,288	1,916.00																																																																																																																		
2022	2022-660028422	WEBB, ROBERT H & SHEENA	10	177,844	1000	18,563	1,936.00																																																																																																																		
2021	2021-660028422	WEBB, ROBERT H & SHEENA	10	182,498	1000	19,075	2,002.00																																																																																																																		
2020	2020-660028422	WEBB, ROBERT H & SHEENA	10	179,638	1000	18,577	1,979.00																																																																																																																		
2019	2019-660028422	WEBB, ROBERT H & SHEENA	10	172,786	1000	18,006	1,883.00																																																																																																																		
2018	2018-660028422	WEBB, ROBERT H & SHEENA	10	179,724	1000	18,770	2,030.00																																																																																																																		
2017	2017-660028422	WEBB, ROBERT H & SHEENA	10	178,208	1000	18,552	2,123.00																																																																																																																		
2016	2016-660028422	LOCKE, ROBERT LEE &	10	173,740	1000	17,983	1,876.00																																																																																																																		
2015	2015-660028422	LOCKE, ROBERT LEE &	10	167,543	1000	17,430	1,721.00																																																																																																																		
2014	2014-660028422	LOCKE, ROBERT LEE &	10	168,856	1000	17,095	1,684.00																																																																																																																		
2013	2013-660028422	LOCKE, ROBERT LEE &	10	159,710	1000	16,568	1,579.00																																																																																																																		



Rogers

Assessment Property Record Card for Tax Year 2026

Data provided by LISA DELOZIER County Assessor

Date 04/18/2026
Time 07:16:45
Page 2

Lot Data		Square-Foot - NBHD 1148 #1	
Lot Size			
Lot Count			
Units Buildable	1		
Non-Ag Acres	2.9502		
Topography			
Street Access			
Utilities			
Amenities	LAND QUALITY	0	0
Method	Square-Foot		
Base Lot Value	128,509.00 x .82 = 105,200		
Factor Value			
Adjustments	1.0000		
Lot Value	105,200		



\\tsclient\T\TOMMY DUNLAP\VI Pictures\112122(3)\IMG_0013.JPG 11/22/2022

Residential Data	
Type	1 Single Family Residence
Condition	3 - Average
Quality	2.5 - Fair
Architecture	
Style	100% One Story
Exterior Wall	60% Veneer, Masonry 40% Frame, Siding, Wood
Base/Total Area	2,068 / 2,068
Style	100% One Story
HVAC	100% Warmed & Cooled Air
Roof Cover	1 Composition Shingle
Area on Slab	2,068
Fixture/RghIn	7 /
Bed/F/H Bath	4 / 1.5 /
Basement Area	
Garage Type	468 Attached Garage - Unfinished 2 Stalls
Remodel	
Year/Eff Age	1983 / 32

GRM Approach	
GRM Code	
Gross Rent	0.00
Indicated Value	

Multiple Regression			
MRA Code	1	Test	
Adusted R	0.8445		
Indicated Value	198,315	95.90	Per SqFt

Direct Comparables			
Selection Model	A	Adam Test	
Adjustment Model	1	2022 Residential	
Comparables	1		
Indicated Value	173,950		Per SqFt

Cost Approach				Manual : 01/2025			
Base Cost	96.81	Total Misc Impr	+	22,748			
Roofing Adj	+ 4.23	Garage Cost	+	13,048			
Subfloor Adj	+ -1.09	Total RCN	=	275,436			
Heat/Cool Adj	+ 11.47	Depreciation (45%)	-	123,946			
Plumbing Adj	+ 4.46	Lump Sums	+	0			
Basement Adj	+ 0.00	RCNLD	=	151,490			
Adj Base Cost	= 115.88	Lot Value	+	105,200			
Total Area	x 2,068	Indicated Value	=	256,690			
Adjusted Cost	= 239,640	Value Per SqFt		124.12			

Value Reconciliation			
Selected Approach	Cost Approach		
Improvements	151,490		
Lot Value	105,200		
Indicated Value	256,690	124.12	Per SqFt
Agland Value			
Site Improvements			
Total Value	256,690	124.12	Total Value Per SqFt

Miscellaneous Improvements								
Code	Description	Sketch ID	Size	Year	Units	Unit Cost	Depr	Value
FPR1	FIREPLACE - RESIDENTIAL 1 STORY	0		1	1	5,095.98		5,096
PRCH	SLAB PORCH - COVERED	68404	23x6		138	23.81		3,286
SUN	Sunroom	68405	18x11		198	20.00		3,960
CPDT	CARPORT - DETACHED	68406	22x17		374	10.74		4,017
EPKS	ENCLOSED PORCH - KNEEWALL SCREEN	68407	18x10		180	26.14		4,705
PRCH	SLAB PORCH - COVERED	68408	10x7		70	24.05		1,684
SHLT	STORM SHELTER			1	2020	1	0.00	



Sketch Image

660028422

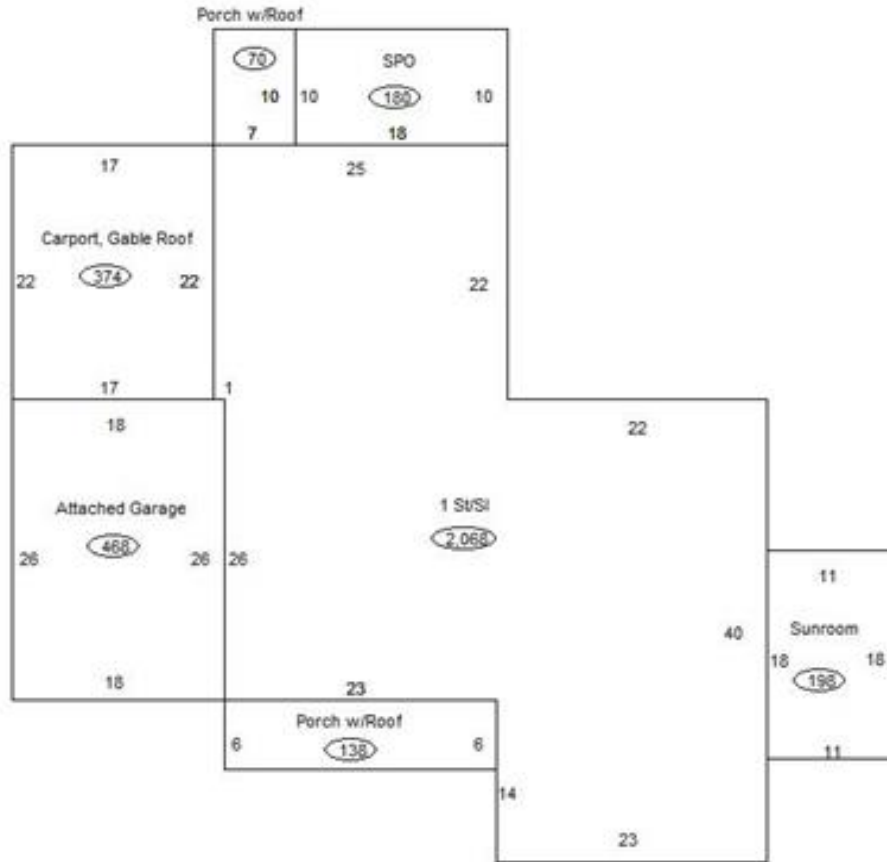

Sketch Vector Information

Sequence	Code	Type	Built Over	Scale	Section Label	Base Area	Multiplier	Total Area
1	R	1	Slab	13	1 St/Sl	2,068	1.000	2,068
2	G	1		13	Attached Garage	468	1.000	468
3	M	PRCH		13	SLBC	138	1.000	138
4	M	SUN		13	Sunroom	198	1.000	198
5	G	3		13	Carport, Gable Roof	374	1.000	374
6	M	EPKS		13	Screen Porch	180	1.000	180
7	M	PRCH		13	SLBC	70	1.000	70
Total Building Area						2,068		2,068



Rogers

Assessment Property Record Card for Tax Year 2026

Data provided by LISA DELOZIER County Assessor

Date 04/18/2026
Time 07:16:46
Page 4

660028422

Outbuildings/Site Improvements

Building Image	Code	Description	Dimensions	Floor	Roofing	Total Units
	STF STG FAIR		0x0x0			
	Qual 2	Cond	Year	Eff Age		

Valuation Summary	Modifier Total	RCN	Depr (0% Phys/ % Func)	RCNLD
Base Cost (4.68 x)				