



Rogers

Assessment Property Record Card for Tax Year 2026

Data provided by LISA DELOZIER County Assessor

Date 04/17/2026
Time 08:15:45
Page 1

Assessment Data					Primary Image																																																																																																																				
Account 660028670 Parcel ID 24N17E-33-3-00000-000-0000 Cadastral ID 33-24-17-01510 Property Type REAL - Real Property Property Class RA VI Area 2 Tax Area 14 - CHELSEA RURAL Name ID 305465 FRYE, JESSICA & CLIFFORD & ELIZABETH FRYE 6701 S 4210 RD UNIT B CHELSEA OK 74016-0000																																																																																																																									
Parcel Location Situs 06701 S 4210 RD Subdivision Lot/Block / Parcel Size 20 - Acres Sec/Twn/Rng 33 / 24 / 17 / 3 Neighborhood 4050 - CHELSEA FOYIL RURAL School District S003 - CHELSEA SCHOOLS																																																																																																																									
Legal Description Lat/Long: 36.51578335 -95.50399761 E2 NW SW					Building Permits <table border="1"> <thead> <tr> <th>Number</th> <th>Description</th> <th>Opened</th> <th>Closed</th> <th>Amount</th> </tr> </thead> <tbody> <tr> <td>R18</td> <td>R18-POSS HOUSE BURNED & NEW SF</td> <td>08/2017</td> <td>10/2017</td> <td></td> </tr> <tr> <td>R15</td> <td>R15-POSS NEW STRUCTURE</td> <td>03/2012</td> <td>10/2014</td> <td></td> </tr> </tbody> </table>					Number	Description	Opened	Closed	Amount	R18	R18-POSS HOUSE BURNED & NEW SF	08/2017	10/2017		R15	R15-POSS NEW STRUCTURE	03/2012	10/2014																																																																																																		
Number	Description	Opened	Closed	Amount																																																																																																																					
R18	R18-POSS HOUSE BURNED & NEW SF	08/2017	10/2017																																																																																																																						
R15	R15-POSS NEW STRUCTURE	03/2012	10/2014																																																																																																																						
Exemptions <table border="1"> <thead> <tr> <th>Code</th> <th>Type</th> <th>Active</th> <th>Maximum</th> <th>Exemption</th> </tr> </thead> <tbody> <tr> <td>H</td> <td>Homestead</td> <td>Yes</td> <td>1,000</td> <td>1,000</td> </tr> </tbody> </table>					Code	Type	Active	Maximum	Exemption	H	Homestead	Yes	1,000	1,000	Sale History <table border="1"> <thead> <tr> <th>Bk/Pg</th> <th>Grantor</th> <th>Date</th> <th>Price</th> <th>Code</th> </tr> </thead> <tbody> <tr> <td>2191/632</td> <td>LEACH, CHESTER L</td> <td>08/31/2011</td> <td>50,000</td> <td>YES</td> </tr> <tr> <td>1408/398</td> <td>FISHER, BOBBY C & PATSY R</td> <td>09/20/2002</td> <td>32,500</td> <td>YES</td> </tr> <tr> <td>1021/281</td> <td>SPICER, CARRIE</td> <td>03/25/1995</td> <td>15,000</td> <td>Yes</td> </tr> <tr> <td>871/808</td> <td>SELLER</td> <td>01/23/1992</td> <td>8,500</td> <td>No</td> </tr> </tbody> </table>					Bk/Pg	Grantor	Date	Price	Code	2191/632	LEACH, CHESTER L	08/31/2011	50,000	YES	1408/398	FISHER, BOBBY C & PATSY R	09/20/2002	32,500	YES	1021/281	SPICER, CARRIE	03/25/1995	15,000	Yes	871/808	SELLER	01/23/1992	8,500	No																																																																													
Code	Type	Active	Maximum	Exemption																																																																																																																					
H	Homestead	Yes	1,000	1,000																																																																																																																					
Bk/Pg	Grantor	Date	Price	Code																																																																																																																					
2191/632	LEACH, CHESTER L	08/31/2011	50,000	YES																																																																																																																					
1408/398	FISHER, BOBBY C & PATSY R	09/20/2002	32,500	YES																																																																																																																					
1021/281	SPICER, CARRIE	03/25/1995	15,000	Yes																																																																																																																					
871/808	SELLER	01/23/1992	8,500	No																																																																																																																					
Parcel Valuation <table border="1"> <thead> <tr> <th>Source</th> <th>REAL</th> <th>Fair Cash</th> <th>Capped</th> <th>Asmnt Level</th> <th>Assessed</th> <th>Levy Rate</th> <th>82.750</th> <th>Current Tax</th> </tr> </thead> <tbody> <tr> <td>Remove Cap</td> <td>0</td> <td>Land Value 1,206</td> <td>1,206</td> <td>11%</td> <td>133</td> <td>Assessed</td> <td>8,294</td> <td>686.33</td> </tr> <tr> <td>Year Frozen</td> <td>0</td> <td>Improvements 109,511</td> <td>74,193</td> <td></td> <td>8,161</td> <td>Penalty</td> <td>0</td> <td></td> </tr> <tr> <td>Uncapped Value</td> <td>0</td> <td>Mobile Home 0</td> <td>0</td> <td></td> <td>0</td> <td>Exemption</td> <td>1,000</td> <td>-82.00</td> </tr> <tr> <td>TIF Project ID</td> <td>0</td> <td>Total Value 110,717</td> <td>75,399</td> <td></td> <td>8,294</td> <td>Total Taxable</td> <td>7,294</td> <td>604.00</td> </tr> </tbody> </table>										Source	REAL	Fair Cash	Capped	Asmnt Level	Assessed	Levy Rate	82.750	Current Tax	Remove Cap	0	Land Value 1,206	1,206	11%	133	Assessed	8,294	686.33	Year Frozen	0	Improvements 109,511	74,193		8,161	Penalty	0		Uncapped Value	0	Mobile Home 0	0		0	Exemption	1,000	-82.00	TIF Project ID	0	Total Value 110,717	75,399		8,294	Total Taxable	7,294	604.00																																																																			
Source	REAL	Fair Cash	Capped	Asmnt Level	Assessed	Levy Rate	82.750	Current Tax																																																																																																																	
Remove Cap	0	Land Value 1,206	1,206	11%	133	Assessed	8,294	686.33																																																																																																																	
Year Frozen	0	Improvements 109,511	74,193		8,161	Penalty	0																																																																																																																		
Uncapped Value	0	Mobile Home 0	0		0	Exemption	1,000	-82.00																																																																																																																	
TIF Project ID	0	Total Value 110,717	75,399		8,294	Total Taxable	7,294	604.00																																																																																																																	
Assessment History <table border="1"> <thead> <tr> <th>Tax Year</th> <th>Statement Number</th> <th>Billed Owner</th> <th>Tax Area</th> <th>Total Value</th> <th>Exemptions</th> <th>Taxable Value</th> <th>Billed Tax</th> </tr> </thead> <tbody> <tr><td>2025</td><td>2025-660028670</td><td>FRYE, JESSICA &</td><td>14</td><td>108,751</td><td>1000</td><td>7,052</td><td>584.00</td></tr> <tr><td>2024</td><td>2024-660028670</td><td>FRYE, JESSICA &</td><td>14</td><td>80,509</td><td>1000</td><td>6,819</td><td>576.00</td></tr> <tr><td>2023</td><td>2023-660028670</td><td>FRYE, JESSICA &</td><td>14</td><td>69,001</td><td>1000</td><td>6,590</td><td>562.00</td></tr> <tr><td>2022</td><td>2022-660028670</td><td>FRYE, JESSICA &</td><td>14</td><td>72,642</td><td>1000</td><td>6,717</td><td>568.00</td></tr> <tr><td>2021</td><td>2021-660028670</td><td>FRYE, JESSICA &</td><td>14</td><td>68,146</td><td>1000</td><td>6,492</td><td>550.00</td></tr> <tr><td>2020</td><td>2020-660028670</td><td>FRYE, JESSICA &</td><td>14</td><td>66,124</td><td>1000</td><td>6,274</td><td>532.00</td></tr> <tr><td>2019</td><td>2019-660028670</td><td>FRYE, JESSICA &</td><td>14</td><td>64,342</td><td>1000</td><td>6,078</td><td>522.00</td></tr> <tr><td>2018</td><td>2018-660028670</td><td>FRYE, JESSICA &</td><td>14</td><td>67,988</td><td>1000</td><td>6,479</td><td>553.00</td></tr> <tr><td>2017</td><td>2017-660028670</td><td>FRYE, JESSICA &</td><td>14</td><td>67,339</td><td>1000</td><td>6,396</td><td>548.00</td></tr> <tr><td>2016</td><td>2016-660028670</td><td>FRYE, JESSICA &</td><td>14</td><td>65,271</td><td>1000</td><td>6,180</td><td>539.00</td></tr> <tr><td>2015</td><td>2015-660028670</td><td>FRYE, JESSICA &</td><td>14</td><td>63,567</td><td>1000</td><td>5,978</td><td>515.00</td></tr> <tr><td>2014</td><td>2014-660028670</td><td>FRYE, JESSICA &</td><td>14</td><td>63,514</td><td>1000</td><td>5,775</td><td>514.00</td></tr> <tr><td>2013</td><td>2013-660028670</td><td>FRYE, JESSICA &</td><td>14</td><td>59,797</td><td>1000</td><td>5,578</td><td>495.00</td></tr> </tbody> </table>										Tax Year	Statement Number	Billed Owner	Tax Area	Total Value	Exemptions	Taxable Value	Billed Tax	2025	2025-660028670	FRYE, JESSICA &	14	108,751	1000	7,052	584.00	2024	2024-660028670	FRYE, JESSICA &	14	80,509	1000	6,819	576.00	2023	2023-660028670	FRYE, JESSICA &	14	69,001	1000	6,590	562.00	2022	2022-660028670	FRYE, JESSICA &	14	72,642	1000	6,717	568.00	2021	2021-660028670	FRYE, JESSICA &	14	68,146	1000	6,492	550.00	2020	2020-660028670	FRYE, JESSICA &	14	66,124	1000	6,274	532.00	2019	2019-660028670	FRYE, JESSICA &	14	64,342	1000	6,078	522.00	2018	2018-660028670	FRYE, JESSICA &	14	67,988	1000	6,479	553.00	2017	2017-660028670	FRYE, JESSICA &	14	67,339	1000	6,396	548.00	2016	2016-660028670	FRYE, JESSICA &	14	65,271	1000	6,180	539.00	2015	2015-660028670	FRYE, JESSICA &	14	63,567	1000	5,978	515.00	2014	2014-660028670	FRYE, JESSICA &	14	63,514	1000	5,775	514.00	2013	2013-660028670	FRYE, JESSICA &	14	59,797	1000	5,578	495.00
Tax Year	Statement Number	Billed Owner	Tax Area	Total Value	Exemptions	Taxable Value	Billed Tax																																																																																																																		
2025	2025-660028670	FRYE, JESSICA &	14	108,751	1000	7,052	584.00																																																																																																																		
2024	2024-660028670	FRYE, JESSICA &	14	80,509	1000	6,819	576.00																																																																																																																		
2023	2023-660028670	FRYE, JESSICA &	14	69,001	1000	6,590	562.00																																																																																																																		
2022	2022-660028670	FRYE, JESSICA &	14	72,642	1000	6,717	568.00																																																																																																																		
2021	2021-660028670	FRYE, JESSICA &	14	68,146	1000	6,492	550.00																																																																																																																		
2020	2020-660028670	FRYE, JESSICA &	14	66,124	1000	6,274	532.00																																																																																																																		
2019	2019-660028670	FRYE, JESSICA &	14	64,342	1000	6,078	522.00																																																																																																																		
2018	2018-660028670	FRYE, JESSICA &	14	67,988	1000	6,479	553.00																																																																																																																		
2017	2017-660028670	FRYE, JESSICA &	14	67,339	1000	6,396	548.00																																																																																																																		
2016	2016-660028670	FRYE, JESSICA &	14	65,271	1000	6,180	539.00																																																																																																																		
2015	2015-660028670	FRYE, JESSICA &	14	63,567	1000	5,978	515.00																																																																																																																		
2014	2014-660028670	FRYE, JESSICA &	14	63,514	1000	5,775	514.00																																																																																																																		
2013	2013-660028670	FRYE, JESSICA &	14	59,797	1000	5,578	495.00																																																																																																																		



Rogers

Assessment Property Record Card for Tax Year 2026

Data provided by LISA DELOZIER County Assessor

Date 04/17/2026
 Time 08:15:46
 Page 2

Lot Data	
Lot Size	
Lot Count	
Units Buildable	
Non-Ag Acres	0
Topography	
Street Access	
Utilities	
Amenities	LAND QUALITY
Method	Units-Buildable
Base Lot Value	
Factor Value	
Adjustments	
Lot Value	

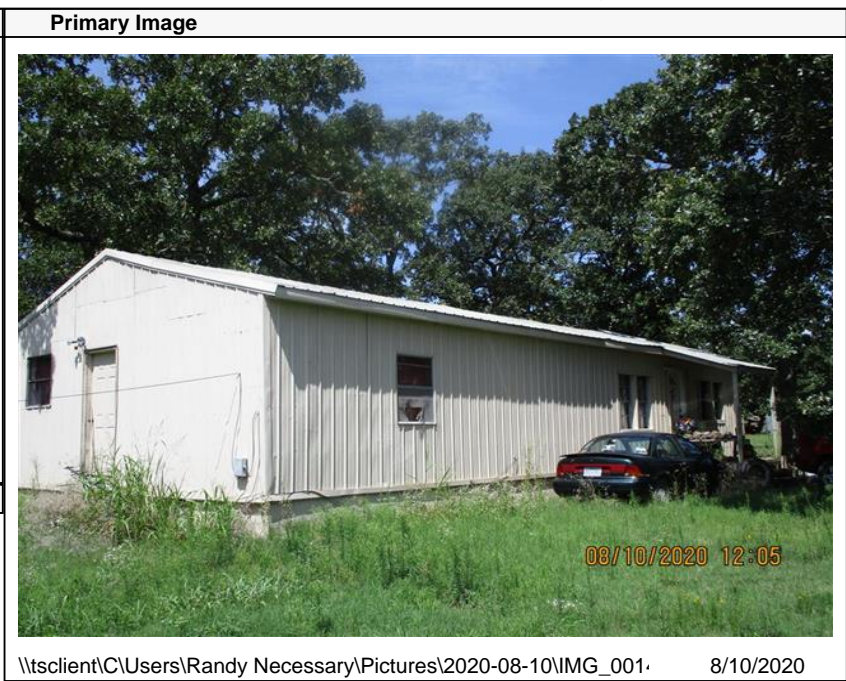

Residential Data	
Type	1 Single Family Residence
Condition	2 - Fair
Quality	2.5 - Fair
Architecture	MTL METAL HOME
Style	100% One Story
Exterior Wall	100% Frame, Siding, Metal
Base/Total Area	1,352 / 1,352
Style	100% One Story
HVAC	
Roof Cover	4 Metal, Preformed
Area on Slab	0
Fixture/RghIn	1 /
Bed/F/H Bath	1 / 1.0 /
Basement Area	
Garage Type	
Remodel	
Year/Eff Age	2006 / 20

GRM Approach	
GRM Code	
Gross Rent	0.00
Indicated Value	

Multiple Regression	
MRA Code	
Adjusted R	
Indicated Value	

Direct Comparables	
Selection Model	1 Res
Adjustment Model	A2 AO Test
Comparables	
Indicated Value	

Cost Approach		Manual : 01/2025	
Base Cost	91.99	Total Misc Impr	+ 0
Roofing Adj	+ 4.99	Garage Cost	+ 0
Subfloor Adj	+ 1.13	Total RCN	= 134,538
Heat/Cool Adj	+ 0.00	Depreciation (25%)	- 33,635
Plumbing Adj	+ 1.40	Lump Sums	+ 0
Basement Adj	+ 0.00	RCNLD	= 100,903
Adj Base Cost	= 99.51	Lot Value	+ 0
Total Area	x 1,352	Indicated Value	= 100,903
Adjusted Cost	= 134,538	Value Per SqFt	74.63

Value Reconciliation	
Selected Approach	Cost Approach
Improvements	100,903
Lot Value	
Indicated Value	100,903 74.63 Per SqFt
Agland Value	1,206
Site Improvements	8,608
Total Value	110,717 81.89 Total Value Per SqFt

Miscellaneous Improvements							
Code	Description	Sketch ID	Size	Year	Units	Unit Cost	Depr Value



Rogers

Assessment Property Record Card for Tax Year 2026

Data provided by LISA DELOZIER County Assessor

Date 04/17/2026
Time 08:15:46
Page 3

Sketch Image

660028670

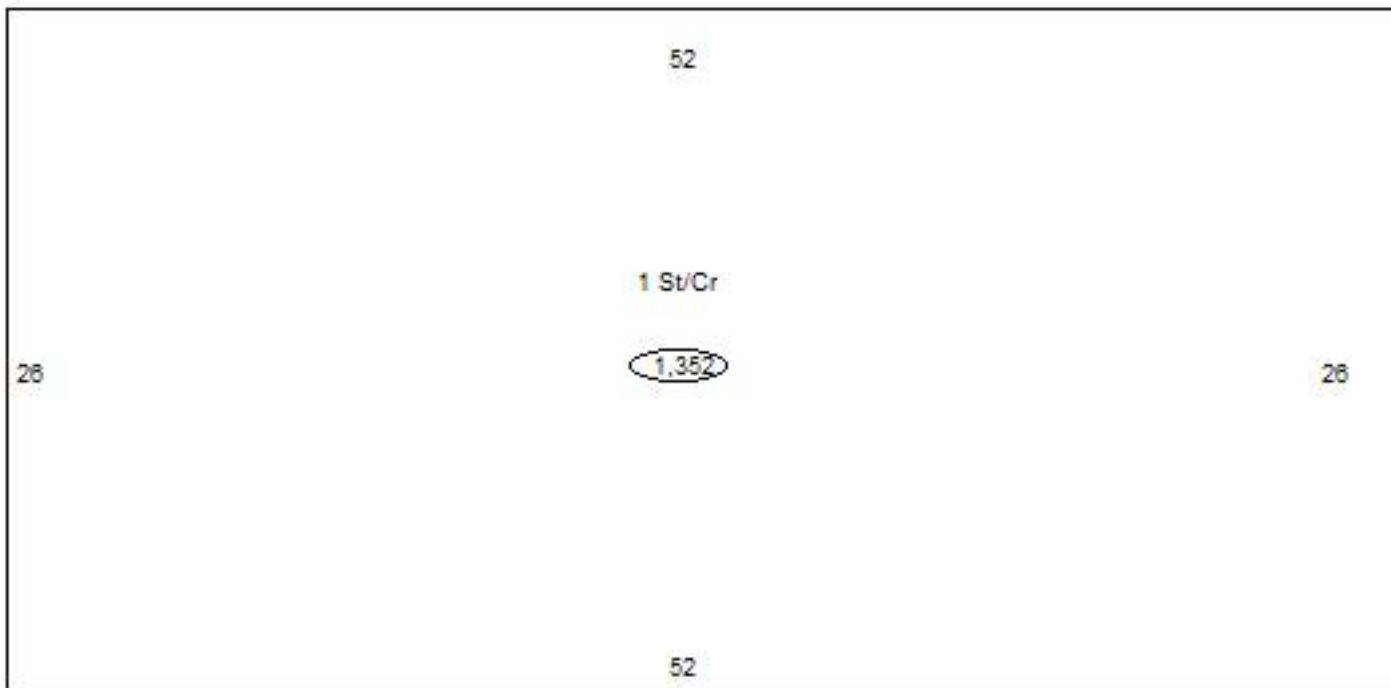

Sketch Vector Information

Sequence	Code	Type	Built Over	Scale	Section Label	Base Area	Multiplier	Total Area
1	R	1	Crawl	10	1 St/Cr	1,352	1.000	1,352
Total Building Area						1,352		1,352



Rogers

Assessment Property Record Card for Tax Year 2026

Data provided by LISA DELOZIER County Assessor

Date 04/17/2026
 Time 08:15:46
 Page 4

660028670

Outbuildings/Site Improvements

Building Image	Code	Description	Dimensions	Floor	Roofing	Total Units
	SHDS	Shed - Small	0x0x0	Base		
	Qual	3	Cond	Year	Eff Age	
	Valuation Summary		Modifier Total	RCN	Depr (100% Phys/ % Func)	RCNLD
	Base Cost (39.31 x)					
	CP	CARPORT DIRT	0x0x0			
	Qual		Cond	Year	Eff Age	
	Valuation Summary		Modifier Total	RCN	Depr (100% Phys/ % Func)	RCNLD
	Base Cost (3.50 x)					
	SHDS	Shed - Small	10x20x0	Base		200
	Qual	3	Cond 3	Year	Eff Age 1520	
	Valuation Summary		Modifier Total	RCN	Depr (80% Phys/ % Func)	RCNLD
	Base Cost (23.19 x 200)	4,638		4,638	3,710	928
	PFS	PORTABLE FRAME STRUCTURE	16x16x0			256
	Qual	2	Cond 2	Year	Eff Age 2026	
	Valuation Summary		Modifier Total	RCN	Depr (0% Phys/ % Func)	RCNLD
	Base Cost (30.00 x 256)	7,680		7,680		7,680
	SHDS	Shed - Small	0x0x0	Base		
	Qual	3	Cond	Year	Eff Age	
	Valuation Summary		Modifier Total	RCN	Depr (100% Phys/ % Func)	RCNLD
	Base Cost (39.31 x)					



Rogers

Assessment Property Record Card for Tax Year 2026

Data provided by LISA DELOZIER County Assessor

Date 04/17/2026
Time 08:15:46
Page 5

Agland Inventory

660028670

Soi	Description	Land Use	LPI	Adj Type	Adj Code	Acres	Use/Acre	Mkt/Acre	Use Value	Market Value
HC	HECTOR STONY SANDY LOAM	TMBR	20			10.000	36	36	360	360
VF	VERDIGRIS SOILS FREQUENTL	TMBR	47			10.000	85	85	846	846
TMBR Totals						20.000			1,206	1,206
Total Agland						20.000			1,206	1,206