



# Rogers

## Assessment Property Record Card for Tax Year 2026

Data provided by LISA DELOZIER County Assessor

Date 04/16/2026  
Time 22:50:57  
Page 1

Assessment Data					Primary Image																																																																																																																				
<b>Account</b> 660028768 <b>Parcel ID</b> 000000-00-0-00609-004-0006 <b>Cadastral ID</b> 34-20-14-02030 <b>Property Type</b> REAL - Real Property <b>Property Class</b> URP VI Area 3 <b>Tax Area</b> 1 - CATOOSA OT <b>Name ID</b> 319376 CHIDESTER, JACK L & PAMELA TRUSTEES ROSIE GENEVIEVE SMALL REVOC TR 14712 E LATIMER ST TULSA OK 74116-0000					<p>660028768_001.JPG 9/29/2025</p>																																																																																																																				
<b>Parcel Location</b> <b>Situs</b> 14712 E LATIMER ST <b>Subdivision</b> PONDEROSA ESTATES <b>Lot/Block</b> 0006 / 0004 <b>Parcel Size</b> 1 - Lots <b>Sec/Twn/Rng</b> 34 / 20 / 14 / 5 <b>Neighborhood</b> 1045 - R-V03-SW CATOOSA <b>School District</b> S002 - CATOOSA SCHOOLS																																																																																																																									
<b>Legal Description</b> Lot/Long: 36.17030490 -95.81182297					<b>Building Permits</b> <table border="1"> <thead> <tr> <th>Number</th> <th>Description</th> <th>Opened</th> <th>Closed</th> <th>Amount</th> </tr> </thead> <tbody> <tr> <td> </td> <td> </td> <td> </td> <td> </td> <td> </td> </tr> </tbody> </table>					Number	Description	Opened	Closed	Amount																																																																																																											
Number	Description	Opened	Closed	Amount																																																																																																																					
<b>Exemptions</b> <table border="1"> <thead> <tr> <th>Code</th> <th>Type</th> <th>Active</th> <th>Maximum</th> <th>Exemption</th> </tr> </thead> <tbody> <tr> <td>H</td> <td>Homestead</td> <td>Yes</td> <td>1,000</td> <td>1,000</td> </tr> </tbody> </table>					Code	Type	Active	Maximum	Exemption	H	Homestead	Yes	1,000	1,000	<b>Sale History</b> <table border="1"> <thead> <tr> <th>Bk/Pg</th> <th>Grantor</th> <th>Date</th> <th>Price</th> <th>Code</th> </tr> </thead> <tbody> <tr> <td>2577/921</td> <td>SMALL, GENEVIEVE</td> <td>08/11/2016</td> <td>0</td> <td>4</td> </tr> <tr> <td>2577/917</td> <td>SMALL, ROBERT D</td> <td>08/11/2016</td> <td>0</td> <td>4</td> </tr> </tbody> </table>					Bk/Pg	Grantor	Date	Price	Code	2577/921	SMALL, GENEVIEVE	08/11/2016	0	4	2577/917	SMALL, ROBERT D	08/11/2016	0	4																																																																																							
Code	Type	Active	Maximum	Exemption																																																																																																																					
H	Homestead	Yes	1,000	1,000																																																																																																																					
Bk/Pg	Grantor	Date	Price	Code																																																																																																																					
2577/921	SMALL, GENEVIEVE	08/11/2016	0	4																																																																																																																					
2577/917	SMALL, ROBERT D	08/11/2016	0	4																																																																																																																					
<b>Parcel Valuation</b> <table border="1"> <thead> <tr> <th>Source</th> <th>REAL</th> <th>Fair Cash</th> <th>Capped</th> <th>Asmnt Level</th> <th>Assessed</th> <th>Levy Rate</th> <th>106.660</th> <th>Current Tax</th> </tr> </thead> <tbody> <tr> <td>Remove Cap</td> <td>0</td> <td>Land Value 63,837</td> <td>13,423</td> <td>11%</td> <td>1,477</td> <td>Assessed</td> <td>10,280</td> <td>1,096.46</td> </tr> <tr> <td>Year Frozen</td> <td>0</td> <td>Improvements 129,831</td> <td>80,035</td> <td></td> <td>8,803</td> <td>Penalty</td> <td>0</td> <td></td> </tr> <tr> <td>Uncapped Value</td> <td>0</td> <td>Mobile Home 0</td> <td>0</td> <td></td> <td>0</td> <td>Exemption</td> <td>1,000</td> <td>-106.00</td> </tr> <tr> <td>TIF Project ID</td> <td>0</td> <td>Total Value 193,668</td> <td>93,458</td> <td></td> <td>10,280</td> <td>Total Taxable</td> <td>9,280</td> <td>990.00</td> </tr> </tbody> </table>										Source	REAL	Fair Cash	Capped	Asmnt Level	Assessed	Levy Rate	106.660	Current Tax	Remove Cap	0	Land Value 63,837	13,423	11%	1,477	Assessed	10,280	1,096.46	Year Frozen	0	Improvements 129,831	80,035		8,803	Penalty	0		Uncapped Value	0	Mobile Home 0	0		0	Exemption	1,000	-106.00	TIF Project ID	0	Total Value 193,668	93,458		10,280	Total Taxable	9,280	990.00																																																																			
Source	REAL	Fair Cash	Capped	Asmnt Level	Assessed	Levy Rate	106.660	Current Tax																																																																																																																	
Remove Cap	0	Land Value 63,837	13,423	11%	1,477	Assessed	10,280	1,096.46																																																																																																																	
Year Frozen	0	Improvements 129,831	80,035		8,803	Penalty	0																																																																																																																		
Uncapped Value	0	Mobile Home 0	0		0	Exemption	1,000	-106.00																																																																																																																	
TIF Project ID	0	Total Value 193,668	93,458		10,280	Total Taxable	9,280	990.00																																																																																																																	
<b>Assessment History</b> <table border="1"> <thead> <tr> <th>Tax Year</th> <th>Statement Number</th> <th>Billed Owner</th> <th>Tax Area</th> <th>Total Value</th> <th>Exemptions</th> <th>Taxable Value</th> <th>Billed Tax</th> </tr> </thead> <tbody> <tr><td>2025</td><td>2025-660028768</td><td>CHIDESTER, JACK L &amp; PAMELA</td><td>1</td><td>186,067</td><td>1000</td><td>8,981</td><td>958.00</td></tr> <tr><td>2024</td><td>2024-660028768</td><td>CHIDESTER, JACK L &amp; PAMELA</td><td>1</td><td>193,094</td><td>1000</td><td>8,691</td><td>917.00</td></tr> <tr><td>2023</td><td>2023-660028768</td><td>CHIDESTER, JACK L &amp; PAMELA</td><td>1</td><td>134,548</td><td>1000</td><td>8,408</td><td>863.00</td></tr> <tr><td>2022</td><td>2022-660028768</td><td>CHIDESTER, JACK L &amp; PAMELA</td><td>1</td><td>129,954</td><td>1000</td><td>8,134</td><td>816.00</td></tr> <tr><td>2021</td><td>2021-660028768</td><td>CHIDESTER, JACK L &amp; PAMELA</td><td>1</td><td>126,064</td><td>1000</td><td>7,868</td><td>692.00</td></tr> <tr><td>2020</td><td>2020-660028768</td><td>CHIDESTER, JACK L &amp; PAMELA</td><td>1</td><td>117,578</td><td>1000</td><td>7,610</td><td>674.00</td></tr> <tr><td>2019</td><td>2019-660028768</td><td>CHIDESTER, JACK L &amp; PAMELA</td><td>1</td><td>112,056</td><td>1000</td><td>7,359</td><td>661.00</td></tr> <tr><td>2018</td><td>2018-660028768</td><td>CHIDESTER, JACK L &amp; PAMELA</td><td>1</td><td>116,733</td><td>1000</td><td>7,116</td><td>635.00</td></tr> <tr><td>2017</td><td>2017-660028768</td><td>CHIDESTER, JACK L &amp; PAMELA</td><td>20</td><td>115,780</td><td>1000</td><td>6,879</td><td>621.00</td></tr> <tr><td>2016</td><td>2016-660028768</td><td>CHIDESTER, JACK L &amp; PAMELA</td><td>20</td><td>113,017</td><td>1000</td><td>6,650</td><td>591.00</td></tr> <tr><td>2015</td><td>2015-660028768</td><td>SMALL, ROBERT D</td><td>20</td><td>112,115</td><td>1000</td><td>6,427</td><td>574.00</td></tr> <tr><td>2014</td><td>2014-660028768</td><td>SMALL, ROBERT D</td><td>20</td><td>109,259</td><td>1000</td><td>6,211</td><td>562.00</td></tr> <tr><td>2013</td><td>2013-660028768</td><td>SMALL, ROBERT D</td><td>20</td><td>104,624</td><td>1000</td><td>6,001</td><td>537.00</td></tr> </tbody> </table>										Tax Year	Statement Number	Billed Owner	Tax Area	Total Value	Exemptions	Taxable Value	Billed Tax	2025	2025-660028768	CHIDESTER, JACK L & PAMELA	1	186,067	1000	8,981	958.00	2024	2024-660028768	CHIDESTER, JACK L & PAMELA	1	193,094	1000	8,691	917.00	2023	2023-660028768	CHIDESTER, JACK L & PAMELA	1	134,548	1000	8,408	863.00	2022	2022-660028768	CHIDESTER, JACK L & PAMELA	1	129,954	1000	8,134	816.00	2021	2021-660028768	CHIDESTER, JACK L & PAMELA	1	126,064	1000	7,868	692.00	2020	2020-660028768	CHIDESTER, JACK L & PAMELA	1	117,578	1000	7,610	674.00	2019	2019-660028768	CHIDESTER, JACK L & PAMELA	1	112,056	1000	7,359	661.00	2018	2018-660028768	CHIDESTER, JACK L & PAMELA	1	116,733	1000	7,116	635.00	2017	2017-660028768	CHIDESTER, JACK L & PAMELA	20	115,780	1000	6,879	621.00	2016	2016-660028768	CHIDESTER, JACK L & PAMELA	20	113,017	1000	6,650	591.00	2015	2015-660028768	SMALL, ROBERT D	20	112,115	1000	6,427	574.00	2014	2014-660028768	SMALL, ROBERT D	20	109,259	1000	6,211	562.00	2013	2013-660028768	SMALL, ROBERT D	20	104,624	1000	6,001	537.00
Tax Year	Statement Number	Billed Owner	Tax Area	Total Value	Exemptions	Taxable Value	Billed Tax																																																																																																																		
2025	2025-660028768	CHIDESTER, JACK L & PAMELA	1	186,067	1000	8,981	958.00																																																																																																																		
2024	2024-660028768	CHIDESTER, JACK L & PAMELA	1	193,094	1000	8,691	917.00																																																																																																																		
2023	2023-660028768	CHIDESTER, JACK L & PAMELA	1	134,548	1000	8,408	863.00																																																																																																																		
2022	2022-660028768	CHIDESTER, JACK L & PAMELA	1	129,954	1000	8,134	816.00																																																																																																																		
2021	2021-660028768	CHIDESTER, JACK L & PAMELA	1	126,064	1000	7,868	692.00																																																																																																																		
2020	2020-660028768	CHIDESTER, JACK L & PAMELA	1	117,578	1000	7,610	674.00																																																																																																																		
2019	2019-660028768	CHIDESTER, JACK L & PAMELA	1	112,056	1000	7,359	661.00																																																																																																																		
2018	2018-660028768	CHIDESTER, JACK L & PAMELA	1	116,733	1000	7,116	635.00																																																																																																																		
2017	2017-660028768	CHIDESTER, JACK L & PAMELA	20	115,780	1000	6,879	621.00																																																																																																																		
2016	2016-660028768	CHIDESTER, JACK L & PAMELA	20	113,017	1000	6,650	591.00																																																																																																																		
2015	2015-660028768	SMALL, ROBERT D	20	112,115	1000	6,427	574.00																																																																																																																		
2014	2014-660028768	SMALL, ROBERT D	20	109,259	1000	6,211	562.00																																																																																																																		
2013	2013-660028768	SMALL, ROBERT D	20	104,624	1000	6,001	537.00																																																																																																																		



# Rogers

## Assessment Property Record Card for Tax Year 2026

Data provided by LISA DELOZIER County Assessor

Date 04/16/2026  
 Time 22:50:57  
 Page 2

Lot Data	Square-Foot - NBHD 1045 #1	Primary Image
Lot Size		
Lot Count		
Units Buildable	1	
Non-Ag Acres	0.5982	
Topography		
Street Access		
Utilities		
Amenities	LAND QUALITY	
	0	
	0	
Method	Square-Foot	
Base Lot Value	26,056.00 x 2.45 = 63,837	
Factor Value		
Adjustments	1.0000	
Lot Value	63,837	

Residential Data	
Type	1 Single Family Residence
Condition	3 - Average
Quality	2.5 - Fair
Architecture	TRAD TRADITIONAL
Style	100% One Story
Exterior Wall	80% Veneer, Masonry 20% Frame, Siding, Vinyl
Base/Total Area	1,352 / 1,352
Style	100% One Story
HVAC	100% Warmed & Cooled Air
Roof Cover	1 Composition Shingle
Area on Slab	1,352
Fixture/RghIn	11 /
Bed/F/H Bath	3 / 2.0 /
Basement Area	
Garage Type	480 Attached Garage - Finished 2 Stalls
Remodel	
Year/Eff Age	1976 / 38



660028768\_001.JPG 9/29/2025

GRM Approach	
GRM Code	
Gross Rent	0.00
Indicated Value	

Multiple Regression			
MRA Code	1	Test	
Adusted R	0.8445		
Indicated Value	170,908	126.41	Per SqFt

Direct Comparables	
Selection Model	A Adam Test
Adjustment Model	1 2022 Residential
Comparables	8
Indicated Value	180,150 Per SqFt

Cost Approach				Manual : 01/2025	
Base Cost	107,54	Total Misc Impr	+	7,112	
Roofing Adj	+ 4.63	Garage Cost	+	16,646	
Subfloor Adj	+ -1.22	Total RCN	=	203,344	
Heat/Cool Adj	+ 11.47	Depreciation ( 47%)	-	95,572	
Plumbing Adj	+ 10.41	Lump Sums	+	0	
Basement Adj	+ 0.00	RCNLD	=	107,772	
Adj Base Cost	= 132.83	Lot Value	+	63,837	
Total Area	x 1,352	Indicated Value	=	171,609	
Adjusted Cost	= 179,586	Value Per SqFt		126.93	

Value Reconciliation			
Selected Approach	Cost Approach		
Improvements	107,772		
Lot Value	63,837		
Indicated Value	171,609	126.93	Per SqFt
Agland Value			
Site Improvements	22,059		
Total Value	193,668	143.25	Total Value Per SqFt

Miscellaneous Improvements								
Code	Description	Sketch ID	Size	Year	Units	Unit Cost	Depr	Value
FPR1	FIREPLACE - RESIDENTIAL 1 STORY	0		1	1	5,095.98		5,096
SHLT	STORM SHELTER	0		1	2017	0.00		
PRCH	SLAB PORCH - COVERED	69132	14x6		84	24.00		2,016



# Rogers

## Assessment Property Record Card for Tax Year 2026

Data provided by LISA DELOZIER County Assessor

Date 04/16/2026  
 Time 22:50:57  
 Page 3

Sketch Image

660028768

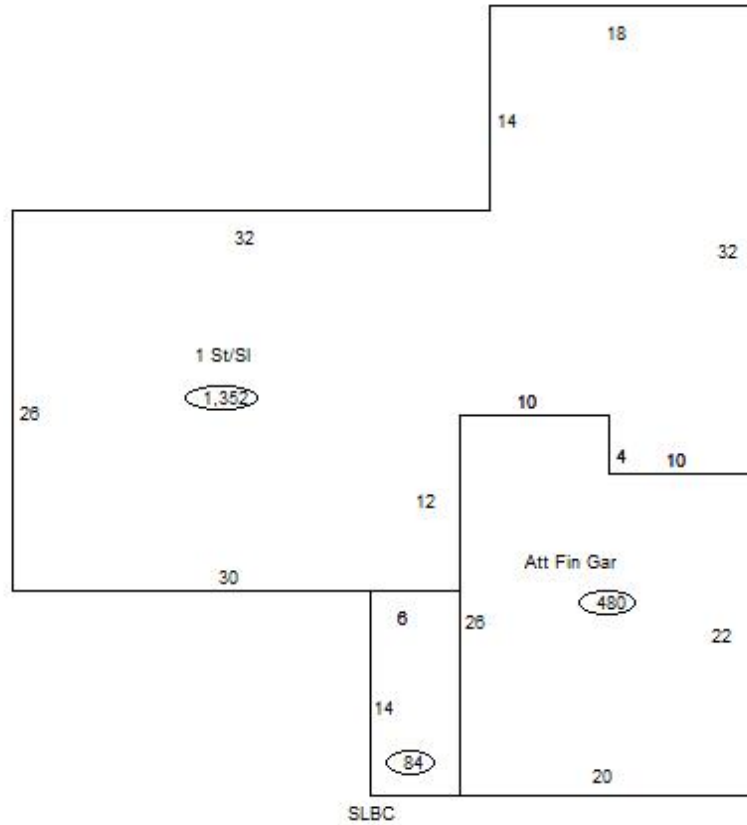

### Sketch Vector Information

Sequence	Code	Type	Built Over	Scale	Section Label	Base Area	Multiplier	Total Area
1	R	1	Slab	13	1 St/SI	1,352	1.000	1,352
2	G	5		13	Att Fin Gar	480	1.000	480
3	M	PRCH		13	SLBC	84	1.000	84
<b>Total Building Area</b>						1,352		1,352



# Rogers



## Assessment Property Record Card for Tax Year 2026

Data provided by LISA DELOZIER County Assessor

Date 04/16/2026  
 Time 22:50:57  
 Page 4

660028768

### Outbuildings/Site Improvements

Building Image	Code	Description	Dimensions	Floor	Roofing	Total Units
	UTIL	Utility Building	30x30x10	Concrete	Formed Metal	900
	Qual	2	Cond 3	Year 2010	Eff Age 12	
	<b>Valuation Summary</b>		<b>Modifier Total</b>	<b>RCN</b>	<b>Depr (25% Phys/ % Func)</b>	
Base Cost (30.60 x 900)		27,540		27,540	6,885	20,655
	LNT0	Lean To - Attached	10x20x8	Dirt	Formed Metal	200
	Qual	2	Cond 3	Year 2010	Eff Age 12	
	<b>Valuation Summary</b>		<b>Modifier Total</b>	<b>RCN</b>	<b>Depr (52% Phys/ % Func)</b>	
Base Cost (8.52 x 200)		1,704		1,704	886	818
	GZBO	Gazebo	0x0x8	Plank	Composition Shingle	41
	Qual	2	Cond 3	Year 2010	Eff Age 12	
	<b>Valuation Summary</b>		<b>Modifier Total</b>	<b>RCN</b>	<b>Depr (54% Phys/ % Func)</b>	
Base Cost (31.05 x 41)		1,273		1,273	687	586