



Rogers

Assessment Property Record Card for Tax Year 2026

Data provided by LISA DELOZIER County Assessor

Date 04/16/2026
 Time 23:13:04
 Page 1

Assessment Data					Primary Image																																																																																																																				
Account 660028871 Parcel ID 000000-00-0-20030-001-0011 Cadastral ID 34-20-14-03060 Property Type REAL - Real Property Property Class URP VI Area 3 Tax Area 1 - CATOOSA OT Name ID 329285 VANG, CHIWOU MAXINE & FEILONG LI YANG 10653 NW 288TH TER NORTH PLAINS OR 97133-0000 Parcel Location Situs 00688 N 153RD E AVE Subdivision CLAMPITT ACRES Lot/Block 0011 / 0001 Parcel Size 2 - Lots Sec/Twn/Rng 34 / 20 / 14 / 5 Neighborhood 1045 - R-V03-SW CATOOSA School District S002 - CATOOSA SCHOOLS					<p>660028871_001.JPG 9/30/2025</p>																																																																																																																				
Legal Description Lot/Long: 36.16540190 -95.80700574 LOT 11 & LOT 12 BLOCK 1 CLAMPITT ACRES																																																																																																																									
Exemptions <table border="1"> <thead> <tr> <th>Code</th> <th>Type</th> <th>Active</th> <th>Maximum</th> <th>Exemption</th> </tr> </thead> <tbody> <tr> <td></td> <td></td> <td></td> <td></td> <td></td> </tr> </tbody> </table>					Code	Type	Active	Maximum	Exemption						Building Permits <table border="1"> <thead> <tr> <th>Number</th> <th>Description</th> <th>Opened</th> <th>Closed</th> <th>Amount</th> </tr> </thead> <tbody> <tr> <td></td> <td></td> <td></td> <td></td> <td></td> </tr> </tbody> </table>					Number	Description	Opened	Closed	Amount																																																																																																	
Code	Type	Active	Maximum	Exemption																																																																																																																					
Number	Description	Opened	Closed	Amount																																																																																																																					
Parcel Valuation <table border="1"> <thead> <tr> <th>Source</th> <th>REAL</th> <th>Fair Cash</th> <th>Capped</th> <th>Asmnt Level</th> <th>Assessed</th> <th>Levy Rate</th> <th>106.660</th> <th>Current Tax</th> </tr> </thead> <tbody> <tr> <td>Remove Cap</td> <td></td> <td>Land Value 85,234</td> <td>46,837</td> <td>11%</td> <td>5,152</td> <td>Assessed</td> <td>18,420</td> <td>1,964.68</td> </tr> <tr> <td>Year Frozen</td> <td>0</td> <td>Improvements 133,753</td> <td>120,617</td> <td></td> <td>13,268</td> <td>Penalty</td> <td>0</td> <td></td> </tr> <tr> <td>Uncapped Value</td> <td>0</td> <td>Mobile Home 0</td> <td>0</td> <td></td> <td>0</td> <td>Exemption</td> <td>0</td> <td>0.00</td> </tr> <tr> <td>TIF Project ID</td> <td>0</td> <td>Total Value 218,987</td> <td>167,454</td> <td></td> <td>18,420</td> <td>Total Taxable</td> <td>18,420</td> <td>1,965.00</td> </tr> </tbody> </table>					Source	REAL	Fair Cash	Capped	Asmnt Level	Assessed	Levy Rate	106.660	Current Tax	Remove Cap		Land Value 85,234	46,837	11%	5,152	Assessed	18,420	1,964.68	Year Frozen	0	Improvements 133,753	120,617		13,268	Penalty	0		Uncapped Value	0	Mobile Home 0	0		0	Exemption	0	0.00	TIF Project ID	0	Total Value 218,987	167,454		18,420	Total Taxable	18,420	1,965.00	Sale History <table border="1"> <thead> <tr> <th>Bk/Pg</th> <th>Grantor</th> <th>Date</th> <th>Price</th> <th>Code</th> </tr> </thead> <tbody> <tr> <td>/</td> <td>YANG, PAO YE &</td> <td>10/03/2019</td> <td>113,000</td> <td>4</td> </tr> <tr> <td>2557/480</td> <td>VANG, YE YANG</td> <td>06/15/2016</td> <td>118,500</td> <td>4</td> </tr> <tr> <td>2060/810</td> <td>FIELDS, FLORENCE E</td> <td>10/02/2009</td> <td>125,000</td> <td>YES</td> </tr> <tr> <td>1583/619</td> <td>GREENLEE, MAURICE M &</td> <td>04/23/2004</td> <td>128,000</td> <td>YES</td> </tr> <tr> <td>1040/126</td> <td>HOSKINSON, JANICE S</td> <td>09/23/1996</td> <td>49,000</td> <td>Yes</td> </tr> <tr> <td>961/295</td> <td>ROWBOTHAM, W E (MRS)</td> <td>06/30/1994</td> <td>63,500</td> <td>No</td> </tr> </tbody> </table>					Bk/Pg	Grantor	Date	Price	Code	/	YANG, PAO YE &	10/03/2019	113,000	4	2557/480	VANG, YE YANG	06/15/2016	118,500	4	2060/810	FIELDS, FLORENCE E	10/02/2009	125,000	YES	1583/619	GREENLEE, MAURICE M &	04/23/2004	128,000	YES	1040/126	HOSKINSON, JANICE S	09/23/1996	49,000	Yes	961/295	ROWBOTHAM, W E (MRS)	06/30/1994	63,500	No																																
Source	REAL	Fair Cash	Capped	Asmnt Level	Assessed	Levy Rate	106.660	Current Tax																																																																																																																	
Remove Cap		Land Value 85,234	46,837	11%	5,152	Assessed	18,420	1,964.68																																																																																																																	
Year Frozen	0	Improvements 133,753	120,617		13,268	Penalty	0																																																																																																																		
Uncapped Value	0	Mobile Home 0	0		0	Exemption	0	0.00																																																																																																																	
TIF Project ID	0	Total Value 218,987	167,454		18,420	Total Taxable	18,420	1,965.00																																																																																																																	
Bk/Pg	Grantor	Date	Price	Code																																																																																																																					
/	YANG, PAO YE &	10/03/2019	113,000	4																																																																																																																					
2557/480	VANG, YE YANG	06/15/2016	118,500	4																																																																																																																					
2060/810	FIELDS, FLORENCE E	10/02/2009	125,000	YES																																																																																																																					
1583/619	GREENLEE, MAURICE M &	04/23/2004	128,000	YES																																																																																																																					
1040/126	HOSKINSON, JANICE S	09/23/1996	49,000	Yes																																																																																																																					
961/295	ROWBOTHAM, W E (MRS)	06/30/1994	63,500	No																																																																																																																					
Assessment History <table border="1"> <thead> <tr> <th>Tax Year</th> <th>Statement Number</th> <th>Billed Owner</th> <th>Tax Area</th> <th>Total Value</th> <th>Exemptions</th> <th>Taxable Value</th> <th>Billed Tax</th> </tr> </thead> <tbody> <tr><td>2025</td><td>2025-660028871</td><td>VANG, CHIWOU MAXINE &</td><td>1</td><td>208,216</td><td>0</td><td>17,543</td><td>1,871.00</td></tr> <tr><td>2024</td><td>2024-660028871</td><td>VANG, CHIWOU MAXINE &</td><td>1</td><td>294,202</td><td>0</td><td>16,708</td><td>1,763.00</td></tr> <tr><td>2023</td><td>2023-660028871</td><td>VANG, CHIWOU MAXINE &</td><td>1</td><td>170,427</td><td>0</td><td>15,912</td><td>1,633.00</td></tr> <tr><td>2022</td><td>2022-660028871</td><td>VANG, CHIWOU MAXINE &</td><td>1</td><td>137,766</td><td>0</td><td>15,154</td><td>1,521.00</td></tr> <tr><td>2021</td><td>2021-660028871</td><td>VANG, CHIWOU MAXINE &</td><td>1</td><td>140,537</td><td>0</td><td>15,459</td><td>1,360.00</td></tr> <tr><td>2020</td><td>2020-660028871</td><td>VANG, CHIWOU MAXINE &</td><td>1</td><td>138,523</td><td>0</td><td>15,238</td><td>1,350.00</td></tr> <tr><td>2019</td><td>2019-660028871</td><td>YANG, PAO YE &</td><td>1</td><td>135,444</td><td>0</td><td>14,899</td><td>1,338.00</td></tr> <tr><td>2018</td><td>2018-660028871</td><td>YANG, PAO YE &</td><td>1</td><td>142,706</td><td>0</td><td>15,698</td><td>1,401.00</td></tr> <tr><td>2017</td><td>2017-660028871</td><td>YANG, PAO YE &</td><td>1</td><td>139,903</td><td>0</td><td>15,389</td><td>1,390.00</td></tr> <tr><td>2016</td><td>2016-660028871</td><td>YANG, PAO YE &</td><td>1</td><td>152,605</td><td>0</td><td>15,983</td><td>1,422.00</td></tr> <tr><td>2015</td><td>2015-660028871</td><td>VANG, YE YANG</td><td>1</td><td>148,064</td><td>0</td><td>15,222</td><td>1,361.00</td></tr> <tr><td>2014</td><td>2014-660028871</td><td>VANG, YE YANG</td><td>1</td><td>149,215</td><td>0</td><td>14,497</td><td>1,311.00</td></tr> <tr><td>2013</td><td>2013-660028871</td><td>VANG, YE YANG</td><td>1</td><td>125,518</td><td>0</td><td>13,807</td><td>1,236.00</td></tr> </tbody> </table>										Tax Year	Statement Number	Billed Owner	Tax Area	Total Value	Exemptions	Taxable Value	Billed Tax	2025	2025-660028871	VANG, CHIWOU MAXINE &	1	208,216	0	17,543	1,871.00	2024	2024-660028871	VANG, CHIWOU MAXINE &	1	294,202	0	16,708	1,763.00	2023	2023-660028871	VANG, CHIWOU MAXINE &	1	170,427	0	15,912	1,633.00	2022	2022-660028871	VANG, CHIWOU MAXINE &	1	137,766	0	15,154	1,521.00	2021	2021-660028871	VANG, CHIWOU MAXINE &	1	140,537	0	15,459	1,360.00	2020	2020-660028871	VANG, CHIWOU MAXINE &	1	138,523	0	15,238	1,350.00	2019	2019-660028871	YANG, PAO YE &	1	135,444	0	14,899	1,338.00	2018	2018-660028871	YANG, PAO YE &	1	142,706	0	15,698	1,401.00	2017	2017-660028871	YANG, PAO YE &	1	139,903	0	15,389	1,390.00	2016	2016-660028871	YANG, PAO YE &	1	152,605	0	15,983	1,422.00	2015	2015-660028871	VANG, YE YANG	1	148,064	0	15,222	1,361.00	2014	2014-660028871	VANG, YE YANG	1	149,215	0	14,497	1,311.00	2013	2013-660028871	VANG, YE YANG	1	125,518	0	13,807	1,236.00
Tax Year	Statement Number	Billed Owner	Tax Area	Total Value	Exemptions	Taxable Value	Billed Tax																																																																																																																		
2025	2025-660028871	VANG, CHIWOU MAXINE &	1	208,216	0	17,543	1,871.00																																																																																																																		
2024	2024-660028871	VANG, CHIWOU MAXINE &	1	294,202	0	16,708	1,763.00																																																																																																																		
2023	2023-660028871	VANG, CHIWOU MAXINE &	1	170,427	0	15,912	1,633.00																																																																																																																		
2022	2022-660028871	VANG, CHIWOU MAXINE &	1	137,766	0	15,154	1,521.00																																																																																																																		
2021	2021-660028871	VANG, CHIWOU MAXINE &	1	140,537	0	15,459	1,360.00																																																																																																																		
2020	2020-660028871	VANG, CHIWOU MAXINE &	1	138,523	0	15,238	1,350.00																																																																																																																		
2019	2019-660028871	YANG, PAO YE &	1	135,444	0	14,899	1,338.00																																																																																																																		
2018	2018-660028871	YANG, PAO YE &	1	142,706	0	15,698	1,401.00																																																																																																																		
2017	2017-660028871	YANG, PAO YE &	1	139,903	0	15,389	1,390.00																																																																																																																		
2016	2016-660028871	YANG, PAO YE &	1	152,605	0	15,983	1,422.00																																																																																																																		
2015	2015-660028871	VANG, YE YANG	1	148,064	0	15,222	1,361.00																																																																																																																		
2014	2014-660028871	VANG, YE YANG	1	149,215	0	14,497	1,311.00																																																																																																																		
2013	2013-660028871	VANG, YE YANG	1	125,518	0	13,807	1,236.00																																																																																																																		



Rogers

Assessment Property Record Card for Tax Year 2026

Data provided by LISA DELOZIER County Assessor

Date 04/16/2026
 Time 23:13:04
 Page 2

Lot Data	Square-Foot - NBHD 1045 #1	Primary Image
Lot Size		
Lot Count		
Units Buildable	2	
Non-Ag Acres	2.1737	
Topography		
Street Access		
Utilities		
Amenities	LAND QUALITY	
	0	
	0	
Method	Square-Foot	
Base Lot Value	94,684.00 x .90 = 85,234	
Factor Value		
Adjustments	1.0000	
Lot Value	85,234	

Residential Data	
Type	1 Single Family Residence
Condition	3 - Average
Quality	2.5 - Fair
Architecture	TRAD TRADITIONAL
Style	100% One Story
Exterior Wall	100% Veneer, Masonry
Base/Total Area	1,944 / 1,944
Style	100% One Story
HVAC	100% Warmed & Cooled Air
Roof Cover	1 Composition Shingle
Area on Slab	0
Fixture/RghIn	8 /
Bed/F/H Bath	3 / 2.0 /
Basement Area	
Garage Type	
Remodel	
Year/Eff Age	1967 / 44

Cost Approach		Manual : 01/2025	
Base Cost	96.37	Total Misc Impr	+ 8,798
Roofing Adj	+ 4.08	Garage Cost	+
Subfloor Adj	+ 1.08	Total RCN	= 238,890
Heat/Cool Adj	+ 11.47	Depreciation (52%)	- 124,223
Plumbing Adj	+ 5.36	Lump Sums	+ 3,262
Basement Adj	+ 0.00	RCNLD	= 117,929
Adj Base Cost	= 118.36	Lot Value	+ 85,234
Total Area	x 1,944	Indicated Value	= 203,163
Adjusted Cost	= 230,092	Value Per SqFt	104.51

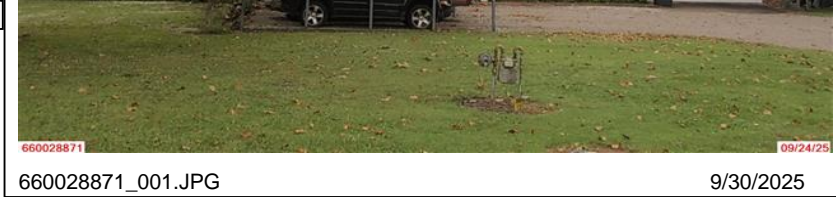

660028871_001.JPG 9/30/2025

GRM Approach	
GRM Code	
Gross Rent	0.00
Indicated Value	

Multiple Regression			
MRA Code	1	Test	
Adusted R	0.8445		
Indicated Value	150,235	77.28	Per SqFt

Direct Comparables	
Selection Model	A Adam Test
Adjustment Model	1 2022 Residential
Comparables	5
Indicated Value	161,920 Per SqFt

Value Reconciliation			
Selected Approach	Cost Approach		
Improvements	117,929		
Lot Value	85,234		
Indicated Value	203,163	104.51	Per SqFt
Agland Value			
Site Improvements	15,824		
Total Value	218,987	112.65	Total Value Per SqFt

Miscellaneous Improvements								
Code	Description	Sketch ID	Size	Year	Units	Unit Cost	Depr	Value
FPR1	FIREPLACE - RESIDENTIAL 1 STORY	0		1	1	5,095.98		5,096
PRCH	SLAB PORCH - COVERED	69305	26x6		156	23.73		3,702
WODO	WOOD DECK - OPEN	69306	16x12		192	21.24	20%	3,262



Rogers

Assessment Property Record Card for Tax Year 2026

Data provided by LISA DELOZIER County Assessor

Date 04/16/2026

Time 23:13:04

Page 3

Sketch Image

660028871

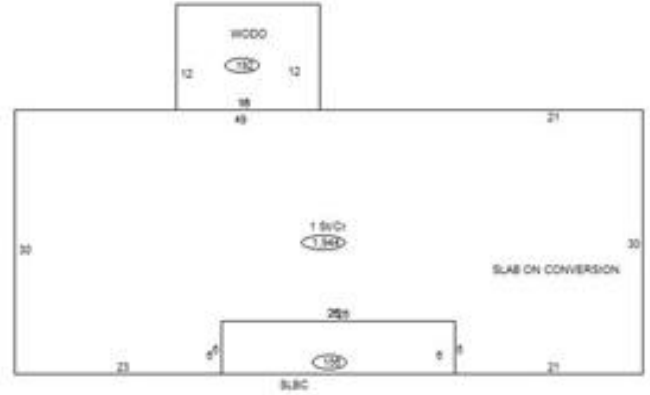

Sketch Vector Information

Sequence	Code	Type	Built Over	Scale	Section Label	Base Area	Multiplier	Total Area
1	R	1	Crawl	13	1 St/Cr	1,944	1.000	1,944
2	M	PRCH		13	SLBC	156	1.000	156
3	M	WODO		13	WODO	192	1.000	192
5	N	0		13	SLAB ON CONVERSION		0.000	
Total Building Area						1,944		1,944



Rogers

Assessment Property Record Card for Tax Year 2026

Data provided by LISA DELOZIER County Assessor

Date 04/16/2026
Time 23:13:04
Page 4

660028871

Outbuildings/Site Improvements

Building Image	Code	Description	Dimensions	Floor	Roofing	Total Units
	PCPT	Carport - Portable - NCV	18x20x8	Gravel	Formed Metal	360
	Qual	3	Cond 3	Year 2010	Eff Age 12	
	Valuation Summary		Modifier Total	RCN	Depr (100% Phys/ % Func)	RCNLD
	Base Cost (4.61 x 360)		1,660		1,660	1,660
	PCPT	Carport - Portable - NCV	18x20x8	Gravel	Formed Metal	360
	Qual	3	Cond 3	Year 2010	Eff Age 12	
	Valuation Summary		Modifier Total	RCN	Depr (100% Phys/ % Func)	RCNLD
	Base Cost (4.61 x 360)		1,660		1,660	1,660
	UTIL	Utility Building	20x24x8	Concrete	Formed Metal	480
	Qual	2	Cond 3	Year 2010	Eff Age 12	
	Valuation Summary		Modifier Total	RCN	Depr (25% Phys/ % Func)	RCNLD
	Base Cost (30.60 x 480)		14,688		14,688	3,672
						11,016
	LNTD	Lean To - Attached	12x28x8	Dirt	Formed Metal	336
	Qual	3	Cond 3	Year 2010	Eff Age 12	
	Valuation Summary		Modifier Total	RCN	Depr (52% Phys/ % Func)	RCNLD
	Base Cost (9.44 x 336)		3,172		3,172	1,649
						1,523
	LNTD	Lean To - Attached	12x24x8	Base	Formed Metal	288
	Qual	3	Cond 3	Year 2010	Eff Age 12	
	Valuation Summary		Modifier Total	RCN	Depr (52% Phys/ % Func)	RCNLD
	Base Cost (9.55 x 288)		2,750		2,750	1,430
						1,320
	SHDS	Shed - Small	12x16x8	Plank	Composition Shingle	192
	Qual	2	Cond 3	Year 2010	Eff Age 12	
	Valuation Summary		Modifier Total	RCN	Depr (46% Phys/ % Func)	RCNLD
	Base Cost (18.95 x 192)		3,638		3,638	1,673
						1,965