



# Rogers

## Assessment Property Record Card for Tax Year 2026

Data provided by LISA DELOZIER County Assessor

Date 04/16/2026  
Time 22:48:57  
Page 1

Assessment Data					Primary Image																																																																																																																				
<b>Account</b> 660029013 <b>Parcel ID</b> 000000-00-0-20080-011-0010 <b>Cadastral ID</b> 34-20-14-04520 <b>Property Type</b> REAL - Real Property <b>Property Class</b> URP VI Area 3 <b>Tax Area</b> 1 - CATOOSA OT <b>Name ID</b> 185744 CROWLEY, ARTHUR C JR &  PAULINE M 15717 E LATIMER PL TULSA OK 74116-0000					<p>660029013_001.JPG 10/2/2025</p>																																																																																																																				
<b>Parcel Location</b> <b>Situs</b> 15717 E LATIMER PL <b>Subdivision</b> HIGHLAND ACRES SECOND ADD AMD <b>Lot/Block</b> 0010 / 0011 <b>Parcel Size</b> 1 - Lots <b>Sec/Twn/Rng</b> 34 / 20 / 14 / 5 <b>Neighborhood</b> 1045 - R-V03-SW CATOOSA <b>School District</b> S002 - CATOOSA SCHOOLS																																																																																																																									
<b>Legal Description</b> Lat/Long: 36.17194347 -95.80109850 LOT 10 BLOCK 11 HIGHLAND AC II AMD					<b>Building Permits</b> <table border="1"> <thead> <tr> <th>Number</th> <th>Description</th> <th>Opened</th> <th>Closed</th> <th>Amount</th> </tr> </thead> <tbody> <tr> <td> </td> <td> </td> <td> </td> <td> </td> <td> </td> </tr> </tbody> </table>					Number	Description	Opened	Closed	Amount																																																																																																											
Number	Description	Opened	Closed	Amount																																																																																																																					
<b>Exemptions</b> <table border="1"> <thead> <tr> <th>Code</th> <th>Type</th> <th>Active</th> <th>Maximum</th> <th>Exemption</th> </tr> </thead> <tbody> <tr> <td>H</td> <td>Homestead</td> <td>Yes</td> <td>1,000</td> <td>1,000</td> </tr> </tbody> </table>					Code	Type	Active	Maximum	Exemption	H	Homestead	Yes	1,000	1,000	<b>Sale History</b> <table border="1"> <thead> <tr> <th>Bk/Pg</th> <th>Grantor</th> <th>Date</th> <th>Price</th> <th>Code</th> </tr> </thead> <tbody> <tr> <td> </td> <td> </td> <td> </td> <td> </td> <td> </td> </tr> </tbody> </table>					Bk/Pg	Grantor	Date	Price	Code																																																																																																	
Code	Type	Active	Maximum	Exemption																																																																																																																					
H	Homestead	Yes	1,000	1,000																																																																																																																					
Bk/Pg	Grantor	Date	Price	Code																																																																																																																					
<b>Parcel Valuation</b> <table border="1"> <thead> <tr> <th>Source</th> <th>REAL</th> <th>Fair Cash</th> <th>Capped</th> <th>Asmnt Level</th> <th>Assessed</th> <th>Levy Rate</th> <th>106.660</th> <th>Current Tax</th> </tr> </thead> <tbody> <tr> <td>Remove Cap</td> <td>0</td> <td>Land Value 28,947</td> <td>14,445</td> <td>11%</td> <td>1,589</td> <td>Assessed</td> <td>11,227</td> <td>1,197.47</td> </tr> <tr> <td>Year Frozen</td> <td>0</td> <td>Improvements 120,143</td> <td>87,615</td> <td></td> <td>9,638</td> <td>Penalty</td> <td>0</td> <td></td> </tr> <tr> <td>Uncapped Value</td> <td>0</td> <td>Mobile Home 0</td> <td>0</td> <td></td> <td>0</td> <td>Exemption</td> <td>1,000</td> <td>-106.00</td> </tr> <tr> <td>TIF Project ID</td> <td>0</td> <td>Total Value 149,090</td> <td>102,060</td> <td></td> <td>11,227</td> <td>Total Taxable</td> <td>10,227</td> <td>1,091.00</td> </tr> </tbody> </table>										Source	REAL	Fair Cash	Capped	Asmnt Level	Assessed	Levy Rate	106.660	Current Tax	Remove Cap	0	Land Value 28,947	14,445	11%	1,589	Assessed	11,227	1,197.47	Year Frozen	0	Improvements 120,143	87,615		9,638	Penalty	0		Uncapped Value	0	Mobile Home 0	0		0	Exemption	1,000	-106.00	TIF Project ID	0	Total Value 149,090	102,060		11,227	Total Taxable	10,227	1,091.00																																																																			
Source	REAL	Fair Cash	Capped	Asmnt Level	Assessed	Levy Rate	106.660	Current Tax																																																																																																																	
Remove Cap	0	Land Value 28,947	14,445	11%	1,589	Assessed	11,227	1,197.47																																																																																																																	
Year Frozen	0	Improvements 120,143	87,615		9,638	Penalty	0																																																																																																																		
Uncapped Value	0	Mobile Home 0	0		0	Exemption	1,000	-106.00																																																																																																																	
TIF Project ID	0	Total Value 149,090	102,060		11,227	Total Taxable	10,227	1,091.00																																																																																																																	
<b>Assessment History</b> <table border="1"> <thead> <tr> <th>Tax Year</th> <th>Statement Number</th> <th>Billed Owner</th> <th>Tax Area</th> <th>Total Value</th> <th>Exemptions</th> <th>Taxable Value</th> <th>Billed Tax</th> </tr> </thead> <tbody> <tr><td>2025</td><td>2025-660029013</td><td>CROWLEY, ARTHUR C JR &amp;</td><td>1</td><td>118,952</td><td>1000</td><td>9,900</td><td>1,056.00</td></tr> <tr><td>2024</td><td>2024-660029013</td><td>CROWLEY, ARTHUR C JR &amp;</td><td>1</td><td>125,602</td><td>1000</td><td>9,583</td><td>1,011.00</td></tr> <tr><td>2023</td><td>2023-660029013</td><td>CROWLEY, ARTHUR C JR &amp;</td><td>1</td><td>101,245</td><td>1000</td><td>9,274</td><td>952.00</td></tr> <tr><td>2022</td><td>2022-660029013</td><td>CROWLEY, ARTHUR C JR &amp;</td><td>1</td><td>90,680</td><td>1000</td><td>8,975</td><td>901.00</td></tr> <tr><td>2021</td><td>2021-660029013</td><td>CROWLEY, ARTHUR C JR &amp;</td><td>1</td><td>96,600</td><td>1000</td><td>9,626</td><td>847.00</td></tr> <tr><td>2020</td><td>2020-660029013</td><td>CROWLEY, ARTHUR C JR &amp;</td><td>1</td><td>96,053</td><td>1000</td><td>9,554</td><td>846.00</td></tr> <tr><td>2019</td><td>2019-660029013</td><td>CROWLEY, ARTHUR C JR &amp;</td><td>1</td><td>93,148</td><td>1000</td><td>9,246</td><td>830.00</td></tr> <tr><td>2018</td><td>2018-660029013</td><td>CROWLEY, ARTHUR C JR &amp;</td><td>1</td><td>99,377</td><td>1000</td><td>9,931</td><td>886.00</td></tr> <tr><td>2017</td><td>2017-660029013</td><td>CROWLEY, ARTHUR C JR &amp;</td><td>1</td><td>98,501</td><td>1000</td><td>9,835</td><td>888.00</td></tr> <tr><td>2016</td><td>2016-660029013</td><td>CROWLEY, ARTHUR C JR &amp;</td><td>1</td><td>95,808</td><td>1000</td><td>9,539</td><td>848.00</td></tr> <tr><td>2015</td><td>2015-660029013</td><td>CROWLEY, ARTHUR C JR &amp;</td><td>1</td><td>93,074</td><td>1000</td><td>9,238</td><td>826.00</td></tr> <tr><td>2014</td><td>2014-660029013</td><td>CROWLEY, ARTHUR C JR &amp;</td><td>1</td><td>94,911</td><td>1000</td><td>9,039</td><td>818.00</td></tr> <tr><td>2013</td><td>2013-660029013</td><td>CROWLEY, ARTHUR C JR &amp;</td><td>1</td><td>89,466</td><td>1000</td><td>8,747</td><td>783.00</td></tr> </tbody> </table>										Tax Year	Statement Number	Billed Owner	Tax Area	Total Value	Exemptions	Taxable Value	Billed Tax	2025	2025-660029013	CROWLEY, ARTHUR C JR &	1	118,952	1000	9,900	1,056.00	2024	2024-660029013	CROWLEY, ARTHUR C JR &	1	125,602	1000	9,583	1,011.00	2023	2023-660029013	CROWLEY, ARTHUR C JR &	1	101,245	1000	9,274	952.00	2022	2022-660029013	CROWLEY, ARTHUR C JR &	1	90,680	1000	8,975	901.00	2021	2021-660029013	CROWLEY, ARTHUR C JR &	1	96,600	1000	9,626	847.00	2020	2020-660029013	CROWLEY, ARTHUR C JR &	1	96,053	1000	9,554	846.00	2019	2019-660029013	CROWLEY, ARTHUR C JR &	1	93,148	1000	9,246	830.00	2018	2018-660029013	CROWLEY, ARTHUR C JR &	1	99,377	1000	9,931	886.00	2017	2017-660029013	CROWLEY, ARTHUR C JR &	1	98,501	1000	9,835	888.00	2016	2016-660029013	CROWLEY, ARTHUR C JR &	1	95,808	1000	9,539	848.00	2015	2015-660029013	CROWLEY, ARTHUR C JR &	1	93,074	1000	9,238	826.00	2014	2014-660029013	CROWLEY, ARTHUR C JR &	1	94,911	1000	9,039	818.00	2013	2013-660029013	CROWLEY, ARTHUR C JR &	1	89,466	1000	8,747	783.00
Tax Year	Statement Number	Billed Owner	Tax Area	Total Value	Exemptions	Taxable Value	Billed Tax																																																																																																																		
2025	2025-660029013	CROWLEY, ARTHUR C JR &	1	118,952	1000	9,900	1,056.00																																																																																																																		
2024	2024-660029013	CROWLEY, ARTHUR C JR &	1	125,602	1000	9,583	1,011.00																																																																																																																		
2023	2023-660029013	CROWLEY, ARTHUR C JR &	1	101,245	1000	9,274	952.00																																																																																																																		
2022	2022-660029013	CROWLEY, ARTHUR C JR &	1	90,680	1000	8,975	901.00																																																																																																																		
2021	2021-660029013	CROWLEY, ARTHUR C JR &	1	96,600	1000	9,626	847.00																																																																																																																		
2020	2020-660029013	CROWLEY, ARTHUR C JR &	1	96,053	1000	9,554	846.00																																																																																																																		
2019	2019-660029013	CROWLEY, ARTHUR C JR &	1	93,148	1000	9,246	830.00																																																																																																																		
2018	2018-660029013	CROWLEY, ARTHUR C JR &	1	99,377	1000	9,931	886.00																																																																																																																		
2017	2017-660029013	CROWLEY, ARTHUR C JR &	1	98,501	1000	9,835	888.00																																																																																																																		
2016	2016-660029013	CROWLEY, ARTHUR C JR &	1	95,808	1000	9,539	848.00																																																																																																																		
2015	2015-660029013	CROWLEY, ARTHUR C JR &	1	93,074	1000	9,238	826.00																																																																																																																		
2014	2014-660029013	CROWLEY, ARTHUR C JR &	1	94,911	1000	9,039	818.00																																																																																																																		
2013	2013-660029013	CROWLEY, ARTHUR C JR &	1	89,466	1000	8,747	783.00																																																																																																																		



# Rogers

## Assessment Property Record Card for Tax Year 2026

Data provided by LISA DELOZIER County Assessor

Date 04/16/2026  
Time 22:48:57  
Page 2

Lot Data		Square-Foot - NBHD 1045 #1		Primary Image				
Lot Size				<p>660029013_001.JPG 10/2/2025</p>				
Lot Count								
Units Buildable	1							
Non-Ag Acres	0.2712							
Topography								
Street Access								
Utilities								
Amenities	LAND QUALITY	0						
		0						
Method	Square-Foot							
Base Lot Value	11,815.00 x 2.45 = 28,947							
Factor Value								
Adjustments	1.0000							
Lot Value	28,947							
Residential Data								
Type	1 Single Family Residence							
Condition	3 - Average							
Quality	3 - Average							
Architecture	TRAD TRADITIONAL							
Style	100% One Story							
Exterior Wall	50% Veneer, Masonry 50% Frame, Siding, Vinyl							
Base/Total Area	1,624 / 1,624							
Style	100% One Story							
HVAC	100% Warmed & Cooled Air							
Roof Cover	1 Composition Shingle							
Area on Slab	1,624							
Fixture/RghIn	12 /							
Bed/F/H Bath	2 / 1.0 /							
Basement Area								
Garage Type								
Remodel	RMA -							
Year/Eff Age	1975 / 36							
Cost Approach		Manual : 01/2025						
Base Cost	100.38	Total Misc Impr	+	3,208				
Roofing Adj	+ 4.58	Garage Cost	+					
Subfloor Adj	+ -2.19	Total RCN	=	207,475				
Heat/Cool Adj	+ 12.64	Depreciation ( 43%)	-	89,214				
Plumbing Adj	+ 10.37	Lump Sums	+	0				
Basement Adj	+ 0.00	RCNLD	=	118,261				
Adj Base Cost	= 125.78	Lot Value	+	28,947				
Total Area	x 1,624	Indicated Value	=	147,208				
Adjusted Cost	= 204,267	Value Per SqFt		90.65				
Value Reconciliation								
Selected Approach	Cost Approach							
Improvements	118,261							
Lot Value	28,947							
Indicated Value	147,208							
Agland Value	90.65 Per SqFt							
Site Improvements	1,882							
Total Value	149,090							
	91.80 Total Value Per SqFt							
Miscellaneous Improvements								
Code	Description	Sketch ID	Size	Year	Units	Unit Cost	Depr	Value
PRCH	SLAB PORCH - COVERED	69432	10x6		60	26.74		1,604
PRCH	SLAB PORCH - COVERED	69433	10x6		60	26.74		1,604



# Rogers

## Assessment Property Record Card for Tax Year 2026

Data provided by LISA DELOZIER County Assessor

Date 04/16/2026  
Time 22:48:57  
Page 3

### Sketch Image

660029013

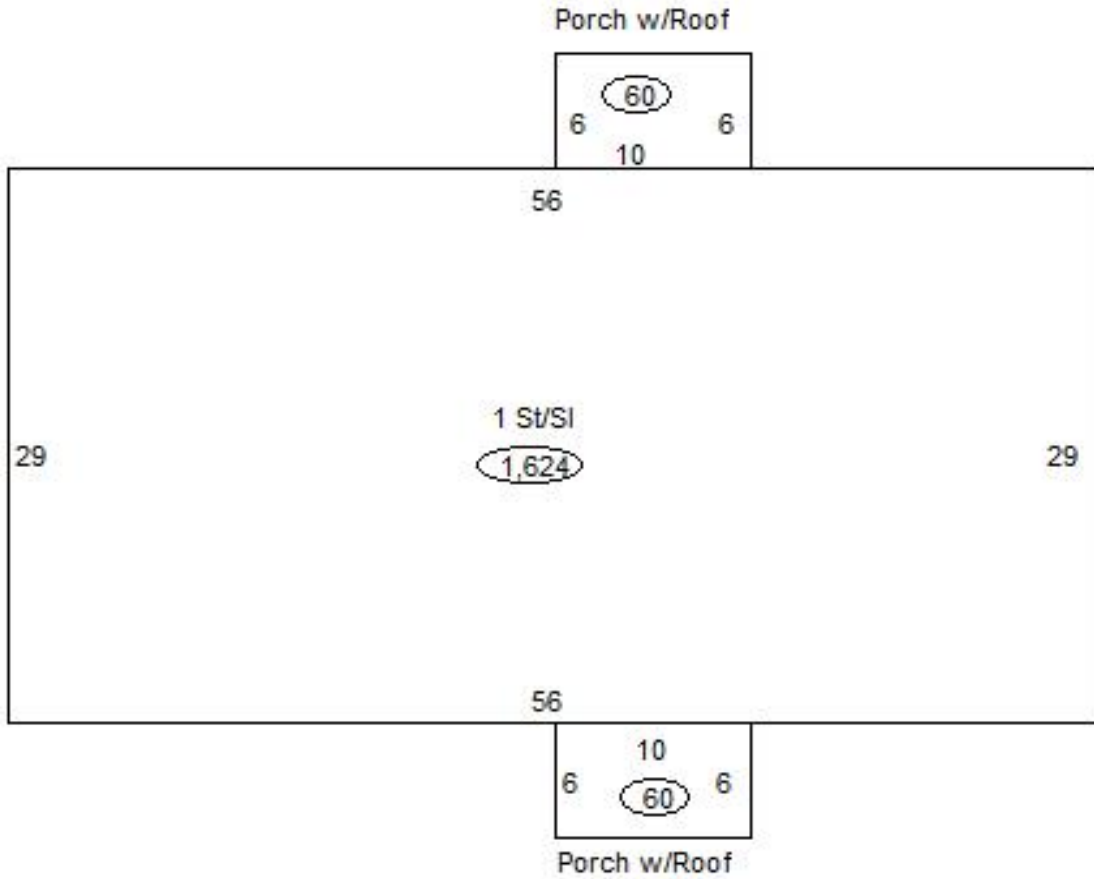

### Sketch Vector Information

Sequence	Code	Type	Built Over	Scale	Section Label	Base Area	Multiplier	Total Area
1	M	PRCH		13	SLBC	60	1.000	60
2	M	PRCH		13	SLBC	60	1.000	60
3	R	1	Slab	13	1 St/Sl	1,624	1.000	1,624
<b>Total Building Area</b>						1,624		1,624



# Rogers

## Assessment Property Record Card for Tax Year 2026

Data provided by LISA DELOZIER County Assessor

Date 04/16/2026  
Time 22:48:57  
Page 4

660029013

### Outbuildings/Site Improvements

Building Image	Code	Description	Dimensions	Floor	Roofing	Total Units
	SHDS	Shed - Small	12x16x8	Plank	Composition Shingle	192
	Qual	2	Cond 3	Year 2010	Eff Age 12	
<b>Valuation Summary</b>		<b>Modifier Total</b>	<b>RCN</b>	<b>Depr (46% Phys/ % Func)</b>		<b>RCNLD</b>
Base Cost (18.15 x 192)		3,485		3,485		1,603
						1,882