



Rogers

Assessment Property Record Card for Tax Year 2026

Data provided by LISA DELOZIER County Assessor

Date 04/18/2026
 Time 07:46:27
 Page 1

Assessment Data					Primary Image																																																																																																																				
Account 660029030 Parcel ID 000000-00-0-20080-012-0013 Cadastral ID 34-20-14-04690 Property Type REAL - Real Property Property Class URP VI Area 3 Tax Area 1 - CATOOSA OT Name ID 335635 ROBERTS, CYNTHIA D 16011 E LATIMER PL TULSA OK 74116-0000 Parcel Location Situs 16011 E LATIMER PL Subdivision HIGHLAND ACRES SECOND ADD AMD Lot/Block 0013 / 0012 Parcel Size 1 - Lots Sec/Twn/Rng 34 / 20 / 14 / 5 Neighborhood 1045 - R-V03-SW CATOOSA School District S002 - CATOOSA SCHOOLS					<p>660029030_001.JPG 10/2/2025</p>																																																																																																																				
Legal Description Lot/Long: 36.17197467 -95.79811104																																																																																																																									
Building Permits					<table border="1"> <thead> <tr> <th>Number</th> <th>Description</th> <th>Opened</th> <th>Closed</th> <th>Amount</th> </tr> </thead> <tbody> <tr> <td>1674</td> <td>NEW HOME</td> <td>02/2001</td> <td>09/2001</td> <td>74,952</td> </tr> </tbody> </table>					Number	Description	Opened	Closed	Amount	1674	NEW HOME	02/2001	09/2001	74,952																																																																																																						
Number	Description	Opened	Closed	Amount																																																																																																																					
1674	NEW HOME	02/2001	09/2001	74,952																																																																																																																					
Exemptions					Sale History																																																																																																																				
<table border="1"> <thead> <tr> <th>Code</th> <th>Type</th> <th>Active</th> <th>Maximum</th> <th>Exemption</th> </tr> </thead> <tbody> <tr> <td></td> <td></td> <td></td> <td></td> <td></td> </tr> </tbody> </table>					Code	Type	Active	Maximum	Exemption						<table border="1"> <thead> <tr> <th>Bk/Pg</th> <th>Grantor</th> <th>Date</th> <th>Price</th> <th>Code</th> </tr> </thead> <tbody> <tr> <td>/</td> <td>DAVIS, MICHAEL R & AMANDA N</td> <td>07/28/2021</td> <td>158,000</td> <td>YES</td> </tr> <tr> <td>2572/752</td> <td>BUTLER-WHITE, CAROL</td> <td>08/24/2016</td> <td>105,000</td> <td>YES</td> </tr> <tr> <td>2572/749</td> <td>WHITE, RON BUTLER &</td> <td>08/24/2016</td> <td>0</td> <td>4</td> </tr> <tr> <td>2160/705</td> <td>FEDERAL NATIONAL MORTGAGE-AS</td> <td>02/14/2011</td> <td>80,000</td> <td>3</td> </tr> <tr> <td>2122/155</td> <td>GORDON, TRACY A</td> <td>08/10/2010</td> <td>0</td> <td>10</td> </tr> <tr> <td>1890/617</td> <td>LARIOS, GENEVA LEANNA</td> <td>08/06/2007</td> <td>110,000</td> <td>YES</td> </tr> </tbody> </table>					Bk/Pg	Grantor	Date	Price	Code	/	DAVIS, MICHAEL R & AMANDA N	07/28/2021	158,000	YES	2572/752	BUTLER-WHITE, CAROL	08/24/2016	105,000	YES	2572/749	WHITE, RON BUTLER &	08/24/2016	0	4	2160/705	FEDERAL NATIONAL MORTGAGE-AS	02/14/2011	80,000	3	2122/155	GORDON, TRACY A	08/10/2010	0	10	1890/617	LARIOS, GENEVA LEANNA	08/06/2007	110,000	YES																																																																			
Code	Type	Active	Maximum	Exemption																																																																																																																					
Bk/Pg	Grantor	Date	Price	Code																																																																																																																					
/	DAVIS, MICHAEL R & AMANDA N	07/28/2021	158,000	YES																																																																																																																					
2572/752	BUTLER-WHITE, CAROL	08/24/2016	105,000	YES																																																																																																																					
2572/749	WHITE, RON BUTLER &	08/24/2016	0	4																																																																																																																					
2160/705	FEDERAL NATIONAL MORTGAGE-AS	02/14/2011	80,000	3																																																																																																																					
2122/155	GORDON, TRACY A	08/10/2010	0	10																																																																																																																					
1890/617	LARIOS, GENEVA LEANNA	08/06/2007	110,000	YES																																																																																																																					
Parcel Valuation																																																																																																																									
<table border="1"> <thead> <tr> <th>Source</th> <th>REAL</th> <th>Fair Cash</th> <th>Capped</th> <th>Asmnt Level</th> <th>Assessed</th> <th>Levy Rate</th> <th>106.660</th> <th>Current Tax</th> </tr> </thead> <tbody> <tr> <td>Remove Cap</td> <td>2022</td> <td>Land Value</td> <td>30,615</td> <td>30,615</td> <td>11%</td> <td>3,368</td> <td>Assessed</td> <td>18,339</td> <td>1,956.04</td> </tr> <tr> <td>Year Frozen</td> <td>0</td> <td>Improvements</td> <td>136,102</td> <td>136,102</td> <td></td> <td>14,971</td> <td>Penalty</td> <td>0</td> <td></td> </tr> <tr> <td>Uncapped Value</td> <td>0</td> <td>Mobile Home</td> <td>0</td> <td>0</td> <td></td> <td>0</td> <td>Exemption</td> <td>0</td> <td>0.00</td> </tr> <tr> <td>TIF Project ID</td> <td>0</td> <td>Total Value</td> <td>166,717</td> <td>166,717</td> <td></td> <td>18,339</td> <td>Total Taxable</td> <td>18,339</td> <td>1,956.00</td> </tr> </tbody> </table>		Source	REAL	Fair Cash	Capped	Asmnt Level	Assessed	Levy Rate	106.660	Current Tax	Remove Cap	2022	Land Value	30,615	30,615	11%	3,368	Assessed	18,339	1,956.04	Year Frozen	0	Improvements	136,102	136,102		14,971	Penalty	0		Uncapped Value	0	Mobile Home	0	0		0	Exemption	0	0.00	TIF Project ID	0	Total Value	166,717	166,717		18,339	Total Taxable	18,339	1,956.00																																																																							
Source	REAL	Fair Cash	Capped	Asmnt Level	Assessed	Levy Rate	106.660	Current Tax																																																																																																																	
Remove Cap	2022	Land Value	30,615	30,615	11%	3,368	Assessed	18,339	1,956.04																																																																																																																
Year Frozen	0	Improvements	136,102	136,102		14,971	Penalty	0																																																																																																																	
Uncapped Value	0	Mobile Home	0	0		0	Exemption	0	0.00																																																																																																																
TIF Project ID	0	Total Value	166,717	166,717		18,339	Total Taxable	18,339	1,956.00																																																																																																																
Assessment History																																																																																																																									
<table border="1"> <thead> <tr> <th>Tax Year</th> <th>Statement Number</th> <th>Billed Owner</th> <th>Tax Area</th> <th>Total Value</th> <th>Exemptions</th> <th>Taxable Value</th> <th>Billed Tax</th> </tr> </thead> <tbody> <tr><td>2025</td><td>2025-660029030</td><td>ROBERTS, CYNTHIA D</td><td>1</td><td>161,875</td><td>0</td><td>17,807</td><td>1,899.00</td></tr> <tr><td>2024</td><td>2024-660029030</td><td>ROBERTS, CYNTHIA D</td><td>1</td><td>171,523</td><td>0</td><td>18,249</td><td>1,925.00</td></tr> <tr><td>2023</td><td>2023-660029030</td><td>ROBERTS, CYNTHIA D</td><td>1</td><td>158,000</td><td>0</td><td>17,380</td><td>1,784.00</td></tr> <tr><td>2022</td><td>2022-660029030</td><td>ROBERTS, CYNTHIA D</td><td>1</td><td>158,000</td><td>0</td><td>17,380</td><td>1,745.00</td></tr> <tr><td>2021</td><td>2021-660029030</td><td>ROBERTS, CYNTHIA D</td><td>1</td><td>110,501</td><td>0</td><td>12,155</td><td>1,069.00</td></tr> <tr><td>2020</td><td>2020-660029030</td><td>DAVIS, MICHAEL R & AMANDA N</td><td>1</td><td>108,563</td><td>0</td><td>11,942</td><td>1,058.00</td></tr> <tr><td>2019</td><td>2019-660029030</td><td>DAVIS, MICHAEL R & AMANDA N</td><td>1</td><td>104,045</td><td>0</td><td>11,445</td><td>1,028.00</td></tr> <tr><td>2018</td><td>2018-660029030</td><td>DAVIS, MICHAEL R & AMANDA N</td><td>1</td><td>108,248</td><td>0</td><td>11,907</td><td>1,063.00</td></tr> <tr><td>2017</td><td>2017-660029030</td><td>DAVIS, MICHAEL R & AMANDA N</td><td>1</td><td>107,255</td><td>0</td><td>11,798</td><td>1,065.00</td></tr> <tr><td>2016</td><td>2016-660029030</td><td>DAVIS, MICHAEL R & AMANDA N</td><td>1</td><td>104,270</td><td>0</td><td>10,696</td><td>951.00</td></tr> <tr><td>2015</td><td>2015-660029030</td><td>WHITE, RON BUTLER &</td><td>1</td><td>101,784</td><td>0</td><td>10,187</td><td>911.00</td></tr> <tr><td>2014</td><td>2014-660029030</td><td>WHITE, RON BUTLER &</td><td>1</td><td>102,693</td><td>0</td><td>9,702</td><td>878.00</td></tr> <tr><td>2013</td><td>2013-660029030</td><td>WHITE, RON BUTLER &</td><td>1</td><td>96,059</td><td>0</td><td>9,240</td><td>827.00</td></tr> </tbody> </table>										Tax Year	Statement Number	Billed Owner	Tax Area	Total Value	Exemptions	Taxable Value	Billed Tax	2025	2025-660029030	ROBERTS, CYNTHIA D	1	161,875	0	17,807	1,899.00	2024	2024-660029030	ROBERTS, CYNTHIA D	1	171,523	0	18,249	1,925.00	2023	2023-660029030	ROBERTS, CYNTHIA D	1	158,000	0	17,380	1,784.00	2022	2022-660029030	ROBERTS, CYNTHIA D	1	158,000	0	17,380	1,745.00	2021	2021-660029030	ROBERTS, CYNTHIA D	1	110,501	0	12,155	1,069.00	2020	2020-660029030	DAVIS, MICHAEL R & AMANDA N	1	108,563	0	11,942	1,058.00	2019	2019-660029030	DAVIS, MICHAEL R & AMANDA N	1	104,045	0	11,445	1,028.00	2018	2018-660029030	DAVIS, MICHAEL R & AMANDA N	1	108,248	0	11,907	1,063.00	2017	2017-660029030	DAVIS, MICHAEL R & AMANDA N	1	107,255	0	11,798	1,065.00	2016	2016-660029030	DAVIS, MICHAEL R & AMANDA N	1	104,270	0	10,696	951.00	2015	2015-660029030	WHITE, RON BUTLER &	1	101,784	0	10,187	911.00	2014	2014-660029030	WHITE, RON BUTLER &	1	102,693	0	9,702	878.00	2013	2013-660029030	WHITE, RON BUTLER &	1	96,059	0	9,240	827.00
Tax Year	Statement Number	Billed Owner	Tax Area	Total Value	Exemptions	Taxable Value	Billed Tax																																																																																																																		
2025	2025-660029030	ROBERTS, CYNTHIA D	1	161,875	0	17,807	1,899.00																																																																																																																		
2024	2024-660029030	ROBERTS, CYNTHIA D	1	171,523	0	18,249	1,925.00																																																																																																																		
2023	2023-660029030	ROBERTS, CYNTHIA D	1	158,000	0	17,380	1,784.00																																																																																																																		
2022	2022-660029030	ROBERTS, CYNTHIA D	1	158,000	0	17,380	1,745.00																																																																																																																		
2021	2021-660029030	ROBERTS, CYNTHIA D	1	110,501	0	12,155	1,069.00																																																																																																																		
2020	2020-660029030	DAVIS, MICHAEL R & AMANDA N	1	108,563	0	11,942	1,058.00																																																																																																																		
2019	2019-660029030	DAVIS, MICHAEL R & AMANDA N	1	104,045	0	11,445	1,028.00																																																																																																																		
2018	2018-660029030	DAVIS, MICHAEL R & AMANDA N	1	108,248	0	11,907	1,063.00																																																																																																																		
2017	2017-660029030	DAVIS, MICHAEL R & AMANDA N	1	107,255	0	11,798	1,065.00																																																																																																																		
2016	2016-660029030	DAVIS, MICHAEL R & AMANDA N	1	104,270	0	10,696	951.00																																																																																																																		
2015	2015-660029030	WHITE, RON BUTLER &	1	101,784	0	10,187	911.00																																																																																																																		
2014	2014-660029030	WHITE, RON BUTLER &	1	102,693	0	9,702	878.00																																																																																																																		
2013	2013-660029030	WHITE, RON BUTLER &	1	96,059	0	9,240	827.00																																																																																																																		



Rogers

Assessment Property Record Card for Tax Year 2026

Data provided by LISA DELOZIER County Assessor

Date 04/18/2026
Time 07:46:27
Page 2

Lot Data		Square-Foot - NBHD 1045 #1		Primary Image	
Lot Size					
Lot Count					
Units Buildable	1				
Non-Ag Acres	0.2869				
Topography					
Street Access					
Utilities					
Amenities	LAND QUALITY	0			
		0			
Method	Square-Foot				
Base Lot Value	12,496.00 x 2.45 = 30,615				
Factor Value					
Adjustments	1.0000				
Lot Value	30,615				
Residential Data				660029030_001.JPG 10/2/2025	
Type	1 Single Family Residence			GRM Approach	
Condition	3 - Average			GRM Code	
Quality	2.5 - Fair			Gross Rent 0.00	
Architecture	TRAD TRADITIONAL			Indicated Value	
Style	100% One Story			Multiple Regression	
Exterior Wall	10% Veneer, Masonry 90% Frame, Siding, Vinyl			MRA Code 1 Test	
Base/Total Area	1,230 / 1,230			Adusted R 0.8445	
Style	100% One Story			Indicated Value 161,851 131.59 Per SqFt	
HVAC	100% Warmed & Cooled Air			Direct Comparables	
Roof Cover	1 Composition Shingle			Selection Model A Adam Test	
Area on Slab	1,230			Adjustment Model 1 2022 Residential	
Fixture/RghIn	11 /			Comparables 5	
Bed/F/H Bath	3 / 2.0 /			Indicated Value 165,830 Per SqFt	
Basement Area				Value Reconciliation	
Garage Type	400 Attached Garage - Finished 2 Stalls			Selected Approach Cost Approach	
Remodel				Improvements 135,138	
Year/Eff Age	2001 / 19			Lot Value 30,615	
Cost Approach		Manual : 01/2025		Indicated Value 165,753 134.76 Per SqFt	
Base Cost	102.90	Total Misc Impr	+ 4,085	Agland Value	
Roofing Adj	+ 4.72	Garage Cost	+ 14,664	Site Improvements 964	
Subfloor Adj	+ -1.21	Total RCN	= 177,813	Total Value 166,717 135.54 Total Value Per SqFt	
Heat/Cool Adj	+ 11.47	Depreciation (24%)	- 42,675		
Plumbing Adj	+ 11.44	Lump Sums	+ 0		
Basement Adj	+ 0.00	RCNLD	= 135,138		
Adj Base Cost	= 129.32	Lot Value	+ 30,615		
Total Area	x 1,230	Indicated Value	= 165,753		
Adjusted Cost	= 159,064	Value Per SqFt	134.76		

Miscellaneous Improvements							
Code	Description	Sketch ID	Size	Year	Units	Unit Cost	Depr Value
PRCH	SLAB PORCH - COVERED	69485	6x4		24	24.19	581
PATO	SLAB PORCH - OPEN	69486	431		431	8.13	3,504



Rogers

Assessment Property Record Card for Tax Year 2026

Data provided by LISA DELOZIER County Assessor

Date 04/18/2026

Time 07:46:27

Page 3

Sketch Image

660029030

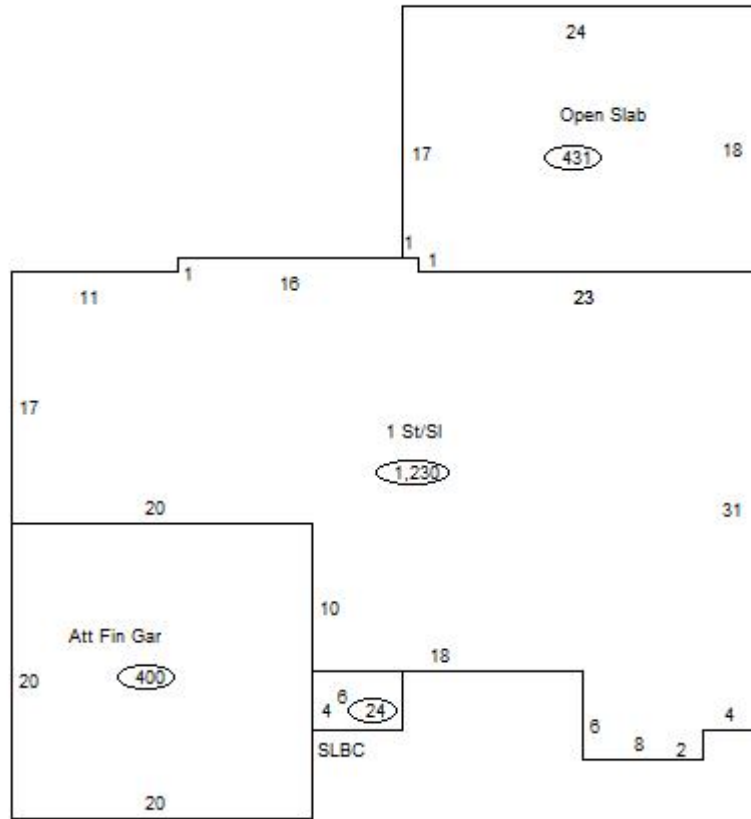

Sketch Vector Information

Sequence	Code	Type	Built Over	Scale	Section Label	Base Area	Multiplier	Total Area
1	R	1	Slab	13	1 St/Sl	1,230	1.000	1,230
2	G	5		13	Att Fin Gar	400	1.000	400
3	M	PRCH		13	SLBC	24	1.000	24
4	M	PATO		13	Open Slab	431	1.000	431
Total Building Area						1,230		1,230



Rogers

Assessment Property Record Card for Tax Year 2026

Data provided by LISA DELOZIER County Assessor

Date 04/18/2026
Time 07:46:27
Page 4

660029030

Outbuildings/Site Improvements

Building Image	Code	Description	Dimensions	Floor	Roofing	Total Units
	SHDS	Shed - Small	8x8x6	Plank	Formed Metal	64
	Qual	2	Cond 3	Year 2010	Eff Age 12	
Valuation Summary		Modifier Total	RCN	Depr (46% Phys/ % Func)		RCNLD
Base Cost (27.90 x 64)		1,786		1,786 822		964