



# Rogers

## Assessment Property Record Card for Tax Year 2026

Data provided by LISA DELOZIER County Assessor

Date 04/16/2026  
Time 22:49:16  
Page 1

Assessment Data					Primary Image																																																																																																																				
<b>Account</b> 660029060 <b>Parcel ID</b> 000000-00-0-20080-015-0008 <b>Cadastral ID</b> 34-20-14-04990 <b>Property Type</b> REAL - Real Property <b>Property Class</b> URP VI Area 3 <b>Tax Area</b> 1 - CATOOSA OT <b>Name ID</b> 338200 DUNCAN, JAMES C & LORETTA R  1111 N 158TH E AVE TULSA OK 74116-0000  <b>Parcel Location</b> <b>Situs</b> 01111 N 158TH E AVE <b>Subdivision</b> HIGHLAND ACRES SECOND ADD AMD <b>Lot/Block</b> 0008 / 0015 <b>Parcel Size</b> 1 - Lots <b>Sec/Twn/Rng</b> 34 / 20 / 14 / 5 <b>Neighborhood</b> 1045 - R-V03-SW CATOOSA <b>School District</b> S002 - CATOOSA SCHOOLS					<p>660029060_001.JPG 10/2/2025</p>																																																																																																																				
<b>Legal Description</b> Lot/Long: 36.17039732 -95.80057336																																																																																																																									
<b>Building Permits</b> <table border="1"> <thead> <tr> <th>Number</th> <th>Description</th> <th>Opened</th> <th>Closed</th> <th>Amount</th> </tr> </thead> <tbody> <tr> <td colspan="5"> </td> </tr> </tbody> </table>					Number	Description	Opened	Closed	Amount																																																																																																																
Number	Description	Opened	Closed	Amount																																																																																																																					
<b>Exemptions</b> <table border="1"> <thead> <tr> <th>Code</th> <th>Type</th> <th>Active</th> <th>Maximum</th> <th>Exemption</th> </tr> </thead> <tbody> <tr> <td>H</td> <td>Homestead</td> <td>Yes</td> <td>1,000</td> <td>1,000</td> </tr> </tbody> </table>					Code	Type	Active	Maximum	Exemption	H	Homestead	Yes	1,000	1,000	<b>Sale History</b> <table border="1"> <thead> <tr> <th>Bk/Pg</th> <th>Grantor</th> <th>Date</th> <th>Price</th> <th>Code</th> </tr> </thead> <tbody> <tr> <td>/</td> <td>CAMP, MICHAEL JOHN TRUSTEE</td> <td>05/03/2022</td> <td>265,000</td> <td>WG</td> </tr> </tbody> </table>					Bk/Pg	Grantor	Date	Price	Code	/	CAMP, MICHAEL JOHN TRUSTEE	05/03/2022	265,000	WG																																																																																												
Code	Type	Active	Maximum	Exemption																																																																																																																					
H	Homestead	Yes	1,000	1,000																																																																																																																					
Bk/Pg	Grantor	Date	Price	Code																																																																																																																					
/	CAMP, MICHAEL JOHN TRUSTEE	05/03/2022	265,000	WG																																																																																																																					
<b>Parcel Valuation</b> <table border="1"> <thead> <tr> <th>Source</th> <th>REAL</th> <th>Fair Cash</th> <th>Capped</th> <th>Asmnt Level</th> <th>Assessed</th> <th>Levy Rate</th> <th>106.660</th> <th>Current Tax</th> </tr> </thead> <tbody> <tr> <td>Remove Cap</td> <td>2023</td> <td>Land Value 42,419</td> <td>6,768</td> <td>11%</td> <td>744</td> <td>Assessed</td> <td>12,154</td> <td>1,296.35</td> </tr> <tr> <td>Year Frozen</td> <td>0</td> <td>Improvements 137,531</td> <td>103,724</td> <td></td> <td>11,410</td> <td>Penalty</td> <td>0</td> <td></td> </tr> <tr> <td>Uncapped Value</td> <td>0</td> <td>Mobile Home 0</td> <td>0</td> <td></td> <td>0</td> <td>Exemption</td> <td>1,000</td> <td>-106.00</td> </tr> <tr> <td>TIF Project ID</td> <td>0</td> <td>Total Value 179,950</td> <td>110,492</td> <td></td> <td>12,154</td> <td>Total Taxable</td> <td>11,154</td> <td>1,190.00</td> </tr> </tbody> </table>										Source	REAL	Fair Cash	Capped	Asmnt Level	Assessed	Levy Rate	106.660	Current Tax	Remove Cap	2023	Land Value 42,419	6,768	11%	744	Assessed	12,154	1,296.35	Year Frozen	0	Improvements 137,531	103,724		11,410	Penalty	0		Uncapped Value	0	Mobile Home 0	0		0	Exemption	1,000	-106.00	TIF Project ID	0	Total Value 179,950	110,492		12,154	Total Taxable	11,154	1,190.00																																																																			
Source	REAL	Fair Cash	Capped	Asmnt Level	Assessed	Levy Rate	106.660	Current Tax																																																																																																																	
Remove Cap	2023	Land Value 42,419	6,768	11%	744	Assessed	12,154	1,296.35																																																																																																																	
Year Frozen	0	Improvements 137,531	103,724		11,410	Penalty	0																																																																																																																		
Uncapped Value	0	Mobile Home 0	0		0	Exemption	1,000	-106.00																																																																																																																	
TIF Project ID	0	Total Value 179,950	110,492		12,154	Total Taxable	11,154	1,190.00																																																																																																																	
<b>Assessment History</b> <table border="1"> <thead> <tr> <th>Tax Year</th> <th>Statement Number</th> <th>Billed Owner</th> <th>Tax Area</th> <th>Total Value</th> <th>Exemptions</th> <th>Taxable Value</th> <th>Billed Tax</th> </tr> </thead> <tbody> <tr><td>2025</td><td>2025-660029060</td><td>DUNCAN, JAMES C &amp; LORETTA R</td><td>1</td><td>174,297</td><td>1000</td><td>10,800</td><td>1,152.00</td></tr> <tr><td>2024</td><td>2024-660029060</td><td>DUNCAN, JAMES C &amp; LORETTA R</td><td>1</td><td>183,351</td><td>1000</td><td>10,457</td><td>1,103.00</td></tr> <tr><td>2023</td><td>2023-660029060</td><td>DUNCAN, JAMES C &amp; LORETTA R</td><td>1</td><td>101,117</td><td>1000</td><td>10,123</td><td>1,039.00</td></tr> <tr><td>2022</td><td>2022-660029060</td><td>DUNCAN, JAMES C &amp; LORETTA R</td><td>1</td><td>102,749</td><td>1000</td><td>10,302</td><td>1,034.00</td></tr> <tr><td>2021</td><td>2021-660029060</td><td>CAMP, MICHAEL JOHN TRUSTEE</td><td>1</td><td>114,481</td><td>1000</td><td>11,593</td><td>1,020.00</td></tr> <tr><td>2020</td><td>2020-660029060</td><td>CAMP, MICHAEL JOHN TRUSTEE</td><td>1</td><td>112,417</td><td>1000</td><td>11,232</td><td>995.00</td></tr> <tr><td>2019</td><td>2019-660029060</td><td>CAMP, MICHAEL JOHN TRUSTEE</td><td>1</td><td>107,959</td><td>1000</td><td>10,875</td><td>977.00</td></tr> <tr><td>2018</td><td>2018-660029060</td><td>CAMP, MICHAEL JOHN TRUSTEE</td><td>1</td><td>112,366</td><td>1000</td><td>11,360</td><td>1,014.00</td></tr> <tr><td>2017</td><td>2017-660029060</td><td>CAMP, MICHAEL JOHN TRUSTEE</td><td>1</td><td>111,350</td><td>1000</td><td>11,209</td><td>1,012.00</td></tr> <tr><td>2016</td><td>2016-660029060</td><td>CAMP, MICHAEL JOHN TRUSTEE</td><td>1</td><td>108,155</td><td>1000</td><td>10,853</td><td>965.00</td></tr> <tr><td>2015</td><td>2015-660029060</td><td>CAMP, MICHAEL JOHN TRUSTEE</td><td>1</td><td>104,617</td><td>1000</td><td>10,508</td><td>939.00</td></tr> <tr><td>2014</td><td>2014-660029060</td><td>CAMP, MICHAEL JOHN TRUSTEE</td><td>1</td><td>107,178</td><td>1000</td><td>10,790</td><td>976.00</td></tr> <tr><td>2013</td><td>2013-660029060</td><td>CAMP, MICHAEL JOHN TRUSTEE</td><td>1</td><td>139,644</td><td>1000</td><td>13,370</td><td>1,197.00</td></tr> </tbody> </table>										Tax Year	Statement Number	Billed Owner	Tax Area	Total Value	Exemptions	Taxable Value	Billed Tax	2025	2025-660029060	DUNCAN, JAMES C & LORETTA R	1	174,297	1000	10,800	1,152.00	2024	2024-660029060	DUNCAN, JAMES C & LORETTA R	1	183,351	1000	10,457	1,103.00	2023	2023-660029060	DUNCAN, JAMES C & LORETTA R	1	101,117	1000	10,123	1,039.00	2022	2022-660029060	DUNCAN, JAMES C & LORETTA R	1	102,749	1000	10,302	1,034.00	2021	2021-660029060	CAMP, MICHAEL JOHN TRUSTEE	1	114,481	1000	11,593	1,020.00	2020	2020-660029060	CAMP, MICHAEL JOHN TRUSTEE	1	112,417	1000	11,232	995.00	2019	2019-660029060	CAMP, MICHAEL JOHN TRUSTEE	1	107,959	1000	10,875	977.00	2018	2018-660029060	CAMP, MICHAEL JOHN TRUSTEE	1	112,366	1000	11,360	1,014.00	2017	2017-660029060	CAMP, MICHAEL JOHN TRUSTEE	1	111,350	1000	11,209	1,012.00	2016	2016-660029060	CAMP, MICHAEL JOHN TRUSTEE	1	108,155	1000	10,853	965.00	2015	2015-660029060	CAMP, MICHAEL JOHN TRUSTEE	1	104,617	1000	10,508	939.00	2014	2014-660029060	CAMP, MICHAEL JOHN TRUSTEE	1	107,178	1000	10,790	976.00	2013	2013-660029060	CAMP, MICHAEL JOHN TRUSTEE	1	139,644	1000	13,370	1,197.00
Tax Year	Statement Number	Billed Owner	Tax Area	Total Value	Exemptions	Taxable Value	Billed Tax																																																																																																																		
2025	2025-660029060	DUNCAN, JAMES C & LORETTA R	1	174,297	1000	10,800	1,152.00																																																																																																																		
2024	2024-660029060	DUNCAN, JAMES C & LORETTA R	1	183,351	1000	10,457	1,103.00																																																																																																																		
2023	2023-660029060	DUNCAN, JAMES C & LORETTA R	1	101,117	1000	10,123	1,039.00																																																																																																																		
2022	2022-660029060	DUNCAN, JAMES C & LORETTA R	1	102,749	1000	10,302	1,034.00																																																																																																																		
2021	2021-660029060	CAMP, MICHAEL JOHN TRUSTEE	1	114,481	1000	11,593	1,020.00																																																																																																																		
2020	2020-660029060	CAMP, MICHAEL JOHN TRUSTEE	1	112,417	1000	11,232	995.00																																																																																																																		
2019	2019-660029060	CAMP, MICHAEL JOHN TRUSTEE	1	107,959	1000	10,875	977.00																																																																																																																		
2018	2018-660029060	CAMP, MICHAEL JOHN TRUSTEE	1	112,366	1000	11,360	1,014.00																																																																																																																		
2017	2017-660029060	CAMP, MICHAEL JOHN TRUSTEE	1	111,350	1000	11,209	1,012.00																																																																																																																		
2016	2016-660029060	CAMP, MICHAEL JOHN TRUSTEE	1	108,155	1000	10,853	965.00																																																																																																																		
2015	2015-660029060	CAMP, MICHAEL JOHN TRUSTEE	1	104,617	1000	10,508	939.00																																																																																																																		
2014	2014-660029060	CAMP, MICHAEL JOHN TRUSTEE	1	107,178	1000	10,790	976.00																																																																																																																		
2013	2013-660029060	CAMP, MICHAEL JOHN TRUSTEE	1	139,644	1000	13,370	1,197.00																																																																																																																		



# Rogers

## Assessment Property Record Card for Tax Year 2026

Data provided by LISA DELOZIER County Assessor

Date 04/16/2026  
Time 22:49:16  
Page 2

Lot Data		Square-Foot - NBHD 1045 #1		Primary Image						
Lot Size					<p>660029060_001.JPG 10/2/2025</p>					
Lot Count										
Units Buildable	1									
Non-Ag Acres	0.3975									
Topography										
Street Access										
Utilities										
Amenities	LAND QUALITY									0
										0
Method	Square-Foot									
Base Lot Value	17,314.00 x 2.45 = 42,419									
Factor Value										
Adjustments	1.0000									
Lot Value	42,419									
<b>Residential Data</b>				<b>GRM Approach</b>						
Type	1 Single Family Residence				<b>GRM Code</b>					
Condition	2 - Fair				<b>Gross Rent</b>		0.00			
Quality	2 - Fair				<b>Indicated Value</b>					
Architecture					<b>Multiple Regression</b>					
Style	100% 1 1/2 Story Finished				<b>MRA Code</b>		1 Test			
Exterior Wall	80% Veneer, Stone 20% Frame, Siding, Wood				<b>Adusted R</b>		0.8445			
Base/Total Area	1,670 / 2,510				<b>Indicated Value</b>		216,128 86.11 Per SqFt			
Style	100% 1 1/2 Story Finished				<b>Direct Comparables</b>					
HVAC	100% Warmed & Cooled Air				<b>Selection Model</b>		A Adam Test			
Roof Cover	1 Composition Shingle				<b>Adjustment Model</b>		1 2022 Residential			
Area on Slab	1,670				<b>Comparables</b>		1			
Fixture/RghIn	11 /				<b>Indicated Value</b>		166,600 Per SqFt			
Bed/F/H Bath	3 / 2.0 /				<b>Value Reconciliation</b>					
Basement Area					<b>Selected Approach</b>		Cost Approach			
Garage Type	680 Attached Garage - Finished				<b>Improvements</b>		136,971			
Remodel					<b>Lot Value</b>		42,419			
Year/Eff Age	1985 / 41				<b>Indicated Value</b>		179,390 71.47 Per SqFt			
<b>Cost Approach</b>				<b>Value Reconciliation</b>						
<b>Manual : 01/2025</b>				<b>Base Cost</b>		80.28		<b>Agland Value</b>		
<b>Roofing Adj</b>		+ 2.58		<b>Total Misc Impr</b>		+ 9,109		<b>Site Improvements</b>		560
<b>Subfloor Adj</b>		+ 0.00		<b>Garage Cost</b>		+ 18,748		<b>Total Value</b>		179,950 71.69 Total Value Per SqFt
<b>Heat/Cool Adj</b>		+ 10.30		<b>Total RCN</b>		= 274,339				
<b>Plumbing Adj</b>		+ 5.04		<b>Depreciation ( 51%)</b>		- 139,913				
<b>Basement Adj</b>		+ 0.00		<b>Lump Sums</b>		+ 2,545				
<b>Adj Base Cost</b>		= 98.20		<b>RCNLD</b>		= 136,971				
<b>Total Area</b>		x 2,510		<b>Lot Value</b>		+ 42,419				
<b>Adjusted Cost</b>		= 246,482		<b>Indicated Value</b>		= 179,390				
				<b>Value Per SqFt</b>		71.47				
<b>Miscellaneous Improvements</b>										
Code	Description	Sketch ID	Size	Year	Units	Unit Cost	Depr	Value		
FPR1	FIREPLACE - RESIDENTIAL 1 STORY	0		1	1	4,576.55		4,577		
PRCH	SLAB PORCH - COVERED	69525		220	220	20.60		4,532		
BALW	BALCONY - WOOD	69526		8x7	56	25.04		1,402		
WODO	WOOD DECK - OPEN	69528		504	504	15.12	85%	1,143		



# Rogers

## Assessment Property Record Card for Tax Year 2026

Data provided by LISA DELOZIER County Assessor

Date 04/16/2026  
 Time 22:49:16  
 Page 3

### Sketch Image

660029060

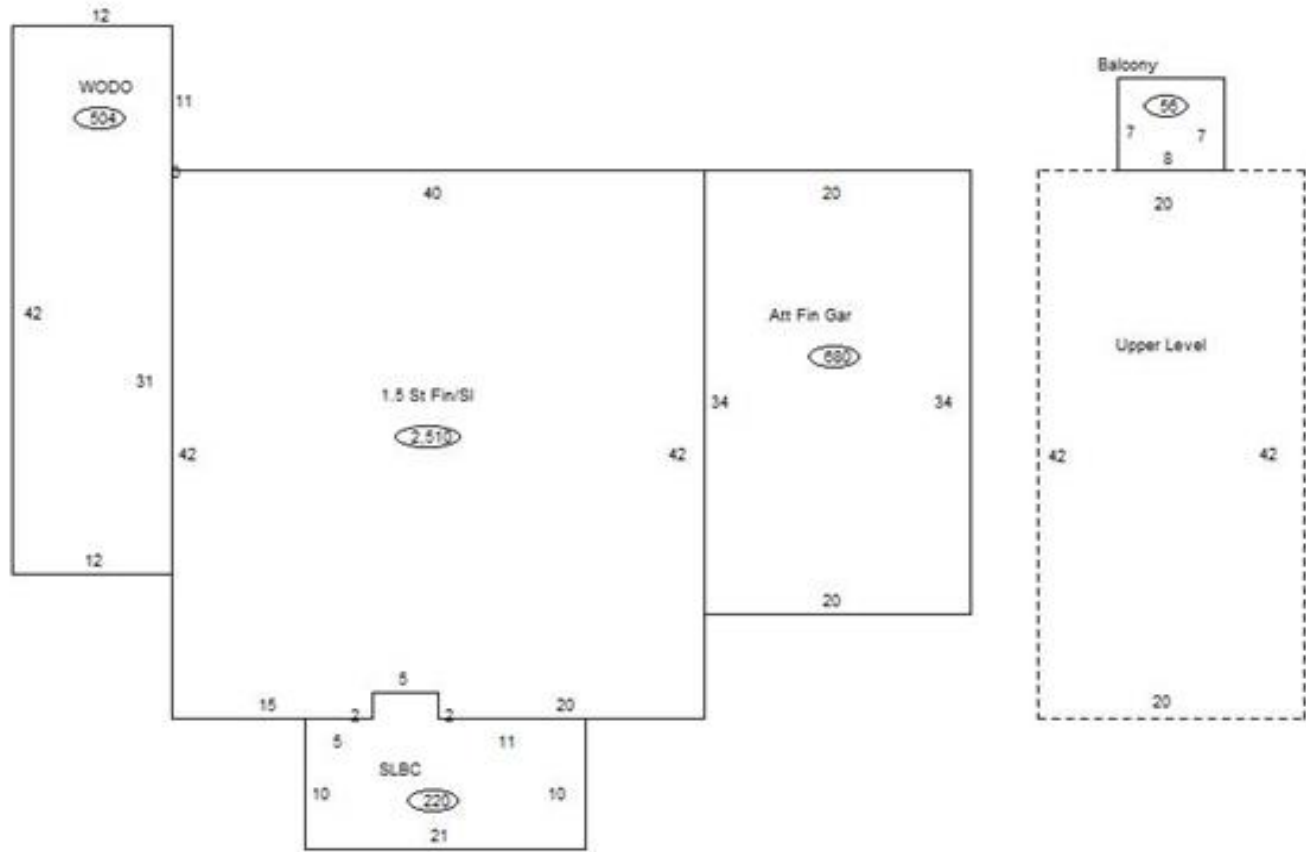

### Sketch Vector Information

Sequence	Code	Type	Built Over	Scale	Section Label	Base Area	Multiplier	Total Area
1	R	5	Slab	13	1.5 St Fin/SI	1,670	1.503	2,510
2	G	5		13	Att Fin Gar	680	1.000	680
3	M	PRCH		13	SLBC	220	1.000	220
4	M	BALW		13	Balcony	56	1.000	56
5	U	^UL	Overhang	13	Upper Level	840	1.000	840
6	M	WODO		13	WODO	504	1.000	504
<b>Total Building Area</b>						1,670		2,510



# Rogers

## Assessment Property Record Card for Tax Year 2026

Data provided by LISA DELOZIER County Assessor

Date 04/16/2026  
Time 22:49:16  
Page 4

660029060

### Outbuildings/Site Improvements

Building Image	Code	Description	Dimensions	Floor	Roofing	Total Units	
	SHDS	Shed - Small	6x6x7	Plank	Formed Metal	36	
	Qual	2	Cond 2	Year	2010	Eff Age	16
		<b>Valuation Summary</b>	<b>Modifier Total</b>	<b>RCN</b>	<b>Depr (52% Phys/ % Func)</b>	<b>RCNLD</b>	
		Base Cost (32.38 x 36)	1,166		1,166	606	560