



Rogers

Assessment Property Record Card for Tax Year 2026

Data provided by LISA DELOZIER County Assessor

Date 04/16/2026
Time 22:08:10
Page 1

Assessment Data					Primary Image				
Account	660029242				<p>660029242_002.JPG 12/19/2025</p>				
Parcel ID	20N17E-34-4-00000-000-0000								
Cadastral ID	34-20-17-00500								
Property Type	REAL - Real Property								
Property Class	RA	VI Area	3						
Tax Area	2 - INOLA RURAL								
Name ID	147704								
MURPHY, WILLIAM JAMES &									
CHARLOTTE ANN									
19705 E 590 RD									
INOLA OK 74036-0000									
Parcel Location									
Situs	19705 E 590 RD								
Subdivision									
Lot/Block	/	Parcel Size	5 - Acres						
Sec/Twn/Rng	34 / 20 / 17 / 4								
Neighborhood	2017 - UNPLATTED LAND								
School District	S005 - INOLA SCHOOLS								
Legal Description									
Lat/Long: 36.16336801 -95.47941408									
TR IN SE SE BEG: S/L SD PT BEING 888.73' W SE/C N 00 DEG W 50'; N 01-32-33 W 281.90'; N 89-12-05 W 30.58', N 01-19 W 377.78', W 309.76', S 660' TO NELY ROW HWY 33, E 355.31' TO POB									
Building Permits									
Number	Description	Opened	Closed	Amount					
Exemptions									
Code	Type	Active	Maximum	Exemption					
H	Homestead	Yes	1,000	1,000					
Sale History									
Bk/Pg	Grantor	Date	Price	Code					
941/186	MURPHY, CHARLES I	12/16/1993		0 No					
Parcel Valuation									
Source	REAL	Fair Cash	Capped	Asmnt Level	Assessed	Levy Rate	80.060	Current Tax	
Remove Cap	0	Land Value	410	410	11%	45	Assessed	9,558 765.21	
Year Frozen	0	Improvements	87,669	86,482		9,513	Penalty	0	
Uncapped Value	0	Mobile Home	0	0		0	Exemption	1,000 -80.00	
TIF Project ID	0	Total Value	88,079	86,892		9,558	Total Taxable	8,558 685.00	
Assessment History									
Tax Year	Statement Number	Billed Owner	Tax Area	Total Value	Exemptions	Taxable Value	Billed Tax		
2025	2025-660029242	MURPHY, WILLIAM JAMES &	2	84,362	1000	8,280	663.00		
2024	2024-660029242	MURPHY, WILLIAM JAMES &	2	89,913	1000	8,890	715.00		
2023	2023-660029242	MURPHY, WILLIAM JAMES &	2	95,280	1000	9,481	764.00		
2022	2022-660029242	MURPHY, WILLIAM JAMES &	2	97,279	1000	9,701	787.00		
2021	2021-660029242	MURPHY, WILLIAM JAMES &	2	110,306	1000	11,134	892.00		
2020	2020-660029242	MURPHY, WILLIAM JAMES &	2	108,244	1000	10,907	881.00		
2019	2019-660029242	MURPHY, WILLIAM JAMES &	2	105,116	1000	10,563	873.00		
2018	2018-660029242	MURPHY, WILLIAM JAMES &	2	110,891	1000	10,907	911.00		
2017	2017-660029242	MURPHY, WILLIAM JAMES &	2	110,991	1000	10,560	889.00		
2016	2016-660029242	MURPHY, WILLIAM JAMES &	2	107,734	1000	10,224	870.00		
2015	2015-660029242	MURPHY, WILLIAM JAMES &	2	104,119	1000	9,897	859.00		
2014	2014-660029242	MURPHY, WILLIAM JAMES &	2	108,061	1000	9,579	860.00		
2013	2013-660029242	MURPHY, WILLIAM JAMES &	2	103,430	1000	9,271	781.00		



Rogers

Assessment Property Record Card for Tax Year 2026

Data provided by LISA DELOZIER County Assessor

Date 04/16/2026
 Time 22:08:10
 Page 2

Lot Data	Units-Buildable - UNPLATTED LAND (UNITS BUILDABLE)	Primary Image
Lot Size		
Lot Count		
Units Buildable		
Non-Ag Acres	0	
Topography		
Street Access		
Utilities		
Amenities	LAND QUALITY	
Method	Units-Buildable	
Base Lot Value		
Factor Value		
Adjustments		
Lot Value		

Residential Data	
Type	1 Single Family Residence
Condition	2.5 - Fair
Quality	2 - Fair
Architecture	TRAD TRADITIONAL
Style	100% One Story
Exterior Wall	80% Veneer, Masonry 20% Frame, Plywood or Ha
Base/Total Area	1,600 / 1,600
Style	100% One Story
HVAC	100% Warmed & Cooled Air
Roof Cover	1 Composition Shingle
Area on Slab	0
Fixture/RghIn	11 /
Bed/F/H Bath	3 / 2.0 /
Basement Area	
Garage Type	576 Attached Garage - Finished 2 Stalls
Remodel	
Year/Eff Age	1969 / 50

GRM Approach	
GRM Code	
Gross Rent	0.00
Indicated Value	

Multiple Regression	
MRA Code	
Adusted R	
Indicated Value	

Direct Comparables	
Selection Model	1 Res
Adjustment Model	A2 AO Test
Comparables	
Indicated Value	

Cost Approach				Manual : 01/2025			
Base Cost	90.61	Total Misc Impr	+ 9,822				
Roofing Adj	+ 3.83	Garage Cost	+ 16,318				
Subfloor Adj	+ 2.31	Total RCN	= 210,076				
Heat/Cool Adj	+ 10.30	Depreciation (59%)	- 123,945				
Plumbing Adj	+ 7.91	Lump Sums	+ 0				
Basement Adj	+ 0.00	RCNLD	= 86,131				
Adj Base Cost	= 114.96	Lot Value	+ 86,131				
Total Area	x 1,600	Indicated Value	= 86,131				
Adjusted Cost	= 183,936	Value Per SqFt	53.83				

Value Reconciliation			
Selected Approach	Cost Approach		
Improvements	86,131		
Lot Value			
Indicated Value	86,131	53.83	Per SqFt
Agland Value	410		
Site Improvements	1,538		
Total Value	88,079	55.05	Total Value Per SqFt

Miscellaneous Improvements								
Code	Description	Sketch ID	Size	Year	Units	Unit Cost	Depr	Value
FPR1	FIREPLACE - RESIDENTIAL 1 STORY	0		1	1	4,576.55		4,577
PRCH	SLAB PORCH - COVERED	69871	32x8		256	20.49		5,245



Rogers

Assessment Property Record Card for Tax Year 2026

Data provided by LISA DELOZIER County Assessor

Date 04/16/2026
Time 22:08:10
Page 3

Sketch Image

660029242

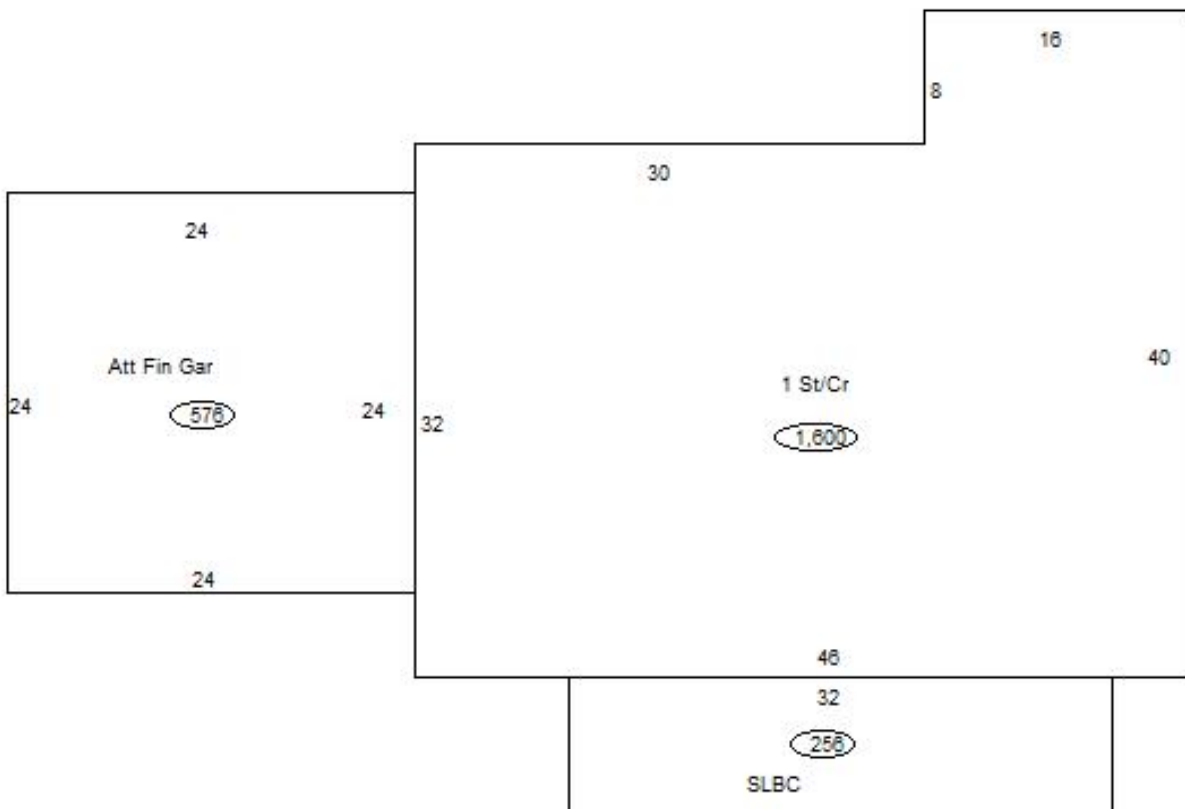

Sketch Vector Information

Sequence	Code	Type	Built Over	Scale	Section Label	Base Area	Multiplier	Total Area
1	R	1	Crawl	13	1 St/Cr	1,600	1.000	1,600
2	G	5		13	Att Fin Gar	576	1.000	576
3	M	PRCH		13	SLBC	256	1.000	256
Total Building Area						1,600		1,600



Rogers





Assessment Property Record Card for Tax Year 2026

Data provided by LISA DELOZIER County Assessor

Date 04/16/2026
 Time 22:08:10
 Page 4

660029242

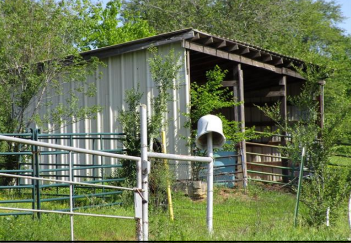
Outbuildings/Site Improvements

Building Image	Code	Description	Dimensions	Floor	Roofing	Total Units
	PCPT	Carport - Portable	20x25x12	Base	Formed Metal	500
	Qual	3	Cond 3	Year 2015	Eff Age 8	
	Valuation Summary		Modifier Total	RCN	Depr (100% Phys/ % Func)	RCNLD
	Base Cost (5.37 x 500)		2,685		2,685	2,685
	LOAF	LOAFING SHED	14x18x8	Dirt	Composition Shingle	252
	Qual	3	Cond 3	Year 2000	Eff Age 20	
	Valuation Summary		Modifier Total	RCN	Depr (59% Phys/ % Func)	RCNLD
	Base Cost (8.24 x 252)		2,076		2,076	1,225
	LOAF	LOAFING SHED	16x18x8	Dirt	Formed Metal	288
	Qual	3	Cond 3	Year 1995	Eff Age 23	
	Valuation Summary		Modifier Total	RCN	Depr (65% Phys/ % Func)	RCNLD
	Base Cost (6.82 x 288)		1,964		1,964	1,277
	BNV	BARN	0x0x0			
	Qual	3	Cond 3	Year 0	Eff Age 0	
	Valuation Summary		Modifier Total	RCN	Depr (100% Phys/ 0% Func)	RCNLD
	Base Cost (0.00 x)					



Rogers

Assessment Property Record Card for Tax Year 2026

Data provided by LISA DELOZIER County Assessor

Date 04/16/2026
Time 22:08:10
Page 5

Agland Inventory

660029242

Soi	Description	Land Use	LPI	Adj Type	Adj Code	Acres	Use/Acre	Mkt/Acre	Use Value	Market Value
BC	BATES-COLLINSVILLE COMPLE	IMP PST	51		0	1.250	143	143	179	179
CO	COLLINSVILLE STONY LOAM	IMP PST	22		0	3.750	62	62	231	231
IMP PST Totals						5.000			410	410
Total Agland						5.000			410	410