



# Rogers

## Assessment Property Record Card for Tax Year 2026

Data provided by LISA DELOZIER County Assessor

Date 04/16/2026  
Time 21:53:40  
Page 1

Assessment Data					Primary Image																																																																																																																				
<b>Account</b> 660029297 <b>Parcel ID</b> 000000-00-0-00507-002-0002 <b>Cadastral ID</b> 34-21-14-01470 <b>Property Type</b> REAL - Real Property <b>Property Class</b> RRP VI Area 4 <b>Tax Area</b> 3 - OWASSO RURAL/NO FIRE <b>Name ID</b> 337889 M COACH USA INC  946 CONESTOGA RD BRYN MAUR PA 19010-0000  <b>Parcel Location</b> <b>Situs</b> 14626 E 76TH ST N <b>Subdivision</b> MEADOWS THE <b>Lot/Block</b> 0002 / 0002 <b>Parcel Size</b> 1 - Lots <b>Sec/Twn/Rng</b> 34 / 21 / 14 / 5 <b>Neighborhood</b> 1212 - R-V04-SW OWASSO <b>School District</b> S021 - OWASSO SCHOOLS																																																																																																																									
<b>Legal Description</b> Lot/Long: 36.26365943 -95.80947093																																																																																																																									
<b>Building Permits</b>					<table border="1"> <thead> <tr> <th>Number</th> <th>Description</th> <th>Opened</th> <th>Closed</th> <th>Amount</th> </tr> </thead> <tbody> <tr> <td></td> <td></td> <td></td> <td></td> <td></td> </tr> </tbody> </table>					Number	Description	Opened	Closed	Amount																																																																																																											
Number	Description	Opened	Closed	Amount																																																																																																																					
<b>Exemptions</b>					<b>Sale History</b>																																																																																																																				
<table border="1"> <thead> <tr> <th>Code</th> <th>Type</th> <th>Active</th> <th>Maximum</th> <th>Exemption</th> </tr> </thead> <tbody> <tr> <td>H</td> <td>Homestead</td> <td>No</td> <td>1,000</td> <td></td> </tr> </tbody> </table>					Code	Type	Active	Maximum	Exemption	H	Homestead	No	1,000		<table border="1"> <thead> <tr> <th>Bk/Pg</th> <th>Grantor</th> <th>Date</th> <th>Price</th> <th>Code</th> </tr> </thead> <tbody> <tr> <td>/</td> <td>NARUSZEWICZ, VICKIE LYNN</td> <td>03/25/2022</td> <td>240,000</td> <td>YES</td> </tr> <tr> <td>2465/737</td> <td>NARUSZEWICZ, HENRY &amp; VICKIE LYN</td> <td>03/10/2015</td> <td>0</td> <td>4</td> </tr> <tr> <td>885/678</td> <td>MENDENHALL, GINGER K</td> <td>06/26/1992</td> <td>77,500</td> <td>Yes</td> </tr> </tbody> </table>					Bk/Pg	Grantor	Date	Price	Code	/	NARUSZEWICZ, VICKIE LYNN	03/25/2022	240,000	YES	2465/737	NARUSZEWICZ, HENRY & VICKIE LYN	03/10/2015	0	4	885/678	MENDENHALL, GINGER K	06/26/1992	77,500	Yes																																																																																		
Code	Type	Active	Maximum	Exemption																																																																																																																					
H	Homestead	No	1,000																																																																																																																						
Bk/Pg	Grantor	Date	Price	Code																																																																																																																					
/	NARUSZEWICZ, VICKIE LYNN	03/25/2022	240,000	YES																																																																																																																					
2465/737	NARUSZEWICZ, HENRY & VICKIE LYN	03/10/2015	0	4																																																																																																																					
885/678	MENDENHALL, GINGER K	06/26/1992	77,500	Yes																																																																																																																					
<b>Parcel Valuation</b>																																																																																																																									
<table border="1"> <thead> <tr> <th>Source</th> <th>REAL</th> <th>Fair Cash</th> <th>Capped</th> <th>Asmnt Level</th> <th>Assessed</th> <th>Levy Rate</th> <th>97.960</th> <th>Current Tax</th> </tr> </thead> <tbody> <tr> <td>Remove Cap</td> <td>2023</td> <td>Land Value</td> <td>102,881</td> <td>102,881</td> <td>11%</td> <td>11,317</td> <td>Assessed</td> <td>27,629</td> </tr> <tr> <td>Year Frozen</td> <td>0</td> <td>Improvements</td> <td>148,287</td> <td>148,287</td> <td></td> <td>16,312</td> <td>Penalty</td> <td>0</td> </tr> <tr> <td>Uncapped Value</td> <td>0</td> <td>Mobile Home</td> <td>0</td> <td>0</td> <td></td> <td>0</td> <td>Exemption</td> <td>0</td> </tr> <tr> <td>TIF Project ID</td> <td>0</td> <td>Total Value</td> <td>251,168</td> <td>251,168</td> <td></td> <td>27,629</td> <td>Total Taxable</td> <td>27,629</td> </tr> </tbody> </table>		Source	REAL	Fair Cash	Capped	Asmnt Level	Assessed	Levy Rate	97.960	Current Tax	Remove Cap	2023	Land Value	102,881	102,881	11%	11,317	Assessed	27,629	Year Frozen	0	Improvements	148,287	148,287		16,312	Penalty	0	Uncapped Value	0	Mobile Home	0	0		0	Exemption	0	TIF Project ID	0	Total Value	251,168	251,168		27,629	Total Taxable	27,629																																																																											
Source	REAL	Fair Cash	Capped	Asmnt Level	Assessed	Levy Rate	97.960	Current Tax																																																																																																																	
Remove Cap	2023	Land Value	102,881	102,881	11%	11,317	Assessed	27,629																																																																																																																	
Year Frozen	0	Improvements	148,287	148,287		16,312	Penalty	0																																																																																																																	
Uncapped Value	0	Mobile Home	0	0		0	Exemption	0																																																																																																																	
TIF Project ID	0	Total Value	251,168	251,168		27,629	Total Taxable	27,629																																																																																																																	
<b>Assessment History</b>																																																																																																																									
<table border="1"> <thead> <tr> <th>Tax Year</th> <th>Statement Number</th> <th>Billed Owner</th> <th>Tax Area</th> <th>Total Value</th> <th>Exemptions</th> <th>Taxable Value</th> <th>Billed Tax</th> </tr> </thead> <tbody> <tr><td>2025</td><td>2025-660029297</td><td>M COACH USA INC</td><td>3</td><td>246,205</td><td>0</td><td>27,083</td><td>2,653.00</td></tr> <tr><td>2024</td><td>2024-660029297</td><td>M COACH USA INC</td><td>3</td><td>264,496</td><td>0</td><td>27,720</td><td>2,663.00</td></tr> <tr><td>2023</td><td>2023-660029297</td><td>M COACH USA INC</td><td>3</td><td>240,000</td><td>0</td><td>26,400</td><td>2,474.00</td></tr> <tr><td>2022</td><td>2022-660029297</td><td>M COACH USA INC</td><td>3</td><td>159,270</td><td>1000</td><td>16,520</td><td>1,618.00</td></tr> <tr><td>2021</td><td>2021-660029297</td><td>NARUSZEWICZ, VICKIE LYNN</td><td>3</td><td>170,194</td><td>1000</td><td>16,019</td><td>1,550.00</td></tr> <tr><td>2020</td><td>2020-660029297</td><td>NARUSZEWICZ, VICKIE LYNN</td><td>3</td><td>167,567</td><td>1000</td><td>15,524</td><td>1,500.00</td></tr> <tr><td>2019</td><td>2019-660029297</td><td>NARUSZEWICZ, VICKIE LYNN</td><td>3</td><td>161,319</td><td>1000</td><td>15,043</td><td>1,454.00</td></tr> <tr><td>2018</td><td>2018-660029297</td><td>NARUSZEWICZ, VICKIE LYNN</td><td>3</td><td>165,982</td><td>1000</td><td>14,576</td><td>1,357.00</td></tr> <tr><td>2017</td><td>2017-660029297</td><td>NARUSZEWICZ, VICKIE LYNN</td><td>3</td><td>164,677</td><td>1000</td><td>14,122</td><td>1,328.00</td></tr> <tr><td>2016</td><td>2016-660029297</td><td>NARUSZEWICZ, VICKIE LYNN</td><td>3</td><td>160,658</td><td>1000</td><td>13,682</td><td>1,288.00</td></tr> <tr><td>2015</td><td>2015-660029297</td><td>NARUSZEWICZ, VICKIE LYNN</td><td>3</td><td>155,914</td><td>1000</td><td>13,254</td><td>1,257.00</td></tr> <tr><td>2014</td><td>2014-660029297</td><td>NARUSZEWICZ, HENRY &amp; VICKIE LYNN</td><td>3</td><td>157,089</td><td>1000</td><td>12,838</td><td>1,229.00</td></tr> <tr><td>2013</td><td>2013-660029297</td><td>NARUSZEWICZ, HENRY &amp; VICKIE LYNN</td><td>3</td><td>149,332</td><td>1000</td><td>12,435</td><td>1,165.00</td></tr> </tbody> </table>										Tax Year	Statement Number	Billed Owner	Tax Area	Total Value	Exemptions	Taxable Value	Billed Tax	2025	2025-660029297	M COACH USA INC	3	246,205	0	27,083	2,653.00	2024	2024-660029297	M COACH USA INC	3	264,496	0	27,720	2,663.00	2023	2023-660029297	M COACH USA INC	3	240,000	0	26,400	2,474.00	2022	2022-660029297	M COACH USA INC	3	159,270	1000	16,520	1,618.00	2021	2021-660029297	NARUSZEWICZ, VICKIE LYNN	3	170,194	1000	16,019	1,550.00	2020	2020-660029297	NARUSZEWICZ, VICKIE LYNN	3	167,567	1000	15,524	1,500.00	2019	2019-660029297	NARUSZEWICZ, VICKIE LYNN	3	161,319	1000	15,043	1,454.00	2018	2018-660029297	NARUSZEWICZ, VICKIE LYNN	3	165,982	1000	14,576	1,357.00	2017	2017-660029297	NARUSZEWICZ, VICKIE LYNN	3	164,677	1000	14,122	1,328.00	2016	2016-660029297	NARUSZEWICZ, VICKIE LYNN	3	160,658	1000	13,682	1,288.00	2015	2015-660029297	NARUSZEWICZ, VICKIE LYNN	3	155,914	1000	13,254	1,257.00	2014	2014-660029297	NARUSZEWICZ, HENRY & VICKIE LYNN	3	157,089	1000	12,838	1,229.00	2013	2013-660029297	NARUSZEWICZ, HENRY & VICKIE LYNN	3	149,332	1000	12,435	1,165.00
Tax Year	Statement Number	Billed Owner	Tax Area	Total Value	Exemptions	Taxable Value	Billed Tax																																																																																																																		
2025	2025-660029297	M COACH USA INC	3	246,205	0	27,083	2,653.00																																																																																																																		
2024	2024-660029297	M COACH USA INC	3	264,496	0	27,720	2,663.00																																																																																																																		
2023	2023-660029297	M COACH USA INC	3	240,000	0	26,400	2,474.00																																																																																																																		
2022	2022-660029297	M COACH USA INC	3	159,270	1000	16,520	1,618.00																																																																																																																		
2021	2021-660029297	NARUSZEWICZ, VICKIE LYNN	3	170,194	1000	16,019	1,550.00																																																																																																																		
2020	2020-660029297	NARUSZEWICZ, VICKIE LYNN	3	167,567	1000	15,524	1,500.00																																																																																																																		
2019	2019-660029297	NARUSZEWICZ, VICKIE LYNN	3	161,319	1000	15,043	1,454.00																																																																																																																		
2018	2018-660029297	NARUSZEWICZ, VICKIE LYNN	3	165,982	1000	14,576	1,357.00																																																																																																																		
2017	2017-660029297	NARUSZEWICZ, VICKIE LYNN	3	164,677	1000	14,122	1,328.00																																																																																																																		
2016	2016-660029297	NARUSZEWICZ, VICKIE LYNN	3	160,658	1000	13,682	1,288.00																																																																																																																		
2015	2015-660029297	NARUSZEWICZ, VICKIE LYNN	3	155,914	1000	13,254	1,257.00																																																																																																																		
2014	2014-660029297	NARUSZEWICZ, HENRY & VICKIE LYNN	3	157,089	1000	12,838	1,229.00																																																																																																																		
2013	2013-660029297	NARUSZEWICZ, HENRY & VICKIE LYNN	3	149,332	1000	12,435	1,165.00																																																																																																																		



# Rogers

## Assessment Property Record Card for Tax Year 2026

Data provided by LISA DELOZIER County Assessor

Date 04/16/2026  
Time 21:53:40  
Page 2

Lot Data	Square-Foot - NBHD 1212 #1	Primary Image
<b>Lot Size</b> <b>Lot Count</b> <b>Units Buildable</b> 14000 <b>Non-Ag Acres</b> 0.8747 <b>Topography</b> <b>Street Access</b> <b>Utilities</b> <b>Amenities</b> LAND QUALITY 0 0 <b>Method</b> Square-Foot <b>Base Lot Value</b> 38,104.00 x 2.70 = 102,881 <b>Factor Value</b> <b>Adjustments</b> 1.0000 <b>Lot Value</b> 102,881		

Residential Data	
<b>Type</b>	1 Single Family Residence
<b>Condition</b>	3 - Average
<b>Quality</b>	3 - Average
<b>Architecture</b>	
<b>Style</b>	100% One Story
<b>Exterior Wall</b>	100% Veneer, Masonry
<b>Base/Total Area</b>	1,804 / 1,804
<b>Style</b>	100% One Story
<b>HVAC</b>	100% Warmed & Cooled Air
<b>Roof Cover</b>	1 Composition Shingle
<b>Area on Slab</b>	1,804
<b>Fixture/RghIn</b>	11 /
<b>Bed/F/H Bath</b>	3 / 2.0 /
<b>Basement Area</b>	
<b>Garage Type</b>	420 Attached Garage - Unfinished 2 Stalls
<b>Remodel</b>	
<b>Year/Eff Age</b>	1977 / 37



\\tsclient\TCASEY\CASEY BOOTH RESIDENTIAL VI\2022-6-23\ 6/23/2022

GRM Approach	
<b>GRM Code</b>	
<b>Gross Rent</b>	0.00
<b>Indicated Value</b>	

Multiple Regression			
<b>MRA Code</b>	1	Test	
<b>Adjusted R</b>	0.8445		
<b>Indicated Value</b>	194,264	107.69	Per SqFt

Direct Comparables			
<b>Selection Model</b>	A	Adam Test	
<b>Adjustment Model</b>	1	2022 Residential	
<b>Comparables</b>	3		
<b>Indicated Value</b>	263,790		Per SqFt

Cost Approach				Manual : 01/2025			
<b>Base Cost</b>	107.42	<b>Total Misc Impr</b>	+	14,570			
<b>Roofing Adj</b>	+ 4.69	<b>Garage Cost</b>	+	14,049			
<b>Subfloor Adj</b>	+ -2.43	<b>Total RCN</b>	=	264,799			
<b>Heat/Cool Adj</b>	+ 12.64	<b>Depreciation ( 44%)</b>	-	116,512			
<b>Plumbing Adj</b>	+ 8.60	<b>Lump Sums</b>	+	0			
<b>Basement Adj</b>	+ 0.00	<b>RCNLD</b>	=	148,287			
<b>Adj Base Cost</b>	= 130.92	<b>Lot Value</b>	+	102,881			
<b>Total Area</b>	x 1,804	<b>Indicated Value</b>	=	251,168			
<b>Adjusted Cost</b>	= 236,180	<b>Value Per SqFt</b>		139.23			

Value Reconciliation			
<b>Selected Approach</b>	Cost Approach		
<b>Improvements</b>	148,287		
<b>Lot Value</b>	102,881		
<b>Indicated Value</b>	251,168	139.23	Per SqFt
<b>Agland Value</b>			
<b>Site Improvements</b>			
<b>Total Value</b>	251,168	139.23	Total Value Per SqFt

Miscellaneous Improvements								
Code	Description	Sketch ID	Size	Year	Units	Unit Cost	Depr	Value
FPR1	FIREPLACE - RESIDENTIAL 1 STORY	0		1	1	5,615.40		5,615
PRCH	SLAB PORCH - COVERED	70004	17x5		85	26.66		2,266
PRCH	SLAB PORCH - COVERED	70005	16x16		256	26.13		6,689



# Rogers

## Assessment Property Record Card for Tax Year 2026

Data provided by LISA DELOZIER County Assessor

Date 04/16/2026  
 Time 21:53:40  
 Page 3

### Sketch Image

660029297

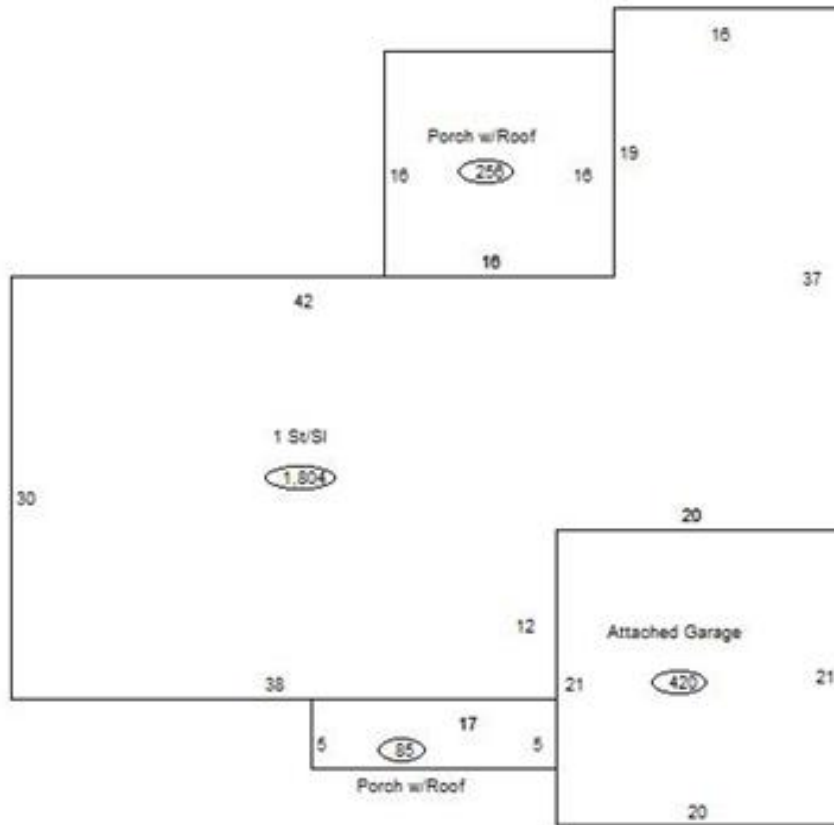

### Sketch Vector Information

Sequence	Code	Type	Built Over	Scale	Section Label	Base Area	Multiplier	Total Area
1	R	1	Slab	13	1 St/SI	1,804	1.000	1,804
2	G	1		13	Attached Garage	420	1.000	420
3	M	PRCH		13	SLBC	85	1.000	85
4	M	PRCH		13	SLBC	256	1.000	256
<b>Total Building Area</b>						1,804		1,804