



Rogers

Assessment Property Record Card for Tax Year 2026

Data provided by LISA DELOZIER County Assessor

Date 04/16/2026
Time 21:53:51
Page 1

Assessment Data					Primary Image																																																																																																																				
Account 660029310 Parcel ID 000000-00-0-00507-002-0015 Cadastral ID 34-21-14-01600 Property Type REAL - Real Property Property Class RRP VI Area 4 Tax Area 3 - OWASSO RURAL/NO FIRE Name ID 347306 STOUT, CHRISTOPHER ROBERT & GINA MARIE LAQUE 7408 N 147TH E AVE OWASSO OK 74055-0000 Parcel Location Situs 07408 N 147TH E AVE Subdivision MEADOWS THE Lot/Block 0015 / 0002 Parcel Size 1 - Lots Sec/Twn/Rng 34 / 21 / 14 / 5 Neighborhood 1212 - R-V04-SW OWASSO School District S021 - OWASSO SCHOOLS																																																																																																																									
\\tsclient\T\TOMMY DUNLAP\New folder (542)\IMG_0007.JPG 12/22/2025																																																																																																																									
Legal Description					Building Permits																																																																																																																				
Lat/Long: 36.26095495 -95.80905479 LOT 15 BLOCK 2 MEADOWS, THE					<table border="1"> <thead> <tr> <th>Number</th> <th>Description</th> <th>Opened</th> <th>Closed</th> <th>Amount</th> </tr> </thead> <tbody> <tr> <td> </td> <td> </td> <td> </td> <td> </td> <td> </td> </tr> </tbody> </table>					Number	Description	Opened	Closed	Amount																																																																																																											
Number	Description	Opened	Closed	Amount																																																																																																																					
Exemptions					Sale History																																																																																																																				
<table border="1"> <thead> <tr> <th>Code</th> <th>Type</th> <th>Active</th> <th>Maximum</th> <th>Exemption</th> </tr> </thead> <tbody> <tr> <td>H</td> <td>Homestead</td> <td>No</td> <td>1,000</td> <td> </td> </tr> </tbody> </table>					Code	Type	Active	Maximum	Exemption	H	Homestead	No	1,000		<table border="1"> <thead> <tr> <th>Bk/Pg</th> <th>Grantor</th> <th>Date</th> <th>Price</th> <th>Code</th> </tr> </thead> <tbody> <tr> <td>/</td> <td>SANDERS, BILLY LANCE &</td> <td>06/09/2025</td> <td>370,000</td> <td>20</td> </tr> <tr> <td>/</td> <td>RUSSELL, SANDRA SUE</td> <td>10/25/2022</td> <td>252,500</td> <td>YES</td> </tr> </tbody> </table>					Bk/Pg	Grantor	Date	Price	Code	/	SANDERS, BILLY LANCE &	06/09/2025	370,000	20	/	RUSSELL, SANDRA SUE	10/25/2022	252,500	YES																																																																																							
Code	Type	Active	Maximum	Exemption																																																																																																																					
H	Homestead	No	1,000																																																																																																																						
Bk/Pg	Grantor	Date	Price	Code																																																																																																																					
/	SANDERS, BILLY LANCE &	06/09/2025	370,000	20																																																																																																																					
/	RUSSELL, SANDRA SUE	10/25/2022	252,500	YES																																																																																																																					
Parcel Valuation																																																																																																																									
<table border="1"> <thead> <tr> <th>Source</th> <th>REAL</th> <th>Fair Cash</th> <th>Capped</th> <th>Asmnt Level</th> <th>Assessed</th> <th>Levy Rate</th> <th>97.960</th> <th>Current Tax</th> </tr> </thead> <tbody> <tr> <td>Remove Cap</td> <td>2026</td> <td>Land Value</td> <td>102,851</td> <td>102,851</td> <td>11%</td> <td>11,314</td> <td>Assessed</td> <td>41,008</td> </tr> <tr> <td>Year Frozen</td> <td>2019</td> <td>Improvements</td> <td>269,945</td> <td>269,945</td> <td> </td> <td>29,694</td> <td>Penalty</td> <td>0</td> </tr> <tr> <td>Uncapped Value</td> <td>7,383</td> <td>Mobile Home</td> <td>0</td> <td>0</td> <td>0</td> <td>0</td> <td>Exemption</td> <td>0</td> </tr> <tr> <td>TIF Project ID</td> <td>0</td> <td>Total Value</td> <td>372,796</td> <td>372,796</td> <td>41,008</td> <td>Total Taxable</td> <td>41,008</td> <td>4,017.00</td> </tr> </tbody> </table>		Source	REAL	Fair Cash	Capped	Asmnt Level	Assessed	Levy Rate	97.960	Current Tax	Remove Cap	2026	Land Value	102,851	102,851	11%	11,314	Assessed	41,008	Year Frozen	2019	Improvements	269,945	269,945		29,694	Penalty	0	Uncapped Value	7,383	Mobile Home	0	0	0	0	Exemption	0	TIF Project ID	0	Total Value	372,796	372,796	41,008	Total Taxable	41,008	4,017.00	<table border="1"> <thead> <tr> <th>Code</th> <th>Type</th> <th>Active</th> <th>Maximum</th> <th>Exemption</th> <th>Bk/Pg</th> <th>Grantor</th> <th>Date</th> <th>Price</th> <th>Code</th> </tr> </thead> <tbody> <tr> <td>H</td> <td>Homestead</td> <td>No</td> <td>1,000</td> <td> </td> <td>/</td> <td>SANDERS, BILLY LANCE &</td> <td>06/09/2025</td> <td>370,000</td> <td>20</td> </tr> <tr> <td> </td> <td> </td> <td> </td> <td> </td> <td> </td> <td>/</td> <td>RUSSELL, SANDRA SUE</td> <td>10/25/2022</td> <td>252,500</td> <td>YES</td> </tr> </tbody> </table>								Code	Type	Active	Maximum	Exemption	Bk/Pg	Grantor	Date	Price	Code	H	Homestead	No	1,000		/	SANDERS, BILLY LANCE &	06/09/2025	370,000	20						/	RUSSELL, SANDRA SUE	10/25/2022	252,500	YES																																					
Source	REAL	Fair Cash	Capped	Asmnt Level	Assessed	Levy Rate	97.960	Current Tax																																																																																																																	
Remove Cap	2026	Land Value	102,851	102,851	11%	11,314	Assessed	41,008																																																																																																																	
Year Frozen	2019	Improvements	269,945	269,945		29,694	Penalty	0																																																																																																																	
Uncapped Value	7,383	Mobile Home	0	0	0	0	Exemption	0																																																																																																																	
TIF Project ID	0	Total Value	372,796	372,796	41,008	Total Taxable	41,008	4,017.00																																																																																																																	
Code	Type	Active	Maximum	Exemption	Bk/Pg	Grantor	Date	Price	Code																																																																																																																
H	Homestead	No	1,000		/	SANDERS, BILLY LANCE &	06/09/2025	370,000	20																																																																																																																
					/	RUSSELL, SANDRA SUE	10/25/2022	252,500	YES																																																																																																																
Assessment History																																																																																																																									
<table border="1"> <thead> <tr> <th>Tax Year</th> <th>Statement Number</th> <th>Billed Owner</th> <th>Tax Area</th> <th>Total Value</th> <th>Exemptions</th> <th>Taxable Value</th> <th>Billed Tax</th> </tr> </thead> <tbody> <tr> <td>2025</td> <td>2025-660029310</td> <td>STOUT, CHRISTOPHER ROBERT &</td> <td>3</td> <td>305,907</td> <td>0</td> <td>30,622</td> <td>3,000.00</td> </tr> <tr> <td>2024</td> <td>2024-660029310</td> <td>SANDERS, BILLY LANCE &</td> <td>3</td> <td>346,465</td> <td>0</td> <td>29,163</td> <td>2,802.00</td> </tr> <tr> <td>2023</td> <td>2023-660029310</td> <td>SANDERS, BILLY LANCE &</td> <td>3</td> <td>252,500</td> <td>0</td> <td>27,775</td> <td>2,603.00</td> </tr> <tr> <td>2022</td> <td>2022-660029310</td> <td>RUSSELL, JOHN A &</td> <td>3</td> <td>229,858</td> <td>0</td> <td>21,514</td> <td>2,108.00</td> </tr> <tr> <td>2021</td> <td>2021-660029310</td> <td>RUSSELL, JOHN A &</td> <td>3</td> <td>223,140</td> <td>1000</td> <td>19,490</td> <td>1,885.00</td> </tr> <tr> <td>2020</td> <td>2020-660029310</td> <td>RUSSELL, JOHN A &</td> <td>3</td> <td>221,749</td> <td>1000</td> <td>19,490</td> <td>1,883.00</td> </tr> <tr> <td>2019</td> <td>2019-660029310</td> <td>RUSSELL, JOHN A &</td> <td>3</td> <td>210,657</td> <td>1000</td> <td>19,490</td> <td>1,884.00</td> </tr> <tr> <td>2018</td> <td>2018-660029310</td> <td>RUSSELL, JOHN A &</td> <td>3</td> <td>216,851</td> <td>1000</td> <td>18,893</td> <td>1,759.00</td> </tr> <tr> <td>2017</td> <td>2017-660029310</td> <td>RUSSELL, JOHN A &</td> <td>3</td> <td>215,031</td> <td>1000</td> <td>18,314</td> <td>1,723.00</td> </tr> <tr> <td>2016</td> <td>2016-660029310</td> <td>RUSSELL, JOHN A &</td> <td>3</td> <td>209,508</td> <td>1000</td> <td>17,751</td> <td>1,671.00</td> </tr> <tr> <td>2015</td> <td>2015-660029310</td> <td>RUSSELL, JOHN A &</td> <td>3</td> <td>203,579</td> <td>1000</td> <td>17,205</td> <td>1,632.00</td> </tr> <tr> <td>2014</td> <td>2014-660029310</td> <td>RUSSELL, JOHN A &</td> <td>3</td> <td>200,709</td> <td>1000</td> <td>16,675</td> <td>1,596.00</td> </tr> <tr> <td>2013</td> <td>2013-660029310</td> <td>RUSSELL, JOHN A &</td> <td>3</td> <td>191,742</td> <td>1000</td> <td>16,160</td> <td>1,514.00</td> </tr> </tbody> </table>										Tax Year	Statement Number	Billed Owner	Tax Area	Total Value	Exemptions	Taxable Value	Billed Tax	2025	2025-660029310	STOUT, CHRISTOPHER ROBERT &	3	305,907	0	30,622	3,000.00	2024	2024-660029310	SANDERS, BILLY LANCE &	3	346,465	0	29,163	2,802.00	2023	2023-660029310	SANDERS, BILLY LANCE &	3	252,500	0	27,775	2,603.00	2022	2022-660029310	RUSSELL, JOHN A &	3	229,858	0	21,514	2,108.00	2021	2021-660029310	RUSSELL, JOHN A &	3	223,140	1000	19,490	1,885.00	2020	2020-660029310	RUSSELL, JOHN A &	3	221,749	1000	19,490	1,883.00	2019	2019-660029310	RUSSELL, JOHN A &	3	210,657	1000	19,490	1,884.00	2018	2018-660029310	RUSSELL, JOHN A &	3	216,851	1000	18,893	1,759.00	2017	2017-660029310	RUSSELL, JOHN A &	3	215,031	1000	18,314	1,723.00	2016	2016-660029310	RUSSELL, JOHN A &	3	209,508	1000	17,751	1,671.00	2015	2015-660029310	RUSSELL, JOHN A &	3	203,579	1000	17,205	1,632.00	2014	2014-660029310	RUSSELL, JOHN A &	3	200,709	1000	16,675	1,596.00	2013	2013-660029310	RUSSELL, JOHN A &	3	191,742	1000	16,160	1,514.00
Tax Year	Statement Number	Billed Owner	Tax Area	Total Value	Exemptions	Taxable Value	Billed Tax																																																																																																																		
2025	2025-660029310	STOUT, CHRISTOPHER ROBERT &	3	305,907	0	30,622	3,000.00																																																																																																																		
2024	2024-660029310	SANDERS, BILLY LANCE &	3	346,465	0	29,163	2,802.00																																																																																																																		
2023	2023-660029310	SANDERS, BILLY LANCE &	3	252,500	0	27,775	2,603.00																																																																																																																		
2022	2022-660029310	RUSSELL, JOHN A &	3	229,858	0	21,514	2,108.00																																																																																																																		
2021	2021-660029310	RUSSELL, JOHN A &	3	223,140	1000	19,490	1,885.00																																																																																																																		
2020	2020-660029310	RUSSELL, JOHN A &	3	221,749	1000	19,490	1,883.00																																																																																																																		
2019	2019-660029310	RUSSELL, JOHN A &	3	210,657	1000	19,490	1,884.00																																																																																																																		
2018	2018-660029310	RUSSELL, JOHN A &	3	216,851	1000	18,893	1,759.00																																																																																																																		
2017	2017-660029310	RUSSELL, JOHN A &	3	215,031	1000	18,314	1,723.00																																																																																																																		
2016	2016-660029310	RUSSELL, JOHN A &	3	209,508	1000	17,751	1,671.00																																																																																																																		
2015	2015-660029310	RUSSELL, JOHN A &	3	203,579	1000	17,205	1,632.00																																																																																																																		
2014	2014-660029310	RUSSELL, JOHN A &	3	200,709	1000	16,675	1,596.00																																																																																																																		
2013	2013-660029310	RUSSELL, JOHN A &	3	191,742	1000	16,160	1,514.00																																																																																																																		



Rogers

Assessment Property Record Card for Tax Year 2026

Data provided by LISA DELOZIER County Assessor

Date 04/16/2026
Time 21:53:51
Page 2

Lot Data	Square-Foot - NBHD 1212 #1	Primary Image
Lot Size		
Lot Count		
Units Buildable	14000	
Non-Ag Acres	0.8745	
Topography		
Street Access		
Utilities		
Amenities	LAND QUALITY	
	0	
	0	
Method	Square-Foot	
Base Lot Value	38,093.00 x 2.70 = 102,851	
Factor Value		
Adjustments	1.0000	
Lot Value	102,851	

Residential Data	
Type	1 Single Family Residence
Condition	3 - Average
Quality	3.5 - Average
Architecture	
Style	100% One Story
Exterior Wall	100% Veneer, Stone
Base/Total Area	2,243 / 2,243
Style	100% One Story
HVAC	100% Warmed & Cooled Air
Roof Cover	1 Composition Shingle
Area on Slab	2,243
Fixture/RghIn	11 /
Bed/F/H Bath	3 / 2.0 /
Basement Area	
Garage Type	648 Attached Garage - Unfinished
Remodel	PARTIAL -
Year/Eff Age	1978 / 24



\\tsclient\T\TOMMY DUNLAP\New folder (542)\IMG_0007.JPG 12/22/2025

GRM Approach	
GRM Code	
Gross Rent	0.00
Indicated Value	

Multiple Regression			
MRA Code	1	Test	
Adusted R	0.8445		
Indicated Value	290,038	129.31	Per SqFt

Direct Comparables			
Selection Model	A	Adam Test	
Adjustment Model	1	2022 Residential	
Comparables	5		
Indicated Value	278,370		Per SqFt

Cost Approach				Manual : 01/2025			
Base Cost	115.66	Total Misc Impr	+	21,329			
Roofing Adj	+ 5.24	Garage Cost	+	24,488			
Subfloor Adj	+ -3.40	Total RCN	=	359,590			
Heat/Cool Adj	+ 14.47	Depreciation (29%)	-	104,281			
Plumbing Adj	+ 7.92	Lump Sums	+	0			
Basement Adj	+ 0.00	RCNLD	=	255,309			
Adj Base Cost	= 139.89	Lot Value	+	102,851			
Total Area	x 2,243	Indicated Value	=	358,160			
Adjusted Cost	= 313,773	Value Per SqFt		159.68			

Value Reconciliation			
Selected Approach	Cost Approach		
Improvements	255,309		
Lot Value	102,851		
Indicated Value	358,160	159.68	Per SqFt
Agland Value			
Site Improvements	14,636		
Total Value	372,796	166.20	Total Value Per SqFt

Miscellaneous Improvements								
Code	Description	Sketch ID	Size	Year	Units	Unit Cost	Depr	Value
FPR1	FIREPLACE - RESIDENTIAL 1 STORY	0		1	1	6,429.63		6,430
FPR1	FIREPLACE - RESIDENTIAL 1 STORY	0		1	1	6,429.63		6,430
PRCH	SLAB PORCH - COVERED	70059	172		172	28.91		4,973
PRCH	SLAB PORCH - COVERED	70060	12x10		120	29.13		3,496



Rogers

Assessment Property Record Card for Tax Year 2026

Data provided by LISA DELOZIER County Assessor

Date 04/16/2026
 Time 21:53:51
 Page 3

Sketch Image

660029310

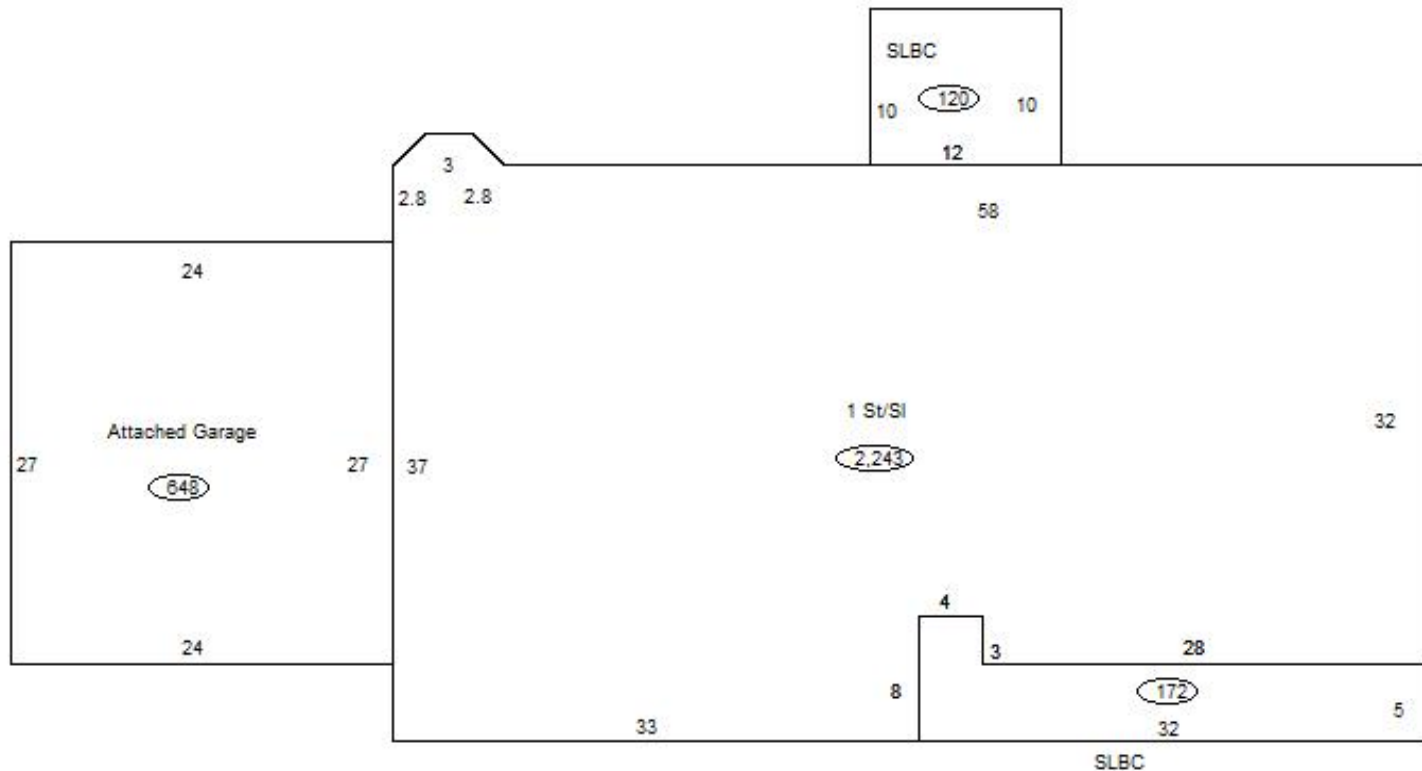

Sketch Vector Information

Sequence	Code	Type	Built Over	Scale	Section Label	Base Area	Multiplier	Total Area
1	R	1	Slab	13	1 St/SI	2,243	1.000	2,243
2	G	1		13	Attached Garage	648	1.000	648
3	M	PRCH		13	SLBC	172	1.000	172
4	M	PRCH		13	SLBC	120	1.000	120
Total Building Area						2,243		2,243



Rogers

Assessment Property Record Card for Tax Year 2026

Data provided by LISA DELOZIER County Assessor

Date 04/16/2026
 Time 21:53:51
 Page 4

660029310

Outbuildings/Site Improvements

Building Image	Code	Description	Dimensions	Floor	Roofing	Total Units
	UTIL	Utility Building	24x24x8	Concrete	Composition Shingle	576
	Qual 3	Cond 3	Year 2010	Eff Age 12		
		Valuation Summary	Modifier Total	RCN	Depr (25% Phys/ % Func)	RCNLD
		Base Cost (30.71 x 576)	17,689	17,689	4,422	13,267
	STF	STG FAIR	25x18x8	Plank	Composition Shingle	450
	Qual 2	Cond 3	Year 2009	Eff Age		
		Valuation Summary	Modifier Total	RCN	Depr (35% Phys/ % Func)	RCNLD
		Base Cost (4.68 x 450)	2,106	2,106	737	1,369