



# Rogers

## Assessment Property Record Card for Tax Year 2026

Data provided by LISA DELOZIER County Assessor

Date 04/18/2026  
Time 07:22:01  
Page 1

Assessment Data					Primary Image																																																																																																																				
<b>Account</b> 660029317 <b>Parcel ID</b> 000000-00-0-00507-003-0007 <b>Cadastral ID</b> 34-21-14-01670 <b>Property Type</b> REAL - Real Property <b>Property Class</b> RRP VI Area 4 <b>Tax Area</b> 3 - OWASSO RURAL/NO FIRE <b>Name ID</b> 333307 BIRD, JAYLYNN NICOLE  7409 N 147TH E AVE OWASSO OK 74055-0000  <b>Parcel Location</b> <b>Situs</b> 07409 N 147TH E AVE <b>Subdivision</b> MEADOWS THE <b>Lot/Block</b> 0007 / 0003 <b>Parcel Size</b> 1 - Lots <b>Sec/Twn/Rng</b> 34 / 21 / 14 / 5 <b>Neighborhood</b> 1212 - R-V04-SW OWASSO <b>School District</b> S021 - OWASSO SCHOOLS																																																																																																																									
<b>Legal Description</b> Lot/Long: 36.26097186 -95.80808861 LOT 7 BLOCK 3 MEADOWS, THE																																																																																																																									
<b>Exemptions</b> <table border="1"> <thead> <tr> <th>Code</th> <th>Type</th> <th>Active</th> <th>Maximum</th> <th>Exemption</th> </tr> </thead> <tbody> <tr> <td>H</td> <td>Homestead</td> <td>Yes</td> <td>1,000</td> <td>1,000</td> </tr> </tbody> </table>					Code	Type	Active	Maximum	Exemption	H	Homestead	Yes	1,000	1,000	<b>Building Permits</b> <table border="1"> <thead> <tr> <th>Number</th> <th>Description</th> <th>Opened</th> <th>Closed</th> <th>Amount</th> </tr> </thead> <tbody> <tr> <td colspan="5"> </td> </tr> </tbody> </table>					Number	Description	Opened	Closed	Amount																																																																																																	
Code	Type	Active	Maximum	Exemption																																																																																																																					
H	Homestead	Yes	1,000	1,000																																																																																																																					
Number	Description	Opened	Closed	Amount																																																																																																																					
<b>Parcel Valuation</b> <table border="1"> <thead> <tr> <th>Source</th> <th>REAL</th> <th>Fair Cash</th> <th>Capped</th> <th>Asmnt Level</th> <th>Assessed</th> <th>Levy Rate</th> <th>97.960</th> <th>Current Tax</th> </tr> </thead> <tbody> <tr> <td>Remove Cap</td> <td>2022</td> <td>Land Value</td> <td>103,575</td> <td>65,364</td> <td>11%</td> <td>7,190</td> <td>Assessed</td> <td>25,119 2,460.66</td> </tr> <tr> <td>Year Frozen</td> <td>0</td> <td>Improvements</td> <td>163,844</td> <td>162,994</td> <td></td> <td>17,929</td> <td>Penalty</td> <td>0</td> </tr> <tr> <td>Uncapped Value</td> <td>0</td> <td>Mobile Home</td> <td>0</td> <td>0</td> <td></td> <td>0</td> <td>Exemption</td> <td>1,000 -98.00</td> </tr> <tr> <td>TIF Project ID</td> <td>0</td> <td>Total Value</td> <td>267,419</td> <td>228,358</td> <td></td> <td>25,119</td> <td>Total Taxable</td> <td>24,119 2,363.00</td> </tr> </tbody> </table>					Source	REAL	Fair Cash	Capped	Asmnt Level	Assessed	Levy Rate	97.960	Current Tax	Remove Cap	2022	Land Value	103,575	65,364	11%	7,190	Assessed	25,119 2,460.66	Year Frozen	0	Improvements	163,844	162,994		17,929	Penalty	0	Uncapped Value	0	Mobile Home	0	0		0	Exemption	1,000 -98.00	TIF Project ID	0	Total Value	267,419	228,358		25,119	Total Taxable	24,119 2,363.00	<b>Sale History</b> <table border="1"> <thead> <tr> <th>Bk/Pg</th> <th>Grantor</th> <th>Date</th> <th>Price</th> <th>Code</th> </tr> </thead> <tbody> <tr> <td>/</td> <td>WILLIAMS, REMINGTON &amp; KELSI</td> <td>01/11/2021</td> <td>205,000</td> <td>YES</td> </tr> <tr> <td>2203/368</td> <td>BANK OF NEW YORK MELLON-TRUST</td> <td>09/19/2011</td> <td>97,500</td> <td>3</td> </tr> <tr> <td>2184/510</td> <td>PARKER, TAMMIE</td> <td>07/13/2011</td> <td>0</td> <td>10</td> </tr> <tr> <td>1301/727</td> <td>LAWRENCE, J FRED &amp; MILDRED-V</td> <td>06/26/2001</td> <td>138,000</td> <td>YES</td> </tr> </tbody> </table>					Bk/Pg	Grantor	Date	Price	Code	/	WILLIAMS, REMINGTON & KELSI	01/11/2021	205,000	YES	2203/368	BANK OF NEW YORK MELLON-TRUST	09/19/2011	97,500	3	2184/510	PARKER, TAMMIE	07/13/2011	0	10	1301/727	LAWRENCE, J FRED & MILDRED-V	06/26/2001	138,000	YES																																										
Source	REAL	Fair Cash	Capped	Asmnt Level	Assessed	Levy Rate	97.960	Current Tax																																																																																																																	
Remove Cap	2022	Land Value	103,575	65,364	11%	7,190	Assessed	25,119 2,460.66																																																																																																																	
Year Frozen	0	Improvements	163,844	162,994		17,929	Penalty	0																																																																																																																	
Uncapped Value	0	Mobile Home	0	0		0	Exemption	1,000 -98.00																																																																																																																	
TIF Project ID	0	Total Value	267,419	228,358		25,119	Total Taxable	24,119 2,363.00																																																																																																																	
Bk/Pg	Grantor	Date	Price	Code																																																																																																																					
/	WILLIAMS, REMINGTON & KELSI	01/11/2021	205,000	YES																																																																																																																					
2203/368	BANK OF NEW YORK MELLON-TRUST	09/19/2011	97,500	3																																																																																																																					
2184/510	PARKER, TAMMIE	07/13/2011	0	10																																																																																																																					
1301/727	LAWRENCE, J FRED & MILDRED-V	06/26/2001	138,000	YES																																																																																																																					
<b>Assessment History</b> <table border="1"> <thead> <tr> <th>Tax Year</th> <th>Statement Number</th> <th>Billed Owner</th> <th>Tax Area</th> <th>Total Value</th> <th>Exemptions</th> <th>Taxable Value</th> <th>Billed Tax</th> </tr> </thead> <tbody> <tr><td>2025</td><td>2025-660029317</td><td>BIRD, JAYLYNN NICOLE</td><td>3</td><td>261,822</td><td>1000</td><td>23,388</td><td>2,291.00</td></tr> <tr><td>2024</td><td>2024-660029317</td><td>BIRD, JAYLYNN NICOLE</td><td>3</td><td>281,770</td><td>0</td><td>23,678</td><td>2,275.00</td></tr> <tr><td>2023</td><td>2023-660029317</td><td>BIRD, SETH A &amp; JAYLYNN N</td><td>3</td><td>205,000</td><td>0</td><td>22,550</td><td>2,113.00</td></tr> <tr><td>2022</td><td>2022-660029317</td><td>BIRD, SETH A &amp; JAYLYNN N</td><td>3</td><td>205,000</td><td>0</td><td>22,550</td><td>2,209.00</td></tr> <tr><td>2021</td><td>2021-660029317</td><td>BIRD, SETH A &amp; JAYLYNN N</td><td>3</td><td>179,893</td><td>0</td><td>19,788</td><td>1,914.00</td></tr> <tr><td>2020</td><td>2020-660029317</td><td>WILLIAMS, REMINGTON &amp; KELSI</td><td>3</td><td>177,094</td><td>0</td><td>19,480</td><td>1,882.00</td></tr> <tr><td>2019</td><td>2019-660029317</td><td>WILLIAMS, REMINGTON &amp; KELSI</td><td>3</td><td>170,381</td><td>0</td><td>18,742</td><td>1,812.00</td></tr> <tr><td>2018</td><td>2018-660029317</td><td>WILLIAMS, REMINGTON &amp; KELSI</td><td>3</td><td>175,519</td><td>0</td><td>19,307</td><td>1,797.00</td></tr> <tr><td>2017</td><td>2017-660029317</td><td>WILLIAMS, REMINGTON &amp; KELSI</td><td>3</td><td>174,100</td><td>0</td><td>19,151</td><td>1,801.00</td></tr> <tr><td>2016</td><td>2016-660029317</td><td>WILLIAMS, REMINGTON &amp; KELSI</td><td>3</td><td>169,819</td><td>0</td><td>18,680</td><td>1,759.00</td></tr> <tr><td>2015</td><td>2015-660029317</td><td>WILLIAMS, REMINGTON &amp; KELSI</td><td>3</td><td>164,731</td><td>0</td><td>18,120</td><td>1,718.00</td></tr> <tr><td>2014</td><td>2014-660029317</td><td>WILLIAMS, REMINGTON &amp; KELSI</td><td>3</td><td>167,689</td><td>0</td><td>17,993</td><td>1,722.00</td></tr> <tr><td>2013</td><td>2013-660029317</td><td>WILLIAMS, REMINGTON &amp;</td><td>3</td><td>160,055</td><td>0</td><td>17,136</td><td>1,605.00</td></tr> </tbody> </table>										Tax Year	Statement Number	Billed Owner	Tax Area	Total Value	Exemptions	Taxable Value	Billed Tax	2025	2025-660029317	BIRD, JAYLYNN NICOLE	3	261,822	1000	23,388	2,291.00	2024	2024-660029317	BIRD, JAYLYNN NICOLE	3	281,770	0	23,678	2,275.00	2023	2023-660029317	BIRD, SETH A & JAYLYNN N	3	205,000	0	22,550	2,113.00	2022	2022-660029317	BIRD, SETH A & JAYLYNN N	3	205,000	0	22,550	2,209.00	2021	2021-660029317	BIRD, SETH A & JAYLYNN N	3	179,893	0	19,788	1,914.00	2020	2020-660029317	WILLIAMS, REMINGTON & KELSI	3	177,094	0	19,480	1,882.00	2019	2019-660029317	WILLIAMS, REMINGTON & KELSI	3	170,381	0	18,742	1,812.00	2018	2018-660029317	WILLIAMS, REMINGTON & KELSI	3	175,519	0	19,307	1,797.00	2017	2017-660029317	WILLIAMS, REMINGTON & KELSI	3	174,100	0	19,151	1,801.00	2016	2016-660029317	WILLIAMS, REMINGTON & KELSI	3	169,819	0	18,680	1,759.00	2015	2015-660029317	WILLIAMS, REMINGTON & KELSI	3	164,731	0	18,120	1,718.00	2014	2014-660029317	WILLIAMS, REMINGTON & KELSI	3	167,689	0	17,993	1,722.00	2013	2013-660029317	WILLIAMS, REMINGTON &	3	160,055	0	17,136	1,605.00
Tax Year	Statement Number	Billed Owner	Tax Area	Total Value	Exemptions	Taxable Value	Billed Tax																																																																																																																		
2025	2025-660029317	BIRD, JAYLYNN NICOLE	3	261,822	1000	23,388	2,291.00																																																																																																																		
2024	2024-660029317	BIRD, JAYLYNN NICOLE	3	281,770	0	23,678	2,275.00																																																																																																																		
2023	2023-660029317	BIRD, SETH A & JAYLYNN N	3	205,000	0	22,550	2,113.00																																																																																																																		
2022	2022-660029317	BIRD, SETH A & JAYLYNN N	3	205,000	0	22,550	2,209.00																																																																																																																		
2021	2021-660029317	BIRD, SETH A & JAYLYNN N	3	179,893	0	19,788	1,914.00																																																																																																																		
2020	2020-660029317	WILLIAMS, REMINGTON & KELSI	3	177,094	0	19,480	1,882.00																																																																																																																		
2019	2019-660029317	WILLIAMS, REMINGTON & KELSI	3	170,381	0	18,742	1,812.00																																																																																																																		
2018	2018-660029317	WILLIAMS, REMINGTON & KELSI	3	175,519	0	19,307	1,797.00																																																																																																																		
2017	2017-660029317	WILLIAMS, REMINGTON & KELSI	3	174,100	0	19,151	1,801.00																																																																																																																		
2016	2016-660029317	WILLIAMS, REMINGTON & KELSI	3	169,819	0	18,680	1,759.00																																																																																																																		
2015	2015-660029317	WILLIAMS, REMINGTON & KELSI	3	164,731	0	18,120	1,718.00																																																																																																																		
2014	2014-660029317	WILLIAMS, REMINGTON & KELSI	3	167,689	0	17,993	1,722.00																																																																																																																		
2013	2013-660029317	WILLIAMS, REMINGTON &	3	160,055	0	17,136	1,605.00																																																																																																																		



# Rogers

## Assessment Property Record Card for Tax Year 2026

Data provided by LISA DELOZIER County Assessor

Date 04/18/2026  
Time 07:22:01  
Page 2

Lot Data	Square-Foot - NBHD 1212 #1	Primary Image
<b>Lot Size</b> <b>Lot Count</b> <b>Units Buildable</b> 1 <b>Non-Ag Acres</b> 0.8806 <b>Topography</b> <b>Street Access</b> <b>Utilities</b> <b>Amenities</b> LAND QUALITY 0 0 <b>Method</b> Square-Foot <b>Base Lot Value</b> 38,361.00 x 2.70 = 103,575 <b>Factor Value</b> <b>Adjustments</b> 1.0000 <b>Lot Value</b> 103,575		

Residential Data	
<b>Type</b>	1 Single Family Residence
<b>Condition</b>	3 - Average
<b>Quality</b>	3 - Average
<b>Architecture</b>	
<b>Style</b>	100% One Story
<b>Exterior Wall</b>	100% Veneer, Stone
<b>Base/Total Area</b>	1,876 / 1,876
<b>Style</b>	100% One Story
<b>HVAC</b>	100% Warmed & Cooled Air
<b>Roof Cover</b>	1 Composition Shingle
<b>Area on Slab</b>	1,876
<b>Fixture/RghIn</b>	11 /
<b>Bed/F/H Bath</b>	3 / 2.0 /
<b>Basement Area</b>	
<b>Garage Type</b>	440 Attached Garage - Unfinished
<b>Remodel</b>	
<b>Year/Eff Age</b>	1979 / 35

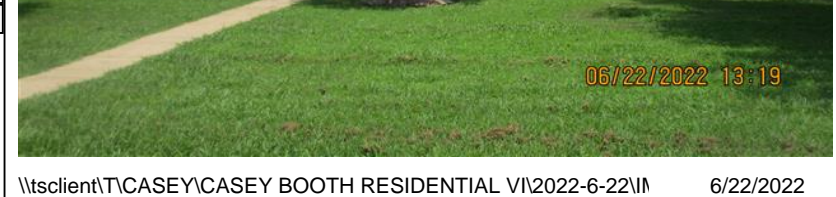

\\tsclient\TCASEY\CASEY BOOTH RESIDENTIAL VI\2022-6-22\ 6/22/2022

GRM Approach	
<b>GRM Code</b>	
<b>Gross Rent</b>	0.00
<b>Indicated Value</b>	

Multiple Regression			
<b>MRA Code</b>	1	Test	
<b>Adjusted R</b>	0.8445		
<b>Indicated Value</b>	203,491	108.47	Per SqFt

Direct Comparables	
<b>Selection Model</b>	A Adam Test
<b>Adjustment Model</b>	1 2022 Residential
<b>Comparables</b>	5
<b>Indicated Value</b>	229,130 Per SqFt

Value Reconciliation			
<b>Selected Approach</b>	Cost Approach		
<b>Improvements</b>	163,563		
<b>Lot Value</b>	103,575		
<b>Indicated Value</b>	267,138	142.40	Per SqFt
<b>Agland Value</b>			
<b>Site Improvements</b>	281		
<b>Total Value</b>	267,419	142.55	Total Value Per SqFt

Cost Approach				Manual : 01/2025			
<b>Base Cost</b>	114.64	<b>Total Misc Impr</b>	+ 13,472				
<b>Roofing Adj</b>	+ 4.76	<b>Garage Cost</b>	+ 14,498				
<b>Subfloor Adj</b>	+ -2.26	<b>Total RCN</b>	= 286,952				
<b>Heat/Cool Adj</b>	+ 12.64	<b>Depreciation ( 43%)</b>	- 123,389				
<b>Plumbing Adj</b>	+ 8.27	<b>Lump Sums</b>	+ 0				
<b>Basement Adj</b>	+ 0.00	<b>RCNLD</b>	= 163,563				
<b>Adj Base Cost</b>	= 138.05	<b>Lot Value</b>	+ 103,575				
<b>Total Area</b>	x 1,876	<b>Indicated Value</b>	= 267,138				
<b>Adjusted Cost</b>	= 258,982	<b>Value Per SqFt</b>	142.40				

Miscellaneous Improvements								
Code	Description	Sketch ID	Size	Year	Units	Unit Cost	Depr	Value
FPR1	FIREPLACE - RESIDENTIAL 1 STORY	0		1	1	5,615.40		5,615
PRCH	SLAB PORCH - COVERED	70090	21x6		126	26.54		3,344
PRCH	SLAB PORCH - COVERED	70091	19x9		171	26.39		4,513



# Rogers

## Assessment Property Record Card for Tax Year 2026

Data provided by LISA DELOZIER County Assessor

Date 04/18/2026  
 Time 07:22:01  
 Page 3

### Sketch Image

660029317

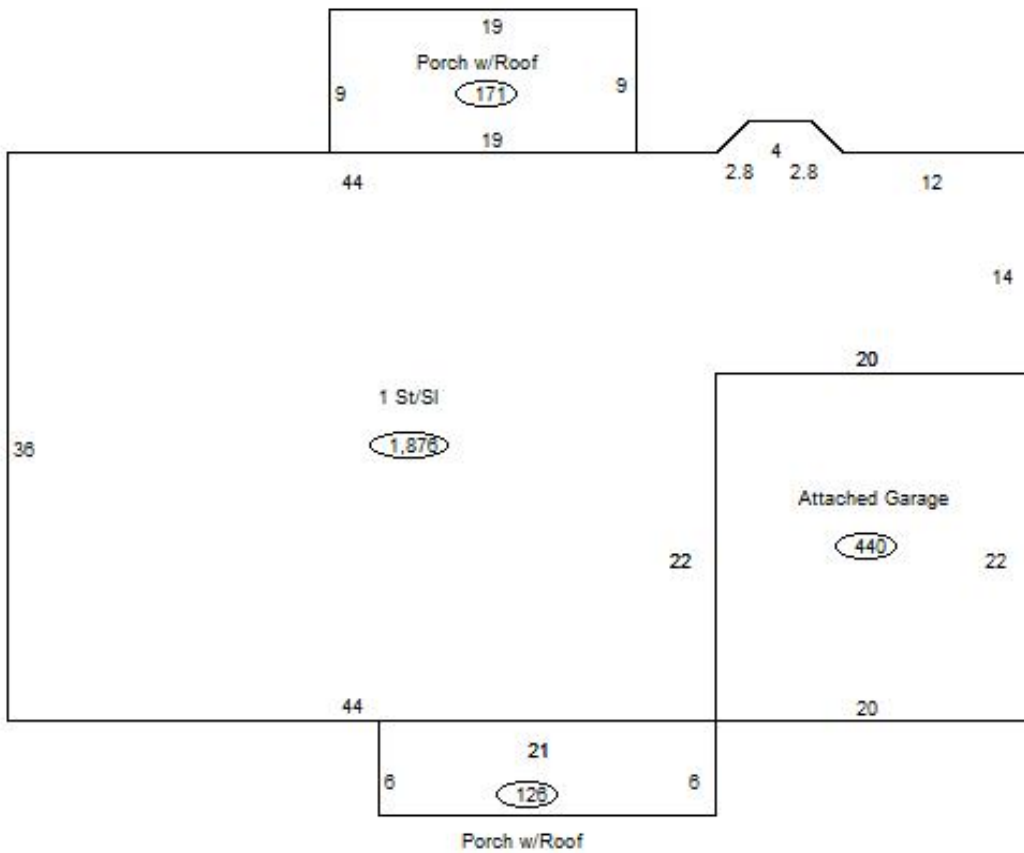

### Sketch Vector Information

Sequence	Code	Type	Built Over	Scale	Section Label	Base Area	Multiplier	Total Area
1	R	1	Slab	13	1 St/Sl	1,876	1.000	1,876
2	G	1		13	Attached Garage	440	1.000	440
3	M	PRCH		13	SLBC	126	1.000	126
4	M	PRCH		13	SLBC	171	1.000	171
<b>Total Building Area</b>						1,876		1,876



# Rogers

## Assessment Property Record Card for Tax Year 2026

Data provided by LISA DELOZIER County Assessor

Date 04/18/2026  
Time 07:22:01  
Page 4

660029317

### Outbuildings/Site Improvements

Building Image	Code	Description	Dimensions	Floor	Roofing	Total Units
	STF	STG FAIR	0x0x0			240
	Qual	2	Cond 3	Year	Eff Age	
<b>Valuation Summary</b>		<b>Modifier Total</b>	<b>RCN</b>	<b>Depr (75% Phys/ % Func)</b>		<b>RCNLD</b>
Base Cost (4.68 x 240)		1,123		1,123 842		281