



Rogers

Assessment Property Record Card for Tax Year 2026

Data provided by LISA DELOZIER County Assessor

Date 04/16/2026
Time 22:51:52
Page 1

Assessment Data					Primary Image																																																																																																																				
Account 660029363 Parcel ID 000000-00-0-00018-001-0007 Cadastral ID 34-21-15-03550 Property Type REAL - Real Property Property Class RRP VI Area 4 Tax Area 4 - VERDIGRIS/VERD FIRE Name ID 314915 SMITH, DONALD & BRENDA 7172 E BATTENFIELD DR CLAREMORE OK 74019-0000 Parcel Location Situs 07172 E BATTENFIELD DR Subdivision BATTENFIELD ACRES Lot/Block 0007 / 0001 Parcel Size 1 - Lots Sec/Twn/Rng 34 / 21 / 15 / 5 Neighborhood 1122 - R-V04-SE VERDIGRIS School District S008 - VERDIGRIS SCHOOLS																																																																																																																									
Legal Description Lot/Long: 36.25348881 -95.70130186 LOT 7 BLOCK 1 BATTENFIELD ACRES																																																																																																																									
Exemptions <table border="1"> <thead> <tr> <th>Code</th> <th>Type</th> <th>Active</th> <th>Maximum</th> <th>Exemption</th> </tr> </thead> <tbody> <tr> <td>H</td> <td>Homestead</td> <td>Yes</td> <td>1,000</td> <td>1,000</td> </tr> <tr> <td>H</td> <td>Homestead</td> <td>No</td> <td>1,000</td> <td></td> </tr> </tbody> </table>					Code	Type	Active	Maximum	Exemption	H	Homestead	Yes	1,000	1,000	H	Homestead	No	1,000		Building Permits <table border="1"> <thead> <tr> <th>Number</th> <th>Description</th> <th>Opened</th> <th>Closed</th> <th>Amount</th> </tr> </thead> <tbody> <tr> <td></td> <td></td> <td></td> <td></td> <td></td> </tr> </tbody> </table>					Number	Description	Opened	Closed	Amount																																																																																												
Code	Type	Active	Maximum	Exemption																																																																																																																					
H	Homestead	Yes	1,000	1,000																																																																																																																					
H	Homestead	No	1,000																																																																																																																						
Number	Description	Opened	Closed	Amount																																																																																																																					
Parcel Valuation <table border="1"> <thead> <tr> <th>Source</th> <th>REAL</th> <th>Fair Cash</th> <th>Capped</th> <th>Asmnt Level</th> <th>Assessed</th> <th>Levy Rate</th> <th>104.132</th> <th>Current Tax</th> </tr> </thead> <tbody> <tr> <td>Remove Cap</td> <td>2016</td> <td>Land Value 70,446</td> <td>33,280</td> <td>11%</td> <td>3,661</td> <td>Assessed</td> <td>21,051</td> <td>2,192.08</td> </tr> <tr> <td>Year Frozen</td> <td>2005</td> <td>Improvements 166,609</td> <td>158,096</td> <td></td> <td>17,390</td> <td>Penalty</td> <td>0</td> <td></td> </tr> <tr> <td>Uncapped Value</td> <td>0</td> <td>Mobile Home 0</td> <td>0</td> <td></td> <td>0</td> <td>Exemption</td> <td>1,000</td> <td>-87.00</td> </tr> <tr> <td>TIF Project ID</td> <td>0</td> <td>Total Value 237,055</td> <td>191,376</td> <td></td> <td>21,051</td> <td>Total Taxable</td> <td>20,051</td> <td>2,105.00</td> </tr> </tbody> </table>					Source	REAL	Fair Cash	Capped	Asmnt Level	Assessed	Levy Rate	104.132	Current Tax	Remove Cap	2016	Land Value 70,446	33,280	11%	3,661	Assessed	21,051	2,192.08	Year Frozen	2005	Improvements 166,609	158,096		17,390	Penalty	0		Uncapped Value	0	Mobile Home 0	0		0	Exemption	1,000	-87.00	TIF Project ID	0	Total Value 237,055	191,376		21,051	Total Taxable	20,051	2,105.00	Sale History <table border="1"> <thead> <tr> <th>Bk/Pg</th> <th>Grantor</th> <th>Date</th> <th>Price</th> <th>Code</th> </tr> </thead> <tbody> <tr> <td>2465/771</td> <td>DUKE, CHARLES W JR & BILLIE-MARL</td> <td>04/07/2015</td> <td>160,000</td> <td>YES</td> </tr> <tr> <td>955/655</td> <td>CHURCH, MICHAEL A &</td> <td>04/26/1994</td> <td>69,000</td> <td>Yes</td> </tr> <tr> <td>838/243</td> <td></td> <td></td> <td>60,000</td> <td>No</td> </tr> </tbody> </table>					Bk/Pg	Grantor	Date	Price	Code	2465/771	DUKE, CHARLES W JR & BILLIE-MARL	04/07/2015	160,000	YES	955/655	CHURCH, MICHAEL A &	04/26/1994	69,000	Yes	838/243			60,000	No																																															
Source	REAL	Fair Cash	Capped	Asmnt Level	Assessed	Levy Rate	104.132	Current Tax																																																																																																																	
Remove Cap	2016	Land Value 70,446	33,280	11%	3,661	Assessed	21,051	2,192.08																																																																																																																	
Year Frozen	2005	Improvements 166,609	158,096		17,390	Penalty	0																																																																																																																		
Uncapped Value	0	Mobile Home 0	0		0	Exemption	1,000	-87.00																																																																																																																	
TIF Project ID	0	Total Value 237,055	191,376		21,051	Total Taxable	20,051	2,105.00																																																																																																																	
Bk/Pg	Grantor	Date	Price	Code																																																																																																																					
2465/771	DUKE, CHARLES W JR & BILLIE-MARL	04/07/2015	160,000	YES																																																																																																																					
955/655	CHURCH, MICHAEL A &	04/26/1994	69,000	Yes																																																																																																																					
838/243			60,000	No																																																																																																																					
Assessment History <table border="1"> <thead> <tr> <th>Tax Year</th> <th>Statement Number</th> <th>Billed Owner</th> <th>Tax Area</th> <th>Total Value</th> <th>Exemptions</th> <th>Taxable Value</th> <th>Billed Tax</th> </tr> </thead> <tbody> <tr><td>2025</td><td>2025-660029363</td><td>SMITH, DONALD & BRENDA</td><td>4</td><td>231,807</td><td>1000</td><td>19,438</td><td>2,041.00</td></tr> <tr><td>2024</td><td>2024-660029363</td><td>SMITH, DONALD & BRENDA</td><td>4</td><td>254,031</td><td>1000</td><td>18,843</td><td>1,816.00</td></tr> <tr><td>2023</td><td>2023-660029363</td><td>SMITH, DONALD & BRENDA</td><td>4</td><td>193,414</td><td>1000</td><td>18,265</td><td>1,734.00</td></tr> <tr><td>2022</td><td>2022-660029363</td><td>SMITH, DONALD & BRENDA</td><td>4</td><td>170,036</td><td>1000</td><td>17,704</td><td>1,712.00</td></tr> <tr><td>2021</td><td>2021-660029363</td><td>SMITH, DONALD & BRENDA</td><td>4</td><td>169,728</td><td>1000</td><td>17,670</td><td>1,664.00</td></tr> <tr><td>2020</td><td>2020-660029363</td><td>SMITH, DONALD & BRENDA</td><td>4</td><td>166,973</td><td>1000</td><td>17,367</td><td>1,639.00</td></tr> <tr><td>2019</td><td>2019-660029363</td><td>SMITH, DONALD & BRENDA</td><td>4</td><td>162,175</td><td>1000</td><td>16,839</td><td>1,614.00</td></tr> <tr><td>2018</td><td>2018-660029363</td><td>SMITH, DONALD & BRENDA</td><td>4</td><td>169,124</td><td>1000</td><td>17,604</td><td>1,688.00</td></tr> <tr><td>2017</td><td>2017-660029363</td><td>SMITH, DONALD & BRENDA</td><td>4</td><td>167,465</td><td>1000</td><td>17,421</td><td>1,675.00</td></tr> <tr><td>2016</td><td>2016-660029363</td><td>SMITH, DONALD & BRENDA</td><td>4</td><td>163,430</td><td>1000</td><td>16,977</td><td>1,637.00</td></tr> <tr><td>2015</td><td>2015-660029363</td><td>SMITH, DONALD & BRENDA</td><td>4</td><td>164,480</td><td>1000</td><td>10,536</td><td>1,028.00</td></tr> <tr><td>2014</td><td>2014-660029363</td><td>DUKE, CHARLES W JR & BILLIE MARLENE CO</td><td>4</td><td>167,026</td><td>1000</td><td>10,537</td><td>973.00</td></tr> <tr><td>2013</td><td>2013-660029363</td><td>DUKE, CHARLES W JR & BILLIE MARLENE CO</td><td>4</td><td>158,644</td><td>1000</td><td>10,536</td><td>1,008.00</td></tr> </tbody> </table>										Tax Year	Statement Number	Billed Owner	Tax Area	Total Value	Exemptions	Taxable Value	Billed Tax	2025	2025-660029363	SMITH, DONALD & BRENDA	4	231,807	1000	19,438	2,041.00	2024	2024-660029363	SMITH, DONALD & BRENDA	4	254,031	1000	18,843	1,816.00	2023	2023-660029363	SMITH, DONALD & BRENDA	4	193,414	1000	18,265	1,734.00	2022	2022-660029363	SMITH, DONALD & BRENDA	4	170,036	1000	17,704	1,712.00	2021	2021-660029363	SMITH, DONALD & BRENDA	4	169,728	1000	17,670	1,664.00	2020	2020-660029363	SMITH, DONALD & BRENDA	4	166,973	1000	17,367	1,639.00	2019	2019-660029363	SMITH, DONALD & BRENDA	4	162,175	1000	16,839	1,614.00	2018	2018-660029363	SMITH, DONALD & BRENDA	4	169,124	1000	17,604	1,688.00	2017	2017-660029363	SMITH, DONALD & BRENDA	4	167,465	1000	17,421	1,675.00	2016	2016-660029363	SMITH, DONALD & BRENDA	4	163,430	1000	16,977	1,637.00	2015	2015-660029363	SMITH, DONALD & BRENDA	4	164,480	1000	10,536	1,028.00	2014	2014-660029363	DUKE, CHARLES W JR & BILLIE MARLENE CO	4	167,026	1000	10,537	973.00	2013	2013-660029363	DUKE, CHARLES W JR & BILLIE MARLENE CO	4	158,644	1000	10,536	1,008.00
Tax Year	Statement Number	Billed Owner	Tax Area	Total Value	Exemptions	Taxable Value	Billed Tax																																																																																																																		
2025	2025-660029363	SMITH, DONALD & BRENDA	4	231,807	1000	19,438	2,041.00																																																																																																																		
2024	2024-660029363	SMITH, DONALD & BRENDA	4	254,031	1000	18,843	1,816.00																																																																																																																		
2023	2023-660029363	SMITH, DONALD & BRENDA	4	193,414	1000	18,265	1,734.00																																																																																																																		
2022	2022-660029363	SMITH, DONALD & BRENDA	4	170,036	1000	17,704	1,712.00																																																																																																																		
2021	2021-660029363	SMITH, DONALD & BRENDA	4	169,728	1000	17,670	1,664.00																																																																																																																		
2020	2020-660029363	SMITH, DONALD & BRENDA	4	166,973	1000	17,367	1,639.00																																																																																																																		
2019	2019-660029363	SMITH, DONALD & BRENDA	4	162,175	1000	16,839	1,614.00																																																																																																																		
2018	2018-660029363	SMITH, DONALD & BRENDA	4	169,124	1000	17,604	1,688.00																																																																																																																		
2017	2017-660029363	SMITH, DONALD & BRENDA	4	167,465	1000	17,421	1,675.00																																																																																																																		
2016	2016-660029363	SMITH, DONALD & BRENDA	4	163,430	1000	16,977	1,637.00																																																																																																																		
2015	2015-660029363	SMITH, DONALD & BRENDA	4	164,480	1000	10,536	1,028.00																																																																																																																		
2014	2014-660029363	DUKE, CHARLES W JR & BILLIE MARLENE CO	4	167,026	1000	10,537	973.00																																																																																																																		
2013	2013-660029363	DUKE, CHARLES W JR & BILLIE MARLENE CO	4	158,644	1000	10,536	1,008.00																																																																																																																		



Rogers

Assessment Property Record Card for Tax Year 2026

Data provided by LISA DELOZIER County Assessor

Date 04/16/2026
Time 22:51:52
Page 2

Lot Data	Square-Foot - NBHD 1122 #1	Primary Image
Lot Size		
Lot Count	1	
Units Buildable	1	
Non-Ag Acres	0.9513	
Topography		
Street Access		
Utilities		
Amenities	LAND QUALITY	
	0	
	0	
Method	Square-Foot	
Base Lot Value	41,439.00 x 1.70 = 70,446	
Factor Value		
Adjustments	1.0000	
Lot Value	70,446	

Residential Data	
Type	1 Single Family Residence
Condition	3 - Average
Quality	2.5 - Fair
Architecture	
Style	100% One Story
Exterior Wall	100% Veneer, Stone
Base/Total Area	2,027 / 2,027
Style	100% One Story
HVAC	100% Warmed & Cooled Air
Roof Cover	1 Composition Shingle
Area on Slab	2,027
Fixture/RghIn	11 /
Bed/F/H Bath	3 / 2.0 /
Basement Area	
Garage Type	440 Attached Garage - Unfinished
Remodel	
Year/Eff Age	1973 / 40

Cost Approach		Manual : 01/2025	
Base Cost	106.13	Total Misc Impr	+ 33,604
Roofing Adj	+ 4.25	Garage Cost	+ 12,487
Subfloor Adj	+ -1.09	Total RCN	= 304,939
Heat/Cool Adj	+ 11.47	Depreciation (48%)	- 146,371
Plumbing Adj	+ 6.94	Lump Sums	+ 0
Basement Adj	+ 0.00	RCNLD	= 158,568
Adj Base Cost	= 127.70	Lot Value	+ 70,446
Total Area	x 2,027	Indicated Value	= 229,014
Adjusted Cost	= 258,848	Value Per SqFt	112.98



\\tsclient\C\Users\Randy Necessary\Pictures\101_0708\IMG_0012. 7/8/2022

GRM Approach	
GRM Code	
Gross Rent	0.00
Indicated Value	

Multiple Regression			
MRA Code	1	Test	
Adjusted R	0.8445		
Indicated Value	192,031	94.74	Per SqFt

Direct Comparables	
Selection Model	A Adam Test
Adjustment Model	1 2022 Residential
Comparables	4
Indicated Value	265,920 Per SqFt

Value Reconciliation			
Selected Approach	Cost Approach		
Improvements	158,568		
Lot Value	70,446		
Indicated Value	229,014	112.98	Per SqFt
Agland Value			
Site Improvements	8,041		
Total Value	237,055	116.95	Total Value Per SqFt

Miscellaneous Improvements							
Code	Description	Sketch ID	Size	Year	Units	Unit Cost	Depr Value
FPR1	FIREPLACE - RESIDENTIAL 1 STORY	0		1	1	5,095.98	5,096
EPSW	ENCLOSED PORCH - SOLID WALL	70218		378	378	60.73	22,956
PRCH	SLAB PORCH - COVERED	70219		11x7	77	24.03	1,850
PRCH	SLAB PORCH - COVERED	70220		13x12	156	23.73	3,702



Rogers

Assessment Property Record Card for Tax Year 2026

Data provided by LISA DELOZIER County Assessor

Date 04/16/2026

Time 22:51:52

Page 3

Sketch Image

660029363

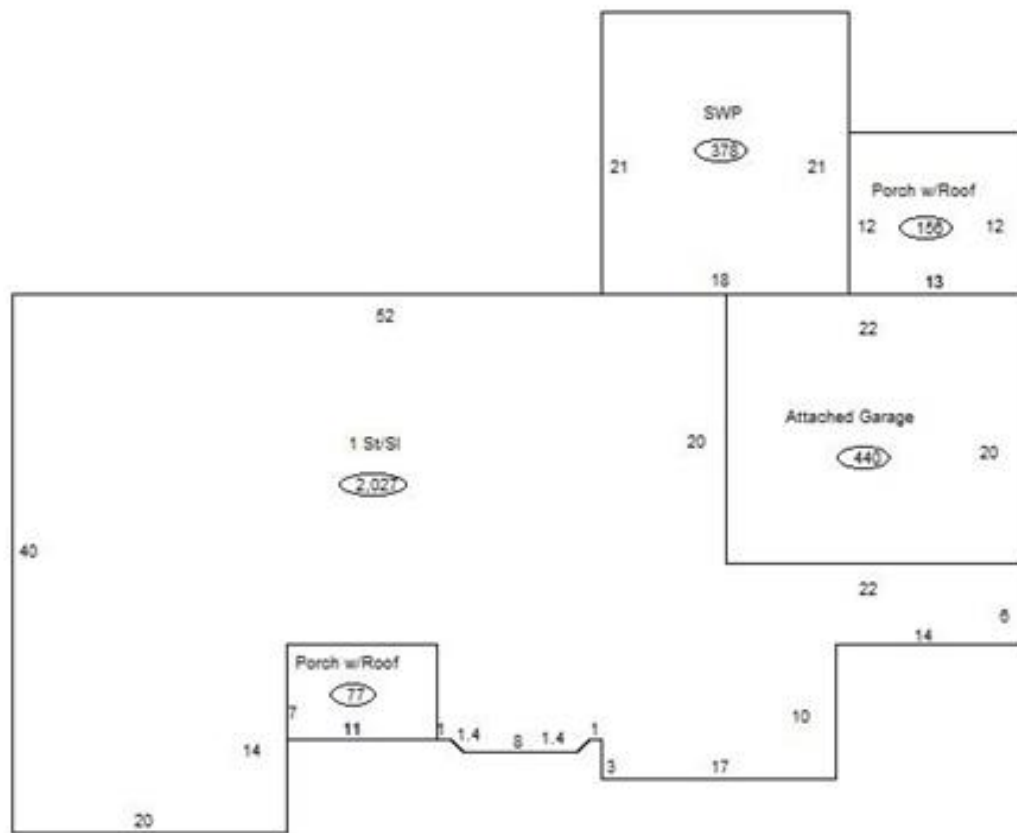

Sketch Vector Information

Sequence	Code	Type	Built Over	Scale	Section Label	Base Area	Multiplier	Total Area
1	R	1	Slab	13	1 St/Sl	2,027	1.000	2,027
2	G	1		13	Attached Garage	440	1.000	440
3	M	EPSW		13	EPSW	378	1.000	378
4	M	PRCH		13	SLBC	77	1.000	77
5	M	PRCH		13	SLBC	156	1.000	156
Total Building Area						2,027		2,027



Rogers



Assessment Property Record Card for Tax Year 2026

Data provided by LISA DELOZIER County Assessor

Date 04/16/2026
 Time 22:51:52
 Page 4

660029363

Outbuildings/Site Improvements

Building Image	Code	Description	Dimensions	Floor	Roofing	Total Units
	LT	LEAN-TO	0x0x0			480
	Qual	3	Cond 3	Year	Eff Age	
	Valuation Summary		Modifier Total	RCN	Depr (40% Phys/ % Func)	RCNLD
	Base Cost (2.92 x 480)	1,402		1,402	561	841
	DTGF	DETACHED GARAGE FAIR	0x0x0			750
	Qual	2	Cond 3	Year	Eff Age	
	Valuation Summary		Modifier Total	RCN	Depr (40% Phys/ % Func)	RCNLD
	Base Cost (16.00 x 750)	12,000		12,000	4,800	7,200