



Rogers

Assessment Property Record Card for Tax Year 2026

Data provided by LISA DELOZIER County Assessor

Date 04/16/2026
Time 22:28:06
Page 1

Assessment Data					Primary Image																																																																																																																				
Account 660029379 Parcel ID 000000-00-0-00021-001-0003 Cadastral ID 34-21-15-03710 Property Type REAL - Real Property Property Class RRP VI Area 4 Tax Area 4 - VERDIGRIS/VERD FIRE Name ID 328629 DAMET, LEE KYLE & KAYLA 7122 E VERDIGRIS DR CLAREMORE OK 74019-0000 Parcel Location Situs 07122 VERDIGRIS DR Subdivision BATTENFIELD ACRES 2 Lot/Block 0003 / 0001 Parcel Size 1 - Lots Sec/Twn/Rng 34 / 21 / 15 / 5 Neighborhood 1122 - R-V04-SE VERDIGRIS School District S008 - VERDIGRIS SCHOOLS																																																																																																																									
Legal Description Lot/Long: 36.25531091 -95.70186797																																																																																																																									
Building Permits					<table border="1"> <thead> <tr> <th>Number</th> <th>Description</th> <th>Opened</th> <th>Closed</th> <th>Amount</th> </tr> </thead> <tbody> <tr> <td>R21 000411</td> <td>R23- ROOM ADDITION/REMODEL</td> <td>10/2021</td> <td>09/2022</td> <td>50,000</td> </tr> </tbody> </table>					Number	Description	Opened	Closed	Amount	R21 000411	R23- ROOM ADDITION/REMODEL	10/2021	09/2022	50,000																																																																																																						
Number	Description	Opened	Closed	Amount																																																																																																																					
R21 000411	R23- ROOM ADDITION/REMODEL	10/2021	09/2022	50,000																																																																																																																					
Exemptions					Sale History																																																																																																																				
<table border="1"> <thead> <tr> <th>Code</th> <th>Type</th> <th>Active</th> <th>Maximum</th> <th>Exemption</th> </tr> </thead> <tbody> <tr> <td colspan="5"> </td> </tr> </tbody> </table>					Code	Type	Active	Maximum	Exemption						<table border="1"> <thead> <tr> <th>Bk/Pg</th> <th>Grantor</th> <th>Date</th> <th>Price</th> <th>Code</th> </tr> </thead> <tbody> <tr> <td>/</td> <td>HESTER, MARK &</td> <td>08/23/2019</td> <td>123,000</td> <td>YES</td> </tr> <tr> <td>2186/19</td> <td>RODRIGUEZ, MANUEL C</td> <td>07/27/2011</td> <td>107,500</td> <td>YES</td> </tr> </tbody> </table>					Bk/Pg	Grantor	Date	Price	Code	/	HESTER, MARK &	08/23/2019	123,000	YES	2186/19	RODRIGUEZ, MANUEL C	07/27/2011	107,500	YES																																																																																							
Code	Type	Active	Maximum	Exemption																																																																																																																					
Bk/Pg	Grantor	Date	Price	Code																																																																																																																					
/	HESTER, MARK &	08/23/2019	123,000	YES																																																																																																																					
2186/19	RODRIGUEZ, MANUEL C	07/27/2011	107,500	YES																																																																																																																					
Parcel Valuation																																																																																																																									
<table border="1"> <thead> <tr> <th>Source</th> <th>REAL</th> <th>Fair Cash</th> <th>Capped</th> <th>Asmnt Level</th> <th>Assessed</th> <th>Levy Rate</th> <th>104.132</th> <th>Current Tax</th> </tr> </thead> <tbody> <tr> <td>Remove Cap</td> <td>2020</td> <td>Land Value 83,887</td> <td>47,475</td> <td>11%</td> <td>5,222</td> <td>Assessed</td> <td>18,095</td> <td>1,884.27</td> </tr> <tr> <td>Year Frozen</td> <td>0</td> <td>Improvements 137,112</td> <td>117,026</td> <td></td> <td>12,873</td> <td>Penalty</td> <td>0</td> <td></td> </tr> <tr> <td>Uncapped Value</td> <td>0</td> <td>Mobile Home 0</td> <td>0</td> <td></td> <td>0</td> <td>Exemption</td> <td>0</td> <td>0.00</td> </tr> <tr> <td>TIF Project ID</td> <td>0</td> <td>Total Value 220,999</td> <td>164,501</td> <td></td> <td>18,095</td> <td>Total Taxable</td> <td>18,095</td> <td>1,884.00</td> </tr> </tbody> </table>		Source	REAL	Fair Cash	Capped	Asmnt Level	Assessed	Levy Rate	104.132	Current Tax	Remove Cap	2020	Land Value 83,887	47,475	11%	5,222	Assessed	18,095	1,884.27	Year Frozen	0	Improvements 137,112	117,026		12,873	Penalty	0		Uncapped Value	0	Mobile Home 0	0		0	Exemption	0	0.00	TIF Project ID	0	Total Value 220,999	164,501		18,095	Total Taxable	18,095	1,884.00																																																																											
Source	REAL	Fair Cash	Capped	Asmnt Level	Assessed	Levy Rate	104.132	Current Tax																																																																																																																	
Remove Cap	2020	Land Value 83,887	47,475	11%	5,222	Assessed	18,095	1,884.27																																																																																																																	
Year Frozen	0	Improvements 137,112	117,026		12,873	Penalty	0																																																																																																																		
Uncapped Value	0	Mobile Home 0	0		0	Exemption	0	0.00																																																																																																																	
TIF Project ID	0	Total Value 220,999	164,501		18,095	Total Taxable	18,095	1,884.00																																																																																																																	
Assessment History																																																																																																																									
<table border="1"> <thead> <tr> <th>Tax Year</th> <th>Statement Number</th> <th>Billed Owner</th> <th>Tax Area</th> <th>Total Value</th> <th>Exemptions</th> <th>Taxable Value</th> <th>Billed Tax</th> </tr> </thead> <tbody> <tr><td>2025</td><td>2025-660029379</td><td>DAMET, LEE KYLE &</td><td>4</td><td>218,945</td><td>0</td><td>17,234</td><td>1,795.00</td></tr> <tr><td>2024</td><td>2024-660029379</td><td>DAMET, LEE KYLE &</td><td>4</td><td>227,720</td><td>0</td><td>16,413</td><td>1,573.00</td></tr> <tr><td>2023</td><td>2023-660029379</td><td>DAMET, LEE KYLE &</td><td>4</td><td>153,108</td><td>0</td><td>15,631</td><td>1,476.00</td></tr> <tr><td>2022</td><td>2022-660029379</td><td>DAMET, LEE KYLE &</td><td>4</td><td>119,902</td><td>0</td><td>13,189</td><td>1,268.00</td></tr> <tr><td>2021</td><td>2021-660029379</td><td>DAMET, LEE KYLE &</td><td>4</td><td>128,454</td><td>0</td><td>14,130</td><td>1,323.00</td></tr> <tr><td>2020</td><td>2020-660029379</td><td>DAMET, LEE KYLE &</td><td>4</td><td>128,137</td><td>0</td><td>14,095</td><td>1,322.00</td></tr> <tr><td>2019</td><td>2019-660029379</td><td>DAMET, LEE KYLE &</td><td>4</td><td>114,517</td><td>0</td><td>12,597</td><td>1,200.00</td></tr> <tr><td>2018</td><td>2018-660029379</td><td>HESTER, MARK &</td><td>4</td><td>120,771</td><td>0</td><td>13,285</td><td>1,266.00</td></tr> <tr><td>2017</td><td>2017-660029379</td><td>HESTER, MARK &</td><td>4</td><td>119,888</td><td>0</td><td>13,188</td><td>1,260.00</td></tr> <tr><td>2016</td><td>2016-660029379</td><td>HESTER, MARK &</td><td>4</td><td>117,143</td><td>0</td><td>12,886</td><td>1,235.00</td></tr> <tr><td>2015</td><td>2015-660029379</td><td>HESTER, MARK &</td><td>4</td><td>117,933</td><td>0</td><td>12,973</td><td>1,253.00</td></tr> <tr><td>2014</td><td>2014-660029379</td><td>HESTER, MARK &</td><td>4</td><td>120,088</td><td>0</td><td>13,114</td><td>1,198.00</td></tr> <tr><td>2013</td><td>2013-660029379</td><td>HESTER, MARK &</td><td>4</td><td>116,184</td><td>1000</td><td>11,490</td><td>1,099.00</td></tr> </tbody> </table>										Tax Year	Statement Number	Billed Owner	Tax Area	Total Value	Exemptions	Taxable Value	Billed Tax	2025	2025-660029379	DAMET, LEE KYLE &	4	218,945	0	17,234	1,795.00	2024	2024-660029379	DAMET, LEE KYLE &	4	227,720	0	16,413	1,573.00	2023	2023-660029379	DAMET, LEE KYLE &	4	153,108	0	15,631	1,476.00	2022	2022-660029379	DAMET, LEE KYLE &	4	119,902	0	13,189	1,268.00	2021	2021-660029379	DAMET, LEE KYLE &	4	128,454	0	14,130	1,323.00	2020	2020-660029379	DAMET, LEE KYLE &	4	128,137	0	14,095	1,322.00	2019	2019-660029379	DAMET, LEE KYLE &	4	114,517	0	12,597	1,200.00	2018	2018-660029379	HESTER, MARK &	4	120,771	0	13,285	1,266.00	2017	2017-660029379	HESTER, MARK &	4	119,888	0	13,188	1,260.00	2016	2016-660029379	HESTER, MARK &	4	117,143	0	12,886	1,235.00	2015	2015-660029379	HESTER, MARK &	4	117,933	0	12,973	1,253.00	2014	2014-660029379	HESTER, MARK &	4	120,088	0	13,114	1,198.00	2013	2013-660029379	HESTER, MARK &	4	116,184	1000	11,490	1,099.00
Tax Year	Statement Number	Billed Owner	Tax Area	Total Value	Exemptions	Taxable Value	Billed Tax																																																																																																																		
2025	2025-660029379	DAMET, LEE KYLE &	4	218,945	0	17,234	1,795.00																																																																																																																		
2024	2024-660029379	DAMET, LEE KYLE &	4	227,720	0	16,413	1,573.00																																																																																																																		
2023	2023-660029379	DAMET, LEE KYLE &	4	153,108	0	15,631	1,476.00																																																																																																																		
2022	2022-660029379	DAMET, LEE KYLE &	4	119,902	0	13,189	1,268.00																																																																																																																		
2021	2021-660029379	DAMET, LEE KYLE &	4	128,454	0	14,130	1,323.00																																																																																																																		
2020	2020-660029379	DAMET, LEE KYLE &	4	128,137	0	14,095	1,322.00																																																																																																																		
2019	2019-660029379	DAMET, LEE KYLE &	4	114,517	0	12,597	1,200.00																																																																																																																		
2018	2018-660029379	HESTER, MARK &	4	120,771	0	13,285	1,266.00																																																																																																																		
2017	2017-660029379	HESTER, MARK &	4	119,888	0	13,188	1,260.00																																																																																																																		
2016	2016-660029379	HESTER, MARK &	4	117,143	0	12,886	1,235.00																																																																																																																		
2015	2015-660029379	HESTER, MARK &	4	117,933	0	12,973	1,253.00																																																																																																																		
2014	2014-660029379	HESTER, MARK &	4	120,088	0	13,114	1,198.00																																																																																																																		
2013	2013-660029379	HESTER, MARK &	4	116,184	1000	11,490	1,099.00																																																																																																																		



Rogers

Assessment Property Record Card for Tax Year 2026

Data provided by LISA DELOZIER County Assessor

Date 04/16/2026
Time 22:28:07
Page 2

Lot Data		Square-Foot - NBHD 1122 #1		Primary Image						
Lot Size					<p>\\tsclient\X\Rob Stuff\ROBS NEW CONST\2022-9-7\IMG_0019.JPG 9/7/2022</p>					
Lot Count	1									
Units Buildable	1									
Non-Ag Acres	1.2656									
Topography										
Street Access										
Utilities										
Amenities	LAND QUALITY									0
										0
Method	Square-Foot									
Base Lot Value	55,131.00 x 1.52 = 83,887									
Factor Value										
Adjustments	1.0000									
Lot Value	83,887									
Residential Data										
Type	1 Single Family Residence									
Condition	3 - Average									
Quality	2.5 - Fair									
Architecture										
Style	100% One Story									
Exterior Wall	85% Veneer, Masonry 15% Frame, Siding, Wood									
Base/Total Area	2,075 / 2,075									
Style	100% One Story									
HVAC	100% Warmed & Cooled Air									
Roof Cover	1 Composition Shingle									
Area on Slab	2,075									
Fixture/RghIn	11 /									
Bed/F/H Bath	3 / 3.0 /									
Basement Area										
Garage Type										
Remodel										
Year/Eff Age	1977 / 37									
Cost Approach		Manual : 01/2025								
Base Cost	95.59	Total Misc Impr	+	11,592						
Roofing Adj	+ 4.15	Garage Cost	+							
Subfloor Adj	+ -1.21	Total RCN	=	253,911						
Heat/Cool Adj	+ 11.47	Depreciation (46%)	-	116,799						
Plumbing Adj	+ 6.78	Lump Sums	+	0						
Basement Adj	+ 0.00	RCNLD	=	137,112						
Adj Base Cost	= 116.78	Lot Value	+	83,887						
Total Area	x 2,075	Indicated Value	=	220,999						
Adjusted Cost	= 242,319	Value Per SqFt		106.51						
Value Reconciliation										
Selected Approach		Cost Approach								
Improvements	137,112									
Lot Value	83,887									
Indicated Value	220,999	106.51	Per SqFt							
Agland Value										
Site Improvements										
Total Value	220,999	106.51	Total Value Per SqFt							
Miscellaneous Improvements										
Code	Description	Sketch ID	Size	Year	Units	Unit Cost	Depr	Value		
FPR1	FIREPLACE - RESIDENTIAL 1 STORY	0		1	1	5,095.98		5,096		
SHLT	STORM SHELTER	0		1	2014	0.00				
PRCH	SLAB PORCH - COVERED	70282	6x6		36	24.16		870		
PRCH	SLAB PORCH - COVERED	70283	20x12		240	23.44		5,626		



Rogers

Assessment Property Record Card for Tax Year 2026

Data provided by LISA DELOZIER County Assessor

Date 04/16/2026
 Time 22:28:07
 Page 3

Sketch Image

660029379

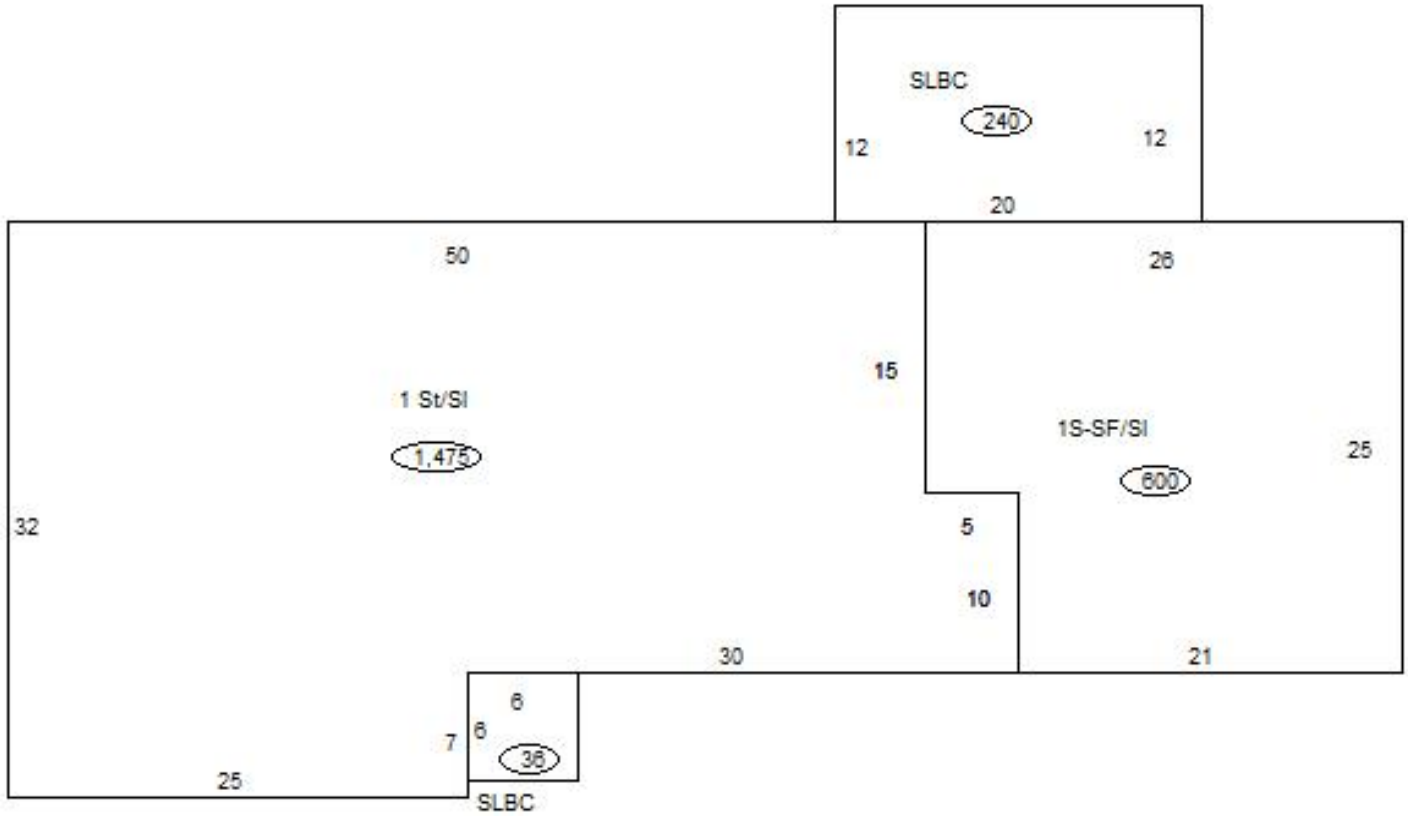

Sketch Vector Information

Sequence	Code	Type	Built Over	Scale	Section Label	Base Area	Multiplier	Total Area
1	R	1	Slab	13	1 St/SI	1,475	1.000	1,475
2	R	1	Slab	13	1S-SF/SI	600	1.000	600
3	M	PRCH		13	SLBC	36	1.000	36
4	M	PRCH		13	SLBC	240	1.000	240
Total Building Area						2,075		2,075



Rogers



Assessment Property Record Card for Tax Year 2026

Data provided by LISA DELOZIER County Assessor

Date 04/16/2026
Time 22:28:07
Page 4

660029379

Outbuildings/Site Improvements

Building Image	Code	Description	Dimensions	Floor	Roofing	Total Units
	STF	STG FAIR	0x0x0			
	Qual 2	Cond 3	Year	Eff Age	1520	
Valuation Summary		Modifier Total		RCN	Depr (100% Phys/ % Func)	RCNLD
Base Cost (4.68 x)						
	STF	STG FAIR	0x0x0			
	Qual	Cond	Year	Eff Age		
Valuation Summary		Modifier Total		RCN	Depr (100% Phys/ % Func)	RCNLD
Base Cost (4.68 x)						