



# Rogers

## Assessment Property Record Card for Tax Year 2026

Data provided by LISA DELOZIER County Assessor

Date 04/16/2026  
Time 22:28:16  
Page 1

Assessment Data					Primary Image																																																																																																																				
<b>Account</b> 660029389 <b>Parcel ID</b> 000000-00-0-00021-002-0006 <b>Cadastral ID</b> 34-21-15-03810 <b>Property Type</b> REAL - Real Property <b>Property Class</b> RRP VI Area 4 <b>Tax Area</b> 4 - VERDIGRIS/VERD FIRE <b>Name ID</b> 342899 RUSSELL, TERRY & KIMBERLY  7245 E VERDIGRIS DR CLAREMORE OK 74019-0000  <b>Parcel Location</b> <b>Situs</b> 07245 VERDIGRIS DR <b>Subdivision</b> BATTENFIELD ACRES 2 <b>Lot/Block</b> 0006 / 0002 Parcel Size 1 - Lots <b>Sec/Twn/Rng</b> 34 / 21 / 15 / 5 <b>Neighborhood</b> 1122 - R-V04-SE VERDIGRIS <b>School District</b> S008 - VERDIGRIS SCHOOLS																																																																																																																									
\\tsclient\C\Users\Randy Necessary\Pictures\101_0708\IMG_0042. 7/11/2022																																																																																																																									
Legal Description					Building Permits																																																																																																																				
Lat/Long: 36.25628834 -95.70004174 LOT 6 BLOCK 2 BATTENFIELD ACRES 2					<table border="1"> <thead> <tr> <th>Number</th> <th>Description</th> <th>Opened</th> <th>Closed</th> <th>Amount</th> </tr> </thead> <tbody> <tr> <td> </td> <td> </td> <td> </td> <td> </td> <td> </td> </tr> </tbody> </table>					Number	Description	Opened	Closed	Amount																																																																																																											
Number	Description	Opened	Closed	Amount																																																																																																																					
Exemptions					Sale History																																																																																																																				
<table border="1"> <thead> <tr> <th>Code</th> <th>Type</th> <th>Active</th> <th>Maximum</th> <th>Exemption</th> </tr> </thead> <tbody> <tr> <td>H</td> <td>Homestead</td> <td>No</td> <td>1,000</td> <td> </td> </tr> </tbody> </table>					Code	Type	Active	Maximum	Exemption	H	Homestead	No	1,000		<table border="1"> <thead> <tr> <th>Bk/Pg</th> <th>Grantor</th> <th>Date</th> <th>Price</th> <th>Code</th> </tr> </thead> <tbody> <tr> <td>/</td> <td>REED, JANICE R</td> <td>09/29/2023</td> <td>230,000</td> <td>YES</td> </tr> <tr> <td>973/71</td> <td>PENNER, DOYNE R &amp;</td> <td>10/17/1994</td> <td>78,000</td> <td>Yes</td> </tr> <tr> <td>862/618</td> <td>SHALEUHY, DONA B</td> <td>09/10/1991</td> <td>75,500</td> <td>No</td> </tr> </tbody> </table>					Bk/Pg	Grantor	Date	Price	Code	/	REED, JANICE R	09/29/2023	230,000	YES	973/71	PENNER, DOYNE R &	10/17/1994	78,000	Yes	862/618	SHALEUHY, DONA B	09/10/1991	75,500	No																																																																																		
Code	Type	Active	Maximum	Exemption																																																																																																																					
H	Homestead	No	1,000																																																																																																																						
Bk/Pg	Grantor	Date	Price	Code																																																																																																																					
/	REED, JANICE R	09/29/2023	230,000	YES																																																																																																																					
973/71	PENNER, DOYNE R &	10/17/1994	78,000	Yes																																																																																																																					
862/618	SHALEUHY, DONA B	09/10/1991	75,500	No																																																																																																																					
Parcel Valuation																																																																																																																									
<table border="1"> <thead> <tr> <th>Source</th> <th>REAL</th> </tr> </thead> <tbody> <tr> <td>Remove Cap</td> <td>2024</td> </tr> <tr> <td>Year Frozen</td> <td>0</td> </tr> <tr> <td>Uncapped Value</td> <td>0</td> </tr> <tr> <td>TIF Project ID</td> <td>0</td> </tr> </tbody> </table>		Source	REAL	Remove Cap	2024	Year Frozen	0	Uncapped Value	0	TIF Project ID	0	<table border="1"> <thead> <tr> <th>Fair Cash</th> <th>Capped</th> <th>Asmnt Level</th> <th>Assessed</th> </tr> </thead> <tbody> <tr> <td>Land Value</td> <td>99,701</td> <td>99,701</td> <td>10,967</td> </tr> <tr> <td>Improvements</td> <td>125,156</td> <td>125,156</td> <td>13,767</td> </tr> <tr> <td>Mobile Home</td> <td>0</td> <td>0</td> <td>0</td> </tr> <tr> <td>Total Value</td> <td>224,857</td> <td>224,857</td> <td>24,734</td> </tr> </tbody> </table>			Fair Cash	Capped	Asmnt Level	Assessed	Land Value	99,701	99,701	10,967	Improvements	125,156	125,156	13,767	Mobile Home	0	0	0	Total Value	224,857	224,857	24,734	<table border="1"> <thead> <tr> <th>Levy Rate</th> <th>Current Tax</th> </tr> </thead> <tbody> <tr> <td>104.132</td> <td>2,575.60</td> </tr> <tr> <td>Assessed</td> <td>24,734</td> </tr> <tr> <td>Penalty</td> <td>0</td> </tr> <tr> <td>Exemption</td> <td>0</td> </tr> <tr> <td>Total Taxable</td> <td>24,734</td> </tr> </tbody> </table>		Levy Rate	Current Tax	104.132	2,575.60	Assessed	24,734	Penalty	0	Exemption	0	Total Taxable	24,734																																																																									
Source	REAL																																																																																																																								
Remove Cap	2024																																																																																																																								
Year Frozen	0																																																																																																																								
Uncapped Value	0																																																																																																																								
TIF Project ID	0																																																																																																																								
Fair Cash	Capped	Asmnt Level	Assessed																																																																																																																						
Land Value	99,701	99,701	10,967																																																																																																																						
Improvements	125,156	125,156	13,767																																																																																																																						
Mobile Home	0	0	0																																																																																																																						
Total Value	224,857	224,857	24,734																																																																																																																						
Levy Rate	Current Tax																																																																																																																								
104.132	2,575.60																																																																																																																								
Assessed	24,734																																																																																																																								
Penalty	0																																																																																																																								
Exemption	0																																																																																																																								
Total Taxable	24,734																																																																																																																								
Assessment History																																																																																																																									
<table border="1"> <thead> <tr> <th>Tax Year</th> <th>Statement Number</th> <th>Billed Owner</th> <th>Tax Area</th> <th>Total Value</th> <th>Exemptions</th> <th>Taxable Value</th> <th>Billed Tax</th> </tr> </thead> <tbody> <tr><td>2025</td><td>2025-660029389</td><td>RUSSELL, TERRY &amp; KIMBERLY</td><td>4</td><td>222,887</td><td>0</td><td>24,517</td><td>2,553.00</td></tr> <tr><td>2024</td><td>2024-660029389</td><td>RUSSELL, TERRY &amp; KIMBERLY</td><td>4</td><td>230,070</td><td>0</td><td>25,308</td><td>2,426.00</td></tr> <tr><td>2023</td><td>2023-660029389</td><td>REED, JANICE R</td><td>4</td><td>156,242</td><td>1000</td><td>14,326</td><td>1,363.00</td></tr> <tr><td>2022</td><td>2022-660029389</td><td>REED, JIM R &amp;</td><td>4</td><td>135,264</td><td>1000</td><td>13,879</td><td>1,344.00</td></tr> <tr><td>2021</td><td>2021-660029389</td><td>REED, JIM R &amp;</td><td>4</td><td>143,785</td><td>1000</td><td>14,568</td><td>1,373.00</td></tr> <tr><td>2020</td><td>2020-660029389</td><td>REED, JIM R &amp;</td><td>4</td><td>143,193</td><td>1000</td><td>14,115</td><td>1,334.00</td></tr> <tr><td>2019</td><td>2019-660029389</td><td>REED, JIM R &amp;</td><td>4</td><td>136,544</td><td>1000</td><td>13,675</td><td>1,313.00</td></tr> <tr><td>2018</td><td>2018-660029389</td><td>REED, JIM R &amp;</td><td>4</td><td>142,124</td><td>1000</td><td>13,248</td><td>1,273.00</td></tr> <tr><td>2017</td><td>2017-660029389</td><td>REED, JIM R &amp;</td><td>4</td><td>141,011</td><td>1000</td><td>12,832</td><td>1,236.00</td></tr> <tr><td>2016</td><td>2016-660029389</td><td>REED, JIM R &amp;</td><td>4</td><td>137,652</td><td>1000</td><td>12,430</td><td>1,201.00</td></tr> <tr><td>2015</td><td>2015-660029389</td><td>REED, JIM R &amp;</td><td>4</td><td>136,481</td><td>1000</td><td>12,039</td><td>1,173.00</td></tr> <tr><td>2014</td><td>2014-660029389</td><td>REED, JIM R &amp;</td><td>4</td><td>138,960</td><td>1000</td><td>11,659</td><td>1,075.00</td></tr> <tr><td>2013</td><td>2013-660029389</td><td>REED, JIM R &amp;</td><td>4</td><td>132,665</td><td>1000</td><td>11,291</td><td>1,080.00</td></tr> </tbody> </table>										Tax Year	Statement Number	Billed Owner	Tax Area	Total Value	Exemptions	Taxable Value	Billed Tax	2025	2025-660029389	RUSSELL, TERRY & KIMBERLY	4	222,887	0	24,517	2,553.00	2024	2024-660029389	RUSSELL, TERRY & KIMBERLY	4	230,070	0	25,308	2,426.00	2023	2023-660029389	REED, JANICE R	4	156,242	1000	14,326	1,363.00	2022	2022-660029389	REED, JIM R &	4	135,264	1000	13,879	1,344.00	2021	2021-660029389	REED, JIM R &	4	143,785	1000	14,568	1,373.00	2020	2020-660029389	REED, JIM R &	4	143,193	1000	14,115	1,334.00	2019	2019-660029389	REED, JIM R &	4	136,544	1000	13,675	1,313.00	2018	2018-660029389	REED, JIM R &	4	142,124	1000	13,248	1,273.00	2017	2017-660029389	REED, JIM R &	4	141,011	1000	12,832	1,236.00	2016	2016-660029389	REED, JIM R &	4	137,652	1000	12,430	1,201.00	2015	2015-660029389	REED, JIM R &	4	136,481	1000	12,039	1,173.00	2014	2014-660029389	REED, JIM R &	4	138,960	1000	11,659	1,075.00	2013	2013-660029389	REED, JIM R &	4	132,665	1000	11,291	1,080.00
Tax Year	Statement Number	Billed Owner	Tax Area	Total Value	Exemptions	Taxable Value	Billed Tax																																																																																																																		
2025	2025-660029389	RUSSELL, TERRY & KIMBERLY	4	222,887	0	24,517	2,553.00																																																																																																																		
2024	2024-660029389	RUSSELL, TERRY & KIMBERLY	4	230,070	0	25,308	2,426.00																																																																																																																		
2023	2023-660029389	REED, JANICE R	4	156,242	1000	14,326	1,363.00																																																																																																																		
2022	2022-660029389	REED, JIM R &	4	135,264	1000	13,879	1,344.00																																																																																																																		
2021	2021-660029389	REED, JIM R &	4	143,785	1000	14,568	1,373.00																																																																																																																		
2020	2020-660029389	REED, JIM R &	4	143,193	1000	14,115	1,334.00																																																																																																																		
2019	2019-660029389	REED, JIM R &	4	136,544	1000	13,675	1,313.00																																																																																																																		
2018	2018-660029389	REED, JIM R &	4	142,124	1000	13,248	1,273.00																																																																																																																		
2017	2017-660029389	REED, JIM R &	4	141,011	1000	12,832	1,236.00																																																																																																																		
2016	2016-660029389	REED, JIM R &	4	137,652	1000	12,430	1,201.00																																																																																																																		
2015	2015-660029389	REED, JIM R &	4	136,481	1000	12,039	1,173.00																																																																																																																		
2014	2014-660029389	REED, JIM R &	4	138,960	1000	11,659	1,075.00																																																																																																																		
2013	2013-660029389	REED, JIM R &	4	132,665	1000	11,291	1,080.00																																																																																																																		



# Rogers

## Assessment Property Record Card for Tax Year 2026

Data provided by LISA DELOZIER County Assessor

Date 04/16/2026  
Time 22:28:16  
Page 2

Lot Data	Square-Foot - NBHD 1122 #1	Primary Image
Lot Size		
Lot Count	1	
Units Buildable	1	
Non-Ag Acres	1.2938	
Topography		
Street Access		
Utilities		
Amenities	LAND QUALITY 0	
	0	
Method	Square-Foot	
Base Lot Value	56,359.00 x 1.51 = 84,931	
Factor Value		
Adjustments	1.1739	
Lot Value	99,701	

Residential Data	
Type	1 Single Family Residence
Condition	3 - Average
Quality	2.5 - Fair
Architecture	
Style	100% One Story
Exterior Wall	100% Veneer, Stone
Base/Total Area	1,600 / 1,600
Style	100% One Story
HVAC	100% Warmed & Cooled Air
Roof Cover	1 Composition Shingle
Area on Slab	1,600
Fixture/RghIn	11 /
Bed/F/H Bath	3 / 2.0 /
Basement Area	
Garage Type	500 Attached Garage - Unfinished
Remodel	
Year/Eff Age	1976 / 38

\\tsclient\C\Users\Randy Necessary\Pictures\101\_0708\IMG\_0042. 7/11/2022

GRM Approach	
GRM Code	
Gross Rent	0.00
Indicated Value	

Multiple Regression			
MRA Code	1	Test	
Adjusted R	0.8445		
Indicated Value	165,850	103.66	Per SqFt

Direct Comparables			
Selection Model	A	Adam Test	
Adjustment Model	1	2022 Residential	
Comparables	4		
Indicated Value	238,010		Per SqFt

Cost Approach				Manual : 01/2025			
Base Cost	105.95	Total Misc Impr	+	15,479			
Roofing Adj	+ 4.27	Garage Cost	+	13,720			
Subfloor Adj	+ -1.15	Total RCN	=	236,143			
Heat/Cool Adj	+ 11.47	Depreciation ( 47%)	-	110,987			
Plumbing Adj	+ 8.80	Lump Sums	+	0			
Basement Adj	+ 0.00	RCNLD	=	125,156			
Adj Base Cost	= 129.34	Lot Value	+	99,701			
Total Area	x 1,600	Indicated Value	=	224,857			
Adjusted Cost	= 206,944	Value Per SqFt		140.54			

Value Reconciliation			
Selected Approach	Cost Approach		
Improvements	125,156		
Lot Value	99,701		
Indicated Value	224,857	140.54	Per SqFt
Agland Value			
Site Improvements			
Total Value	224,857	140.54	Total Value Per SqFt

Miscellaneous Improvements								
Code	Description	Sketch ID	Size	Year	Units	Unit Cost	Depr	Value
FPR1	FIREPLACE - RESIDENTIAL 1 STORY	0		1	1	5,095.98		5,096
PRCH	SLAB PORCH - COVERED	70326		120	120	23.88		2,866
PRCH	SLAB PORCH - COVERED	70327	18x18		324	23.20		7,517



# Rogers

## Assessment Property Record Card for Tax Year 2026

Data provided by LISA DELOZIER County Assessor

Date 04/16/2026

Time 22:28:16

Page 3

Sketch Image

660029389

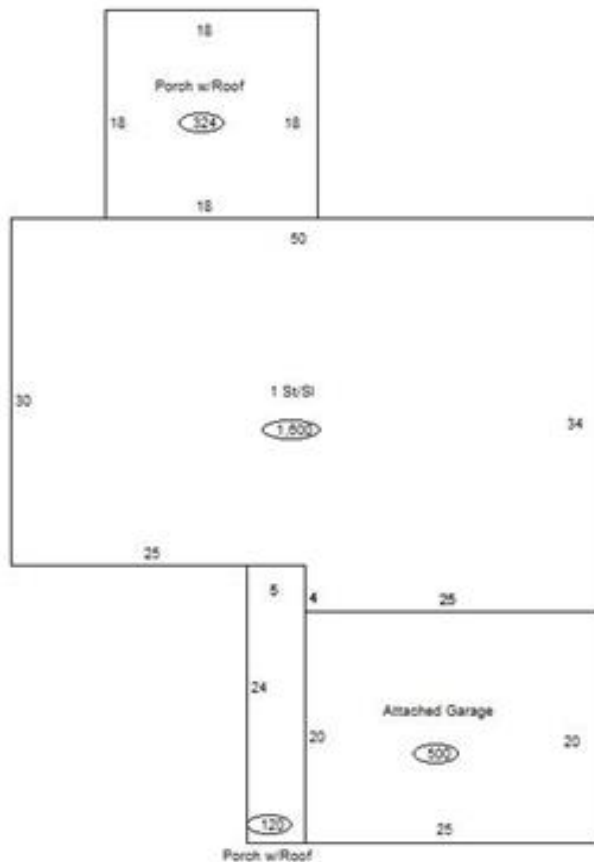

### Sketch Vector Information

Sequence	Code	Type	Built Over	Scale	Section Label	Base Area	Multiplier	Total Area
1	R	1	Slab	13	1 St/Sl	1,600	1.000	1,600
2	G	1		13	Attached Garage	500	1.000	500
3	M	PRCH		13	SLBC	120	1.000	120
4	M	PRCH		13	SLBC	324	1.000	324
<b>Total Building Area</b>						1,600		1,600