



# Rogers

## Assessment Property Record Card for Tax Year 2026

Data provided by LISA DELOZIER County Assessor

Date 04/16/2026  
Time 21:58:40  
Page 1

Assessment Data					Primary Image																																																																																																																				
<b>Account</b> 660029402 <b>Parcel ID</b> 000000-00-0-00024-003-0001 <b>Cadastral ID</b> 34-21-15-03940 <b>Property Type</b> REAL - Real Property <b>Property Class</b> RRP VI Area 4 <b>Tax Area</b> 4 - VERDIGRIS/VERD FIRE <b>Name ID</b> 253071 LAWSON, DOROTHY J-TRUSTEE IRREVOCABLE TRUST  7388 E VERDIGRIS DR CLAREMORE OK 74019-0000  <b>Parcel Location</b> <b>Situs</b> 07388 E VERDIGRIS DR <b>Subdivision</b> BATTENFIELD ACRES 3 <b>Lot/Block</b> 0001 / 0003 <b>Parcel Size</b> 1 - Lots <b>Sec/Twn/Rng</b> 34 / 21 / 15 / 5 <b>Neighborhood</b> 1122 - R-V04-SE VERDIGRIS <b>School District</b> S008 - VERDIGRIS SCHOOLS																																																																																																																									
<b>Legal Description</b> Lot/Long: 36.25533315 -95.69652881																																																																																																																									
<b>Building Permits</b>					<table border="1"> <thead> <tr> <th>Number</th> <th>Description</th> <th>Opened</th> <th>Closed</th> <th>Amount</th> </tr> </thead> <tbody> <tr> <td colspan="5" style="height: 100px;"> </td> </tr> </tbody> </table>					Number	Description	Opened	Closed	Amount																																																																																																											
Number	Description	Opened	Closed	Amount																																																																																																																					
<b>Exemptions</b>					<b>Sale History</b>																																																																																																																				
<table border="1"> <thead> <tr> <th>Code</th> <th>Type</th> <th>Active</th> <th>Maximum</th> <th>Exemption</th> </tr> </thead> <tbody> <tr> <td>H</td> <td>Homestead</td> <td>Yes</td> <td>1,000</td> <td>1,000</td> </tr> </tbody> </table>					Code	Type	Active	Maximum	Exemption	H	Homestead	Yes	1,000	1,000	<table border="1"> <thead> <tr> <th>Bk/Pg</th> <th>Grantor</th> <th>Date</th> <th>Price</th> <th>Code</th> </tr> </thead> <tbody> <tr> <td>2658/237</td> <td>LAWSON, DOROTHY J</td> <td>07/25/2017</td> <td></td> <td>4</td> </tr> <tr> <td>2631/708</td> <td>LAWSON, WILLARD D &amp;</td> <td>05/08/2017</td> <td>0</td> <td>4</td> </tr> <tr> <td>889/177</td> <td>SEHESTED, ROBERT H</td> <td>08/10/1992</td> <td>11,000</td> <td>No</td> </tr> </tbody> </table>					Bk/Pg	Grantor	Date	Price	Code	2658/237	LAWSON, DOROTHY J	07/25/2017		4	2631/708	LAWSON, WILLARD D &	05/08/2017	0	4	889/177	SEHESTED, ROBERT H	08/10/1992	11,000	No																																																																																		
Code	Type	Active	Maximum	Exemption																																																																																																																					
H	Homestead	Yes	1,000	1,000																																																																																																																					
Bk/Pg	Grantor	Date	Price	Code																																																																																																																					
2658/237	LAWSON, DOROTHY J	07/25/2017		4																																																																																																																					
2631/708	LAWSON, WILLARD D &	05/08/2017	0	4																																																																																																																					
889/177	SEHESTED, ROBERT H	08/10/1992	11,000	No																																																																																																																					
<b>Parcel Valuation</b>																																																																																																																									
<table border="1"> <thead> <tr> <th>Source</th> <th>REAL</th> </tr> </thead> <tbody> <tr> <td>Remove Cap</td> <td>0</td> </tr> <tr> <td>Year Frozen</td> <td>2005</td> </tr> <tr> <td>Uncapped Value</td> <td>0</td> </tr> <tr> <td>TIF Project ID</td> <td>0</td> </tr> </tbody> </table>		Source	REAL	Remove Cap	0	Year Frozen	2005	Uncapped Value	0	TIF Project ID	0	<table border="1"> <thead> <tr> <th>Fair Cash</th> <th>Capped</th> <th>Asmnt Level</th> <th>Assessed</th> </tr> </thead> <tbody> <tr> <td>Land Value</td> <td>88,369</td> <td>30,732</td> <td>11%</td> </tr> <tr> <td>Improvements</td> <td>157,219</td> <td>54,676</td> <td>6,014</td> </tr> <tr> <td>Mobile Home</td> <td>0</td> <td>0</td> <td>0</td> </tr> <tr> <td>Total Value</td> <td>245,588</td> <td>85,408</td> <td>9,395</td> </tr> </tbody> </table>			Fair Cash	Capped	Asmnt Level	Assessed	Land Value	88,369	30,732	11%	Improvements	157,219	54,676	6,014	Mobile Home	0	0	0	Total Value	245,588	85,408	9,395	<table border="1"> <thead> <tr> <th>Levy Rate</th> <th>Current Tax</th> </tr> </thead> <tbody> <tr> <td>104.132</td> <td>978.32</td> </tr> <tr> <td>Assessed</td> <td>9,395</td> </tr> <tr> <td>Penalty</td> <td>0</td> </tr> <tr> <td>Exemption</td> <td>1,000</td> </tr> <tr> <td>Total Taxable</td> <td>8,395</td> </tr> </tbody> </table>		Levy Rate	Current Tax	104.132	978.32	Assessed	9,395	Penalty	0	Exemption	1,000	Total Taxable	8,395																																																																									
Source	REAL																																																																																																																								
Remove Cap	0																																																																																																																								
Year Frozen	2005																																																																																																																								
Uncapped Value	0																																																																																																																								
TIF Project ID	0																																																																																																																								
Fair Cash	Capped	Asmnt Level	Assessed																																																																																																																						
Land Value	88,369	30,732	11%																																																																																																																						
Improvements	157,219	54,676	6,014																																																																																																																						
Mobile Home	0	0	0																																																																																																																						
Total Value	245,588	85,408	9,395																																																																																																																						
Levy Rate	Current Tax																																																																																																																								
104.132	978.32																																																																																																																								
Assessed	9,395																																																																																																																								
Penalty	0																																																																																																																								
Exemption	1,000																																																																																																																								
Total Taxable	8,395																																																																																																																								
<b>Assessment History</b>																																																																																																																									
<table border="1"> <thead> <tr> <th>Tax Year</th> <th>Statement Number</th> <th>Billed Owner</th> <th>Tax Area</th> <th>Total Value</th> <th>Exemptions</th> <th>Taxable Value</th> <th>Billed Tax</th> </tr> </thead> <tbody> <tr><td>2025</td><td>2025-660029402</td><td>LAWSON, DOROTHY J-TRUSTEE</td><td>4</td><td>244,421</td><td>1000</td><td>8,395</td><td>891.00</td></tr> <tr><td>2024</td><td>2024-660029402</td><td>LAWSON, DOROTHY J-TRUSTEE</td><td>4</td><td>254,116</td><td>1000</td><td>8,395</td><td>815.00</td></tr> <tr><td>2023</td><td>2023-660029402</td><td>LAWSON, DOROTHY J-TRUSTEE</td><td>4</td><td>186,991</td><td>1000</td><td>8,395</td><td>803.00</td></tr> <tr><td>2022</td><td>2022-660029402</td><td>LAWSON, DOROTHY J-TRUSTEE</td><td>4</td><td>160,030</td><td>1000</td><td>8,395</td><td>817.00</td></tr> <tr><td>2021</td><td>2021-660029402</td><td>LAWSON, DOROTHY J-TRUSTEE</td><td>4</td><td>158,307</td><td>1000</td><td>8,395</td><td>796.00</td></tr> <tr><td>2020</td><td>2020-660029402</td><td>LAWSON, DOROTHY J-TRUSTEE</td><td>4</td><td>157,326</td><td>1000</td><td>8,395</td><td>798.00</td></tr> <tr><td>2019</td><td>2019-660029402</td><td>LAWSON, DOROTHY J-TRUSTEE</td><td>4</td><td>149,674</td><td>1000</td><td>8,394</td><td>810.00</td></tr> <tr><td>2018</td><td>2018-660029402</td><td>LAWSON, DOROTHY J-TRUSTEE</td><td>4</td><td>155,306</td><td>1000</td><td>8,395</td><td>811.00</td></tr> <tr><td>2017</td><td>2017-660029402</td><td>LAWSON, DOROTHY J-TRUSTEE</td><td>4</td><td>154,027</td><td>1000</td><td>8,395</td><td>813.00</td></tr> <tr><td>2016</td><td>2016-660029402</td><td>LAWSON, WILLARD D &amp;</td><td>4</td><td>150,103</td><td>1000</td><td>8,395</td><td>815.00</td></tr> <tr><td>2015</td><td>2015-660029402</td><td>LAWSON, WILLARD D &amp;</td><td>4</td><td>147,790</td><td>1000</td><td>8,395</td><td>821.00</td></tr> <tr><td>2014</td><td>2014-660029402</td><td>LAWSON, WILLARD D &amp;</td><td>4</td><td>150,998</td><td>1000</td><td>8,395</td><td>778.00</td></tr> <tr><td>2013</td><td>2013-660029402</td><td>LAWSON, WILLARD D &amp;</td><td>4</td><td>142,465</td><td>1000</td><td>8,395</td><td>805.00</td></tr> </tbody> </table>										Tax Year	Statement Number	Billed Owner	Tax Area	Total Value	Exemptions	Taxable Value	Billed Tax	2025	2025-660029402	LAWSON, DOROTHY J-TRUSTEE	4	244,421	1000	8,395	891.00	2024	2024-660029402	LAWSON, DOROTHY J-TRUSTEE	4	254,116	1000	8,395	815.00	2023	2023-660029402	LAWSON, DOROTHY J-TRUSTEE	4	186,991	1000	8,395	803.00	2022	2022-660029402	LAWSON, DOROTHY J-TRUSTEE	4	160,030	1000	8,395	817.00	2021	2021-660029402	LAWSON, DOROTHY J-TRUSTEE	4	158,307	1000	8,395	796.00	2020	2020-660029402	LAWSON, DOROTHY J-TRUSTEE	4	157,326	1000	8,395	798.00	2019	2019-660029402	LAWSON, DOROTHY J-TRUSTEE	4	149,674	1000	8,394	810.00	2018	2018-660029402	LAWSON, DOROTHY J-TRUSTEE	4	155,306	1000	8,395	811.00	2017	2017-660029402	LAWSON, DOROTHY J-TRUSTEE	4	154,027	1000	8,395	813.00	2016	2016-660029402	LAWSON, WILLARD D &	4	150,103	1000	8,395	815.00	2015	2015-660029402	LAWSON, WILLARD D &	4	147,790	1000	8,395	821.00	2014	2014-660029402	LAWSON, WILLARD D &	4	150,998	1000	8,395	778.00	2013	2013-660029402	LAWSON, WILLARD D &	4	142,465	1000	8,395	805.00
Tax Year	Statement Number	Billed Owner	Tax Area	Total Value	Exemptions	Taxable Value	Billed Tax																																																																																																																		
2025	2025-660029402	LAWSON, DOROTHY J-TRUSTEE	4	244,421	1000	8,395	891.00																																																																																																																		
2024	2024-660029402	LAWSON, DOROTHY J-TRUSTEE	4	254,116	1000	8,395	815.00																																																																																																																		
2023	2023-660029402	LAWSON, DOROTHY J-TRUSTEE	4	186,991	1000	8,395	803.00																																																																																																																		
2022	2022-660029402	LAWSON, DOROTHY J-TRUSTEE	4	160,030	1000	8,395	817.00																																																																																																																		
2021	2021-660029402	LAWSON, DOROTHY J-TRUSTEE	4	158,307	1000	8,395	796.00																																																																																																																		
2020	2020-660029402	LAWSON, DOROTHY J-TRUSTEE	4	157,326	1000	8,395	798.00																																																																																																																		
2019	2019-660029402	LAWSON, DOROTHY J-TRUSTEE	4	149,674	1000	8,394	810.00																																																																																																																		
2018	2018-660029402	LAWSON, DOROTHY J-TRUSTEE	4	155,306	1000	8,395	811.00																																																																																																																		
2017	2017-660029402	LAWSON, DOROTHY J-TRUSTEE	4	154,027	1000	8,395	813.00																																																																																																																		
2016	2016-660029402	LAWSON, WILLARD D &	4	150,103	1000	8,395	815.00																																																																																																																		
2015	2015-660029402	LAWSON, WILLARD D &	4	147,790	1000	8,395	821.00																																																																																																																		
2014	2014-660029402	LAWSON, WILLARD D &	4	150,998	1000	8,395	778.00																																																																																																																		
2013	2013-660029402	LAWSON, WILLARD D &	4	142,465	1000	8,395	805.00																																																																																																																		



# Rogers

## Assessment Property Record Card for Tax Year 2026

Data provided by LISA DELOZIER County Assessor

Date 04/16/2026  
Time 21:58:40  
Page 2

Lot Data		Square-Foot - NBHD 1122 #1	
Lot Size			
Lot Count	1		
Units Buildable	1		
Non-Ag Acres	1.3867		
Topography			
Street Access			
Utilities			
Amenities	LAND QUALITY	0	
		0	
Method	Square-Foot		
Base Lot Value	60,404.00 x 1.46 = 88,369		
Factor Value			
Adjustments	1.0000		
Lot Value	88,369		



\\tsclient\C\Users\Randy Necessary\Pictures\101\_0708\IMG\_0060. 7/11/2022

Residential Data	
Type	1 Single Family Residence
Condition	3 - Average
Quality	2.5 - Fair
Architecture	
Style	100% One Story
Exterior Wall	40% Veneer, Masonry 60% Frame, Siding, Wood
Base/Total Area	1,713 / 1,713
Style	100% One Story
HVAC	100% Warmed & Cooled Air
Roof Cover	1 Composition Shingle
Area on Slab	1,713
Fixture/RghIn	11 /
Bed/F/H Bath	2 / 2.0 /
Basement Area	
Garage Type	582 Attached Garage - Unfinished
Remodel	
Year/Eff Age	1992 / 26

GRM Approach	
GRM Code	
Gross Rent	0.00
Indicated Value	

Multiple Regression			
MRA Code	1	Test	
Adjusted R	0.8445		
Indicated Value	196,081	114.47	Per SqFt

Direct Comparables			
Selection Model	A	Adam Test	
Adjustment Model	1	2022 Residential	
Comparables	4		
Indicated Value	247,640		Per SqFt

Cost Approach				Manual : 01/2025			
Base Cost	98.92	Total Misc Impr	+	11,623			
Roofing Adj	+ 4.40	Garage Cost	+	15,435			
Subfloor Adj	+ -1.15	Total RCN	=	235,804			
Heat/Cool Adj	+ 11.47	Depreciation ( 35%)	-	82,531			
Plumbing Adj	+ 8.22	Lump Sums	+	3,946			
Basement Adj	+ 0.00	RCNLD	=	157,219			
Adj Base Cost	= 121.86	Lot Value	+	88,369			
Total Area	x 1,713	Indicated Value	=	245,588			
Adjusted Cost	= 208,746	Value Per SqFt		143.37			

Value Reconciliation			
Selected Approach	Cost Approach		
Improvements	157,219		
Lot Value	88,369		
Indicated Value	245,588	143.37	Per SqFt
Agland Value			
Site Improvements			
Total Value	245,588	143.37	Total Value Per SqFt

Miscellaneous Improvements								
Code	Description	Sketch ID	Size	Year	Units	Unit Cost	Depr	Value
FPR1	FIREPLACE - RESIDENTIAL 1 STORY	0		1	1	5,095.98		5,096
PRCH	SLAB PORCH - COVERED	70388	40x7		280	23.31		6,527
WODO	WOOD DECK - OPEN	70389	63x6		378	16.06	35%	3,946



**Rogers**  
**Assessment Property Record Card for Tax Year 2026**

Data provided by LISA DELOZIER County Assessor

Date 04/16/2026  
 Time 21:58:40  
 Page 3

Sketch Image

660029402

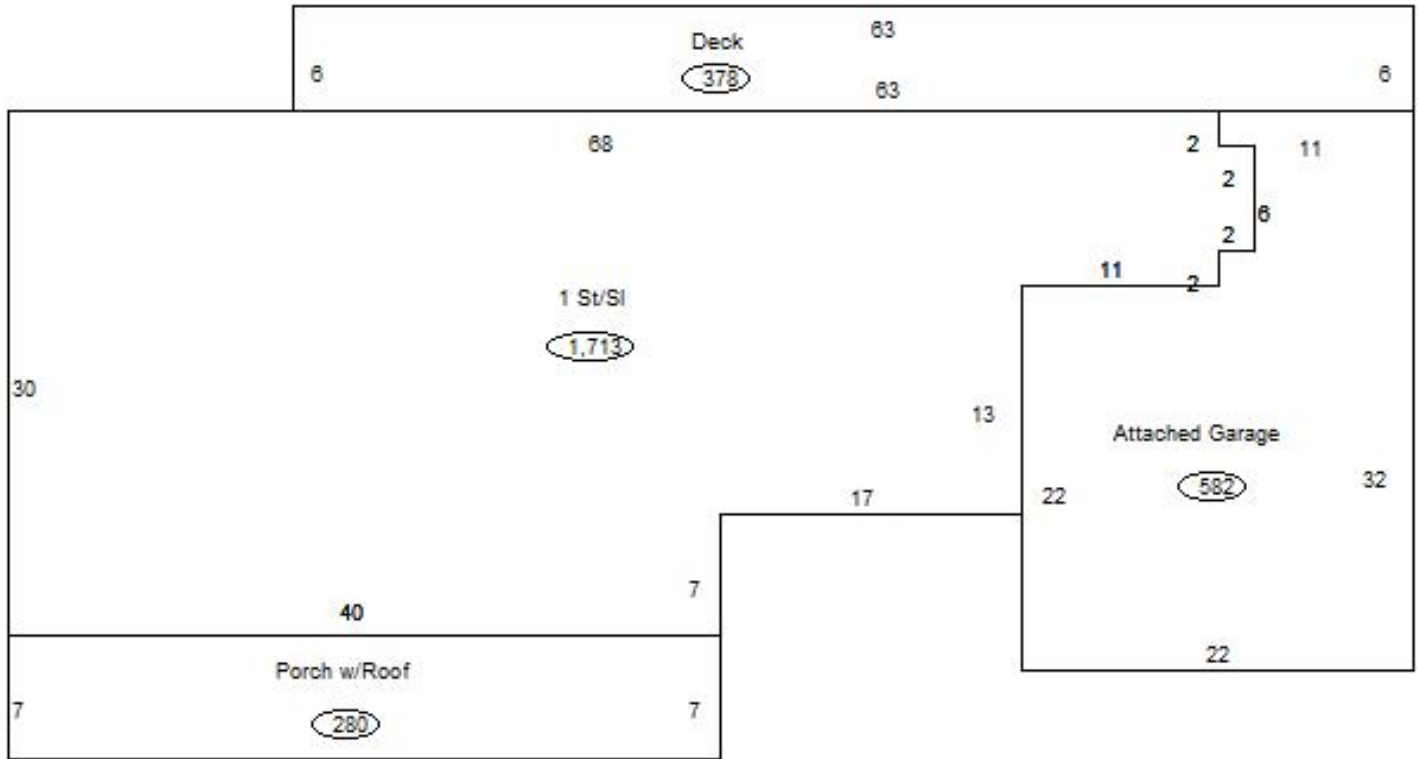

**Sketch Vector Information**

Sequence	Code	Type	Built Over	Scale	Section Label	Base Area	Multiplier	Total Area
1	R	1	Slab	13	1 St/Sl	1,713	1.000	1,713
2	G	1		13	Attached Garage	582	1.000	582
3	M	PRCH		13	SLBC	280	1.000	280
4	M	WODO		13	WODO	378	1.000	378
<b>Total Building Area</b>						1,713		1,713